

RW-3 EAST

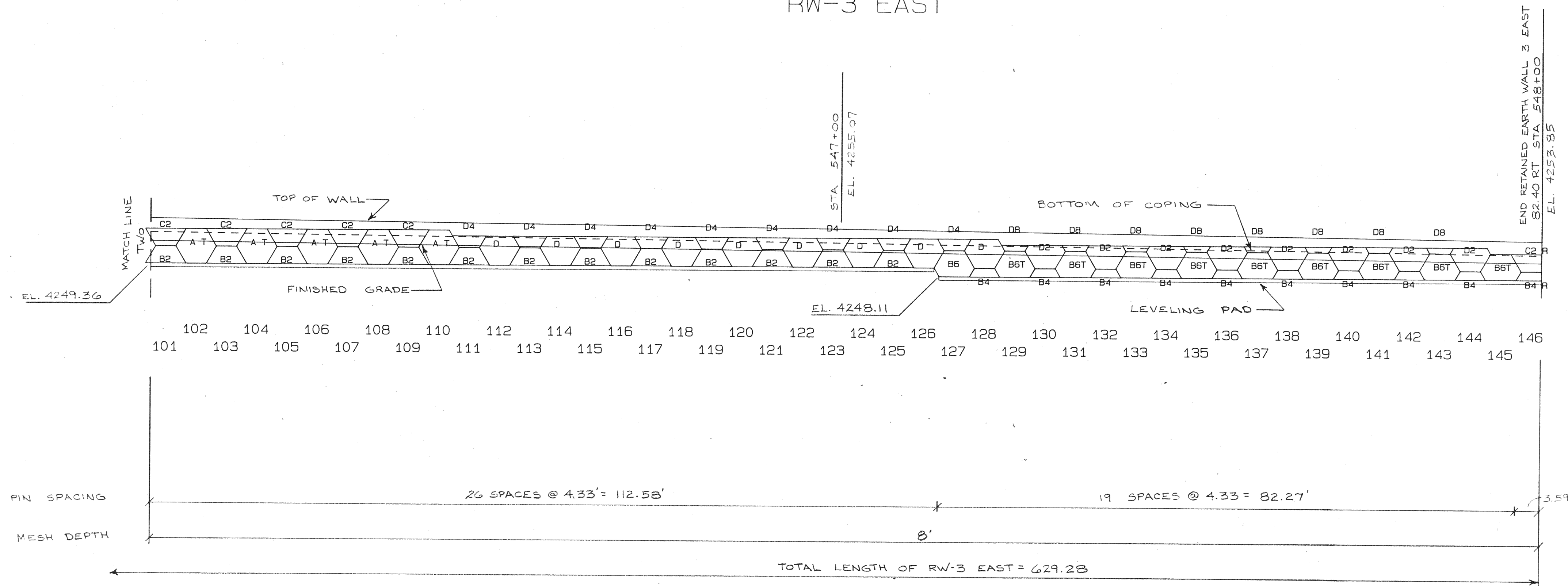

RW-3 EAST

DES.	DRN.	CHK.	NO.	DATE	REVISION	BY
8/2/87	8/20/87	8/24/87				
VSL POSTENSIONING INSTITUTE						

**VSL Corporation**

1414 Post & Padlock  
Grand Prairie, Texas 75050  
Telephone: 214/647-0200  
Fax: 750-886

LOS GATOS, CA / CHICAGO, IL / DALLAS, TX / DENVER, CO / HONOLULU, HI  
HOUSTON, TX / LOS ANGELES, CA / MIAMI, FL / NEW YORK, NY / WASHINGTON, D.C.

VSL Corporation ("VSL") claims a strict proprietary ("information") in and to the design, calculations, drawings, and specifications. This information is to be used only for the project specifically intended for it and to the material and/or services provided by VSL. No part of this information may be reproduced, stored in a retrieval system, or transmitted, in any form or by any means, electronic, mechanical, photocopying, recording, or by any information storage and retrieval system, without the prior written permission of VSL. ANY LIABILITY THEREFOR.

**RETAINED EARTH WALL 3 EAST**

**CALIFORNIA AVE INTERCHANGE**  
DEPT. OF TRANSPORTATION  
UTAH

**PROJ.**  
I-15-9(82)19  
Drawg. No. R-196

**JOB NO:** 278-PB 187

**RE-7**