

22-JF 4 D:\ENR\0416244\3525_03\Sheet_Files\Structures\Wall R-434C.dwg

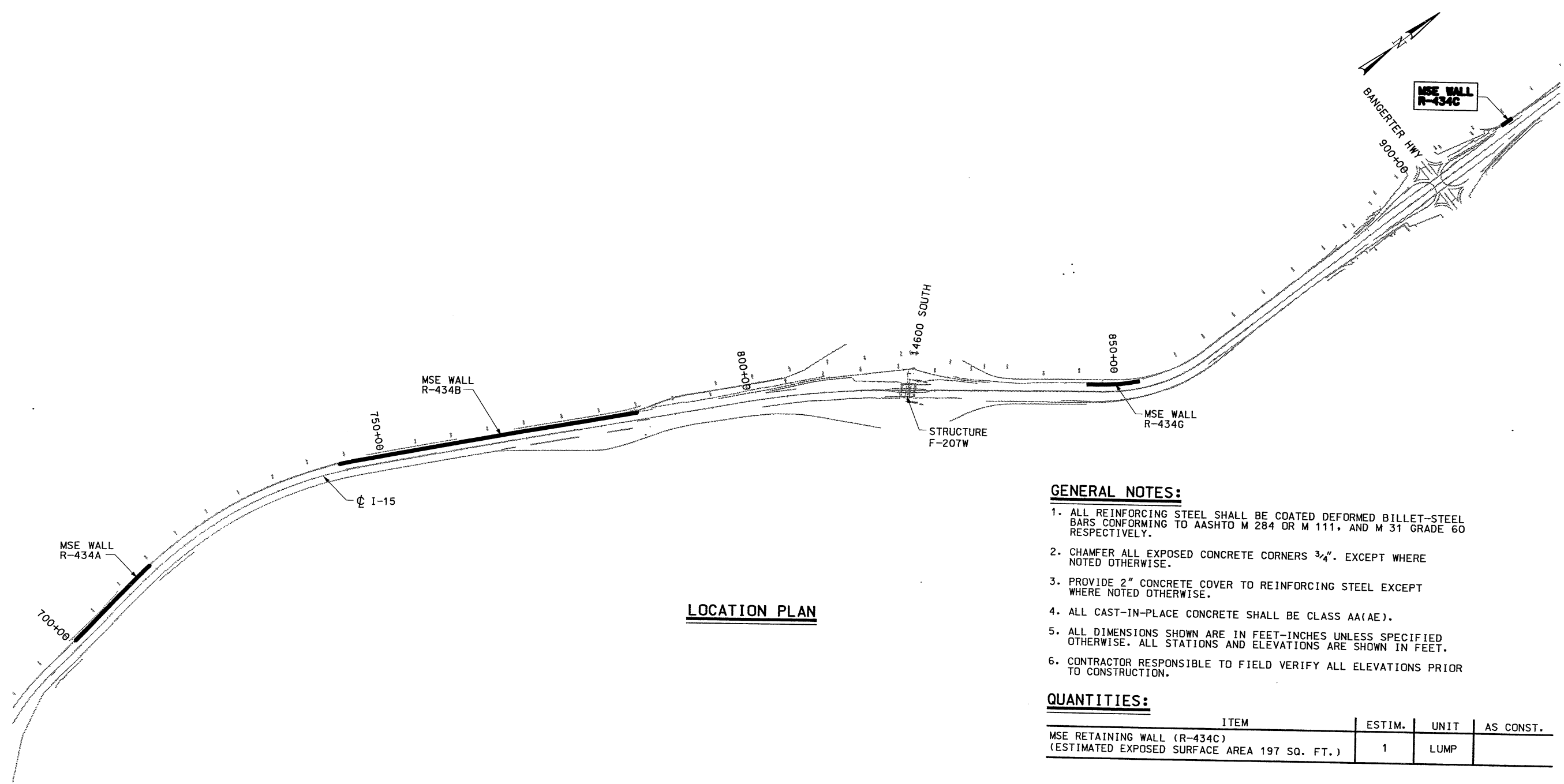

LOCATION PLAN

GENERAL NOTES:

1. ALL REINFORCING STEEL SHALL BE COATED DEFORMED BILLET-STEEL BARS CONFORMING TO AASHTO M 284 OR M 111, AND M 31 GRADE 60 RESPECTIVELY.
2. CHAMFER ALL EXPOSED CONCRETE CORNERS 3/4". EXCEPT WHERE NOTED OTHERWISE.
3. PROVIDE 2" CONCRETE COVER TO REINFORCING STEEL EXCEPT WHERE NOTED OTHERWISE.
4. ALL CAST-IN-PLACE CONCRETE SHALL BE CLASS AA(AE).
5. ALL DIMENSIONS SHOWN ARE IN FEET-INCHES UNLESS SPECIFIED OTHERWISE. ALL STATIONS AND ELEVATIONS ARE SHOWN IN FEET.
6. CONTRACTOR RESPONSIBLE TO FIELD VERIFY ALL ELEVATIONS PRIOR TO CONSTRUCTION.

QUANTITIES:

ITEM	ESTIM.	UNIT	AS CONST.
MSE RETAINING WALL (R-434C) (ESTIMATED EXPOSED SURFACE AREA 197 SQ. FT.)	1	LUMP	

DESIGN DATA:

CAST-IN-PLACE CONCRETE: $f'_c = 3650$ psi; $f'_c = 1200$ psi;
(FOR COPING) f'_s (REINF.) = 24,000 psi; $n=9$

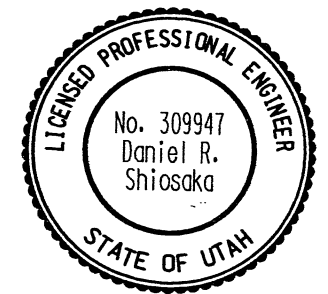

UTAH DEPARTMENT OF TRANSPORTATION SALT LAKE CITY, UTAH STRUCTURES DIVISION		DESIGN_BPD_01/04	CHECK_DRS_01/04
I-15 UTAH CO. LINE TO 10600 SO. WALL R-434C		DRAWN_NRD_01/04	CHECK_DRS_01/04
SITUATION AND LAYOUT		APPROVAL_DATE_1/12/04	SENDER_DESIGN_ENGR.
PROJECT NUMBER SP-15-7(167)288		APPROVED_BY_UJOT	UDOT BRIDGE ENGR.
SALT LAKE COUNTY			
R-434C DRG. NO.			
SHT. 1 OF 5			