

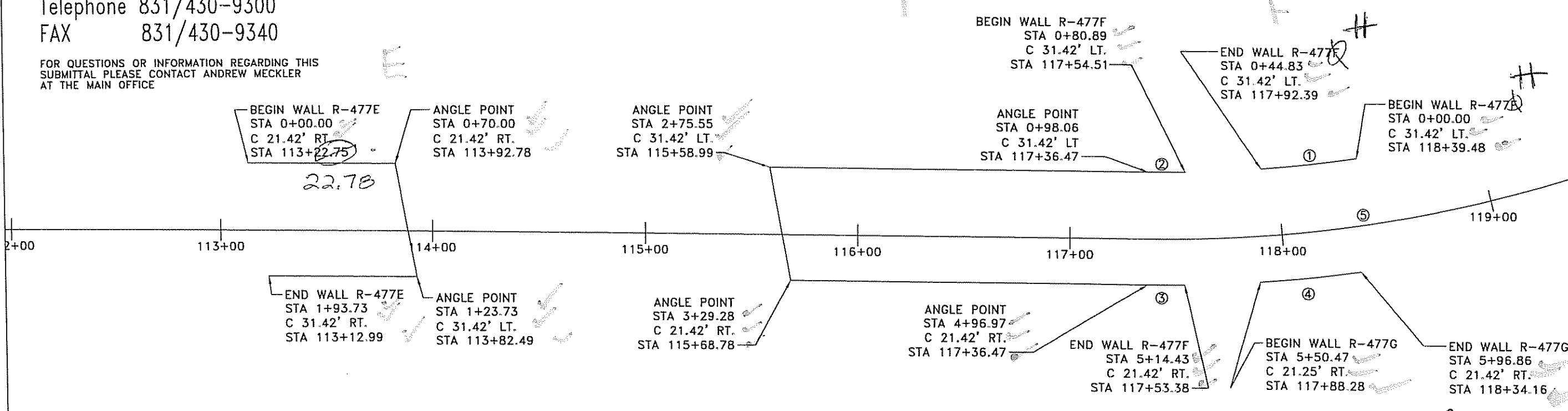

MAIN OFFICE
 4740 Scotts Valley Drive, Suite "E"
 Scotts Valley, California 95066
 Telephone 831/430-9300
 FAX 831/430-9340

FOR QUESTIONS OR INFORMATION REGARDING THIS SUBMITTAL PLEASE CONTACT ANDREW MECKLER AT THE MAIN OFFICE

INDEX OF DRAWINGS	
SHEET	DESCRIPTION
WW1	PLAN VIEW AND INDEX OF DRAWINGS
WW2	ELEVATIONS: WALLS E - 1 OF 2
WW3	ELEVATIONS: WALLS E - 2 OF 2
WW4	ELEVATIONS: WALL H
WW5	ELEVATIONS: WALL F - 1 OF 3
WW6	ELEVATIONS: WALL F - 2 OF 3
WW7	ELEVATIONS: WALL F - 3 OF 3
WW8	ELEVATIONS: WALL G
WW9	TYPICAL CROSS SECTIONS - 1 OF 3
WW10	TYPICAL CROSS SECTIONS - 2 OF 3
WW11	TYPICAL CROSS SECTIONS - 3 OF 3
WW12	STANDARD WIRE WALL DETAILS: 1 OF 2
WW13	STANDARD WIRE WALL DETAILS: 2 OF 2



LPI CURVE DATA				
No.	RADIUS	Δ	TANGENT	LENGTH
1	622.57'	9°01'29"	49.13'	98.06'
2	622.57	9°01'29"	49.13'	98.06'
3	675.41'	8°33'32"	50.54'	100.89
4	675.41'	8°33'32"	50.54'	100.89'
5	654.00'	18°13'13"	104.87'	207.98'

- NOTES:
- MSE DESIGN CRITERIA IS LISTED ON PROJECT SPECIFICATIONS CALCULATIONS.
 - SSL ENGINEERING DRAWINGS ARE TO BE USED IN CONJUNCTION WITH THE CONTRACT DOCUMENTS FOR DETAILS AND FEATURES NOT SHOWN HERE.
 - SSL EXPERTISE IS IN THE DESIGN, DETAILING AND PRODUCTION OF PROPRIETARY AND OR PATENTED PERMANENT AND TEMPORARY MSE WALL SYSTEM COMPONENTS.
 - THE INCLUSION OF THE SSL INSTALLATION AND ERECTION SEQUENCE MANUAL DOES NOT RELIEVE THE CONTRACTOR TO COMPLY WITH THE CONTRACT DOCUMENTS FOR THE DEVELOPMENT AND IMPLEMENTATION OF A SAFE CONSTRUCTION PROCEDURE WHICH COMPLIES WITH THE CONTRACT DOCUMENTS.
 - THE OWNER REMAINS RESPONSIBLE FOR THE INSPECTION AND ACCEPTANCE OF THE COMPLETED RETAINING WALL.

Furnish As Submitted Revise And Resubmit
 Furnish As Corrected Submit Specified Item

Corrections or comments made on the shop drawings during the review do not relieve contractor from compliance with requirements of the drawings and specifications. This check is only for review of general conformance with the design concept of the project and general compliance with the information given in the contract documents. The contractor is responsible for coordinating and correlating all quantities and dimensions, selecting fabrication processes and techniques of construction, coordinating his work with that of all other trades, and performing his work in a safe and satisfactory manner.

CARTER & BURGESS, INC.
 Date 3/20/07 By SKW

- DESIGN PARAMETERS
- SOIL PARAMETERS:
 INTERNAL DESIGN - $\phi=34^\circ$, $\lambda=125$ PCF
 EXTERNAL DESIGN: RETAINED - $\phi=35^\circ$, $\lambda=135$ PCF
 - SOIL REINFORCEMENT:
 WELDED WIRE MESH $f_y = 75,000$ PSI
 CORROSION RATE ZINC = $15 \mu\text{m}/\text{YEAR}$ (FIRST 2 YEARS)
 = $4 \mu\text{m}/\text{YEAR}$ (THEREAFTER)
 CORROSION RATE STEEL = $12 \mu\text{m}/\text{YEAR}$

- DESIGN CRITERIA
- TRAFFIC SURCHARGE = 250 PSF
 - DESIGN LIFE = 75 YEARS
 - AASHTO 2005 LRFD SPECIFICATIONS

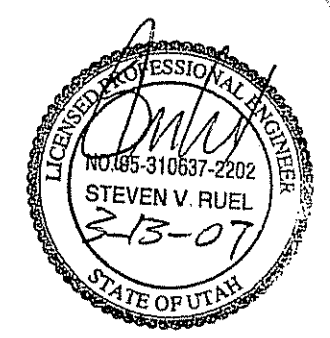

FOR QUESTIONS OR INFORMATION PLEASE CONTACT ANDREW MECKLER AT THE MAIN OFFICE

THE DESIGN OF THESE MSE PLUSSM WALLS IS BASED ON THE ASSUMPTION THAT ALL MATERIALS AND METHODS OF CONSTRUCTION CONFORM TO THE SPECIFICATIONS FOR MSE PLUSSM RETAINING WALLS, THE PROJECT BID DOCUMENTS

THESE DRAWINGS, AS WELL AS THE DESIGN, ARE CERTIFIED WITH RESPECT TO THE INTERNAL STABILITY OF THE MSE PLUSSM STRUCTURES ONLY. EXTERNAL STABILITY INCLUDING, BUT NOT LIMITED TO, SLOPE AND FOUNDATION STABILITY IS THE RESPONSIBILITY OF THE OWNER AND THE ENGINEER FOR THE OWNER.

BY	
REVISION	
NO.	
DATE	
PLAN VIEW AND INDEX OF DRAWINGS LEGACY PARKWAY SEGMENT 1 UTAH DEPARTMENT OF TRANSPORTATION SALT LAKE CITY, UTAH PROJECT No. SP-0067(10)4	
Date:	1/23/07
Scale:	NTS
Drawn By:	AJM
Job:	2506
Sheet:	WW-1
Sheet	1 of 13

TOTAL LENGTH ALONG WALL = 193'-8 1/2"

4265
4260
4255
4250
4245
4240
4235
4230
4225
4220
4215
4210
4205

BEGIN WIRE WALL R-477E
STA 0+00.00
C 21.42' RT.
STA 113+22.78

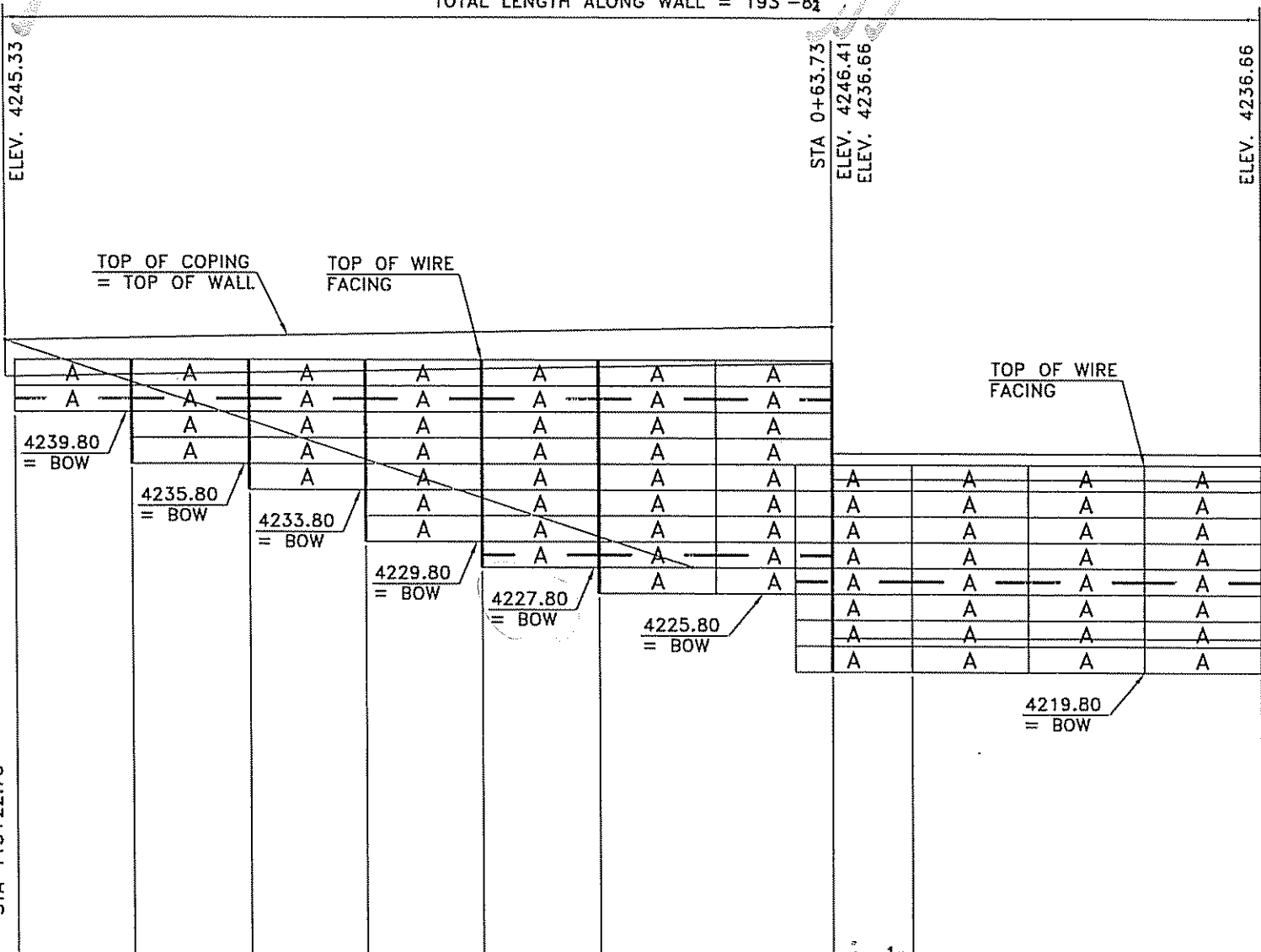

PANEL SPACING	5@9.00'=45'				2@9.00'=18'		6'-1 1/2"	3@9.00'=27'	
DESIGN "H"	H=8.00'	H=10.00'	H=12.00'	H=18.00'	H=20.00'	H=22.00'	H=28.00'		
BEARING PRESSURE	1.87 KSF	2.28 KSF	2.62 KSF	4.04 KSF	4.44 KSF	4.75 KSF	5.95 KSF		
MESH LENGTH	L = 11'	L = 13'	L = 16'	L = 19'	L = 21'	L = 24'	L = 30'		
LOAD CONDITION	LC 1B	LC 1B	LC 1B	LC 1B	LC 1B	LC 1B	LC 1B		
	2(9W5x0.50W5) 1(9W8X1.50W5)		2(9W5x1.00W5) 4(9W8X2.00W5)		2(9W5x1.00W5) 6(9W8X2.50W5) 1(9W11X3.00W8)		2(9W5x1.50W5) 6(9W8X3.00W5) 2(9W11X3.00W8)		0(9W5x1.50W5) 5(9W8X3.00W5) 4(9W11X3.00W8)
	2(9W5x0.50W5) 3(9W8X2.00W5)		2(9W5x1.00W5) 6(9W8X2.50W5)						

Furnish As Submitted Revise And Resubmit
 Furnish As Corrected Submit Specified Item

Corrections or comments made on the shop drawings during the review do not relieve contractor from providing all requirements of the drawings and specifications. This check is only for review of general compliance with the design concept of the project and does not constitute compliance with the information given in the contract documents. The contractor is responsible for verifying and correlating all quantities and dimensions, selecting fabrication processes and methods of construction, coordinating his work with that of all other trades, and performing his work in a safe and satisfactory manner.

CARTER & BURGESS, INC.
Date 3/20/07 By SKW

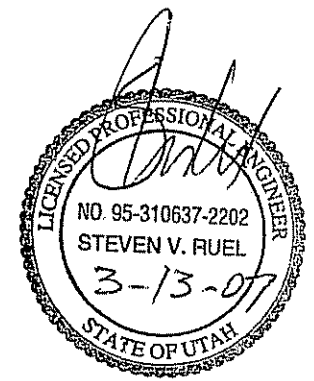

GENERAL NOTES:
1. ELEVATIONS SHOWN ABOVE WALL ARE TO TOP OF COPING.
2. ELEVATIONS SHOWN BELOW WALL ARE TO TOP OF CAST-IN-PLACE LEVELING PAD.
3. SEE THE GENERAL PROVISIONS FOR EARTH RETAINING STRUCTURES FOR MATERIAL AND CONSTRUCTION SPECIFICATIONS.

SOIL REINFORCEMENT LENGTHS
1. MESH LENGTH SHOWN ABOVE BASE WIDTH LINE.
2. HEAVY VERTICAL LINES SEPARATE ZONES OF DIFFERENT MESH LENGTHS / DESIGN HEIGHTS.
3. MESH TYPES SHOWN BELOW MESH LENGTH LINE. (SEE STANDARD DETAIL SHEET FOR MESH KEY)
4. THE NUMBER PRECEDING THE MESH TYPE INDICATES THE NUMBER OF LAYERS OF THAT TYPE REQUIRED.

MSE WALL R-477E: ELEVATIONS
(FRONT FACE SHOWN)

FOR QUESTIONS OR INFORMATION PLEASE CONTACT ANDREW MECKLER AT THE MAIN OFFICE

THE DESIGN OF THESE MSE PLUS_w WALLS IS BASED ON THE ASSUMPTION THAT ALL MATERIALS AND METHODS OF CONSTRUCTION CONFORM TO THE SPECIFICATIONS FOR MSE PLUS_w RETAINING WALLS. THE PROJECT BID DOCUMENTS.

THESE DRAWINGS, AS WELL AS THE DESIGN, ARE CERTIFIED WITH RESPECT TO THE INTERNAL STABILITY OF THE MSE PLUS_w STRUCTURES ONLY. EXTERNAL STABILITY INCLUDING, BUT NOT LIMITED TO, SLOPE AND FOUNDATION STABILITY IS THE RESPONSIBILITY OF THE OWNER AND THE ENGINEER FOR THE OWNER.

Date: 1/23/07

Scale: NTS

Drawn By: AJM

Job: 2506

Sheet: WW-2

Sheet 2 of 13

ELEVATIONS: WALL E - 1 OF 2
LEGACY PARKWAY SEGMENT 1
UTAH DEPARTMENT OF TRANSPORTATION
SALT LAKE CITY, UTAH
PROJECT No. SP-0067(10)4

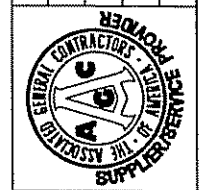

SPECIALIZING IN CONSTRUCTION PRODUCTS
SSL
MAIN OFFICE: 4702 South Valley Dr., Suite 101, Salt Lake City, Utah 84106
Phone: 801-439-9300 Fax: 801-439-9340

NO.	DATE	REVISION	BY

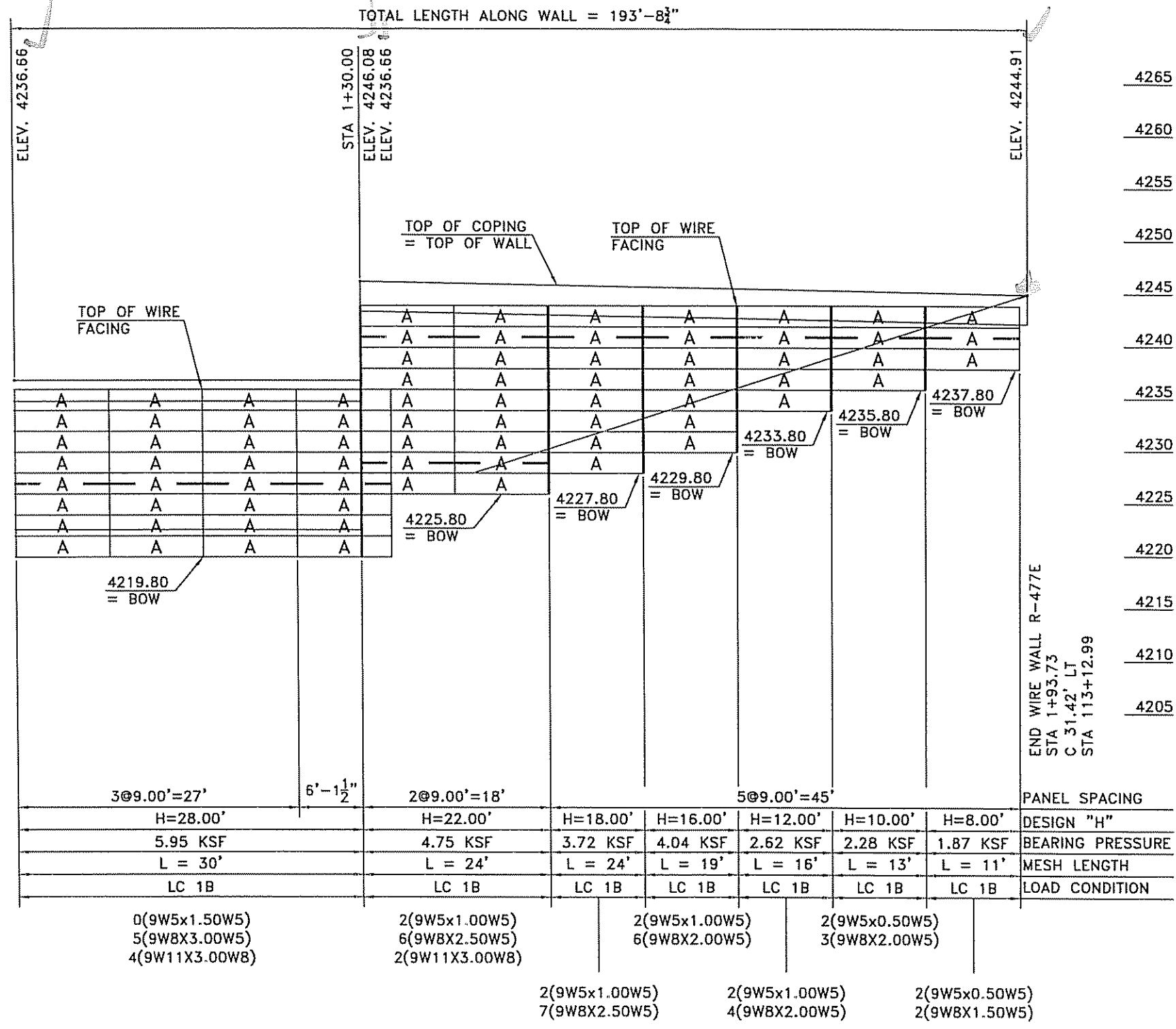

4265
4260
4255
4250
4245
4240
4235
4230
4225
4220
4215
4210
4205

Furnish As Submitted Revise And Resubmit
 Furnish As Corrected Submit Specified Item

Corrections or comments made on the shop drawings during this review do not relieve contractor from compliance with requirements of the drawings and specifications. This check is only for review of general conformance with the design concept of the project and general compliance with the information given in the contract documents. The contractor is responsible for confirming and correlating all quantities and dimensions; selecting fabrication processes and techniques of construction; coordinating his work with that of all other trades; and performing his work in a safe and satisfactory manner.

CARTER & BURGESS, INC.
 Date 3/26/07 By *SLW*



SSL
 SPECIALIZING IN CONSTRUCTION PRODUCTS
 MAIN OFFICE: 4140 South Valley Dr., Suite 101, Salt Lake City, UT 84119
 Phone: 801.438.8300 Fax: 801.438.9340

ELEVATIONS: WALL E - 2 OF 2
 LEGACY PARKWAY SEGMENT 1
 UTAH DEPARTMENT OF TRANSPORTATION
 SALT LAKE CITY, UTAH
 PROJECT No. SP-0067(10)4

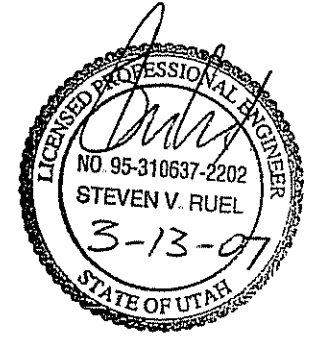

FOR QUESTIONS OR INFORMATION PLEASE CONTACT ANDREW MECKLER AT THE MAIN OFFICE

THE DESIGN OF THESE MSE PLUSSM WALLS IS BASED ON THE ASSUMPTION THAT ALL MATERIALS AND METHODS OF CONSTRUCTION CONFORM TO THE SPECIFICATIONS FOR MSE PLUSSM RETAINING WALLS, THE PROJECT BID DOCUMENTS.

THESE DRAWINGS, AS WELL AS THE DESIGN, ARE CERTIFIED WITH RESPECT TO THE INTERNAL STABILITY OF THE MSE PLUSSM STRUCTURES ONLY. EXTERNAL STABILITY INCLUDING, BUT NOT LIMITED TO, SLOPE AND FOUNDATION STABILITY IS THE RESPONSIBILITY OF THE OWNER AND THE ENGINEER FOR THE OWNER.

- GENERAL NOTES:**
- ELEVATIONS SHOWN ABOVE WALL ARE TO TOP OF COPING.
 - ELEVATIONS SHOWN BELOW WALL ARE TO TOP OF CAST-IN-PLACE LEVELING PAD.
 - SEE THE GENERAL PROVISIONS FOR EARTH EARTH RETAINING STRUCTURES FOR MATERIAL AND CONSTRUCTION SPECIFICATIONS.

- SOIL REINFORCEMENT LENGTHS**
- MESH LENGTH SHOWN ABOVE BASE WIDTH LINE.
 - HEAVY VERTICAL LINES SEPARATE ZONES OF DIFFERENT MESH LENGTHS / DESIGN HEIGHTS.
 - MESH TYPES SHOWN BELOW MESH LENGTH LINE. (SEE STANDARD DETAIL SHEET FOR MESH KEY)
 - THE NUMBER PRECEDING THE MESH TYPE INDICATES THE NUMBER OF LAYERS OF THAT TYPE REQUIRED.

MSE WALL R-477E: ELEVATIONS

(FRONT FACE SHOWN)

Date:	1/23/07
Scale:	NTS
Drawn By:	AJM
Job:	2506
Sheet:	WW-3
Sheet	3 of 13

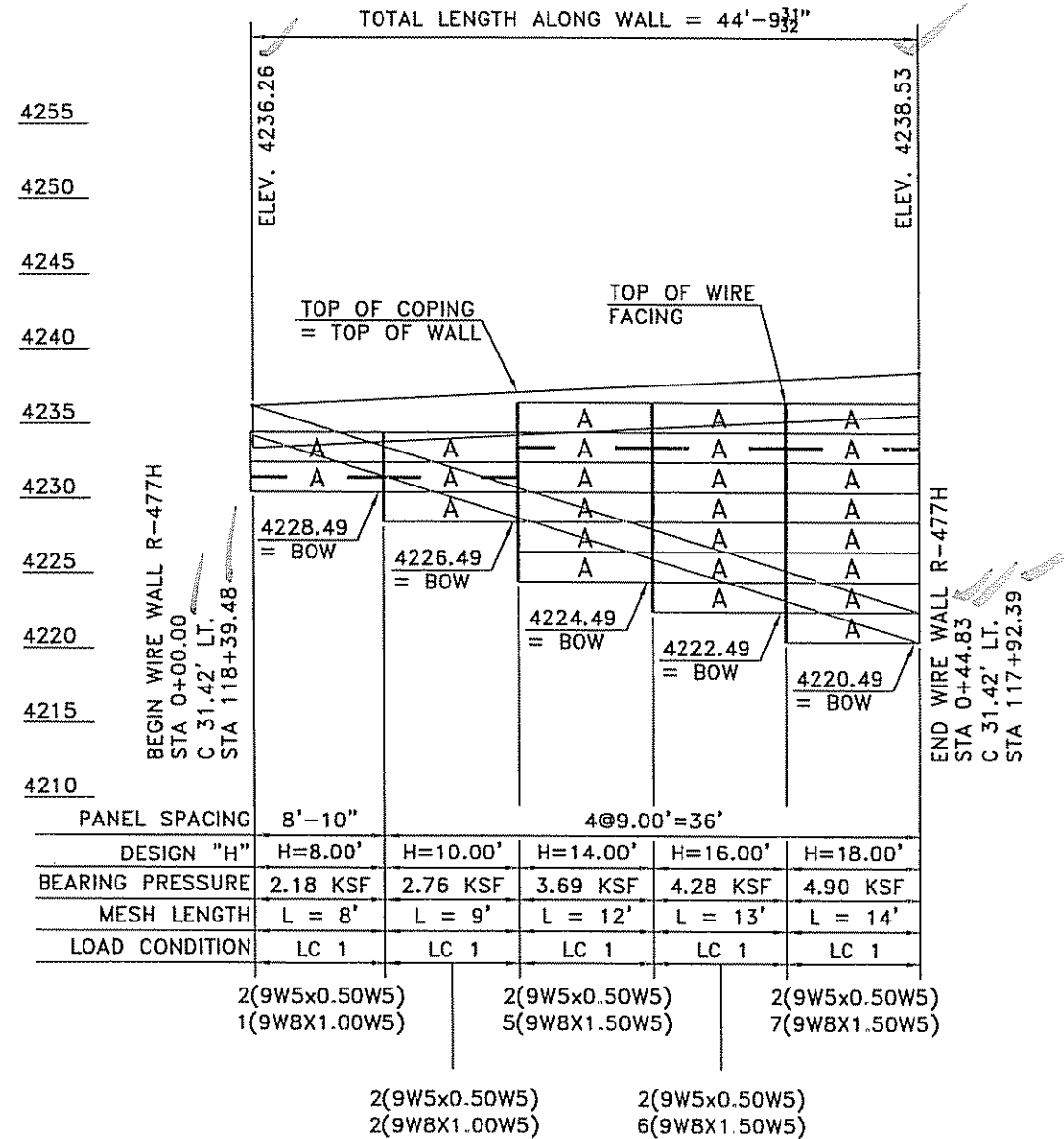

Furnish As Submitted Revise And Resubmit
 Furnish As Corrected Submit Specified Item

Corrections or comments made on the shop drawings during the review do not relieve contractor from compliance with requirements of the drawings and specifications. This check is only for review of general compliance with the design concept of the project and general compliance with the information given in the contract documents. The contractor is responsible for confirming and correlating all quantities and dimensions, selecting fabrication processes and techniques of construction; coordinating his work with that of all other trades; and performing his work in a safe and satisfactory manner.

CARTER & BURGESS, INC.
 Date 3/20/07 By SKW

- GENERAL NOTES:**
- ELEVATIONS SHOWN ABOVE WALL ARE TO TOP OF COPING.
 - ELEVATIONS SHOWN BELOW WALL ARE TO TOP OF CAST-IN-PLACE LEVELING PAD.
 - SEE THE GENERAL PROVISIONS FOR EARTH RETAINING STRUCTURES FOR MATERIAL AND CONSTRUCTION SPECIFICATIONS.

- SOIL REINFORCEMENT LENGTHS**
- MESH LENGTH SHOWN ABOVE BASE WIDTH LINE.
 - HEAVY VERTICAL LINES SEPARATE ZONES OF DIFFERENT MESH LENGTHS / DESIGN HEIGHTS.
 - MESH TYPES SHOWN BELOW MESH LENGTH LINE. (SEE STANDARD DETAIL SHEET FOR MESH KEY)
 - THE NUMBER PRECEDING THE MESH TYPE INDICATES THE NUMBER OF LAYERS OF THAT TYPE REQUIRED.

MSE WALL R-477H: ELEVATIONS

(FRONT FACE SHOWN)

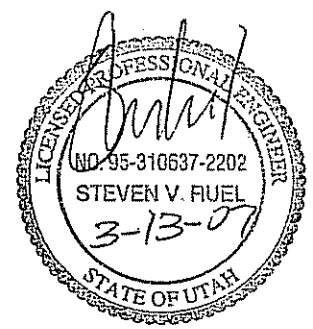

FOR QUESTIONS OR INFORMATION PLEASE CONTACT ANDREW MECKLER AT THE MAIN OFFICE

THE DESIGN OF THESE MSE PLUS_w WALLS IS BASED ON THE ASSUMPTION THAT ALL MATERIALS AND METHODS OF CONSTRUCTION CONFORM TO THE SPECIFICATIONS FOR MSE PLUS_w RETAINING WALLS, THE PROJECT BID DOCUMENTS.

THESE DRAWINGS, AS WELL AS THE DESIGN, ARE CERTIFIED WITH RESPECT TO THE INTERNAL STABILITY OF THE MSE PLUS_w STRUCTURES ONLY. EXTERNAL STABILITY INCLUDING, BUT NOT LIMITED TO, SLOPE AND FOUNDATION STABILITY IS THE RESPONSIBILITY OF THE OWNER AND THE ENGINEER FOR THE OWNER.

ELEVATIONS: WALL H LEGACY PARKWAY SEGMENT 1 UTAH DEPARTMENT OF TRANSPORTATION SALT LAKE CITY, UTAH PROJECT No. SP-0067(10)4	
Date: 1/23/07	Scale: NTS
Drawn By: AJM	Job: 2506
Sheet: WW-4	Sheet 4 of 13

TOTAL LENGTH ALONG WALL = 433'-6 1/2"

4255
4255
4250
4245
4240
4235
4230
4225
4220
4215
4210

BEGIN WIRE WALL R-477F
STA 0+80.89
C 31.42' LT.
STA 117+54.51

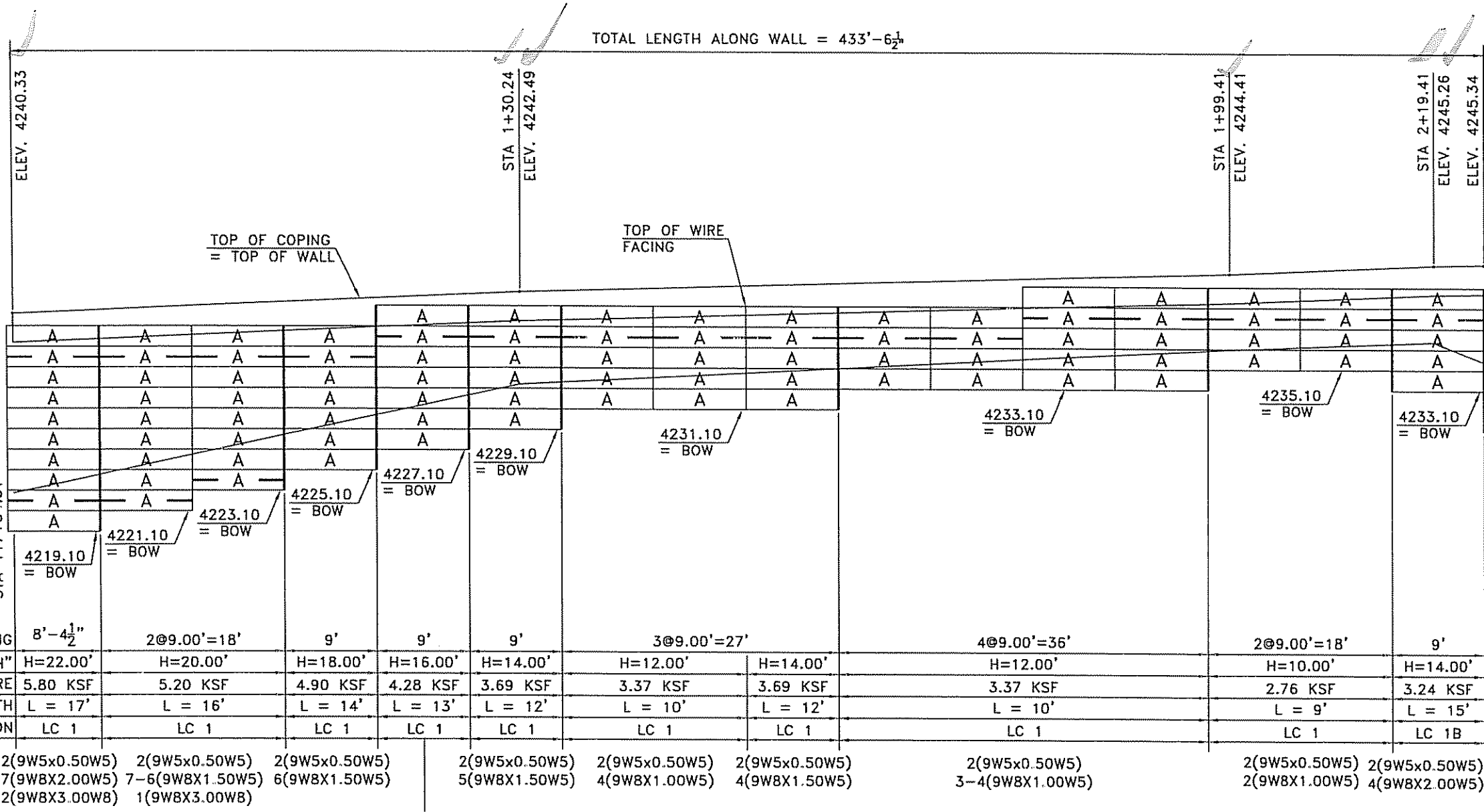

PANEL SPACING	8'-4 1/2"	2@9.00'=18'	9'	9'	9'	3@9.00'=27'	4@9.00'=36'	2@9.00'=18'	9'
DESIGN "H"	H=22.00'	H=20.00'	H=18.00'	H=16.00'	H=14.00'	H=12.00'	H=14.00'	H=12.00'	H=14.00'
BEARING PRESSURE	5.80 KSF	5.20 KSF	4.90 KSF	4.28 KSF	3.69 KSF	3.37 KSF	3.69 KSF	3.37 KSF	3.24 KSF
MESH LENGTH	L = 17'	L = 16'	L = 14'	L = 13'	L = 12'	L = 10'	L = 12'	L = 10'	L = 15'
LOAD CONDITION	LC 1	LC 1	LC 1	LC 1	LC 1	LC 1	LC 1	LC 1	LC 1B

2(9W5x0.50W5) 2(9W5x0.50W5) 2(9W5x0.50W5) 2(9W5x0.50W5) 2(9W5x0.50W5) 2(9W5x0.50W5) 2(9W5x0.50W5) 2(9W5x0.50W5) 2(9W5x0.50W5) 2(9W5x0.50W5)
 7(9W8X2.00W5) 7-6(9W8X1.50W5) 6(9W8X1.50W5) 5(9W8X1.50W5) 4(9W8X1.00W5) 4(9W8X1.50W5) 3-4(9W8X1.00W5) 2(9W8X1.00W5) 2(9W8X1.00W5) 4(9W8X2.00W5)
 2(9W8X3.00W8) 1(9W8X3.00W8)

2(9W5x0.50W5)
6(9W8X1.50W5)

Furnish As Submitted Provide No. 10 Rebar
 Furnish As Corrected Furnish As Shown
 Corrections or comments must be submitted during the review period. The contractor shall be responsible for providing all necessary information and specifications for the project. The contractor shall be responsible for providing all necessary information and specifications for the project. The contractor shall be responsible for providing all necessary information and specifications for the project.
CARTER & BUNDGE, INC.
 Date 3/20/07 skw

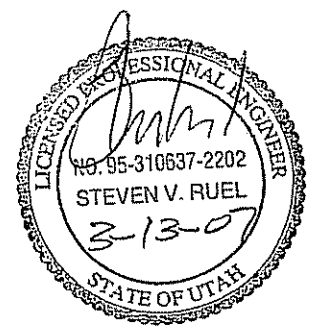

FOR QUESTIONS OR INFORMATION PLEASE CONTACT ANDREW MECKLER AT THE MAIN OFFICE

THE DESIGN OF THESE MSE PLUS™ WALLS IS BASED ON THE ASSUMPTION THAT ALL MATERIALS AND METHODS OF CONSTRUCTION CONFORM TO THE SPECIFICATIONS FOR MSE PLUS™ RETAINING WALLS, THE PROJECT BID DOCUMENTS.

THESE DRAWINGS, AS WELL AS THE DESIGN, ARE CERTIFIED WITH RESPECT TO THE INTERNAL STABILITY OF THE MSE PLUS™ STRUCTURES ONLY. EXTERNAL STABILITY INCLUDING, BUT NOT LIMITED TO, SLOPE AND FOUNDATION STABILITY IS THE RESPONSIBILITY OF THE OWNER AND THE ENGINEER FOR THE OWNER.

GENERAL NOTES:
 1. ELEVATIONS SHOWN ABOVE WALL ARE TO TOP OF COPING.
 2. ELEVATIONS SHOWN BELOW WALL ARE TO TOP OF CAST-IN-PLACE LEVELING PAD.
 3. SEE THE GENERAL PROVISIONS FOR EARTH RETAINING STRUCTURES FOR MATERIAL AND CONSTRUCTION SPECIFICATIONS.

SOIL REINFORCEMENT LENGTHS
 1. MESH LENGTH SHOWN ABOVE BASE WIDTH LINE.
 2. HEAVY VERTICAL LINES SEPARATE ZONES OF DIFFERENT MESH LENGTHS / DESIGN HEIGHTS.
 3. MESH TYPES SHOWN BELOW MESH LENGTH LINE. (SEE STANDARD DETAIL SHEET FOR MESH KEY)
 4. THE NUMBER PRECEDING THE MESH TYPE INDICATES THE NUMBER OF LAYERS OF THAT TYPE REQUIRED.

MSE WALL R-477F: ELEVATIONS
(FRONT FACE SHOWN)

NO.	DATE	REVISION	BY
ELEVATIONS: WALL F - 1 OF 3 LEGACY PARKWAY SEGMENT 1 UTAH DEPARTMENT OF TRANSPORTATION SALT LAKE CITY, UTAH PROJECT No. SP-0067(10)4			
Date:	1/23/07	Scale:	NTS
Drawn By:	AJM	Job:	2506
Sheet:	WW-5	Sheet 5	of 13

TOTAL LENGTH ALONG WALL = 433'-6 1/2"

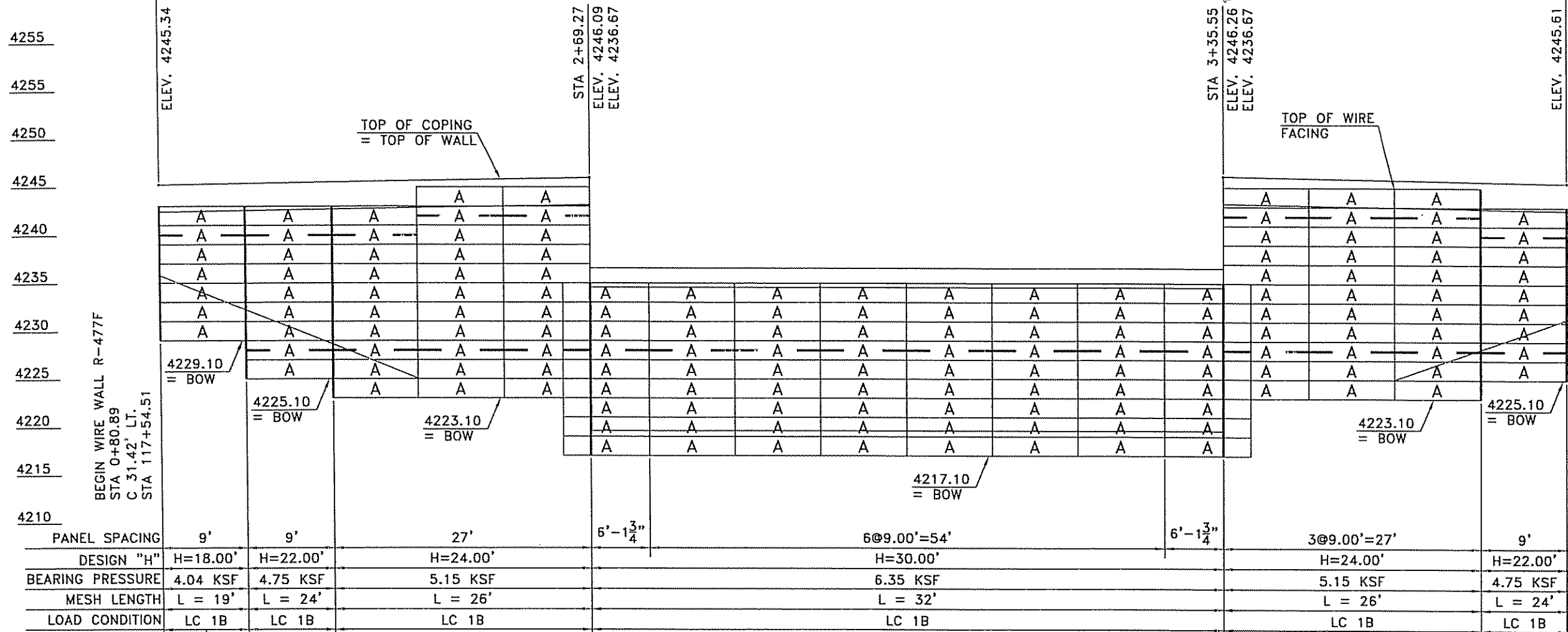

	2(9W5x1.00W5) 6(9W8X3.00W5) 2(9W8X3.00W8)	2(9W5x1.50W5) 6-7(9W8X3.00W5) 3(9W8X3.00W8)	0(9W5x1.50W5) 4(9W8X3.00W5) 6(9W8X3.00W8)	2(9W5x1.50W5) 7(9W8X3.00W5) 3(9W8X3.00W8)	2(9W5x1.00W5) 6(9W8X3.00W5) 2(9W8X3.00W8)
--	---	---	---	---	---

2(9W5x1.00W5)
6(9W8X2.50W5)

Furnish As Submitted Revise And Resubmit
 Furnish As Corrected Submit Specified Item

Corrections or comments made on the shop drawings during this review do not relieve contractor from compliance with requirements of the drawings and specifications. This check is only for review of general conformity with the design concept of the project and does not constitute compliance with the information given in the contract documents. The contractor is responsible for confirming and executing all quantities and dimensions; selecting fabrication processes and techniques of construction; coordinating all work with that of all other trades; and performing his work in a safe and satisfactory manner.

CARTER & BURGESS, INC.
 Date 3/20/07 By skw

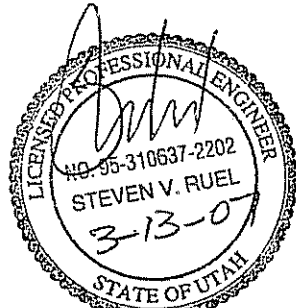

FOR QUESTIONS OR INFORMATION PLEASE CONTACT ANDREW MECKLER AT THE MAIN OFFICE

THE DESIGN OF THESE MSE PLUS_w WALLS IS BASED ON THE ASSUMPTION THAT ALL MATERIALS AND METHODS OF CONSTRUCTION CONFORM TO THE SPECIFICATIONS FOR MSE PLUS_w RETAINING WALLS. THE PROJECT BID DOCUMENTS.

THESE DRAWINGS, AS WELL AS THE DESIGN, ARE CERTIFIED WITH RESPECT TO THE INTERNAL STABILITY OF THE MSE PLUS_w STRUCTURES ONLY. EXTERNAL STABILITY INCLUDING, BUT NOT LIMITED TO, SLOPE AND FOUNDATION STABILITY IS THE RESPONSIBILITY OF THE OWNER AND THE ENGINEER FOR THE OWNER.

- GENERAL NOTES:**
- ELEVATIONS SHOWN ABOVE WALL ARE TO TOP OF COPING.
 - ELEVATIONS SHOWN BELOW WALL ARE TO TOP OF CAST-IN-PLACE LEVELING PAD.
 - SEE THE GENERAL PROVISIONS FOR EARTH EARTH RETAINING STRUCTURES FOR MATERIAL AND CONSTRUCTION SPECIFICATIONS.

- SOIL REINFORCEMENT LENGTHS**
- MESH LENGTH SHOWN ABOVE BASE WIDTH LINE.
 - HEAVY VERTICAL LINES SEPARATE ZONES OF DIFFERENT MESH LENGTHS / DESIGN HEIGHTS.
 - MESH TYPES SHOWN BELOW MESH LENGTH LINE. (SEE STANDARD DETAIL SHEET FOR MESH KEY)
 - THE NUMBER PRECEDING THE MESH TYPE INDICATES THE NUMBER OF LAYERS OF THAT TYPE REQUIRED.

MSE WALL R-477F: ELEVATIONS
(FRONT FACE SHOWN)

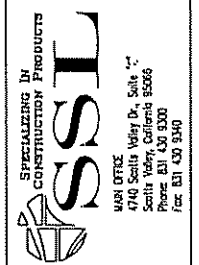

ELEVATIONS: WALL F - 2 OF 3
 LEGACY PARKWAY SEGMENT 1
 UTAH DEPARTMENT OF TRANSPORTATION
 SALT LAKE CITY, UTAH
 PROJECT No. SP-0067(10)4

Date:	1/23/07
Scale:	NTS
Drawn By:	AJM
Job:	2506
Sheet:	WW-6
Sheet 6 of 13	

TOTAL LENGTH ALONG WALL = 433'-6 1/2"

4255
4255
4250
4245
4240
4235
4230
4225
4220
4215
4210

BEGIN WIRE WALL R-477F
STA 0+80.89
C 31.42' LT.
STA 117+54.51

END WIRE WALL R-477F
STA 5+14.43
C 21.42' RT.
STA 117+53.38

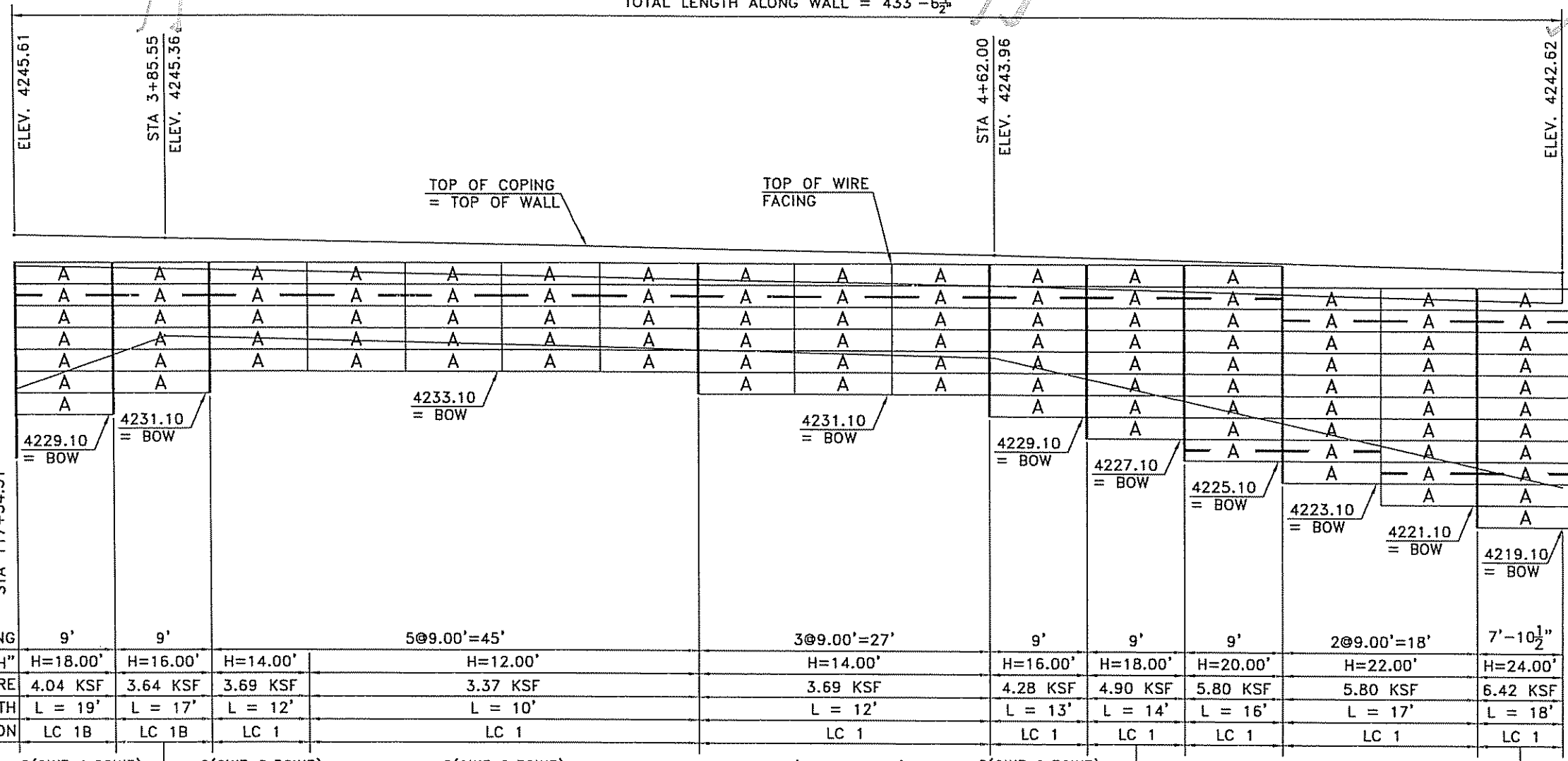

PANEL SPACING	9'	9'	5@9.00'=45'		3@9.00'=27'		9'	9'	9'	2@9.00'=18'	7'-10 1/2"
DESIGN "H"	H=18.00'	H=16.00'	H=14.00'	H=12.00'		H=14.00'	H=16.00'	H=18.00'	H=20.00'	H=22.00'	H=24.00'
BEARING PRESSURE	4.04 KSF	3.64 KSF	3.69 KSF	3.37 KSF		3.69 KSF	4.28 KSF	4.90 KSF	5.80 KSF	5.80 KSF	6.42 KSF
MESH LENGTH	L = 19'	L = 17'	L = 12'	L = 10'		L = 12'	L = 13'	L = 14'	L = 16'	L = 17'	L = 18'
LOAD CONDITION	LC 1B	LC 1B	LC 1	LC 1		LC 1	LC 1	LC 1	LC 1	LC 1	LC 1

2(9W5x1.00W5)
6(9W8X2.50W5)

2(9W5x0.50W5)
4(9W8X1.50W5)

2(9W5x0.50W5)
4(9W8X1.00W5)

2(9W5x0.50W5)
5(9W8X1.50W5)

2(9W5x0.50W5)
6(9W8X1.50W5)

2(9W5x0.50W5)
7(9W8X1.50W5)
1(9W8X3.00W8)

2(9W5x0.50W5)
7(9W8X2.00W5)
2(9W8X3.00W8)

2(9W5x0.50W5)
7(9W8X2.00W5)
3(9W8X3.00W8)

Furnish As Submitted
 Furnish As Generated

Corrections to drawings made during the design process are indicated by heavy vertical lines separating zones of different mesh lengths / design heights.

CARTER ENGINEERS, INC.
Date 3/20/07 skw

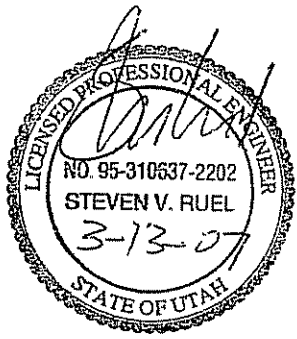

FOR QUESTIONS OR INFORMATION PLEASE CONTACT ANDREW MECKLER AT THE MAIN OFFICE

THE DESIGN OF THESE MSE PLUS_w WALLS IS BASED ON THE ASSUMPTION THAT ALL MATERIALS AND METHODS OF CONSTRUCTION CONFORM TO THE SPECIFICATIONS FOR MSE PLUS_w RETAINING WALLS, THE PROJECT BID DOCUMENTS.

THESE DRAWINGS, AS WELL AS THE DESIGN, ARE CERTIFIED WITH RESPECT TO THE INTERNAL STABILITY OF THE MSE PLUS_w STRUCTURES ONLY. EXTERNAL STABILITY INCLUDING, BUT NOT LIMITED TO, SLOPE AND FOUNDATION STABILITY IS THE RESPONSIBILITY OF THE OWNER AND THE ENGINEER FOR THE OWNER.

- GENERAL NOTES:**
- ELEVATIONS SHOWN ABOVE WALL ARE TO TOP OF COPING.
 - ELEVATIONS SHOWN BELOW WALL ARE TO TOP OF CAST-IN-PLACE LEVELING PAD.
 - SEE THE GENERAL PROVISIONS FOR EARTH RETAINING STRUCTURES FOR MATERIAL AND CONSTRUCTION SPECIFICATIONS

- SOIL REINFORCEMENT LENGTHS**
- MESH LENGTH SHOWN ABOVE BASE WIDTH LINE.
 - HEAVY VERTICAL LINES SEPARATE ZONES OF DIFFERENT MESH LENGTHS / DESIGN HEIGHTS.
 - MESH TYPES SHOWN BELOW MESH LENGTH LINE. (SEE STANDARD DETAIL SHEET FOR MESH KEY)
 - THE NUMBER PRECEDING THE MESH TYPE INDICATES THE NUMBER OF LAYERS OF THAT TYPE REQUIRED.

MSE WALL R-477F: ELEVATIONS
(FRONT FACE SHOWN)

NO.	DATE	REVISION	BY
ELEVATIONS: WALL F - 3 OF 3 LEGACY PARKWAY SEGMENT 1 UTAH DEPARTMENT OF TRANSPORTATION SALT LAKE CITY, UTAH PROJECT No. SP-0067(10)4			
Date:	1/23/07		
Scale:	NTS		
Drawn By:	AJM		
Job:	2506		
Sheet:	WW-7		
Sheet	7 of 13		

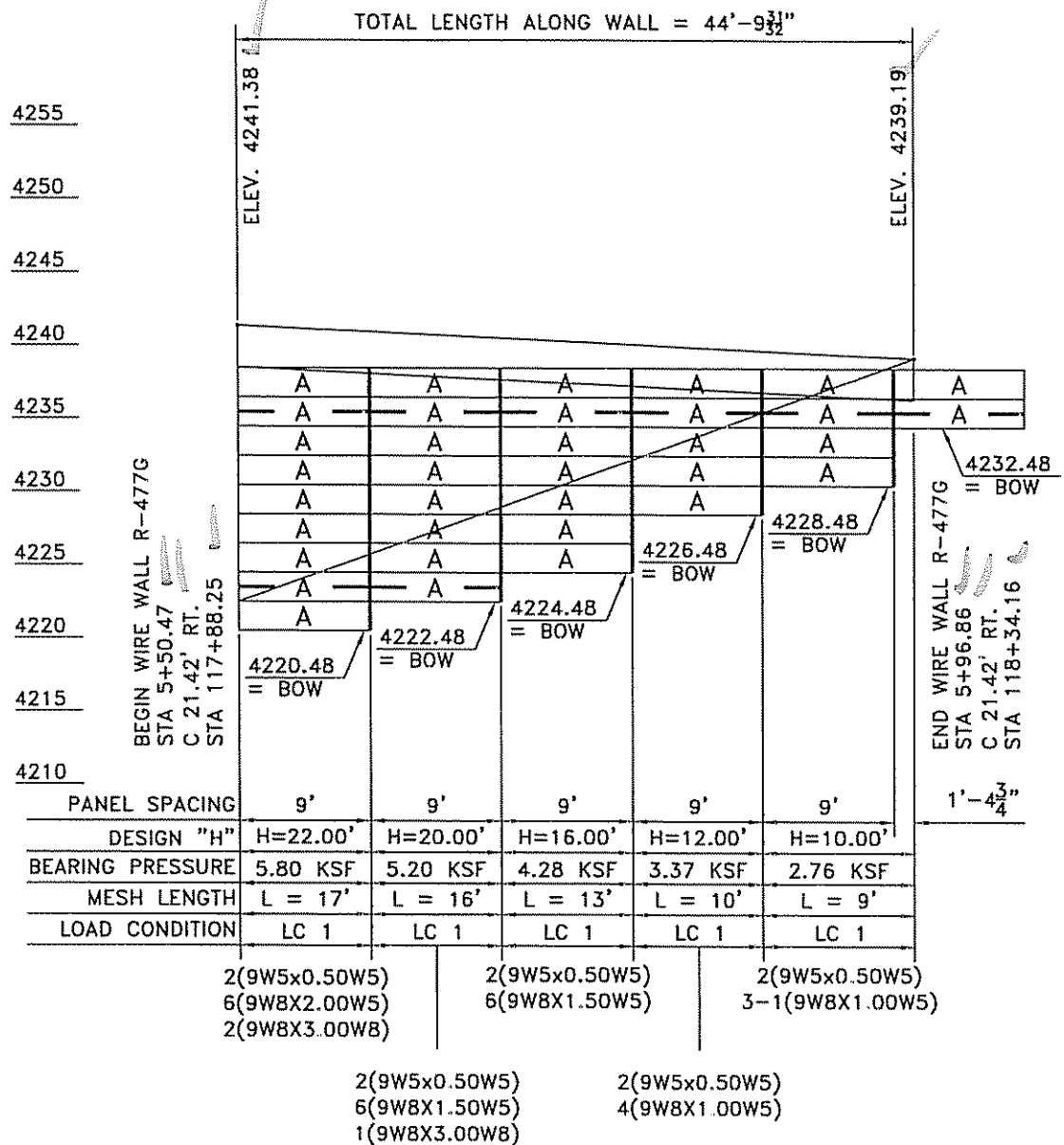

Furnish As Submitted Revise And Resubmit
 Furnish As Corrected Submit Specified Item

Corrections or comments made on the shop drawings during this review do not relieve contractor from compliance with requirements of the drawings and specifications. This check is only for review of general compliance with the design concept of the project and general compliance with the information given in the contract documents. The contractor is responsible for confirming and correlating all quantities and dimensions, selecting fabrication processes and techniques of construction, coordinating his work with that of all other trades, and performing his work in a safe and satisfactory manner.

CARTER & BURGESS, INC.
 Date 3/20/07 By SKW

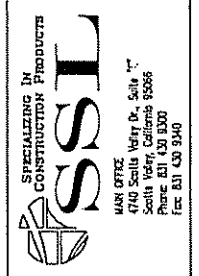
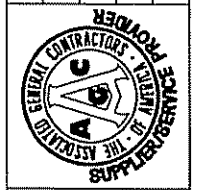

ELEVATIONS: WALL G
 LEGACY PARKWAY SEGMENT 1
 UTAH DEPARTMENT OF TRANSPORTATION
 SALT LAKE CITY, UTAH
 PROJECT No. SP-0067(10)4

Date:	1/23/07
Scale:	NTS
Drawn By:	AJM
Job:	2506
Sheet:	WW-8
Sheet	8 of 13

- GENERAL NOTES:**
- ELEVATIONS SHOWN ABOVE WALL ARE TO TOP OF COPING.
 - ELEVATIONS SHOWN BELOW WALL ARE TO TOP OF CAST-IN-PLACE LEVELING PAD.
 - SEE THE GENERAL PROVISIONS FOR EARTH RETAINING STRUCTURES FOR MATERIAL AND CONSTRUCTION SPECIFICATIONS.

- SOIL REINFORCEMENT LENGTHS**
- MESH LENGTH SHOWN ABOVE BASE WIDTH LINE.
 - HEAVY VERTICAL LINES SEPARATE ZONES OF DIFFERENT MESH LENGTHS / DESIGN HEIGHTS.
 - MESH TYPES SHOWN BELOW MESH LENGTH LINE. (SEE STANDARD DETAIL SHEET FOR MESH KEY)
 - THE NUMBER PRECEDING THE MESH TYPE INDICATES THE NUMBER OF LAYERS OF THAT TYPE REQUIRED.

MSE WALL R-477G: ELEVATIONS

(FRONT FACE SHOWN)

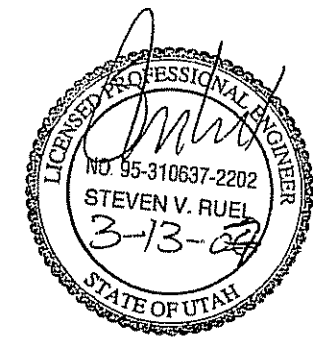

FOR QUESTIONS OR INFORMATION PLEASE CONTACT ANDREW MECKLER AT THE MAIN OFFICE

THE DESIGN OF THESE MSE PLUS_w WALLS IS BASED ON THE ASSUMPTION THAT ALL MATERIALS AND METHODS OF CONSTRUCTION CONFORM TO THE SPECIFICATIONS FOR MSE PLUS_w RETAINING WALLS, THE PROJECT BID DOCUMENTS.

THESE DRAWINGS, AS WELL AS THE DESIGN, ARE CERTIFIED WITH RESPECT TO THE INTERNAL STABILITY OF THE MSE PLUS_w STRUCTURES ONLY. EXTERNAL STABILITY INCLUDING, BUT NOT LIMITED TO, SLOPE AND FOUNDATION STABILITY IS THE RESPONSIBILITY OF THE OWNER AND THE ENGINEER FOR THE OWNER.

NO.	DATE	REVISION	BY

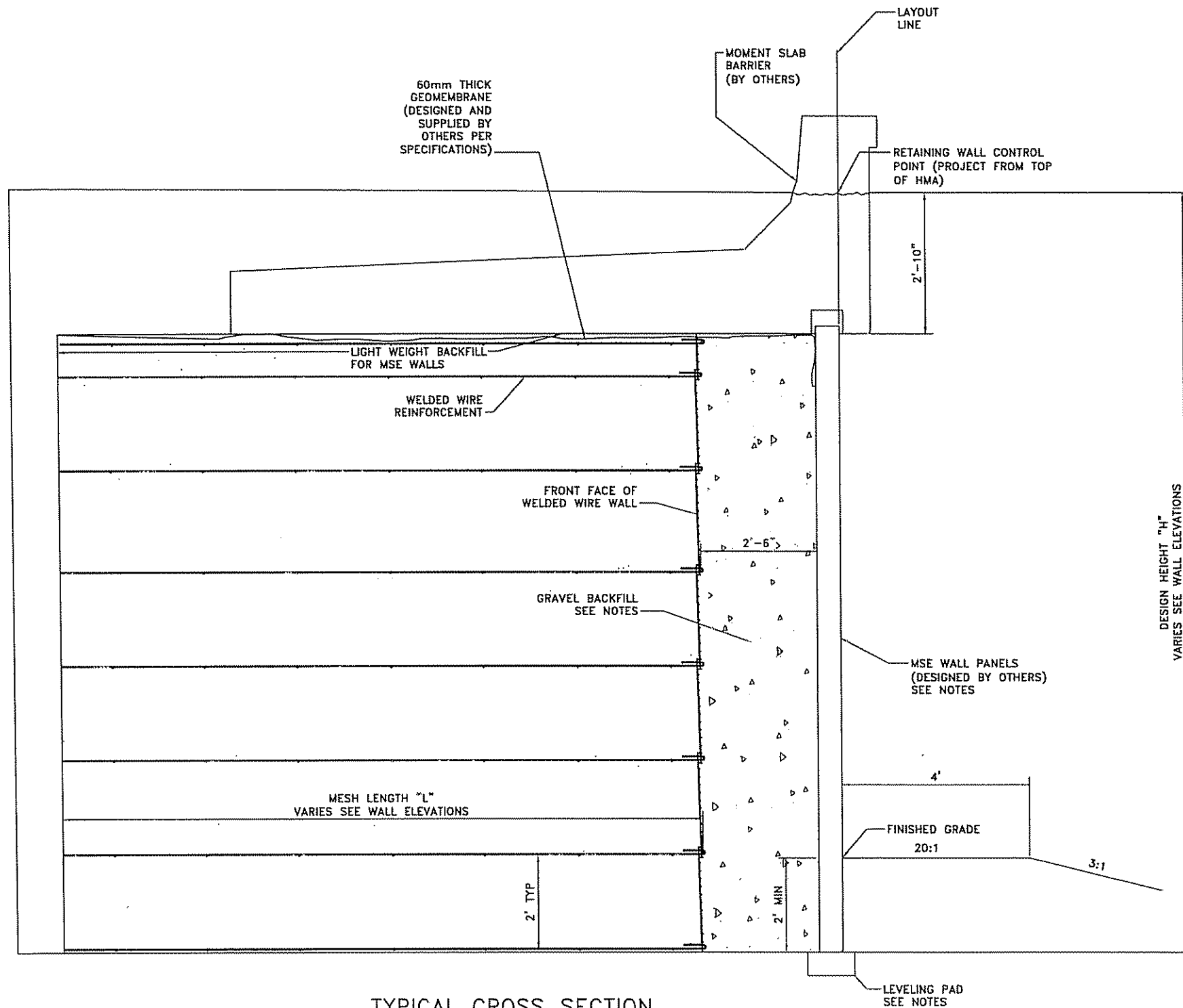

TYPICAL CROSS SECTION
 AT MOMENT SLAB
 (SEE CONTRACT PLANS FOR DETAILS NOT SHOWN)

NOTES:

1. INFORMATION SHOWING CONCRETE PANELS, BARRIER/SLAB DETAILS, AND ANY OTHER STAGE 2 DETAILS ARE FOR INFORMATION ONLY. FINAL DESIGN SHALL BE SUBMITTED AT A LATER DATE.
2. CONCRETE PANEL REINFORCEMENT AND LIFTING ANCHOR DESIGN IS THE RESPONSIBILITY OF THE CONTRACTOR AND MUST BE DESIGNED TO HANDLE MAXIMUM BENDING MOMENTS AND GENERAL SERVICE LOADS EXPERIENCED BY THE PANEL ONCE IN PLACE.
3. RIGGING SETUP AND PROCEDURE IS THE RESPONSIBILITY OF THE CONTRACTOR DURING ALL PHASES OF PANEL CASTING AND WALL CONSTRUCTION. IT IS THE CONTRACTOR'S RESPONSIBILITY TO DESIGN AND INSTALL AN ADEQUATE BRACING SYSTEM TO SUPPORT THE PANEL OVER ITS ENTIRE HEIGHT UNTIL CONNECTED TO WIRE FACED MSE RETAINING WALL.
4. DESIGN AND INSTALLATION OF THE CONNECTION OF THE PANEL TO THE WIRE FACED MSE RETAINING WALL IS THE RESPONSIBILITY OF THE CONTRACTOR.

Furnish As Submitted Revise And Resubmit
 Furnish As Corrected Submit Specified Item

Corrections or comments made on the shop drawings during this review do not relieve contractor from compliance with requirements of the contract and specifications. This check is only for review of general conformance with the design concept of the contract and general compliance with the information given in the contract documents. The contractor is responsible for confirming and correlating all quantities and dimensions; selecting alternative processes and techniques of construction; coordinating the work of all other trades; and performing the work in a safe and satisfactory manner.

CARTER & BURGESS, INC.
 Date 3/20/07 By SKW

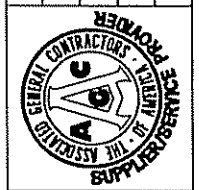
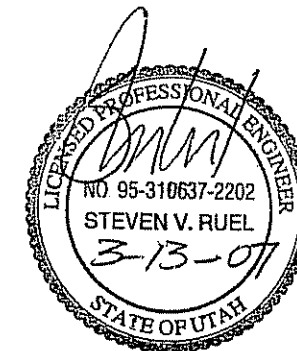

SPECIALTIES IN CONSTRUCTION PRODUCTS
SSL
 MAIN OFFICE
 4740 Seala Valley Dr., Suite 101
 Salt Lake City, Utah 84126
 Phone 801-430-3300
 Fax 801-430-3340

TYPICAL CROSS SECTIONS - 1 OF 3
 LEGACY PARKWAY SEGMENT 1
 UTAH DEPARTMENT OF TRANSPORTATION
 SALT LAKE CITY, UTAH
 PROJECT No. SP-0067(10)4

FOR QUESTIONS OR INFORMATION PLEASE CONTACT ANDREW MECKLER AT THE MAIN OFFICE

THE DESIGN OF THESE MSE PLUSSM WALLS IS BASED ON THE ASSUMPTION THAT ALL MATERIALS AND METHODS OF CONSTRUCTION CONFORM TO THE SPECIFICATIONS FOR MSE PLUSSM RETAINING WALLS, THE PROJECT BID DOCUMENTS.

THESE DRAWINGS, AS WELL AS THE DESIGN, ARE CERTIFIED WITH RESPECT TO THE INTERNAL STABILITY OF THE MSE PLUSSM STRUCTURES ONLY. EXTERNAL STABILITY INCLUDING, BUT NOT LIMITED TO, SLOPE AND FOUNDATION STABILITY IS THE RESPONSIBILITY OF THE OWNER AND THE ENGINEER FOR THE OWNER.

Date:	1/23/07
Scale:	NTS
Drawn By:	AJM
Job:	2506
Sheet:	WW-9
Sheet	9 of 13

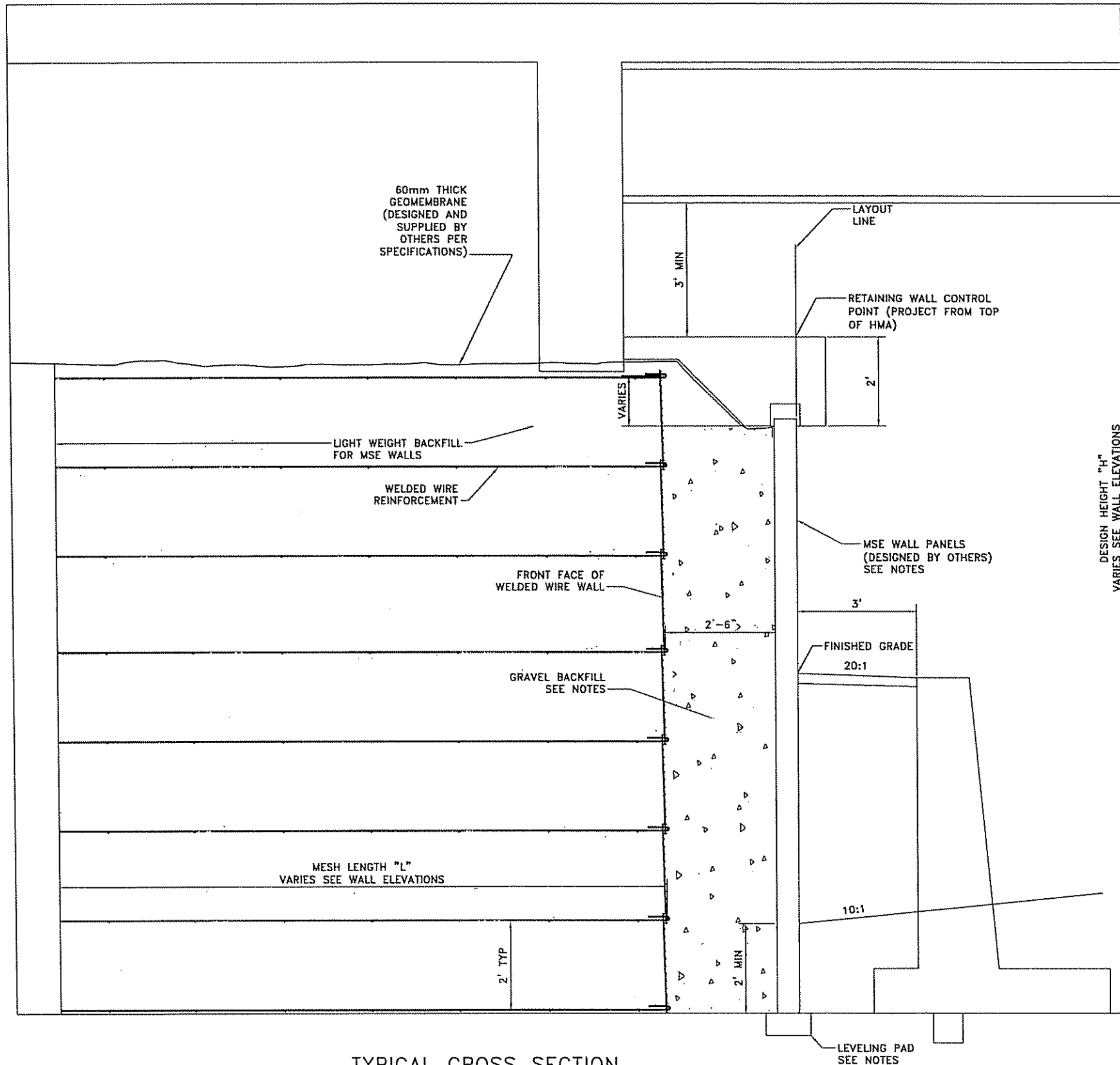

TYPICAL CROSS SECTION
AT ABUTMENT
(SEE CONTRACT PLANS FOR DETAILS NOT SHOWN)

NOTES:

1. INFORMATION SHOWING CONCRETE PANELS, BARRIER/SLAB DETAILS, AND ANY OTHER STAGE 2 DETAILS ARE FOR INFORMATION ONLY. FINAL DESIGN SHALL BE SUBMITTED AT A LATER DATE.
2. CONCRETE PANEL REINFORCEMENT AND LIFTING ANCHOR DESIGN IS THE RESPONSIBILITY OF THE CONTRACTOR AND MUST BE DESIGNED TO HANDLE MAXIMUM BENDING MOMENTS AND GENERAL SERVICE LOADS EXPERIENCED BY THE PANEL ONCE IN PLACE.
3. RIGGING SETUP AND PROCEDURE IS THE RESPONSIBILITY OF THE CONTRACTOR DURING ALL PHASES OF PANEL CASTING AND WALL CONSTRUCTION. IT IS THE CONTRACTOR'S RESPONSIBILITY TO DESIGN AND INSTALL AN ADEQUATE BRACING SYSTEM TO SUPPORT THE PANEL OVER ITS ENTIRE HEIGHT UNTIL CONNECTED TO WIRE FACED MSE RETAINING WALL.
4. DESIGN AND INSTALLATION OF THE CONNECTION OF THE PANEL TO THE WIRE FACED MSE RETAINING WALL IS THE RESPONSIBILITY OF THE CONTRACTOR.

Furnish As Submitted
 Furnish As Corrected

Corrections or changes to these drawings shall be made during the review process. The contractor shall be responsible for compliance with all applicable codes and specifications. The contractor shall be responsible for confirming the accuracy of all dimensions and general conditions. The contractor shall be responsible for the contact of all other drawings and specifications. The contractor shall be responsible for confirming the accuracy of all dimensions and general conditions. The contractor shall be responsible for the contact of all other drawings and specifications. The contractor shall be responsible for confirming the accuracy of all dimensions and general conditions. The contractor shall be responsible for the contact of all other drawings and specifications.

CARTER & BURDESS, INC.
Date 3/20/07 skw

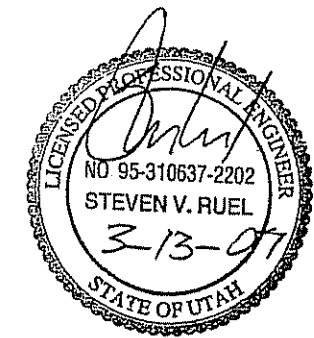

FOR QUESTIONS OR INFORMATION PLEASE CONTACT ANDREW MECKLER AT THE MAIN OFFICE

THE DESIGN OF THESE MSE PLUSSM WALLS IS BASED ON THE ASSUMPTION THAT ALL MATERIALS AND METHODS OF CONSTRUCTION CONFORM TO THE SPECIFICATIONS FOR MSE PLUSSM RETAINING WALLS, THE PROJECT BID DOCUMENTS.

THESE DRAWINGS, AS WELL AS THE DESIGN, ARE CERTIFIED WITH RESPECT TO THE INTERNAL STABILITY OF THE MSE PLUSSM STRUCTURES ONLY. EXTERNAL STABILITY INCLUDING, BUT NOT LIMITED TO, SLOPE AND FOUNDATION STABILITY IS THE RESPONSIBILITY OF THE OWNER AND THE ENGINEER FOR THE OWNER.

NO.	DATE	REVISION	BY

GENERAL CONTRACTOR - FULLY LICENSED
CONTRACTOR SUPPLIER

SSIL
SPECIALIZING IN CONSTRUCTION PRODUCTS
MAIN OFFICE: 4710 South Valley Dr., Suite 101, South Valley, California 92086
Phone: 818-430-9300 Fax: 818-430-9300

TYPICAL CROSS SECTIONS - 2 OF 3
LEGACY PARKWAY SEGMENT 1
UTAH DEPARTMENT OF TRANSPORTATION
SALT LAKE CITY, UTAH
PROJECT No. SP-0067(10)4

Date: 1/23/07
Scale: NTS
Drawn By: AJM
Job: 2506
Sheet: WW-10
Sheet 10 of 13

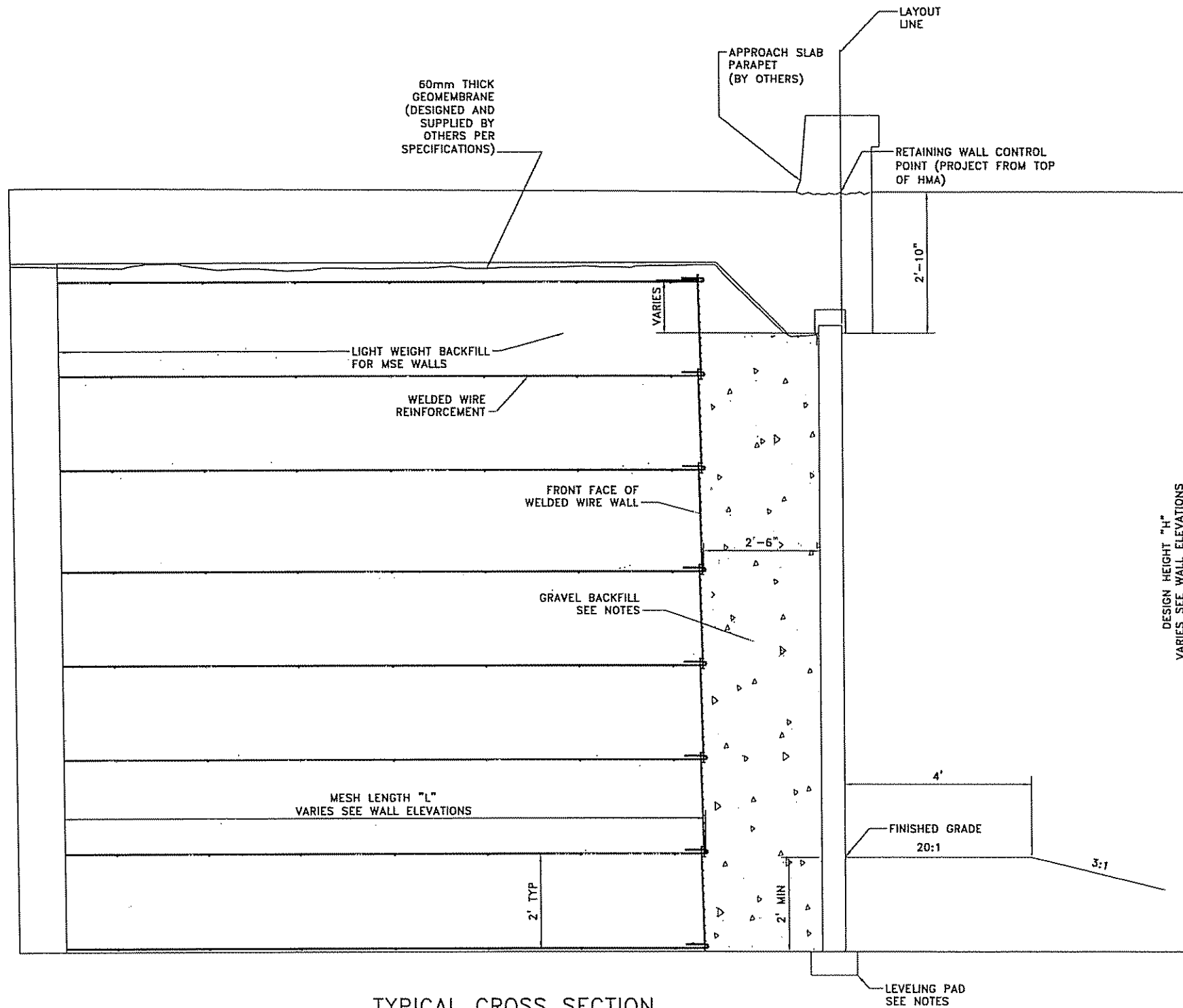

TYPICAL CROSS SECTION
AT APPROACH SLAB
(SEE CONTRACT PLANS FOR DETAILS NOT SHOWN)

NOTES:

1. INFORMATION SHOWING CONCRETE PANELS, BARRIER/SLAB DETAILS, AND ANY OTHER STAGE 2 DETAILS ARE FOR INFORMATION ONLY. FINAL DESIGN SHALL BE SUBMITTED AT A LATER DATE.
2. CONCRETE PANEL REINFORCEMENT AND LIFTING ANCHOR DESIGN IS THE RESPONSIBILITY OF THE CONTRACTOR AND MUST BE DESIGNED TO HANDLE MAXIMUM BENDING MOMENTS AND GENERAL SERVICE LOADS EXPERIENCED BY THE PANEL ONCE IN PLACE.
3. RIGGING SETUP AND PROCEDURE IS THE RESPONSIBILITY OF THE CONTRACTOR DURING ALL PHASES OF PANEL CASTING AND WALL CONSTRUCTION. IT IS THE CONTRACTOR'S RESPONSIBILITY TO DESIGN AND INSTALL AN ADEQUATE BRACING SYSTEM TO SUPPORT THE PANEL OVER ITS ENTIRE HEIGHT UNTIL CONNECTED TO WIRE FACED MSE RETAINING WALL.
4. DESIGN AND INSTALLATION OF THE CONNECTION OF THE PANEL TO THE WIRE FACED MSE RETAINING WALL IS THE RESPONSIBILITY OF THE CONTRACTOR.

Furnish As Submitted Revise And Resubmit
 Finish As Corrected Submit Specified Item

Corrections or comments made on the shop drawings during this review do not relieve contractor from compliance with requirements of the drawings and specifications. This check is only for review of general compliance with the design concept of the project and general compliance with the information given in the contract documents. The contractor is responsible for performing and completing all quantities and dimensions, selecting fabrication processes and techniques of construction, coordinating his work with that of all other trades, and performing his work in a safe and satisfactory manner.

CARTER & BURNESS, INC.
 Date 3/20/07 By SKW

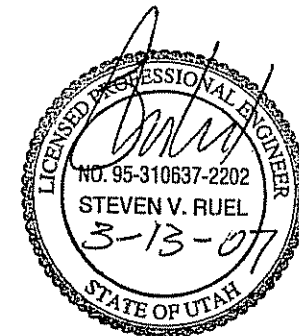

SPECIALIZING IN
 CONSTRUCTION PRODUCTS
SSL
 MAIN OFFICE
 4740 Soils Valley Dr., Suite 101
 South Valley, California 92386
 Phone 831 430 3300
 Fax 831 430 3340

TYPICAL CROSS SECTIONS - 3 OF 3
 LEGACY PARKWAY SEGMENT 1
 UTAH DEPARTMENT OF TRANSPORTATION
 SALT LAKE CITY, UTAH
 PROJECT No. SP-0067(10)4

FOR QUESTIONS OR INFORMATION PLEASE CONTACT ANDREW MECKLER AT THE MAIN OFFICE

THE DESIGN OF THESE MSE PLUSSM WALLS IS BASED ON THE ASSUMPTION THAT ALL MATERIALS AND METHODS OF CONSTRUCTION CONFORM TO THE SPECIFICATIONS FOR MSE PLUSSM RETAINING WALLS, THE PROJECT BID DOCUMENTS.

THESE DRAWINGS, AS WELL AS THE DESIGN, ARE CERTIFIED WITH RESPECT TO THE INTERNAL STABILITY OF THE MSE PLUSSM STRUCTURES ONLY. EXTERNAL STABILITY INCLUDING, BUT NOT LIMITED TO, SLOPE AND FOUNDATION STABILITY IS THE RESPONSIBILITY OF THE OWNER AND THE ENGINEER FOR THE OWNER.

Date:	1/23/07
Scale:	NTS
Drawn By:	AJM
Job:	2506
Sheet:	WW-11
Sheet	11 of 13

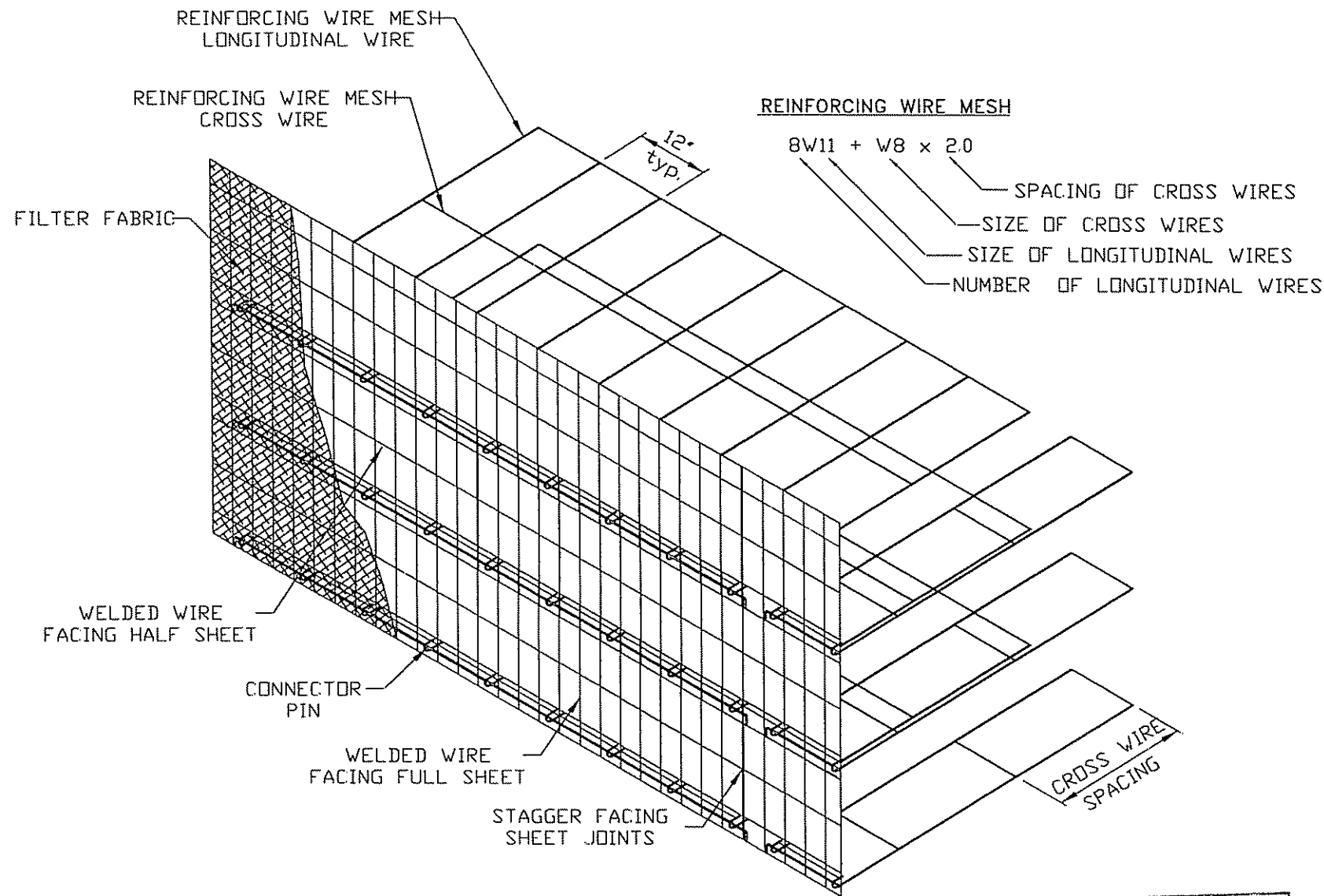

**GENERAL ASSEMBLY DETAIL
WELDED WIRE FACING SHEET**

(Mesh Cross Wires Omitted Behind Facing Sheets For Clarity)

MATERIAL SPECIFICATIONS

1. Soil Reinforcement Shall Be Cold Drawn Steel Wire And Meet The Requirements Of ASTM A-82.
2. Soil Reinforcement Shall Be Welded In Accordance With The Requirements Of ASTM A-185.
3. Galvanize Per ASTM A-123.

Furnish As Submitted Revise And Resubmit
 Furnish As Corrected Submit Specified Item

Corrections or comments made on the shop drawings during this review do not relieve contractor from compliance with requirements of the drawings and specifications. This check is only for review of general compliance with the design concept of the project and does not constitute compliance with the information given in the contract documents. The contractor is responsible for confirming and correlating all quantities and conditions, selecting fabrication processes and techniques of construction, coordinating his work with that of all other trades and performing his work in a safe and satisfactory manner.

CARTER & BURGESS, INC.
 Date 3/20/07 By skw

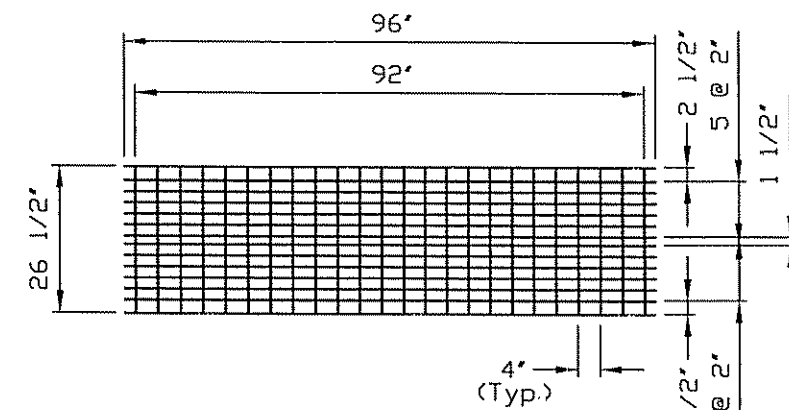

TYPICAL WELDED WIRE FACING FULL SHEET TYPE "A"

W5 (0.25Ø) GALVANIZED WIRE

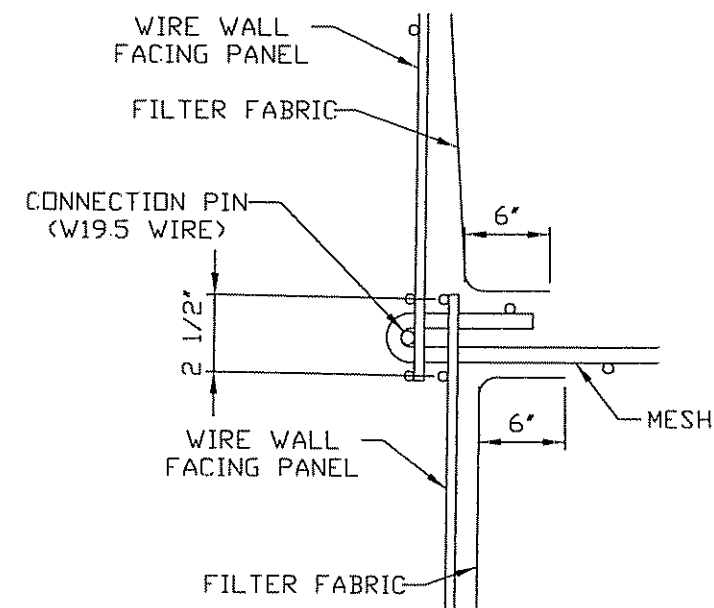

**MESH CONNECTION/
FILTER FABRIC DETAIL**

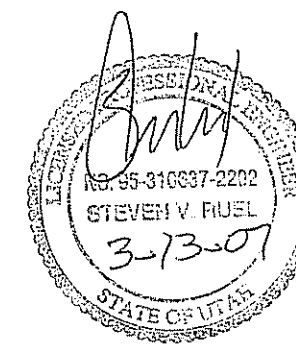

FOR QUESTIONS OR INFORMATION PLEASE CONTACT ANDREW MECKLER AT THE MAIN OFFICE

THE DESIGN OF THESE MSE PLUSSM WALLS IS BASED ON THE ASSUMPTION THAT ALL MATERIALS AND METHODS OF CONSTRUCTION CONFORM TO THE SPECIFICATIONS FOR MSE PLUSSM RETAINING WALLS, THE PROJECT BID DOCUMENTS.

THESE DRAWINGS, AS WELL AS THE DESIGN, ARE CERTIFIED WITH RESPECT TO THE INTERNAL STABILITY OF THE MSE PLUSSM STRUCTURES ONLY. EXTERNAL STABILITY INCLUDING, BUT NOT LIMITED TO, SLOPE AND FOUNDATION STABILITY IS THE RESPONSIBILITY OF THE OWNER AND THE ENGINEER FOR THE OWNER.

NO.	DATE	REVISION	BY
STANDARD WIRE WALL DETAILS: 1 OF 2 LEGACY PARKWAY SEGMENT 1 UTAH DEPARTMENT OF TRANSPORTATION SALT LAKE CITY, UTAH PROJECT No. SP-0067(10)4			
Date:	1/23/07	Scale:	NTS
Drawn By:	AJM	Job:	2506
Sheet:	WW-12	Sheet	12 of 13

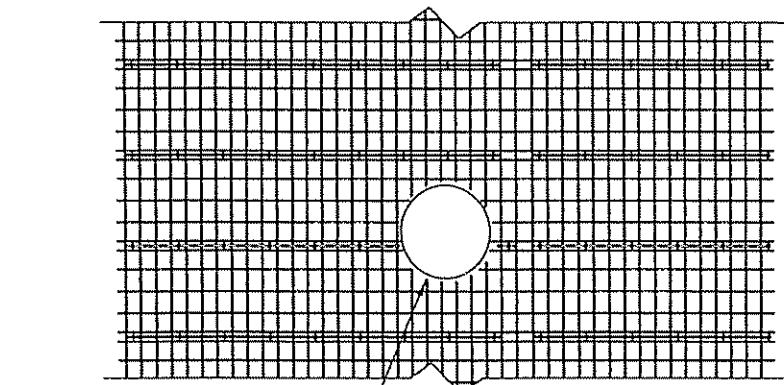

CUT FACING SHEETS AS REQUIRED TO ALLOW FOR PIPE PENETRATION

PIPE PENETRATION DETAIL (ELEVATION VIEW)

CUT FACING SHEETS AS REQUIRED TO ALLOW FOR PIPE PENETRATION

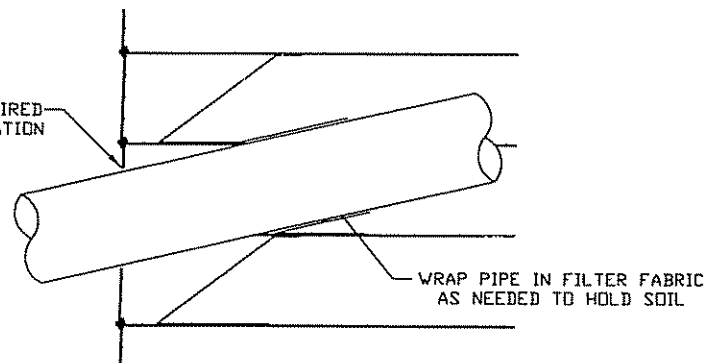

PIPE PENETRATION DETAIL (SECTION VIEW)

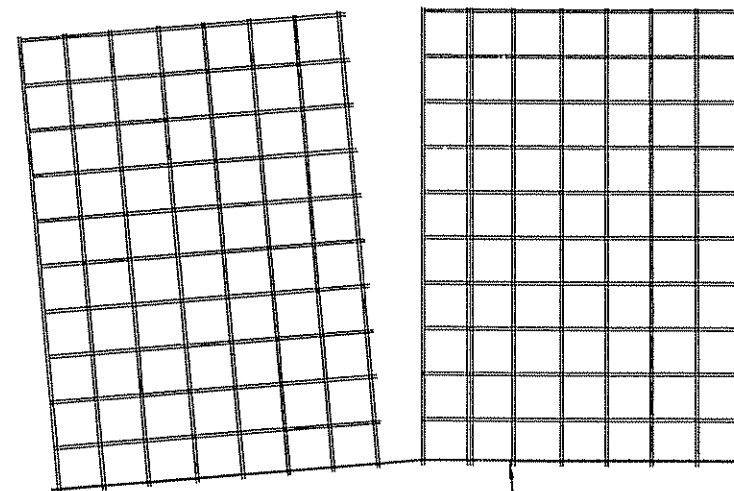

FRONT OF WALL

MESH DETAIL FOR CORNER (PLAN VIEW)

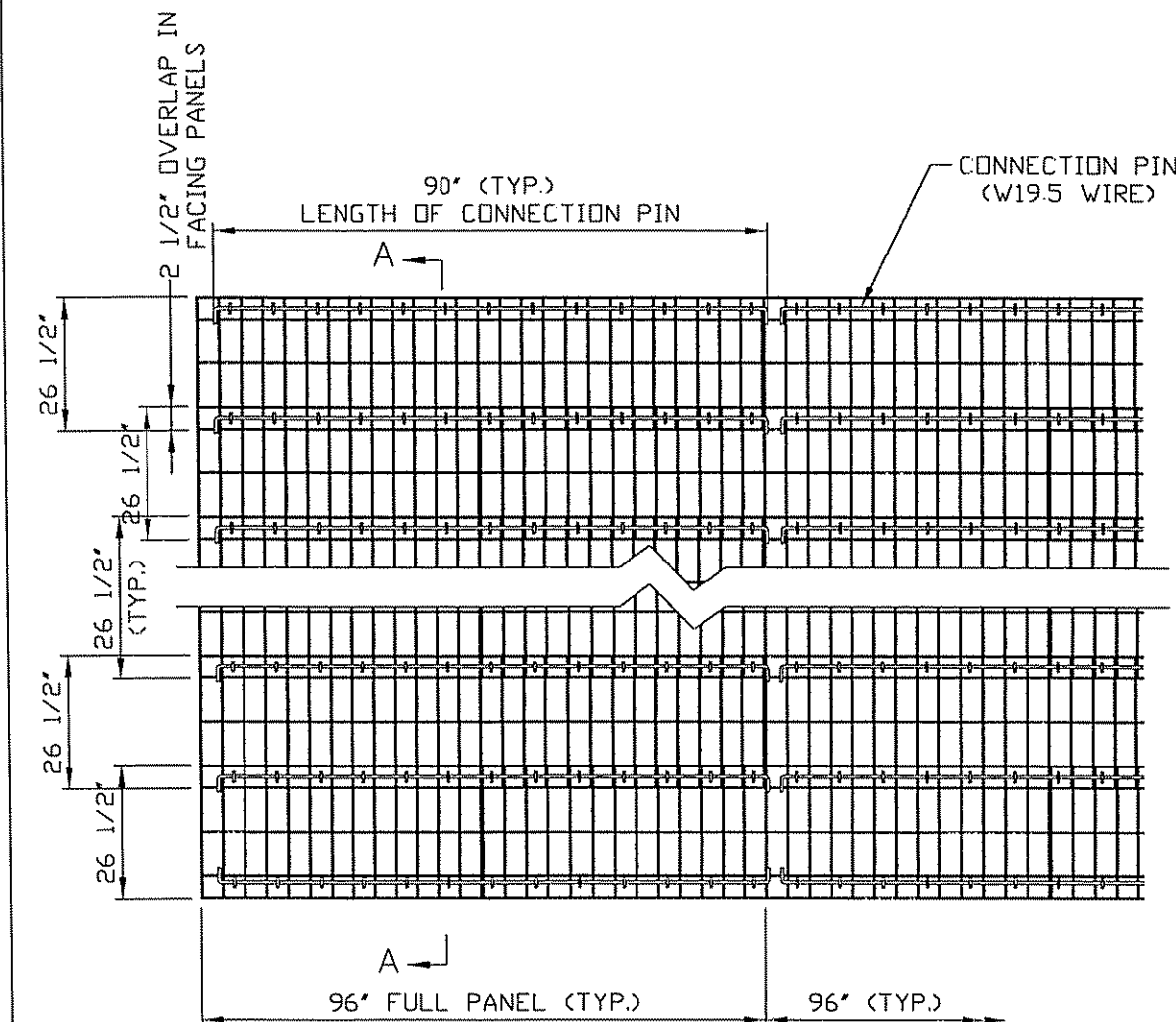

WELDED WIRE WALL PARTIAL ELEVATION

STAGGER FACING SHEET JOINTS (FRONT BERM OMITTED FOR CLARITY)

CUT MESH AS REQUIRED TO AVOID PIPE

MOVE / CUT MESH AROUND PIPE IF NECESSARY

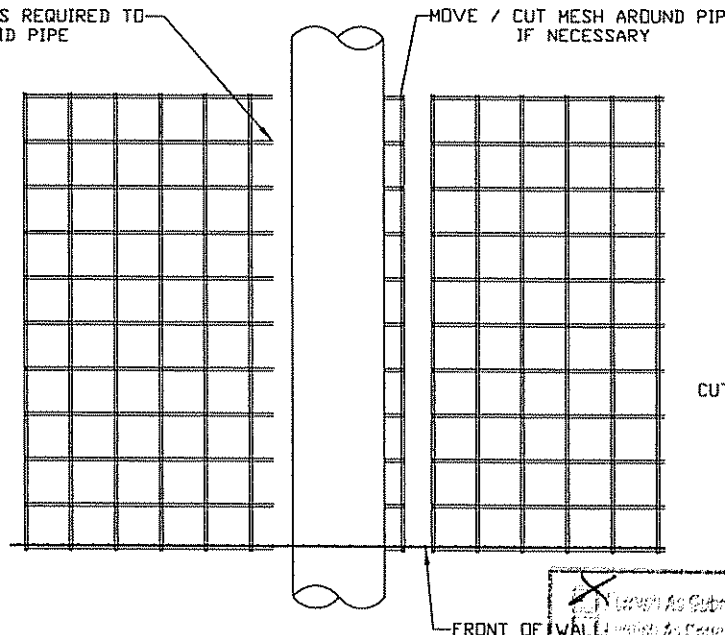

PIPE PENETRATION DETAIL (PLAN VIEW)

CUT MESH AS REQUIRED TO AVOID OBSTRUCTION

MOVE / CUT MESH AROUND OBSTRUCTION IF NECESSARY

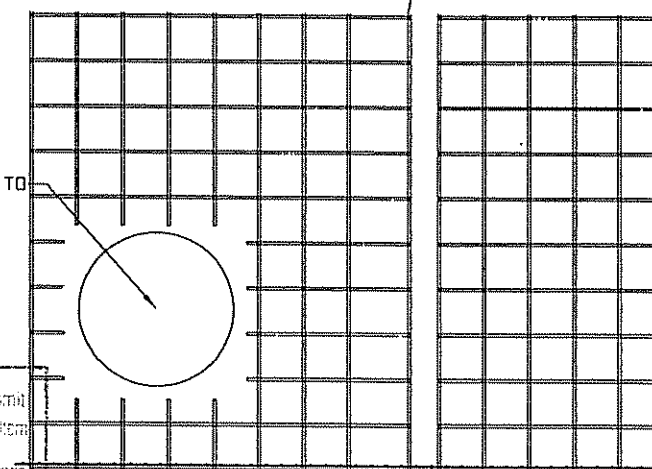

FRONT OF WALL

PIPE PENETRATION DETAIL (PLAN VIEW)

Review As Submitted
 Revise And Resubmit
 Submit As Corrected
 Submit Specified Item

I/We, the undersigned, certify that the design and construction of the project shown on these drawings complies with the information given in the contract documents. The contractor is responsible for coordinating and correlating all quantities and dimensions, selecting fabrication processes and methods of construction, coordinating the work with that of all other trades, and performing his work in a safe and satisfactory manner.

GANTER & BURGESS, INC.
 Date 3/20/07 By SKW

NOTES:

- SEE CONTRACT PLANS FOR ALL DETAILS NOT SHOWN
- PIPE SHALL BE PLACED DURING CONSTRUCTION AND MESH SHALL BE MODIFIED TO ACCOMMODATE PIPE
- CUT MESH OR DAMAGED GALV SHALL BE COATED WITH ZINC RICH PAINT.

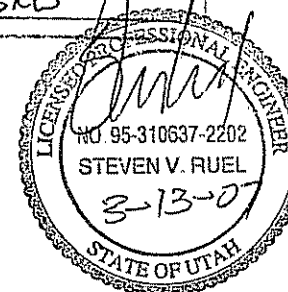

FOR QUESTIONS OR INFORMATION PLEASE CONTACT ANDREW MECKLER AT THE MAIN OFFICE

THE DESIGN OF THESE MSE PLUSSM WALLS IS BASED ON THE ASSUMPTION THAT ALL MATERIALS AND METHODS OF CONSTRUCTION CONFORM TO THE SPECIFICATIONS FOR MSE PLUSSM RETAINING WALLS, THE PROJECT BID DOCUMENTS.

THESE DRAWINGS, AS WELL AS THE DESIGN, ARE CERTIFIED WITH RESPECT TO THE INTERNAL STABILITY OF THE MSE PLUSSM STRUCTURES ONLY. EXTERNAL STABILITY INCLUDING, BUT NOT LIMITED TO, SLOPE AND FOUNDATION STABILITY IS THE RESPONSIBILITY OF THE OWNER AND THE ENGINEER FOR THE OWNER.



SPECIALIZING IN CONSTRUCTION PRODUCTS
SSSL
 MAIN OFFICE
 4740 South Valley Dr., Suite 111
 South Valley, Ogden, UT 84403
 Phone: 435-436-9300
 Fax: 435-436-9300

STANDARD WIRE WALL DETAILS: 2 OF 2
 LEGACY PARKWAY SEGMENT 1
 UTAH DEPARTMENT OF TRANSPORTATION
 SALT LAKE CITY, UTAH
 PROJECT No. SP-0067(10)4

Date: 1/23/07

Scale: NTS

Drawn By: AJM

Job: 2506

Sheet:

WW-13

Sheet 13 of 13

NO.	DATE	REVISION	BY