

*Craig Seark  
Lori Dabbling*

# UTAH DEPARTMENT OF TRANSPORTATION PLANS OF PROPOSED STATE ROAD FEDERAL AID PROJECT BRF-0006(25)159 US-6 OVER UPRR WEST OF SANTAQUIN UTAH COUNTY BRIDGE REPLACEMENT LENGTH 0.413 MILES

6-04-1

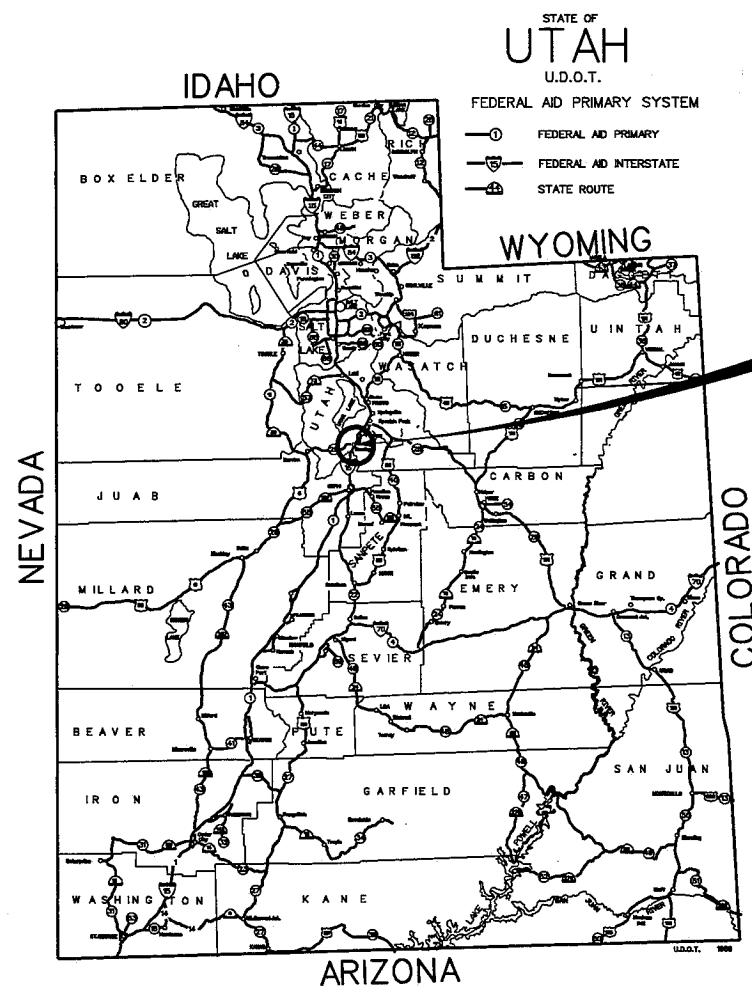

BRF-0006(25)159

STA. 57+50.00  
END PROJECT  
BRF-0006(25)159  
R.P. 158.581

STA. 35+66.00  
BEG. PROJECT  
BRF-0006(25)159  
R.P. 158.994

RR STRUCTURE NO.  
US-6  
AAR # 806 854 W  
RR MP 730.60  
SHARP SUBDIVISION

STRUCTURE NO. F-722  
STRUCTURE NO. R-436  
Exist. Structure No. C-381  
Exist. Structure No. C-133

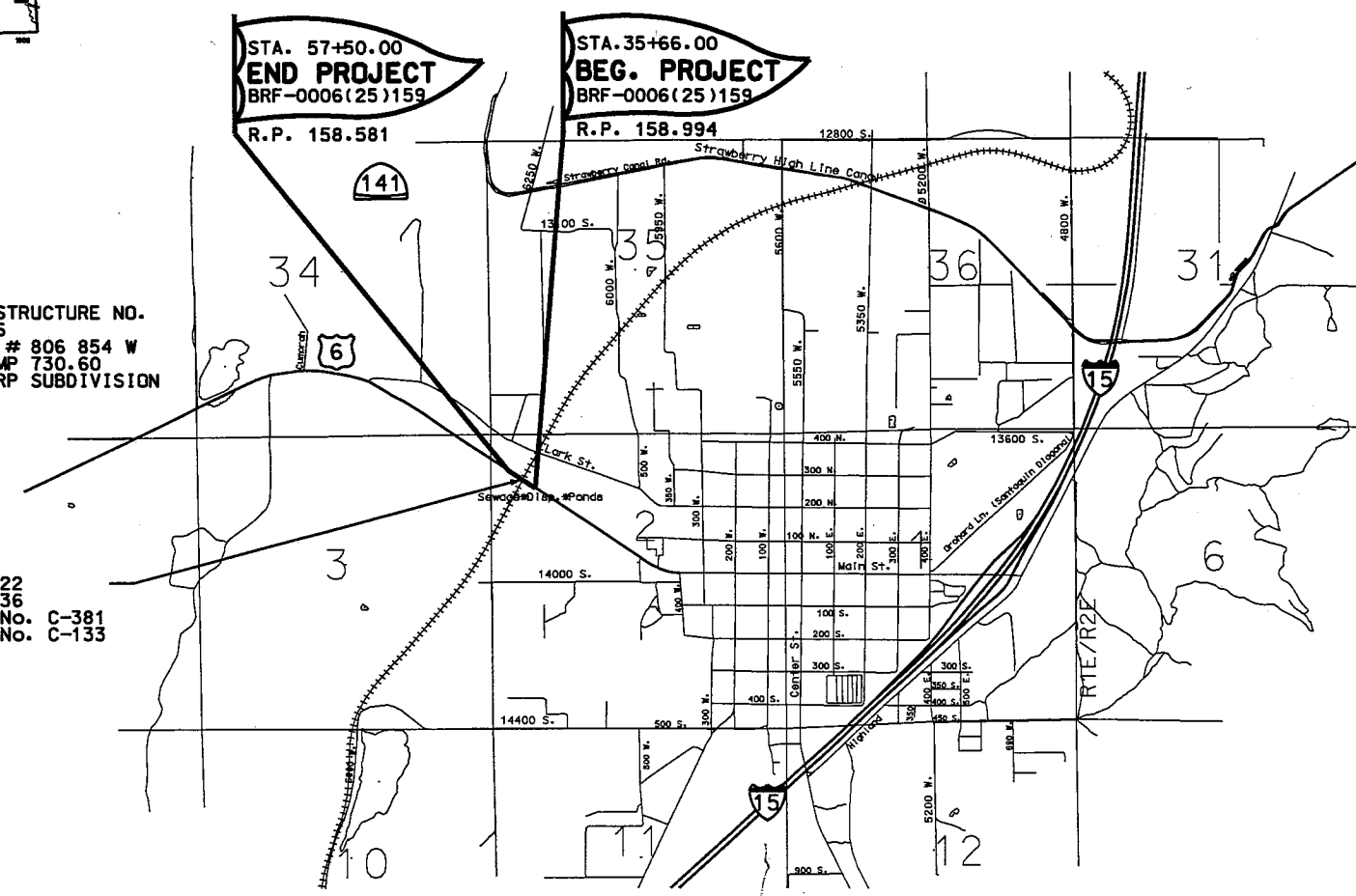

RECEIVED  
NOV 17 2004  
CONST.ORG.3755

UTAH DEPARTMENT OF TRANSPORTATION  
RECOMMENDED FOR APPROVAL \_\_\_\_\_ 2004  
PRECONSTRUCTION ENGINEER  
RECOMMENDED FOR APPROVAL \_\_\_\_\_ 2004  
PROJECT MANAGER  
APPROVAL \_\_\_\_\_ 2004  
REGION DIRECTOR

BRF-0006(25)159

DESIGN: BSP 03/04  
 DRAWN: BSP 03/04  
 QUANT.: BSP 03/04

CHECK: GCG 03/04  
 CHECK: GCG 03/04  
 CHECK: GCG 03/04

DATE: 9/27/04  
 DATE: 9/27/04  
 DATE: 9/27/04

REVISIONS

NO. 1  
 DATE  
 BY

REVISIONS

NO. 2  
 DATE  
 BY

REVISIONS

NO. 3  
 DATE  
 BY

REVISIONS

NO. 4  
 DATE  
 BY

REVISIONS

UTAH DEPARTMENT OF TRANSPORTATION  
 REGION 3, OREM, UTAH  
 HDR ENGINEERING, INC.

APPROVAL RECORD

DESIGN: GCG 12/03  
 CHECK: BSP 12/03

DRAWN: JMG 12/03  
 CHECK: GCG 12/03

QUANT.: BSP 03/04  
 CHECK: GCG 03/04

DATE: 9/27/04  
 DATE: 9/27/04  
 DATE: 9/27/04

SECTION DESIGN ENGR.  
 UNIT BRIDGE ENGR.

DATE: 9/27/04  
 DATE: 9/27/04  
 DATE: 9/27/04

SECTION DESIGN ENGR.  
 UNIT BRIDGE ENGR.

DATE: 9/27/04  
 DATE: 9/27/04  
 DATE: 9/27/04

UTAH  
 COUNTY

R-436  
 ORG. NO.

UTAH  
 COUNTY

SITUATION AND LAYOUT

PROJECT NUMBER  
 BRF-0006(25)159

UTAH  
 COUNTY

R-436  
 ORG. NO.

UTAH  
 COUNTY

SITUATION AND LAYOUT

PROJECT NUMBER  
 BRF-0006(25)159

UTAH  
 COUNTY

R-436  
 ORG. NO.

UTAH  
 COUNTY

SITUATION AND LAYOUT

PROJECT NUMBER  
 BRF-0006(25)159

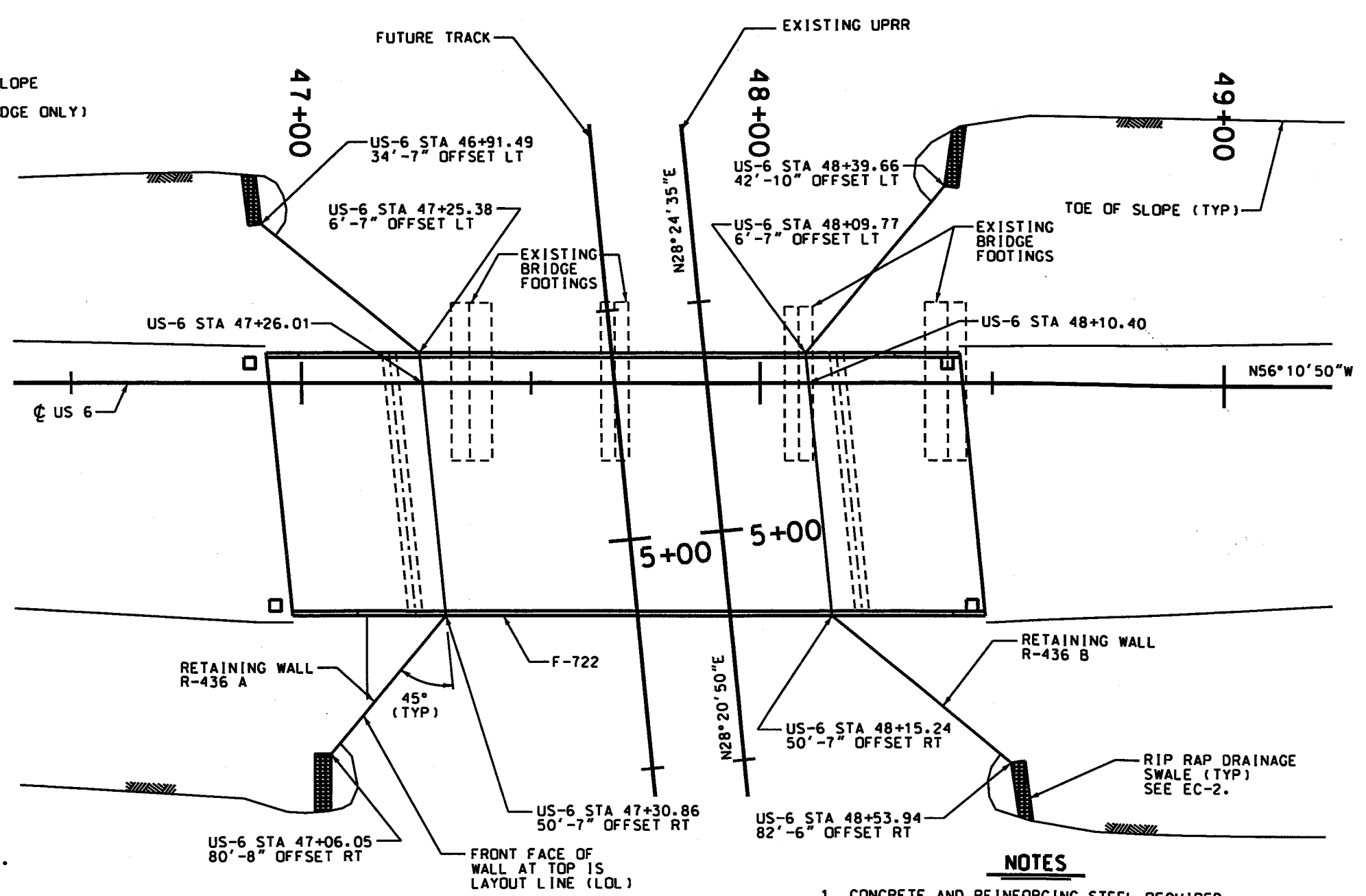
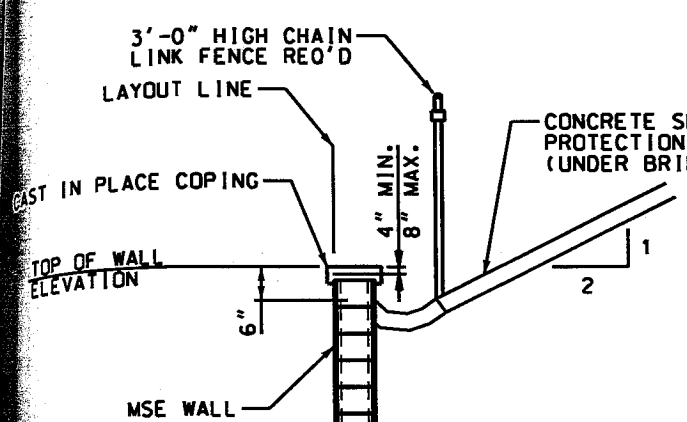

**DETAIL A  
 WALL CROSS SECTION**

GRADE DRAINAGE DITCH IN FRONT OF WALL TO DRAIN NORTH UNDER THE BRIDGE AND THEN OUT AWAY FROM THE UPRR TRACKS.

\* 2'-0" MINIMUM DEPTH MUST BE MAINTAINED FOR A MINIMUM OF 4'-0" AT FRONT FACE OF WALL.

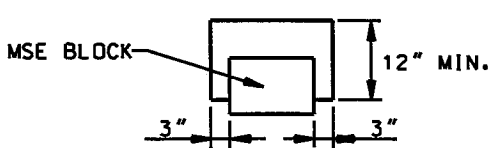

**DETAIL  
 CAST IN PLACE COPING**

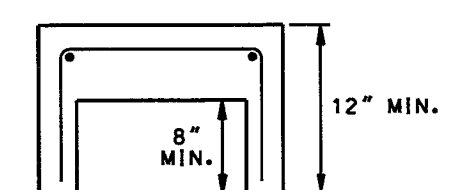

**COPING**

**NOTES**

1. CONCRETE AND REINFORCING STEEL REQUIRED FOR THE COPING IS INCLUDED IN WALL COST.
2. COPING MATERIALS:  
 f'c = 4000 PSI CLASS AA CONCRETE  
 fy = 60,000 PSI EPOXY COATED REINFORCEMENT
3. CHAIN LINK FENCE MATERIAL AND INSTALLATION SHALL BE IN ACCORDANCE WITH THE "STATE OF UTAH STANDARD SPECIFICATIONS" CURRENT EDITION, AND STANDARD DRAWING NO. FG 6.
4. EXCAVATION FOR WALL CONSTRUCTION IS INCIDENTAL TO RETAINING WALL BID ITEMS.

**RETAINING WALL QUANTITIES**

ITEM	QUANTITY	UNIT	AS CONSTR
MSE RETAINING WALL	5420.0 SO FT* EST. EXPOSED SURFACE	LUMP	
3' CHAIN LINK FENCE - TYPE II	295'	FT	

\*FOR INFORMATION ONLY

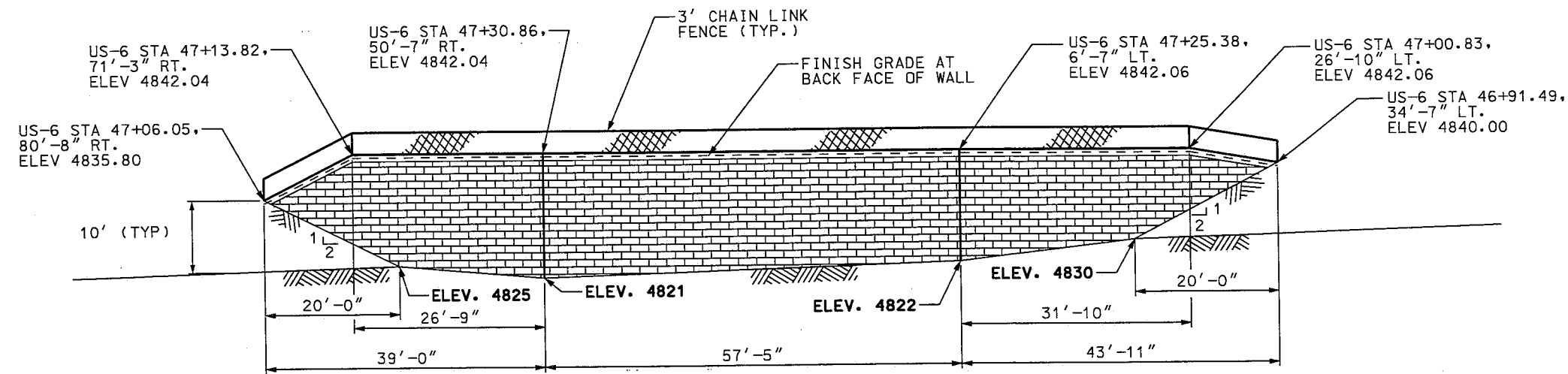

**DEVELOPED ELEVATION - WALL R-436 A  
LOOKING BACK STATION US-6**

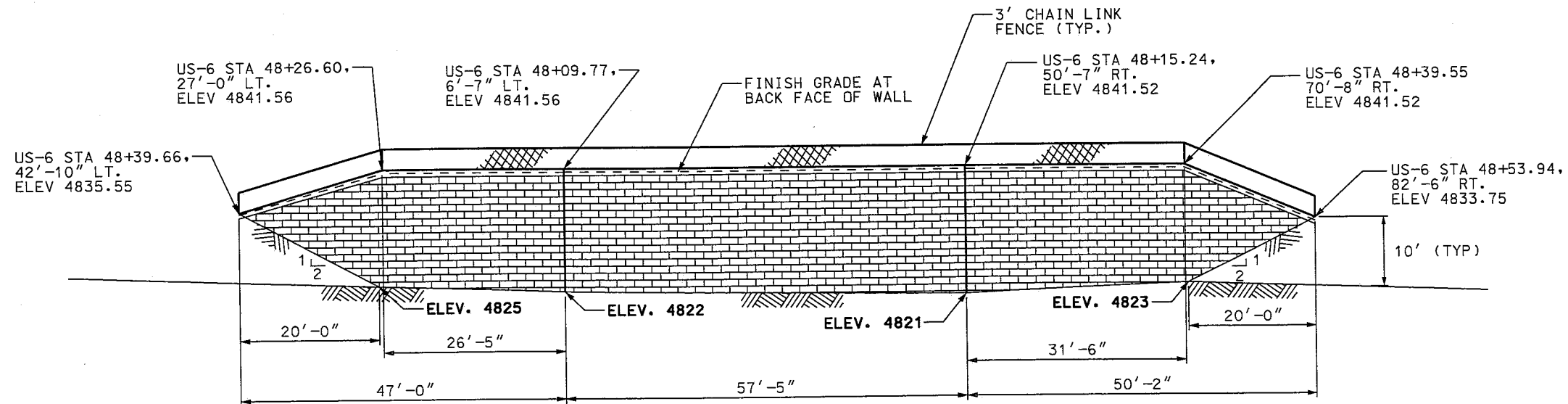

**DEVELOPED ELEVATION - WALL R-436 B  
LOOKING AHEAD STATION US-6**

UTAH DEPARTMENT OF TRANSPORTATION		SALT LAKE CITY, UTAH		STRUCTURES DIVISION	
DESIGN	GCG	12/03	CHECK	BSP	12/03
DRAWN	JMG	12/03	CHECK	GCG	12/03
QUANT.	BSP	12/03	CHECK	RDH	04/04
APPROVAL	RECOMM.	DATE	SENIOR DESIGN ENGR.	DATE	UNIT BRIDGE ENGR.
APPROVED FOR USE	BY	DATE	DATE	DATE	DATE
PROJECT NAME LINE 1	PROJECT NAME LINE 2				
SITUATION AND LAYOUT					
PROJECT NUMBER	PROJECT NUMBER				
COUNTY					
COUNTY					
XR-436 <sup>±</sup>					
DRG. NO.					
SHT. 2 OF 2					