

NEW HAMPSHIRE DEPARTMENT OF TRANSPORTATION
BUREAU OF TRANSPORTATION PLANNING
IN COOPERATION WITH
U.S. DEPARTMENT OF TRANSPORTATION
FEDERAL HIGHWAY ADMINISTRATION



STRAIGHT LINE DIAGRAM PROGRESS PROFILE

NOMINAL SCALE 1" EQUALS 1000'

UNLESS OTHERWISE NOTED

INVENTORY DATA FOR 1987

DIST. NO. 3 TOWN OF NEW DURHAM (325)
COUNTY STRAFFORD INVENTORY NO. 0037
U.S. ROUTE NO. N.H. ROUTE NO. 11
SHEET 1 OF 2 ROAD NAME HENRY WILSON Hwy
COMPUTER DRAWN BY: SBH 21MAR89

System - Class	
PAVEMENT WIDTH	1-1
PAVEMENT TYPE	24'
NUM. LANES / WIDTH	60
SHOULDER TYPE/L/R	2 @ 12'
FUNCTIONAL CLASS	1/10/10
ROUTE SIGNING/ROUTE #	06
FA SYS/RTE SEC.	NH-11
MAINTENANCE S/V	2/022
FACILITY TYPE	
TRUCK ROUTE	2
	1

LEGEND

- TOLL BARRIER OR OTHER HALL (USE LETTERS T, B OR O TO DENOTE KIND)
- CHURCH
- SCHOOL
- CEMETERY
- HOSPITAL
- HIGHWAY BRIDGE
- HIGHWAY UNDERPASS
- RAILROAD
- TRANSMISSION LINE
- FIRE STATION
- POLICE STATION

CONSTRUCTION AND MAINTENANCE RECORD

NO R1% DATA SELECTED FROM R1
DATA
87

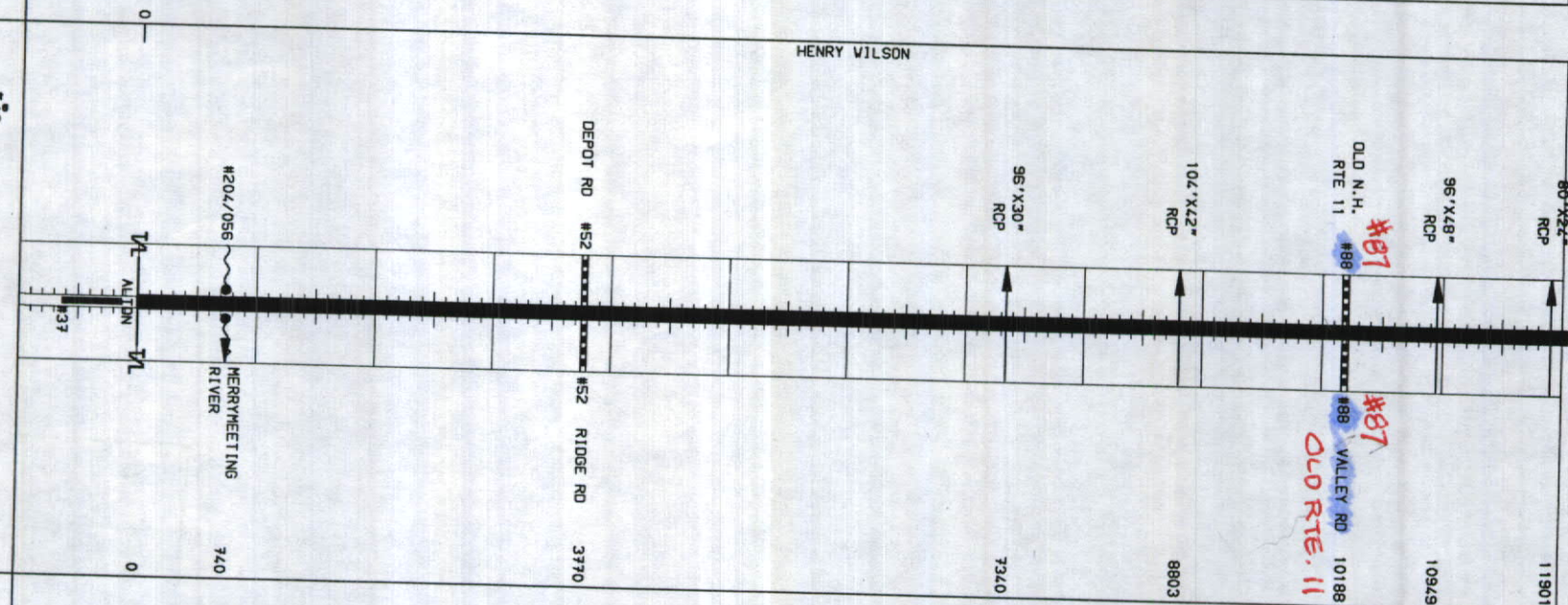

Revisions:

PLOTTED:
JAN 10, 1994

SURFACE TYPES

HIGH TYPE (61) (62) (72)	MEDIUM TYPE (51) (52) (53)	GRAVEL (40)	S.A.D. (30)	UNIMPROVED (20)	PRIVATE	BRK. BLK. PISC. (80)

TOTAL MILES



STRAIGHT LINE DIAGRAM PROGRESS PROFILE

NOMINAL SCALE 1" EQUALS 1000'

UNLESS OTHERWISE NOTED

INVENTORY DATA FOR 1987

DIST. NO. 3 TOWN OF NEW DURHAM (325)
COUNTY STRAFFORD INVENTORY NO. 0037
U.S. ROUTE NO. N.H. ROUTE NO. 11
SHEET 2 OF 2 ROAD NAME HENRY WILSON
COMPUTER DRAWN BY: SBH 21MAR89

