



Maps and data sets are not guaranteed to be free from errors and omissions. Data is in a constant state of update and correction by various groups and agencies. Information displayed on this map is the best available at the time of publication.

# 2025 Nodal Reference Bookmap

## LEGEND



NHDOT will accept crash locations based on the State of NH Uniform Police Traffic Accident Report.

Crash occurred on:

**Option 1**     Street Address  
                   123 Main Street

**Option 2**     Route No and/or     Distance from             NESW             Intesecting Road, Bridge,  
                   Street name             Intersecting Street                                     Town/County line  
                   Main Street                     500                     E                     Oak Street

**Option 3**     First Node                     Distance from First Node                     Second Node  
                   515                                     212                                     632

**Option 4**     Route No and/or             Mile Marker on Interstate Only             NESW             Mile (Marker)  
                   Street name  
                   189S                                     700 feet                                     S                     36.8

**Option 3 – Example**

Street Name                     Loudon Road  
First Node                             803  
Distance from First Node             318 Ft  
Second Node                             813



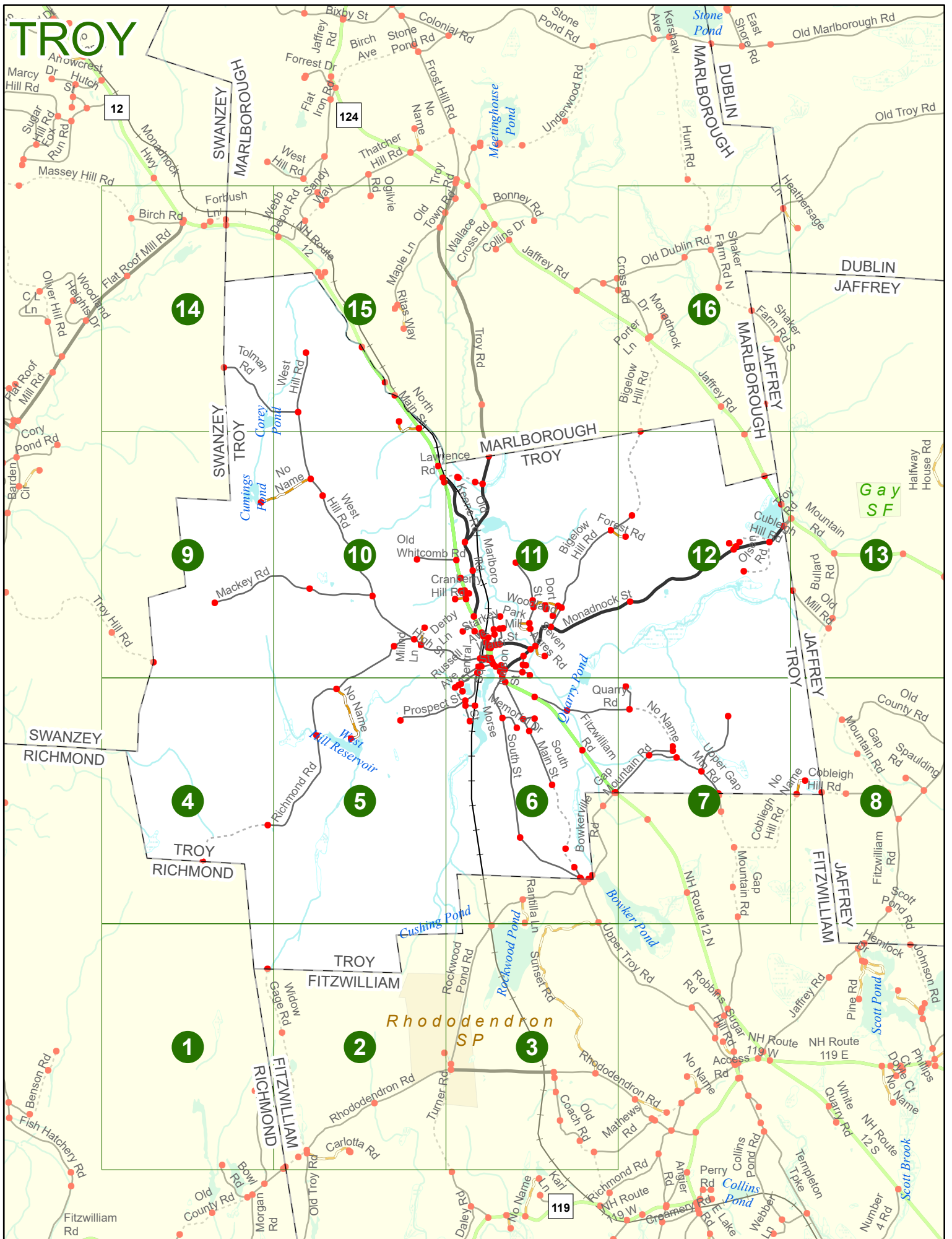

Match to Page 4

# TROY

Match to Page 0

# 1

TROY  
RICHMOND

6108 TROY  
FITZWILLIAM

Wilcox  
Gage Rd

Match to Page 2

0148

FITZWILLIAM  
RICHMOND

0038

Morgan Rd

0037

Bow Rd

0082

0 495 990 1,980 Feet

Match to Page 0



# TROY

FITZWILLIAM

Match to Page 6

Match to Page 0

Rhododendron SP

## 3

Match to Page 2  
0143  
0147

Turner Rd

Rockwood Pond Rd

Rockwood Pond

Sunset Rd

Upper Toy Rd

Bowler Pond

Rhododendron Rd

0141

0411

0534

0530

Old Coach Rd

0464

0463

0077

Mathews Rd

0 495 990 1,980 Feet

Match to Page 0

Match to Page 9

# TROY

SWANZEY  
TROY

SWANZEY  
RICHMOND

# 4

Match to Page 0

Match to Page 5

Richmond Rd

TROY  
RICHMOND

6388

0084

0 495 990 1,980 Feet

Match to Page 1

# TROY

Match to Page 10

Brook St  
0062

0106

0001

Prospect St

0083

0103

Richmond Rd

West Hill Reservoir

# 5

Match to Page 4

0084

Match to Page 6

0 495 990 1,980 Feet

Match to Page 2

Cushing Pond

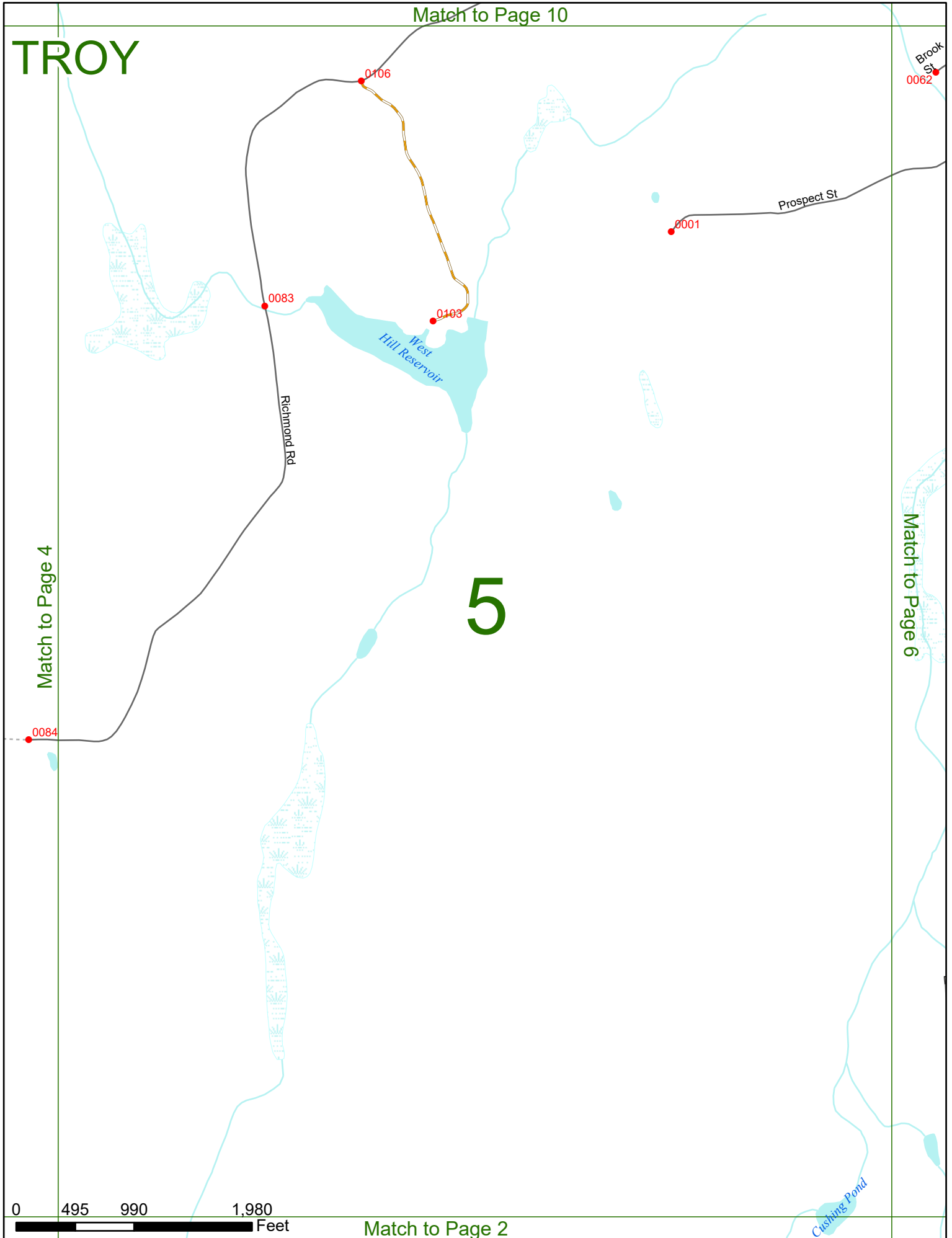



TROY

Match to Page 11

Match to Page 5

Match to Page 7

6

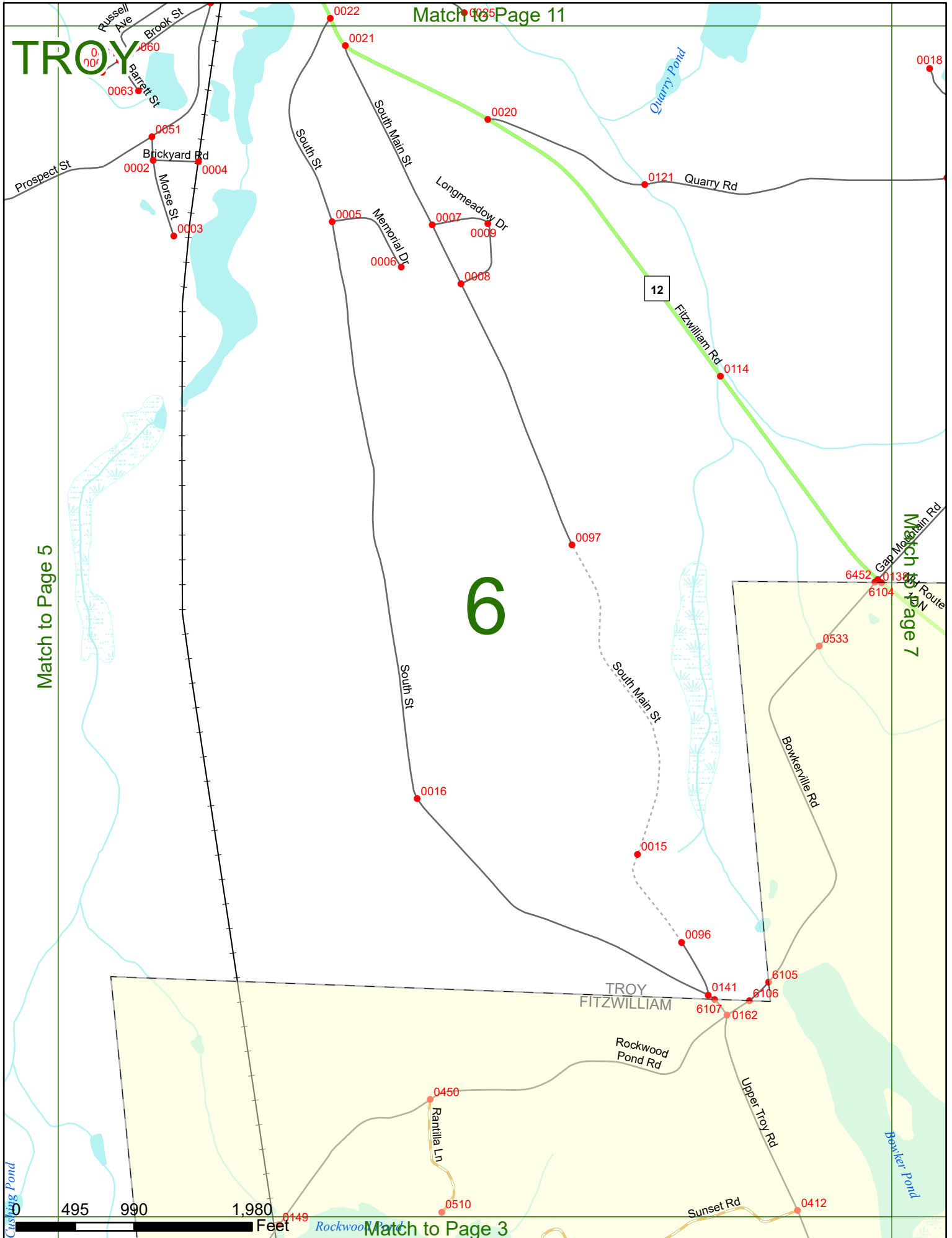

Match to Page 3

Cushing Pond

Bowker Pond

Quarry Pond

TROY FITZWILLIAM

Rockwood Pond Rd

Upper Troy Rd

Sunset Rd

Bowkerville Rd

South Main St

South St

Longmeadow Dr

Memorial Dr

Brickyard Rd

Morse St

Prospect St

Russell Ave  
Brook St  
Parrett St

Gap Mountain Rd  
Route 100 N

12

Fitzwilliam Rd

Quarry Rd

Match to Page 12

# TROY

Quarry Rd

0019

0014

Gap Mountain Rd

0098

0012

Fern Hill Rd

0010

0013

0011

Upper Gap Mtn Rd

Fitzwilliam Rd

6452 138 104

# 7

6102

0567

Match to Page 8

6430

Match to Page 6

0158

12

NH Route 12 N

0568

Upper Gap Mountain Rd

Cobleigh Hill Rd

0459

0156

Gap Mountain Rd

0157

0468

Bowker Pond

0 495 990 1,980 Feet

Match to Page 0

# TROY

Bixler Way

0853

Old County Rd

0341

JAFFREY  
TROY

Fitzwilliam Rd

0318

0891

Gap Mountain Rd

0316

Spaulding Rd

0315

Match to Page 0

# 8

0856 Cobleigh Hill Rd

0314

TROY  
FITZWILLIAM

6463

6430

Cobleigh Hill Rd

Match to Page 7



JAFFREY  
FITZWILLIAM

Fitzwilliam Rd

0313

0309

Scott Pond Rd

Scott Pond

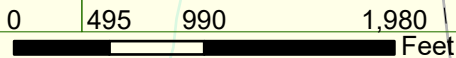

Match to Page 14

Corey Pond

# TROY

TROY  
SWANZEY

# 9

Match to Page 0

Match to Page 10



0104

Mackey Rd

0080

0243

Troy Hill Rd

6401

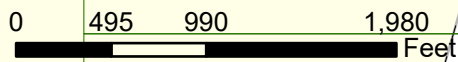

Match to Page 4

Match to Page 15

# TROY

# 10

Match to Page 9

Match to Page 11

MARLBOROUGH  
TROY

12

0107

0076

0112

0120

0149

0073

0071

0070

Mackey Rd  
0081

0079

0089

0113

0050

0108

0085

High St

Richmond Rd

Millind Ln

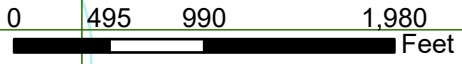

Match to Page 5

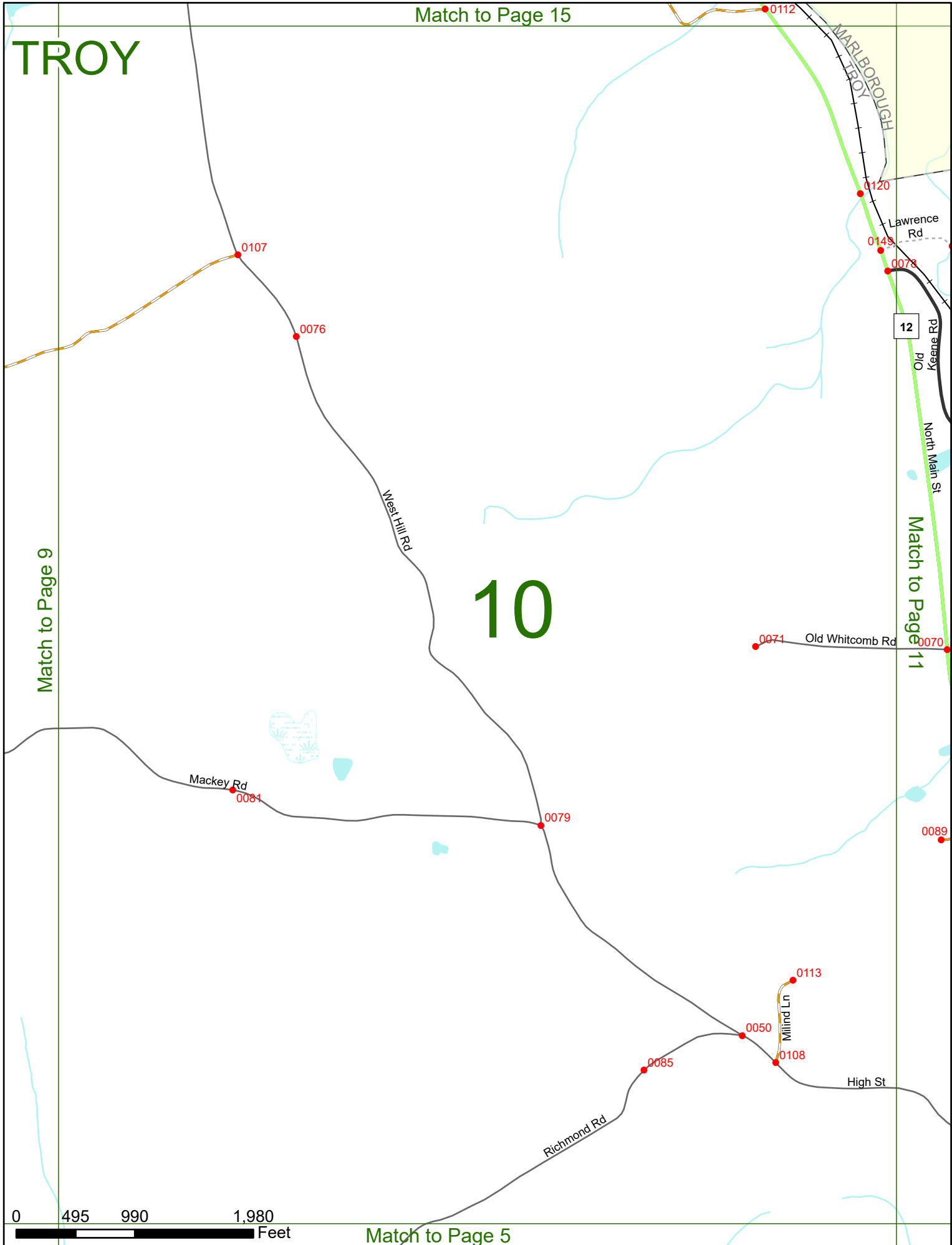

# TROY

MARLBOROUGH  
TROY

Bigelow  
Hill Rd

Match to Page 10

Match to Page 12

# 11

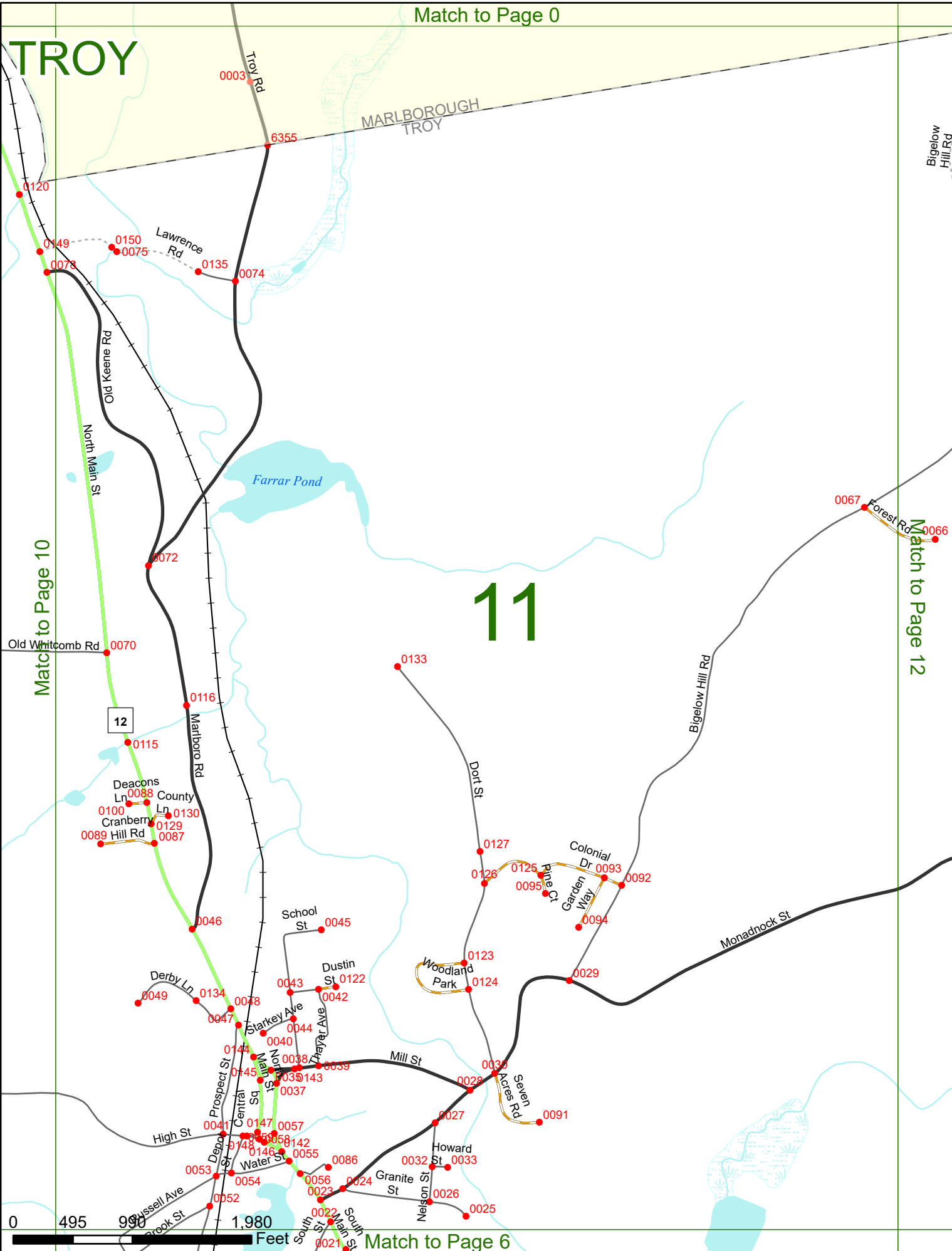

Match to Page 16

# TROY

# 12

Match to Page 11

Match to Page 13

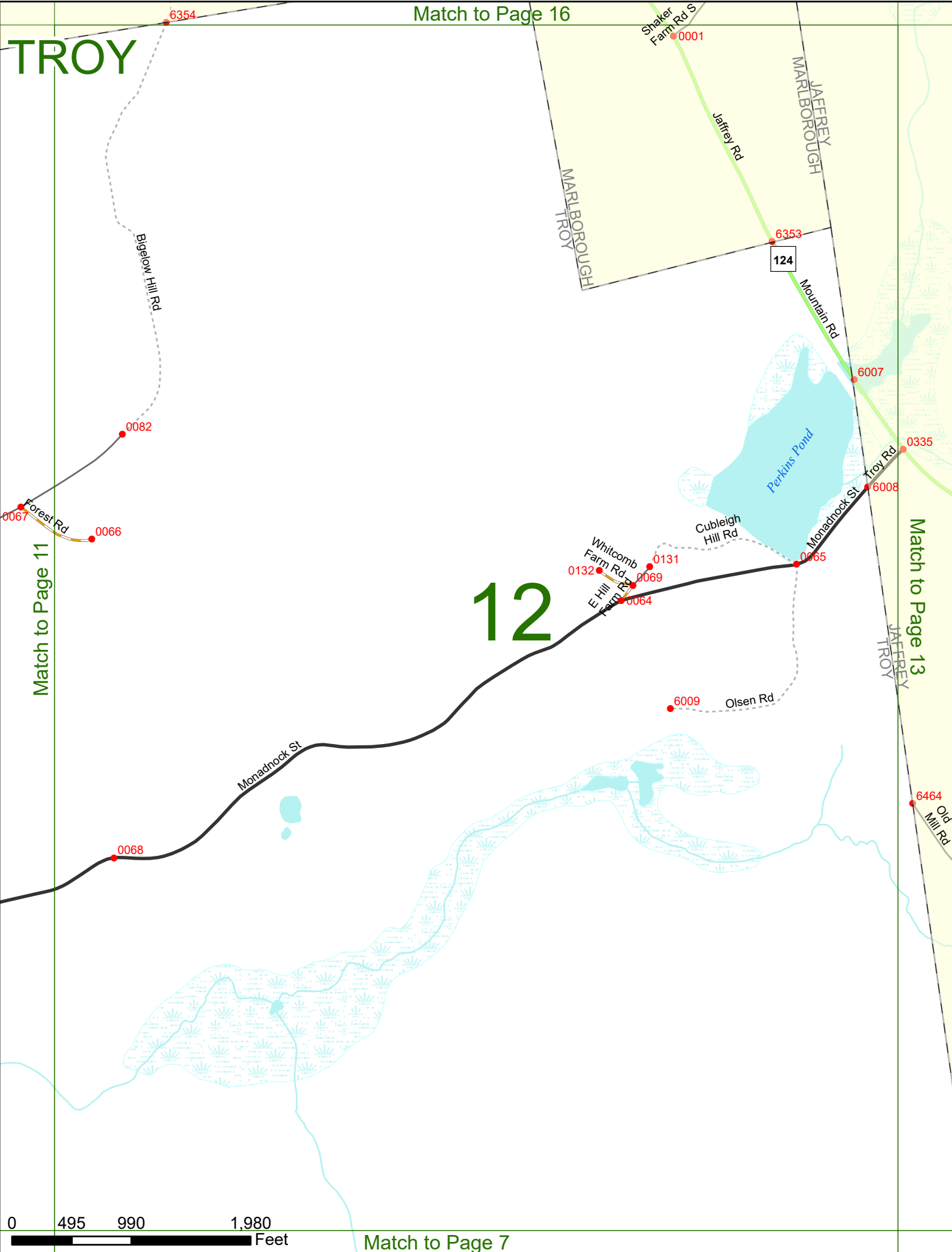

0 495 990 1,980 Feet

Match to Page 7

# TROY

Gay SF

# 13

24

Mountain Rd

0889

0337

0333

0330

0329

0328

0327

Halfway House Rd

Bullard Rd

0875

0339

Old Mill Rd

Gap Mountain Rd

6007

Mountain Rd

0335

6008

Troy Rd

Match to Page 12

6464

JAFFREY TROY

Match to Page 0

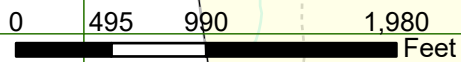



Match to Page 0

TROY

Washburn Hill Rd

Monadnock Hwy

0245

Birch Rd

0132

0133

0131

Forbush Ln

12

0379

SWANZEY  
MARLBOROUGH

6400

6377

NH Route 12

Webb  
Depot Rd

0164

Flat Roof Mill Rd

0350

MARLBOROUGH  
TROY

Match to Page 0

14

Match to Page 15

SWANZEY  
TROY

6387

Tolan Rd

Corey Pond

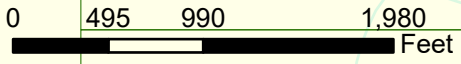

Match to Page 9

# TROY

Match to Page 0

# 15

Match to Page 14

Match to Page 0

Match to Page 10

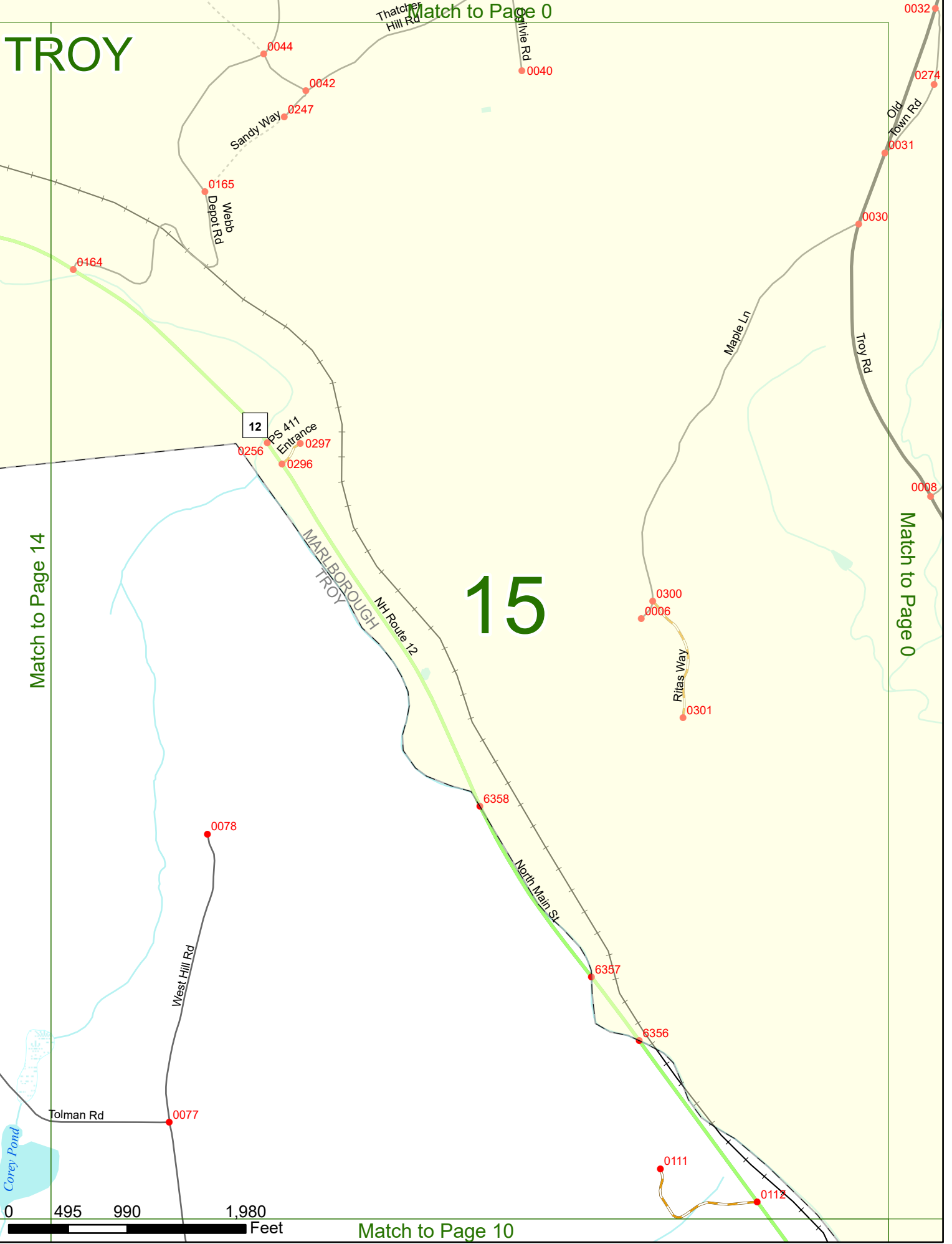

Match to Page 0

# TROY

Old Troy Rd

6136

Heathersage Ln

0287

MARLBOROUGH  
DUBLIN

Hunt Rd

0254

0022

0266

Old Dublin Rd

0014

Cross Rd

0015

Match to Page 0

Monadnock Dr

0017

Porter Ln

0016

0002

# 16

Shaker Farm Rd N

MARLBOROUGH  
JAFFREY

6005

Shaker Farm Rd S

0884

Match to Page 0

124

Jaffrey Rd

Bigelow Hill Rd

0265

6006

0001

MARLBOROUGH  
TROY



Match to Page 12