



Maps and data sets are not guaranteed to be free from errors and omissions. Data is in a constant state of update and correction by various groups and agencies. Information displayed on this map is the best available at the time of publication.

2025 Nodal Reference Bookmap

LEGEND



NHDOT will accept crash locations based on the State of NH Uniform Police Traffic Accident Report.

Crash occurred on:

Option 1 Street Address
 123 Main Street

Option 2 Route No and/or Distance from NESW Intesecting Road, Bridge,
 Street name Intersecting Street Town/County line
 Main Street 500 E Oak Street

Option 3 First Node Distance from First Node Second Node
 515 212 632

Option 4 Route No and/or Mile Marker on Interstate Only NESW Mile (Marker)
 Street name
 189S 700 feet S 36.8

Option 3 – Example

Street Name Loudon Road
First Node 803
Distance from First Node 318 Ft
Second Node 813



ORFORD

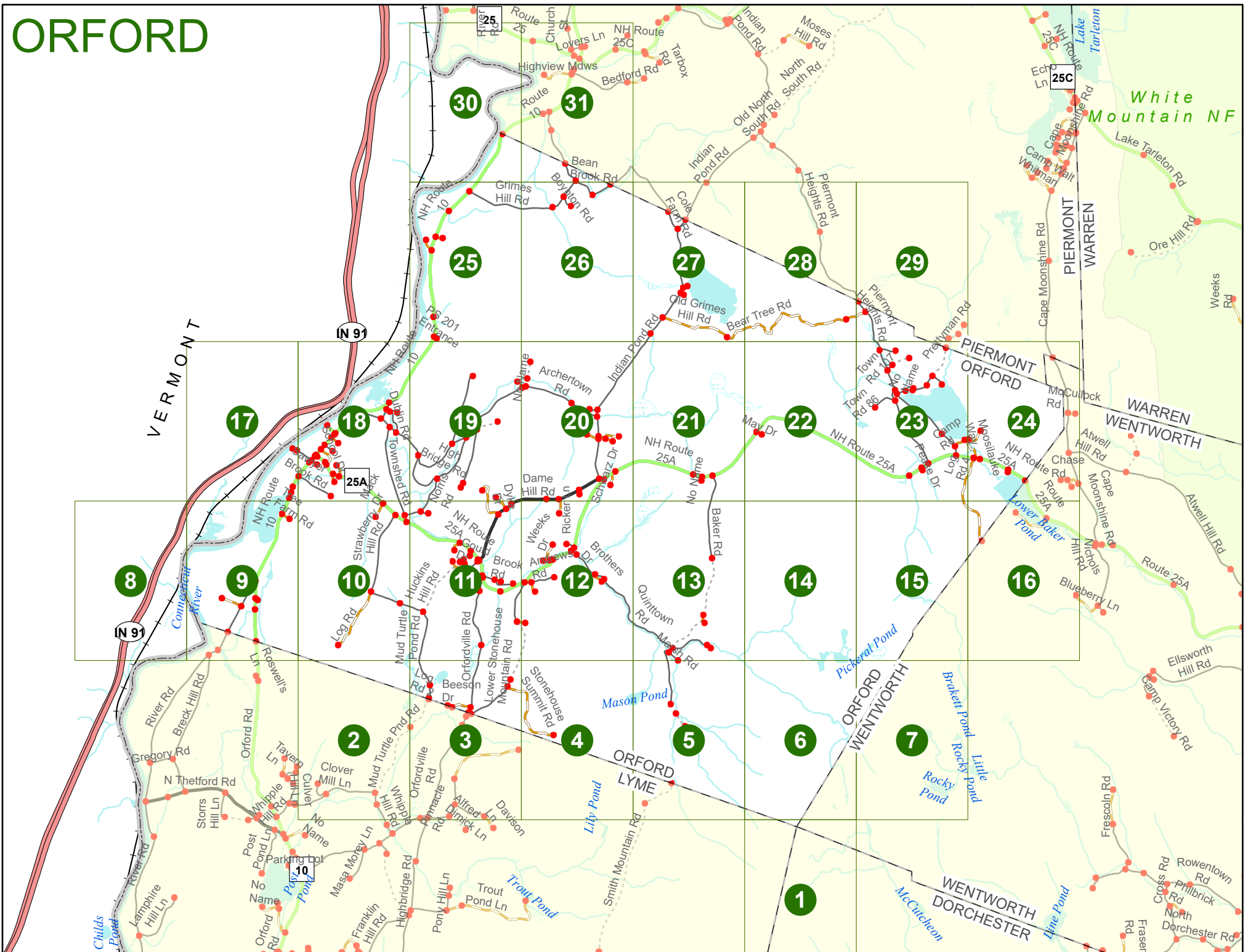

ORFORD

Match to Page 6

ORFORD
LYME

WENTWORTH
DORCHESTER

LYME
DORCHESTER

1

Match to Page 0

Match to Page 0

0 495 990 1,980 Feet

Match to Page 0

ORFORD

ORFORD
LYME

2

Match to Page 0

Match to Page 3

0130
0353
0352
Culver Hill Ln
0367

0116
Clover Mill Ln
0115

Whipple Hill Rd

0126

0369

Mud Turtle Pond Rd

Pinnacle Rd

0 495 990 1,980 Feet

Match to Page 0

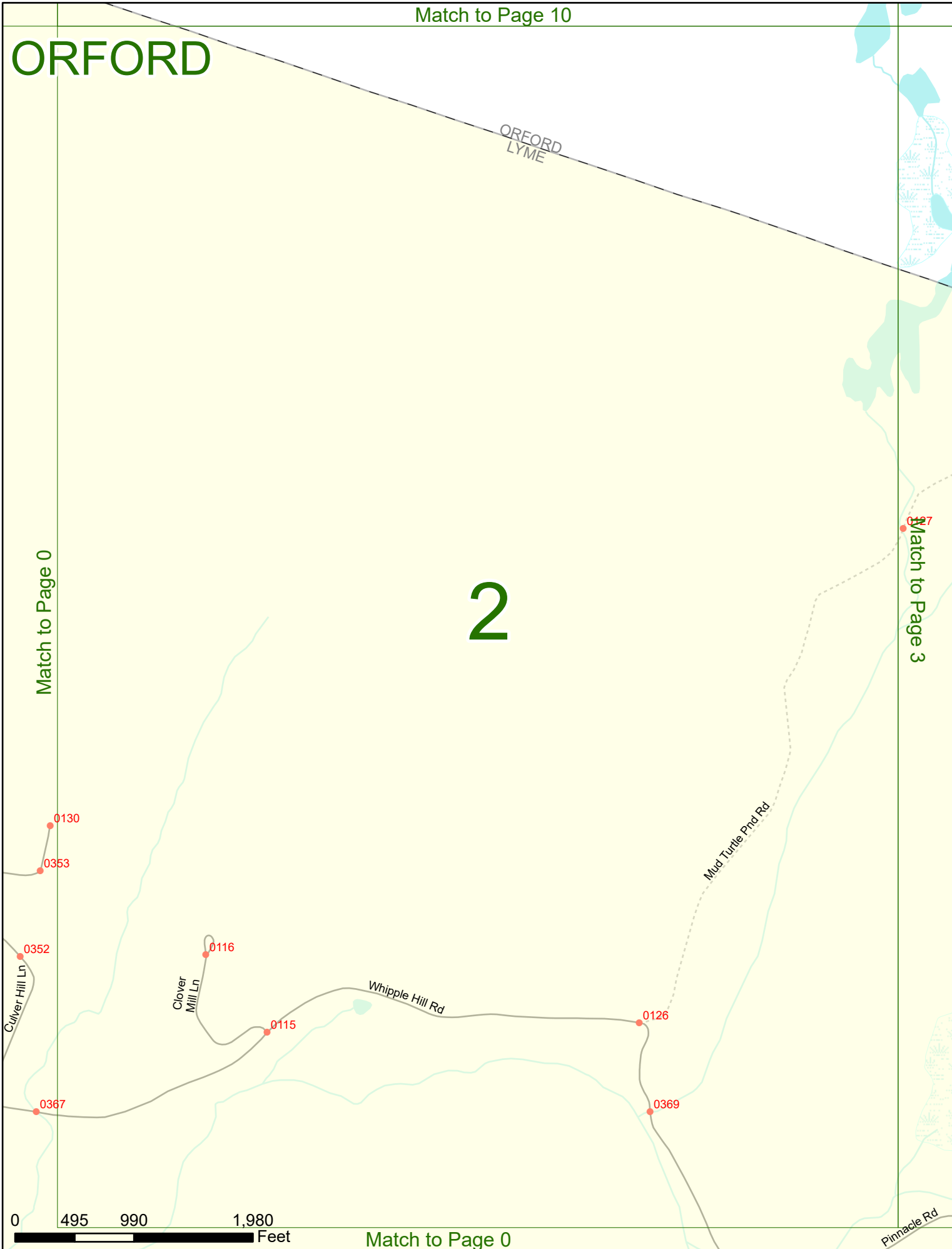

ORFORD

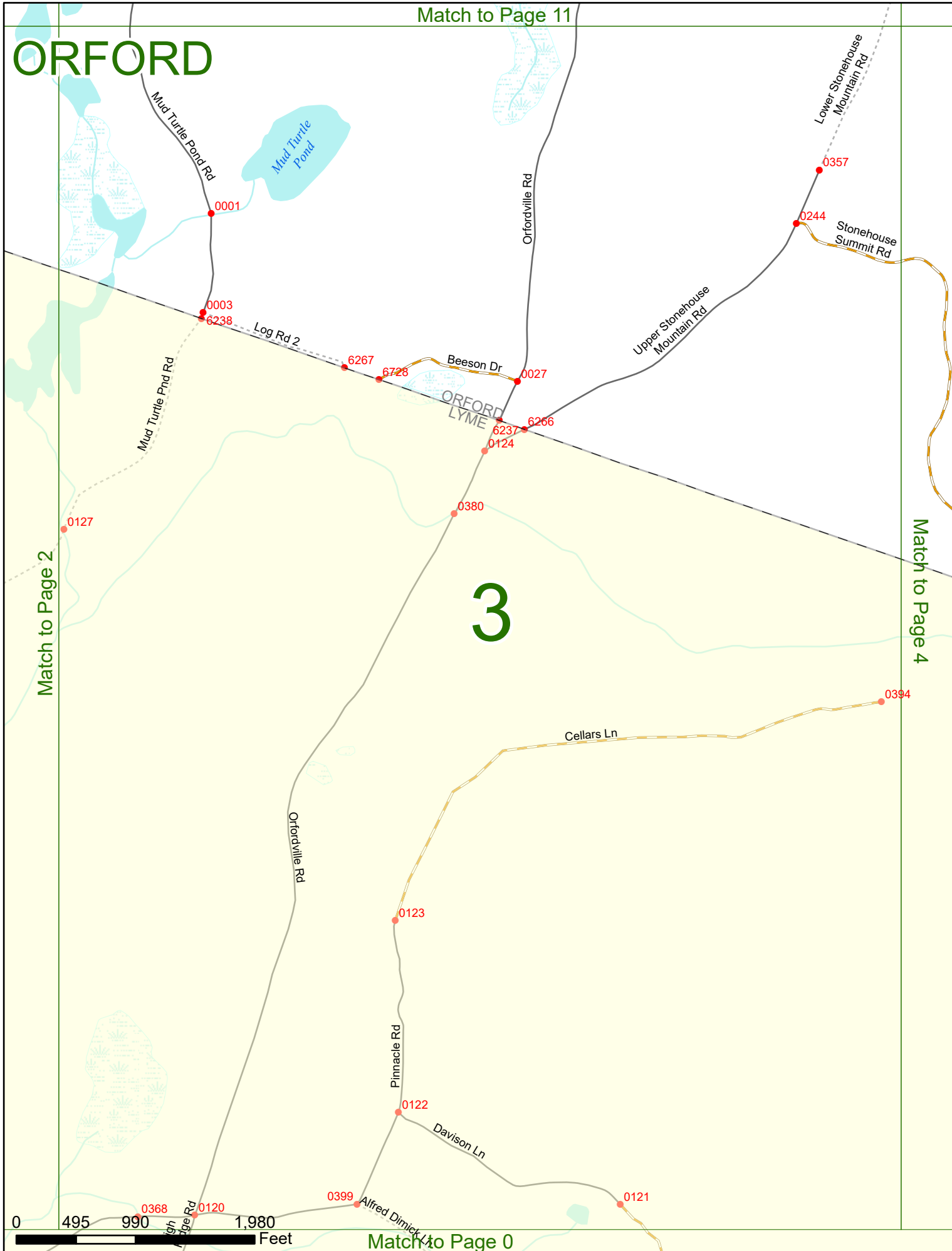

Match to Page 2

Match to Page 4

3

0 495 990 1,980 Feet

Match to Page 0

ORFORD

4

Mason Pond

Match to Page 5

Stonehouse Summit Rd

0328

ORFORD
LYME

Cellar Ln

0394

Lily Pond

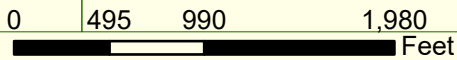

ORFORD

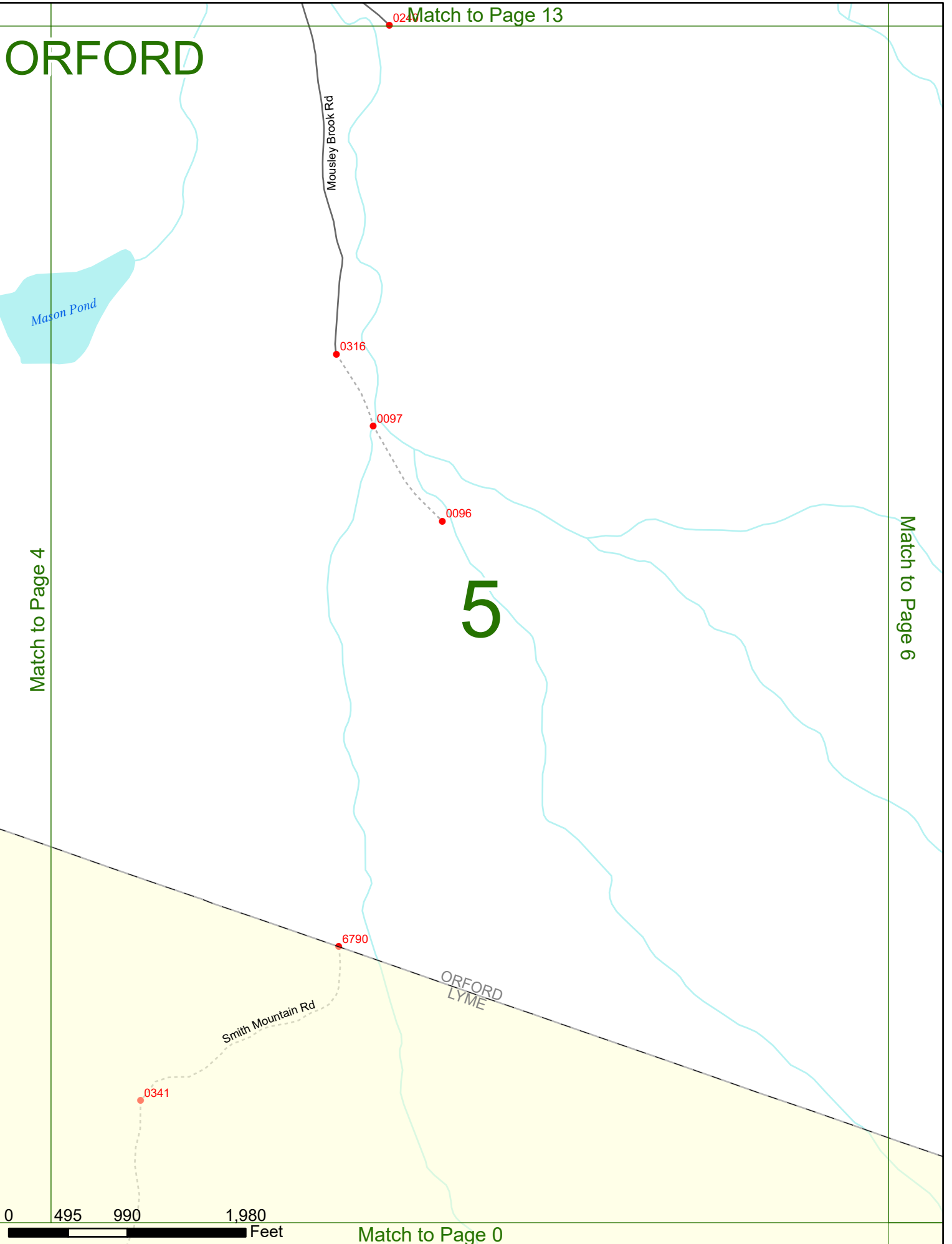

0 495 990 1,980 Feet

Match to Page 0

Match to Page 4

Match to Page 6

Match to Page 13

5

Match to Page 14

ORFORD

6

Match to Page 5

Match to Page 7

ORFORD
WENTWORTH

ORFORD
LYME

0 495 990 1,980 Feet

Match to Page 1

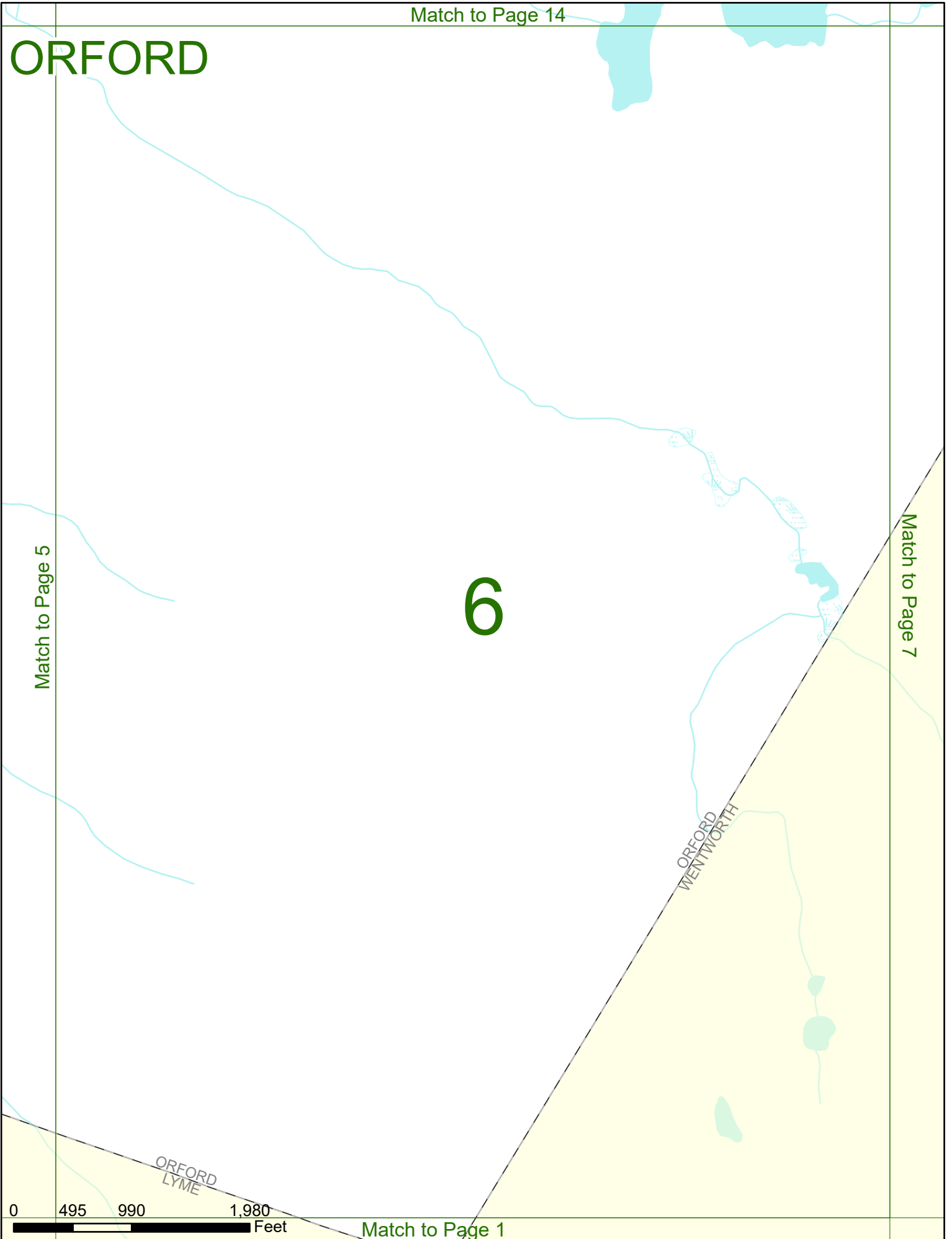

Match to Page 15

ORFORD

ORFORD
WENTWORTH

Match to Page 6

Match to Page 0

7

Bracket Pond

Little
Rocky Pond

Rocky Pond

0 495 990 1,980 Feet

Match to Page 0

ORFORD

Match to Page 0

VERMONT
08

N 91

N 91

Connecticut River

Match to Page 9

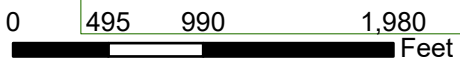

Match to Page 17

ORFORD

N 91
N 91

VERMONT

NH Route 10

0347 Tree Farm Rd 0348

9

Match to Page 8

Match to Page 10

0341 Sanborn Ln

0284 0285

0340

0006

10

6240

ORFORD LYME 6239

River Rd 0135

0136 Beech Hill Rd 4,980

Orford Rd

0 495 990 Feet

Match to Page 0

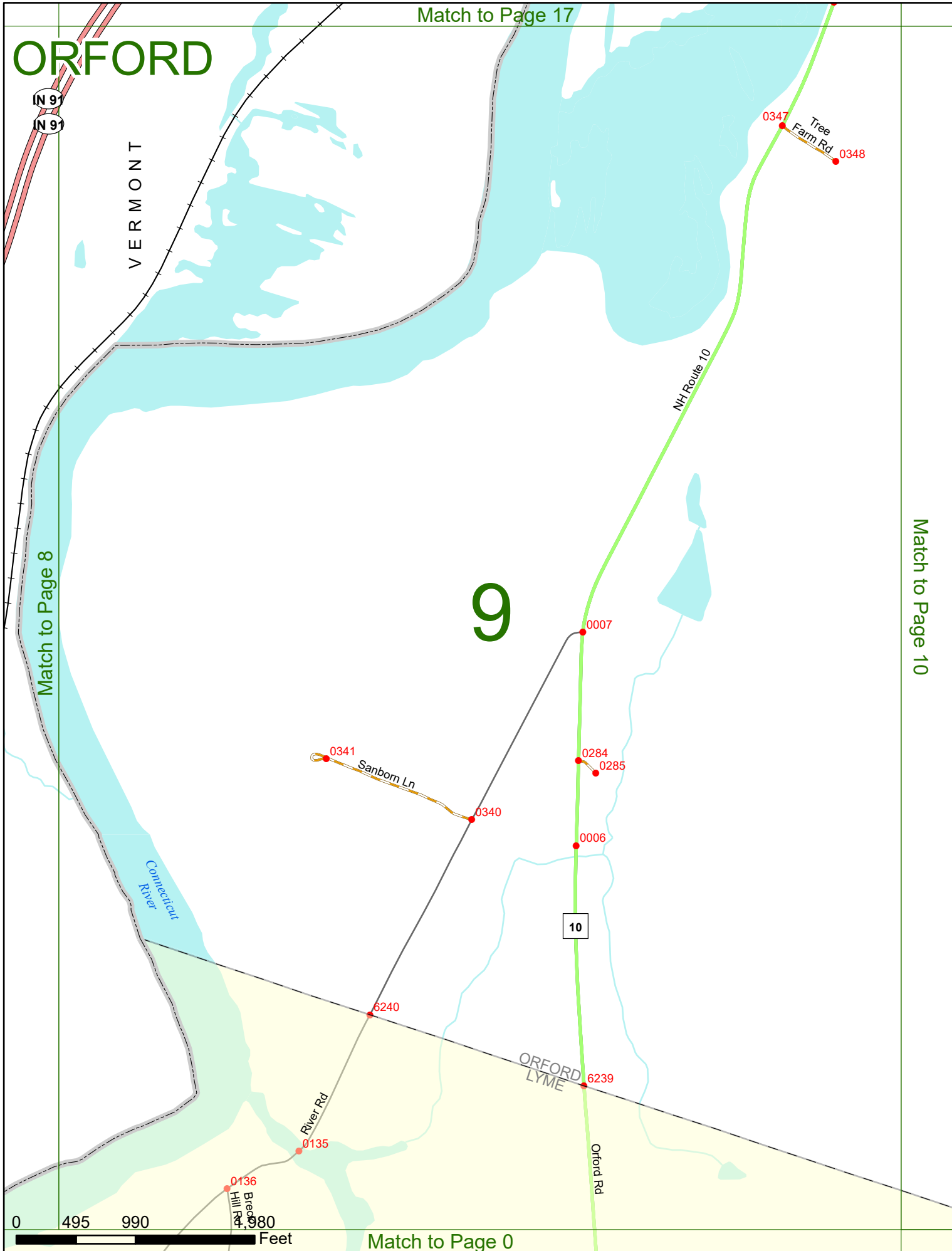

ORFORD

Match to Page 9

Match to Page 11

10

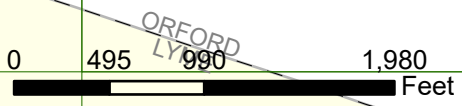
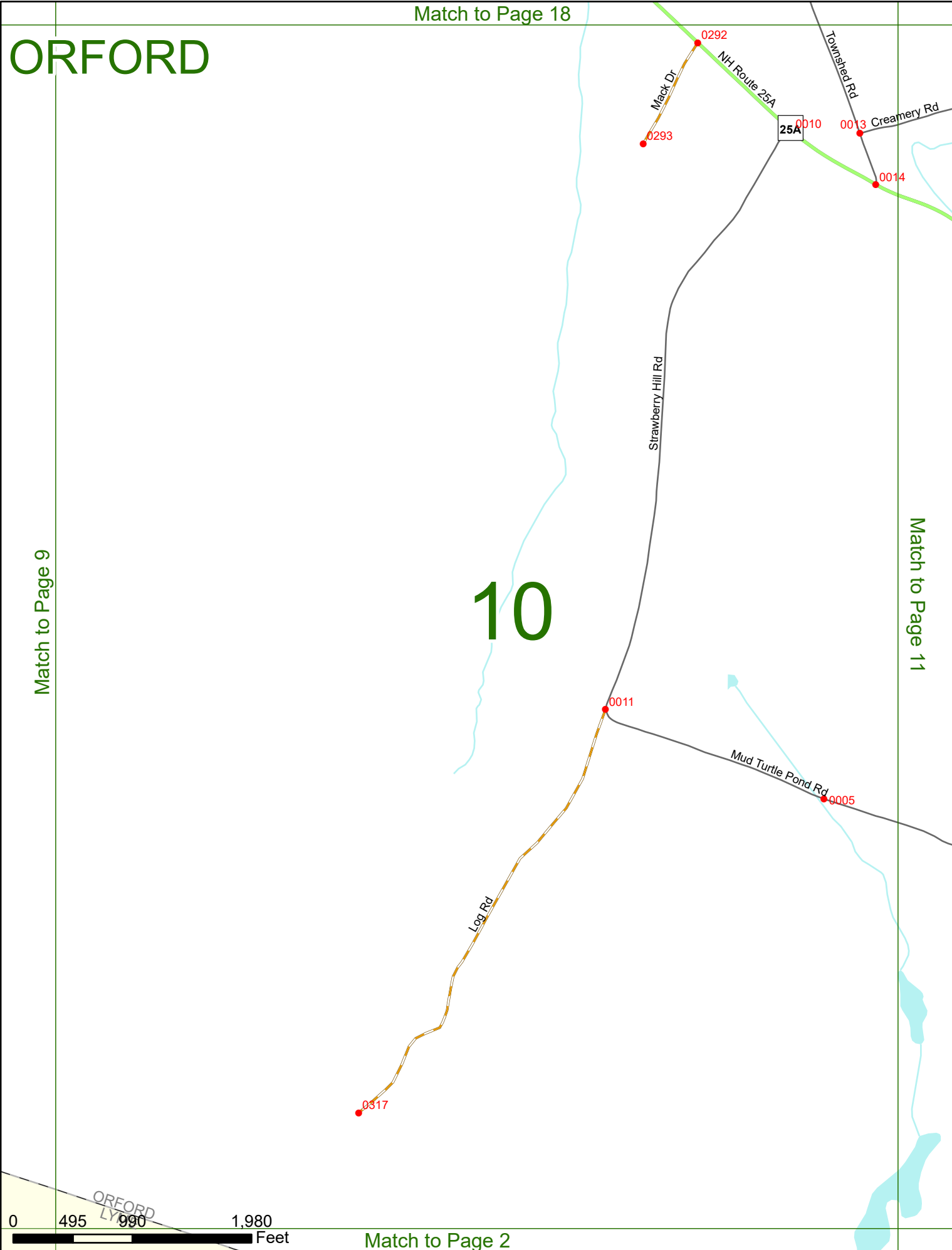

Match to Page 19

ORFORD

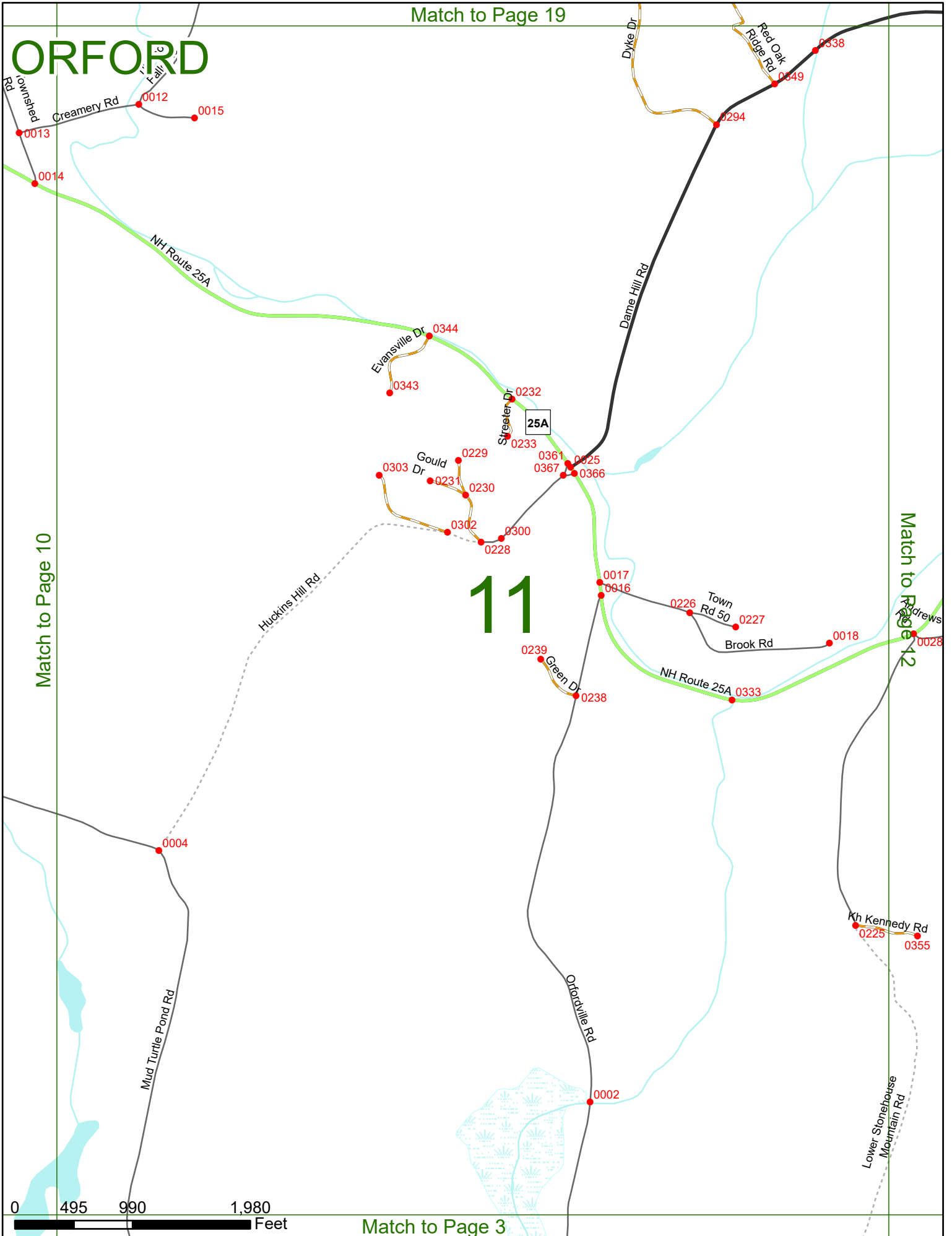

Match to Page 10

Match to Page 12

11

0 495 990 1,980 Feet

Match to Page 3

ORFORD

Match to Page 20

12

Match to Page 13

Match to Page 11

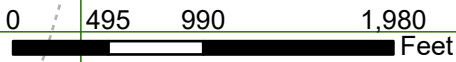
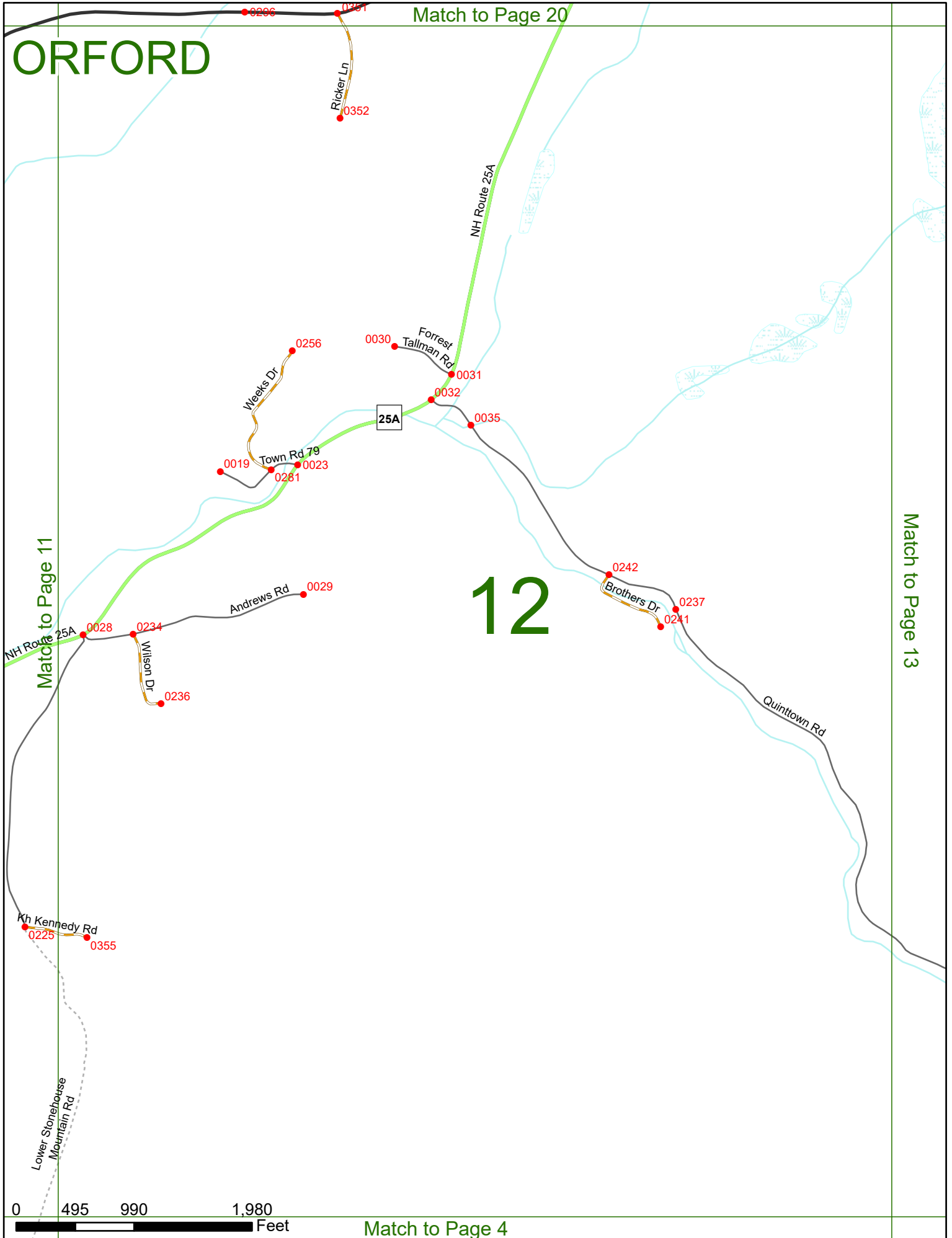

Match to Page 4

Match to Page 21

ORFORD

Match to Page 12

Match to Page 14

13

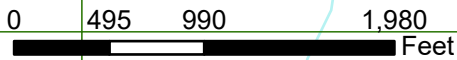
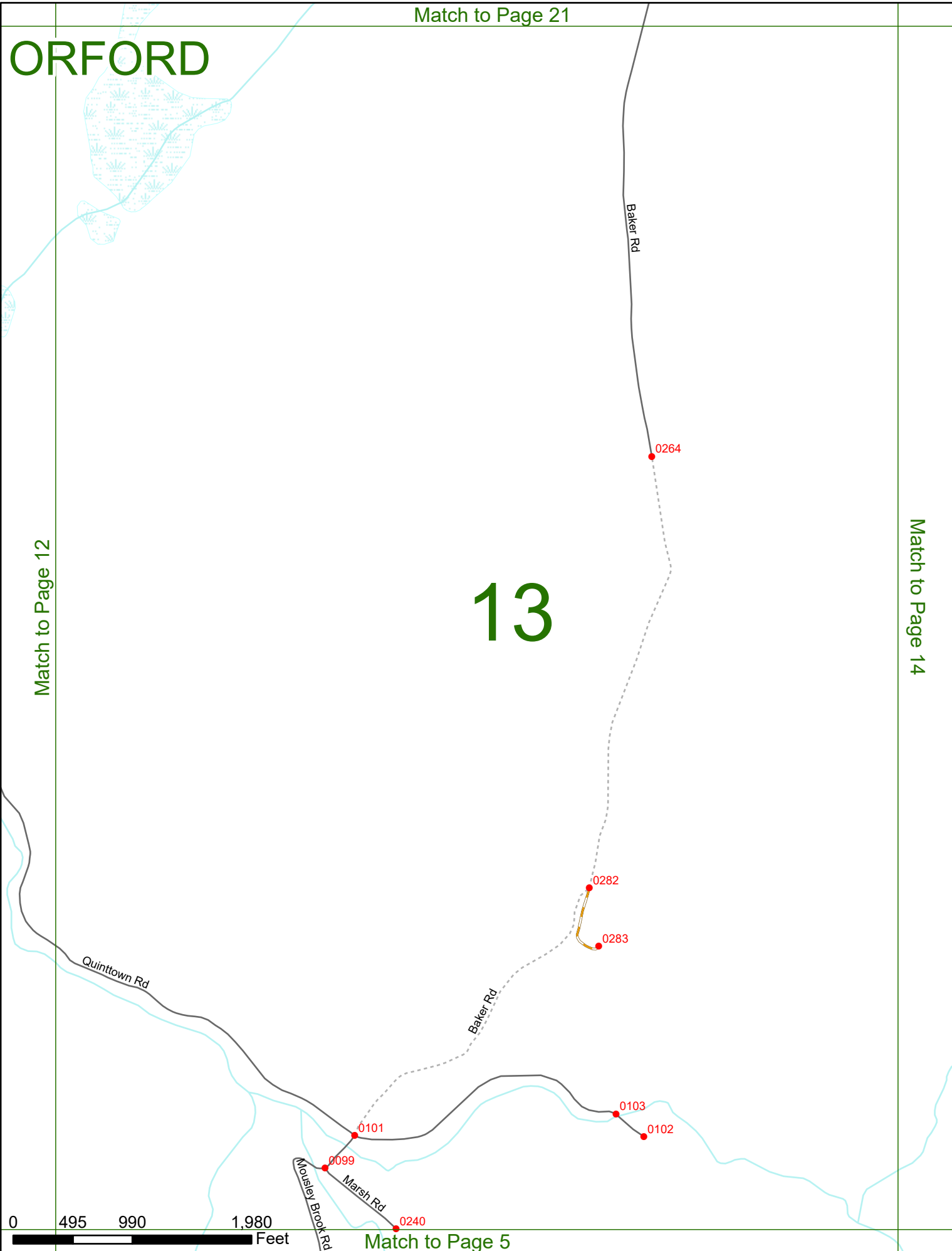

Match to Page 5

ORFORD

Match to Page 13

Match to Page 15

14

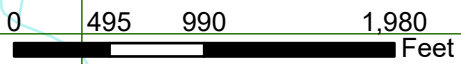

Match to Page 6

Pickeral Pond

Match to Page 23

ORFORD

Log Rd 4

Match to Page 14

15

Match to Page 16

ORFORD
WENTWORTH

Pickeral Pond

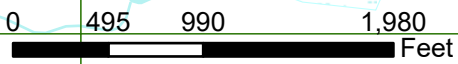

Match to Page 7

ORFORD

Match to Page 24

0230

Camp Pemigewasset Rd

0229

25A

Route 25A

Log Rd 4

ORFORD
WENTWORTH

0322

16

Match to Page 15

Match to Page 0

0228

Blueberry Ln

0 495 990 1,980 Feet

Match to Page 0

ORFORD

Match to Page 0

VERMONT

17

Match to Page 18

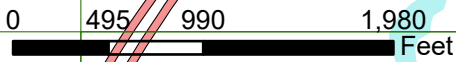

Match to Page 9

N 91

N 91

Connecticut River

0331 Boat Landing Rd
0086

0008 Sawyer Brook Rd

10
NH Route 10
0335
0287
0286

ORFORD

VERMONT

18

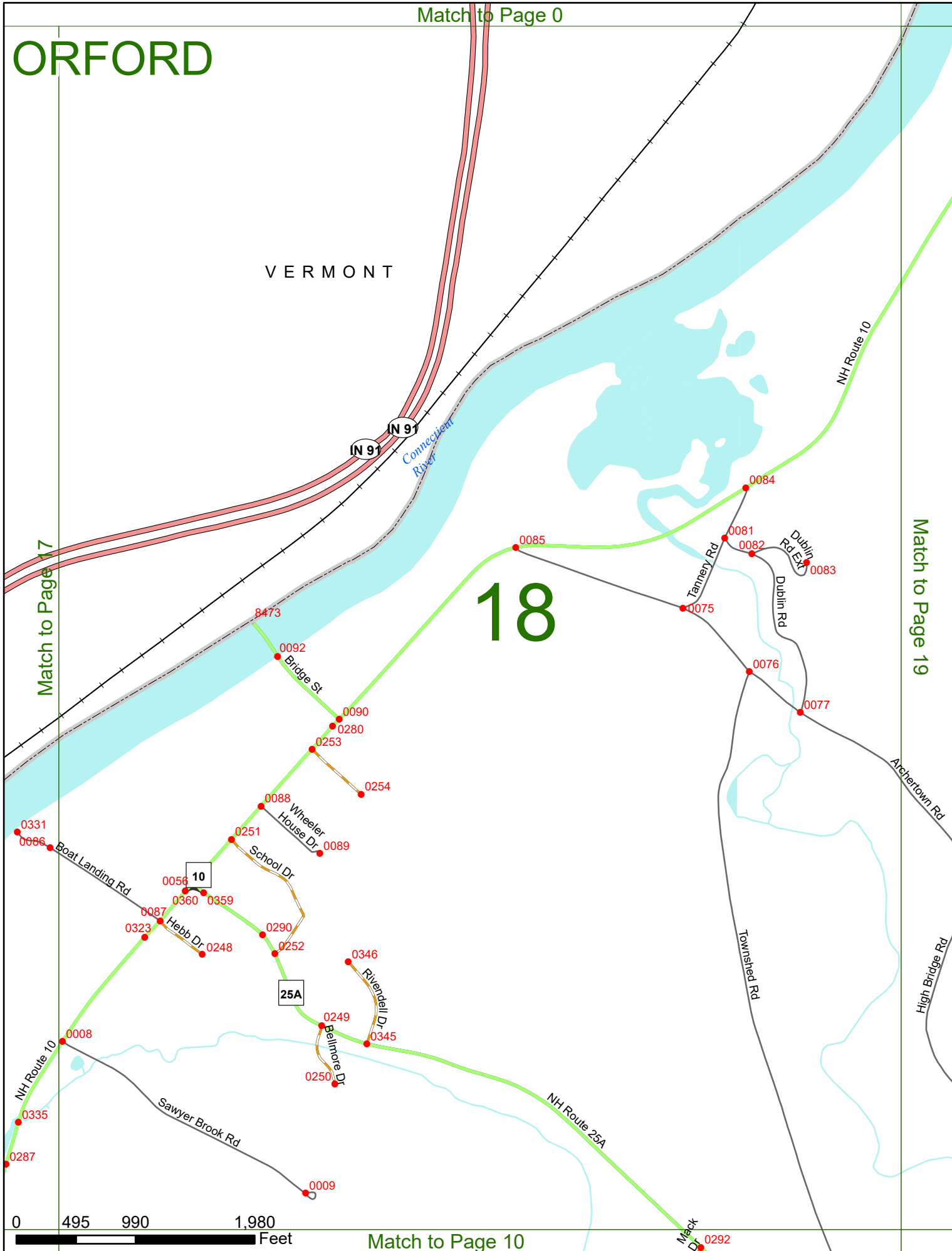

Match to Page 17

Match to Page 19

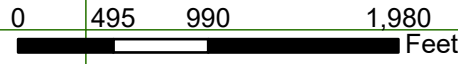

ORFORD

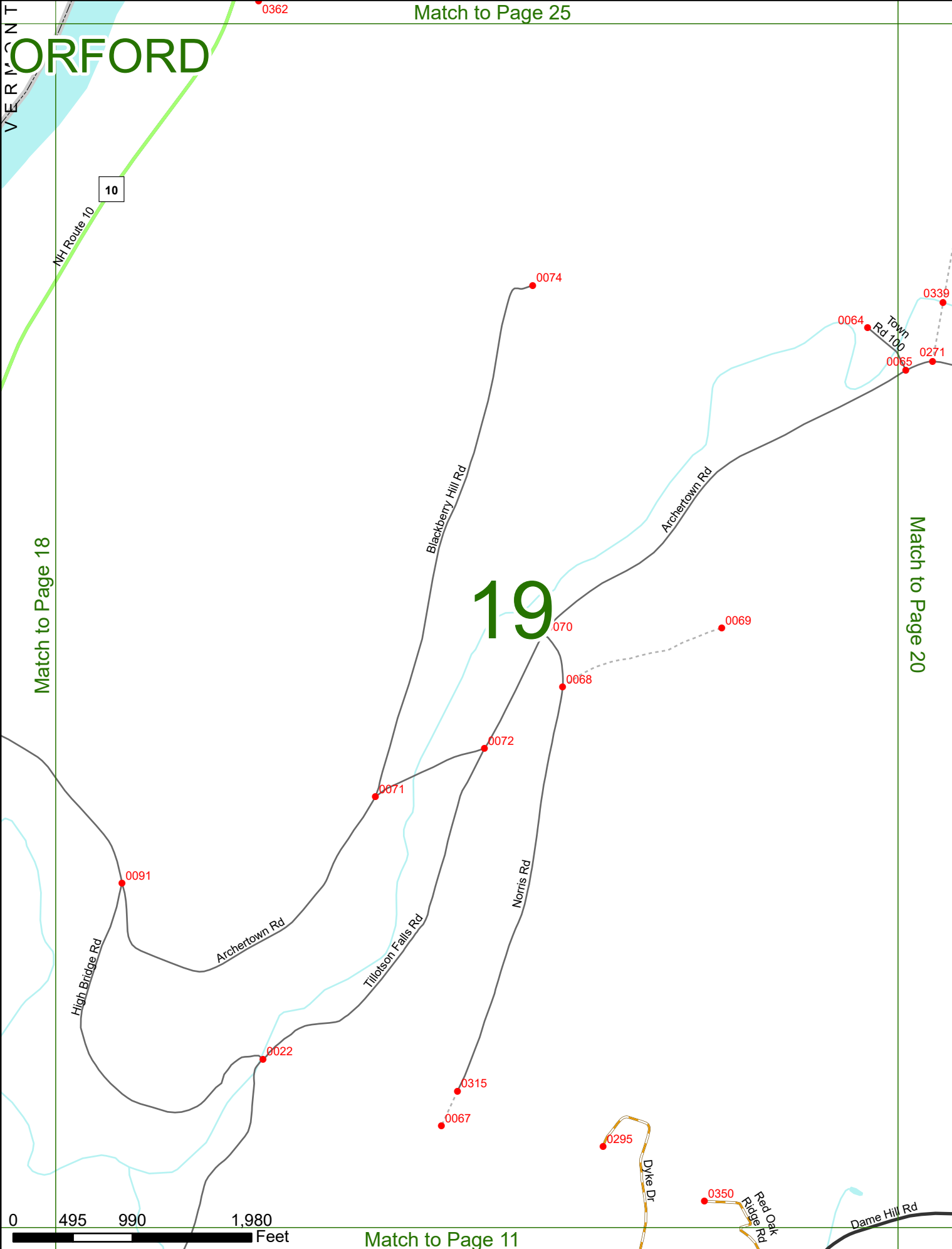

Match to Page 18

Match to Page 20

19

0 495 990 1,980 Feet

Match to Page 11

ORFORD

20

Match to Page 19

Match to Page 21

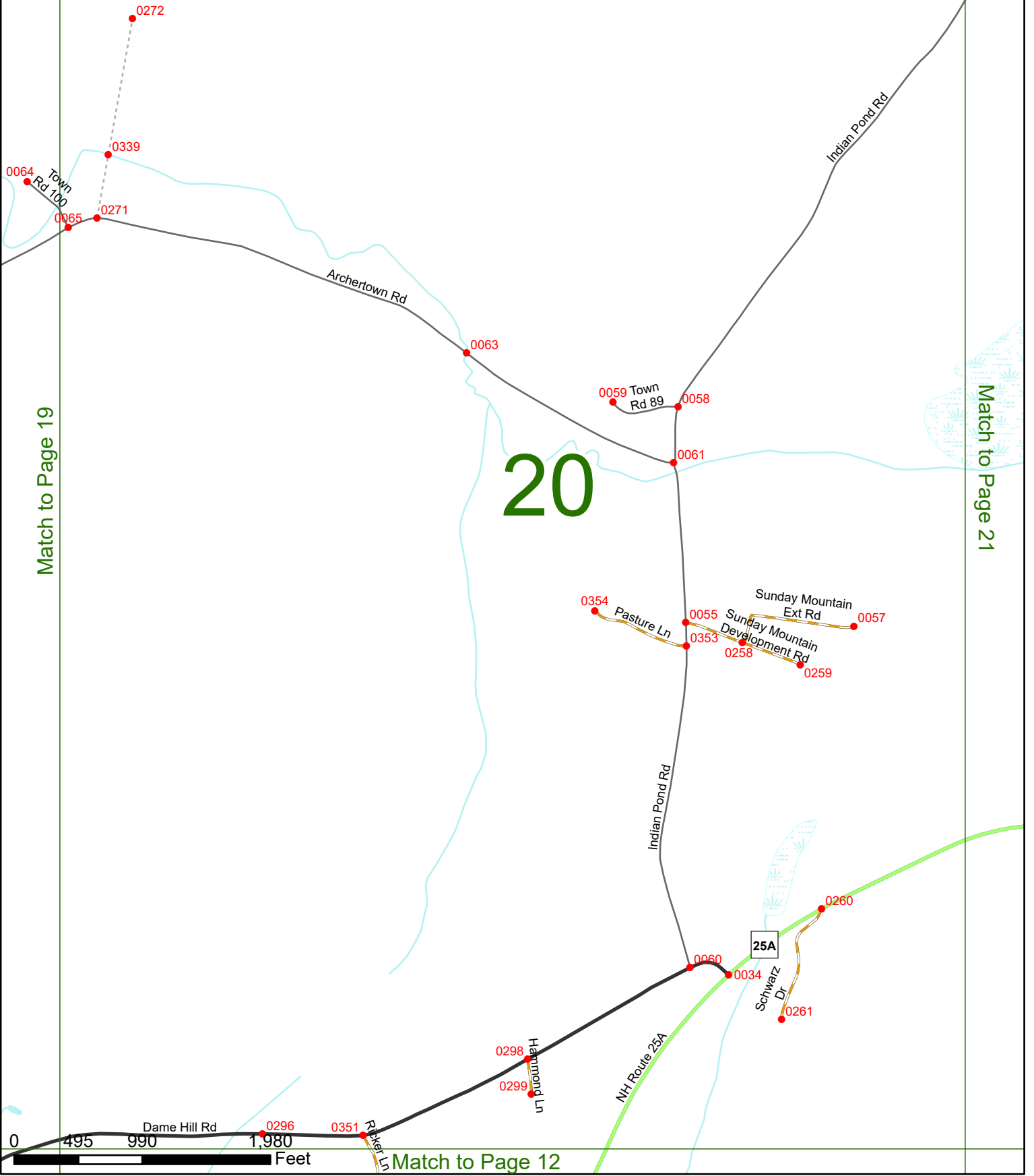

ORFORD

Indian Pond Rd

Match to Page 20

Match to Page 22

21

NH Route 25A

0054

25A

0262

0263

0053

Baker Rd

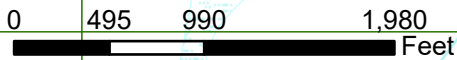

ORFORD

Match to Page 21

Match to Page 23

22

25A

NH Route 25A

0265 May Dr 0266

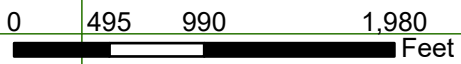

Match to Page 29

ORFORD

PIERMONT
ORFORD

0104 Town Rd 85 0105

0106
Town Rd 107

0048
0047
Piermont Heights Rd

0039
0040
Upper Baker Pond Beach Rd

0044
0043
0337
0309
0308

0046
Town Rd 86
0045

Upper Baker Pond Rd

23

East Cemetery Rd

0305
0304
0365
0330
Camp Rd
Mooslaube Way

0041
0329
0364
NH Route 25A

0267
0268
Pasee Dr

25A

NH Route 25A

0050

Log Rd 4

Match to Page 22

Match to Page 24

0 495 990 1,980 Feet

Match to Page 15

ORFORD

24

Match to Page 0

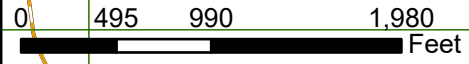
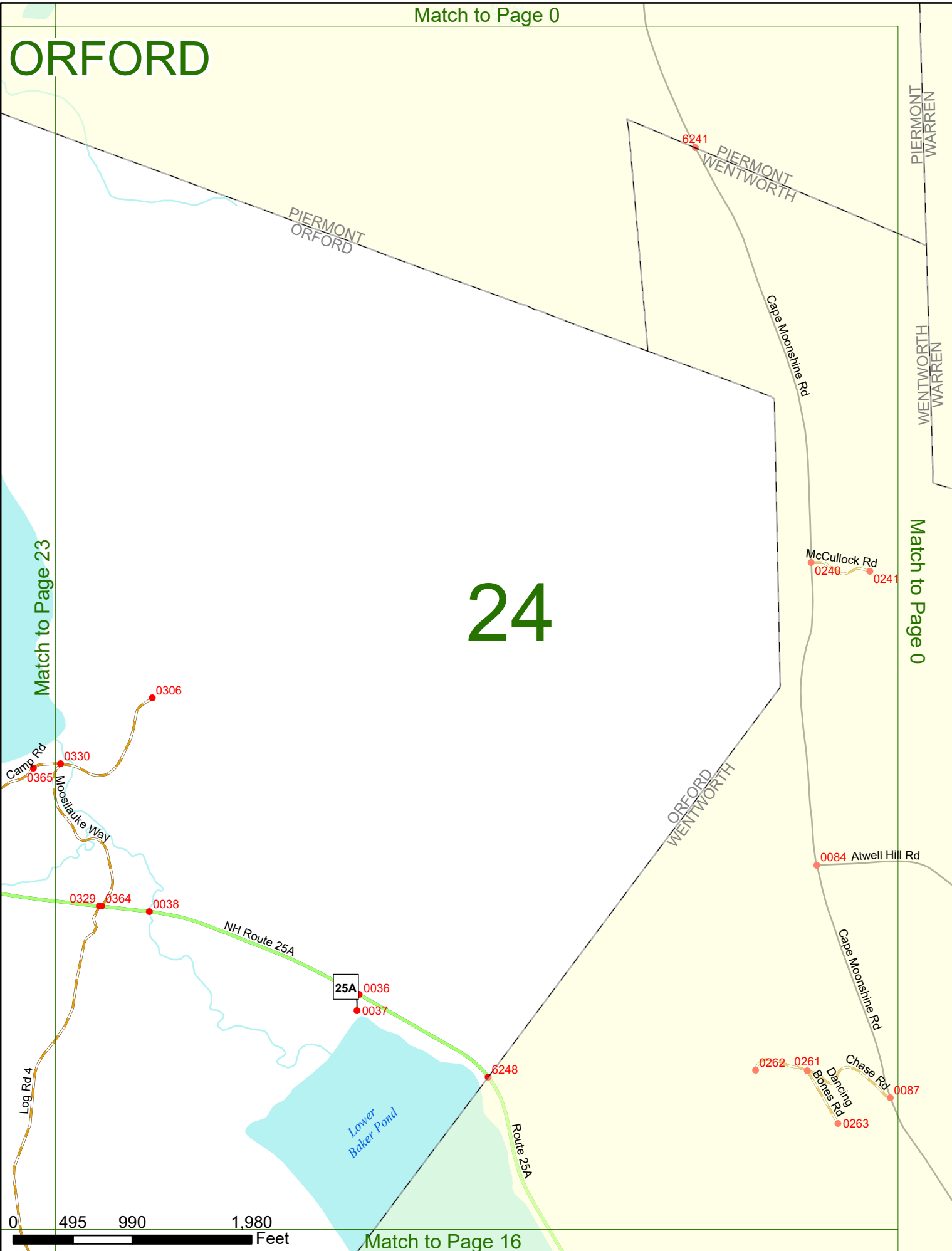

Match to Page 16

ORFORD

Match to Page 30

VERMONT

25

Match to Page 26

Match to Page 0

Connecticut River

NH Route 10

Grimes Hill Rd

Cottonstone Farm Ln

River Cottage Ln

NH Route 10

10

PS 201 Entrance

0 495 990 Feet

Match to Page 19

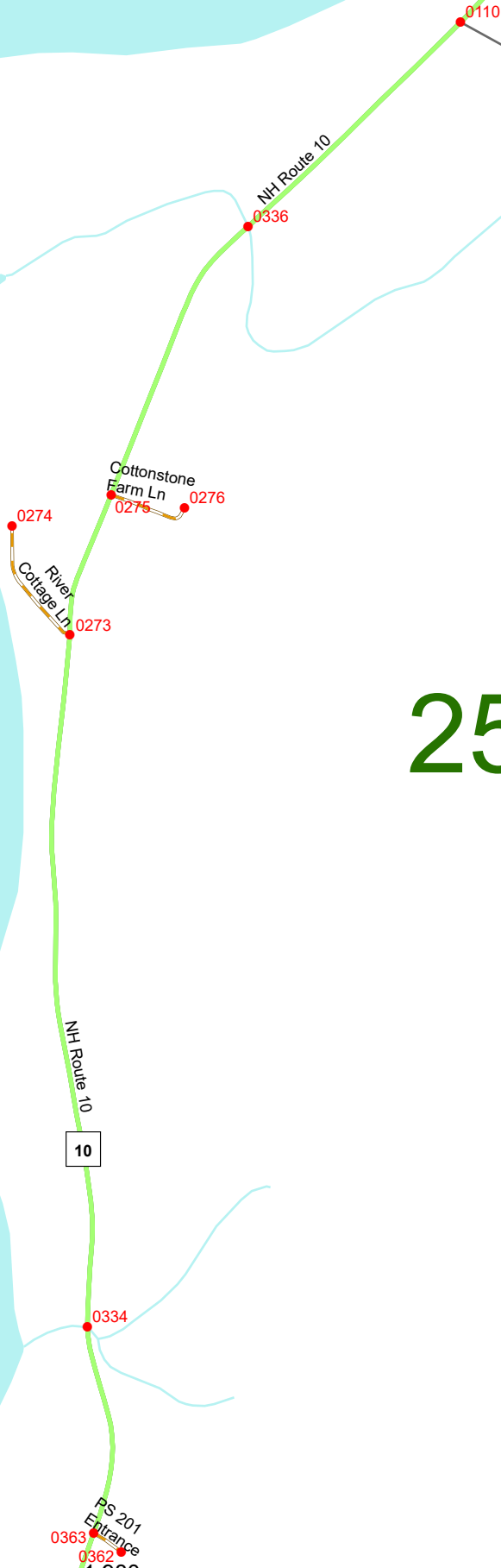

ORFORD

Match to Page 31

PIERMONT
ORFORD

Bean Brook Rd

0277
Borlon Rd

Grimes Hill Rd

0109

0278

0107

6263

26

Match to Page 25

Match to Page 27

0 495 990 1,980 Feet

Match to Page 20

Match to Page 0

ORFORD

Bean Brook Rd

0007

6268

Cole Farm Rd

6269

PIERMONT
ORFORD

0112

Indian Pond Rd

27

Match to Page 28

Match to Page 26



Indian Pond
Beach Rd

0094

0093

0312

Post Ln

0313

Indian Pond

0270

Old Grimes Hill Rd

0332

Bear Tree Rd

0327

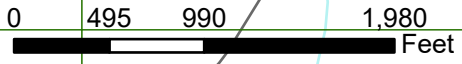

Match to Page 21

Match to Page 0

ORFORD

28

Match to Page 27

Match to Page 29

PIERMONT
ORFORD

Piermont Heights Rd

Bear Tree Rd

0205

6265

0324

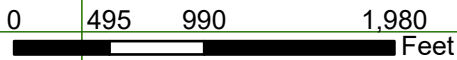

Match to Page 22



ORFORD

29

Match to Page 28

Match to Page 0

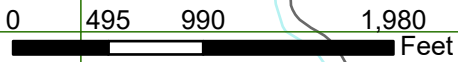
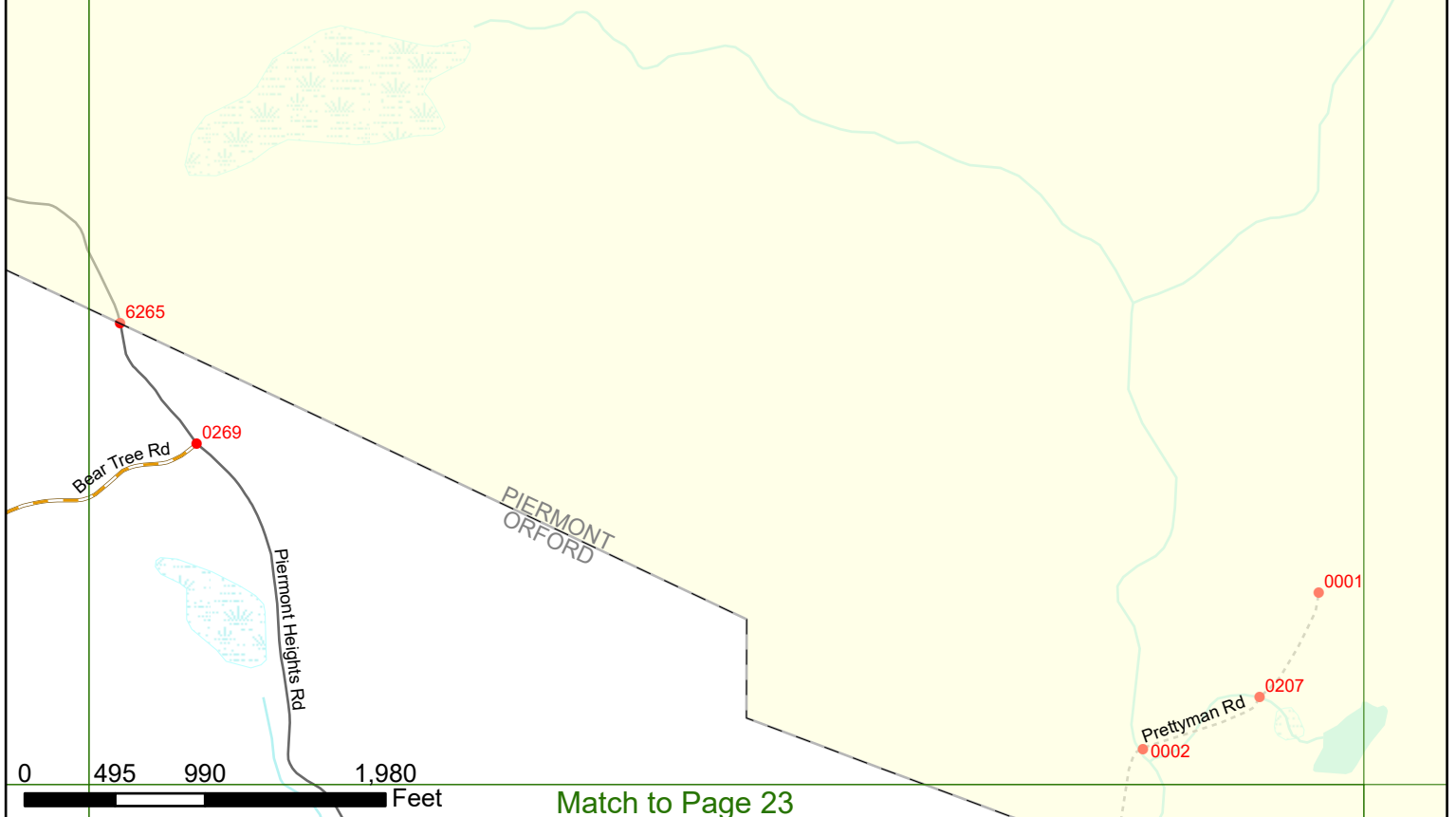

Match to Page 23

ORFORD

Match to Page 0

Route 25

25

Connecticut River

Match to Page 0

VERMONT

30

Match to Page 31

Route 10

6261

10

NH Route 10

0 495 990 1,980 Feet

Match to Page 25

ORFORD

Match to Page 0

VERMONT

Match to Page 30

Match to Page 0

31

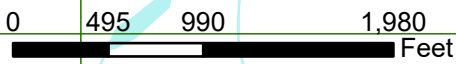

Match to Page 26

