



Maps and data sets are not guaranteed to be free from errors and omissions. Data is in a constant state of update and correction by various groups and agencies. Information displayed on this map is the best available at the time of publication.

2025 Nodal Reference Bookmap

LEGEND



NHDOT will accept crash locations based on the State of NH Uniform Police Traffic Accident Report.

Crash occurred on:

Option 1 Street Address
 123 Main Street

Option 2 Route No and/or Distance from NESW Intesecting Road, Bridge,
 Street name Intersecting Street Town/County line
 Main Street 500 E Oak Street

Option 3 First Node Distance from First Node Second Node
 515 212 632

Option 4 Route No and/or Mile Marker on Interstate Only NESW Mile (Marker)
 Street name
 189S 700 feet S 36.8

Option 3 – Example

Street Name Loudon Road
First Node 803
Distance from First Node 318 Ft
Second Node 813



NORTHUMBERLAND

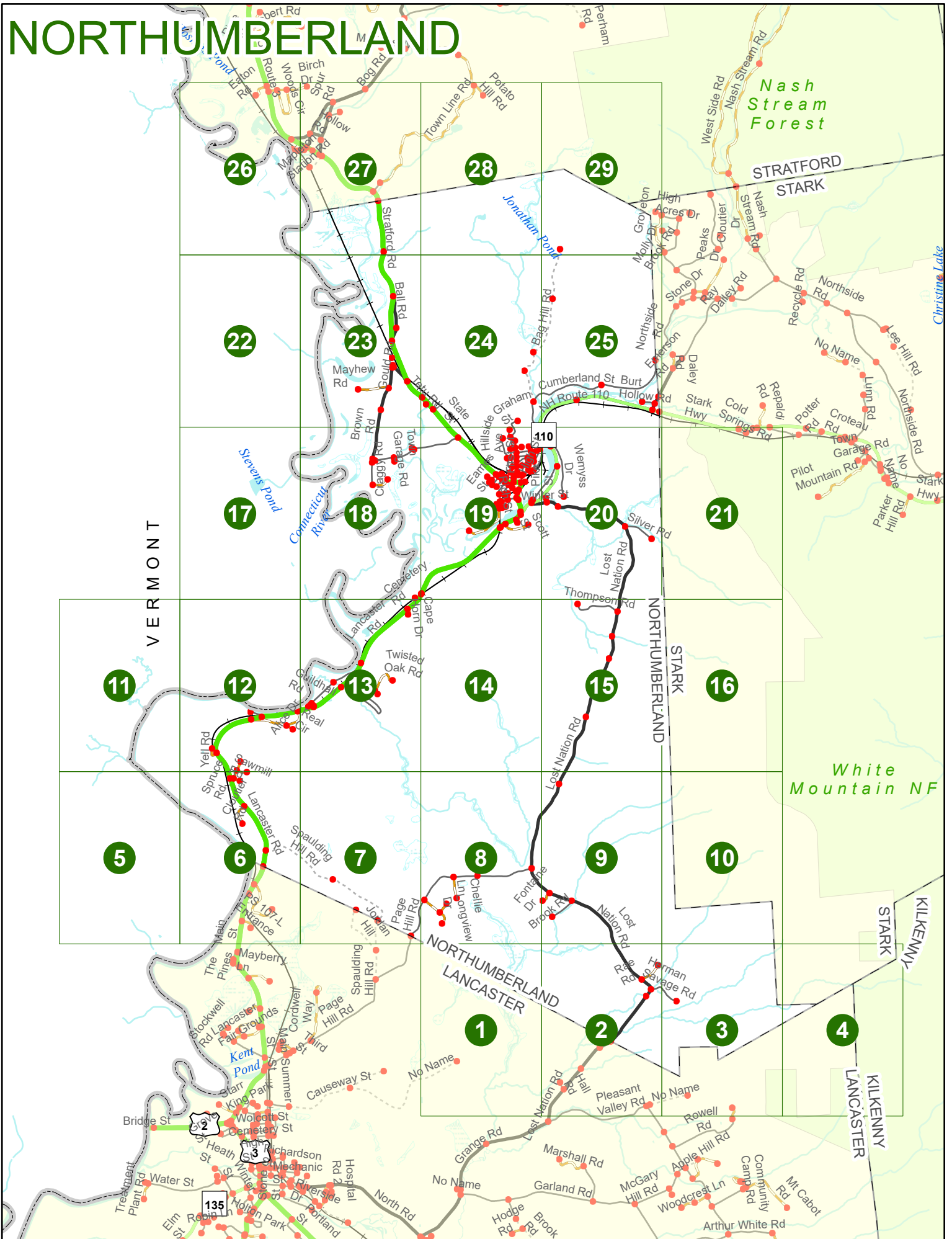

NORTHUMBERLAND

NORTHUMBERLAND
LANCASTER

1

Match to Page 0

Match to Page 2

0136

0 495 990 1,980 Feet

Match to Page 0

Lost
Nation Rd

Match to Page 9

NORTHUMBERLAND

Match to Page 1

NORTHUMBERLAND
LANCASTER

2

Match to Page 3

Rae Rd
0223
0222

0002
Herman
Salvage Rd

Lost Nation Rd

Greene Rd
0209
0208
0252

0267

0139
Hall Rd
0138

Lost Nation Rd

Abandoned
Town Rd
0222
0140

Pleasant Valley Rd

0 495 990 1,980 Feet

Match to Page 0

NORTHUMBERLAND

Rae Rd
0222

Herran Savage Rd
0001

STARK
NORTHUMBERLAND

Match to Page 2

3

Match to Page 4

NORTHUMBERLAND
LANCASTER

White
Mountain NF

0141

0207

Rowell Rd

0144

0 495 990 1,980 Feet

Match to Page 0

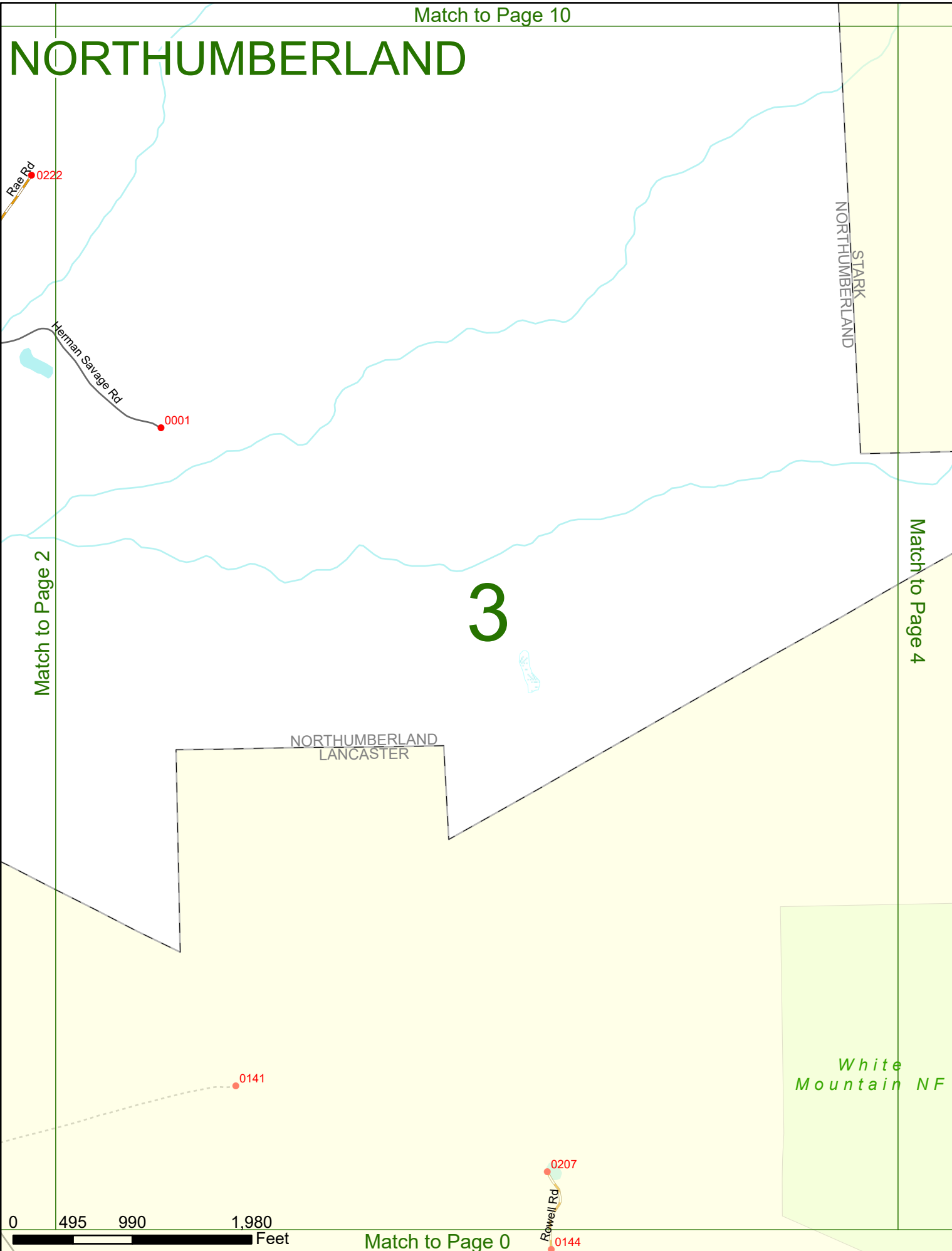

Match to Page 0

NORTHUMBERLAND

STARK
KILKENNY

STARK
LANCASTER

STARK
NORTHUMBERLAND

NORTHUMBERLAND
LANCASTER

4

*White
Mountain NF*

Match to Page 3

Match to Page 0

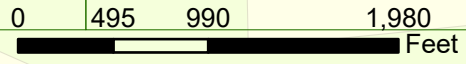

Match to Page 0

Match to Page 11

NORTHUMBERLAND

Connecticut River

Match to Page 0

VERMONT **5**

Match to Page 6

0 495 990 1,980 Feet

Match to Page 0

NORTHUMBERLAND

Match to Page 12

Match to Page 5

Match to Page 7

VERMONT

6

Connecticut River

3

Cloutier Rd

Lancaster Rd

Spaulding Hill Rd

NORTHUMBERLAND
LANCASTER

Main St

Industrial
Park Rd

PS 107-L
Entrance

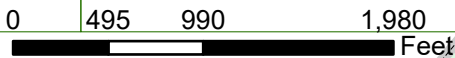

Match to Page 0

0174
Spice
Rd 01742

0141
Spaulding Hill
Rd 0159

0161

0150

0003

6248

0296

0260

0297

0316

0315

NORTHUMBERLAND

7

Match to Page 6

Match to Page 8

0004

Spaulding Hill Rd

6249

NORTHUMBERLAND
LANCASTER

6250

Jordan Hill

6251

0175

Page Hill Rd

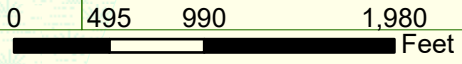

Match to Page 0

NORTHUMBERLAND

8

Match to Page 7

Match to Page 9

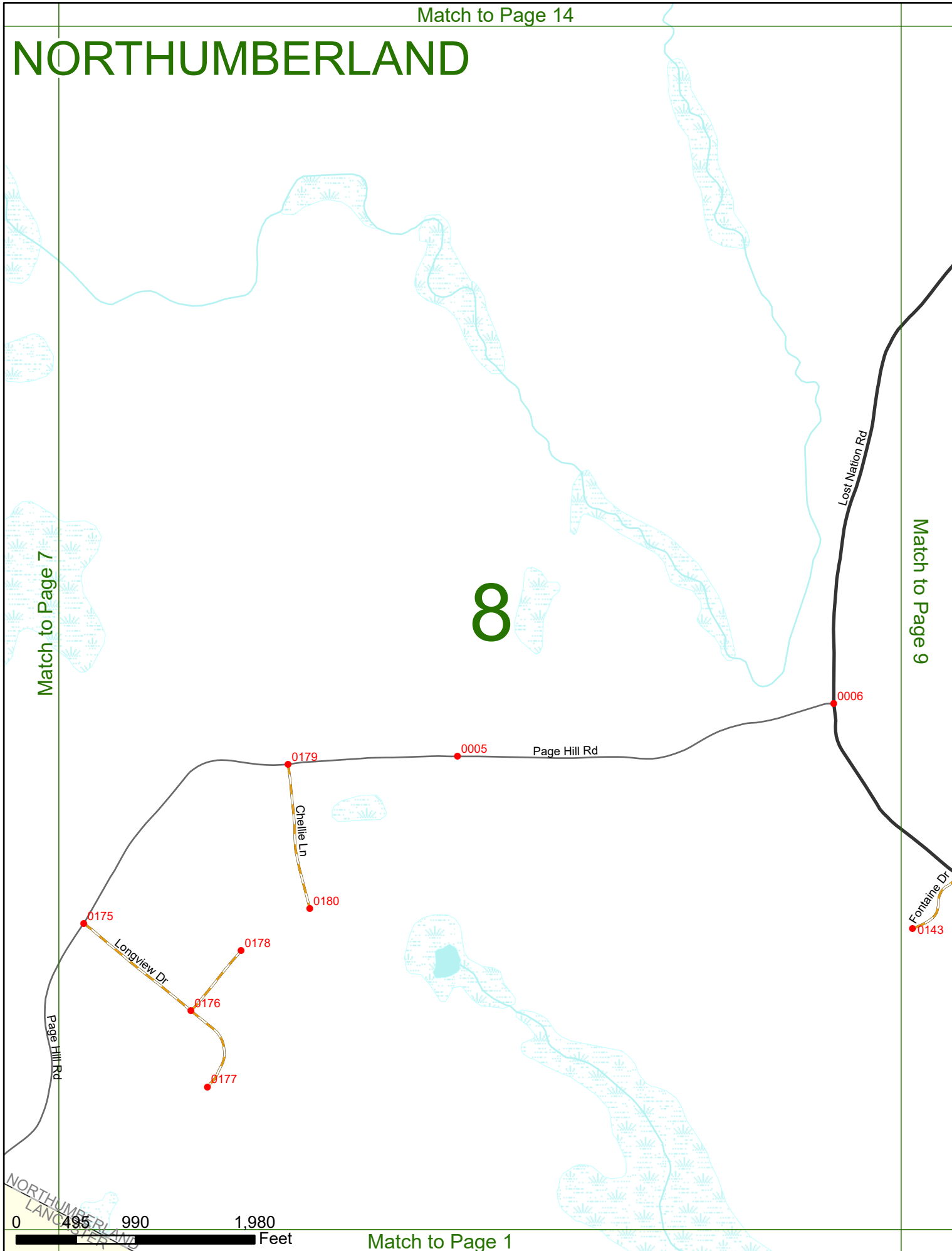

NORTHUMBERLAND
 LANCASHIRE
 YORKSHIRE



Match to Page 1

NORTHUMBERLAND

9

Match to Page 8

Match to Page 10

0127

Lost Nation Rd

0144

0143

Fontaine D

0008

Brook Rd

0007

Lost Nation Rd

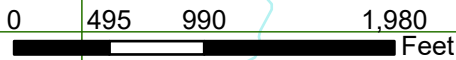

Match to Page 2

Match to Page 16

NORTHUMBERLAND

*White
Mountain NF*

Match to Page 9

Match to Page 0

10

STARK
NORTHUMBERLAND

0 495 990 1,980 Feet

Match to Page 3

NORTHUMBERLAND

Match to Page 0

Match to Page 12

VERMONT

11

Connecticut River

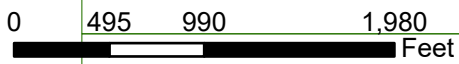

Match to Page 5

NORTHUMBERLAND

VERMONT

12

Match to Page 11

Match to Page 13

Connecticut River

8753

Lancaster Rd

0193 Perras Rd

0192

0218

Alice Dr

0220

Real Cir

0221

Lancaster Rd

3

0216

0217

Yell Rd

0172

0171

Spruce Rd

0142

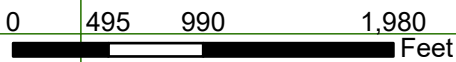

Match to Page 6

NORTHUMBERLAND

VERMONT

Match to Page 12

Match to Page 14

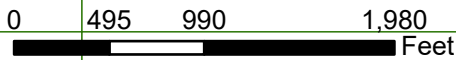
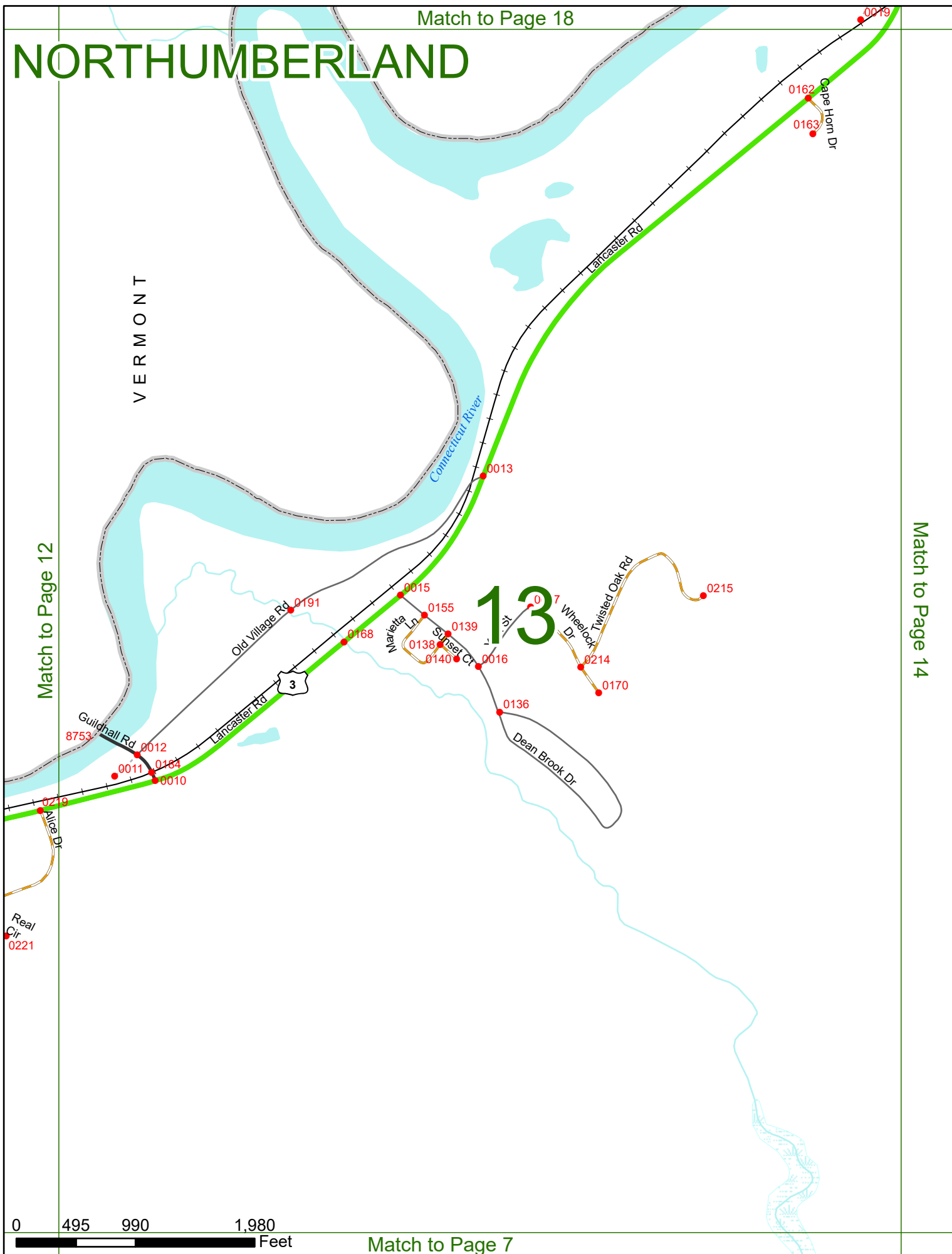



NORTHUMBERLAND

Match to Page 13

Match to Page 15

14

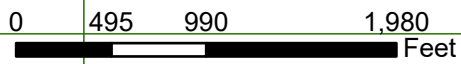

Match to Page 8

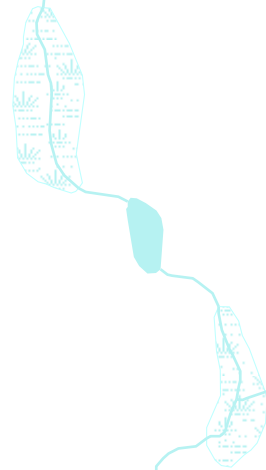

Match to Page 20

NORTHUMBERLAND

Lost Nation Rd

0020

0125

0126

15

Lost Nation Rd

0128

Match to Page 14

STARK
NORTHUMBERLAND
Match to Page 16

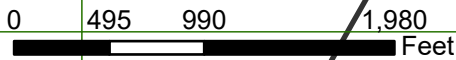

Match to Page 9

Match to Page 21

NORTHUMBERLAND

16

Match to Page 15

STARK
NORTHUMBERLAND

Match to Page 0

*White
Mountain NF*

0 495 990 1,980 Feet

Match to Page 10

NORTHUMBERLAND

Match to Page 0

VERMONT
17

Match to Page 18

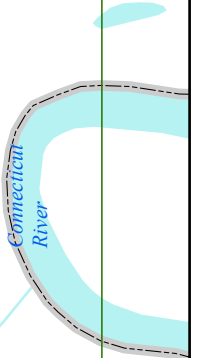

NORTHUMBERLAND

Match to Page 17

Match to Page 19

VERMONT

18

Connecticut River

Brown Rd

PS 104 Entrance

0092
0091
0089

0156
0157
Town Garage Rd

0190
0189

Craggy Rd

0173

0088 Hidden Acres

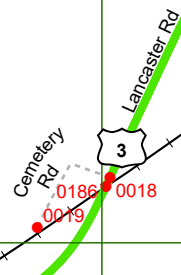
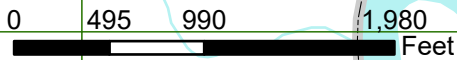

Match to Page 24

NORTHUMBERLAND

19

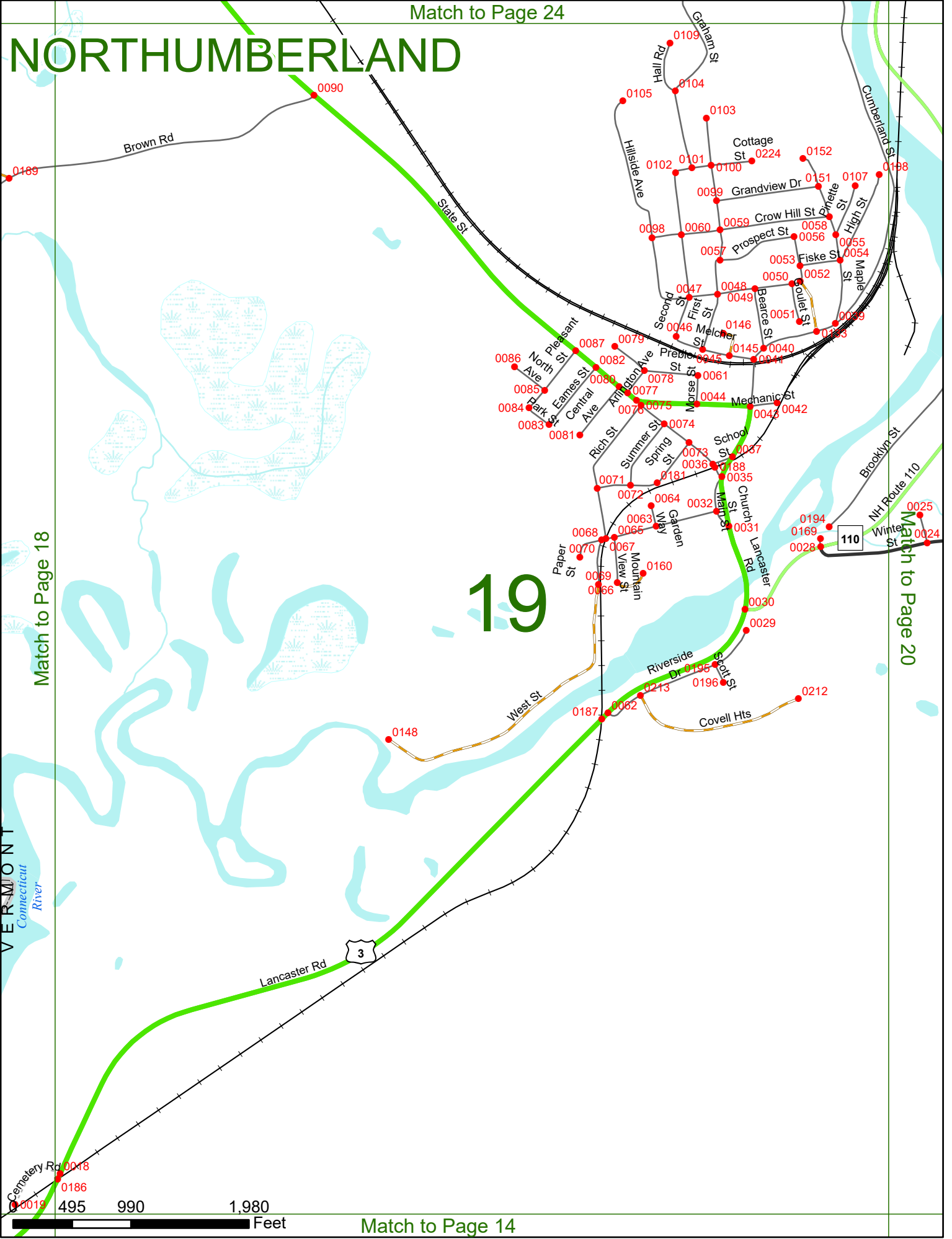

Match to Page 18

Match to Page 20

VERMONT
Connecticut River

0019 495 990 1,980 Feet

Match to Page 14

NORTHUMBERLAND

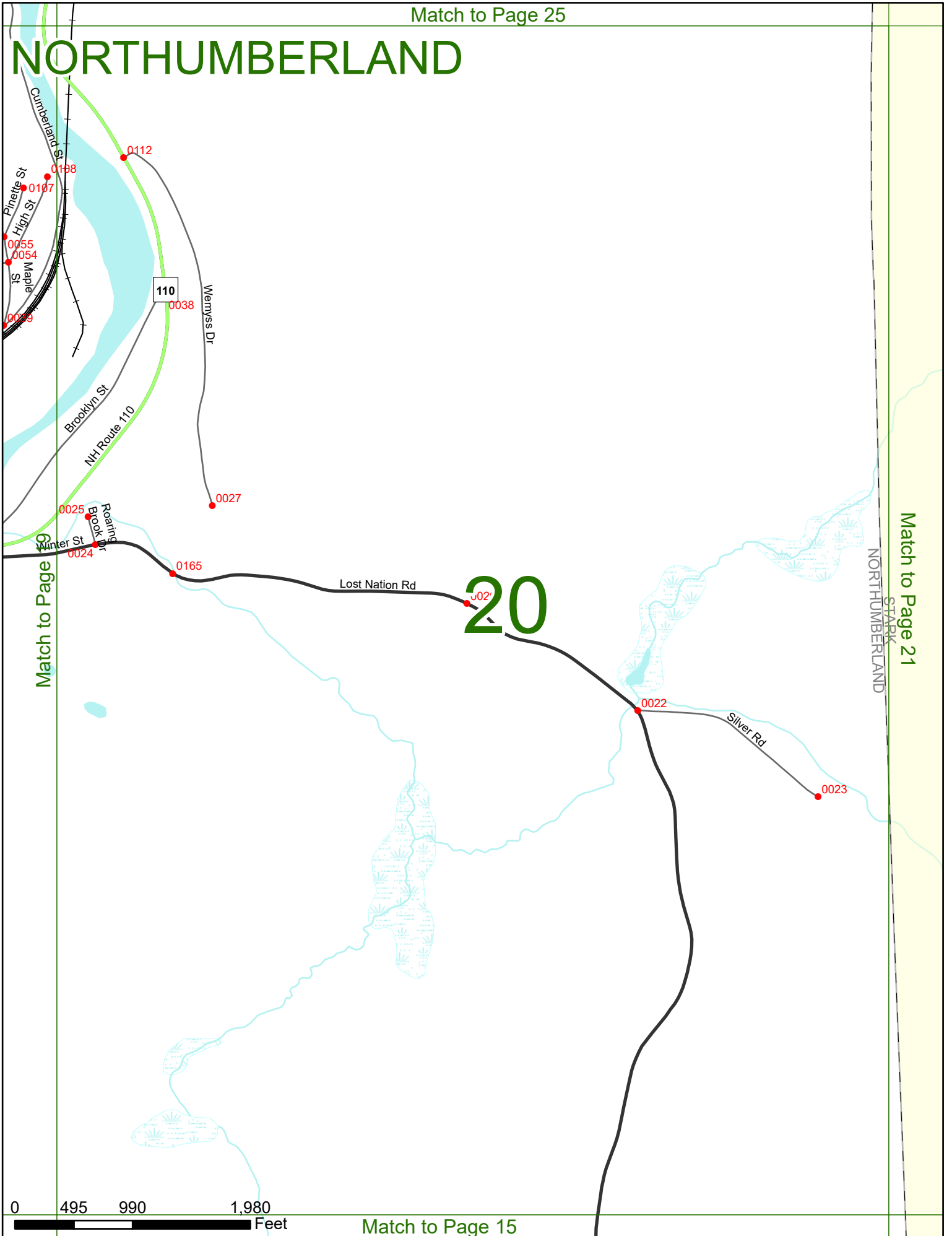

Match to Page 19

Match to Page 21

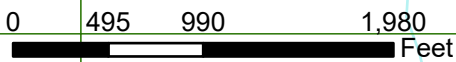

Match to Page 15

NORTHUMBERLAND

Match to Page 0

Stark Hwy

0046

Cold Springs Rd

0047

110

0045

0291

0044

Potter Rd

White Mountain NF

21

Match to Page 20

STARK

Match to Page 0

0 495 990 1,980 Feet

Match to Page 16

NORTHUMBERLAND

Connecticut River

Match to Page 0

VERMONT
22

Match to Page 23

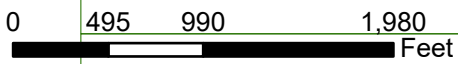

Match to Page 17

Match to Page 27

NORTHUMBERLAND

Match to Page 22

VERMONT

23

Match to Page 24

0 495 990 1,980 Feet

Match to Page 18

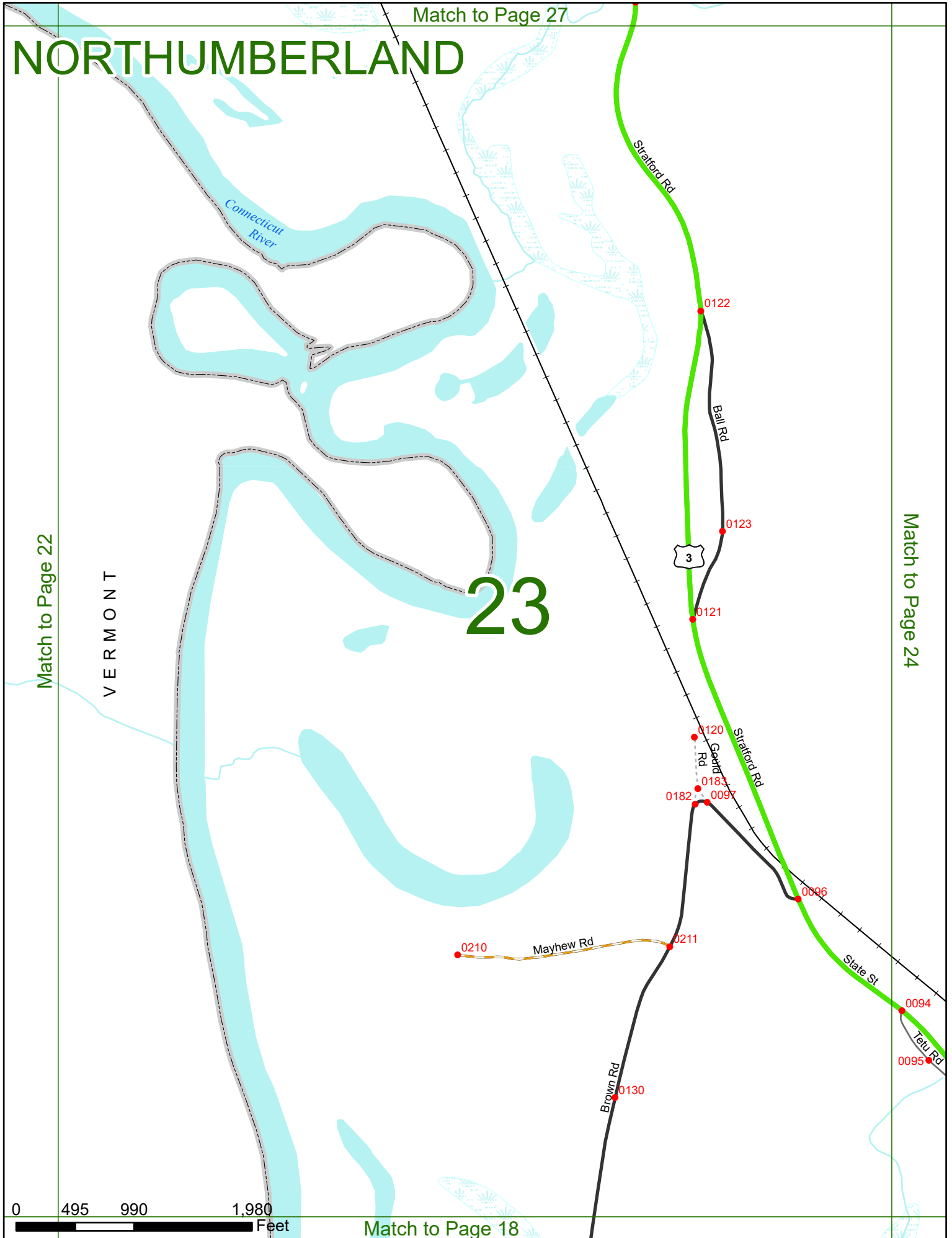

NORTHUMBERLAND

24

Match to Page 23

Match to Page 25

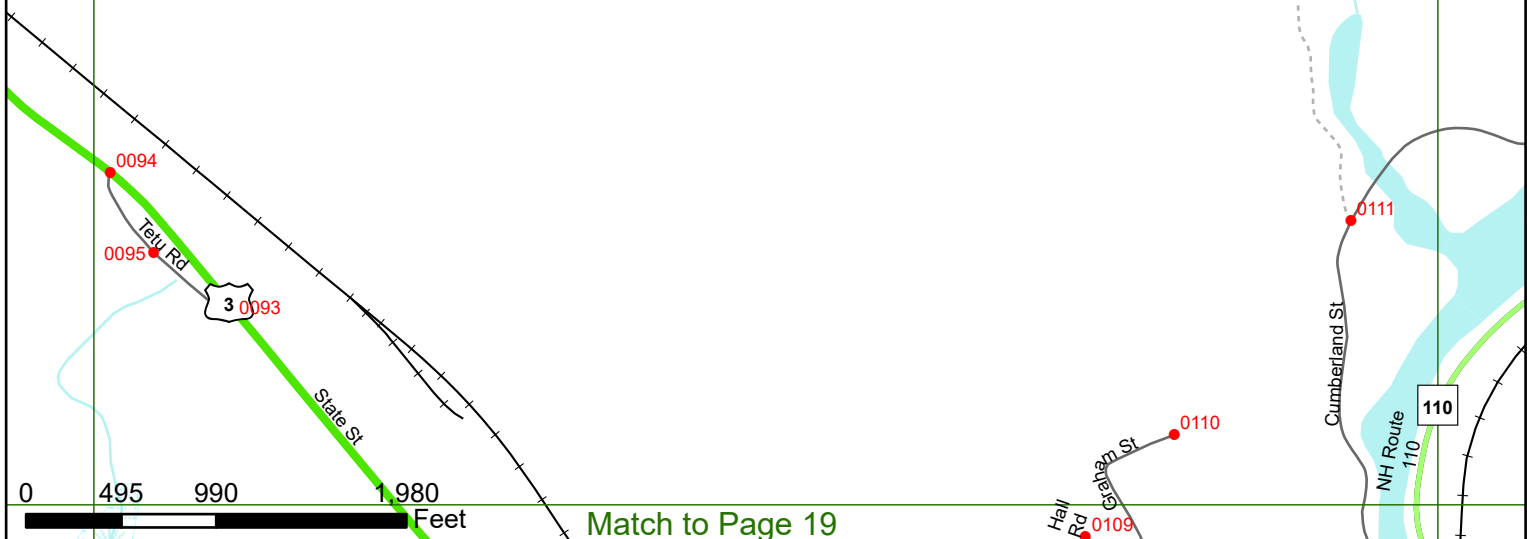

NORTHUMBERLAND

25

0063
Molly Brook Rd

0131
Bag Hill Rd

Match to Page 24

0119

NORTHUMBERLAND STARK

Match to Page 26

6059

0117 Cumberland St

Emerson Rd

0111

0116 NH Route 110

110

0115 Burt Hollow Rd

0114

6060

0113

6061

Stark Hwy

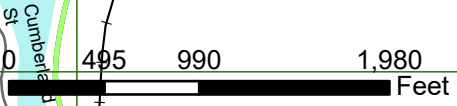

NORTHUMBERLAND

Match to Page 0

Match to Page 0

26

VERMONT

Match to Page 27

0 495 990 1,980 Feet

Match to Page 22



Match to Page 0

NORTHUMBERLAND

27

Match to Page 28

Match to Page 26

Match to Page 23

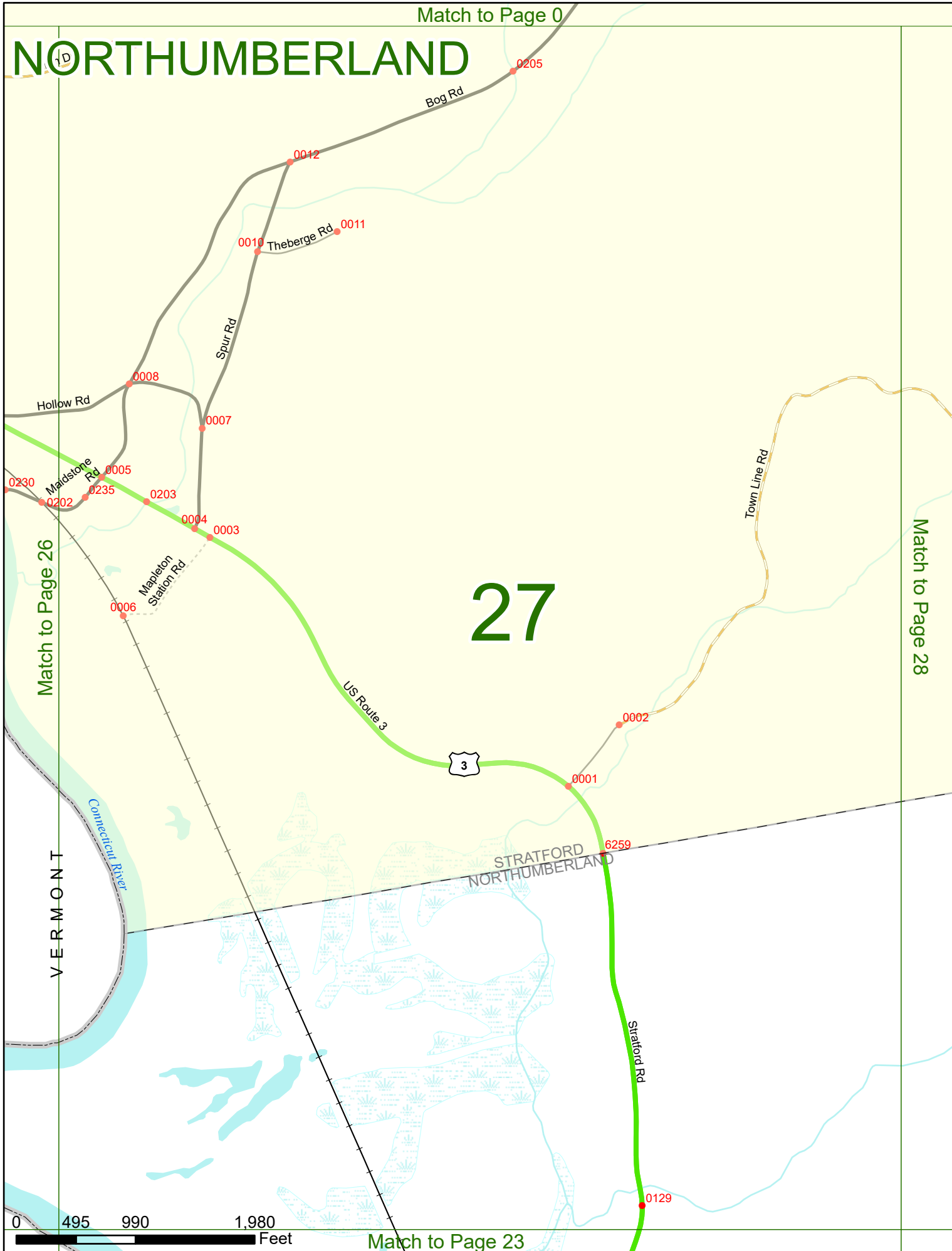

VERMONT

Connecticut River

STRATFORD
NORTHUMBERLAND

10

0205

0012

0010

0011

0008

0007

0005

0230

0202

0235

0203

0004

0003

0006

0002

0001

6259

0129

NORTHUMBERLAND

Match to Page 0

0086
to Hill Rd
0173

Town Line Rd

28

Match to Page 27

Match to Page 29

STRATFORD
NORTHUMBERLAND

Jonathan
Pond

0 495 990 1,980 Feet

Match to Page 24

Match to Page 0

NORTHUMBERLAND

Nash Stream Forest

29

Match to Page 28

Match to Page 0

STRATFORD
NORTHUMBERLAND

STRATFORD
STARK

NORTHUMBERLAND
STARK

High Acres Dr
0109
0068

Moose Pond Dr
0106

Molly Brook Rd
0063

Jonathan Pond

Big Hill Rd
0124



Match to Page 25