



Maps and data sets are not guaranteed to be free from errors and omissions. Data is in a constant state of update and correction by various groups and agencies. Information displayed on this map is the best available at the time of publication.

# 2025 Nodal Reference Bookmap

## LEGEND



NHDOT will accept crash locations based on the State of NH Uniform Police Traffic Accident Report.

Crash occurred on:

**Option 1**     Street Address  
                   123 Main Street

**Option 2**     Route No and/or     Distance from             NESW             Intesecting Road, Bridge,  
                   Street name             Intersecting Street                                     Town/County line  
                   Main Street                     500                     E                     Oak Street

**Option 3**     First Node                     Distance from First Node                     Second Node  
                   515                                     212                                     632

**Option 4**     Route No and/or             Mile Marker on Interstate Only     NESW             Mile (Marker)  
                   Street name  
                   189S                                     700 feet                     S                     36.8

**Option 3 – Example**

Street Name                     Loudon Road  
First Node                             803  
Distance from First Node             318 Ft  
Second Node                             813



# NORTHFIELD

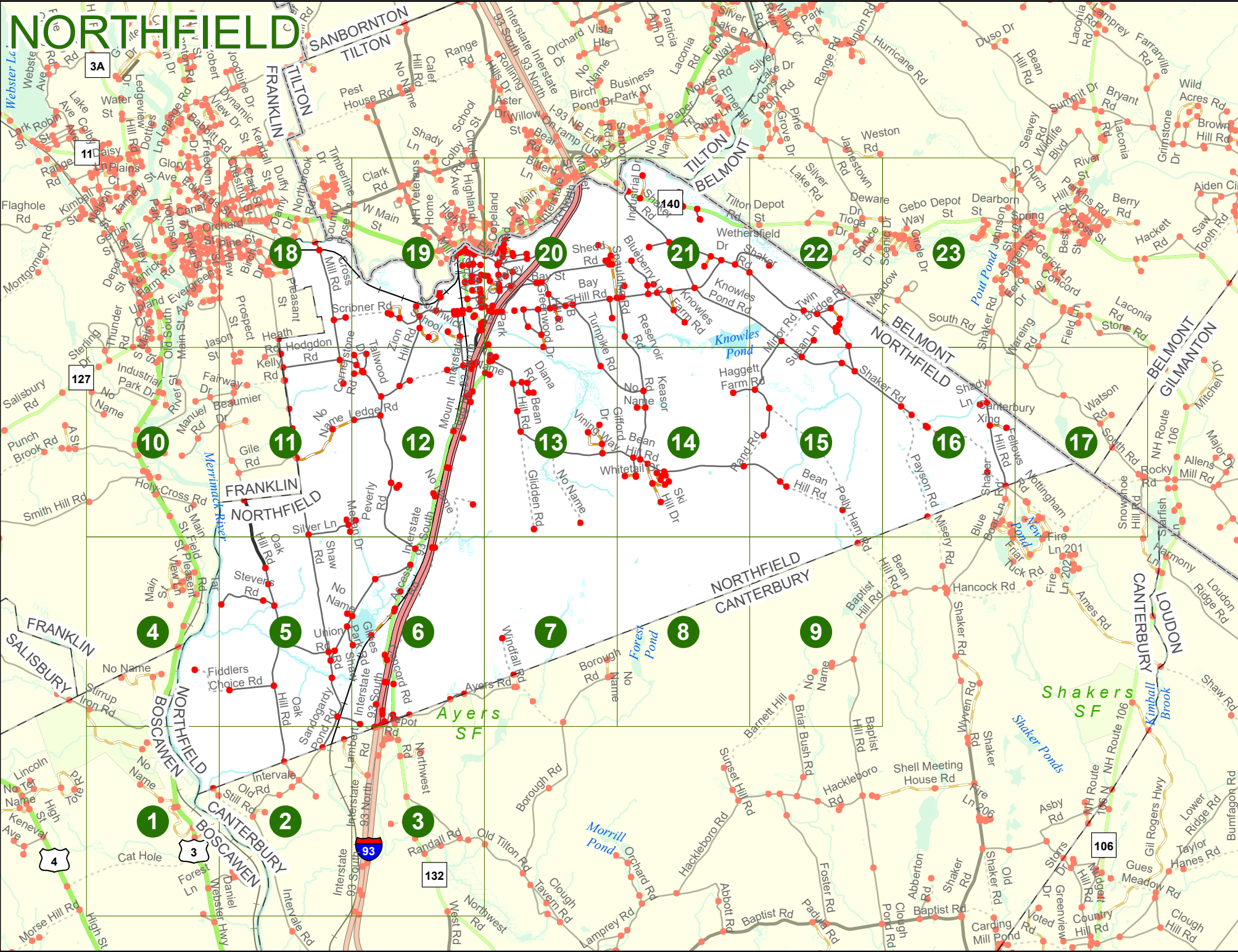

# NORTHFIELD

Match to Page 4

State Forest Nursery

NORTHFIELD BOSCAWEN

Merrimack River

NORTHFIELD CANTERBURY

CANTERBURY BOSCAWEN

Match to Page 2

Match to Page 0

# 1

Stirrup Iron Rd

0139

1201

1202

1187

1262

3

Daniel Webster Hwy

0317

1244

1328

1243

6160

0160

Old Still Rd

Wastewater Treatment Access

0316

1295

1195

0320

Cat Hole

Daniel Webster Hwy

Forest Ln

0122

0102

4

495 990 1,980 Feet

Match to Page 0

0121

Eastmen Rd

# NORTHFIELD

NORTHFIELD  
CANTERBURY

# 2

CANTERBURY  
BOSCOWEN

Match to Page 3

Match to Page 1



495 990 1,980 Feet

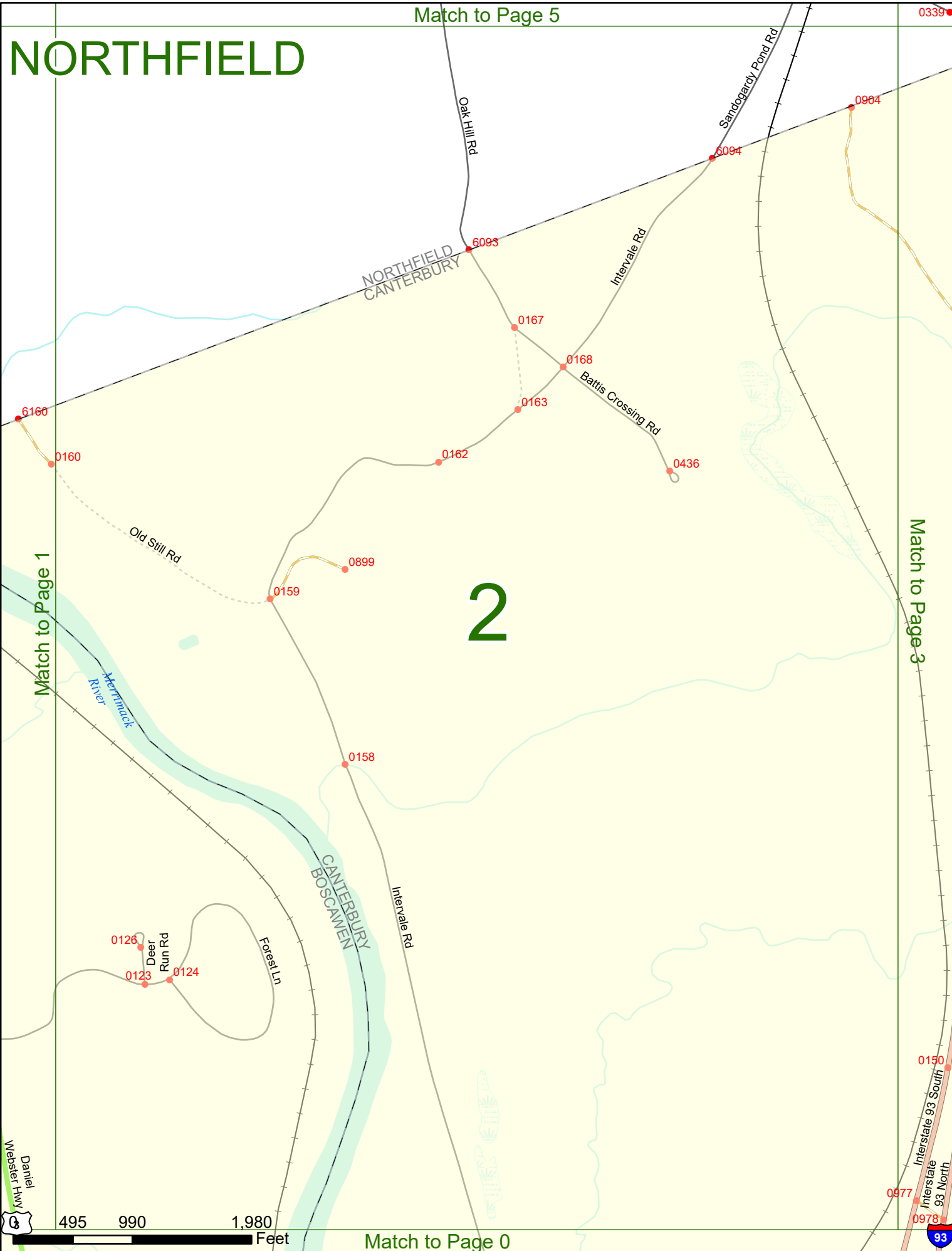

# NORTHFIELD

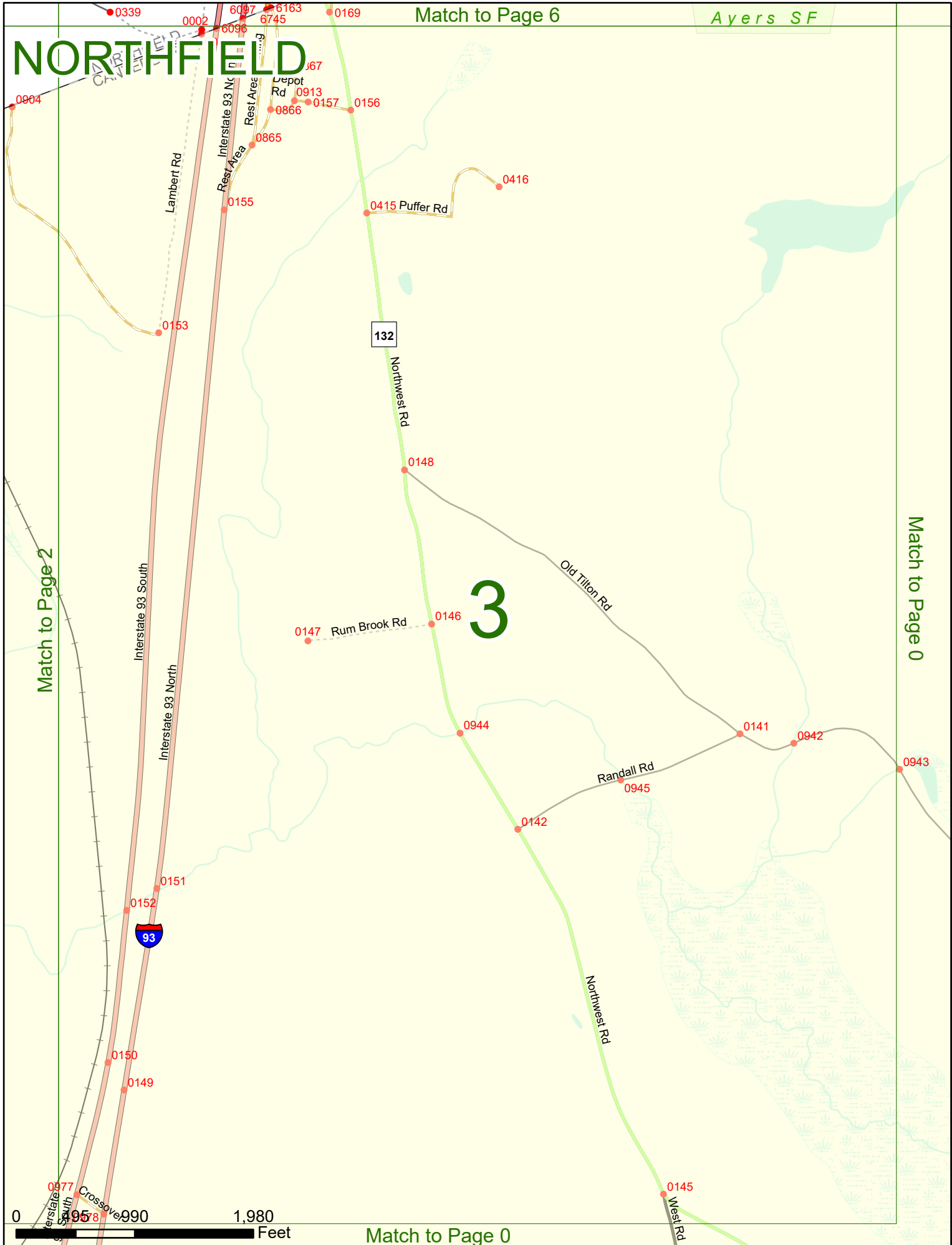

Match to Page 2

Match to Page 0



# NORTHFIELD

Match to Page 0

# 4

Match to Page 5

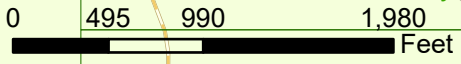
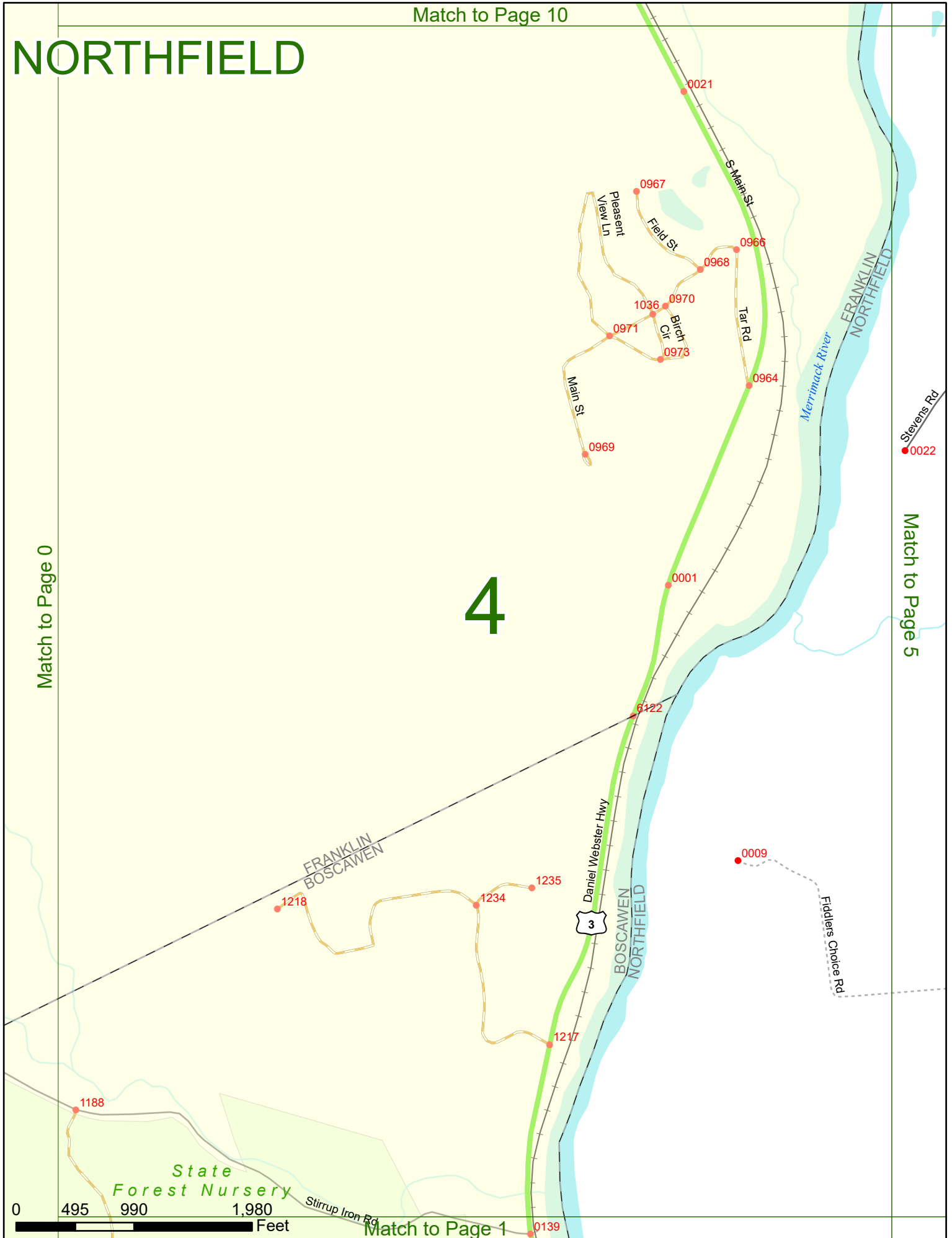

Match to Page 11

# NORTHFIELD

# 5

Match to Page 4

Match to Page 6

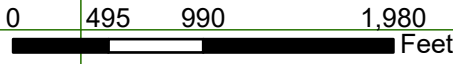
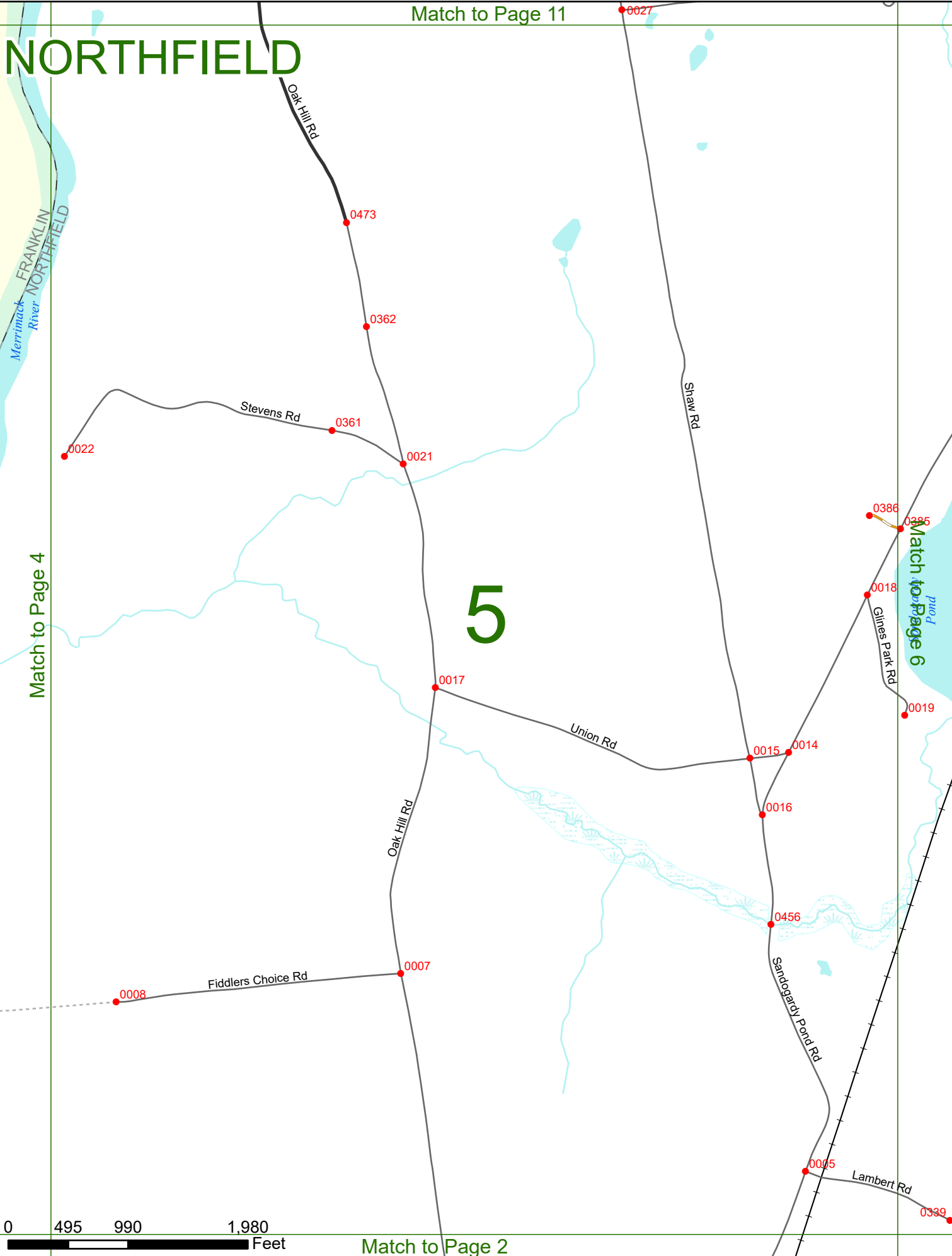

Match to Page 2



# NORTHFIELD

Match to Page 12

Match to Page 7

# 6

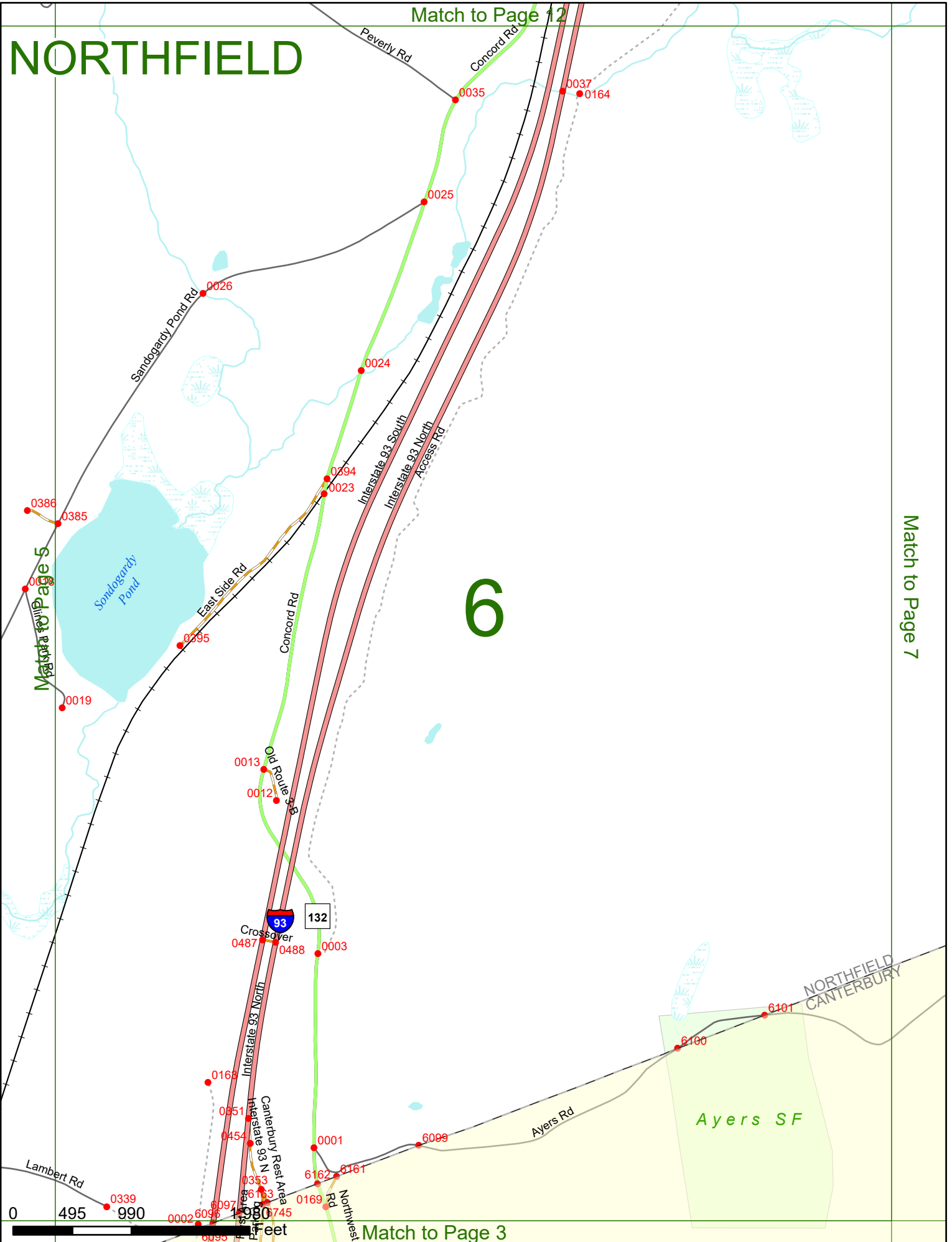

Match to Page 5

Match to Page 3

0 495 990 Feet

# NORTHFIELD

# 7

Match to Page 6

Match to Page 8

NORTHFIELD  
CANTERBURY

0340

Windfall Rd

6102

0438 0170

0941

Ayers Rd

0172

0420

0419

0173

Borough Rd

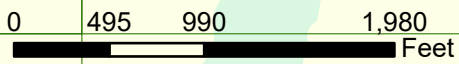

Match to Page 0

# NORTHFIELD

NORTHFIELD  
CANTERBURY

8

Match to Page 7

Match to Page 9

*Forest Pond*

0173

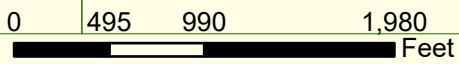

Match to Page 0

# NORTHFIELD

NORTHFIELD  
CANTERBURY

Polly  
Hart Rd  
6103

Bear Hill Rd

# 9

Baptist Hill Rd  
0934

Match to Page 0

Match to Page 8

0175

0871

0870

0174

0959

Briar Bush Rd

Barnett Hill



Match to Page 0

# NORTHFIELD

Match to Page 9

Match to Page 0

Match to Page 11

# 10

FRANKLIN  
NORTHFIELD

0 495 990 1,980 Feet

Match to Page 4

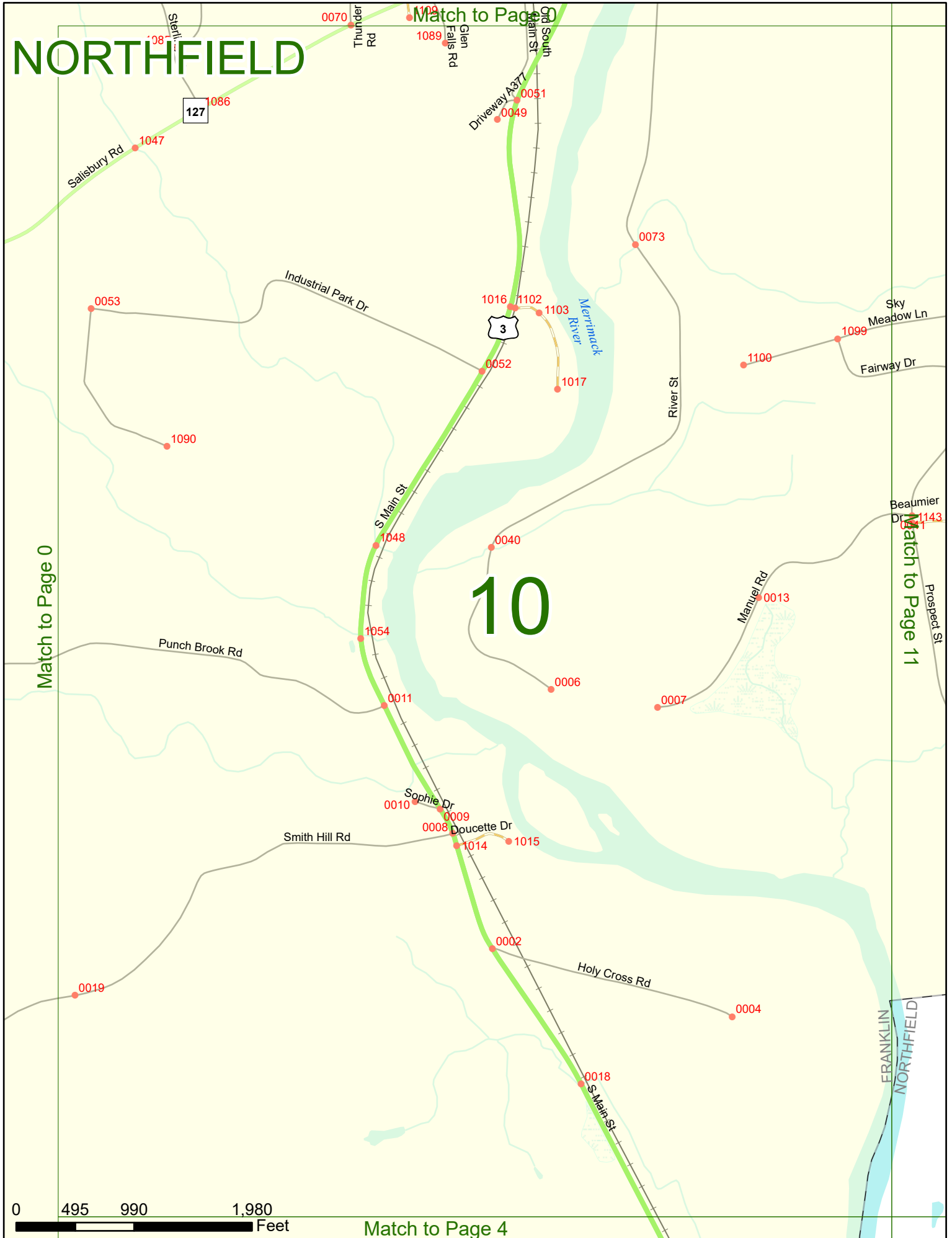

# NORTHFIELD

Match to Page 18

# 11

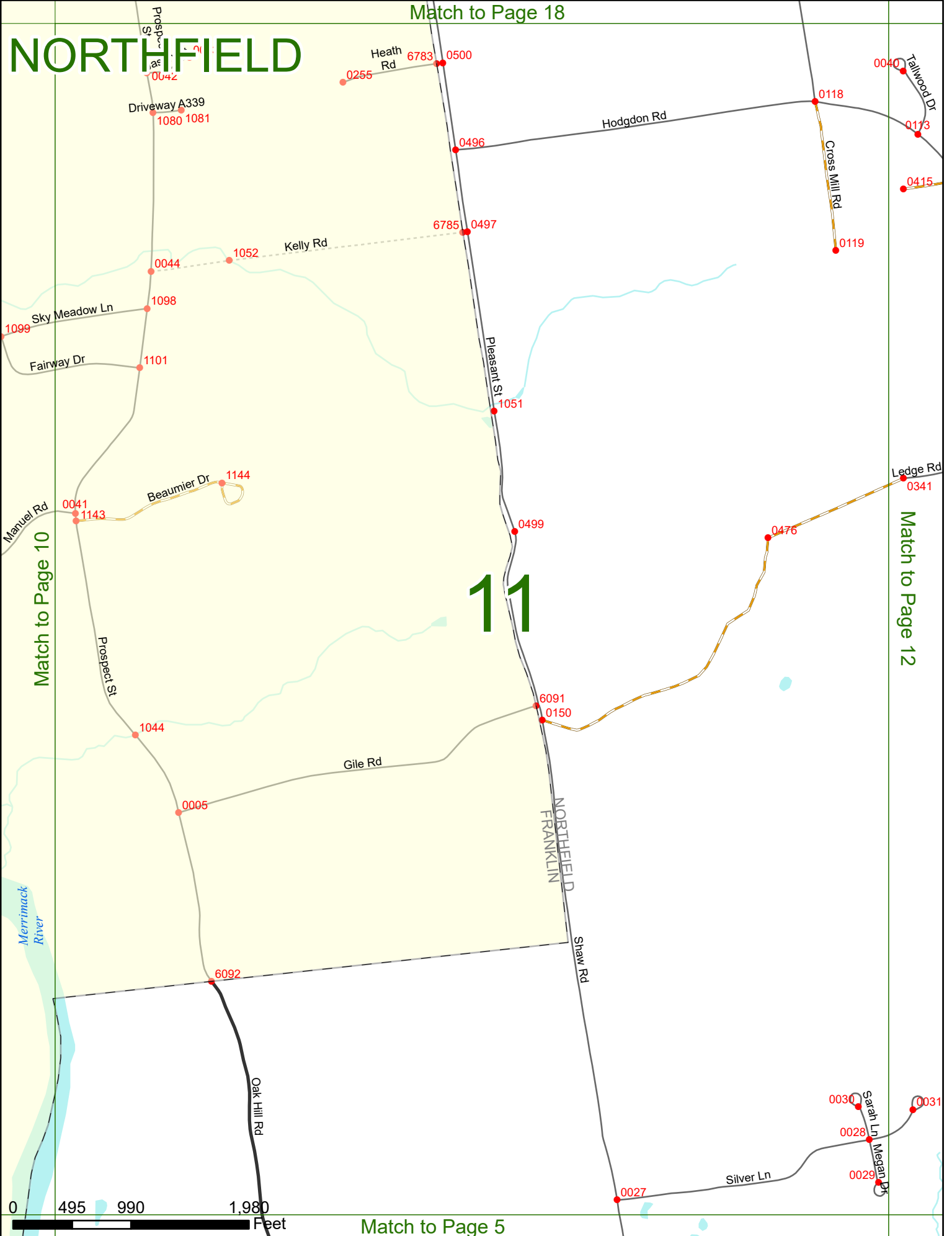

Match to Page 10

Match to Page 12

Match to Page 5



Match to Page 19

# NORTHFIELD

# 12

Match to Page 11

Match to Page 13

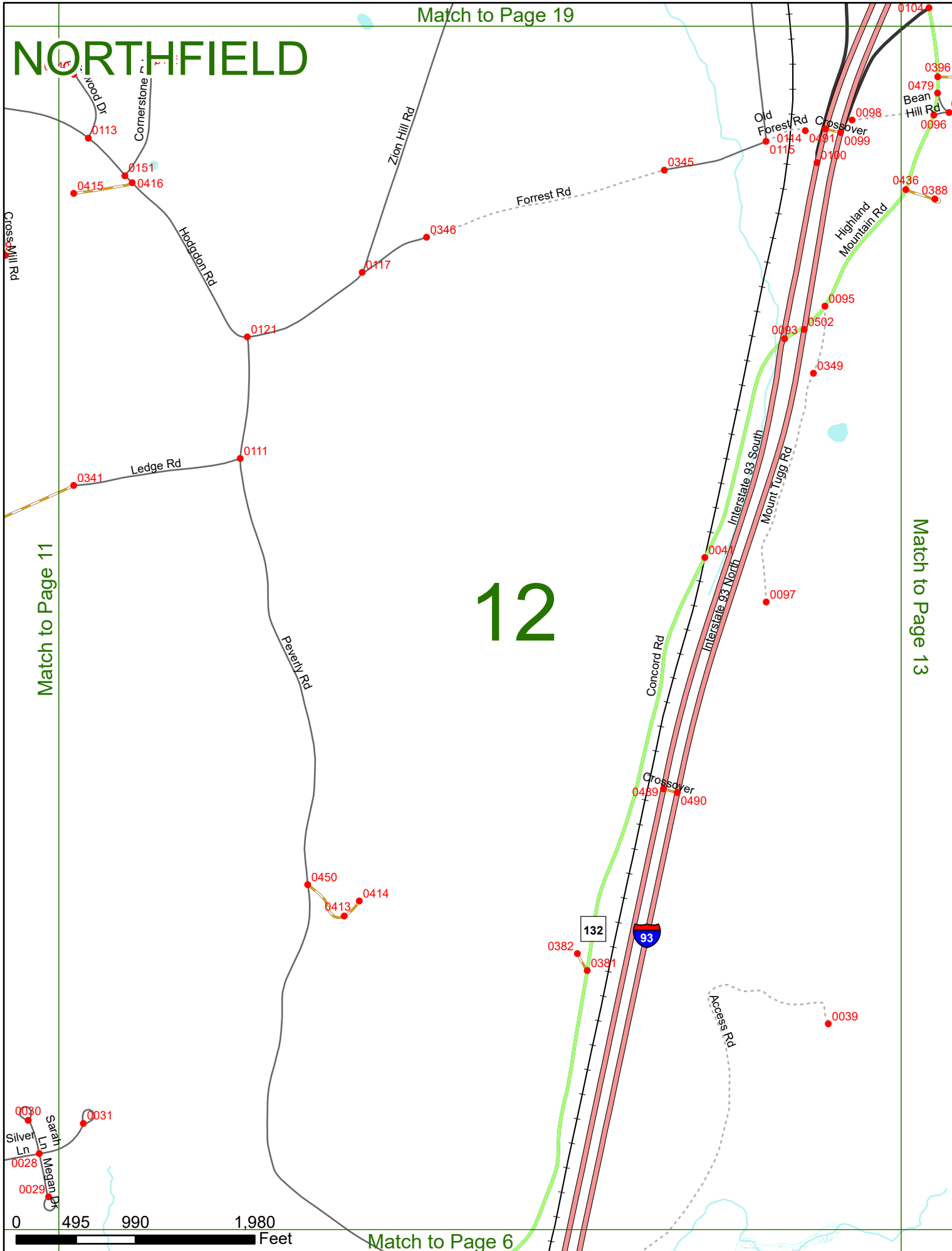

Match to Page 6



# NORTHFIELD

Match to Page 20

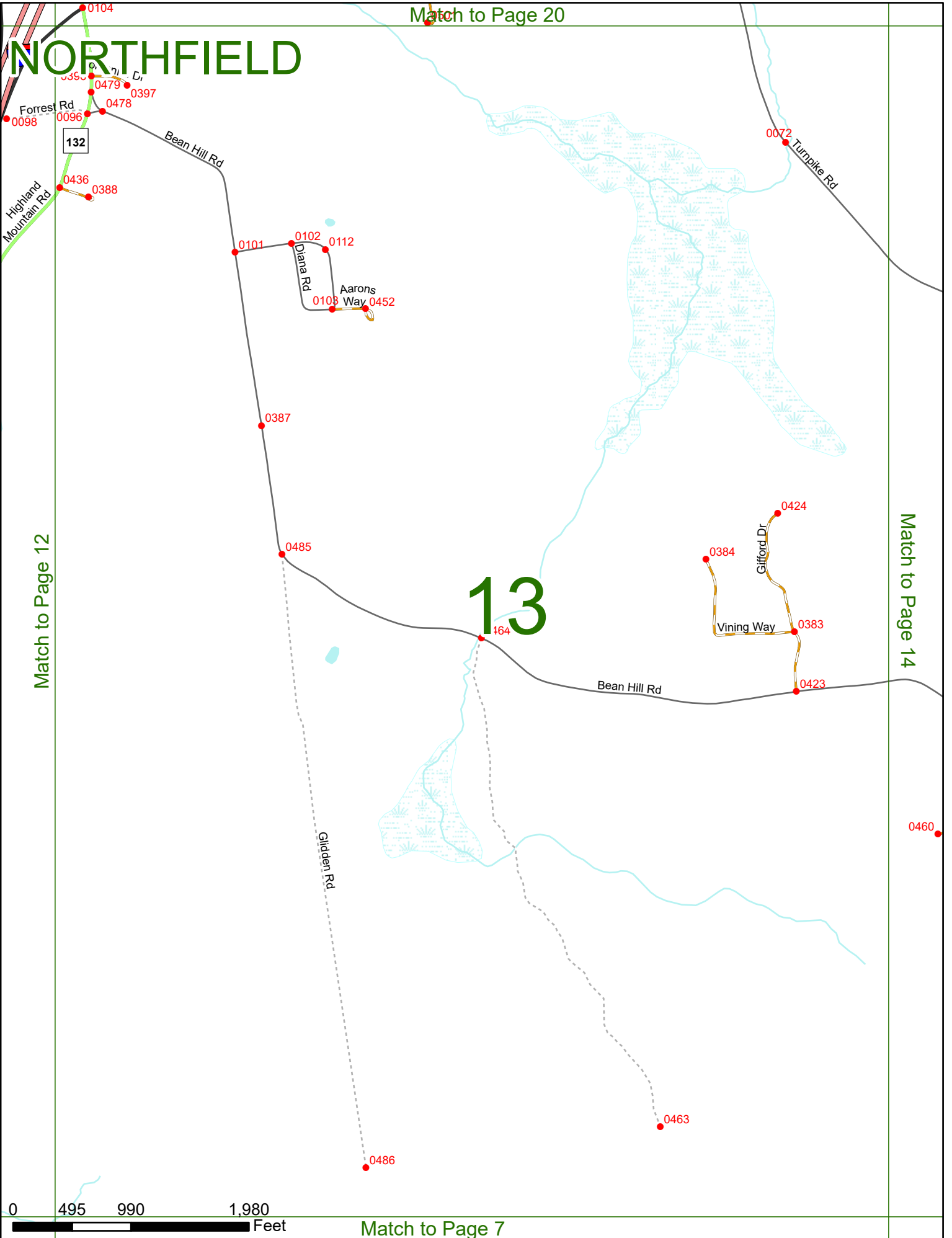

Match to Page 12

Match to Page 14

# 13

0 495 990 1,980 Feet

Match to Page 7

# NORTHFIELD

Knowles Pond

# 14

Match to Page 13

Match to Page 15

Reservoir Rd

Turnpike Rd

Haggett Farm Rd

Keasor Rd

Bean Hill Rd

Raine Rd

Bean Hill Rd

0020

0043

0443

0453

0398

0399

0354

St. Hill Dr

0442

0447

0445

0446

0355

Whitetail Dr

0459

0460

0036

0053

0378

0377

0071

0062

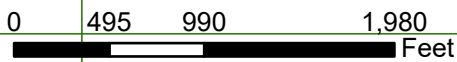

# NORTHFIELD

Match to Page 22

# 15

Match to Page 16

Match to Page 14

Match to Page 9

Haggett Farm Rd

Rand Rd

Susan Ln

Knowles Pond Rd

Shaker Rd

Bean Hill Rd

Polly Horn Rd

Bean Hill Rd

NORTHFIELD  
CANTERBURY

0 495 990 1,980 Feet

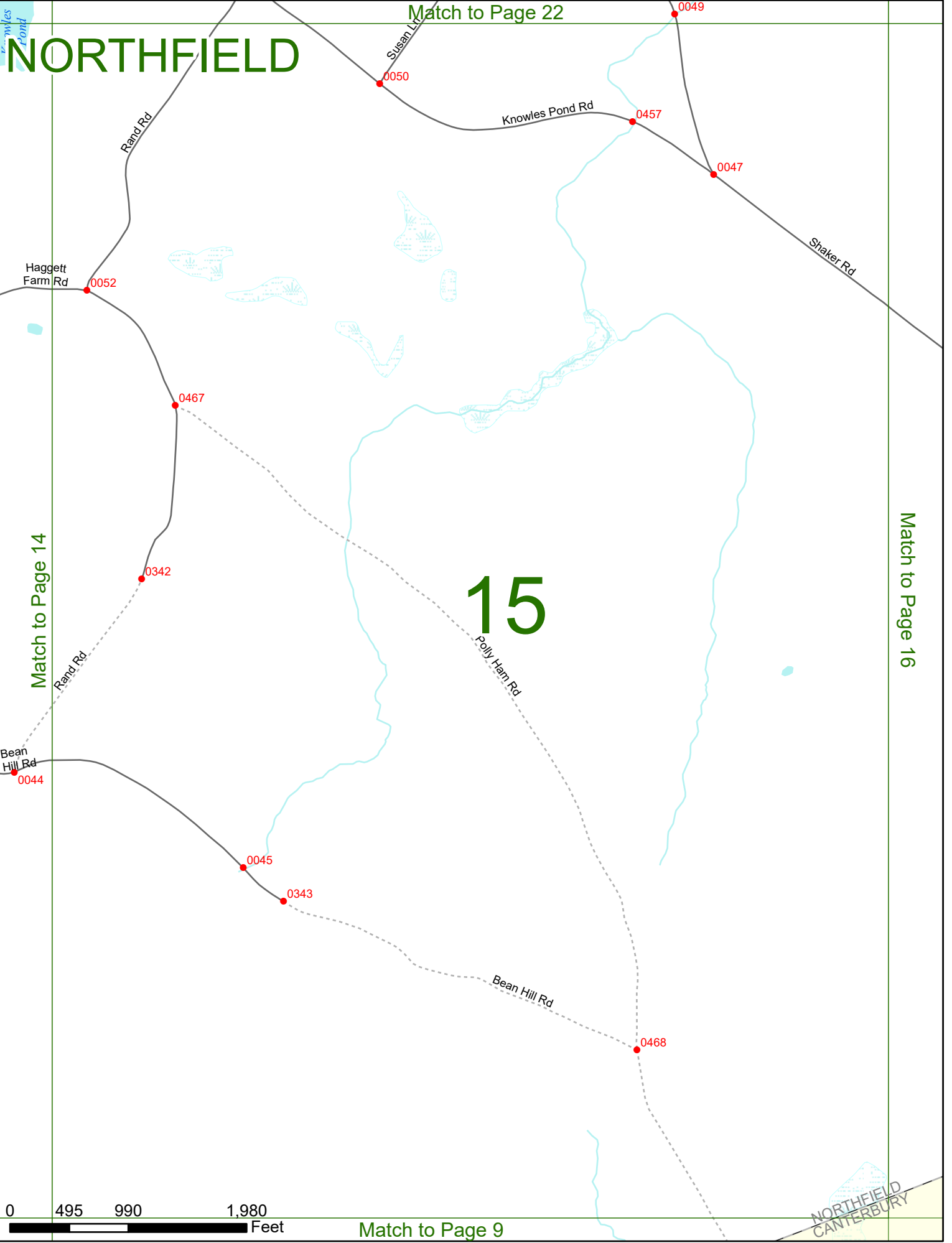

# NORTHFIELD

South Rd

BELMONT  
NORTHFIELD

Shaker Rd

0920

8162

Shady Ln  
0470 0469

Shaker Rd

0155

0344

0046

0441

0419

0438

Canterbury King

0437

Match to Page 15

Match to Page 17

# 16

Payson Rd

Felows Hill Rd

0365

6105

Old Gilmenton Rd

0432

Shaker Rd

Blue Boar Ln

0430

0429

0431

Sherwood Forest Dr

0902

0421

Robin Shore Dr

0423

0422

0424

0424

0424

0424

0424

0424

0424

0424

0424

New Pond

Canterbury Shore Dr

Fier Tuck Rd

NORTHFIELD  
CANTERBURY

6104

Misery Rd

Lyford Pond

0 495 990 1,980 Feet

Match to Page 0

Match to Page 0

# NORTHFIELD

Stone Rd  
0003106

Water

0005

South Rd

0003

Clough Pond

Watson Rd  
0001 0002

BELMONT  
GILMANTON

Match to Page 0

# 17

Match to Page 16

BELMONT  
NORTHFIELD

6284

South Rd

NORTHFIELD  
CANTERBURY

BELMONT  
CANTERBURY

0016 0258  
0597

8295

GILMANTON  
CANTERBURY

Snowshoe Hill Rd

8801

Blue Boat Ln

0440 0428

Old Gilmanton Rd

0869 0920

0984

Canterbury Shore Dr

Fire Lane

0868

Nottingham Rd

0902

Sherwood Forest Dr

0422 0423

0495

990

1980

0983 0427

0191

Harmony Ln

0970

Rocky Pond

0424 Feet

Match to Page 0

Match to Page 0

# NORTHFIELD

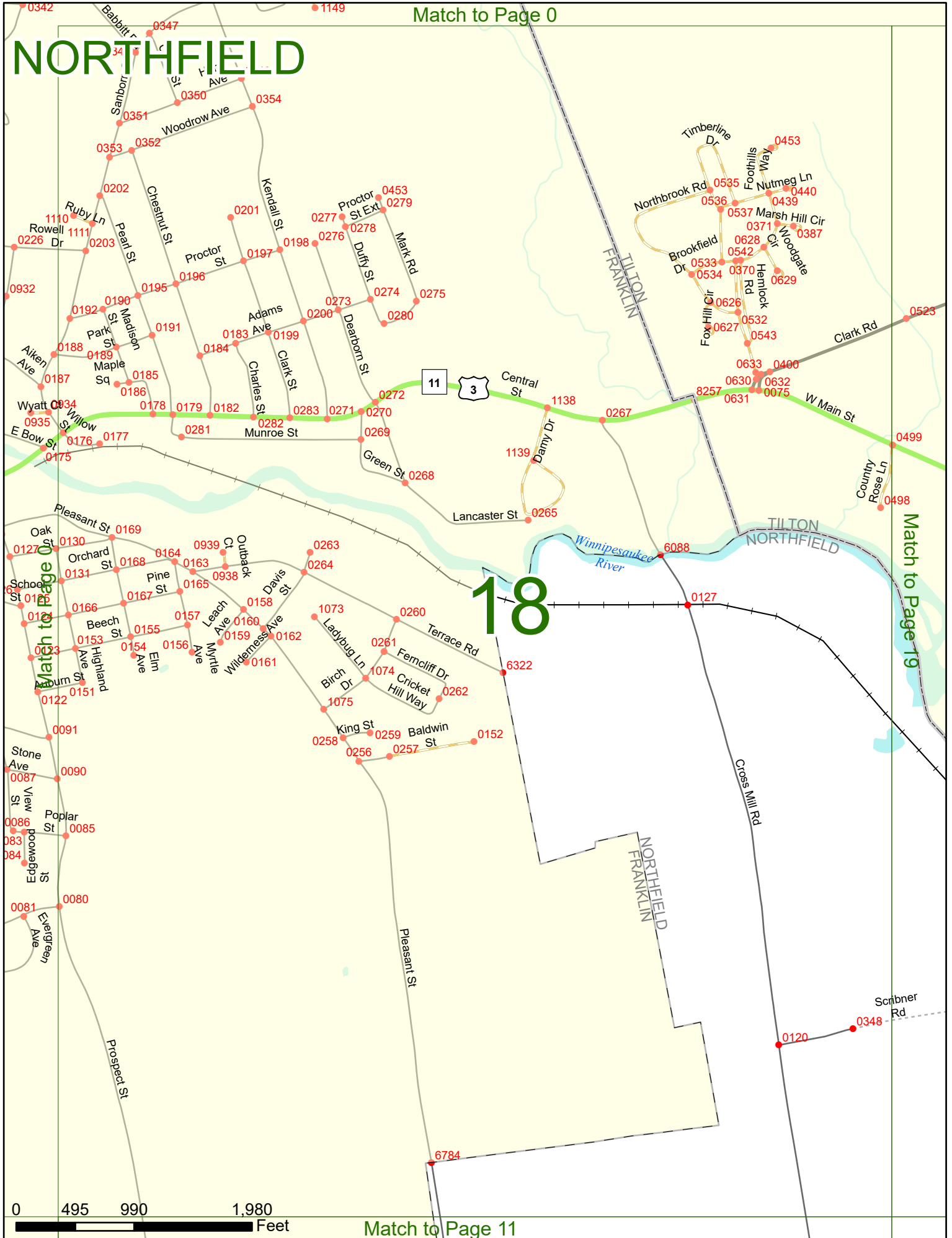

0 495 990 1,980 Feet

Match to Page 11

Match to Page 0

Match to Page 19

# NORTHFIELD

Match to Page 9

Match to Page 18

Match to Page 20

Match to Page 12

# 19

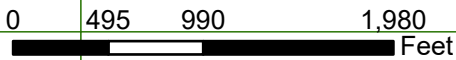
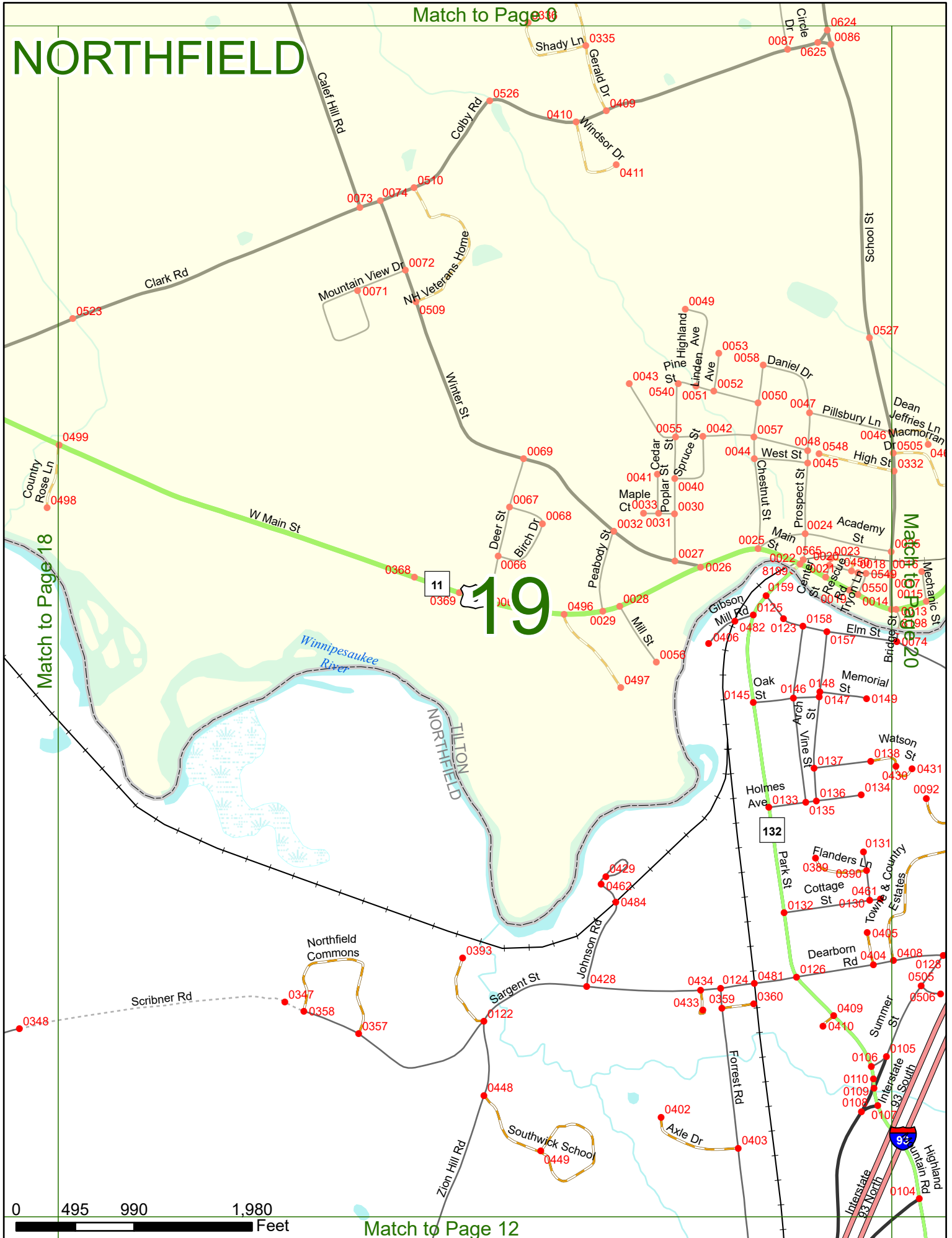



# NORTHFIELD

Match to Page 0

Match to Page 21

# 20

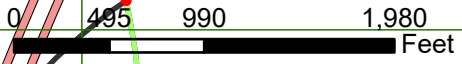
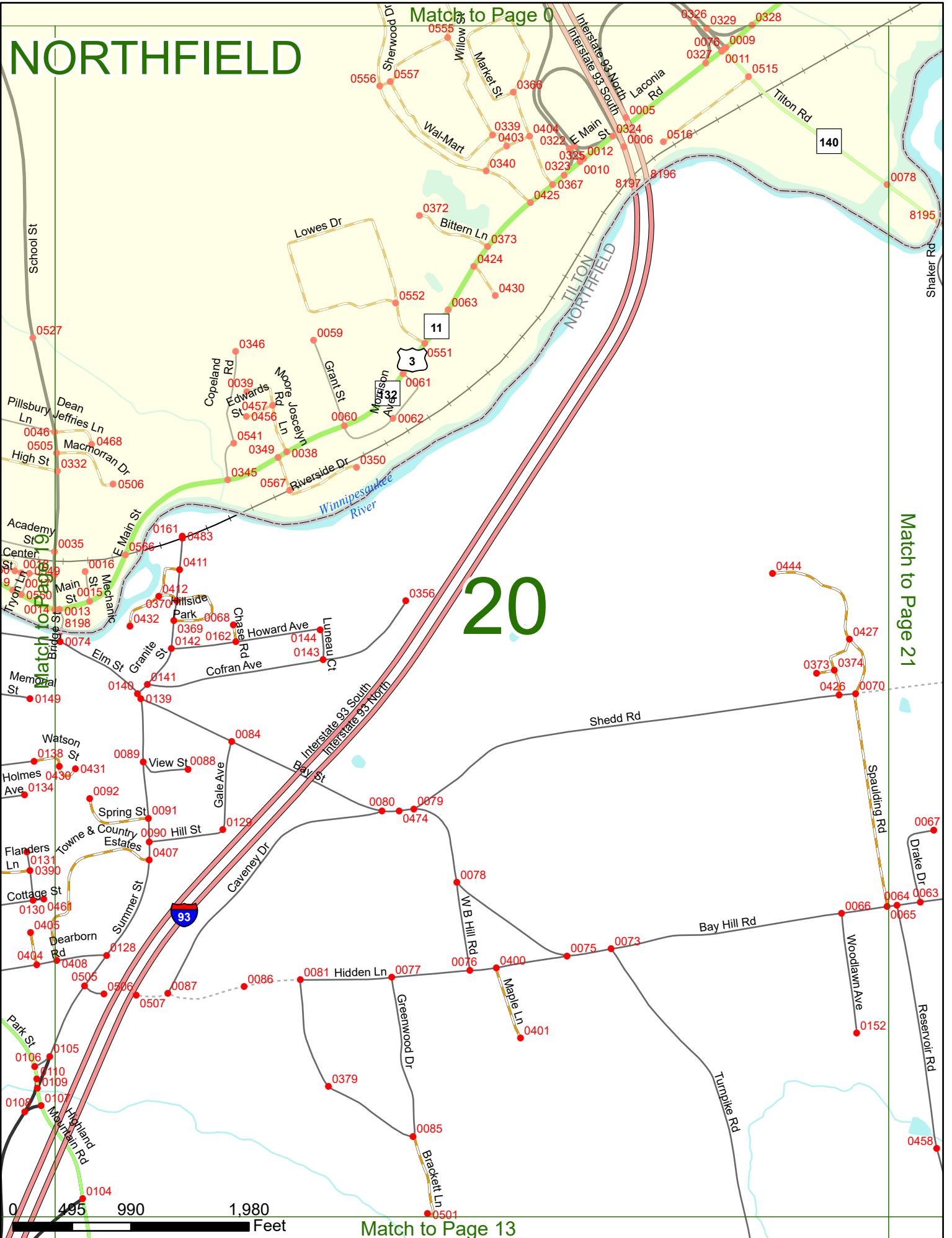

Match to Page 13

Match to Page 0

# NORTHFIELD

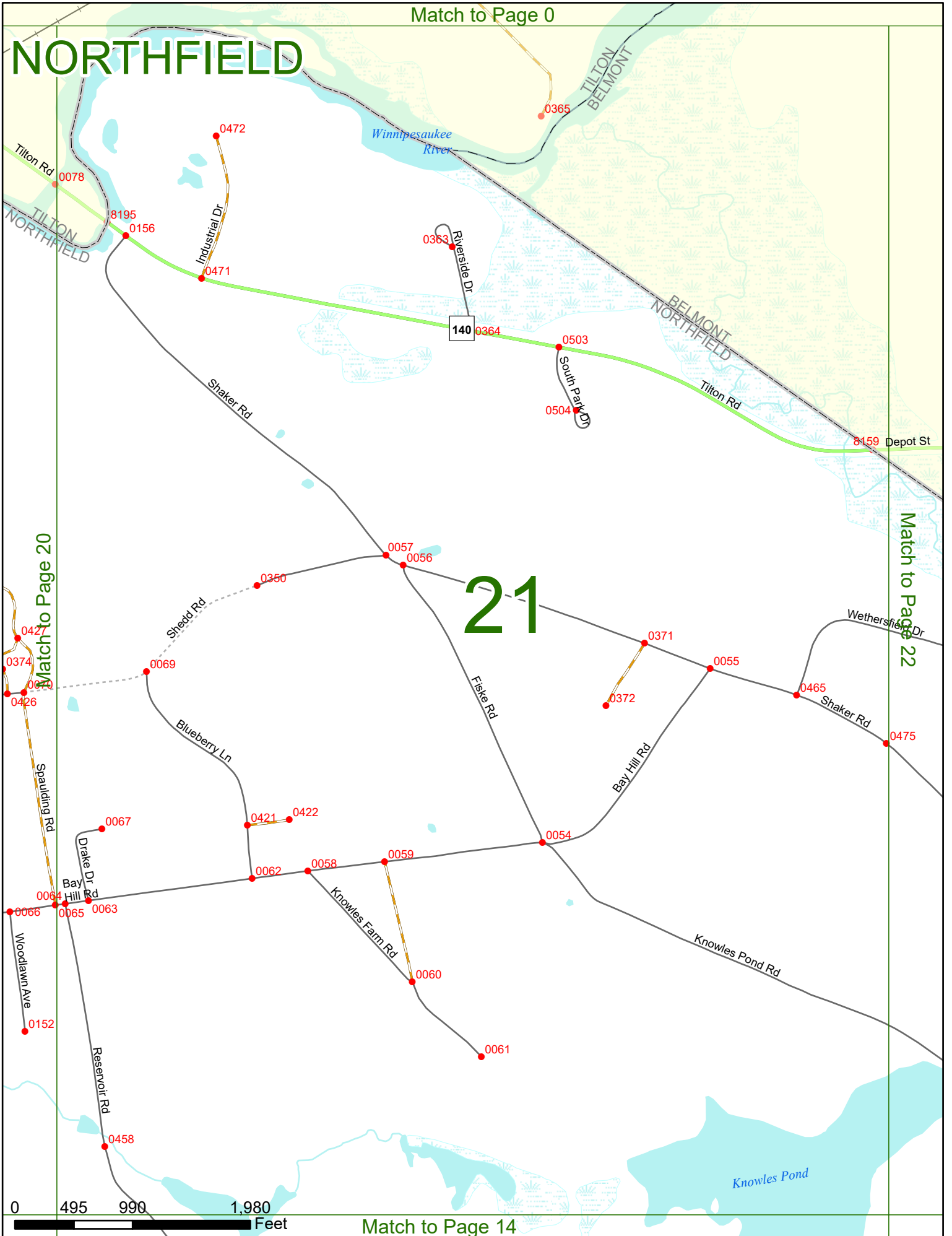

# 21

Match to Page 20

Match to Page 22

0 495 990 1,980 Feet

Match to Page 14

# NORTHFIELD

# 22

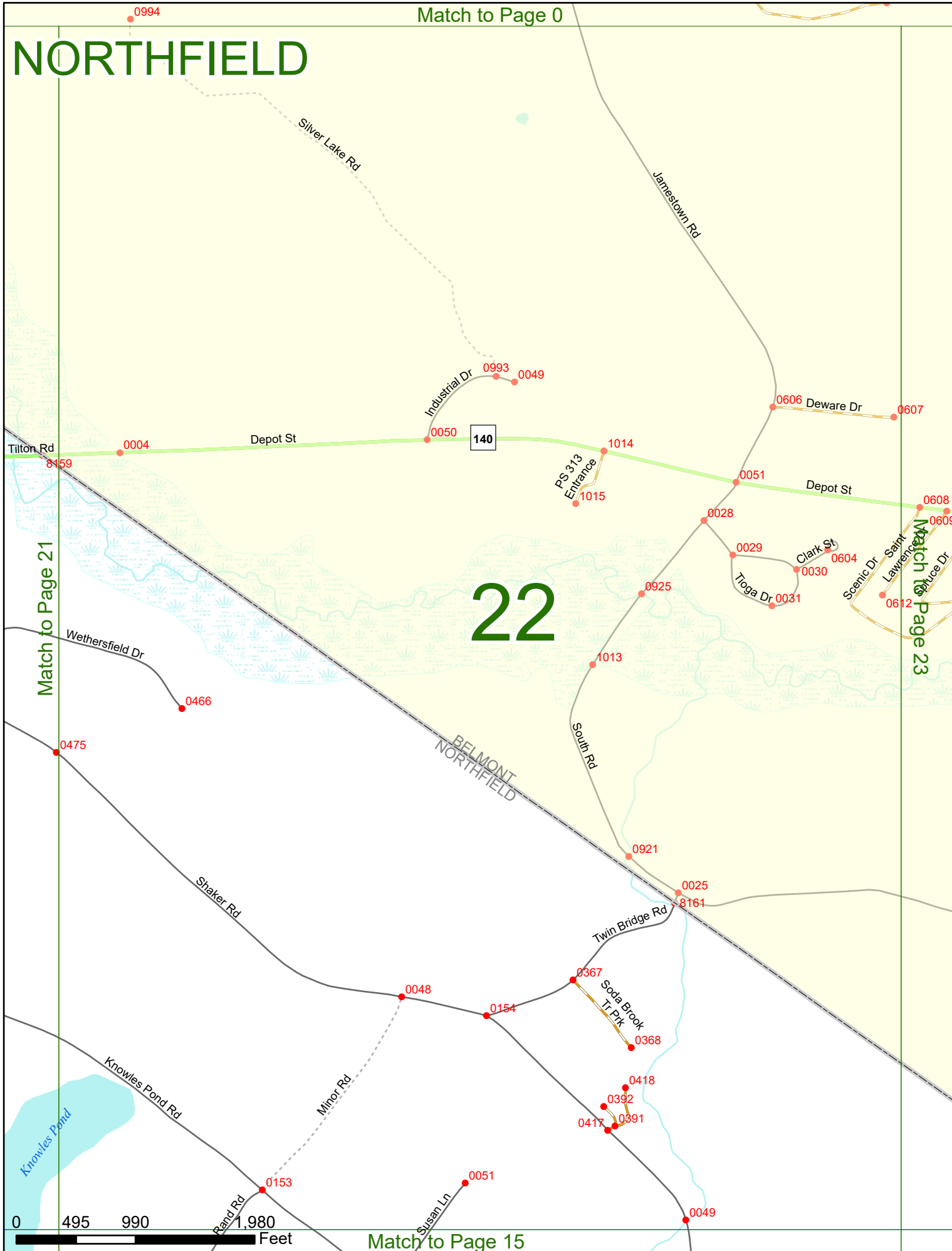

Match to Page 21

Match to Page 23



# NORTHFIELD

# 23

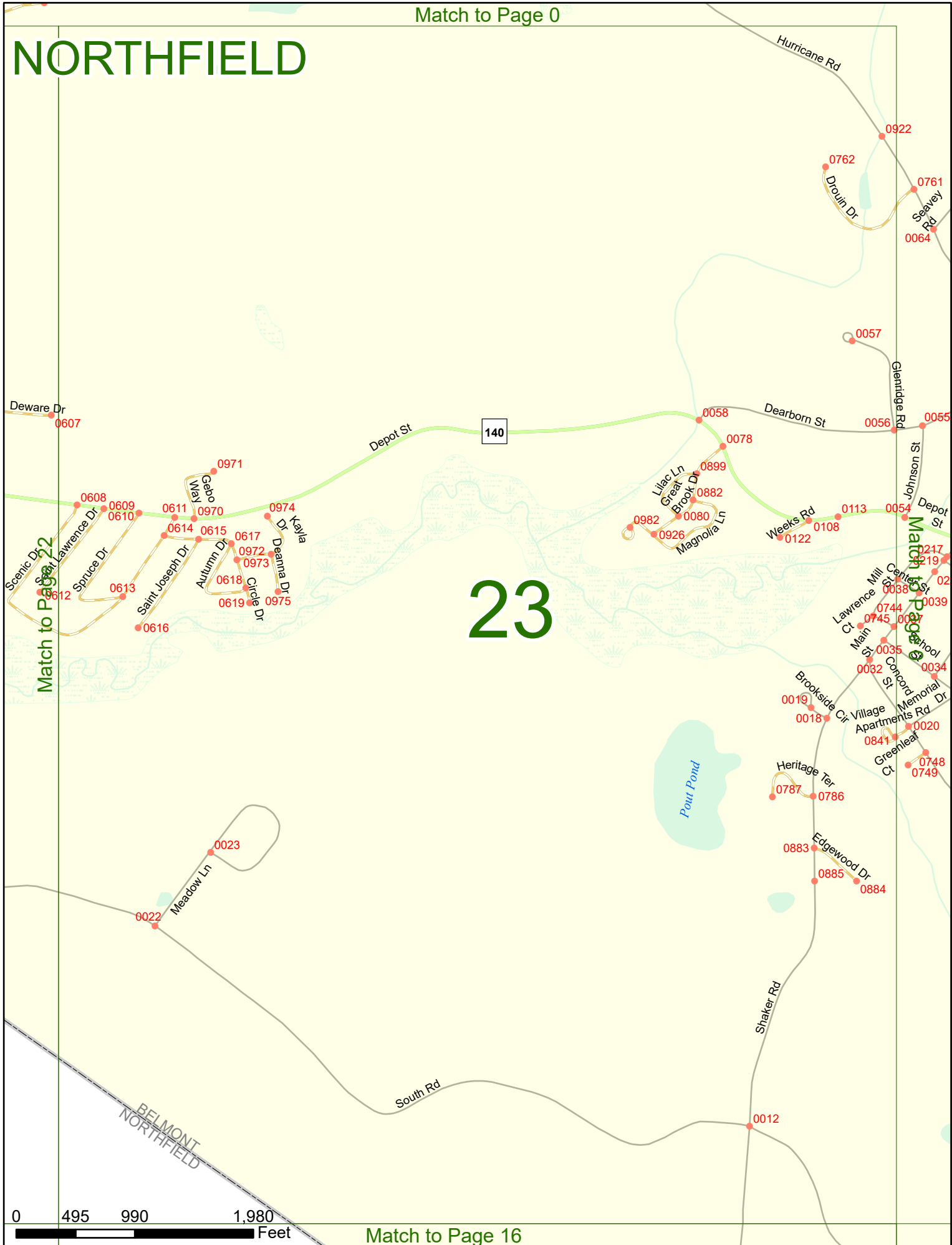

Match to Page 22

Match to Page 0

