



Maps and data sets are not guaranteed to be free from errors and omissions. Data is in a constant state of update and correction by various groups and agencies. Information displayed on this map is the best available at the time of publication.

# 2025 Nodal Reference Bookmap

## LEGEND



NHDOT will accept crash locations based on the State of NH Uniform Police Traffic Accident Report.

Crash occurred on:

**Option 1**     Street Address  
                   123 Main Street

**Option 2**     Route No and/or     Distance from             NESW             Intesecting Road, Bridge,  
                   Street name             Intersecting Street                                     Town/County line  
                   Main Street                    500                                     E                    Oak Street

**Option 3**     First Node                    Distance from First Node                    Second Node  
                   515                                    212                                    632

**Option 4**     Route No and/or             Mile Marker on Interstate Only     NESW             Mile (Marker)  
                   Street name  
                   189S                                    700 feet                                    S                    36.8

**Option 3 – Example**

Street Name                    Loudon Road  
First Node                        803  
Distance from First Node       318 Ft  
Second Node                    813



# NEWBURY

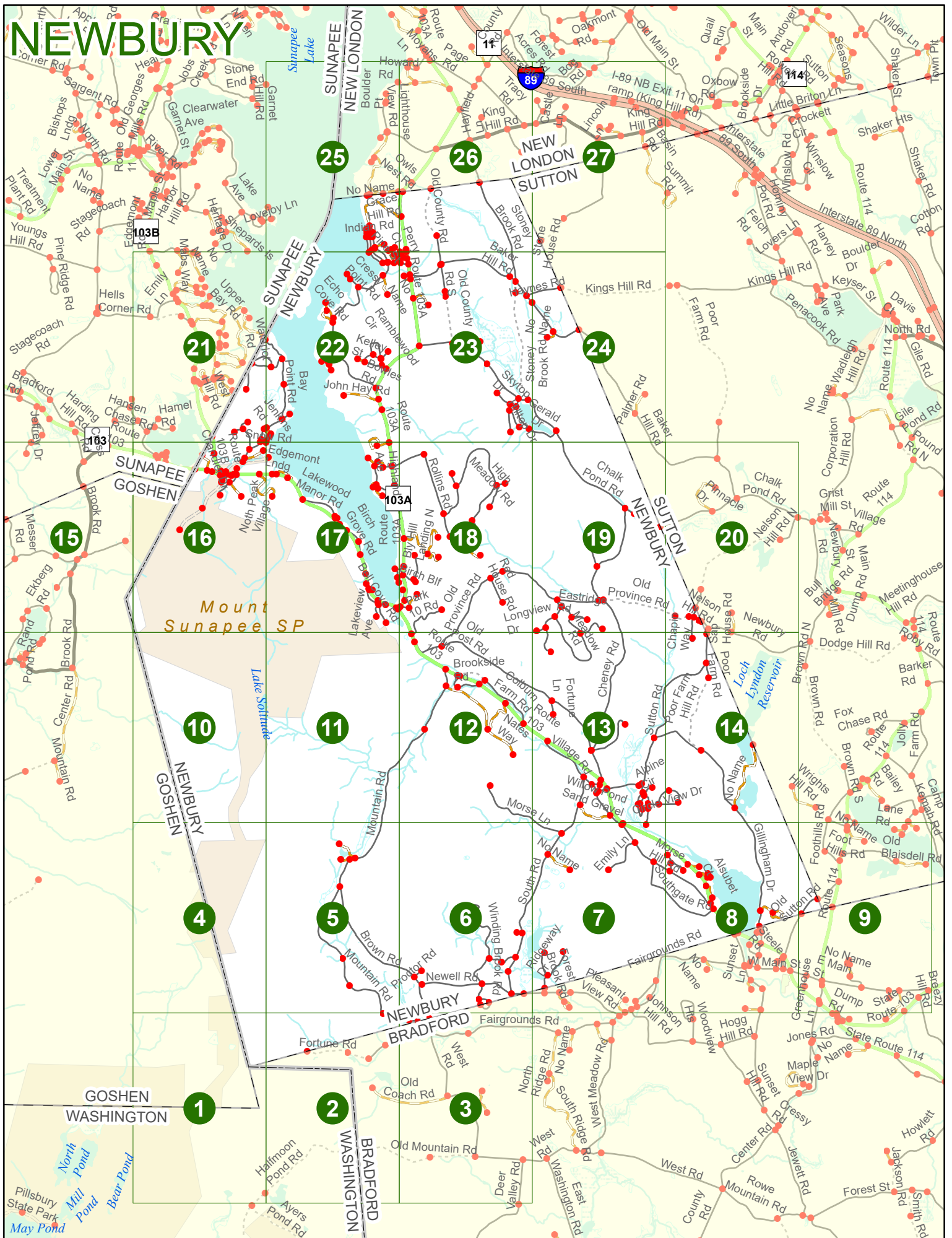

Match to Page 4

# NEWBURY

*Mount Sunapee SP*

NEWBURY  
GOSHEN

BRADFORD  
WASHINGTON

Match to Page 0

# 1

GOSHEN  
WASHINGTON

Match to Page 2

*Pillsbury SP*

*Bear Pond*

Halfmoon Pond Rd 0077  
0286

0 495 990 1,980 Feet

Match to Page 0

# NEWBURY

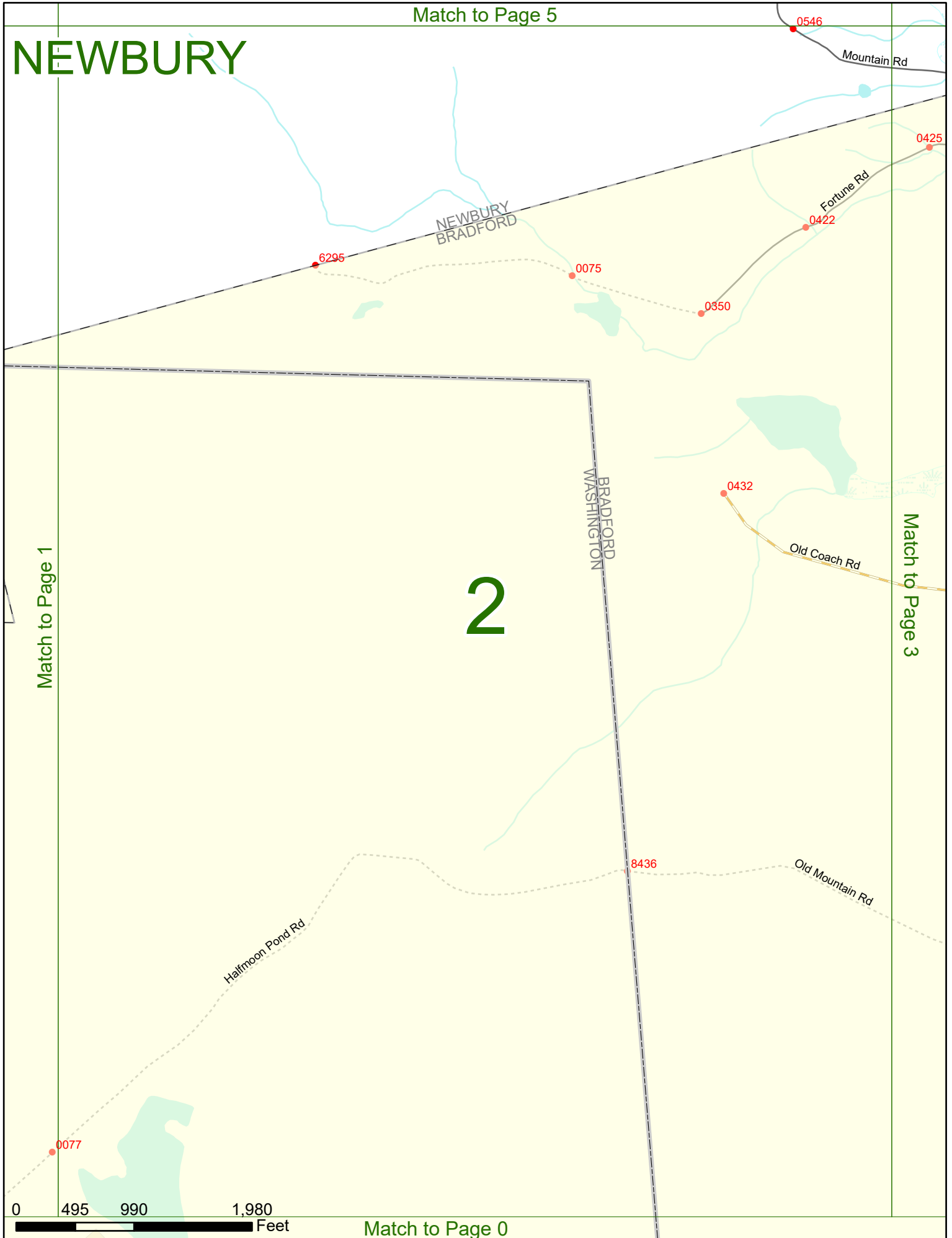

Match to Page 1

Match to Page 3

# 2



# NEWBURY

Match to Page 6

NEWBURY  
BRADFORD

Match to Page 2

Match to Page 0

## 3

0 495 990 1,980 Feet

Match to Page 0

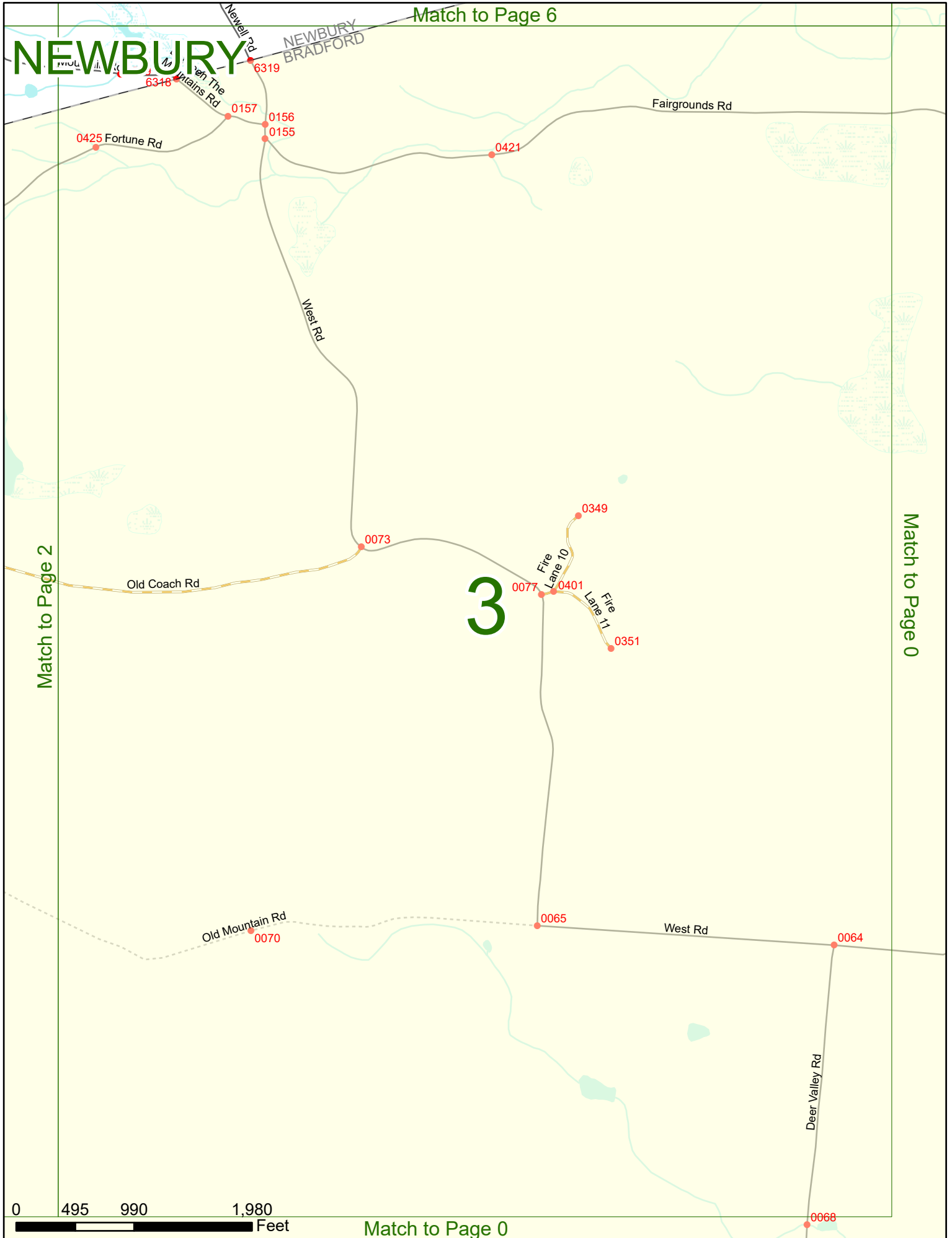

Match to Page 10

# NEWBURY

Match to Page 0

Match to Page 5

4

*Mount  
Sunapee SP*

NEWBURY  
GOSHEN

0 495 990 1,980 Feet

Match to Page 1

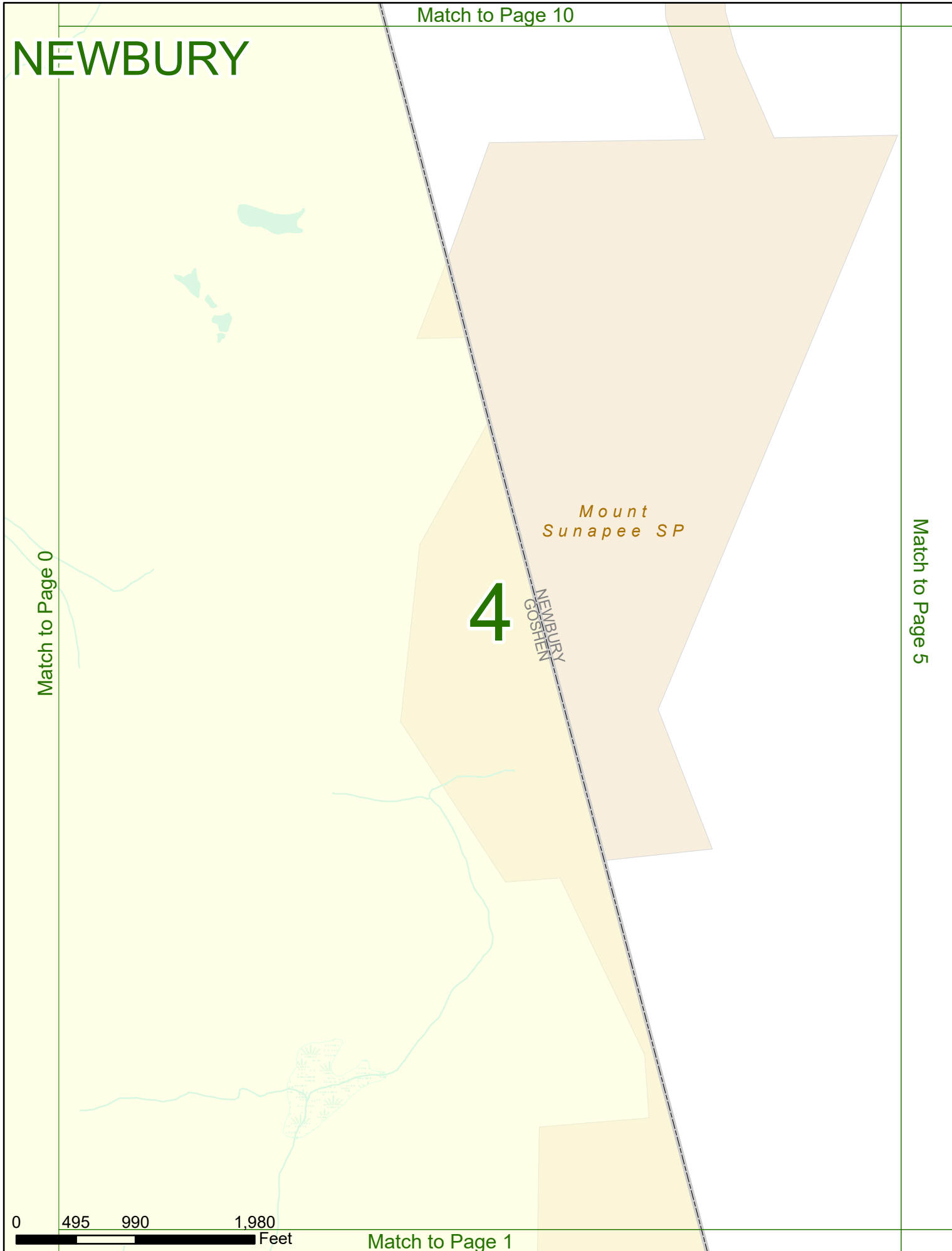

# NEWBURY

Match to Page 4

Match to Page 6

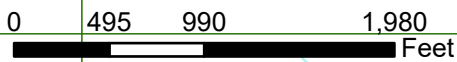
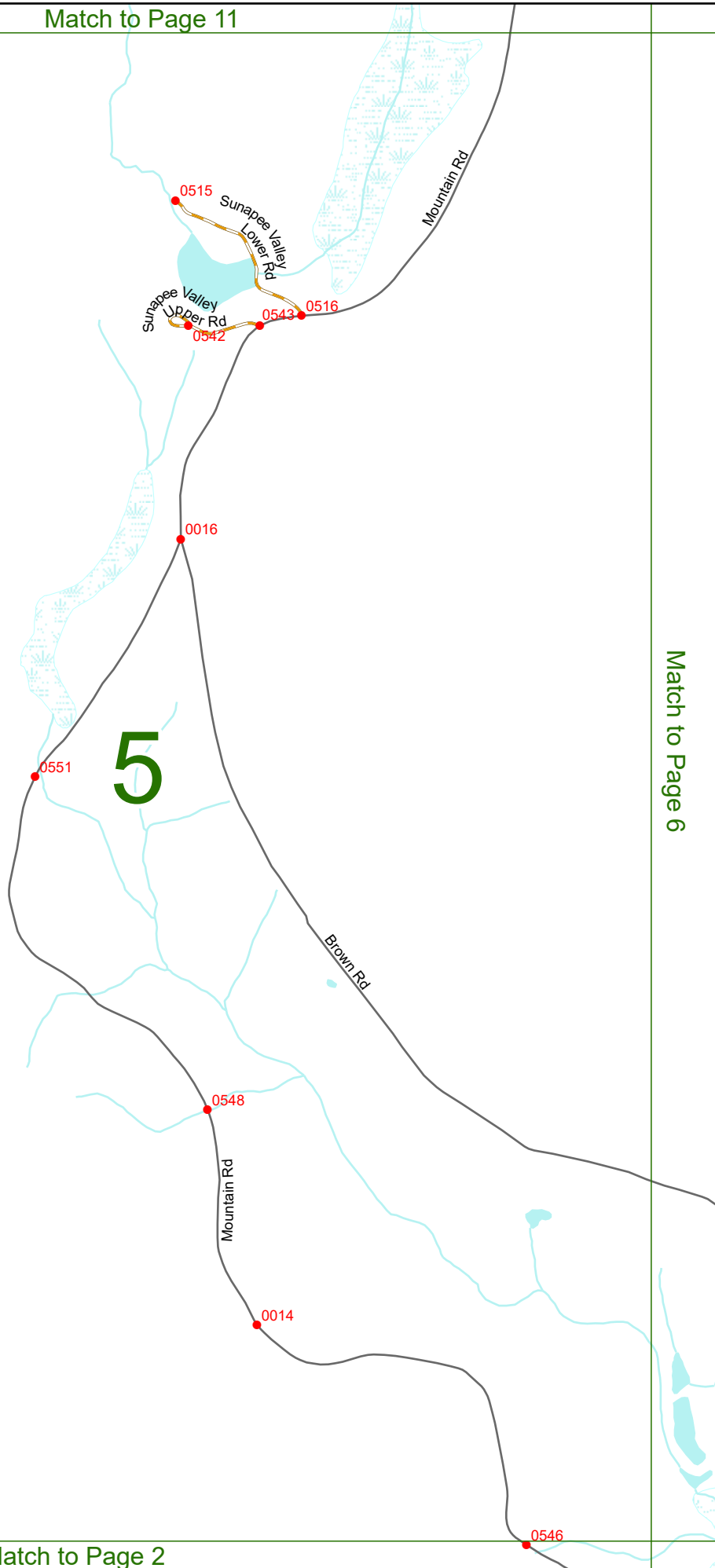



# NEWBURY

Match to Page 5

Match to Page 7

# 6

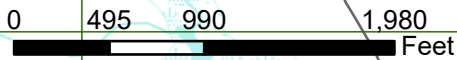
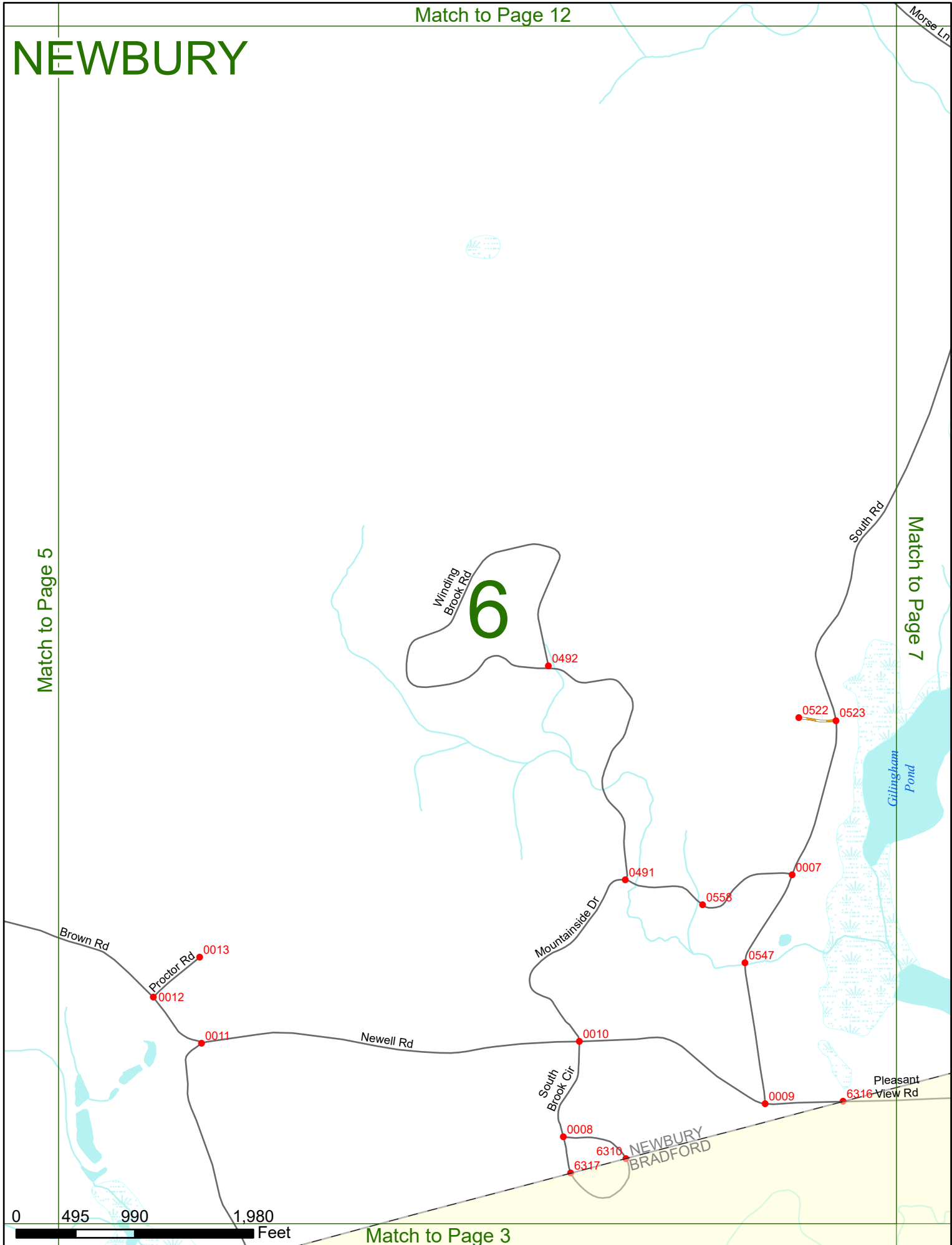

Match to Page 3

NEWBURY  
BRADFORD

Match to Page 13

# NEWBURY

# 7

Match to Page 6

Match to Page 8

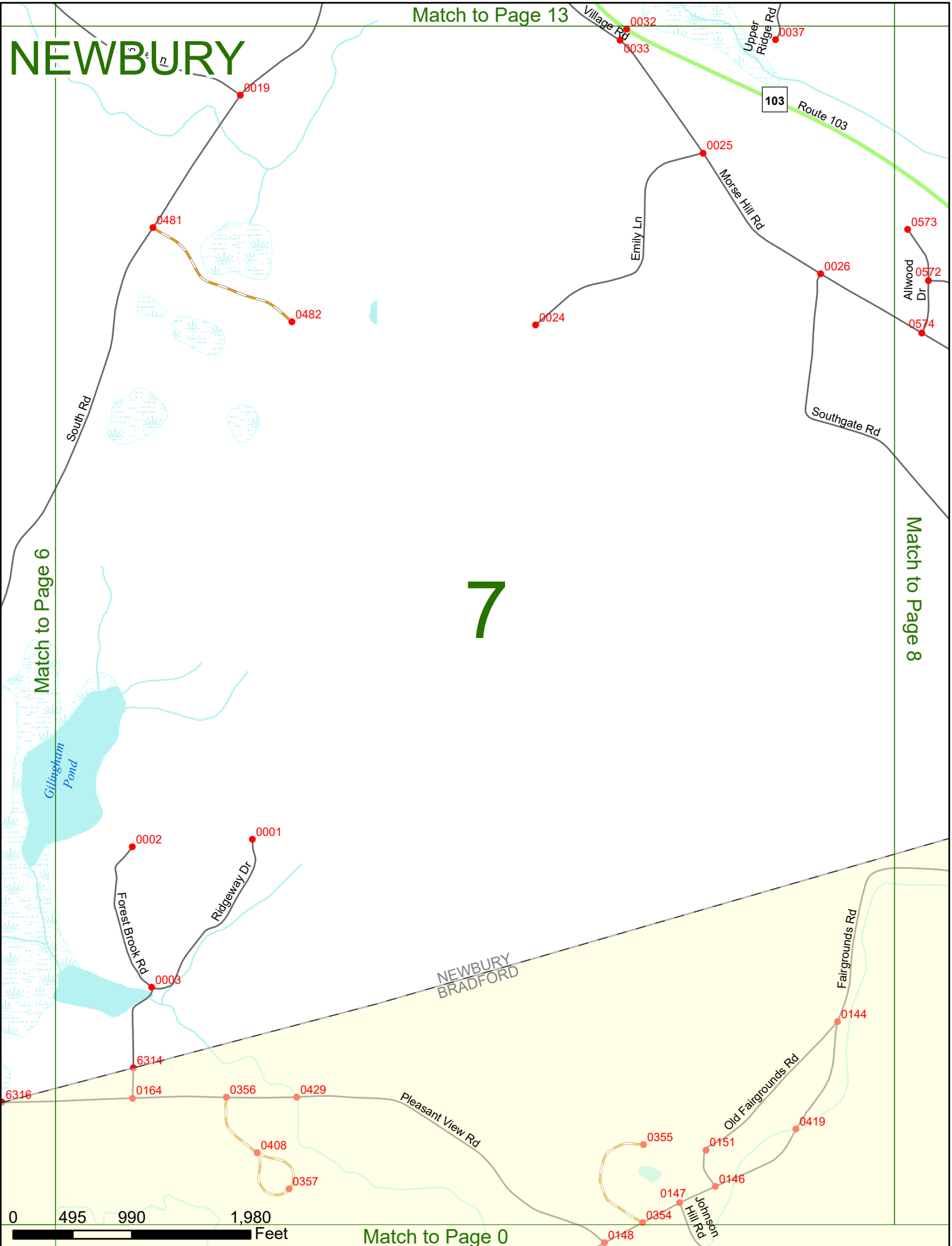

Match to Page 0

# NEWBURY

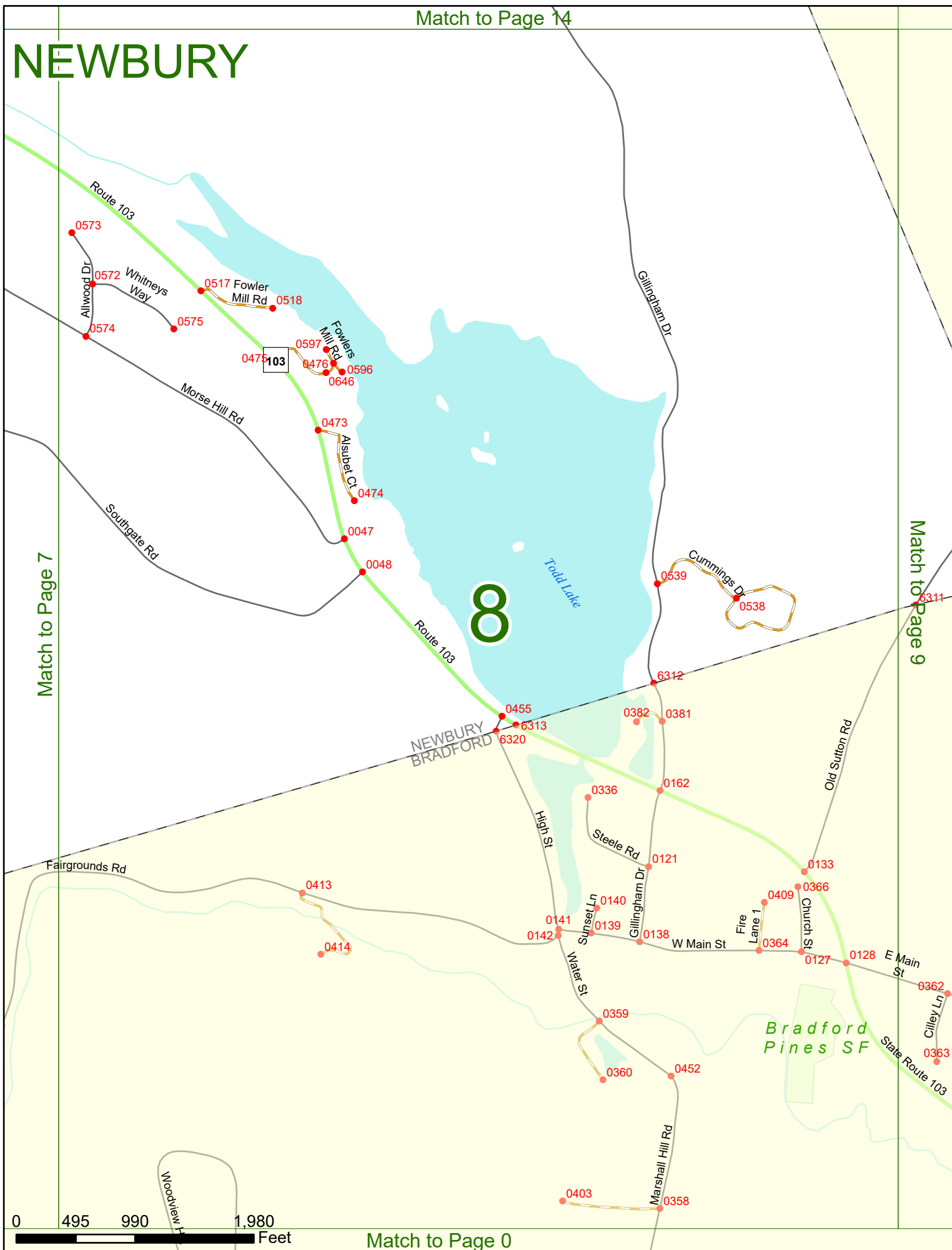

Match to Page 7

Match to Page 9

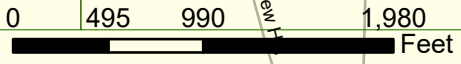

# NEWBURY

Match to Page 0

Match to Page 0

# 9

Match to Page 8

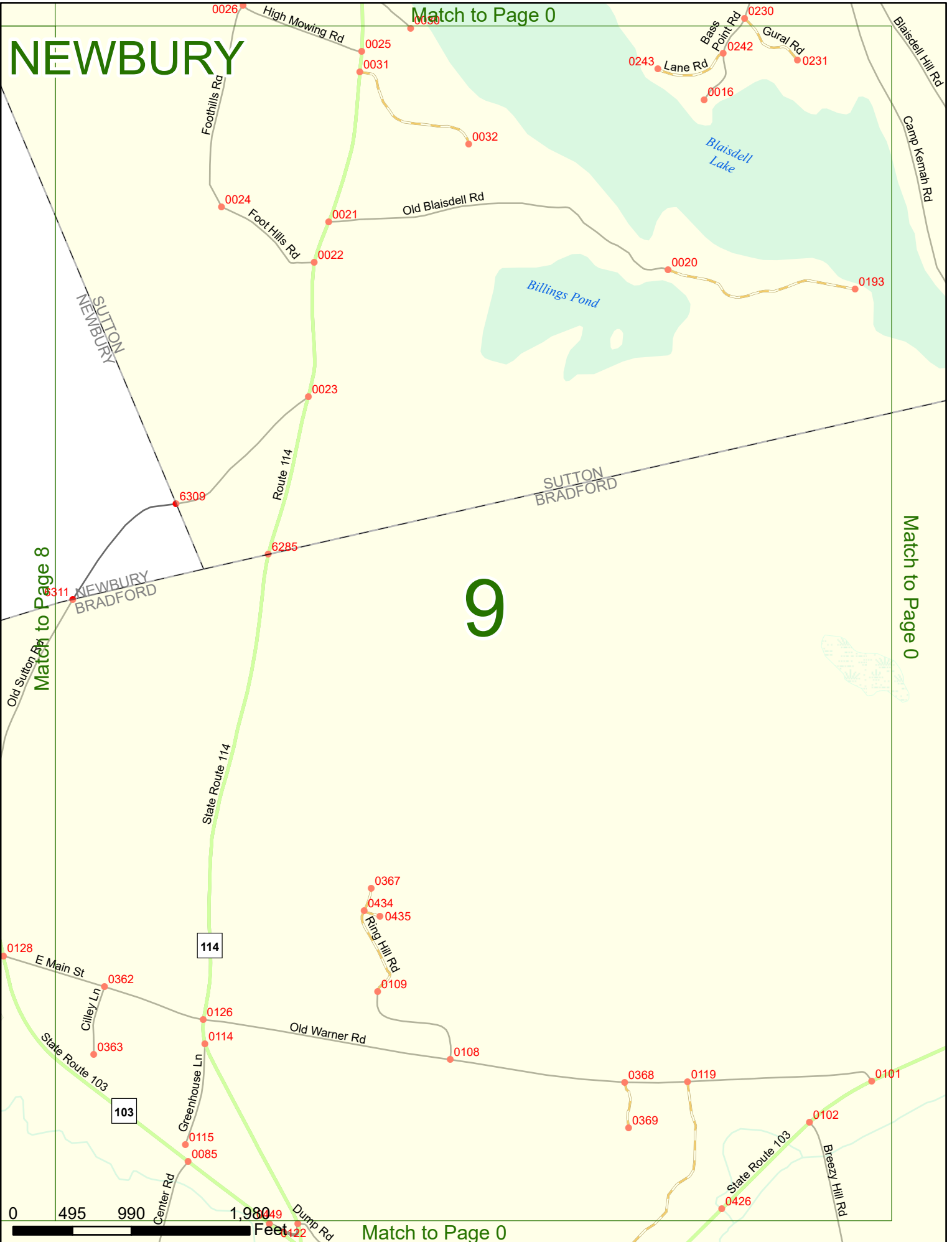

Match to Page 0



Match to Page 16

# NEWBURY

*Mount  
Sunapee SP*

*Lake Solitude*

Match to Page 11

# 10

Match to Page 0

NEWBURY  
GOSHEN

0 495 990 1,980 Feet

Match to Page 4

Match to Page 17

# NEWBURY

*Mount  
Sunapee SP*

*Lake Solitude*

Match to Page 10

# 11

Match to Page 12

Mountain Rd

0 495 990 1,980 Feet

Match to Page 5

# NEWBURY

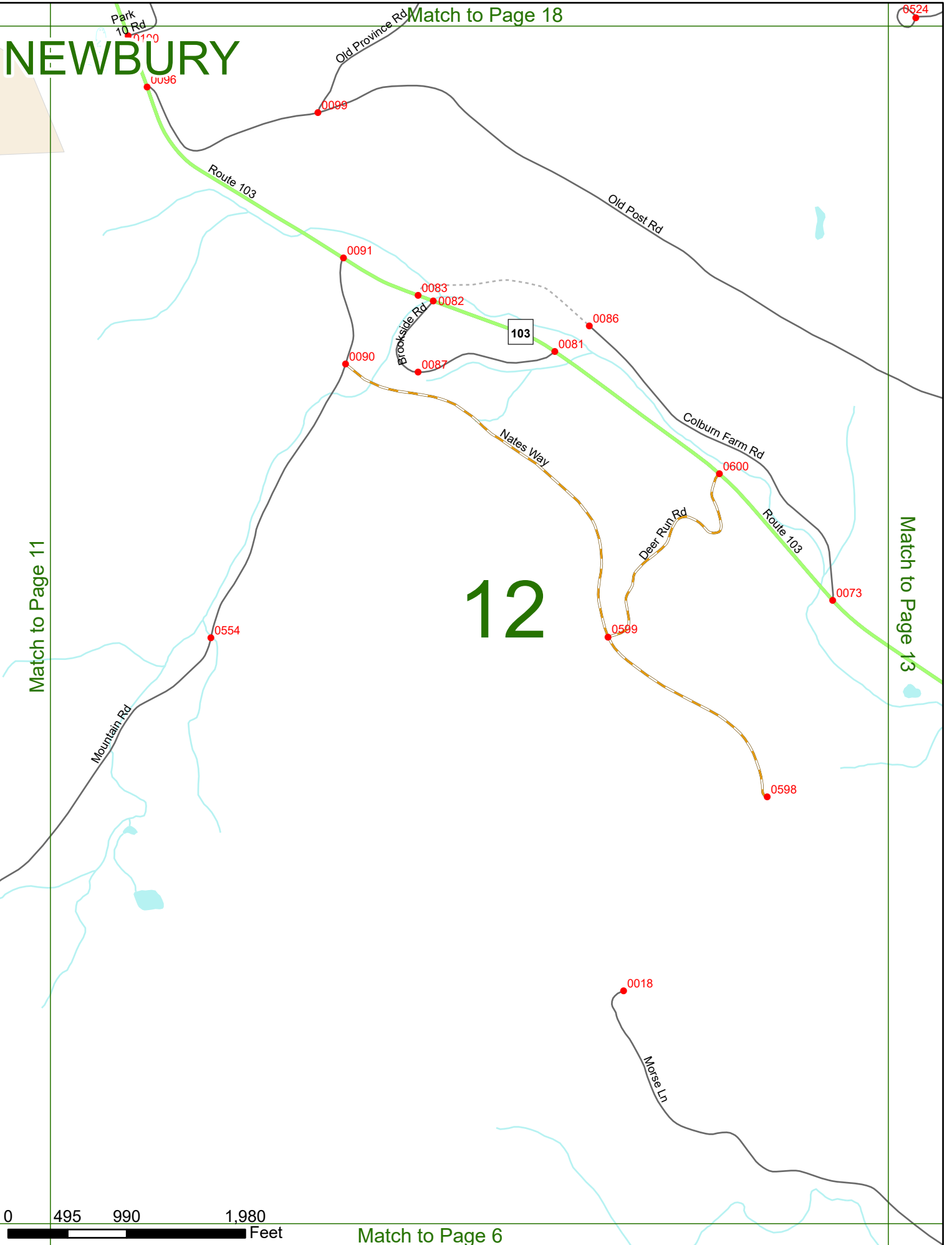

Match to Page 6

# NEWBURY

Match to Page 19

# 13

Match to Page 12

Match to Page 14

Match to Page 7

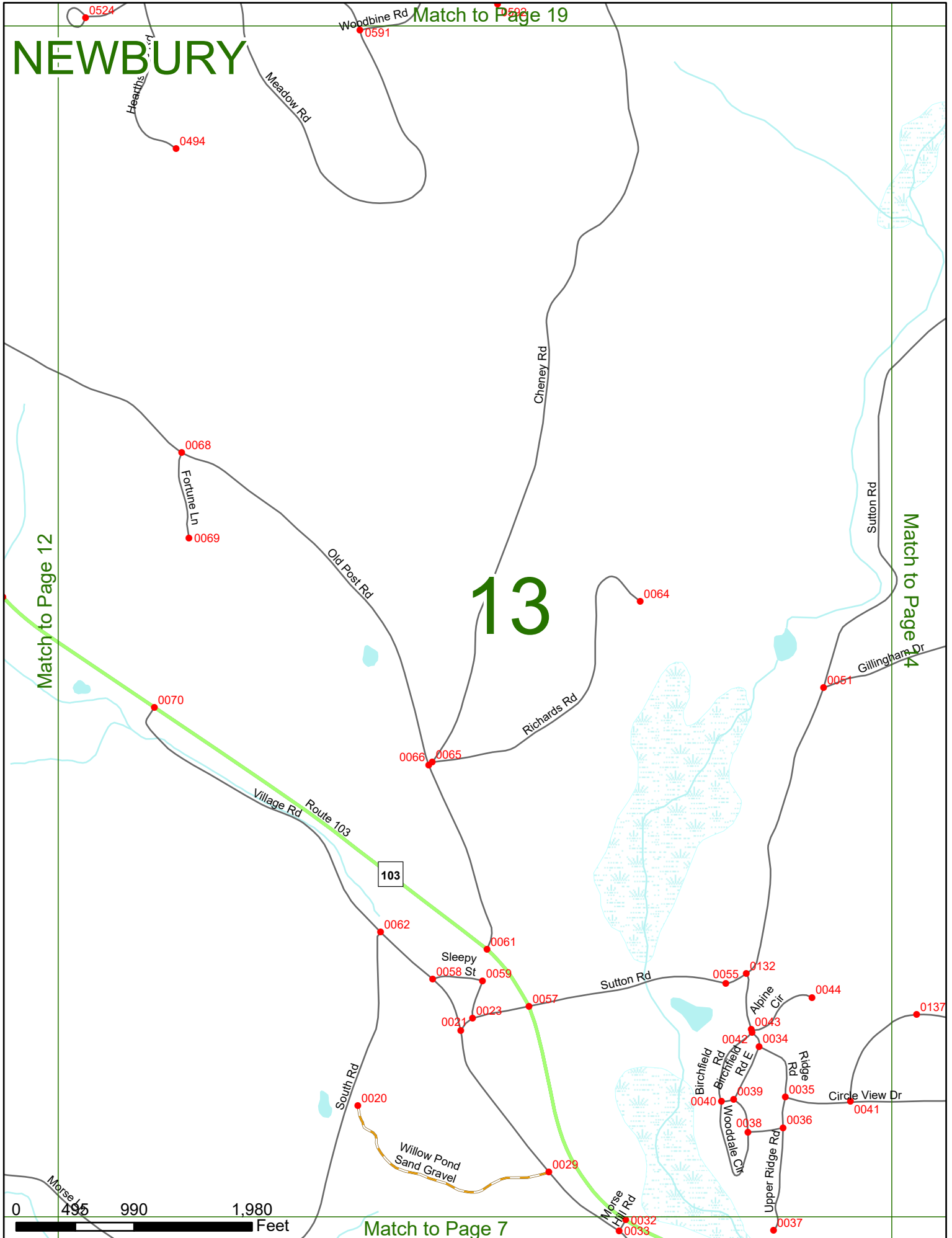



# NEWBURY

Match to Page 20

Match to Page 13

Match to Page 0

Match to Page 8

# 14

SUTTON  
NEWBURY

Loch Lyndon  
Reservoir

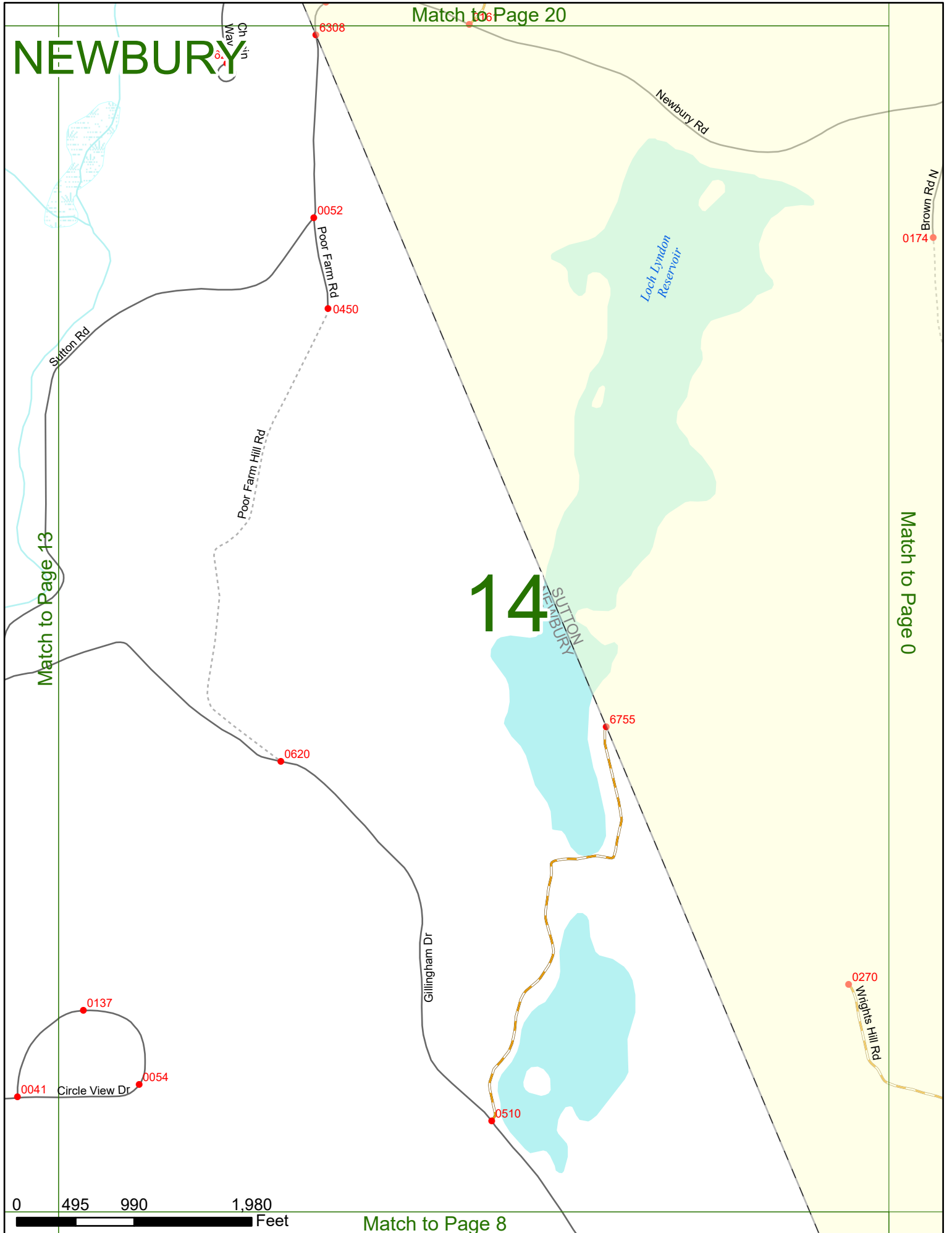

# NEWBURY

Match to Page 0

# 15

Match to Page 0

Match to Page 16

0 495 990 1,980 Feet

Match to Page 0

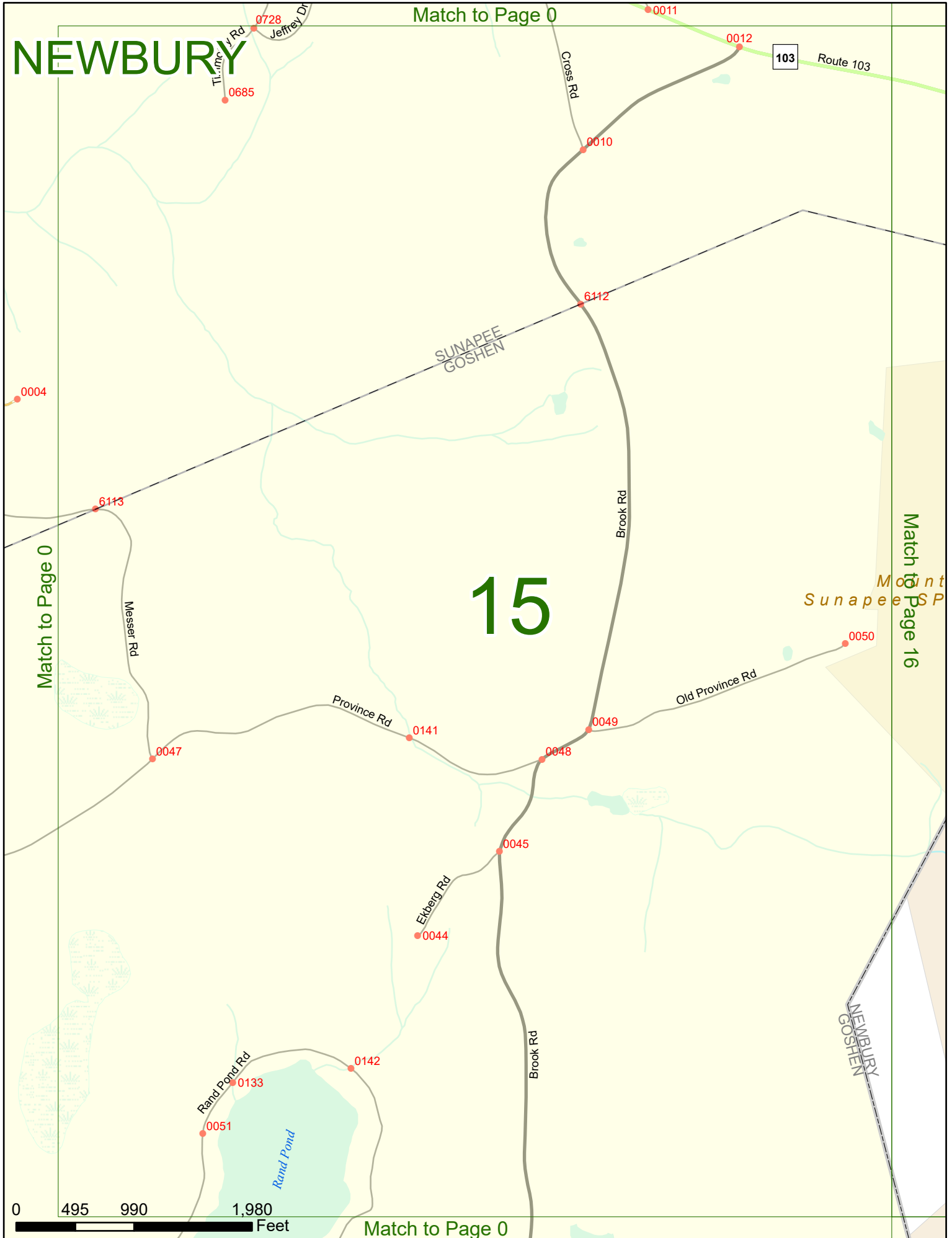

0728 Jeffrey Dr  
0685  
0004

0011  
0012

0010

6112

6113

Mount  
Sunapee SP

0050

0047

0141

0048

0049

0045

0044

0142

0133

0051

Match to Page 21

# NEWBURY

Mountainview Lake

Route 103

Camel Rd

Sunnyside Ter

Sunnyside Dr

0715

0015

0013

0697

0714

0673

0697

0714

0673

8496

103

Chandler Dr

0519

0138

0136

0131

0630

0449

0127

0126

0125

0567

0124

SUNAPEE  
GOSHEN

SUNAPEE  
NEWBURY

0128

0130

0566

0608

0609

0634

0545

Mount Sunapee Rd

0550

0122

# 16

Mount  
Sunapee SP

Sunapee Park Rd

West Province Rd

Johnson Farm Rd

North Peak Village

Beach Access Rd

Old Bay Point Rd

Chandler Brook Rd

Wildwood Rd

Bay Point Rd

Snow Rd

0581

0580

0582

0148

0461

0462

0145

0139

0144

0583

0582

0144

0634

0545

0634

0545

0634

0545

0634

0545

0634

0545

0634

0545

0634

0545

0634

0545

0634

0545

0634

0545

0634

0545

0634

0545

0634

0545

0634

0545

0634

0545

0634

0545

0634

0545

0634

0545

0634

0545

0634

0545

0634

0545

0634

0545

0634

0545

0634

0545

0634

0545

0634

0545

0634

0545

0634

0545

0634

0545

0634

0545

0634

0545

0634

0545

0634

0545

0634

0545

0634

0545

0634

0545

0634

0545

0634

0545

0634

0545

0634

0545

0634

0545

0634

0545

0634

0545

0634

0545

0634

0545

0634

0545

0634

0545

0634

0545

Match to Page 15

Match to Page 17



Match to Page 10

Match to Page 22

# NEWBURY

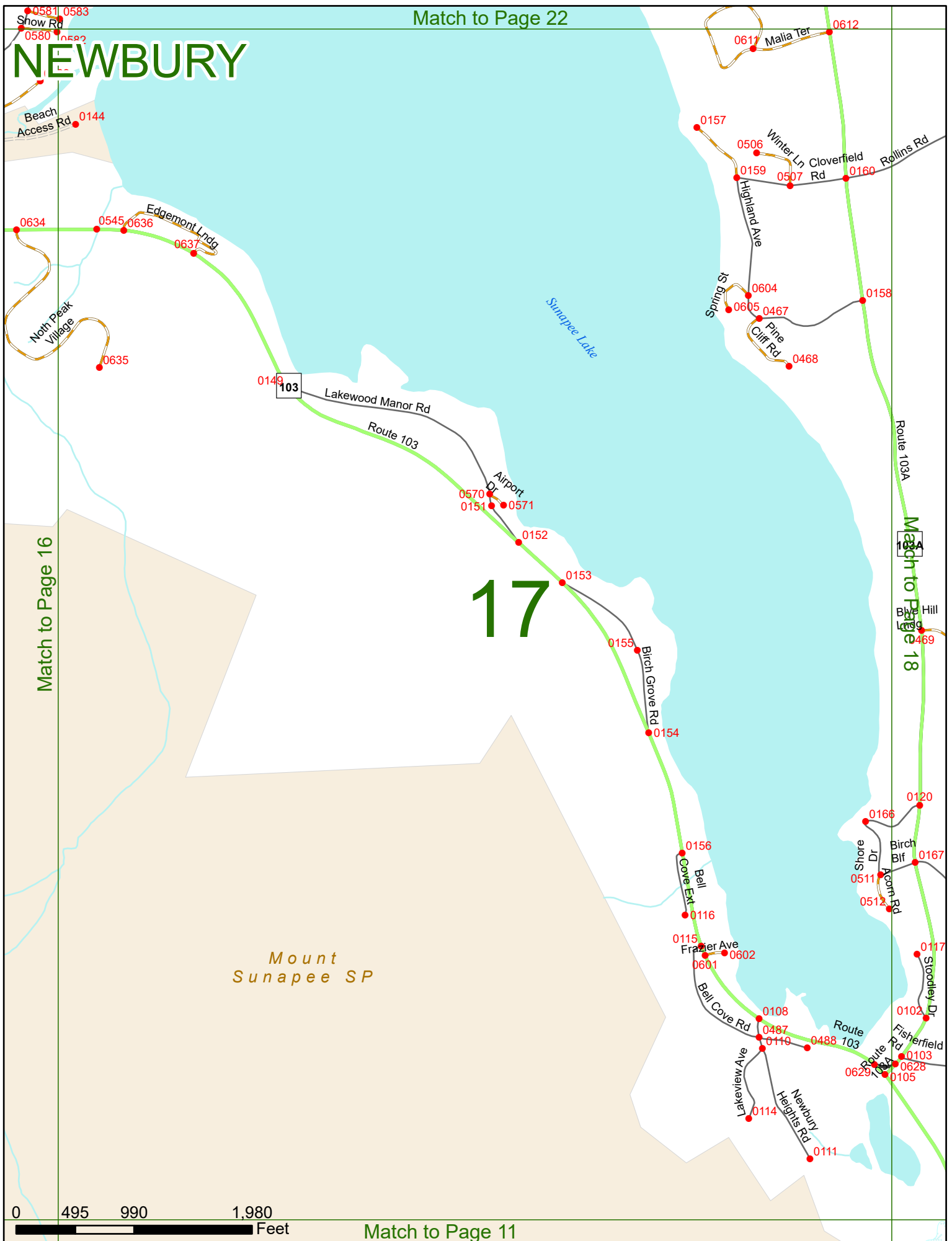

Match to Page 16

Match to Page 18

# 17

Mount Sunapee SP



Match to Page 11

# NEWBURY

# 18

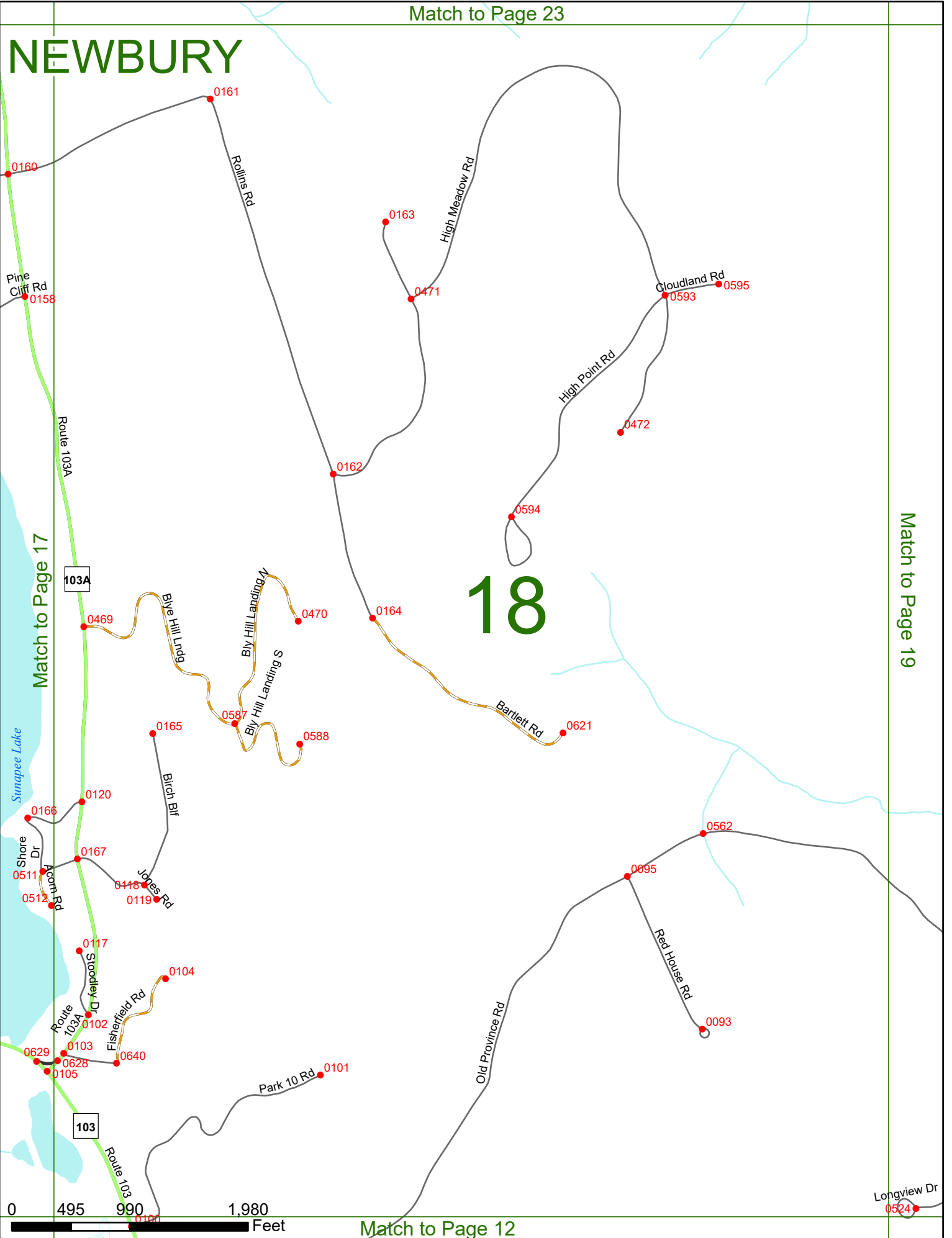

# NEWBURY

# 19

Match to Page 18

Match to Page 20

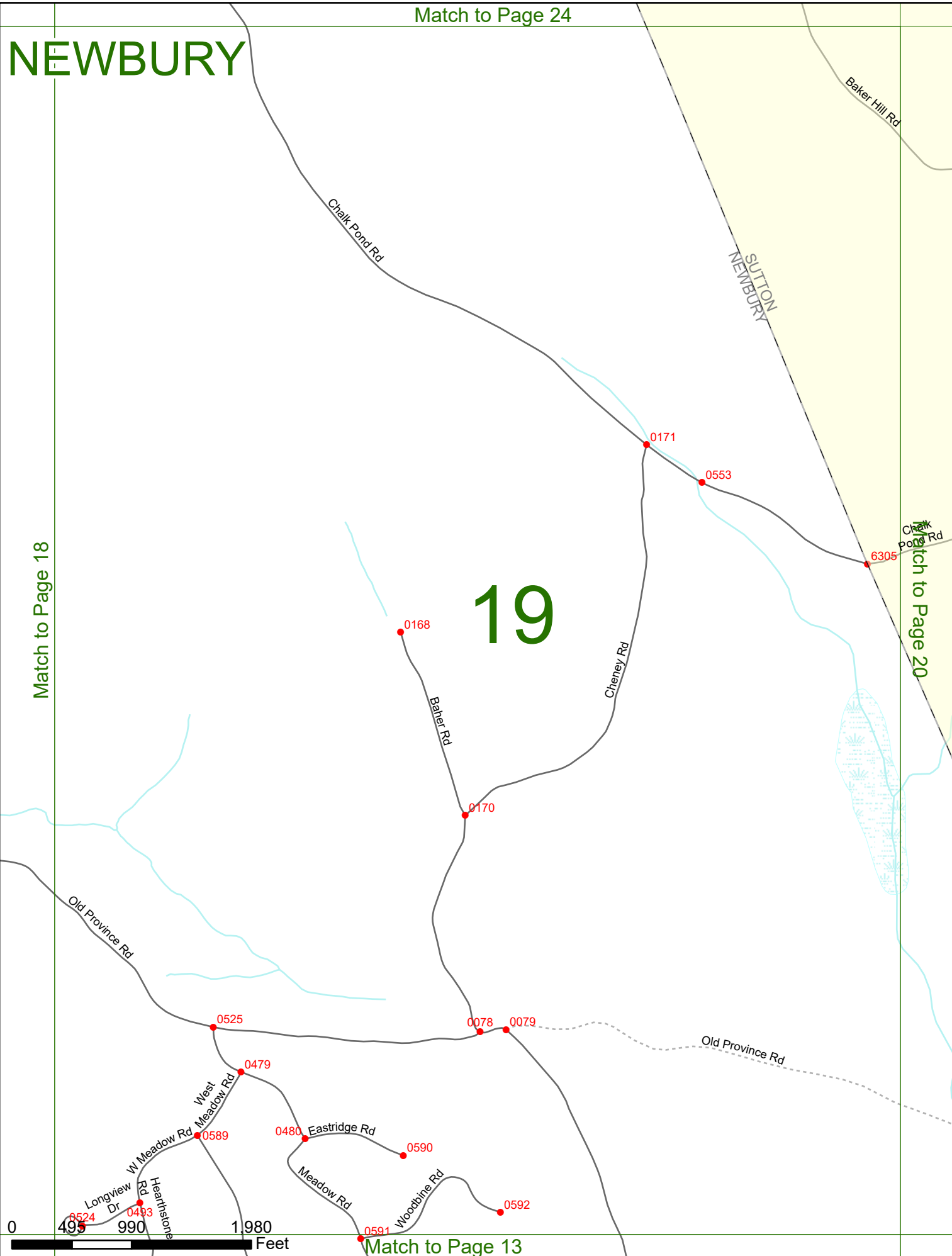

Match to Page 0

# NEWBURY

# 20

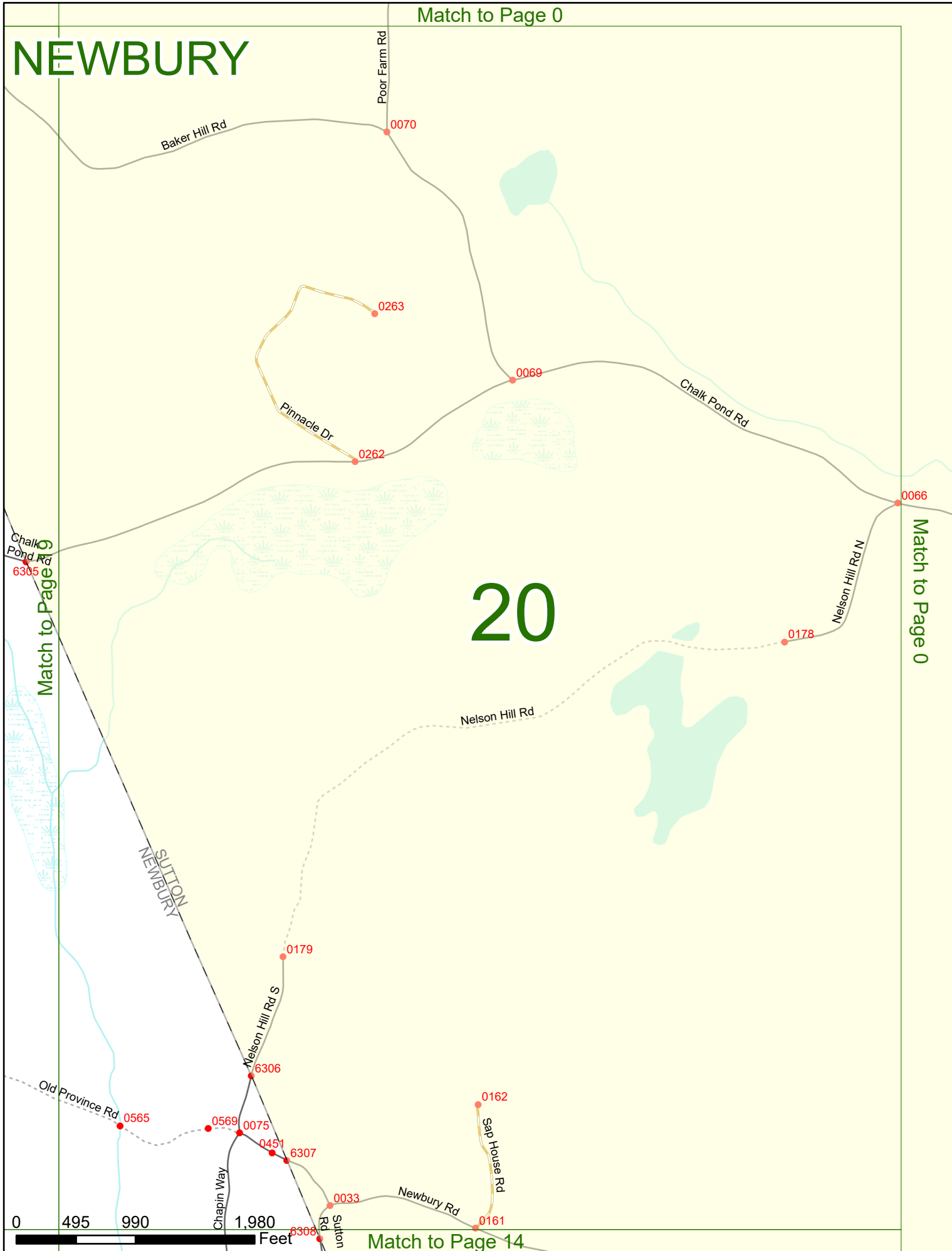

Match to Page 9

Match to Page 0

Match to Page 14

0 495 990 1,980 Feet

# NEWBURY

Match to Page 0

# 21

Match to Page 0

Match to Page 22

Match to Page 16

0 495 990 1,980 Feet

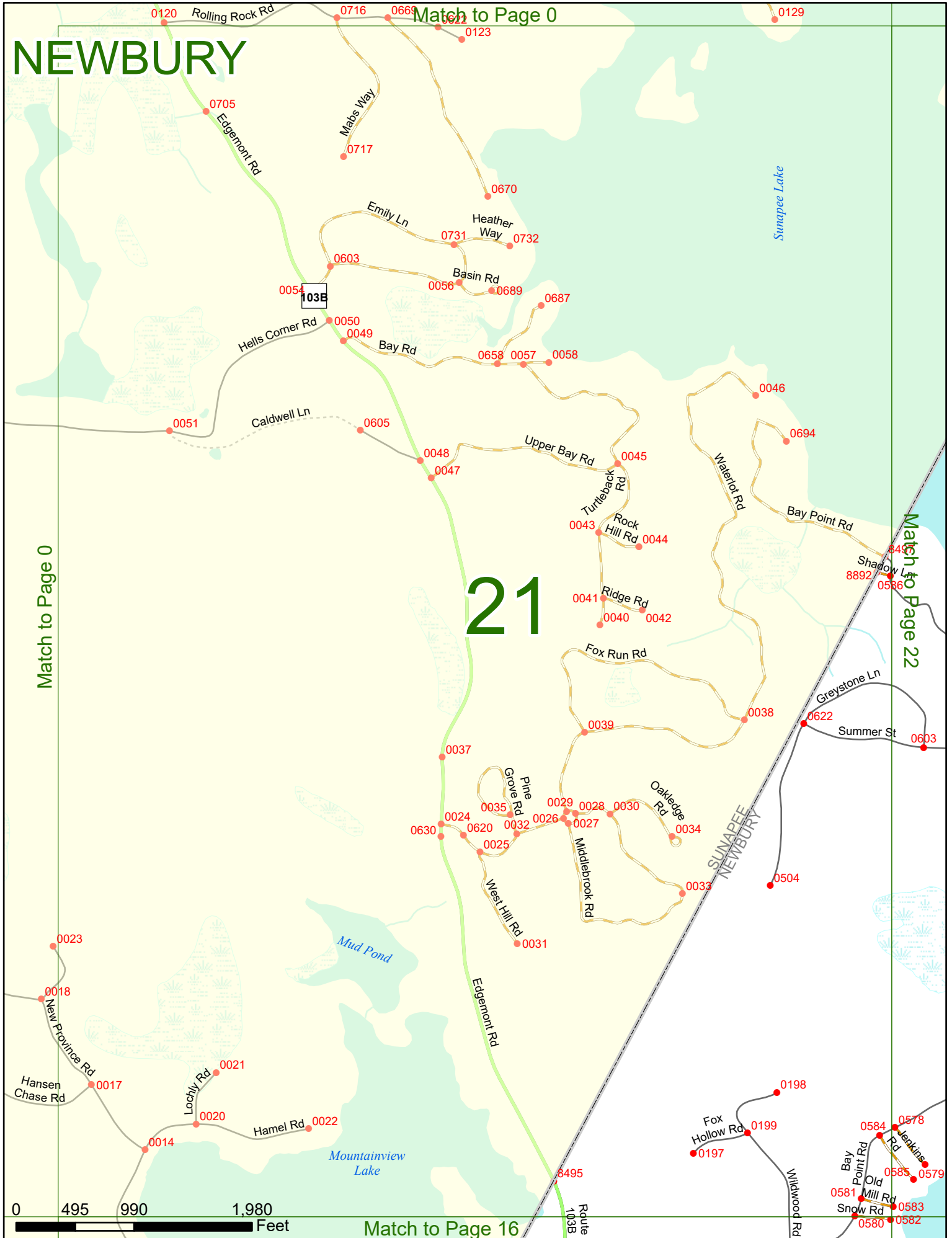



Match to Page 25

# NEWBURY

SUNAPEE  
NEWBURY

# 22

Match to Page 23

Match to Page 21

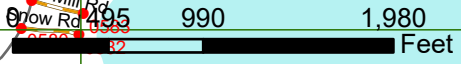
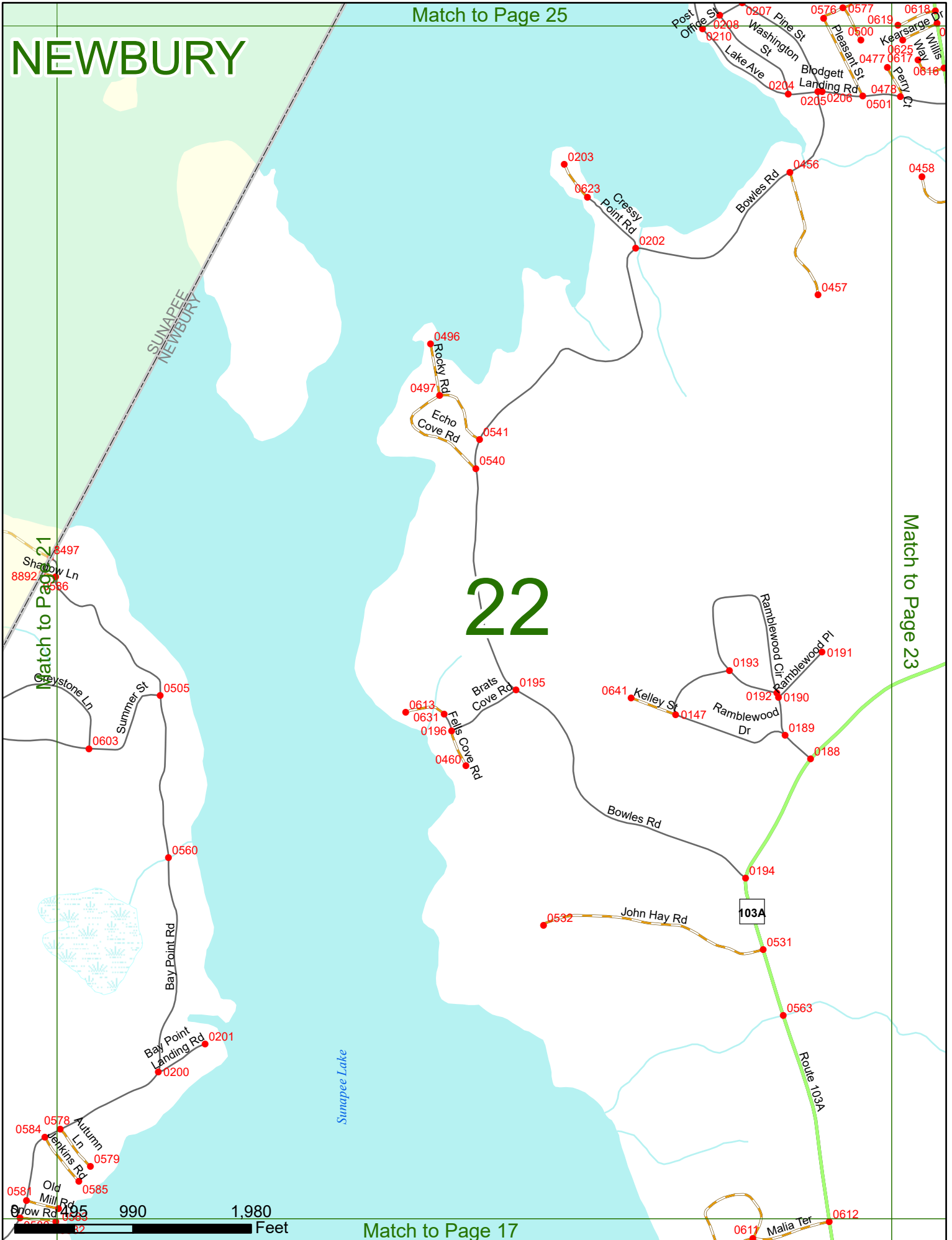

Match to Page 17

Match to Page 26

# NEWBURY

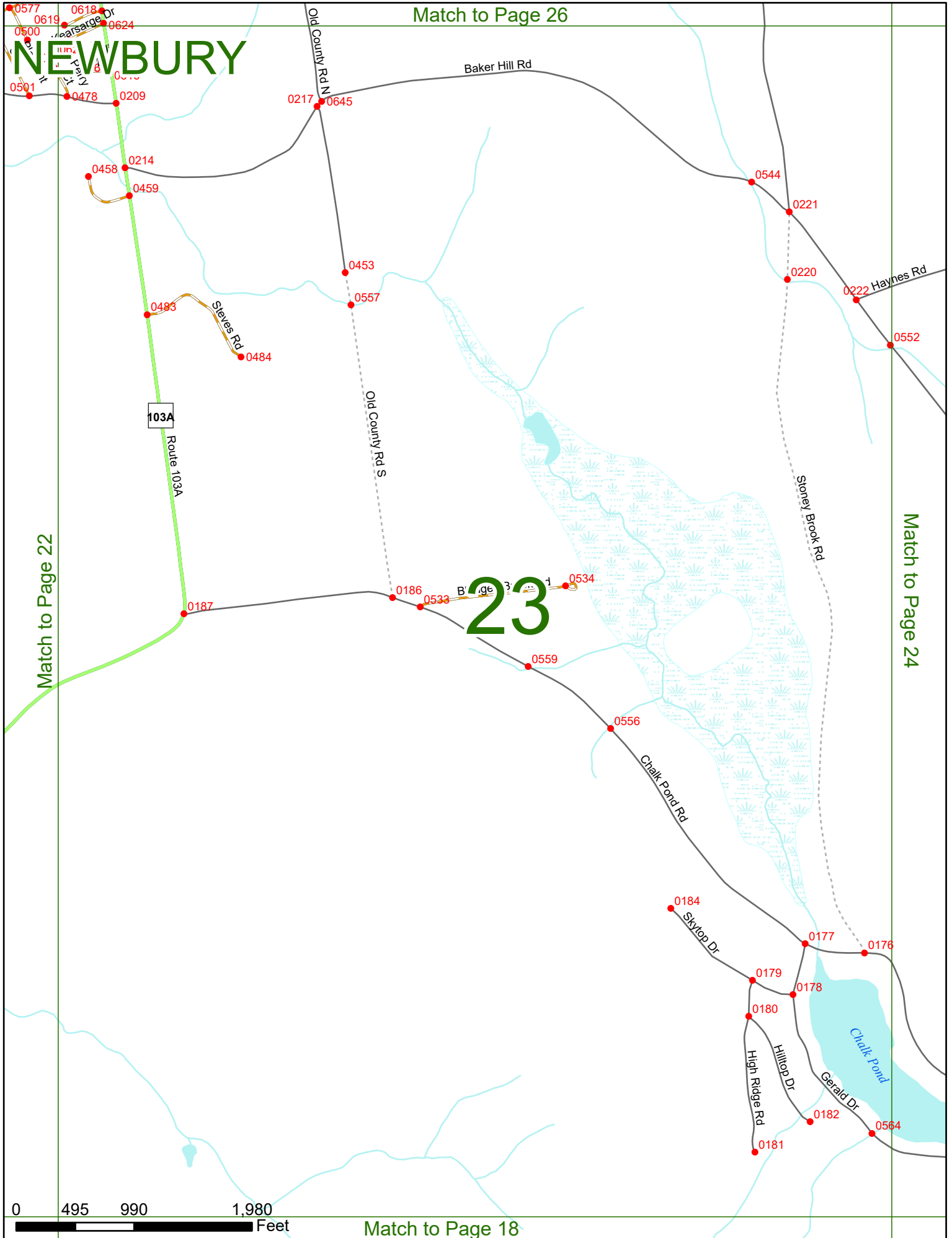

# 23

Match to Page 22

Match to Page 24



Match to Page 18

# NEWBURY

# 24

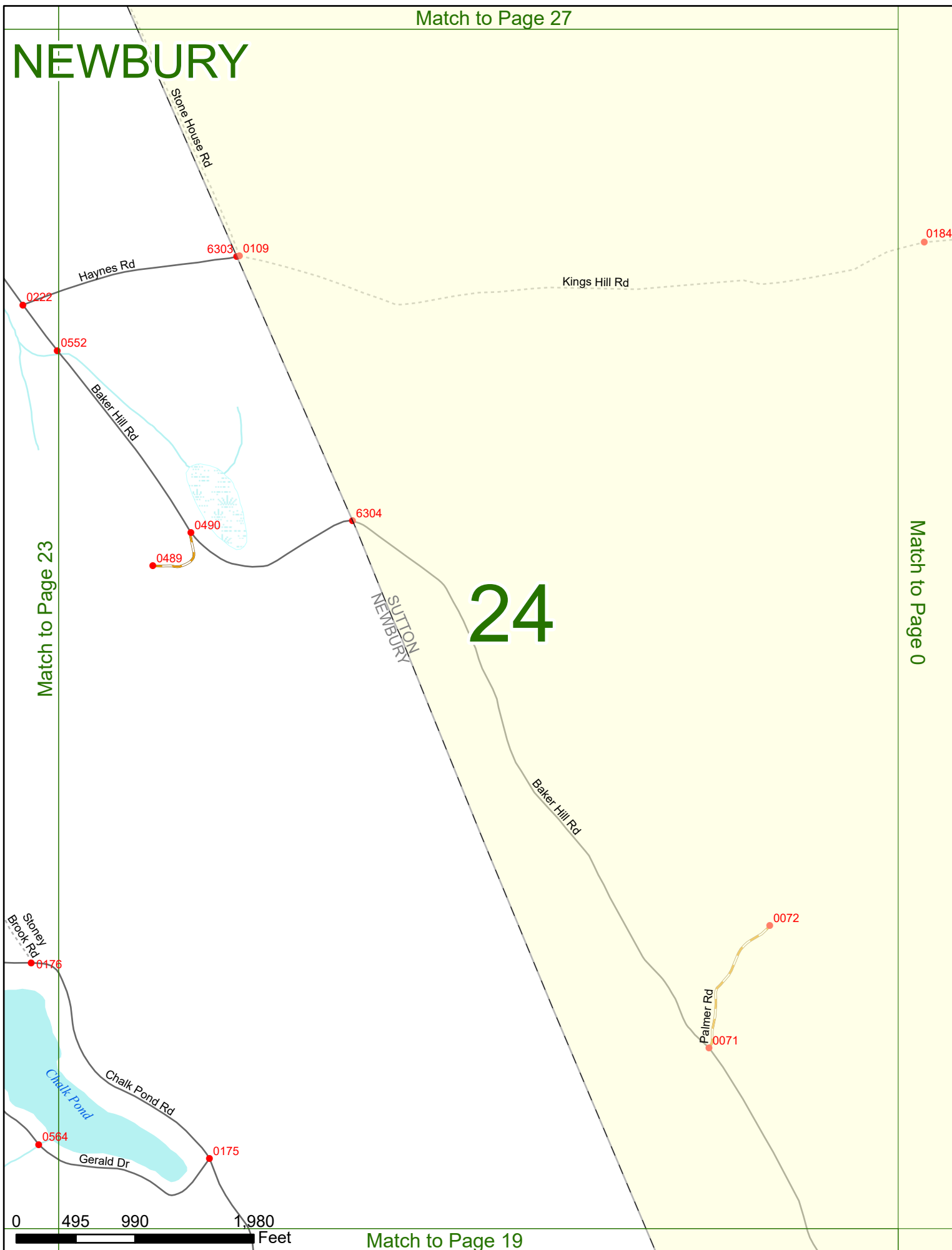

Match to Page 23

Match to Page 0

# NEWBURY

Stone End Rd  
0284

Howard Rd  
0553

Hastings Landing Rd

Boulder Pt  
0443  
0032  
0444

Lighthouse View Rd

0375 0305  
0376

Soo Nipi Park Rd

Pike Brook Rd  
0374  
0398  
0555

Match to Page 26

Match to Page 0

# 25

Sunapee Lake

SUNAPEE  
NEW LONDON

NEW LONDON  
NEWBURY

SUNAPEE  
NEWBURY

Owls Nest Rd

6756 0328 6757 6791 6300

Grace Hill Rd

103A

Route 103A

Birch Point Ln  
0134  
0133  
0135  
0136

Maple Way 0526  
Indian 0610  
Lakeside Rd 0536  
0606  
Sunlite Ln 0607  
0537  
0211 0615

Post Office St 0208  
0210  
Orchard St 0495  
0207  
Pine St 0576  
0577  
Pleasant St 0644  
Weslmo Dr 0619  
Woodsum Dr 0625  
Kearsarge Dr 0625

0 495 990 1,980 Feet

Match to Page 22

# NEWBURY

Match to Page 0

# 26

Match to Page 25

Match to Page 27

NEW LONDON  
NEWBURY

NEW LONDON  
SUTTON

SUTTON  
NEWBURY

Match to Page 23

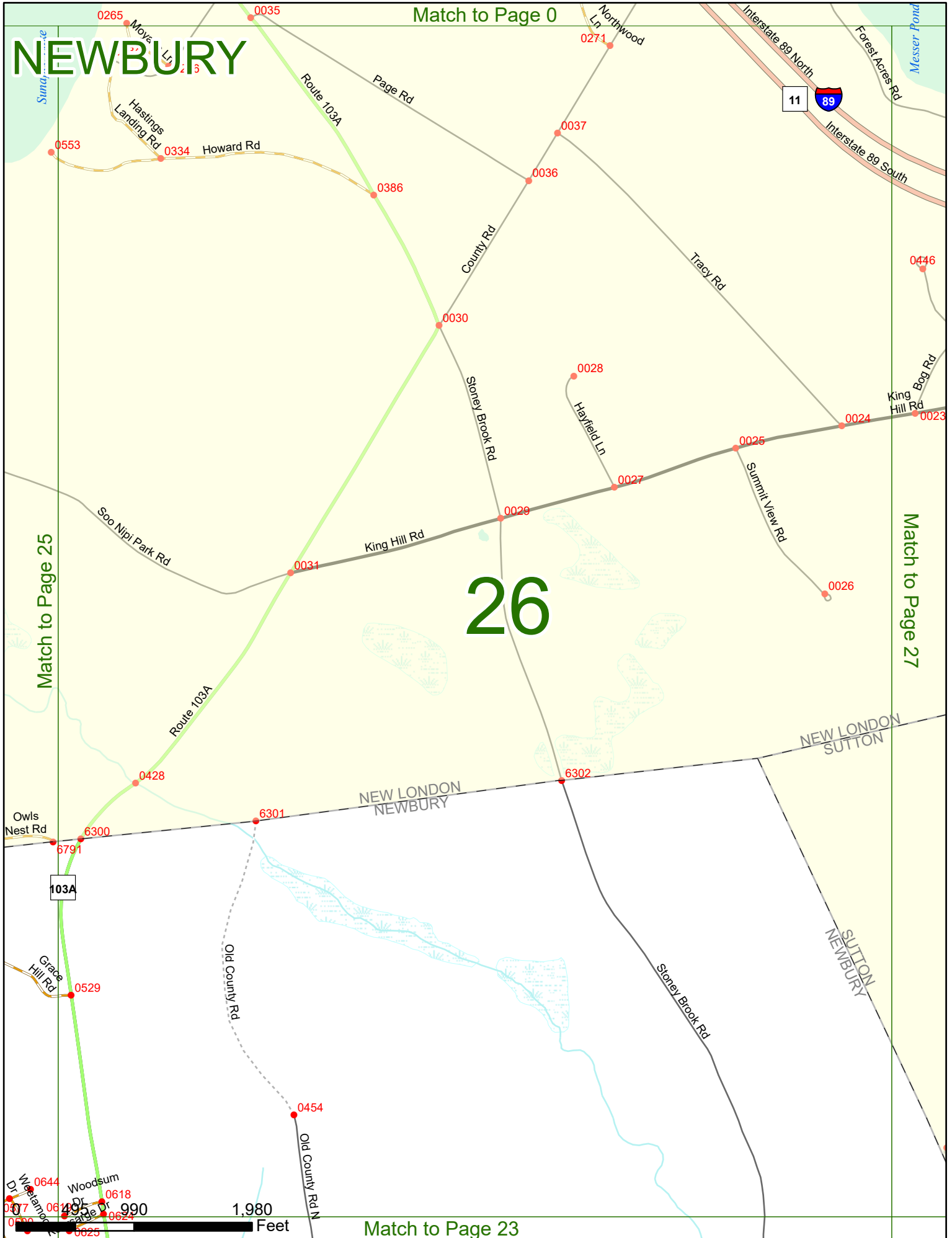

# NEWBURY

Match to Page 0

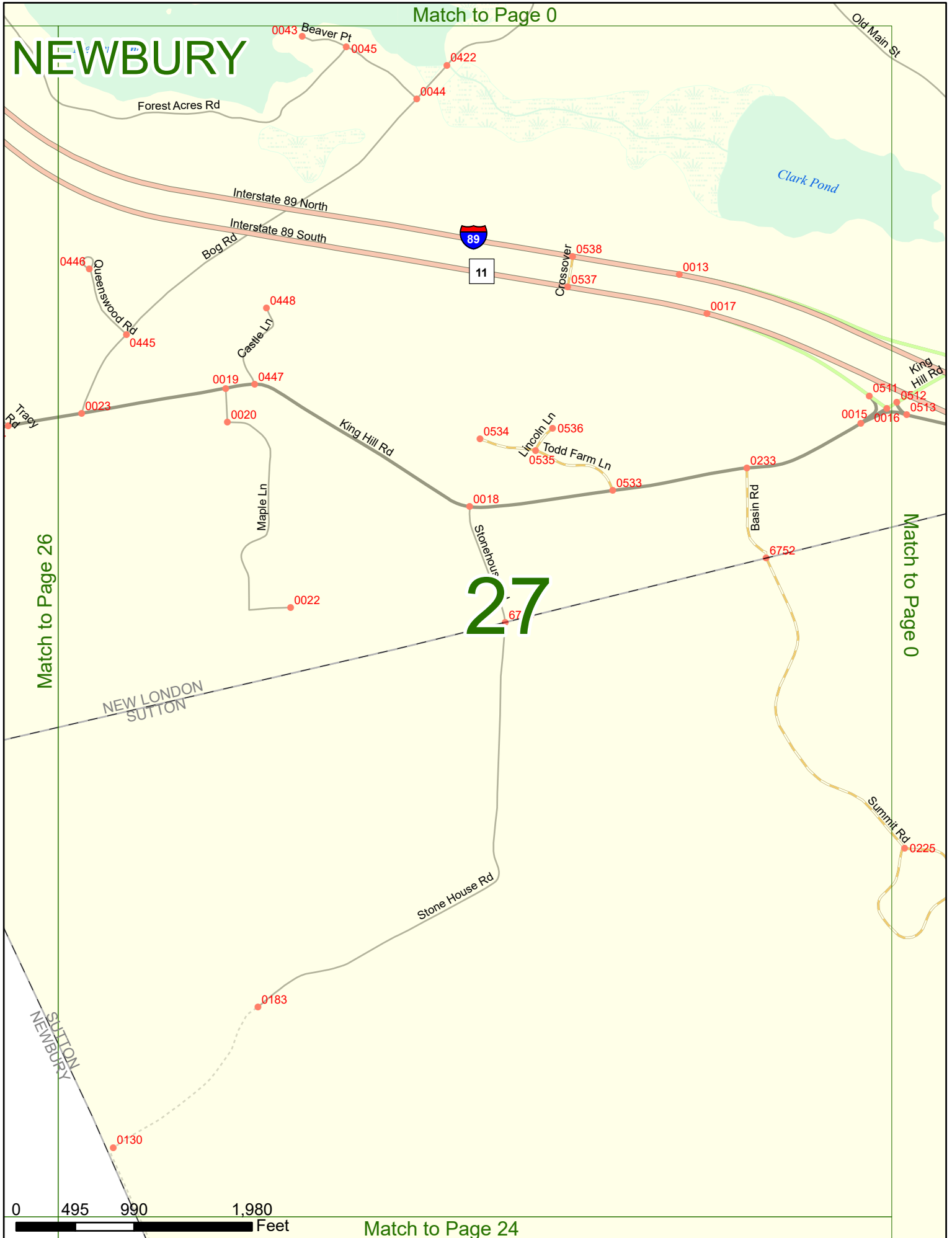

# 27

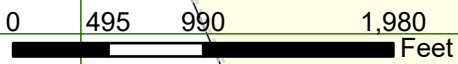

Match to Page 24