



Maps and data sets are not guaranteed to be free from errors and omissions. Data is in a constant state of update and correction by various groups and agencies. Information displayed on this map is the best available at the time of publication.

2025 Nodal Reference Bookmap

LEGEND



NHDOT will accept crash locations based on the State of NH Uniform Police Traffic Accident Report.

Crash occurred on:

Option 1 Street Address
 123 Main Street

Option 2 Route No and/or Distance from NESW Intesecting Road, Bridge,
 Street name Intersecting Street Town/County line
 Main Street 500 E Oak Street

Option 3 First Node Distance from First Node Second Node
 515 212 632

Option 4 Route No and/or Mile Marker on Interstate Only NESW Mile (Marker)
 Street name
 189S 700 feet S 36.8

Option 3 – Example

Street Name Loudon Road
First Node 803
Distance from First Node 318 Ft
Second Node 813



FITZWILLIAM

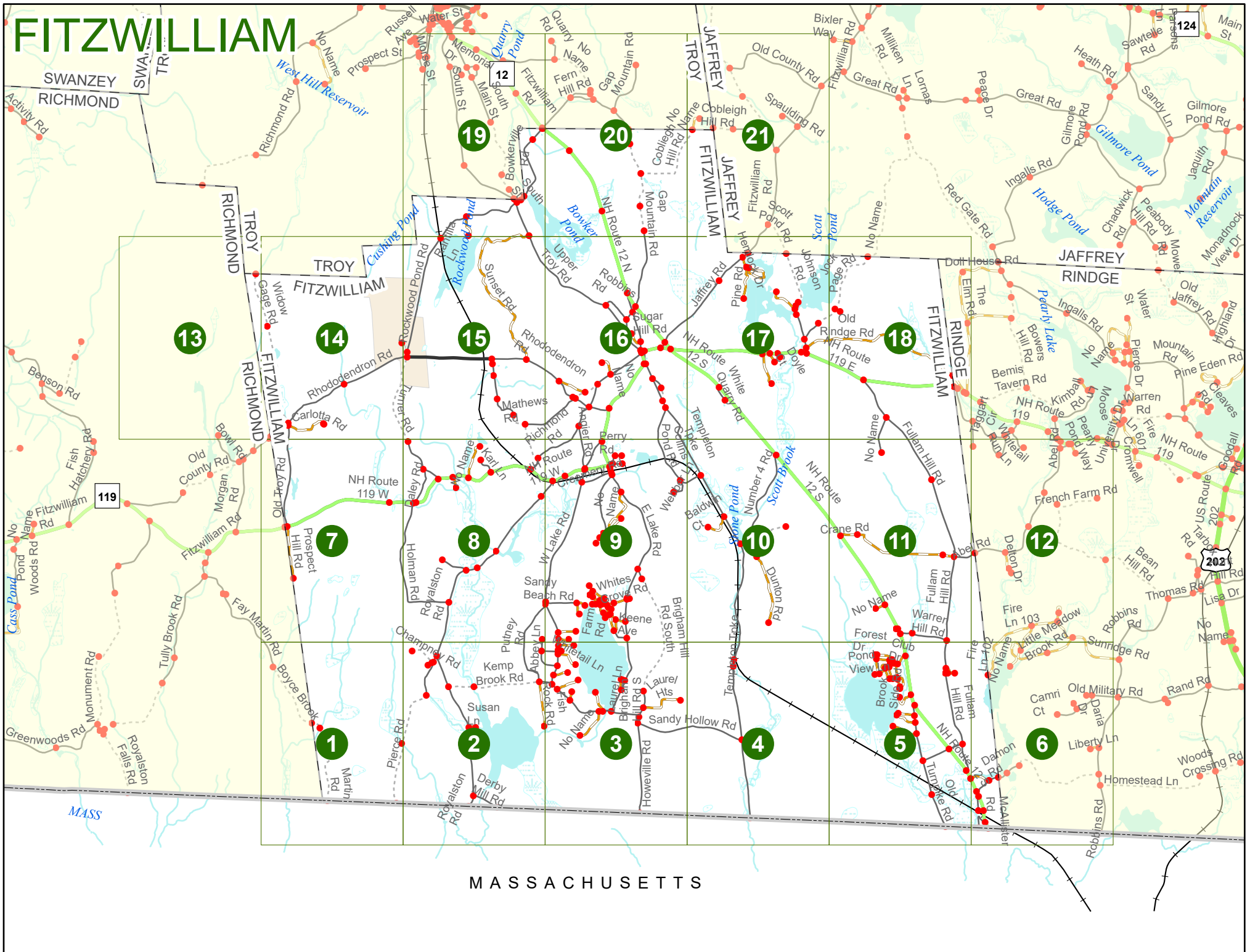

MASSACHUSETTS

Match to Page 7

FITZWILLIAM

747 Martin Rd

0051

Boyce Brook

FITZWILLIAM
RICHMOND

6110

0529

1

Martin Rd

8453

Pierce Rd

8452

Match to Page 2

0021

Match to Page 0

MASSACHUSETTS

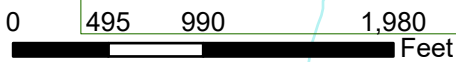

Match to Page 0

FITZWILLIAM

Match to Page 8

Match to Page 1

Match to Page 3

2

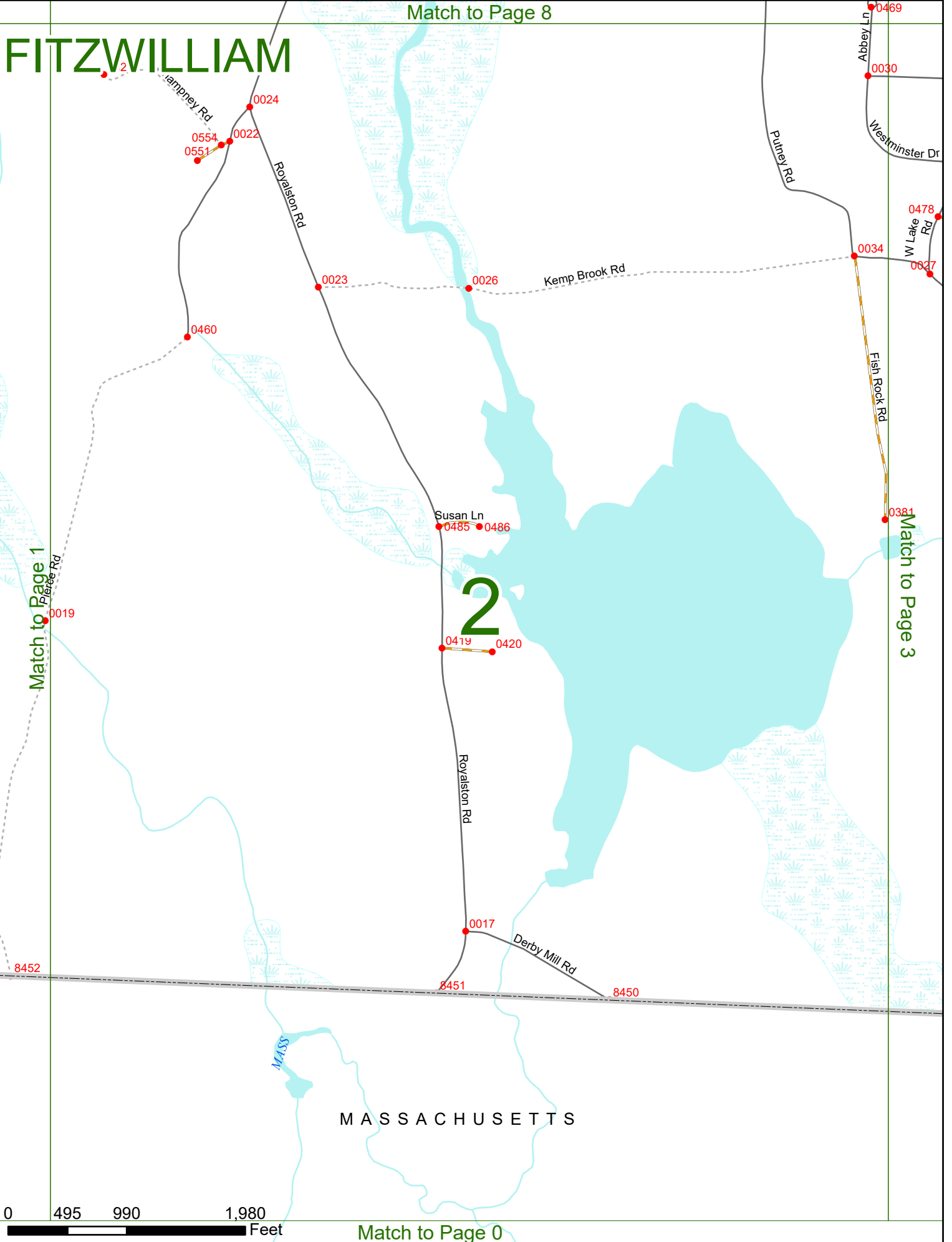

MASSACHUSETTS

0 495 990 1,980 Feet

Match to Page 0

Match to Page 9

FITZWILLIAM

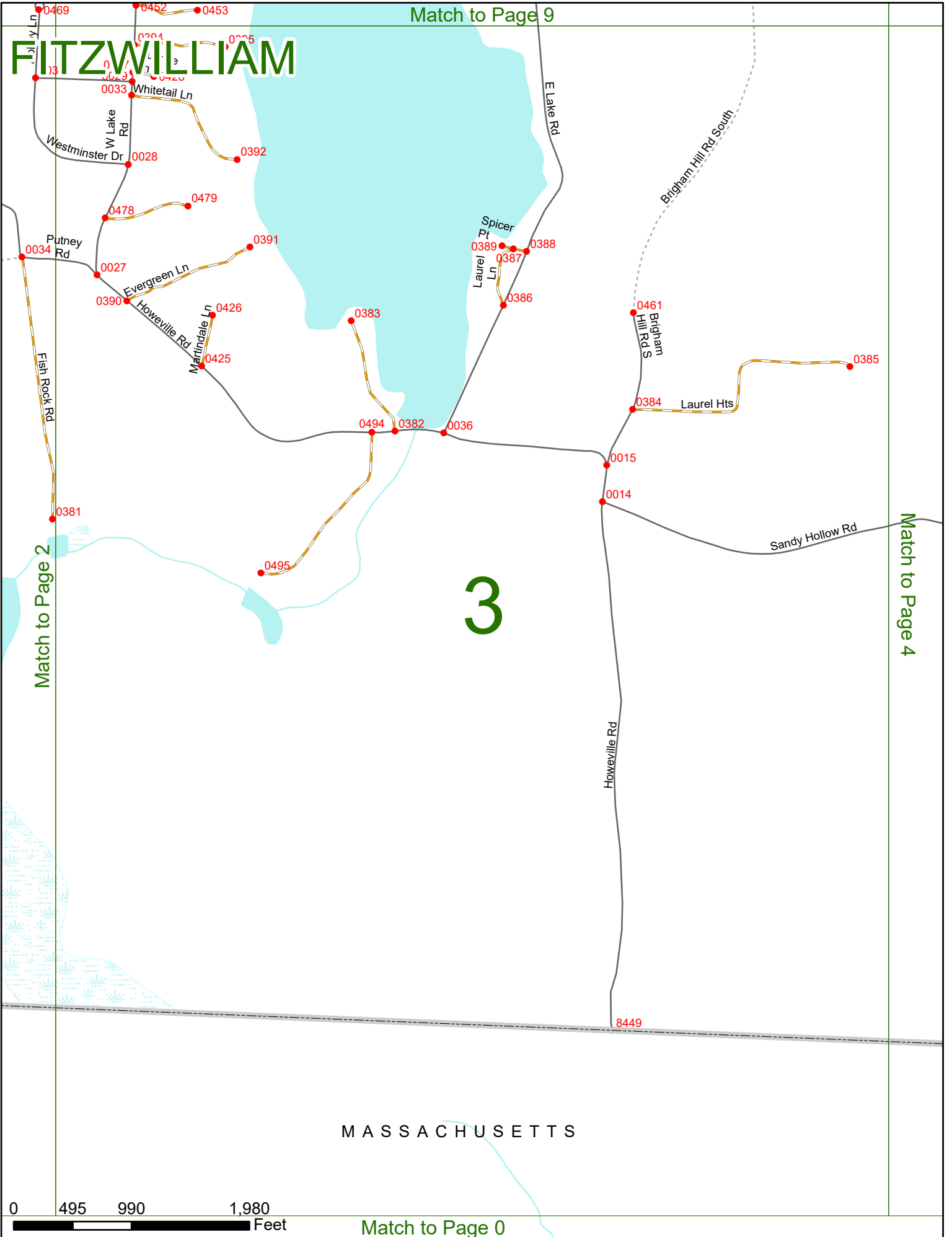

MASSACHUSETTS

0 495 990 1,980 Feet

Match to Page 0

Match to Page 2

Match to Page 4

Match to Page 10

FITZWILLIAM

Laurel
Hts
0385

0040
0039

Templeton Lake

Sandy Hollow Rd

0013

4

Match to Page 5

8448

MASSACHUSETTS

0 495 990 1,980 Feet

Match to Page 0

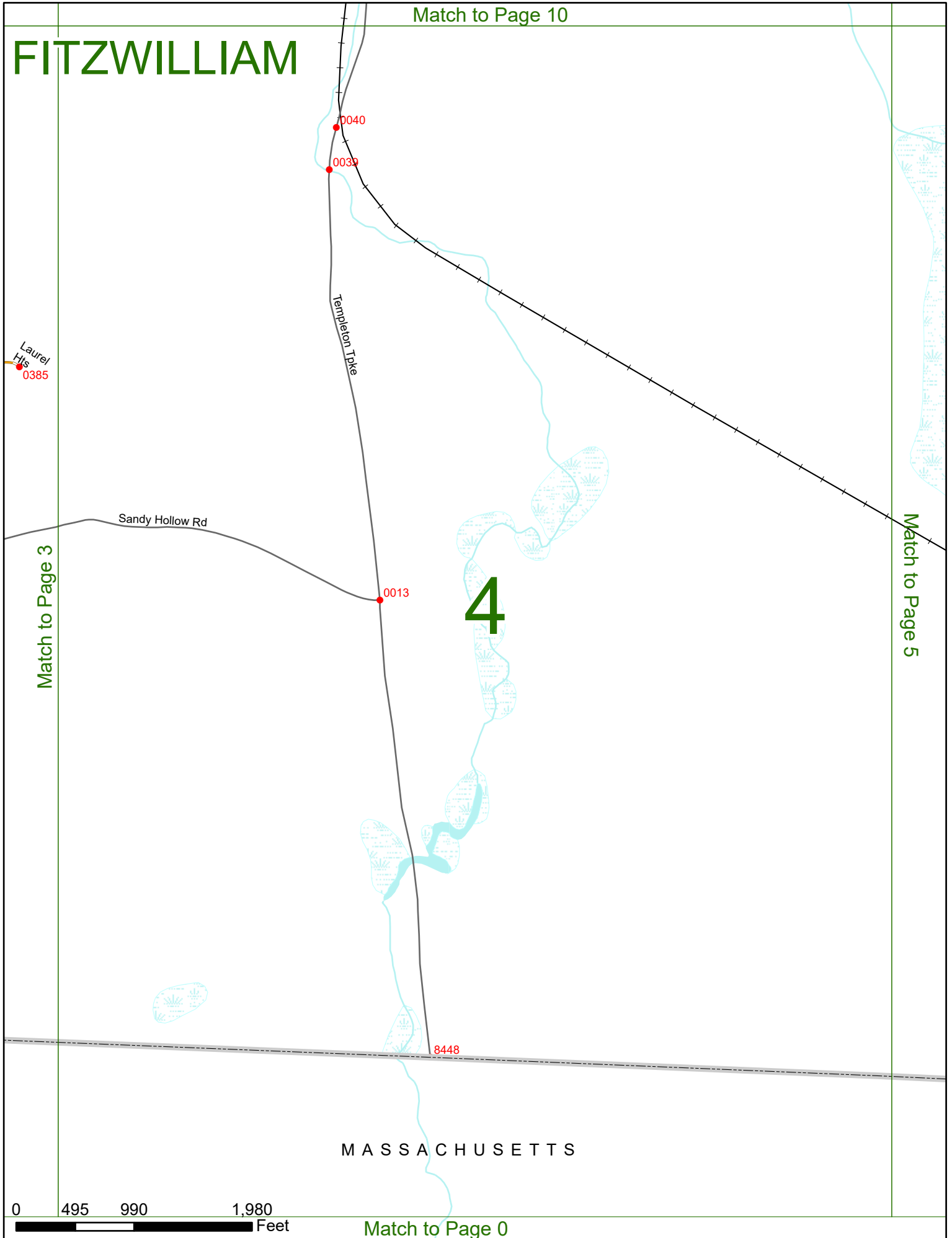

Match to Page 11

FITZWILLIAM

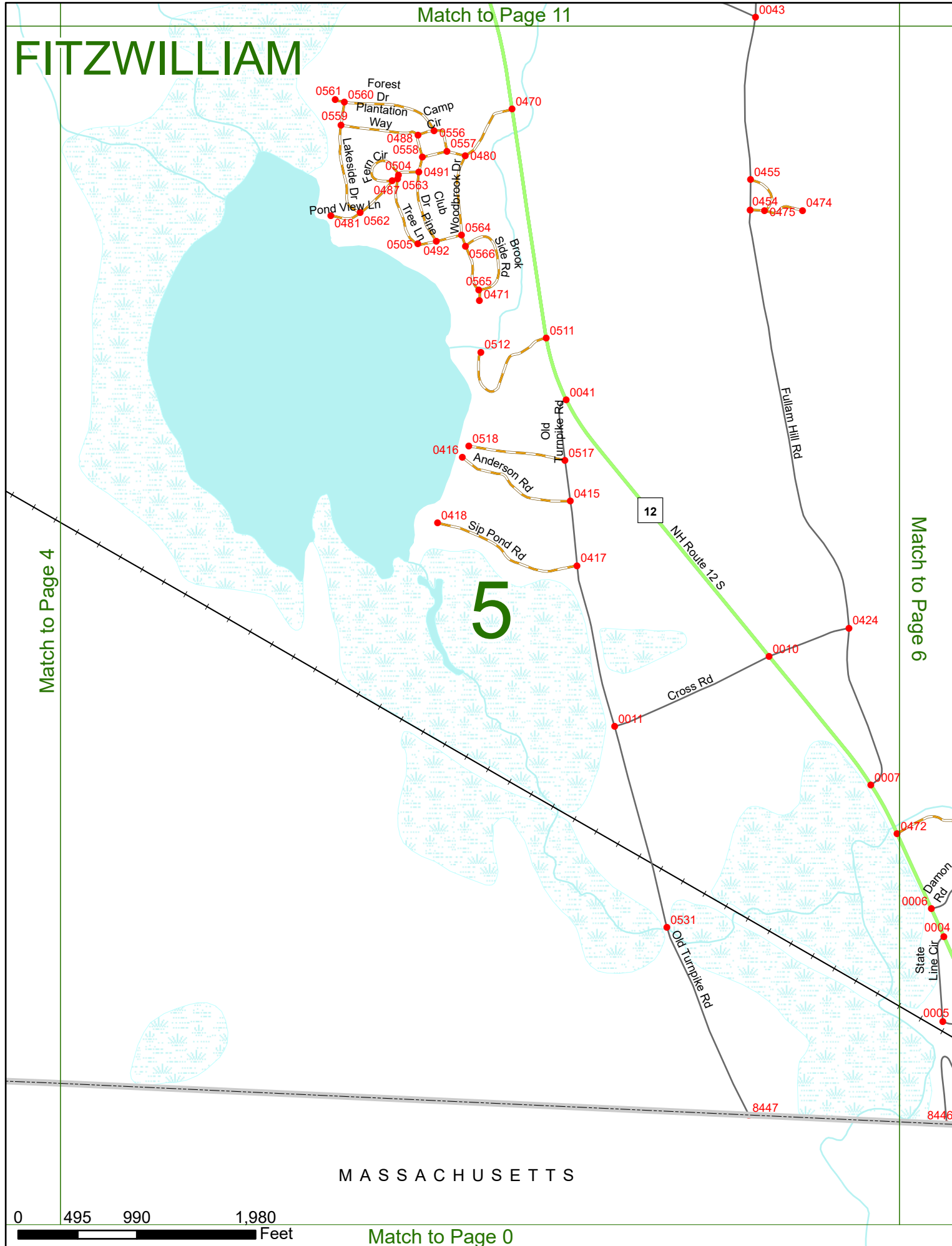

Match to Page 4

Match to Page 6

5

MASSACHUSETTS

0 495 990 1,980 Feet

Match to Page 0

Match to Page 12

FITZWILLIAM

6

Match to Page 5

Match to Page 0

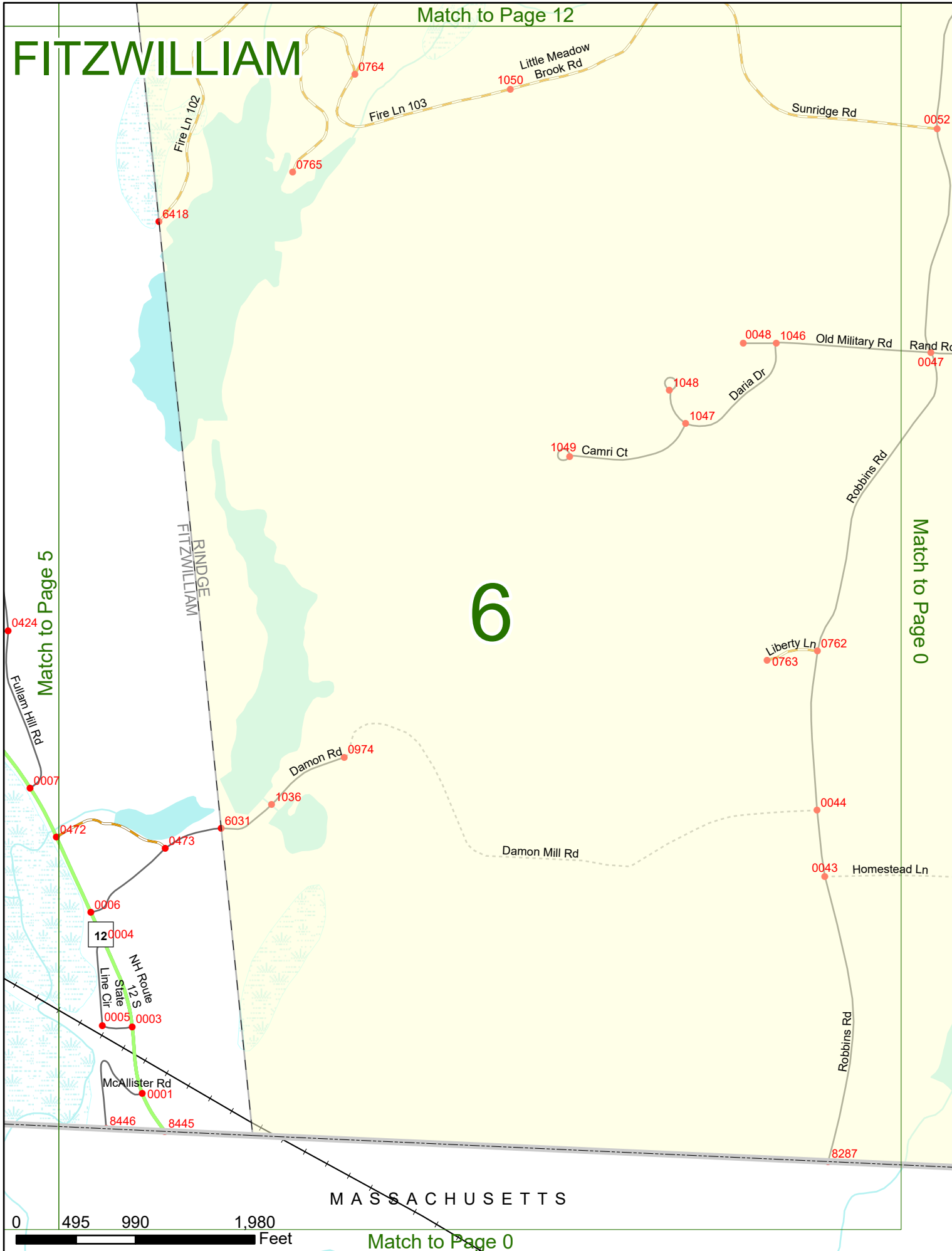

MASSACHUSETTS

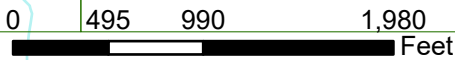

Match to Page 0

Match to Page 14

FITZWILLIAM

7

Match to Page 0

Match to Page 8

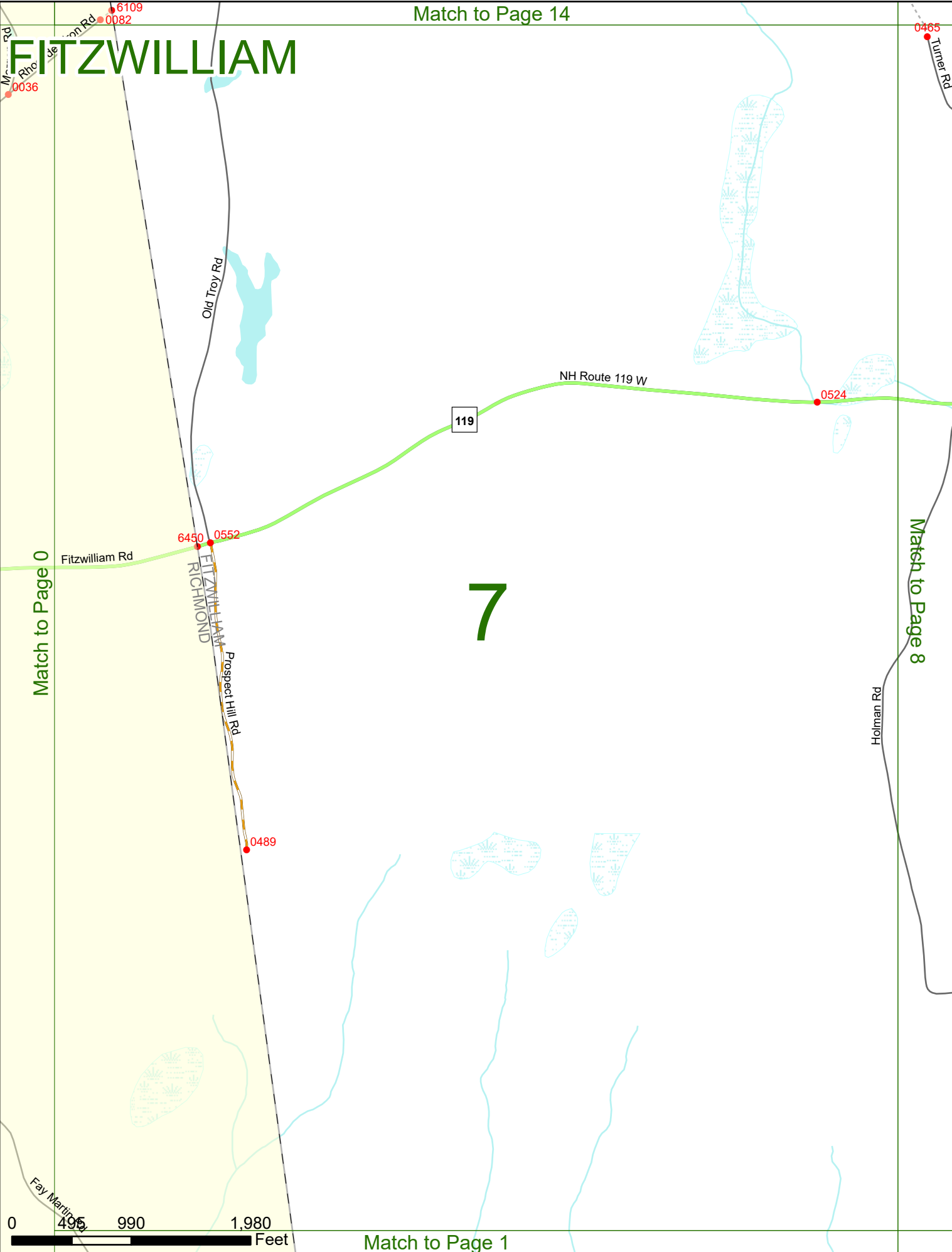

Match to Page 1

0 495 990 1,980 Feet

Match to Page 15

FITZWILLIAM

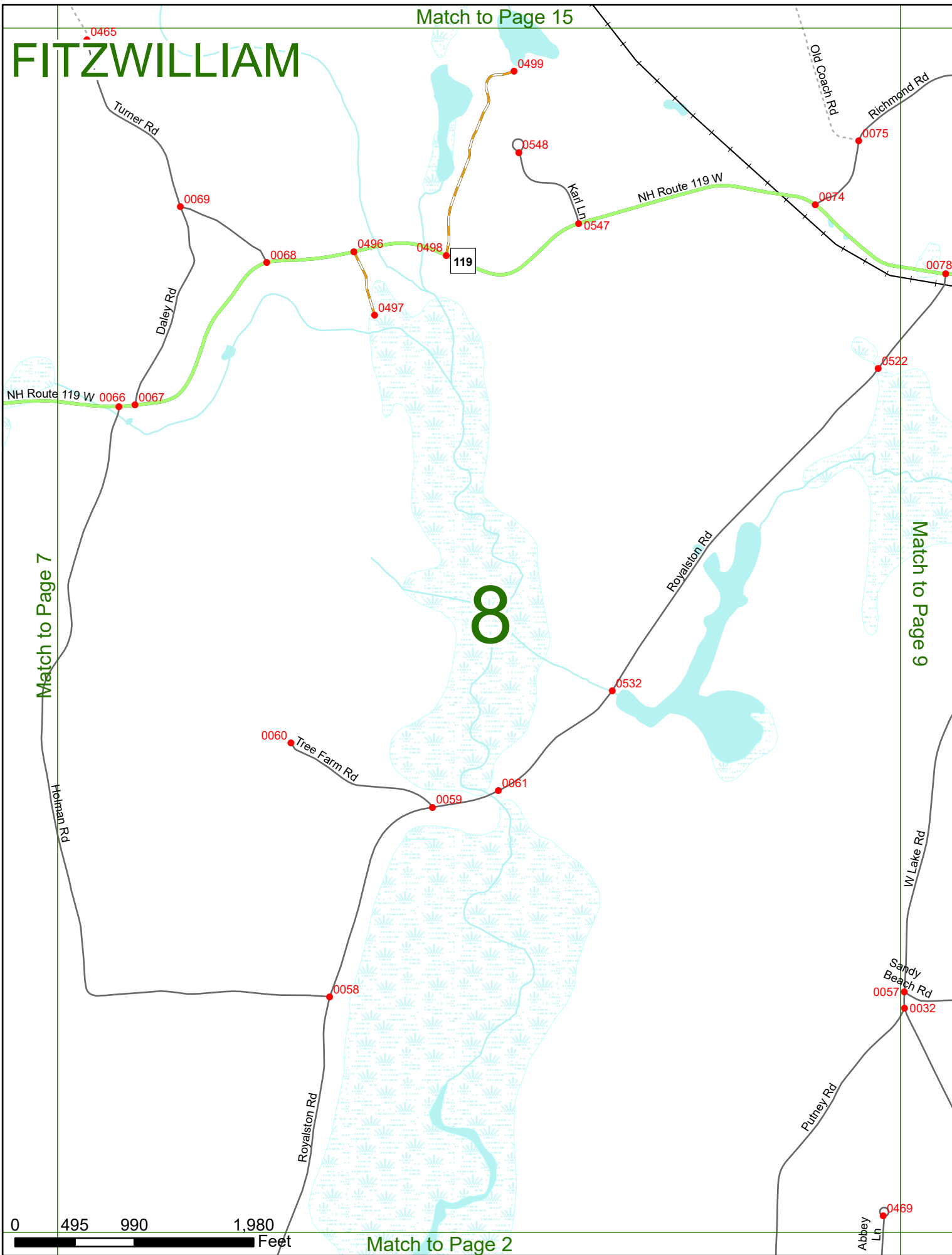

Match to Page 7

Match to Page 9

0 495 990 1,980 Feet

Match to Page 2

FITZWILLIAM

Match to Page 16

Match to Page 8

Match to Page 10

9

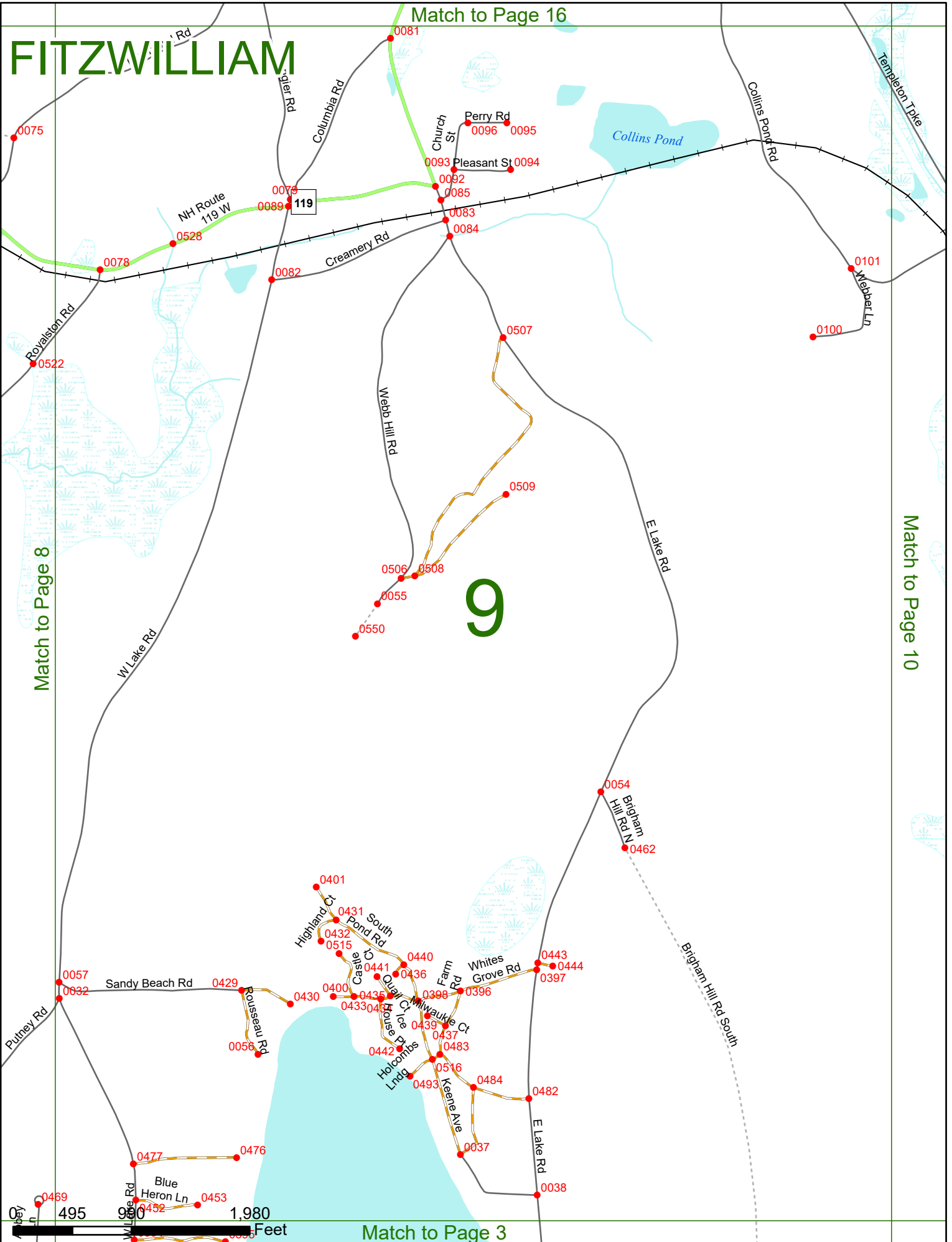

Match to Page 3

Match to Page 17

FITZWILLIAM

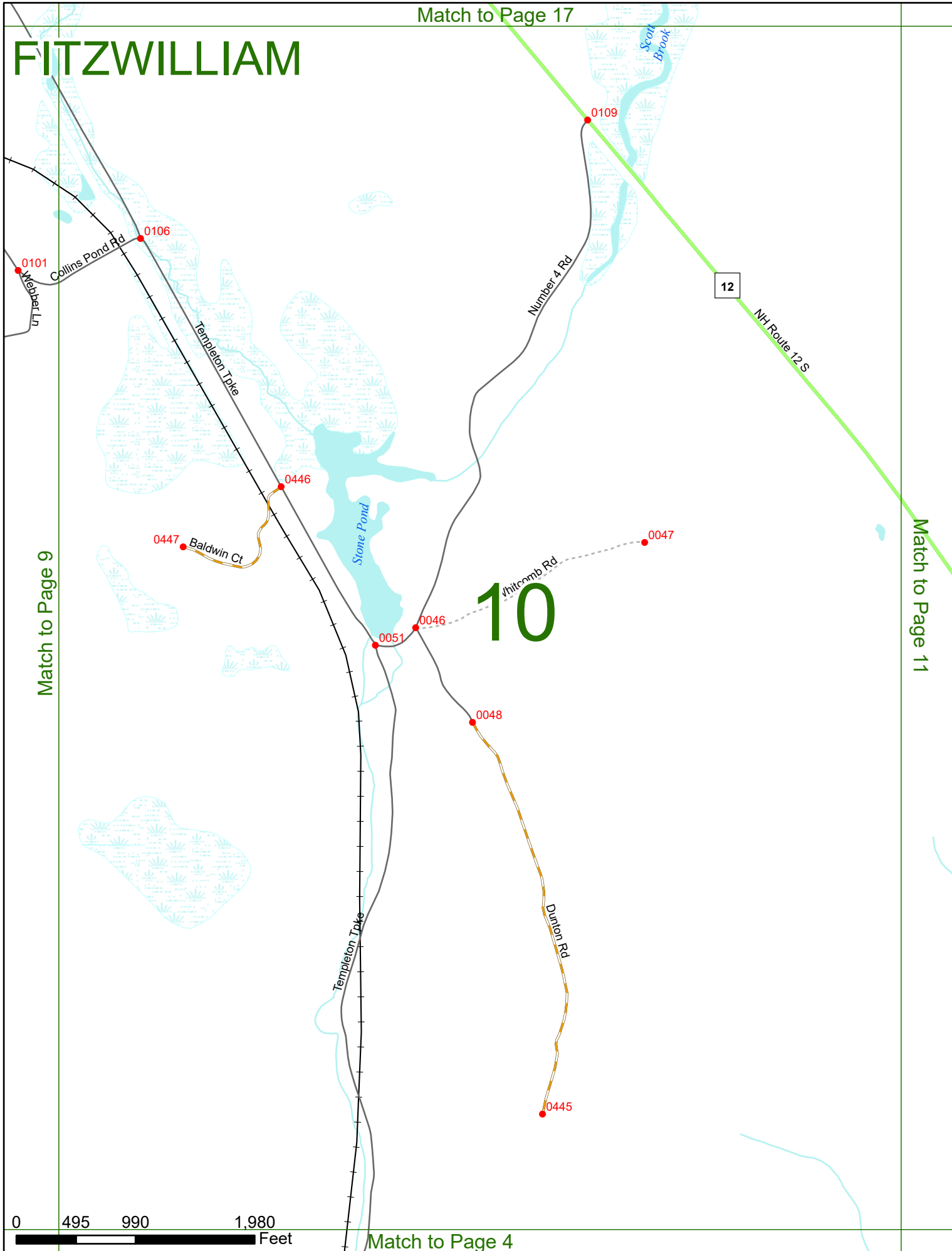

Match to Page 9

Match to Page 11

10

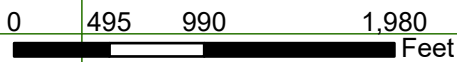

Match to Page 4

FITZWILLIAM

Match to Page 18

0999 Monadnock View Rd

0457

0114

Fullam Hill Rd

RIDGE
FITZWILLIAM

Match to Page 12

Match to Page 10

0393

0421

11

Crane Rd

0546

0045

Abel Rd

6032

NH Route 12 S

12

Fullam Hill Rd

0544

0545

0543

0542

0042

0525

Warren Hill Rd

0043

0 495 990 1,980 Feet

Match to Page 5

FITZWILLIAM

Match to Page 0

119

12

Match to Page 0

Match to Page 11

RINDGE
FITZWILLIAM

0 495 990

Feet

Match to Page 6

Robbins Rd

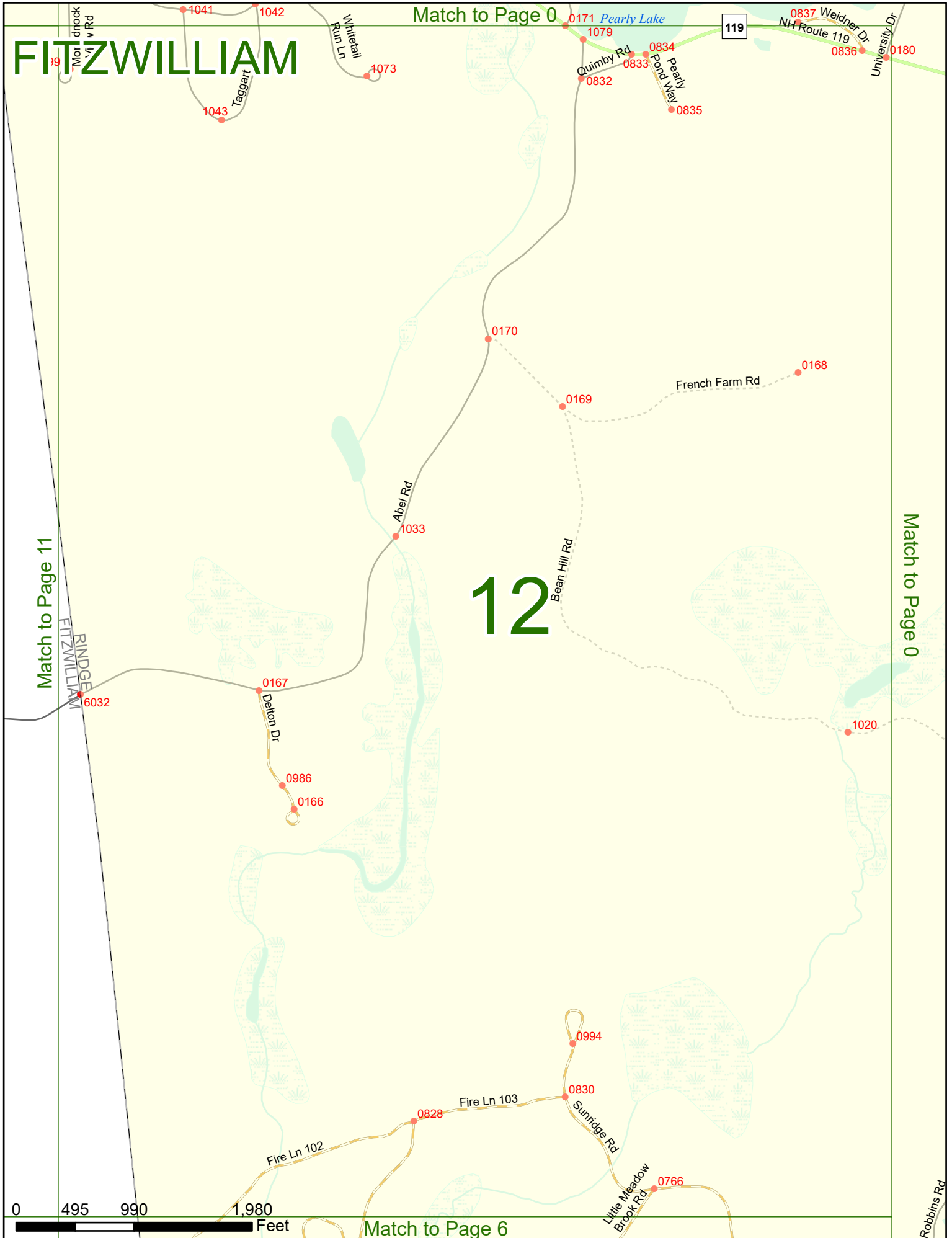

Match to Page 0

FITZWILLIAM

Match to Page 0

13

TROY
RICHMOND

6108 TROY
FITZWILLIAM

Wilcox
Gage Rd

Match to Page 14

0148

FITZWILLIAM
RICHMOND

0038

Morgan Rd

0037

Bow Rd

0082

0 495 990 1,980 Feet

Match to Page 0

FITZWILLIAM

Cushing Pond

TROY
FITZWILLIAM

6108

0148

14

Rhododendron P

Match to Page 15

0144

0143

0147

Match to Page 13

Widow Gage Rd

Rhododendron Rd

0146

Turner Rd

Carlotta Rd

0064
0063

0521
0414

0466

6109
0090

495

1,980

Troy Rd

Morgan Rd

Feet

Match to Page 7

0465

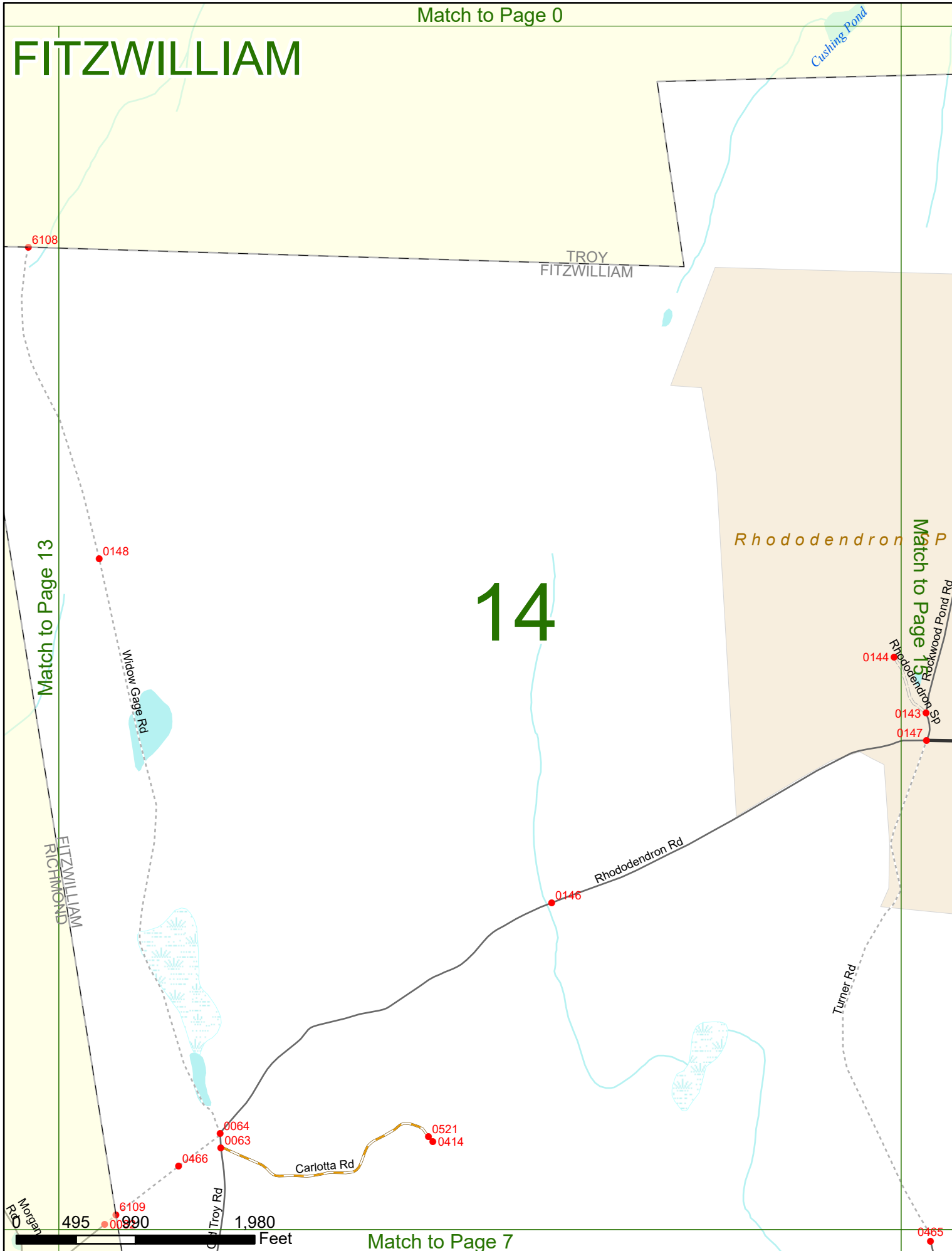

FITZWILLIAM

Match to Page 19

15

Match to Page 16

Rhododendron SP

Match to Page 14

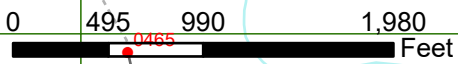

Match to Page 8

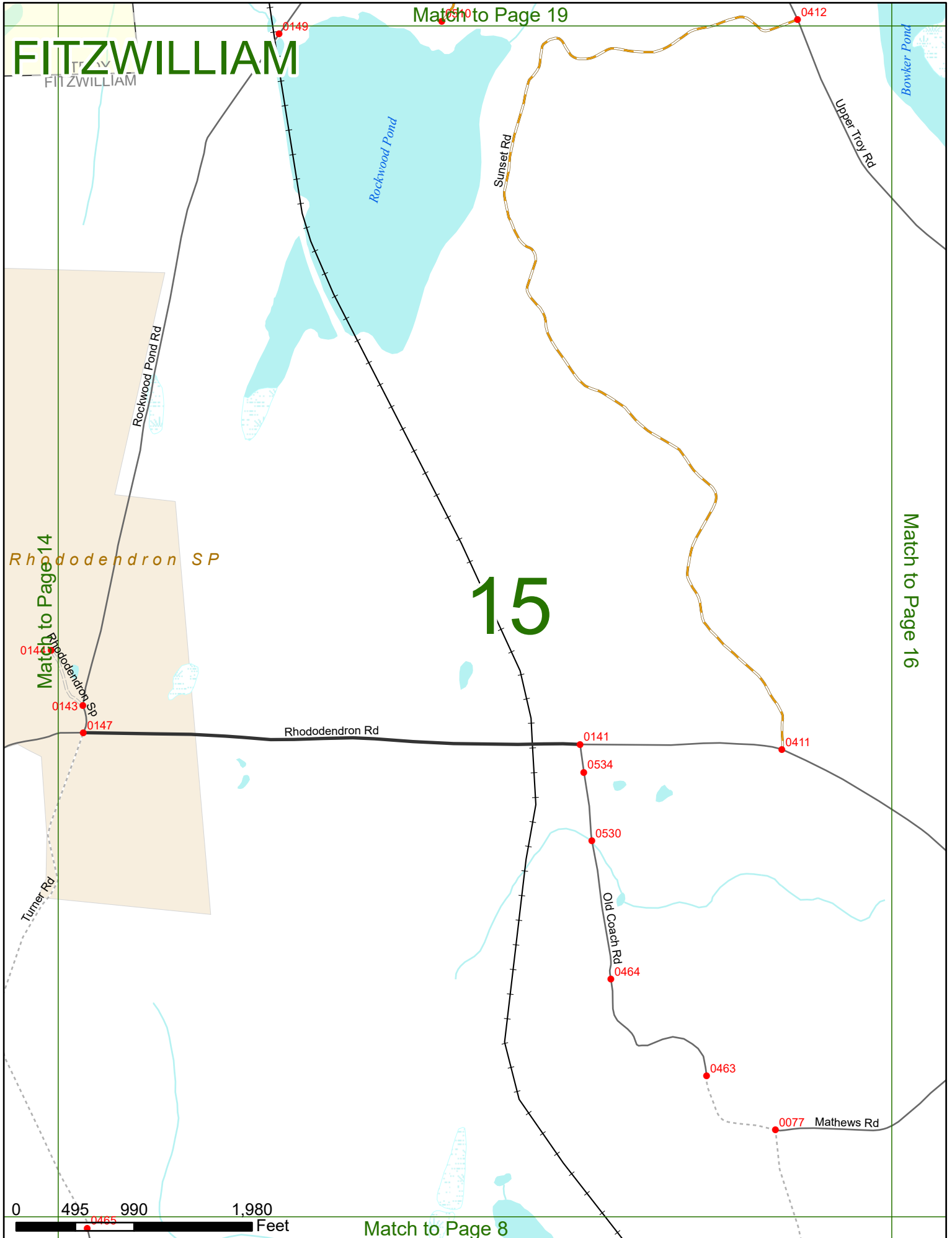

FITZWILLIAM

Bowker Pond

Match to Page 20

Match to Page 15

Match to Page 17

16

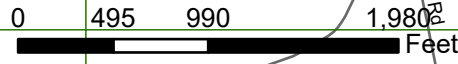
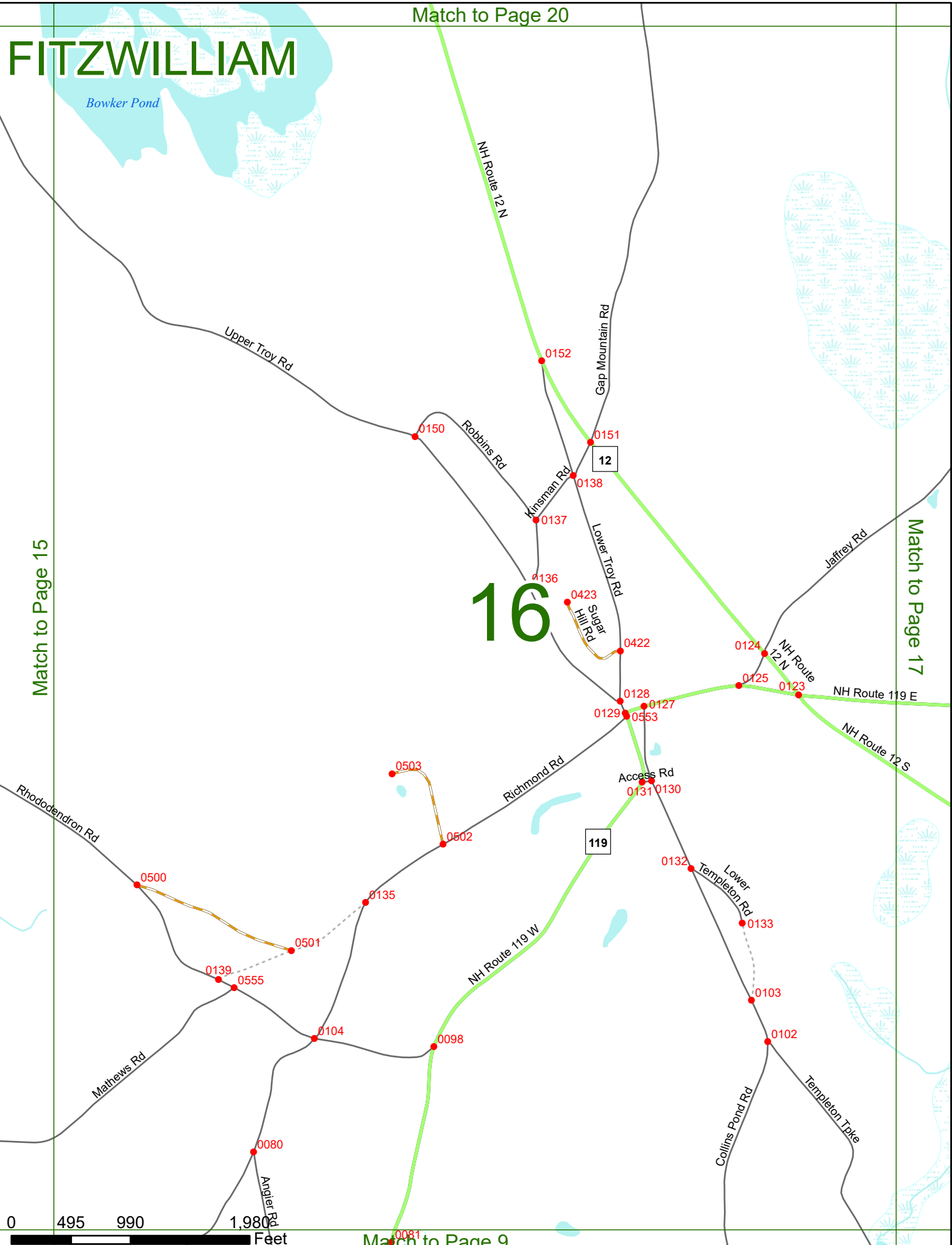

Match to Page 9

FITZWILLIAM

Match to Page 21

Match to Page 16

Match to Page 18

17

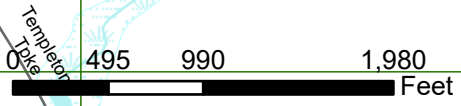
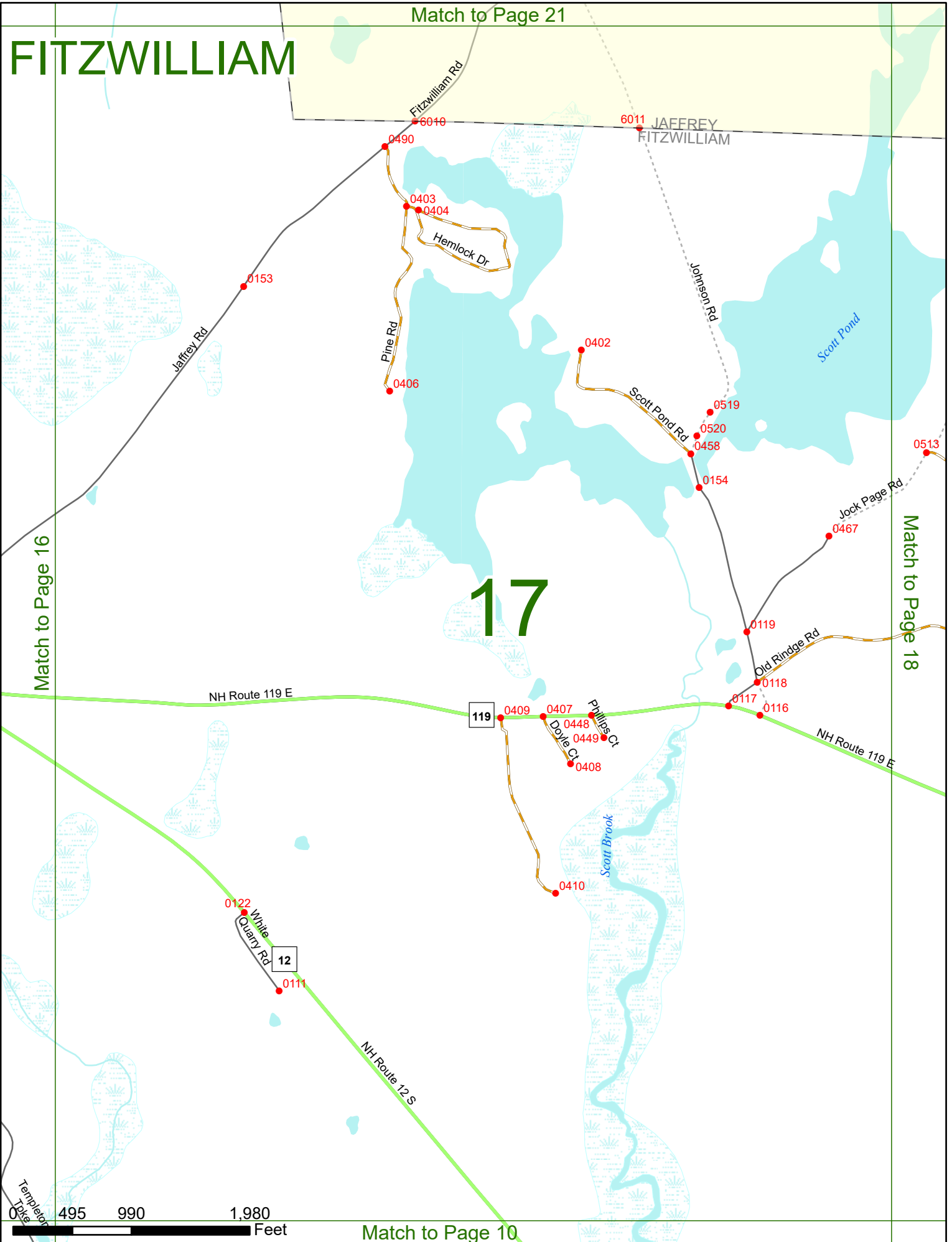

Match to Page 10

FITZWILLIAM

6012 JAFFREY
FITZWILLIAM

JAFFREY
RINDGE

Doll House Rd
0941

Scott Pond

Jock Page Rd

0513
0514

Match to Page 17

Old Rindge Rd

18

Match to Page 0

School
House Rd
0939

RINDGE
FITZWILLIAM

The Elm Rd

6417

Old
Rindge Rd
6033 0938

NH Route
119
0937
0936

Meadow View Rd

0952

Monadnock View Rd

0115

119

NH Route 119 E

Fulham Hill Rd

0456

0 495 990 1,980 Feet

Match to Page 11

FITZWILLIAM

Match to Page 0

19

Match to Page 0

Match to Page 20

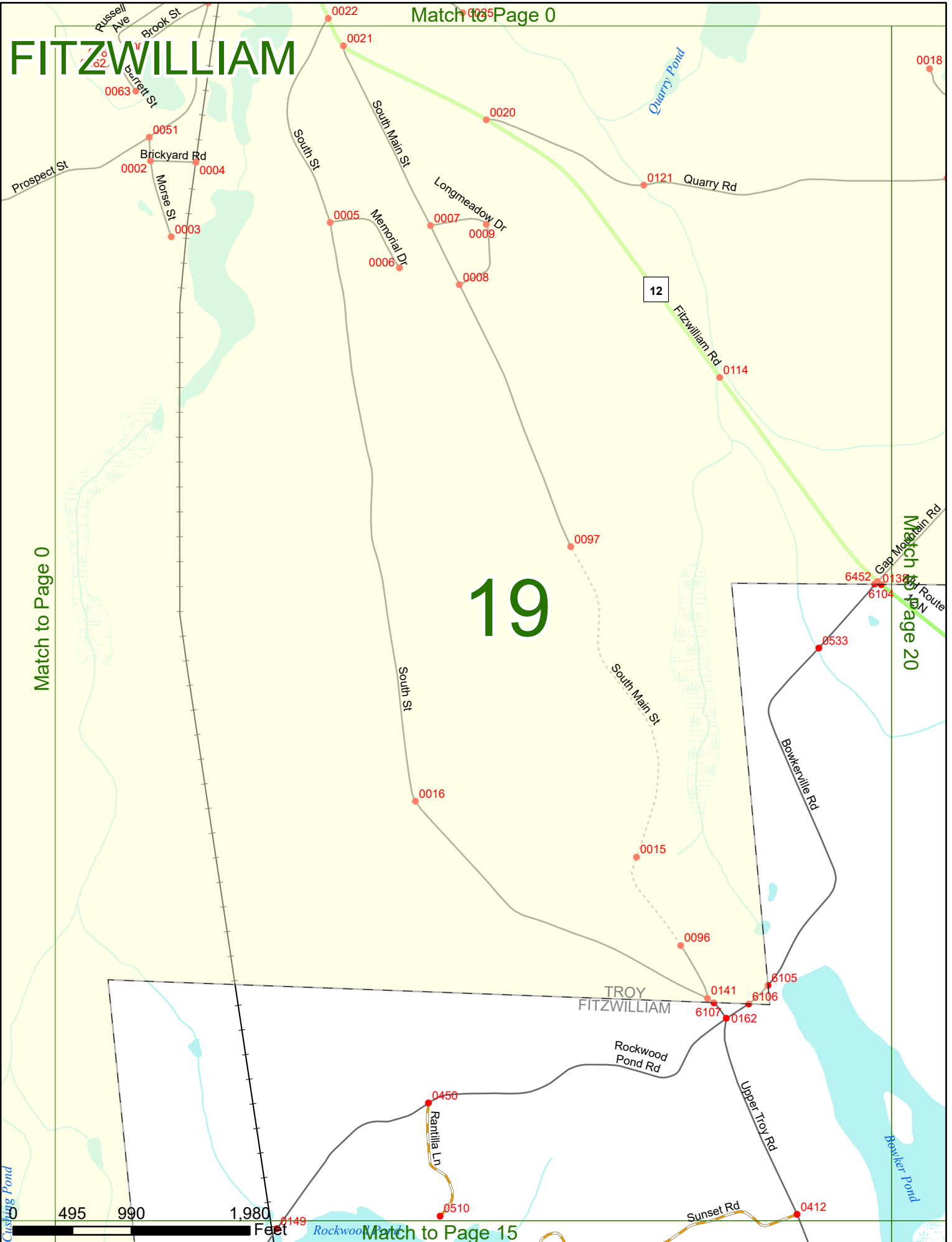

Cushing Pond

0 495 990 1,980 Feet

Match to Page 15



FITZWILLIAM

20

Match to Page 9

Match to Page 21



Quarry Rd

0019

Fern Hill Rd

0098

0012

0010

0013

0011

Upper Gap Mtn Rd

Gap Mountain Rd

0014

Fitzwilliam Rd

6452 138 104

TPS
FITZWILLIAM

6102

0567

0568

Upper Gap Mountain Rd

0459

Cobleigh Hill Rd

12

N.H. Route 12 N

0157

0156

Gap Mountain Rd

0468

6430

Bowker Pond

Match to Page 0

FITZWILLIAM

Bixler Way
0853

Old County Rd

0341

JAFFREY
TROY

Fitzwilliam Rd

0318

0891

Gap Mountain Rd

0316

Spaulding Rd

0315

6463

0856 Cobleigh Hill Rd

0314

21

TROY
FITZWILLIAM

6430

Cobleigh Hill Rd

0313

Match to Page 0

JAFFREY
FITZWILLIAM

Fitzwilliam Rd

0309

Scott Pond Rd

Scott Pond



Match to Page 17