



Maps and data sets are not guaranteed to be free from errors and omissions. Data is in a constant state of update and correction by various groups and agencies. Information displayed on this map is the best available at the time of publication.

# 2025 Nodal Reference Bookmap

## LEGEND



NHDOT will accept crash locations based on the State of NH Uniform Police Traffic Accident Report.

Crash occurred on:

**Option 1**     Street Address  
                   123 Main Street

**Option 2**     Route No and/or     Distance from             NESW             Intesecting Road, Bridge,  
                   Street name             Intersecting Street                                     Town/County line  
                   Main Street                     500                     E                     Oak Street

**Option 3**     First Node                     Distance from First Node                     Second Node  
                   515                                     212                                     632

**Option 4**     Route No and/or             Mile Marker on Interstate Only             NESW             Mile (Marker)  
                   Street name  
                   189S                                     700 feet                                     S                     36.8

**Option 3 – Example**

Street Name                     Loudon Road  
First Node                             803  
Distance from First Node             318 Ft  
Second Node                             813



# DORCHESTER

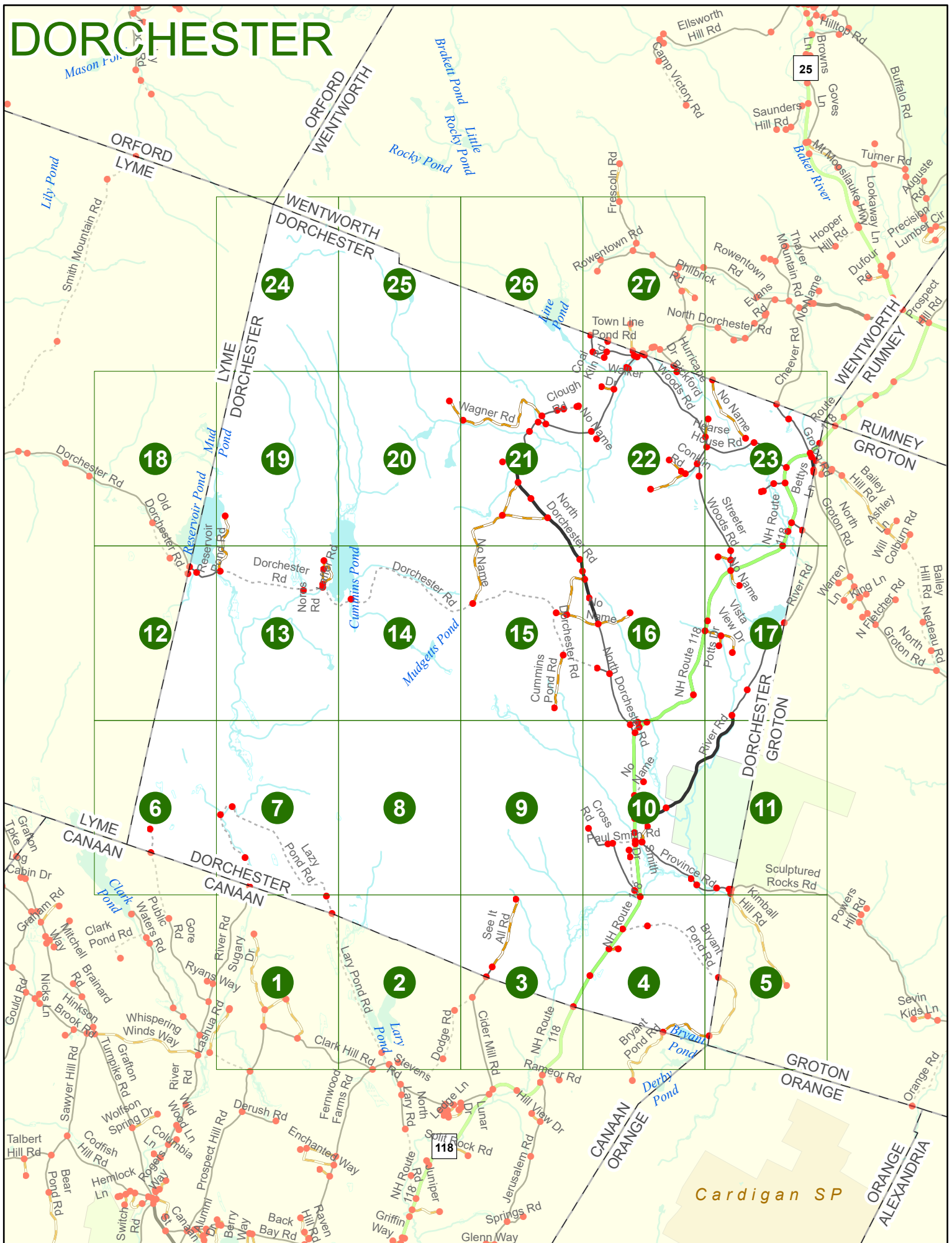

Match to Page 7

# DORCHESTER

DORCHESTER  
CANAAN

0174

Lazy Pond Rd

6088

Lazy Pond Rd

Match to Page 2

River Rd

0487

Sugary Dr

# 1

Match to Page 0

Ryans Way  
0168

Gore Rd  
0165

0484  
0511

Lashua Rd

Wentworth Army Dr  
0146

0485

0149

0141

Prospect Hill Rd

Clark Hill Rd

0481

0 495 990 1,980

Feet

Match to Page 0

0145

# DORCHESTER

Lazy Pond Rd  
6088

DORCHESTER  
CANAAN

Match to Page 1

# 2

Match to Page 3

Lazy Pond Rd

Lazy Pond

0156

Dodge Rd

0157

0530

0499

0152

Stevens Rd

Clark Hill Rd

1,980  
Feet

Match to Page 0

0 495 990



# DORCHESTER

Match to Page 9

0164

See It All Rd

0011

6087

# 3

DORCHESTER  
CANAAN

Match to Page 4

0010

Match to Page 2

0155

Dodge Rd

0156

Cider Mill Rd

6086

118

NH Route 118

0 495 990 1,980 Feet

Match to Page 0

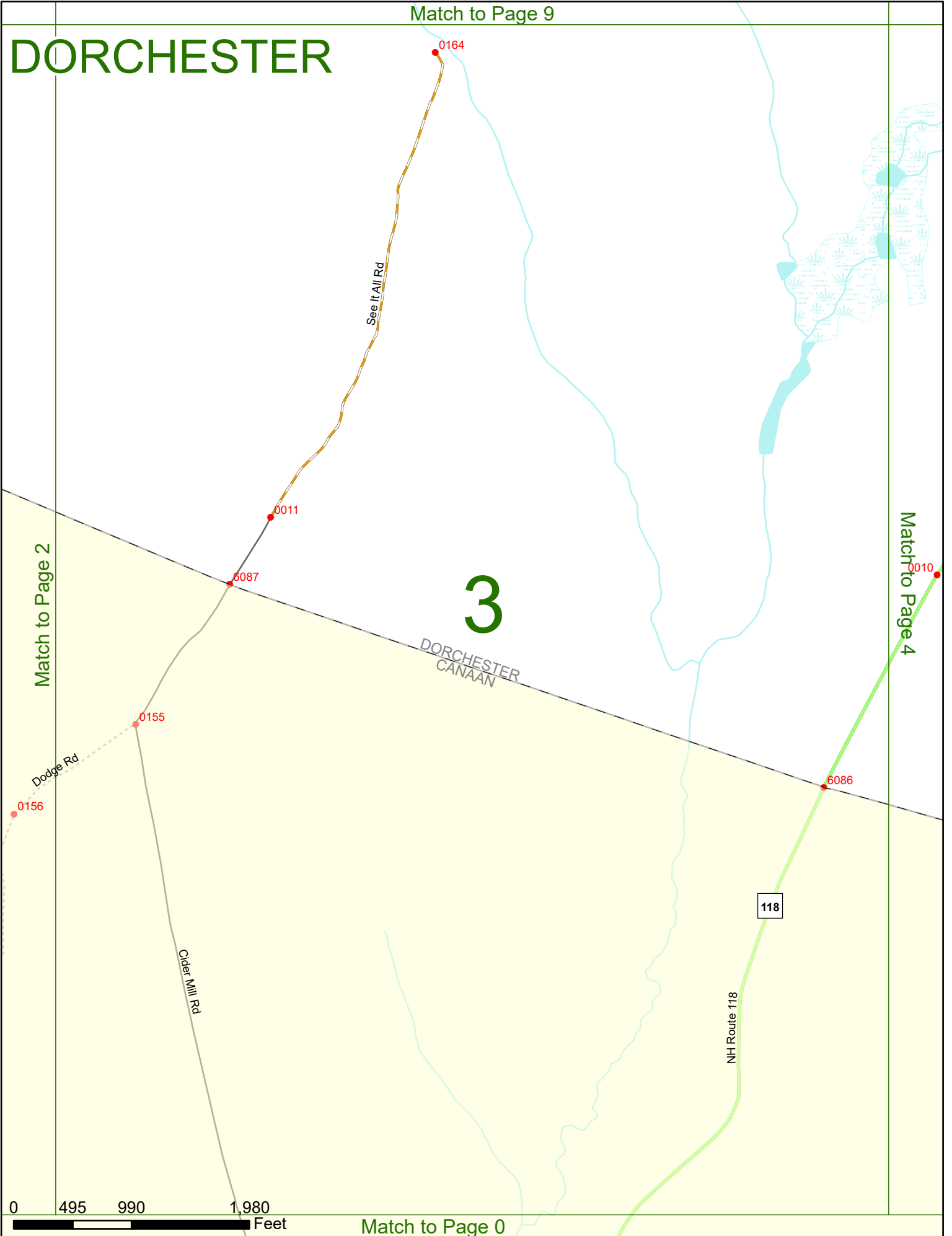

# DORCHESTER

Match to Page 10

0006

0008

0009

0022

118

Kennedy  
Town Rd

0021

NH Route 118

0010

# 4

Bryant Pond Rd

Match to Page 5

Match to Page 3

DORCHESTER  
CANAAN

6768

Bryant Pond

Bryant  
Pond Rd  
6709

Bryant  
Pond Rd

CANAAN  
ORANGE

0 495 990 1,980 Feet

Match to Page 0

# DORCHESTER

DORCHESTER  
GROTON

Kimball Hill Rd

Bryant Pond Rd

# 5

Match to Page 4

Match to Page 0

6758

6757

0112

6709

Bryant Pond

CANAAN  
ORANGE

GROTON  
ORANGE

0 495 990 1,980 Feet

Match to Page 0



# DORCHESTER

Match to Page 0

Match to Page 7

# 6

LYME  
DORCHESTER

LYME  
CANAAN

DORCHESTER  
CANAAN

0012  
Uphaffenraffer Rd  
6090

Gore Rd

0204  
Lazy Pond Rd

Clark Pond

0 495 990 1,980 Feet

Match to Page 0

# DORCHESTER

# 7

Match to Page 6

Match to Page 8

0204

0013

0213

6089

0174

Lazy Pond Rd

DORCHESTER  
CANAAN

0174 Rd

0 495 990 1,980 Feet

Match to Page 1

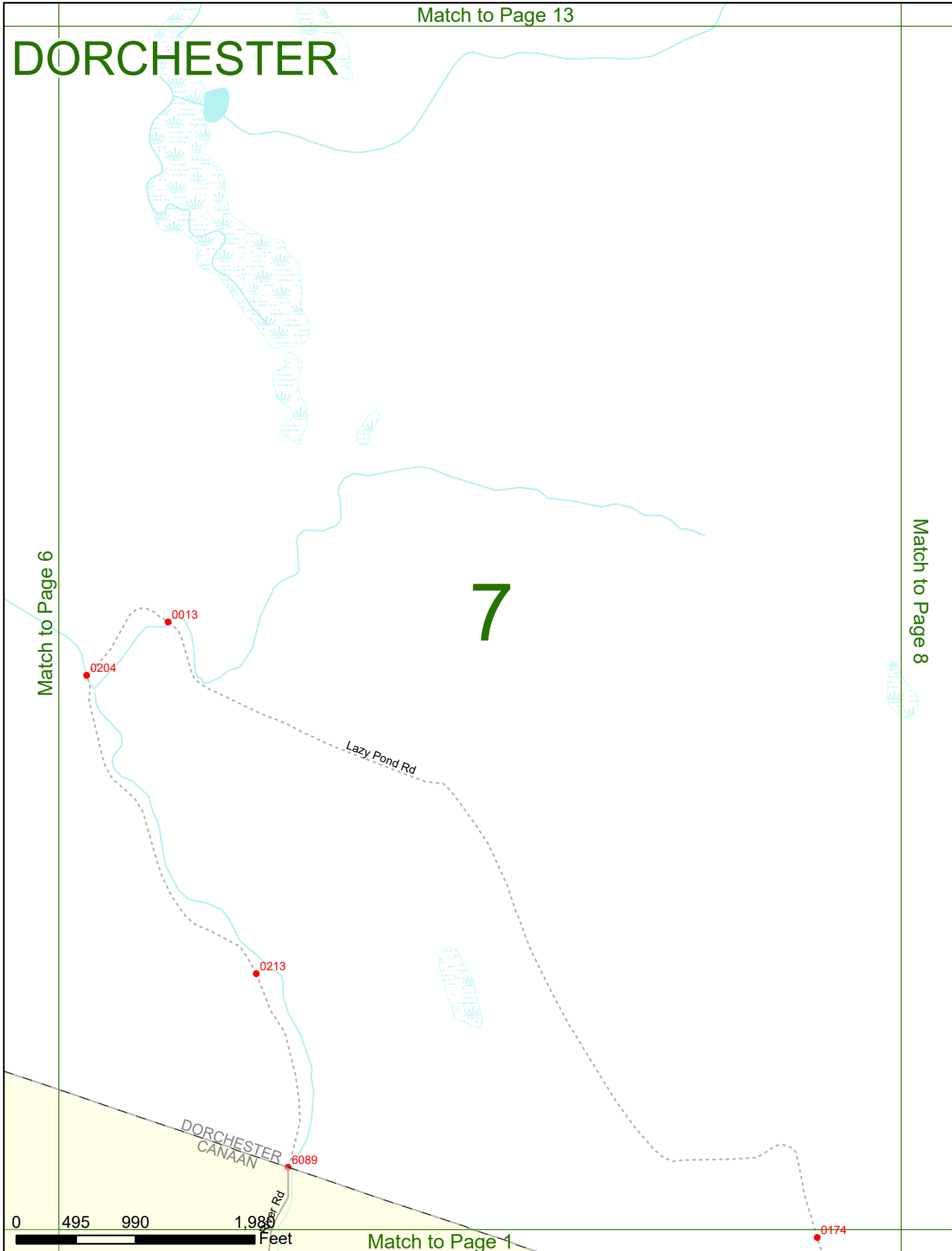

# DORCHESTER

Match to Page 7

Match to Page 9

8

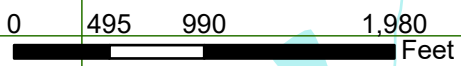

Match to Page 2

Match to Page 15

# DORCHESTER

9

Match to Page 8

Match to Page 10

0014

0 495 990 1,980 Feet

Match to Page 3

# DORCHESTER

Match to Page 16

Match to Page 9

Match to Page 11

# 10

Province Road SF

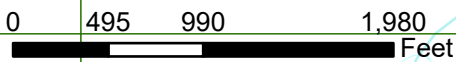

Match to Page 4

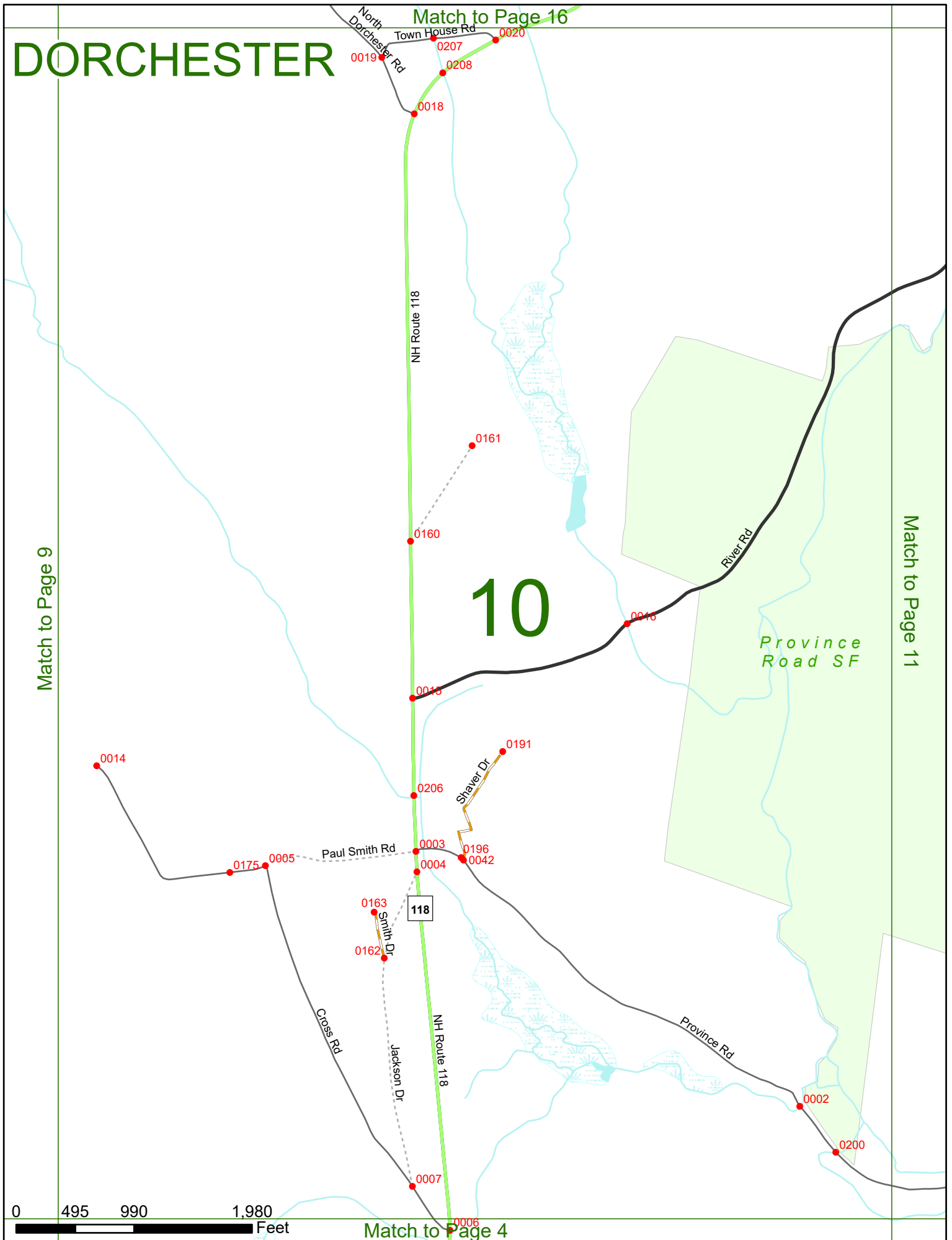

Match to Page 17

# DORCHESTER

River Rd

DORCHESTER  
GROTON

Match to Page 10

Match to Page 0

# 11

Province  
Road SF

Province Rd

Sculptured Rocks Rd

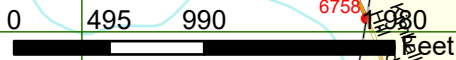

0001  
0165  
6110  
6758  
1485

Match to Page 5

Match to Page 18

# DORCHESTER

Match to Page 0

Match to Page 13

# 12

LYME  
DORCHESTER

Reservoir  
Pond

0005

Old Dorchester Rd

6236

6792

0203

Dorchester Rd

Reservoir  
Pond Rd

0036

0 495 990 1,980 Feet

Match to Page 6

# DORCHESTER

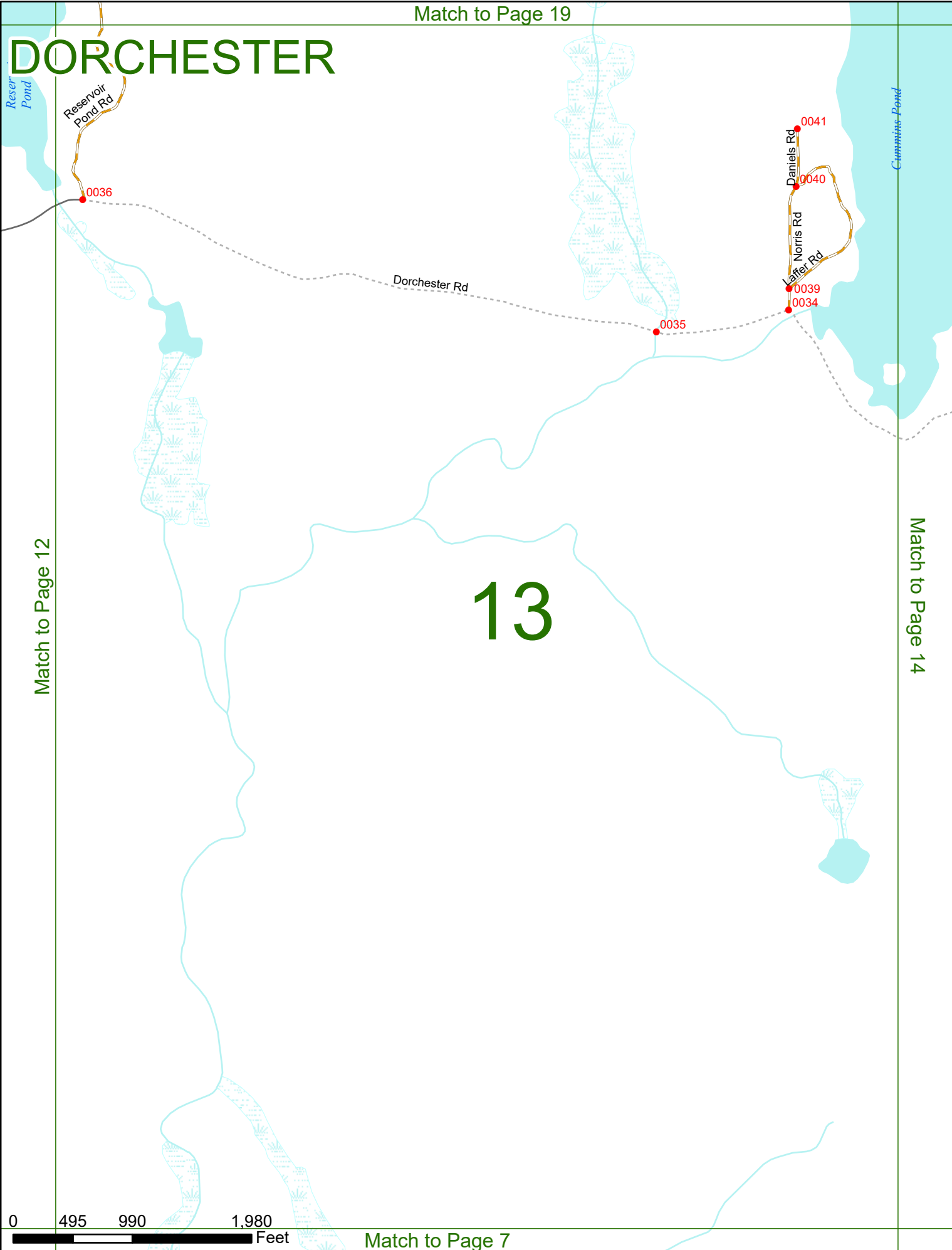

Match to Page 12

Match to Page 14

# 13



Match to Page 7



# DORCHESTER

Cummins Pond

Laffer Rd

Dorchester Rd

0033

# 14

Mudgets Pond

Match to Page 13

Match to Page 15

# DORCHESTER

# 15

Match to Page 14

Match to Page 16

Dorchester Rd

Cummins Pond Rd

North Dorchester Rd

0179

0186

0189

0166

0167

0217

0216

0190

0018

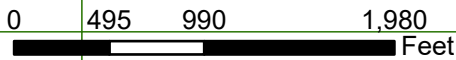

# DORCHESTER

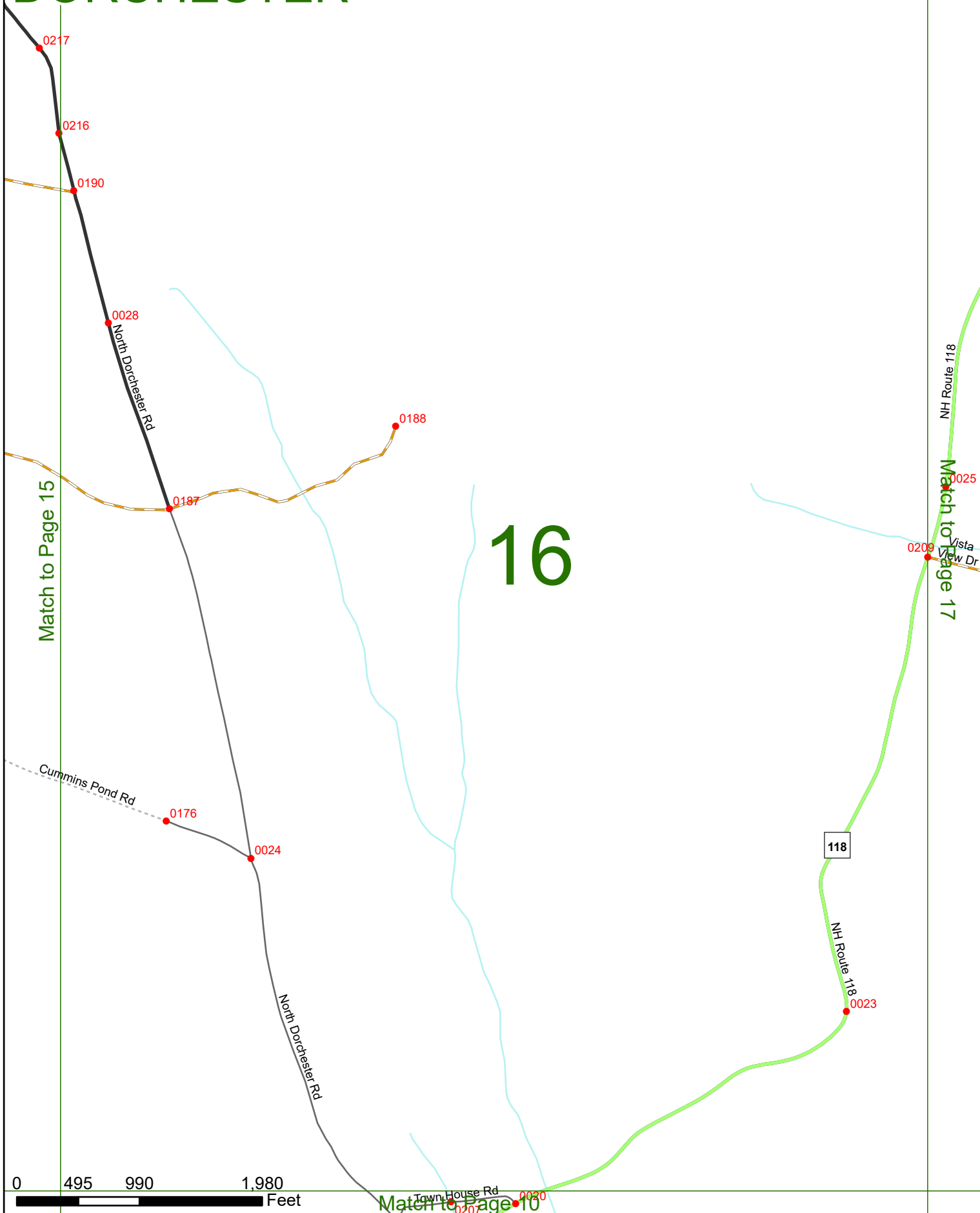

# DORCHESTER

Match to Page 23

0030 Young Rd

0029 Street Woods

NH Route 118

0026

0193

118

River Rd

0025

Match to Page 16

0209

0184

Potts Dr  
0185

Vista View Dr  
0183

# 17

DORCHESTER  
GROTON

6111

River Rd

0017

0218

Match to Page 0

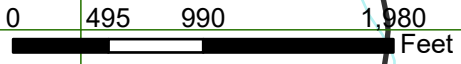

Match to Page 11

# DORCHESTER

18

Match to Page 0

Match to Page 19

0373

Dorchester Rd

0067

Old Dorchester Rd

LYME  
DORCHESTER

Reservoir  
Pond

Reservoir  
Pond Rd

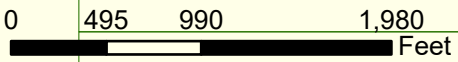

# DORCHESTER

# 19

Match to Page 18

Match to Page 20

LYME  
DORCHESTER

Reservoir Pond  
Reservoir Pond Rd  
0037

Cummins Pond

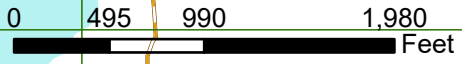

Match to Page 13

# DORCHESTER

Match to Page 19

Match to Page 21

# 20

0171

Wagner Rd

0194

Cummins Pond

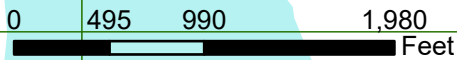

# DORCHESTER

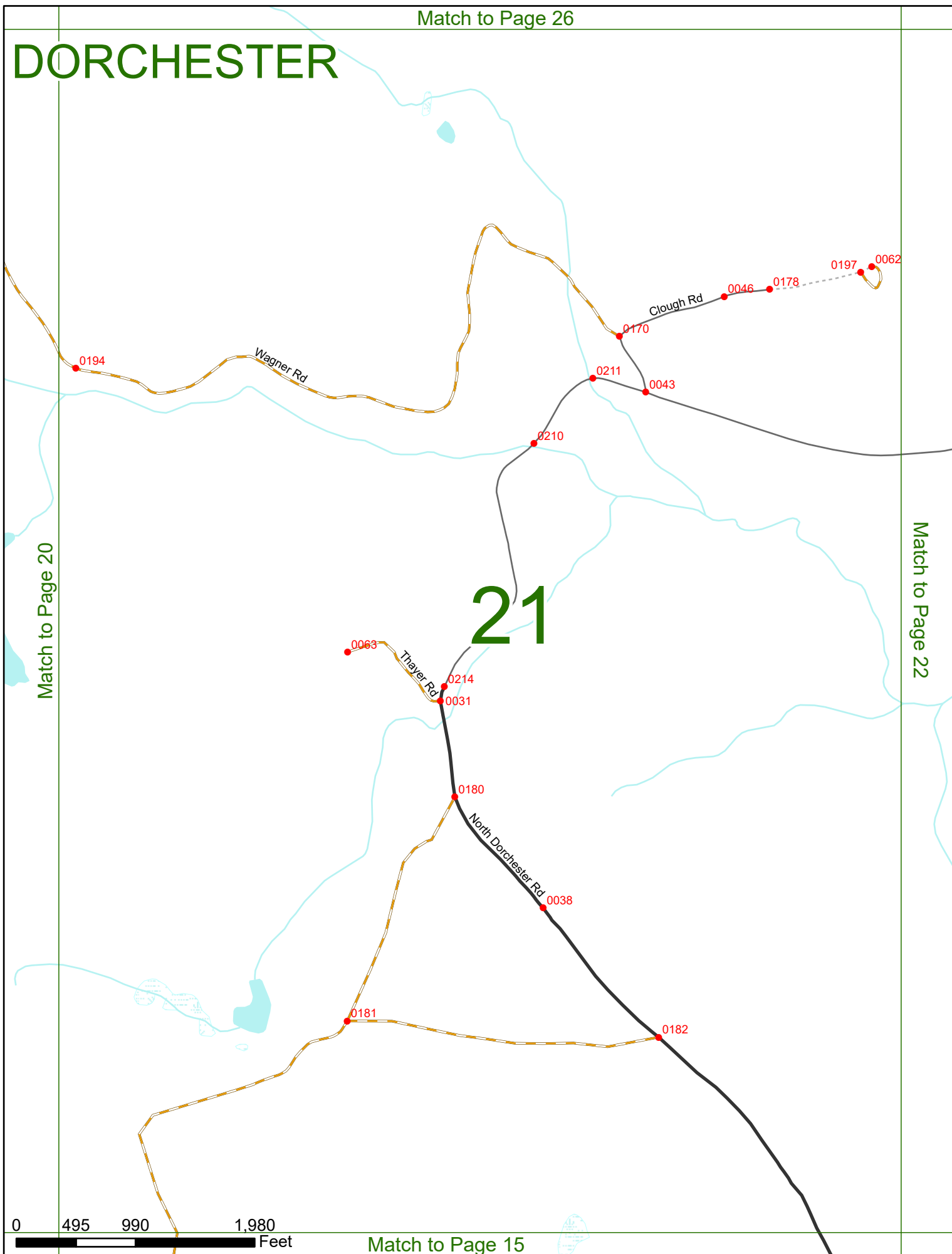

Match to Page 20

Match to Page 22

# 21

0 495 990 1,980 Feet

Match to Page 15





# DORCHESTER

Match to Page 27

WENTWORTH  
DORCHESTER

South Branch

Bickford Woods Rd

North Dorchester Rd

Walker Dr

Clough Rd

Hearse House Rd

Davenport Rd

Copkin Rd

Siblester Woods Rd

# 22

Match to Page 21

Match to Page 23

0 495 990 1,980 Feet

Match to Page 16

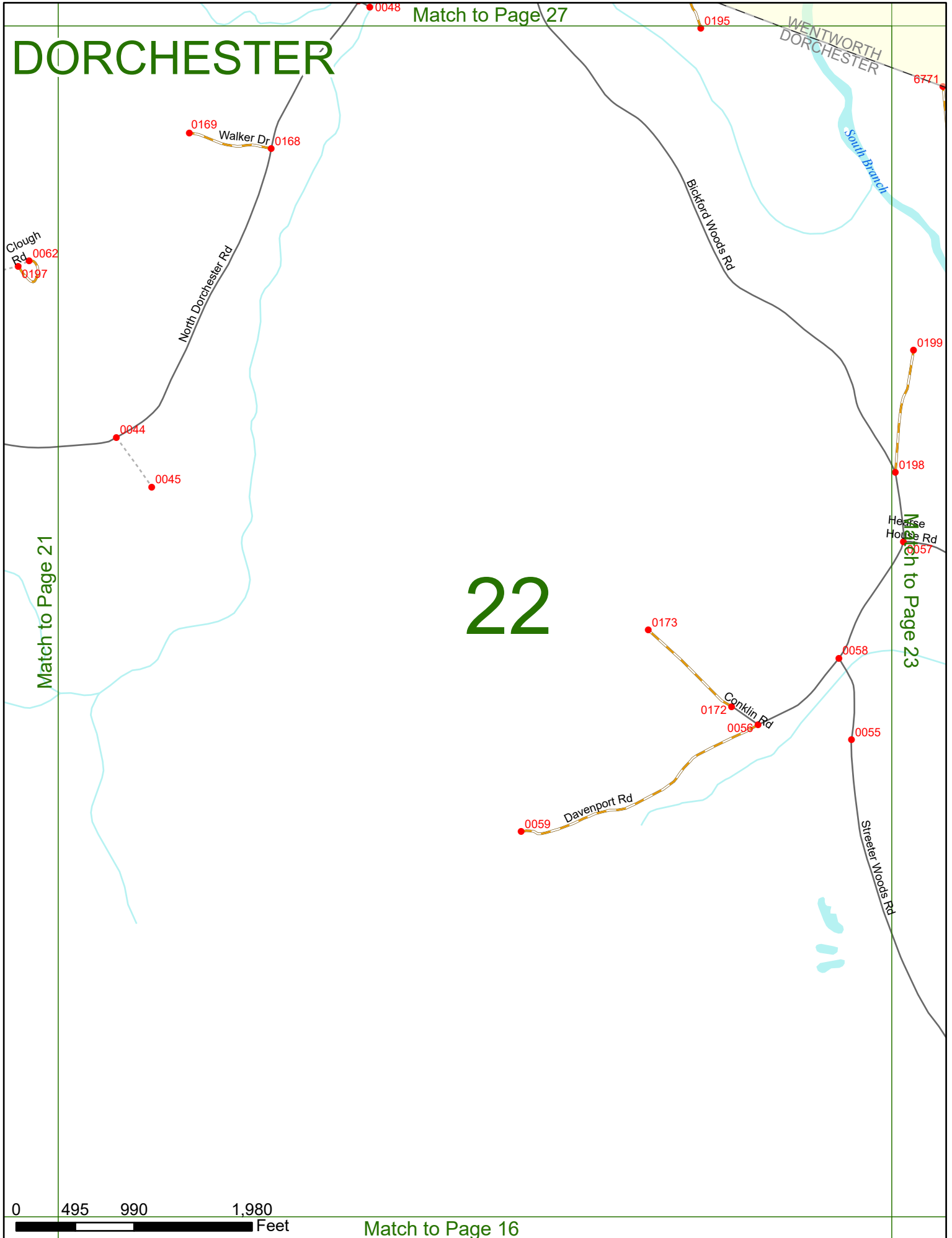

# DORCHESTER

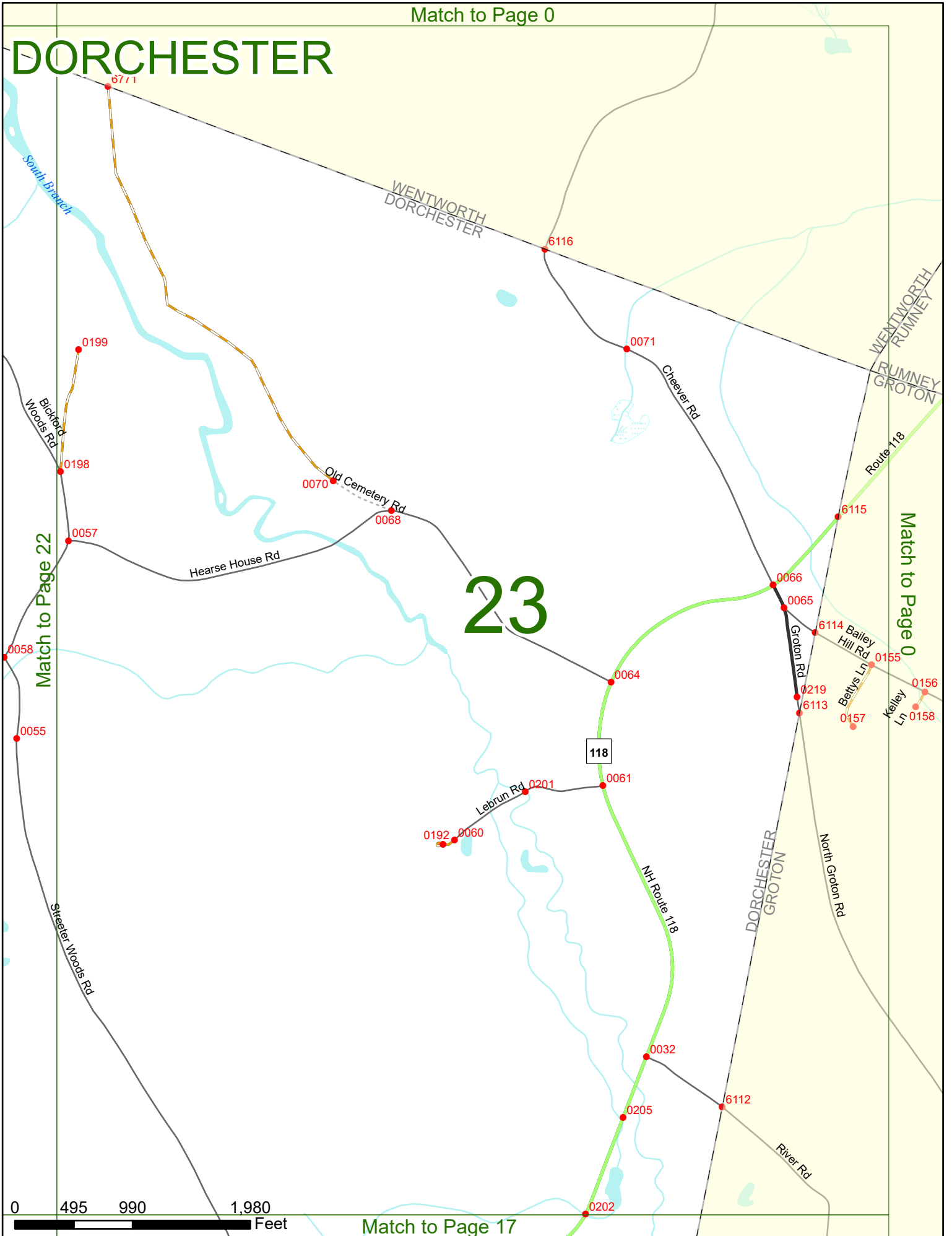

# 23

Match to Page 22

Match to Page 0

Match to Page 17

0 495 990 1,980 Feet

# DORCHESTER

Match to Page 0

ORFORD  
LYME

WENTWORTH  
DORCHESTER

LYME  
DORCHESTER

# 24

Match to Page 0

Match to Page 25

0 495 990 1,980 Feet

Match to Page 19

# DORCHESTER

WENTWORTH  
DORCHESTER

# 25

McClatchieon

Match to Page 24

Match to Page 26

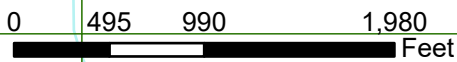

# DORCHESTER

26

Match to Page 25

Match to Page 27

WENTWORTH  
DORCHESTER

Line Pond

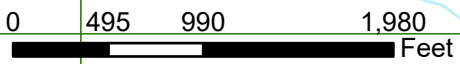

Match to Page 21

# DORCHESTER

# 27

Match to Page 26

Match to Page 0

