



Maps and data sets are not guaranteed to be free from errors and omissions. Data is in a constant state of update and correction by various groups and agencies. Information displayed on this map is the best available at the time of publication.

2025 Nodal Reference Bookmap

LEGEND



NHDOT will accept crash locations based on the State of NH Uniform Police Traffic Accident Report.

Crash occurred on:

Option 1 Street Address
 123 Main Street

Option 2 Route No and/or Distance from NESW Intesecting Road, Bridge,
 Street name Intersecting Street Town/County line
 Main Street 500 E Oak Street

Option 3 First Node Distance from First Node Second Node
 515 212 632

Option 4 Route No and/or Mile Marker on Interstate Only NESW Mile (Marker)
 Street name
 189S 700 feet S 36.8

Option 3 – Example

Street Name Loudon Road
First Node 803
Distance from First Node 318 Ft
Second Node 813



Match to Page 2

CHANDLERS PURCHASE

Match to Page 0

Match to Page 0

1
White
Mountain NF

BEANS GRANT
CUTTS GRANT

0 495 990 1,980 Feet

Match to Page 0

Match to Page 4

CHANDLERS PURCHASE

Match to Page 0

Where
Mountain 2 NF

CHANDLERS PURCHASE
BEANS GRANT

SARGENTS PURCHASE
CHANDLERS PURCHASE

Match to Page 3

CHANDLERS PURCHASE
CUTTS GRANT

0 495 990 1,980 Feet

Match to Page 1

CHANDLERS PURCHASE

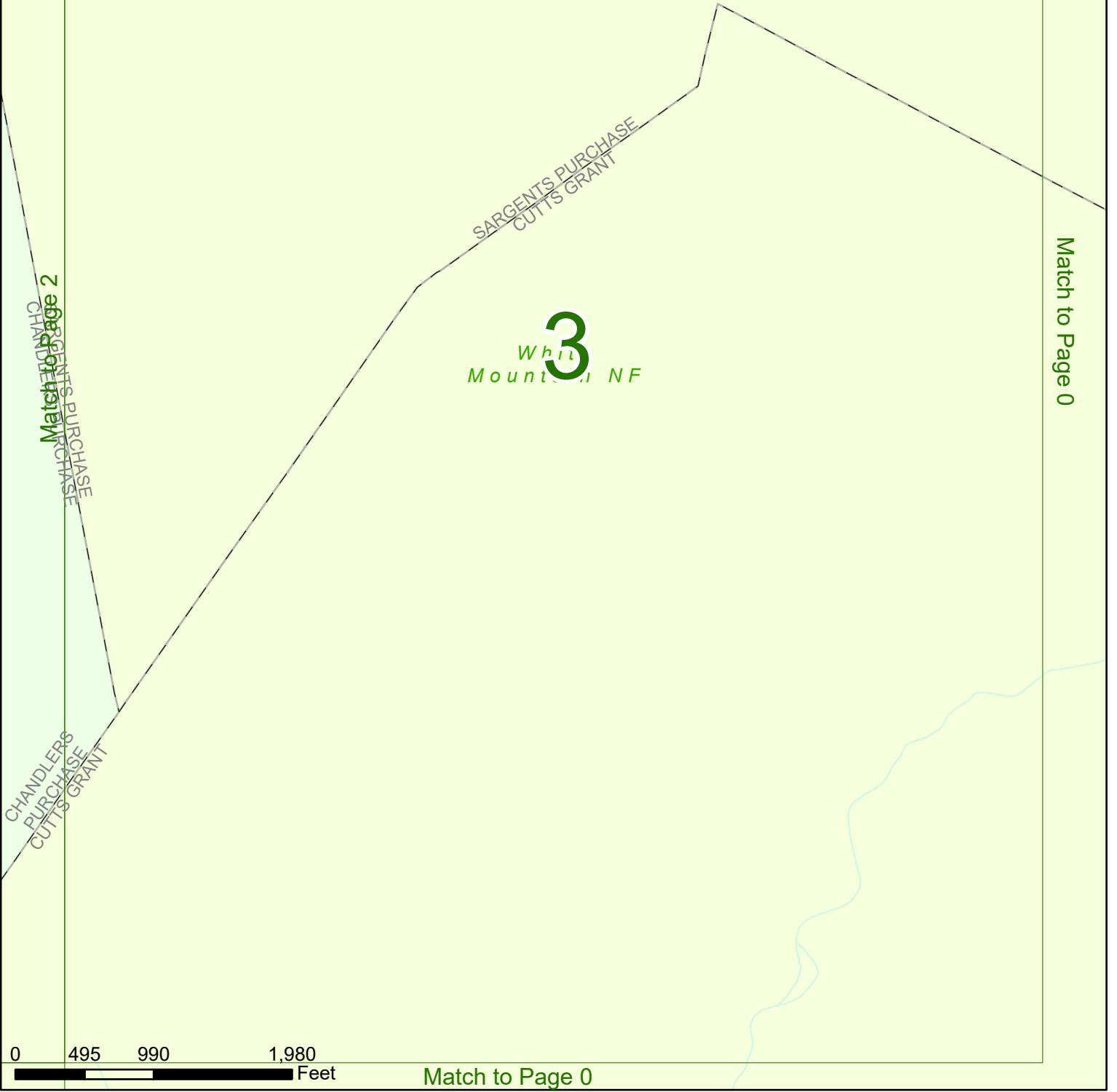

Match to Page 2

Match to Page 0

3
White Mountain NF

0 495 990 1,980 Feet

Match to Page 0

CHANDLERS PURCHASE

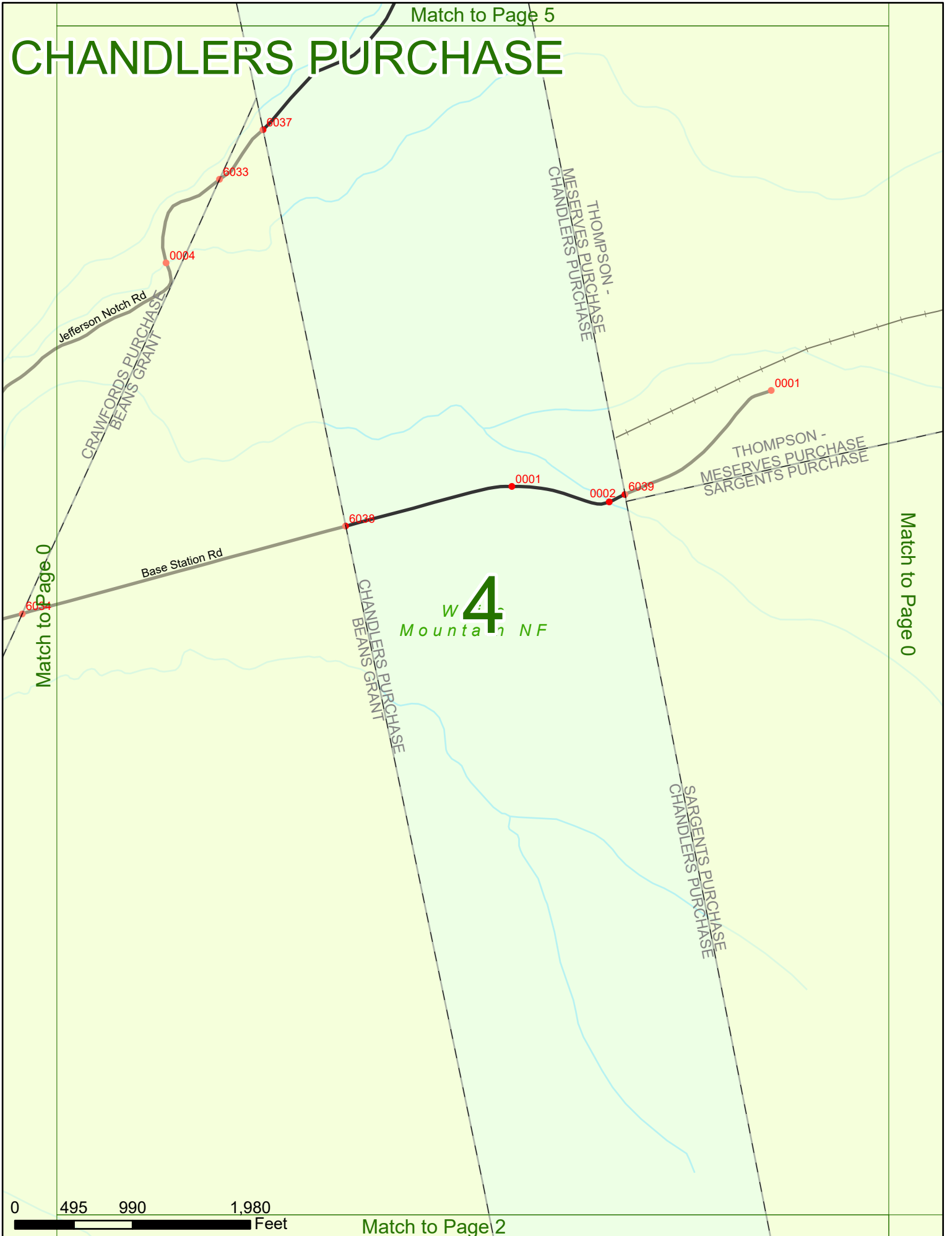

Match to Page 0

Match to Page 0

W4
Mountain NF

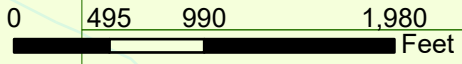

Match to Page 2

Match to Page 0

CHANDLERS PURCHASE

Notch Rd

LOW - BURBANKS GRANT
THOMPSON -
MESERVES PURCHASE

6043

LOW - BURBANKS GRANT
CHANDLERS PURCHASE

Match to Page 0

5
Writ
Mountains NF

Match to Page 0

0002

CHANDLERS PURCHASE
CRAWFORDS PURCHASE

THOMPSON -
MESERVES PURCHASE
CHANDLERS PURCHASE

Jefferson Notch Rd

6040

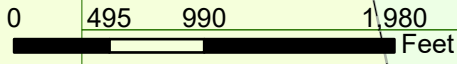

Match to Page 4