

















Maps and data sets are not guaranteed to be free from errors and omissions. Data is in a constant state of update and correction by various groups and agencies. Information displayed on this map is the best available at the time of publication.

# 2024 Nodal Reference Bookmap

## LEGEND

<b>Divided Highway Limited Access</b>	<b>Turnpike Toll Road</b>	<b>U.S. Route</b>	<b>N.H. Route</b>
			
<b>State Roads (Carries NO Route Number)</b>	<b>Local Roads</b>	<b>Class 6 Roads (Not Maintained)</b>	<b>Private Roads</b>
			
	<b>State Line</b>		<b>Lakes &amp; Ponds</b>
	<b>County Line</b>		<b>State Parks</b>
	<b>Town Line</b>		<b>National &amp; State Forests</b>
	<b>Rivers &amp; Streams</b>		<b>Reference Nodes</b>

NHDOT will accept crash locations based on the State of NH Uniform Police Traffic Accident Report.

Crash occurred on:

**Option 1**     Street Address  
                   123 Main Street

**Option 2**     Route No and/or     Distance from             NESW             Intesecting Road, Bridge,  
                   Street name             Intersecting Street                                     Town/County line  
                   Main Street                     500                     E                     Oak Street

**Option 3**     First Node                     Distance from First Node                     Second Node  
                   515                                     212                                     632

**Option 4**     Route No and/or             Mile Marker on Interstate Only             NESW             Mile (Marker)  
                   Street name  
                   189S                                     700 feet                                     S                     36.8

**Option 3 – Example**

Street Name                     Loudon Road  
First Node                             803  
Distance from First Node             318 Ft  
Second Node                             813



# PIERMONT

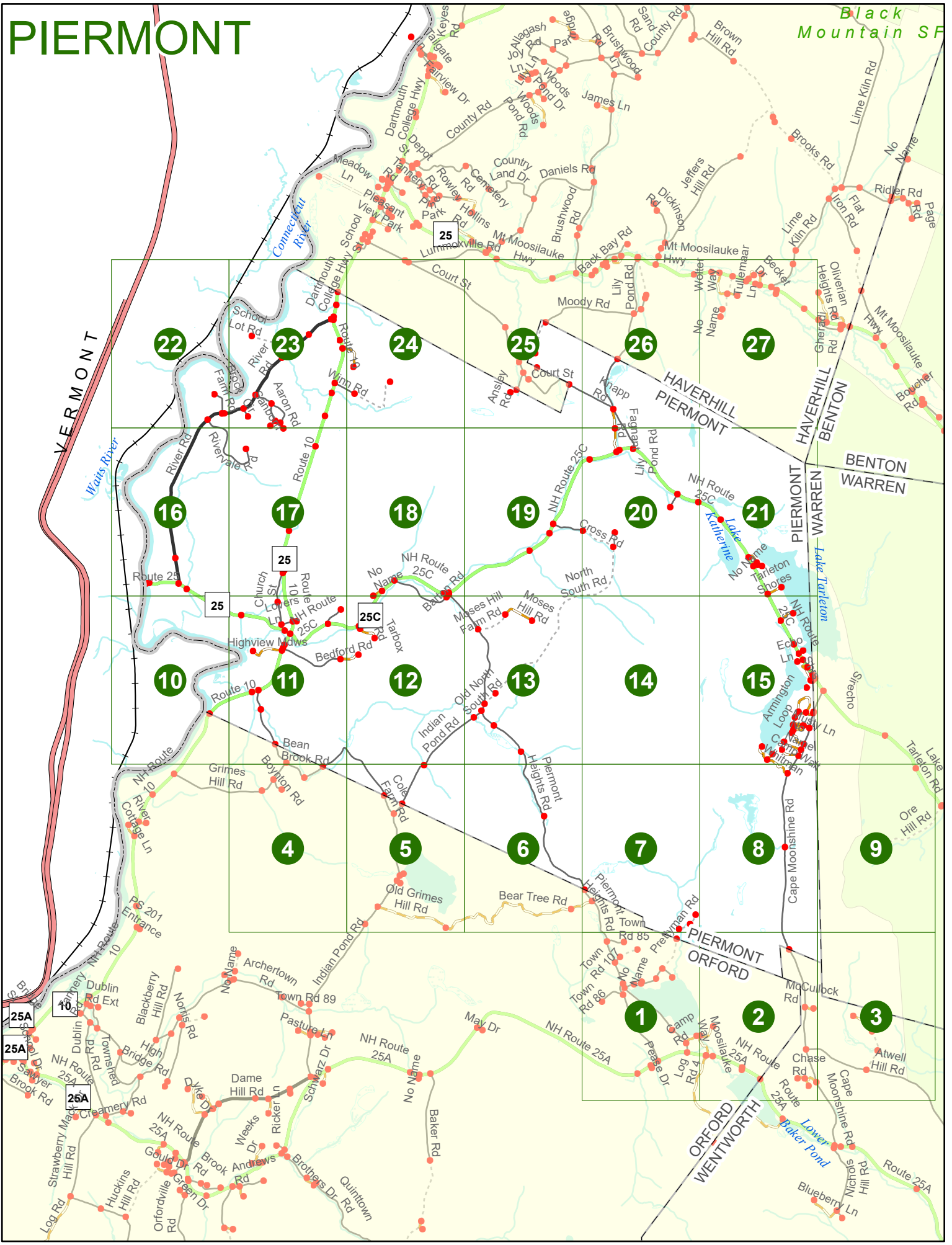

Match to Page 7

# PIERMONT

PIERMONT  
ORFORD

Match to Page 0

Match to Page 2

# 1

Town Rd 85 0104 0105

Town Rd 107 0048 0106

Prettyman Rd 6264

Piermont Heights Rd 0047

Upper Baker Pond Beach Rd 0039 0040

0044 0043 0045 0337 0309 0308

Town Rd 86 0046

Upper Baker Pond Rd

East Cemetery Rd 0305

Camp Rd 0304 0365 0330

Mooslaube Way 0329 0364

NH Route 25A 0041

Pease Dr 0267 0268

NH Route 25A 0050

25A

Log Rd 4

0 495 990 1,980 Feet

Match to Page 0

# PIERMONT

# 2

Match to Page 1

Match to Page 3

PIERMONT  
ORFORD

PIERMONT  
WENTWORTH

PIERMONT  
WARREN

WENTWORTH  
WARREN

Cape Monshire Rd

McCulloch Rd  
0240 0241

0084 Atwell Hill Rd

Cape Monshire Rd

0262 0261  
Bones Rd  
Dancing  
Chase Rd  
0263 0087

Camp Rd  
0365 0330

Moosilauke Way  
0306

0329 0364 0038

NH Route 25A

25A  
0036  
0037

6248

Route 25A

Lower  
Baker Pond

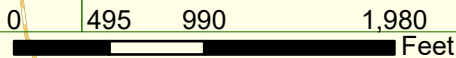

Match to Page 0

# PIERMONT

PIERMONT  
WARREN

WARREN  
WENTWORTH

White  
Mountain NF

# 3

Match to Page 0

Match to Page 2

0241

0239

0086

0088

0085

Chese  
Rd

0087

Cape Moonshine Rd

Webster Rd

Atwell Hill Rd

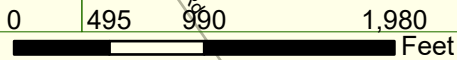

Match to Page 0

# PIERMONT

Match to Page 11

6263

PIERMONT  
ORFORD

Bean Brook Rd

0107

0277

Boylton Rd

0278

Grimes Hill Rd

0109

# 4

Match to Page 0

Match to Page 5

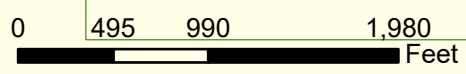

Match to Page 0

Match to Page 12

# PIERMONT

Bean Brook Rd

6268

Cole Farm Rd

6269

PIERMONT  
ORFORD

0112

Indian Pond Rd

# 5

Indian Pond  
Beach Rd 0094  
Host Ln 0093

0312  
0313

Indian Pond

0270

Old Grimes Hill Rd

0332

Bear Tree Rd

0327

Match to Page 4

Match to Page 6

0 495 990 1,980 Feet

Match to Page 0



Match to Page 13

# PIERMONT

# 6

Match to Page 5

Match to Page 7

PIERMONT  
ORFORD

Piermont Heights Rd

Bear Tree Rd

0205

6265

0324

0 495 990 1,980 Feet

Match to Page 0



# PIERMONT

# 7

Match to Page 6

Match to Page 8

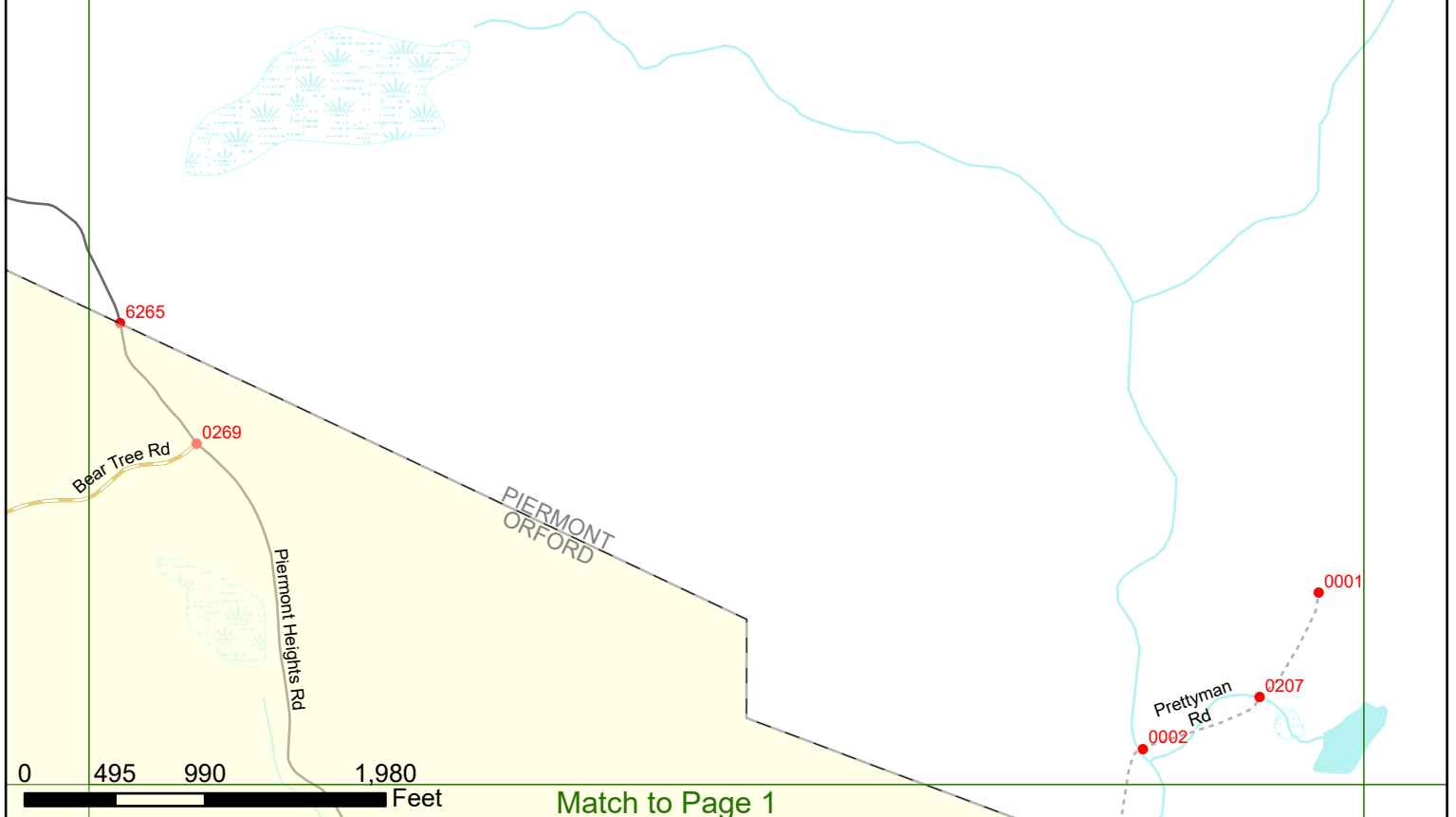

# PIERMONT

Match to Page 15

Camp Wait Whittan  
Cape Moonshine Rd  
0041

Match to Page 7

8

Cape Moonshine Rd  
0204

Match to Page 9

PIERMONT  
WARREN

0001

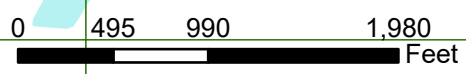

Match to Page 2

Match to Page 0

# PIERMONT

0246

Lake Tarleton Rd

25C

0063  
0227

Ore Hill Rd

0064

# 9

White Mountain NF

Match to Page 0

Match to Page 8

PIERMONT  
WARREN

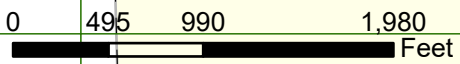

Match to Page 3

Match to Page 16

# PIERMONT

Route 25

25

Connecticut  
River

Match to Page 0

Match to Page 11

# 10

VERMONT

Route 10

6261

10

NH Route 10



Match to Page 0

# PIERMONT

Match to Page 17

VERMONT

Match to Page 10

Match to Page 12

# 11

0 495 990 1,980 Feet

Match to Page 4

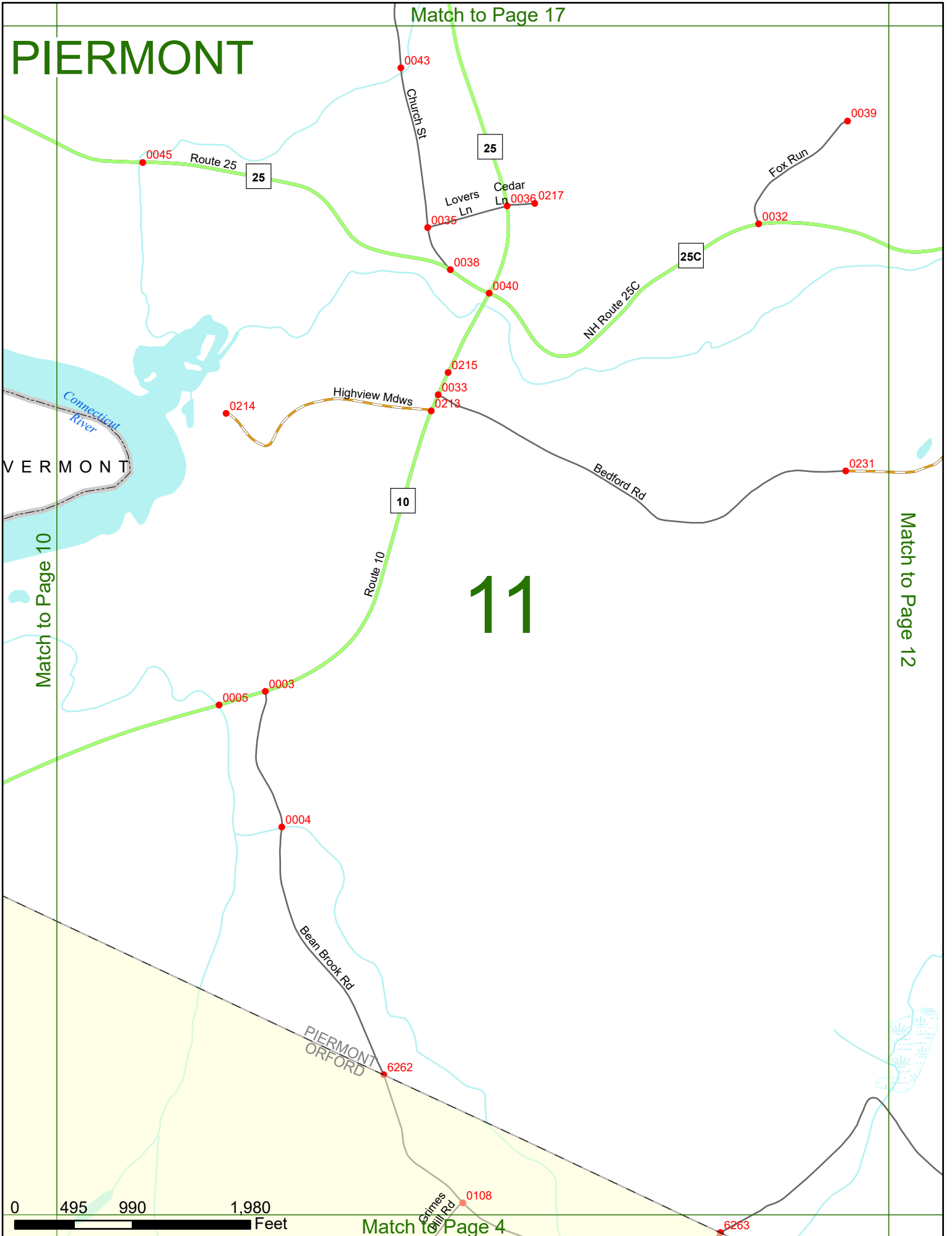

# PIERMONT

Match to Page 18

Fox Run  
0039

0031

NH Route 25C

25C

0201

0232

Tarbox Rd

0202

Barton Rd

0025 0227

0024

Indian Pond Rd

0231 Bedford Rd

0034

Match to Page 11

# 12

Match to Page 13

Bean Brook Rd

Indian Pond Rd

0 495 990 1,980 Feet

Match to Page 5

0007

# PIERMONT

Match to Page 12

Match to Page 14

# 13

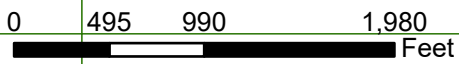
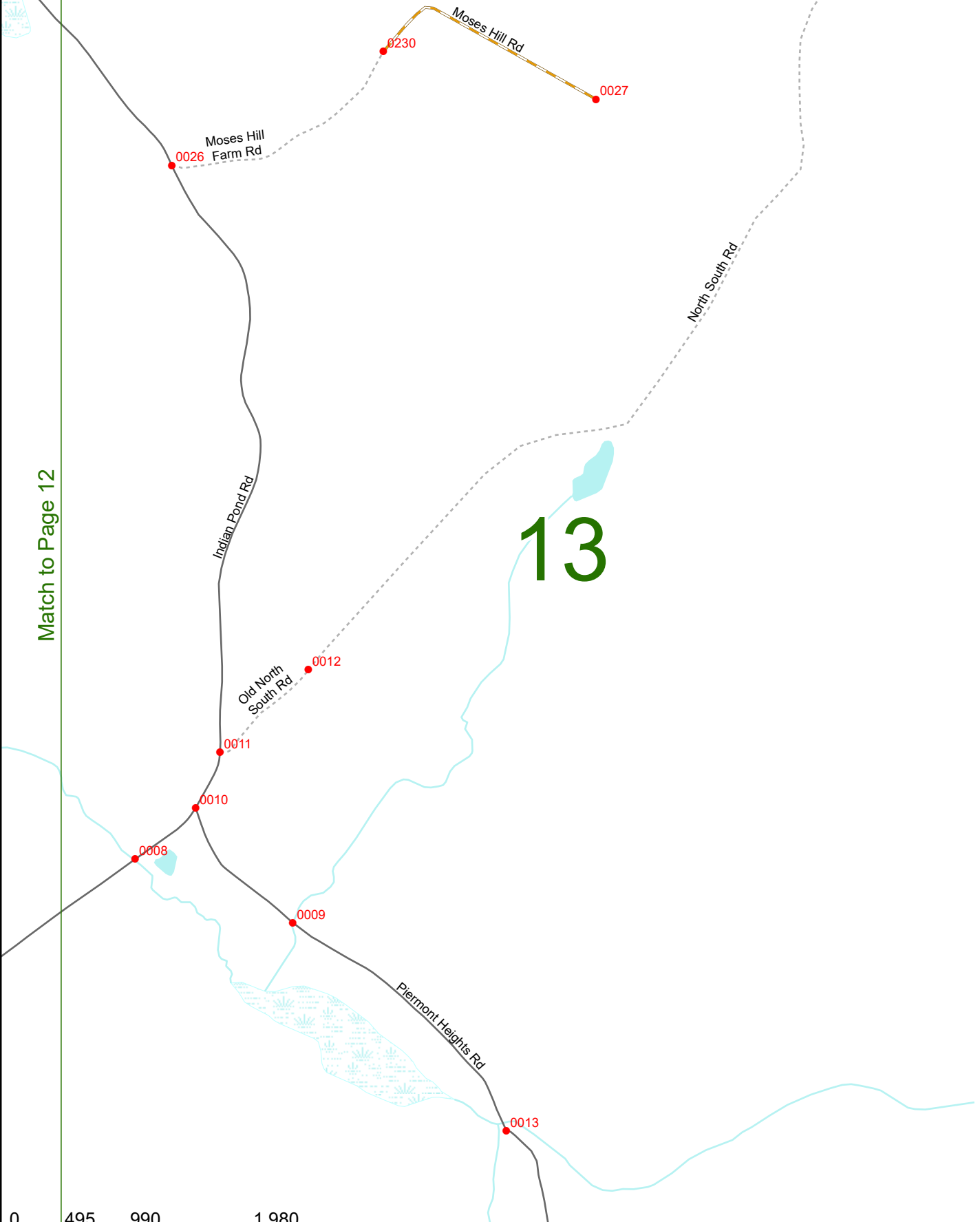



North South Rd

Match to Page 20

# PIERMONT

Match to Page 13

Match to Page 15

# 14

0 495 990 1,980 Feet

Match to Page 7

Match to Page 21

# PIERMONT

Match to Page 14

# 15

Match to Page 6

0 495 990 1,980 Feet

Match to Page 8



# PIERMONT

Match to Page 22

Connecticut  
River

Rivendale Rd

Waits River

River Rd

# 16

Match to Page 17

Match to Page 0

VERMONT

8483 0049 0048

Route 25

25

0050

0047

0046

0 495 990 1,980 Feet

Match to Page 10

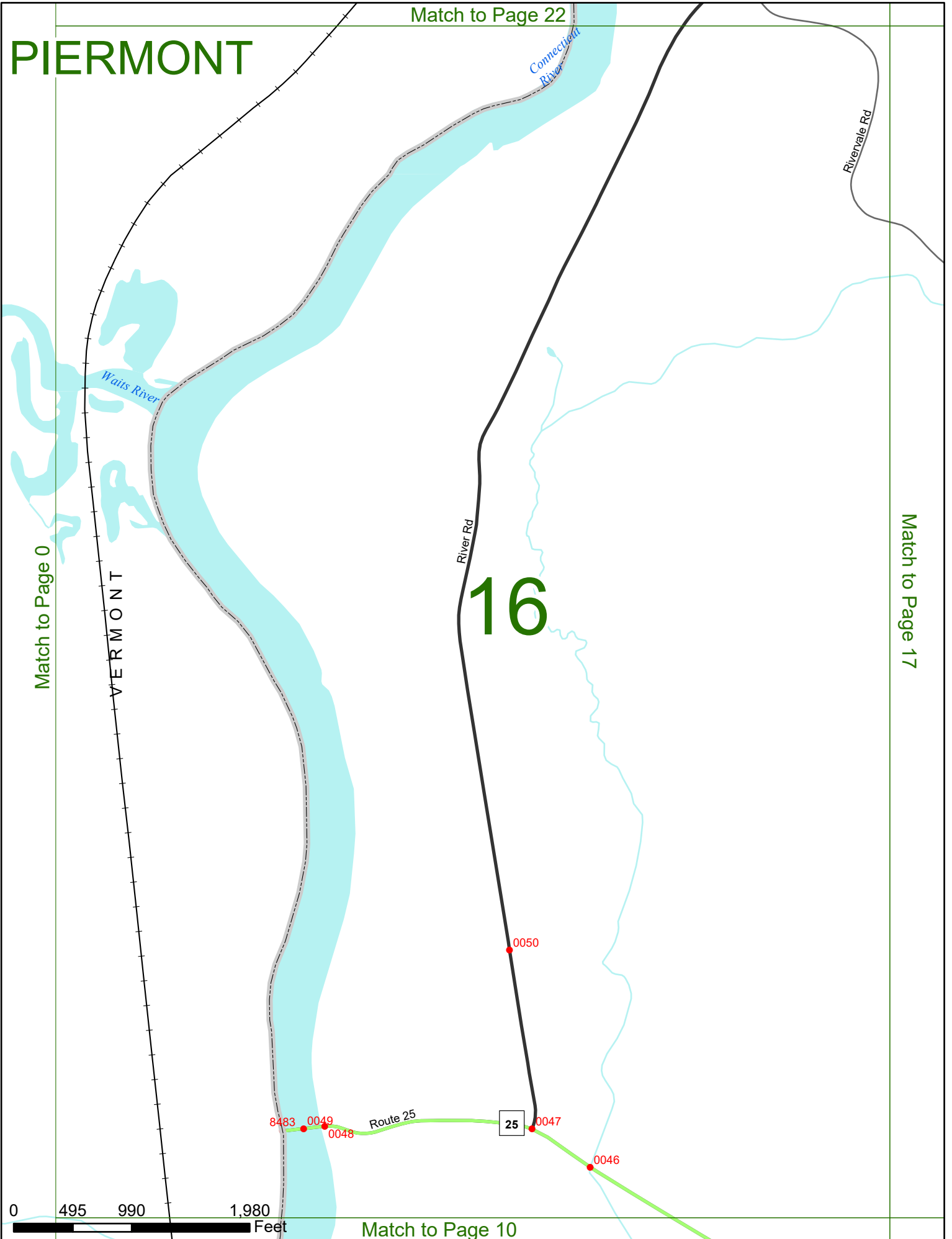

# PIERMONT

Match to Page 23

Rivervale Rd

0030

0051

0032

0084

Route 10

Match to Page 16

0061

Szuch Rd

# 17

0060

Match to Page 18

0044

25

10

0037

0042

Church St

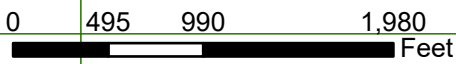

Match to Page 11

# PIERMONT

Match to Page 17

Match to Page 19

# 18

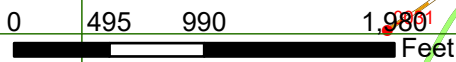

Match to Page 12

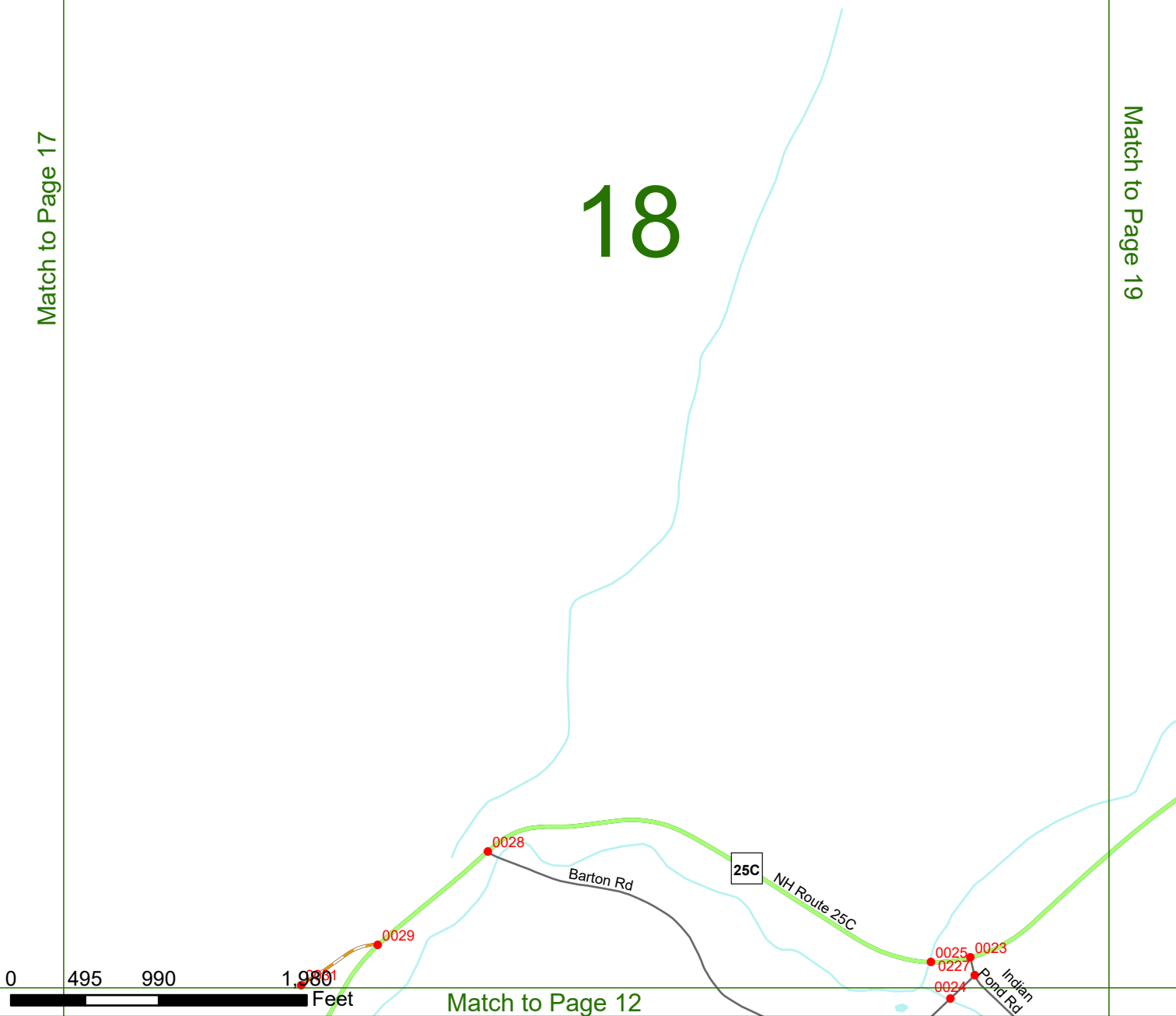

# PIERMONT

Match to Page 18

Match to Page 20

# 19

25C

NH Route 25C

NH Route 25C

Cross Rd

North South Rd

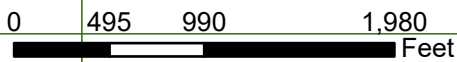

Match to Page 13

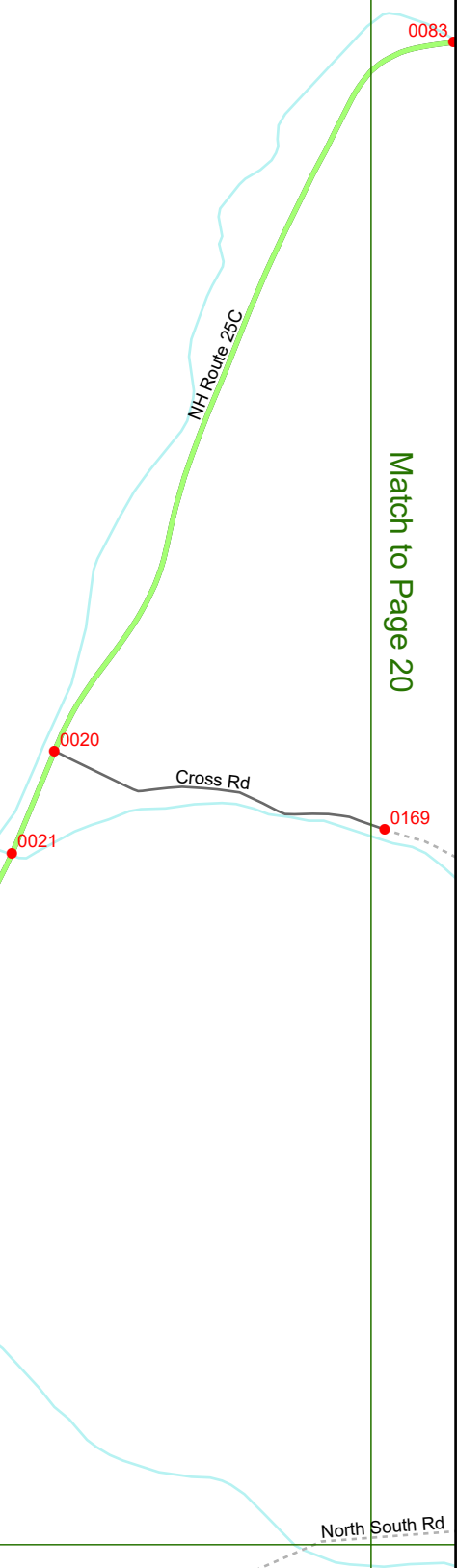

# PIERMONT

Match to Page 26

0170  
Fagnant Rd

Lily Pond Rd

0081  
0082

0080

0083

25C

NH Route 25C

0077  
Rochimon Ln

0078

0079

Match to Page 21

# 20

Match to Page 19

0169

Cross Rd

0018

0228

North South Rd

0 495 990 1,980 Feet

Match to Page 14

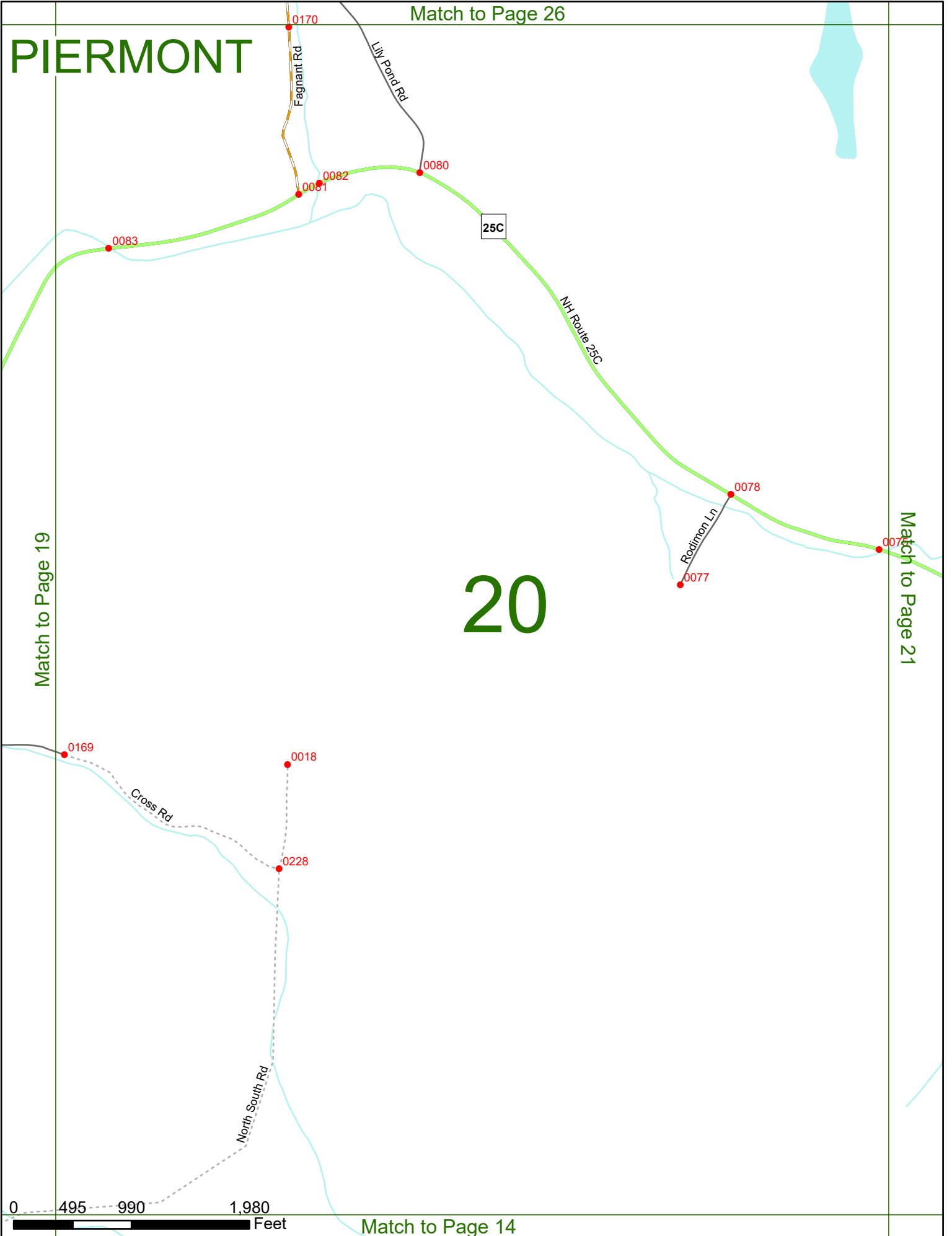

Match to Page 27

# PIERMONT

Haverhill  
Piermont

Haverhill  
Benton

Benton  
Warren

White  
Mountain  
NF

Match to Page 0

Piermont  
Warren

# 21

Match to Page 20

0075

0019

NH Route 25C

25C

Lake  
Katherine

0198

0182

0189

0211

0212

Lake  
Tarleton

0186

0185

Tarleton Shores  
NH Route 25C

0 495 990 1,980 Feet

Match to Page 15

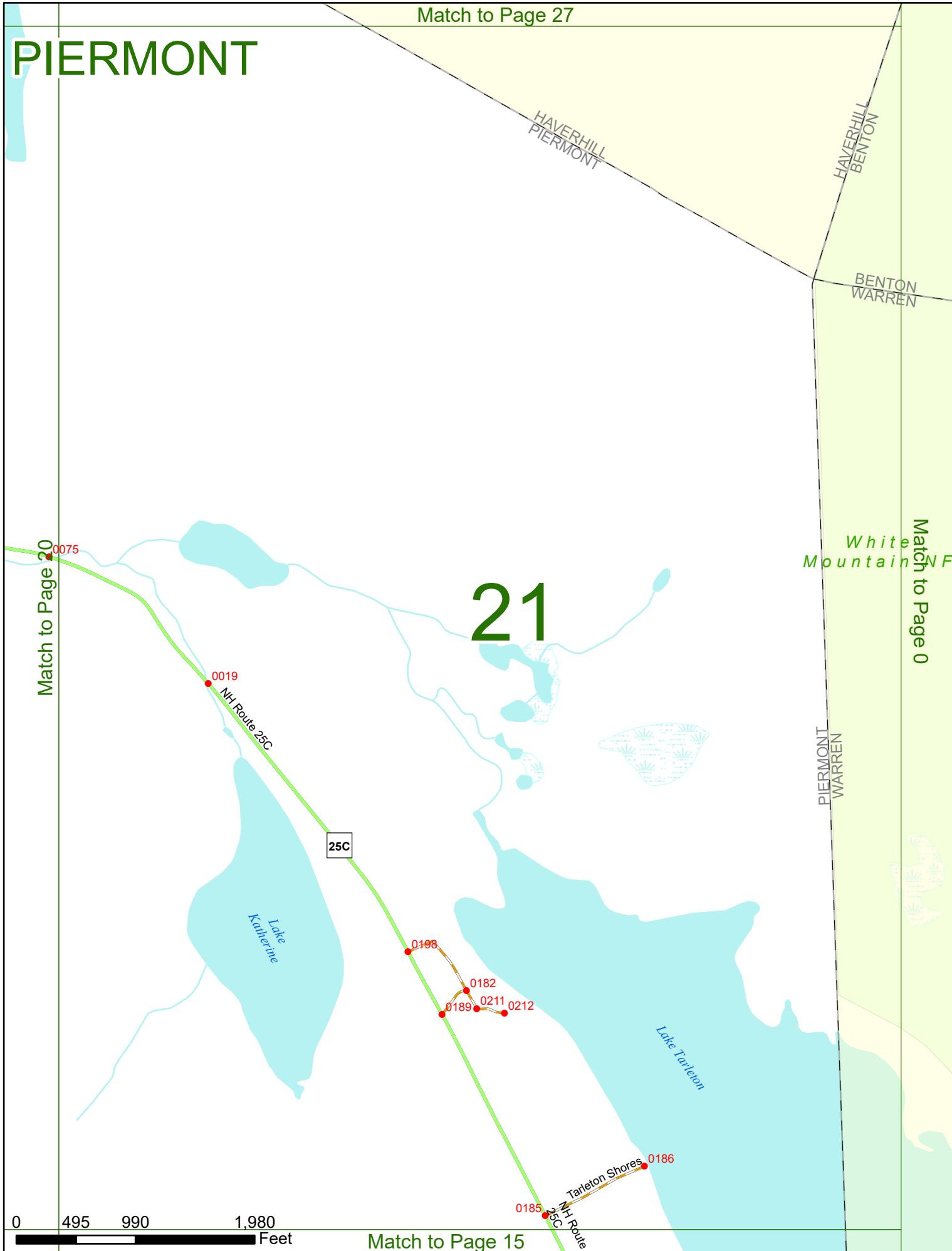



Match to Page 0

# PIERMONT

VERMONT

# 22

Match to Page 23

Match to Page 0

N 91

N 91

Connecticut River

0058

Brock Farm Rd

River Rd 0059

0057

0079

Rivervale Rd

0 495 990 1,980 Feet

Match to Page 16

Match to Page 0

# PIERMONT

VERMONT

HAVERTHILL  
PIERMONT

Dartmouth College Hwy

Match to Page 22

Match to Page 24

# 23

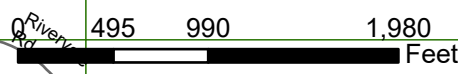

Match to Page 17

# PIERMONT

Match to Page 0

Lummoxxville Rd

Court St

HAVERHILL  
PIERMONT

# 24

Match to Page 25

Match to Page 23

Route 10

Black Hill Rd

Winn Rd

0 495 990 1,980 Feet

Match to Page 18

0031 0029

0070

0221

0219

0238

# PIERMONT

Match to Page 0

0035

Mt Moosilauke Hwy

Brushwood Rd

0014

0020

25

Court St

Moody Rd

Match to Page 24

Match to Page 26

# 25

0028

Coos Tpke

0022

Cutting Hill Rd

6285

6286

0072

0021

6282

Water Rd

0024

0023

Ansley Rd

0229

6281

Court St

HAVERTHILL  
PIERMONT

6283

Knapp Rd

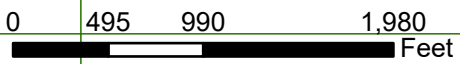

Match to Page 19

# PIERMONT

Match to Page 0

# 26

Match to Page 25

Match to Page 27

Match to Page 20

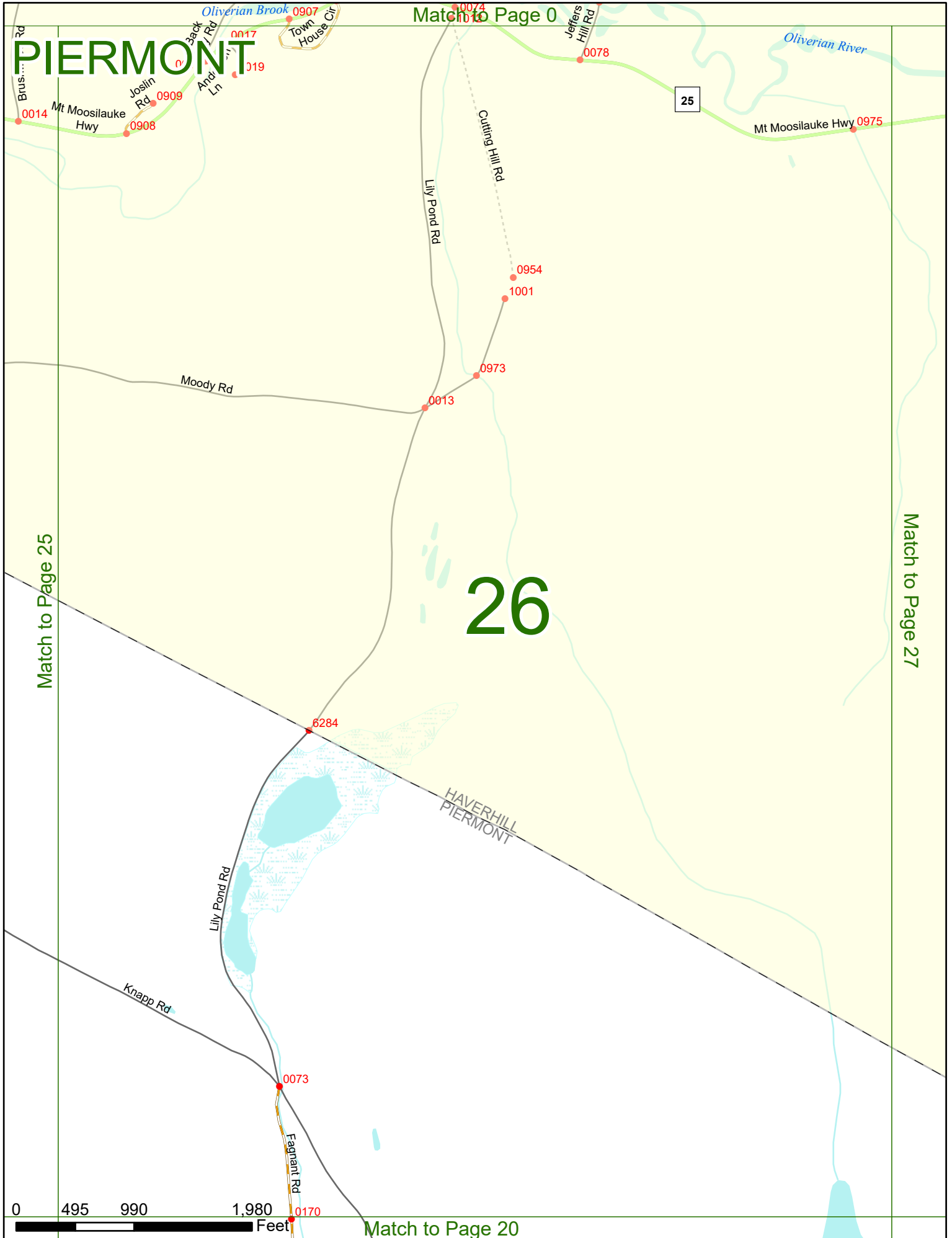

Match to Page 0

# PIERMONT

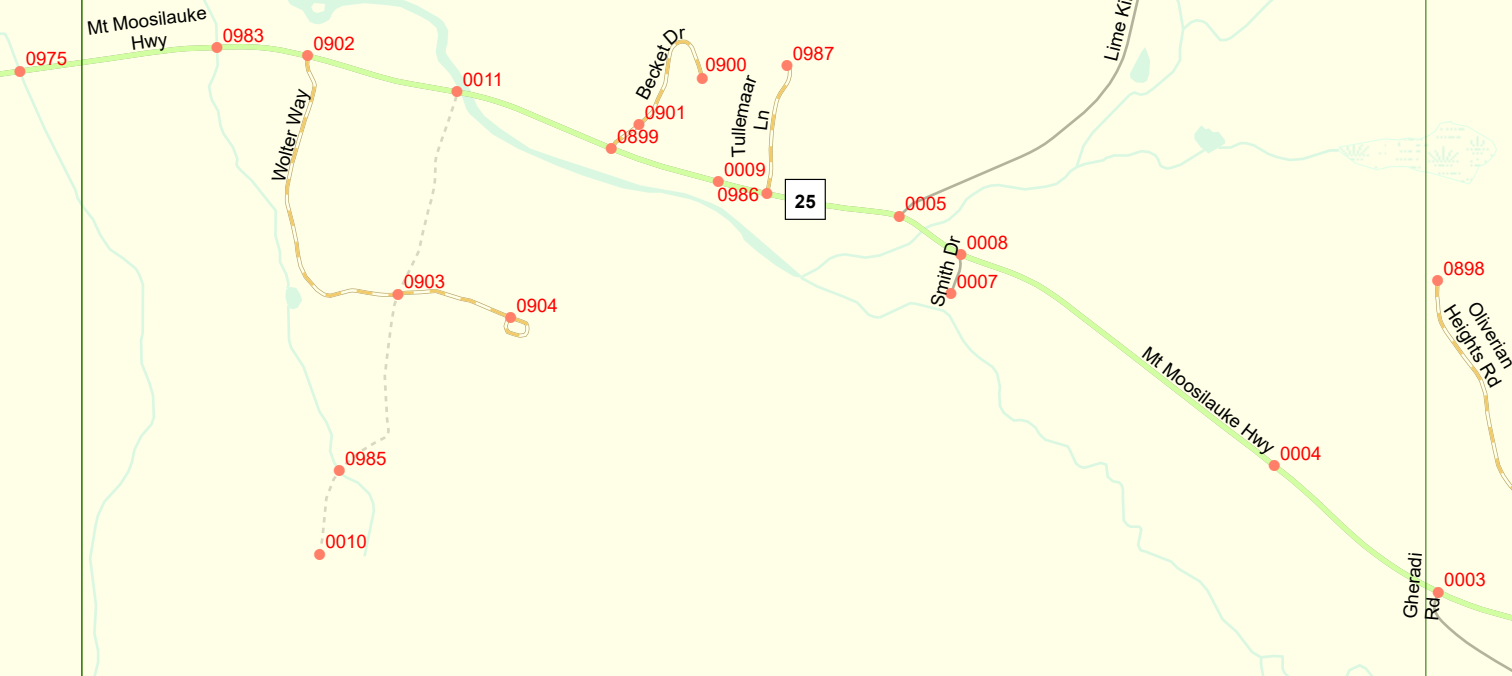

Match to Page 26

Match to Page 0

# 27

HAVERHILL  
PIERMONT

HAVERHILL  
BENTON

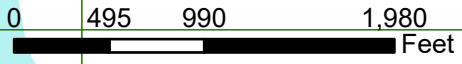

Match to Page 21

White Mountain NF