

New Hampshire  
**DOT**  
 Department of Transportation

Maps and data sets are not guaranteed to be free from errors and omissions. Data is in a constant state of update and correction by various groups and agencies. Information displayed on this map is the best available at the time of publication.

# 2024 Nodal Reference Bookmap

## LEGEND

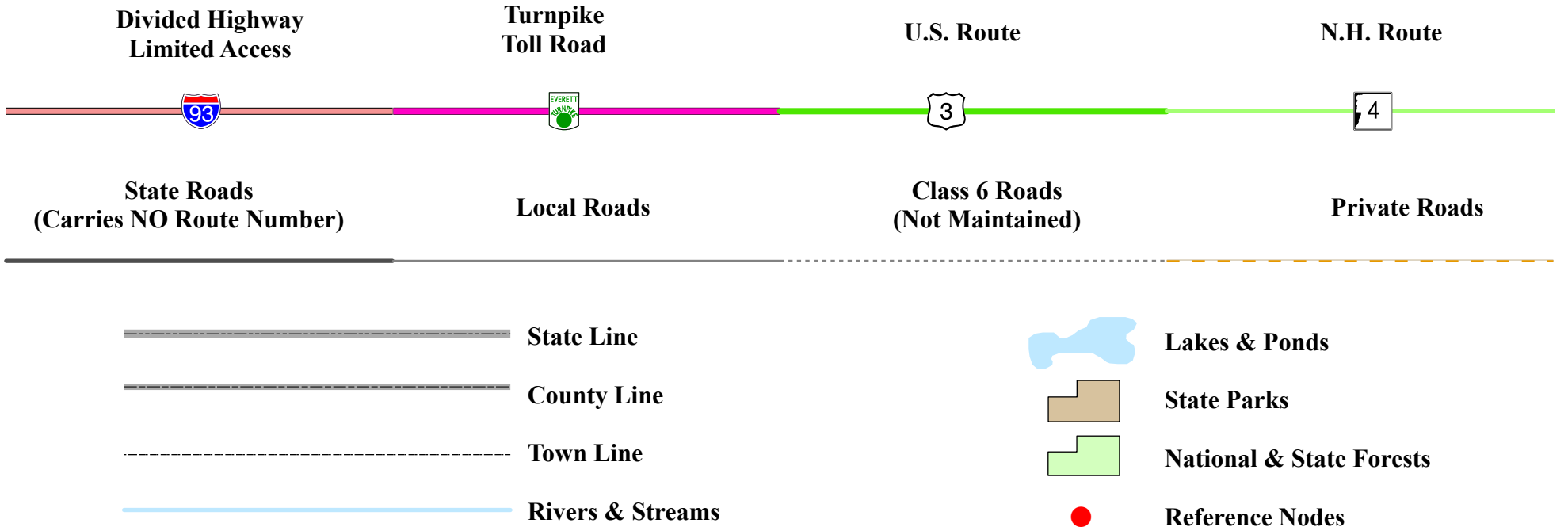

NHDOT will accept crash locations based on the State of NH Uniform Police Traffic Accident Report.

Crash occurred on:

**Option 1**     Street Address  
                   123 Main Street

**Option 2**     Route No and/or     Distance from             NESW             Intesecting Road, Bridge,  
                   Street name             Intersecting Street                                     Town/County line  
                   Main Street                    500                                     E                    Oak Street

**Option 3**     First Node                    Distance from First Node                    Second Node  
                   515                                    212                                    632

**Option 4**     Route No and/or     Mile Marker on Interstate Only     NESW     Mile (Marker)  
                   Street name  
                   189S                    700 feet                                    S                    36.8

**Option 3 – Example**

Street Name                    Loudon Road  
First Node                        803  
Distance from First Node     318 Ft  
Second Node                    813



# NORTHFIELD

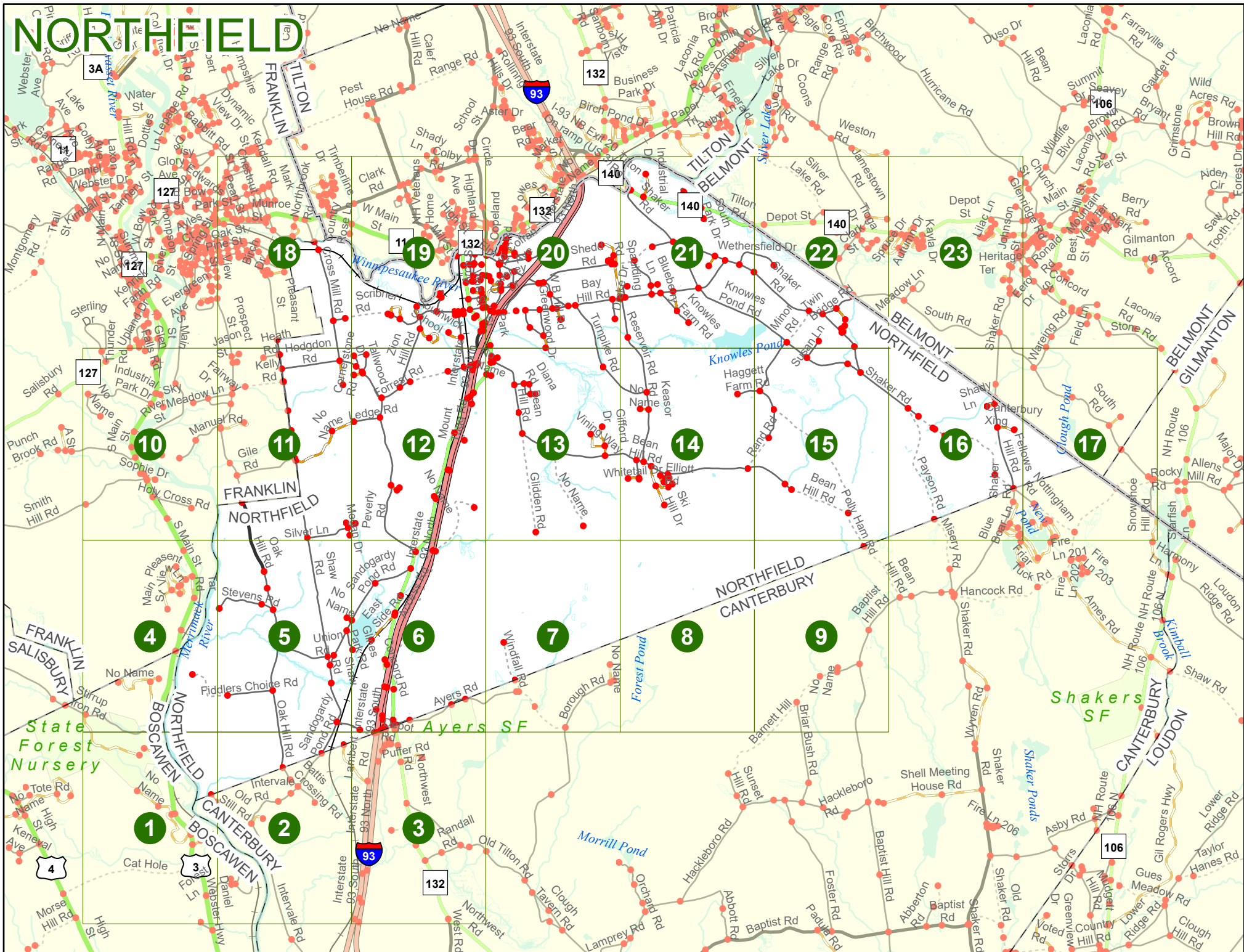

# NORTHFIELD

Match to Page 4

State Forest Nursery

# 1

Match to Page 0

Match to Page 2

Stirrup Iron Rd

NORTHFIELD BOSCAWEN

Merrimack River

3

Daniel Webster Hwy

NORTHFIELD CANTERBURY

CANTERBURY BOSCAWEN

Old Still Rd

Wastewater Treatment Access

Cat Hole

Forest Ln

Daniel Webster Hwy

Eastmen Rd

0102

4

495 990 1980 Feet

Match to Page 0

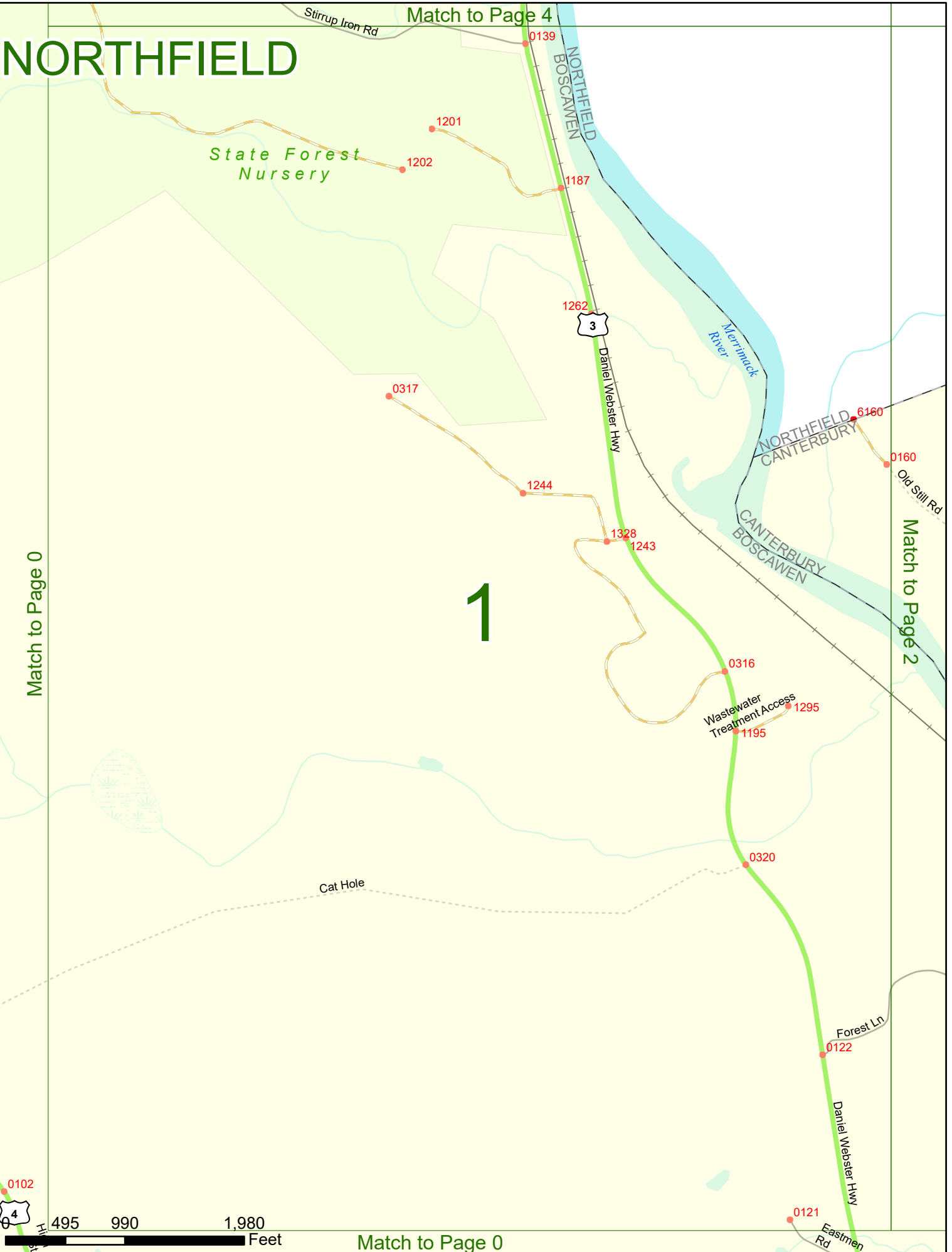

# NORTHFIELD

NORTHFIELD  
CANTERBURY

Oak Hill Rd

Sandogardy Pond Rd

Intervale Rd

Battis Crossing Rd

# 2

Old Still Rd

Merimack  
River

CANTERBURY  
BOSCAWEN

Intervale Rd

Forest Ln

Deer Run Rd

Daniel Webster Hwy

495 990 1,980 Feet



# NORTHFIELD

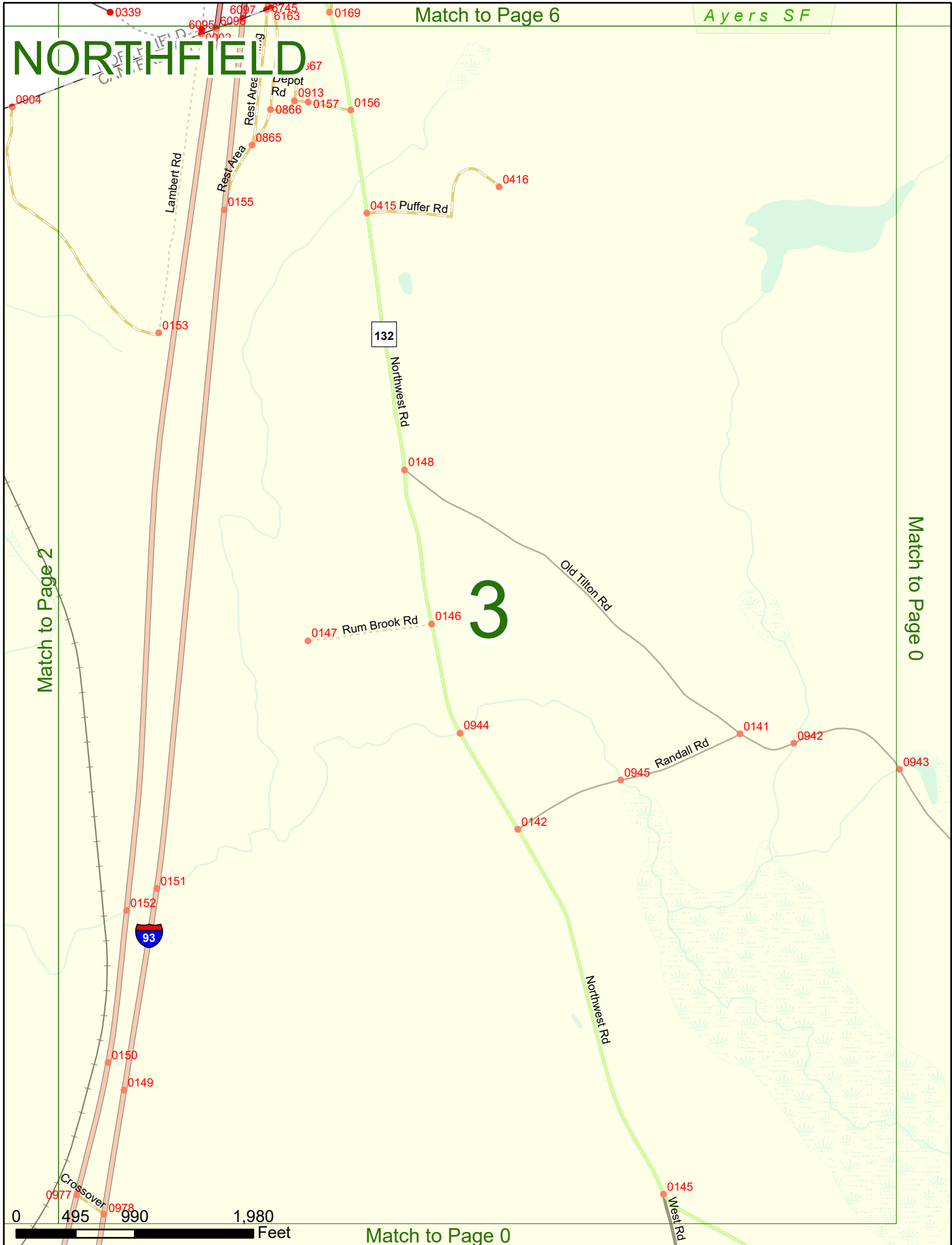

Match to Page 2

Match to Page 0

# 3





# NORTHFIELD

Match to Page 0

Match to Page 5

# 4

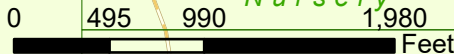
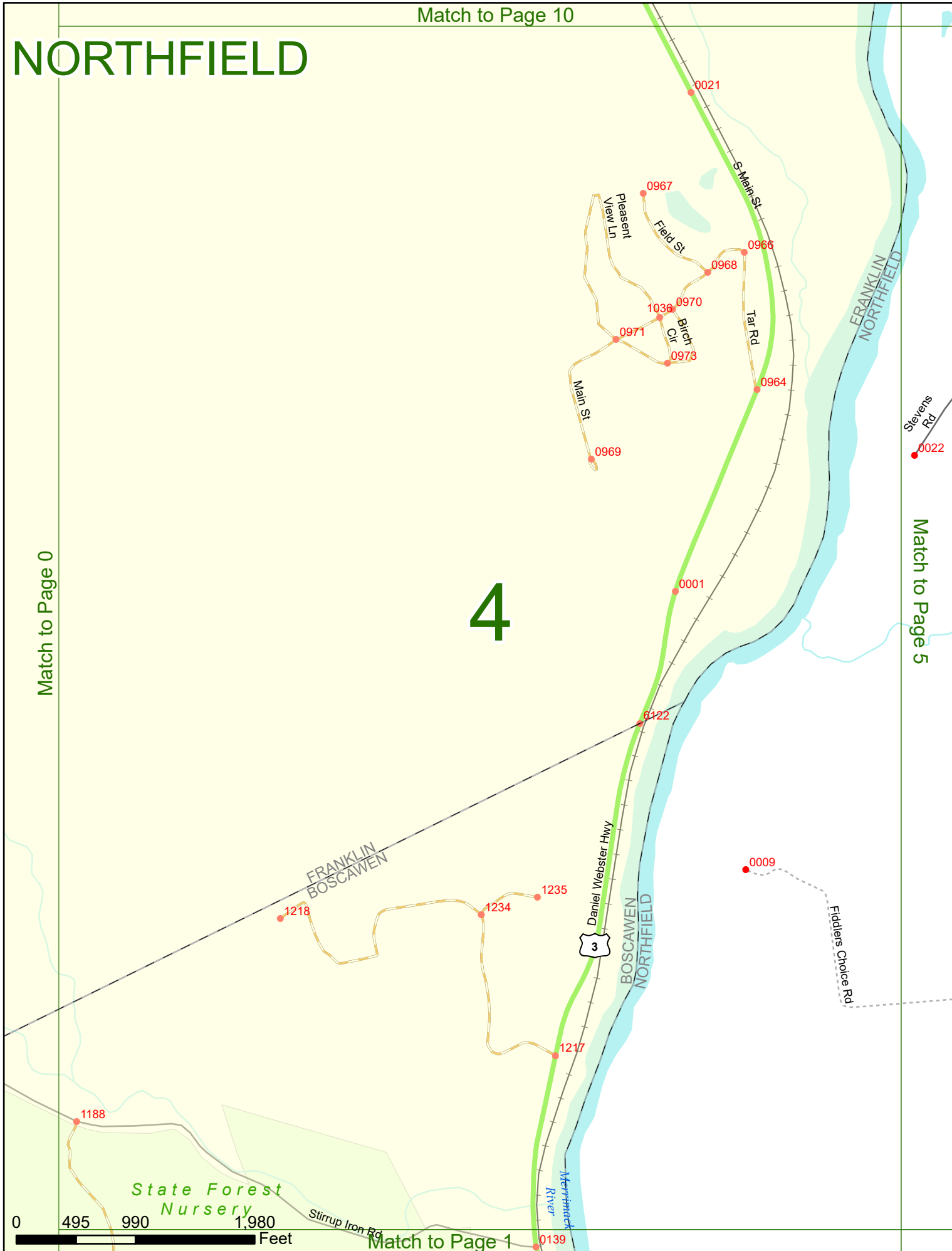

Match to Page 11

# NORTHFIELD

# 5

Match to Page 4

Match to Page 6

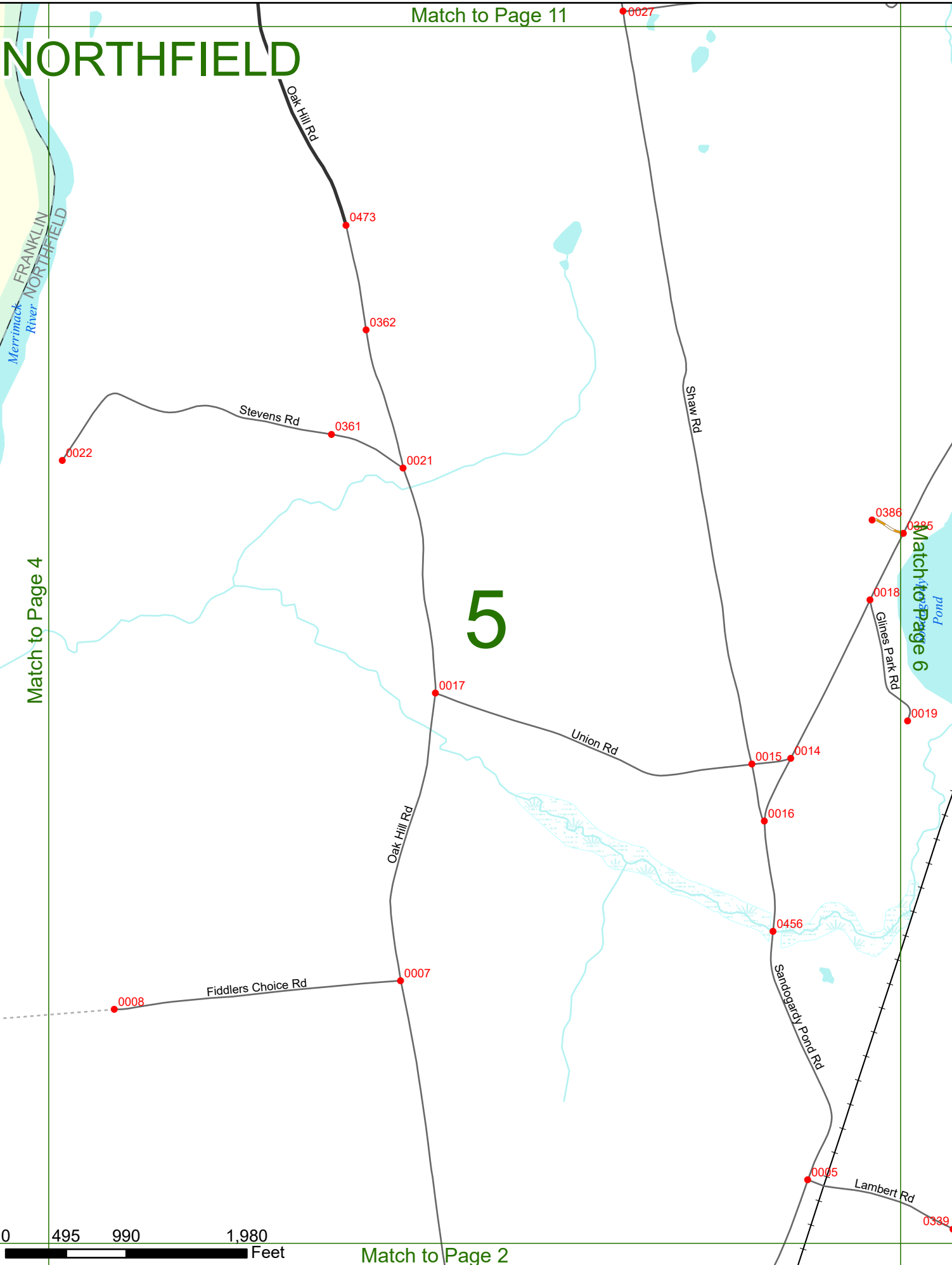

0 495 990 1,980 Feet

Match to Page 2



# NORTHFIELD

Match to Page 12

Match to Page 7

# 6

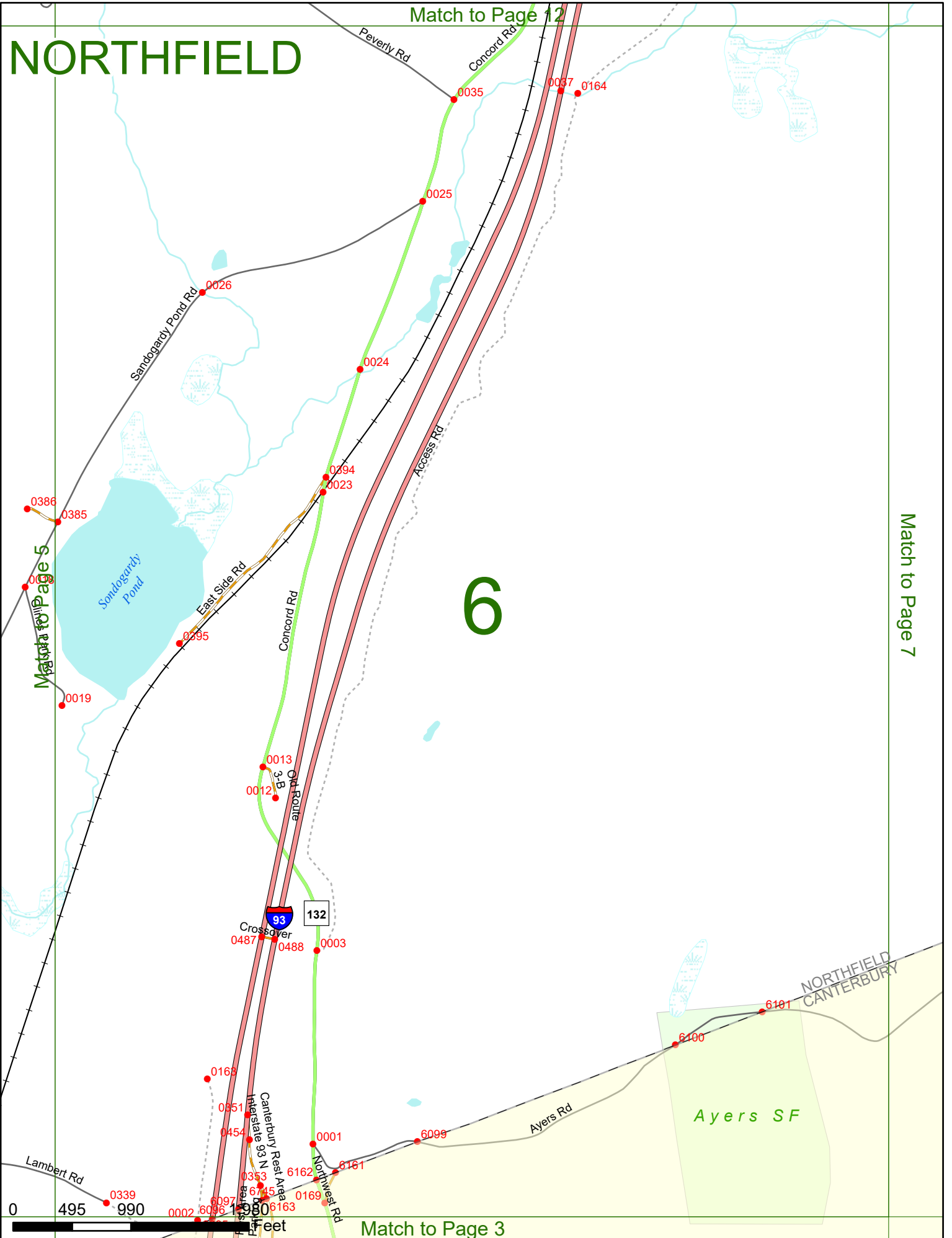

0 495 990 Feet

Match to Page 3

Ayers SF

NORTHFIELD  
CANTERBURY

# NORTHFIELD

# 7

Match to Page 6

Match to Page 8

NORTHFIELD  
CANTERBURY

0340

Windfall Rd

6182

0438

0170

0941

Ayers Rd

0172

0420

0173

0419

Borough Rd

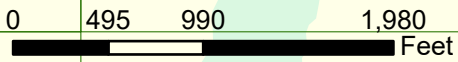

Match to Page 0

# NORTHFIELD

NORTHFIELD  
CANTERBURY

8

*Forest Pond*

0173

Match to Page 7

Match to Page 9

0 495 990 1,980 Feet

Match to Page 0

# NORTHFIELD

NORTHFIELD  
CANTERBURY

Polly  
Hart Rd  
6103

Bear Hill Rd

# 9

Baptist Hill Rd  
0934

Match to Page 0

Match to Page 8

0175

0871  
0870

0174

Briar Bush Rd

0959

Barnett Hill

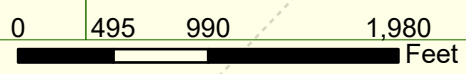

Match to Page 0

# NORTHFIELD

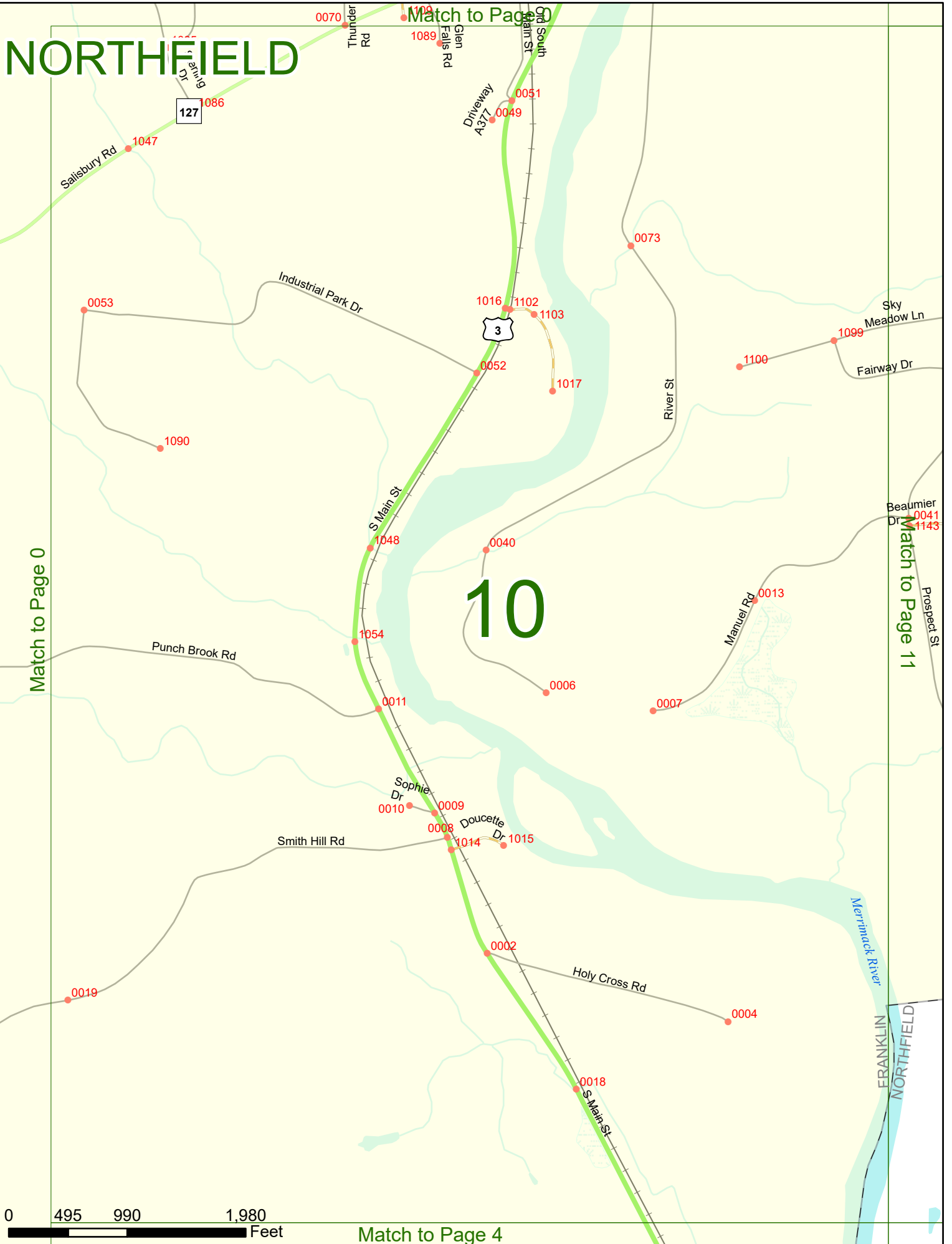

0 495 990 1,980 Feet

Match to Page 4

Match to Page 0

Match to Page 11

10

# NORTHFIELD

Match to Page 18

# 11

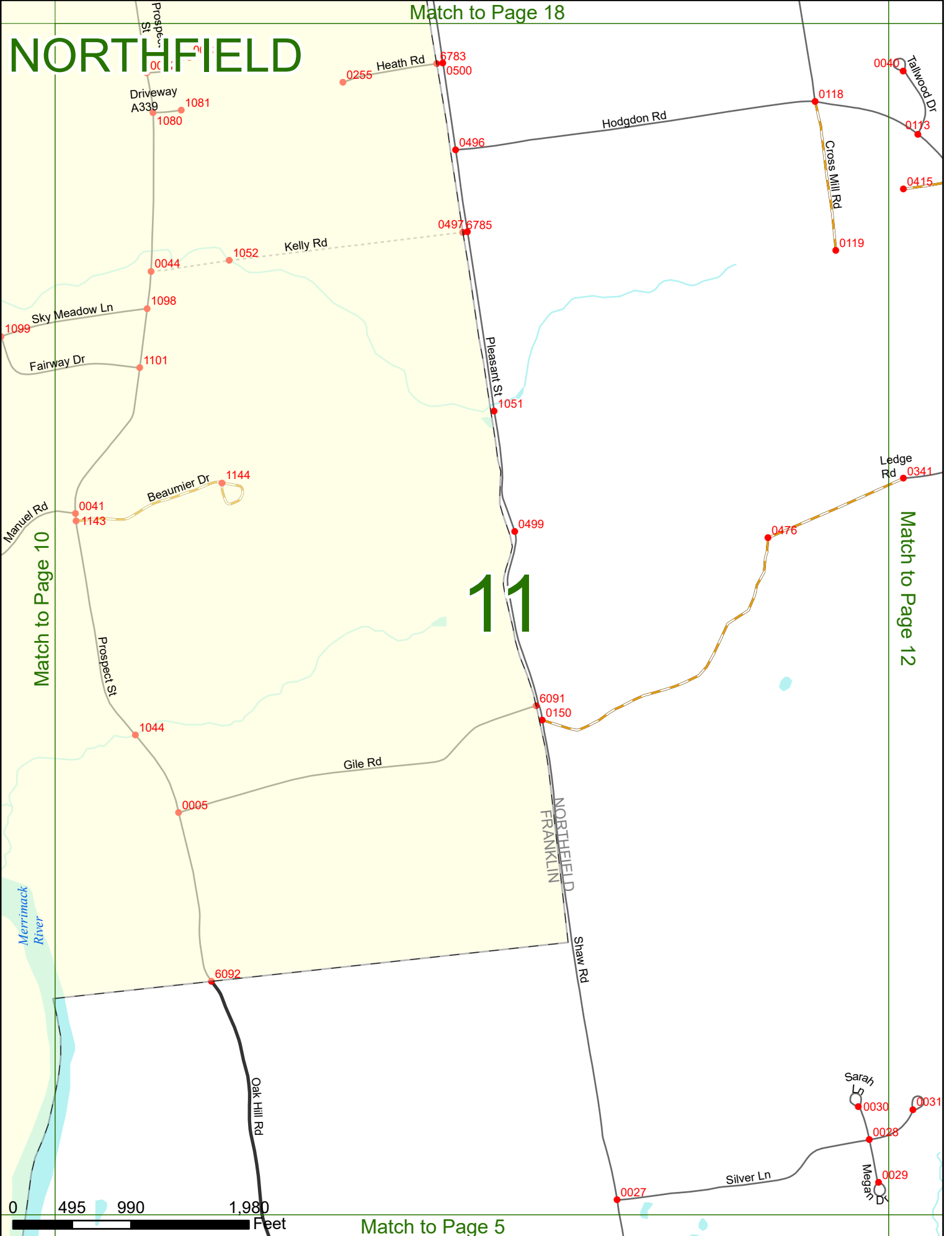

Match to Page 10

Match to Page 12

Match to Page 5

Match to Page 19

# NORTHFIELD

# 12

Match to Page 13

Match to Page 11

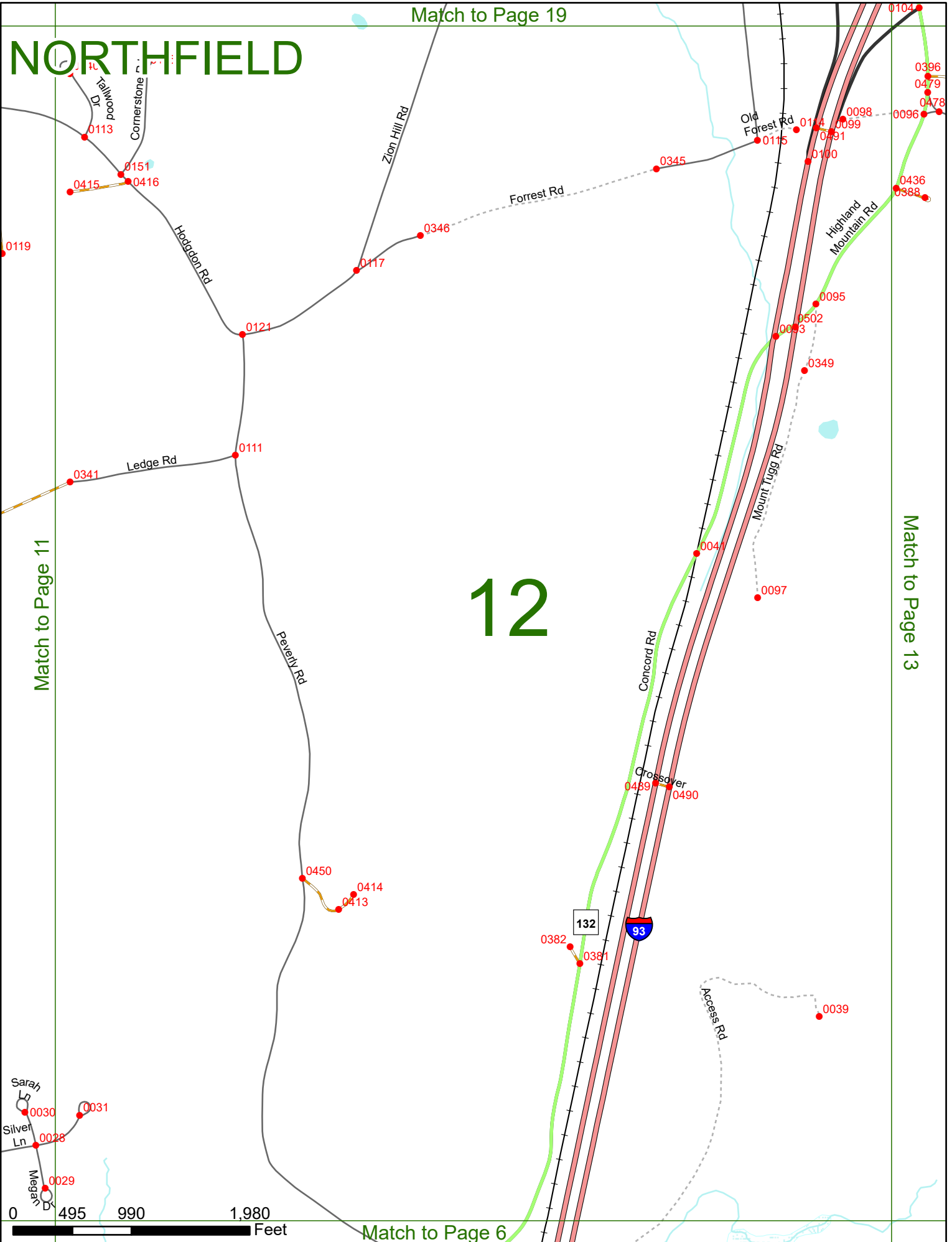

Sarah Ln  
Silver Ln  
Megan Dr

0030  
0031  
0028  
0029

0 495 990 1,980 Feet

Match to Page 6

Access Rd

132  
93

Crossover  
0489 0490

0450  
0414  
0413

0097

0095  
0502  
0093

0098  
0099  
0091

0104  
0396  
0479  
0478

0436  
0388

0345

0346

0117

0121

0111

0151  
0416

0113

0119

0341

0349

0041

0382

0381



# NORTHFIELD

Match to Page 20

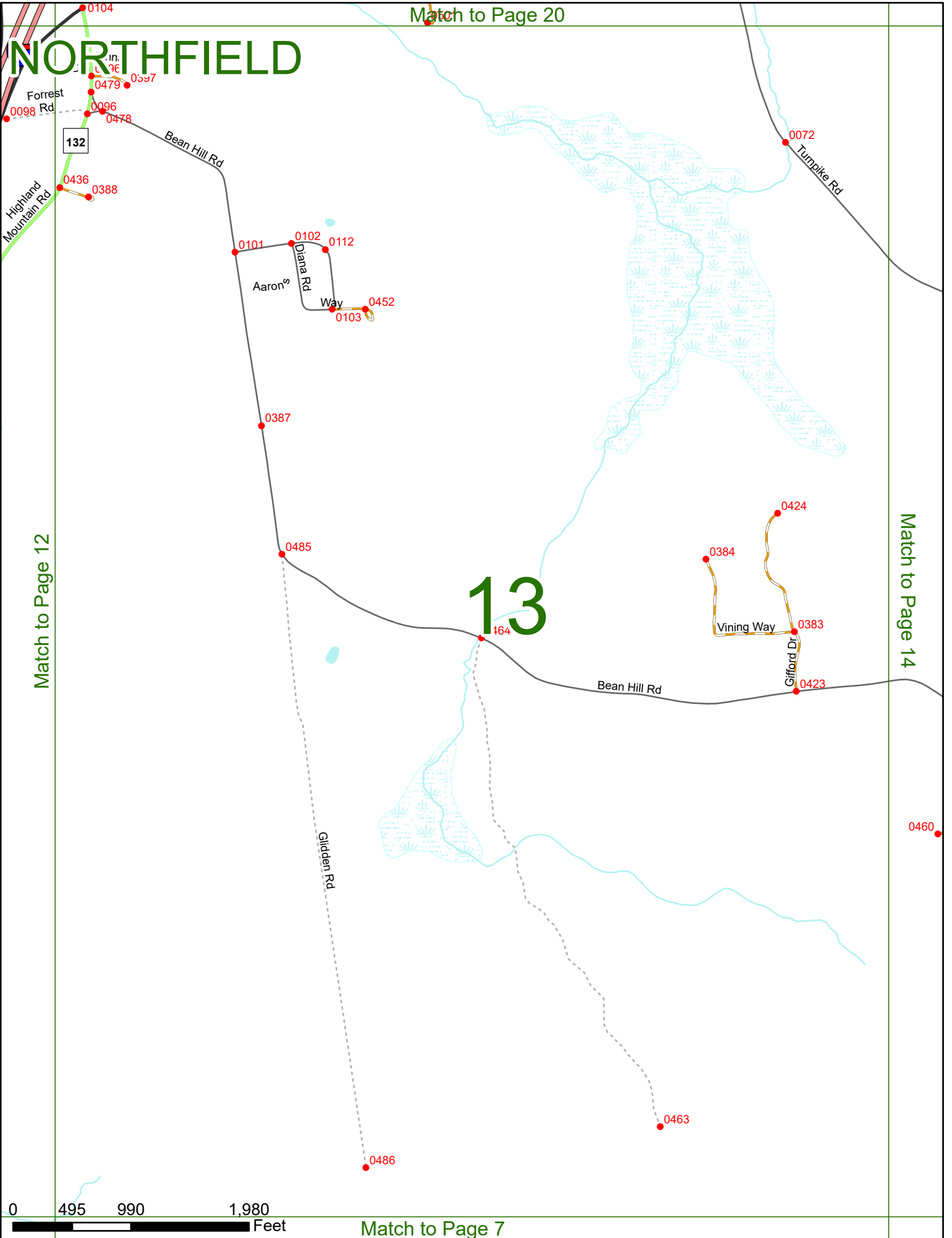

Match to Page 12

Match to Page 14

# 13

0 495 990 1,980 Feet

Match to Page 7

Knowles Pond

# NORTHFIELD

# 14

Match to Page 13

Match to Page 15

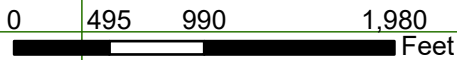
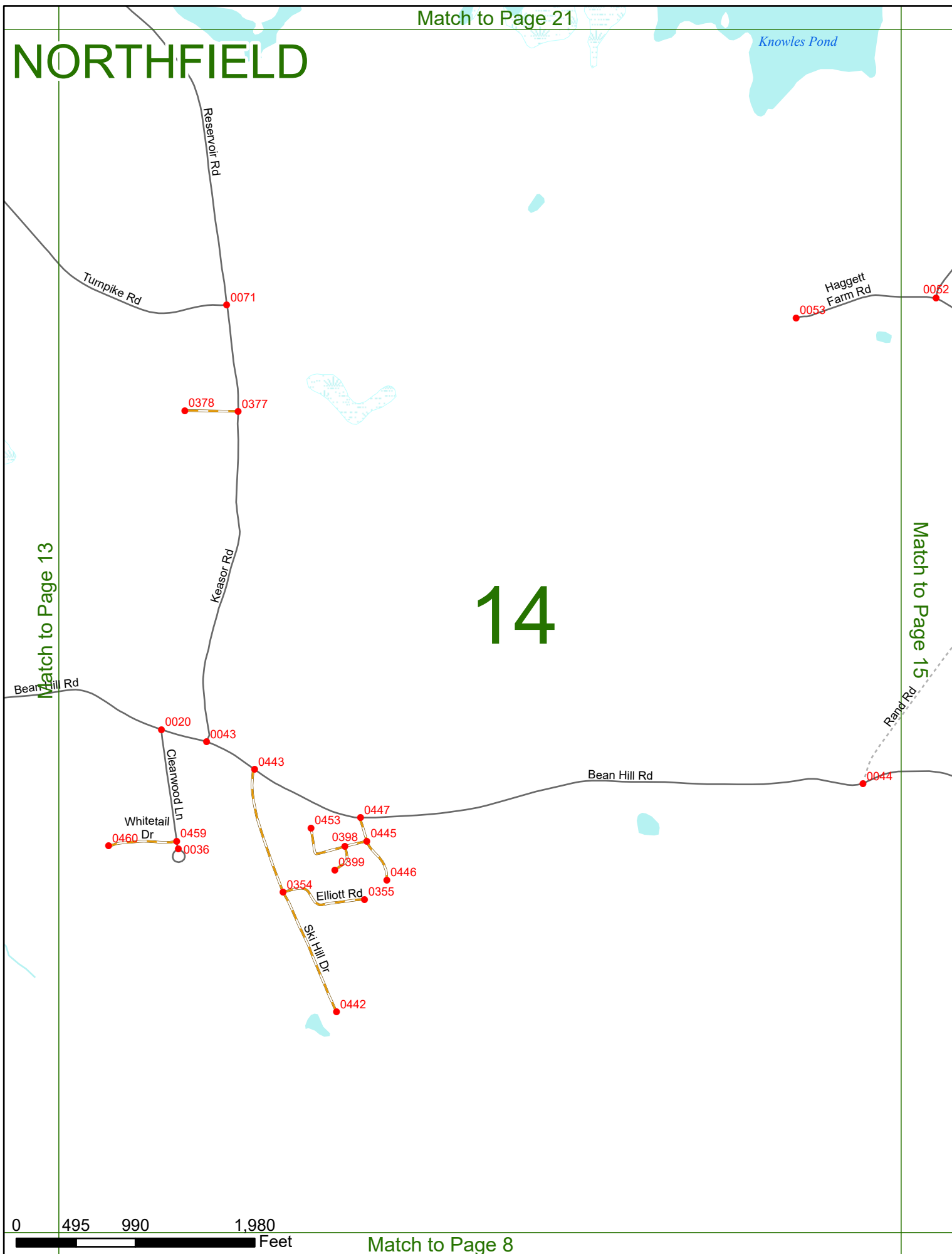

# NORTHFIELD

Match to Page 22

# 15

Match to Page 16

Match to Page 14

Match to Page 9

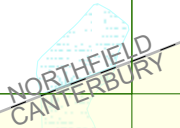
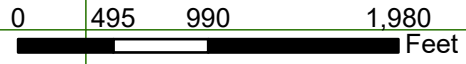
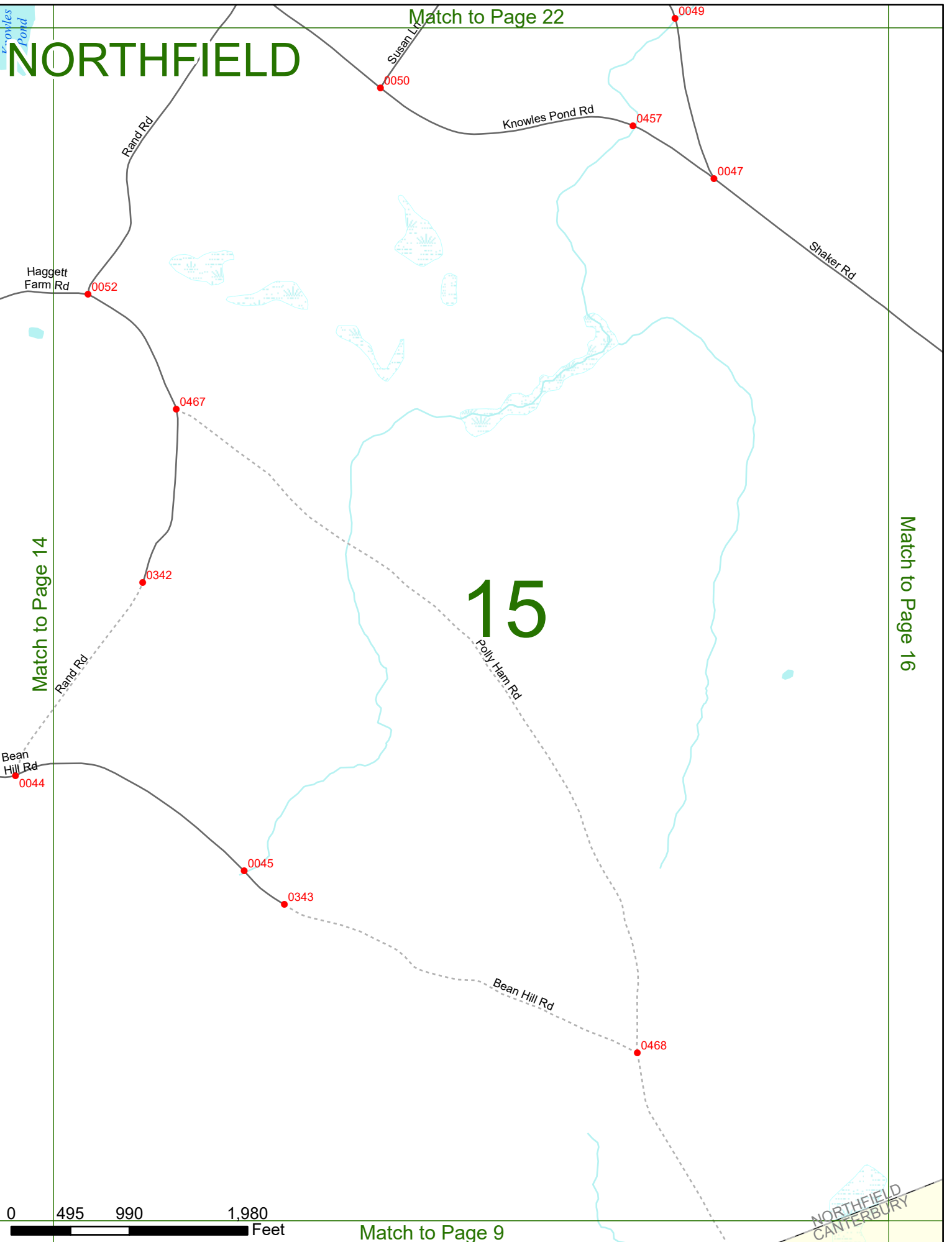

# NORTHFIELD

South Rd

BELMONT  
NORTHFIELD

Shaker Rd

0920

8162

Shady  
Ln

0470

0469

Shaker Rd

0155

0344

0046

0441

0419

Canterbury  
0438 Xing

0437

Match to Page 15

Match to Page 17

# 16

Payson Rd

Felows Hill Rd

0365

6105

Old Gilmenton Rd

0432

NORTHFIELD  
CANTERBURY

6104

Misery Rd

Shaker Rd

Blue Boar Ln

0430

0429

0431

0902

0421

Robin  
Shore Dr

0423

0422

Friar  
Tuck Rd

0424

Lyford  
Pond

New Pond  
Canterbury  
Shore Dr

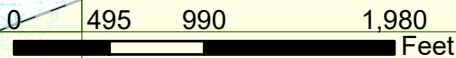

Match to Page 0

# NORTHFIELD

Stone Rd  
0008 106

Water

0005

South Rd

0003

Clough Pond

Watson Rd 0002

0001

BELMONT  
GILMANTON

Match to Page 0

# 17

6284

South Rd

Match to Page 16

BELMONT  
NORTHFIELD

NORTHFIELD  
CANTERBURY

BELMONT  
CANTERBURY

0016

0597

0258

8295

GILMANTON  
CANTERBURY

Blue Boat Ln

0440

0428

Old Gilmanton Rd

0869

0920

0984

Fire Lane 200

0868

Nottingham Rd

Snowshoe Hill Rd

0191

8801

Harmony Ln

New Pond

Rocky Pond

0902

0423

0422

990

1,980

0983

0427

0922

Match to Page 0

Feet

0970

Match to Page 0

# NORTHFIELD

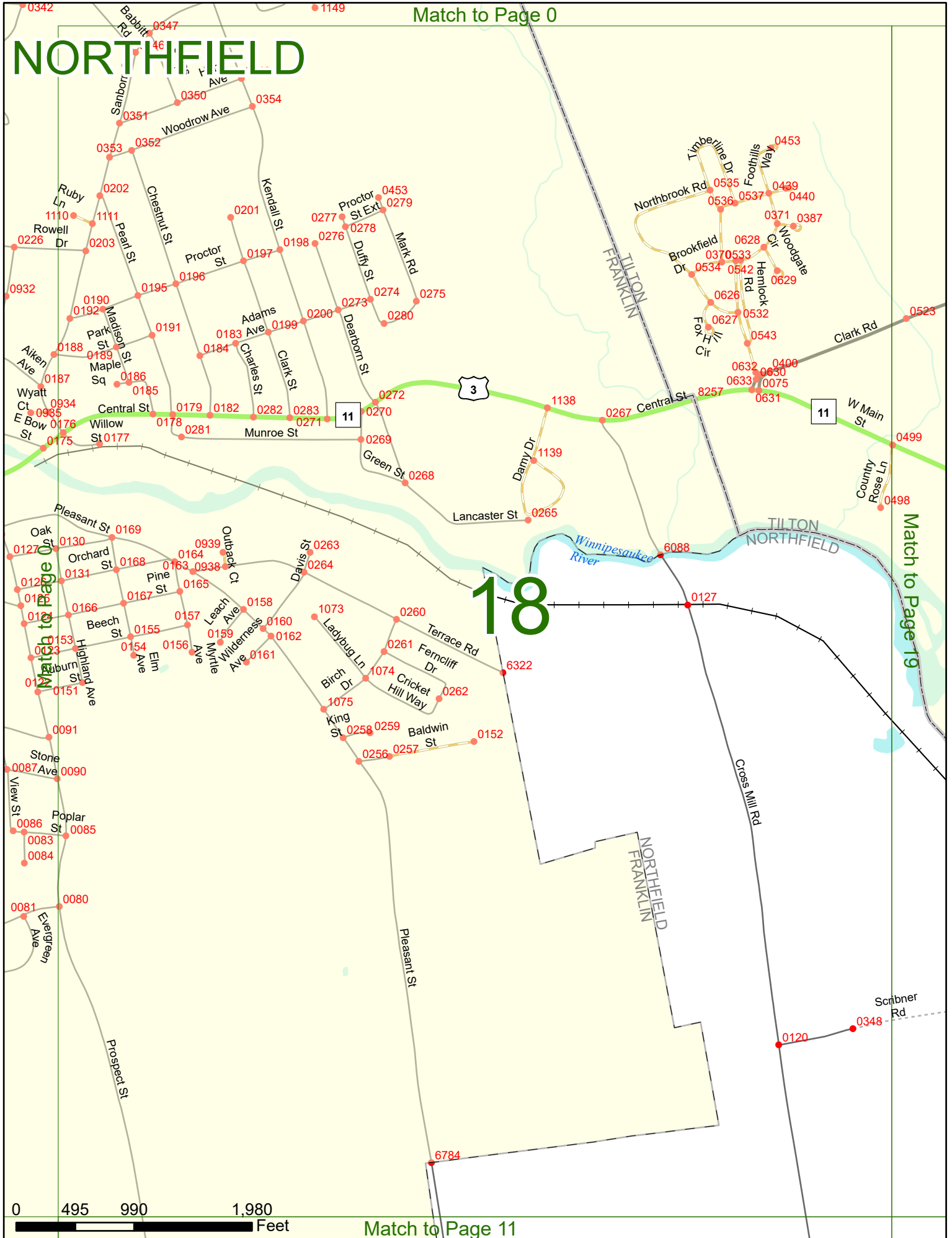

Match to Page 11

Match to Page 0

Match to Page 19

# 18

# NORTHFIELD

Match to Page 9

Match to Page 18

Match to Page 20

# 19

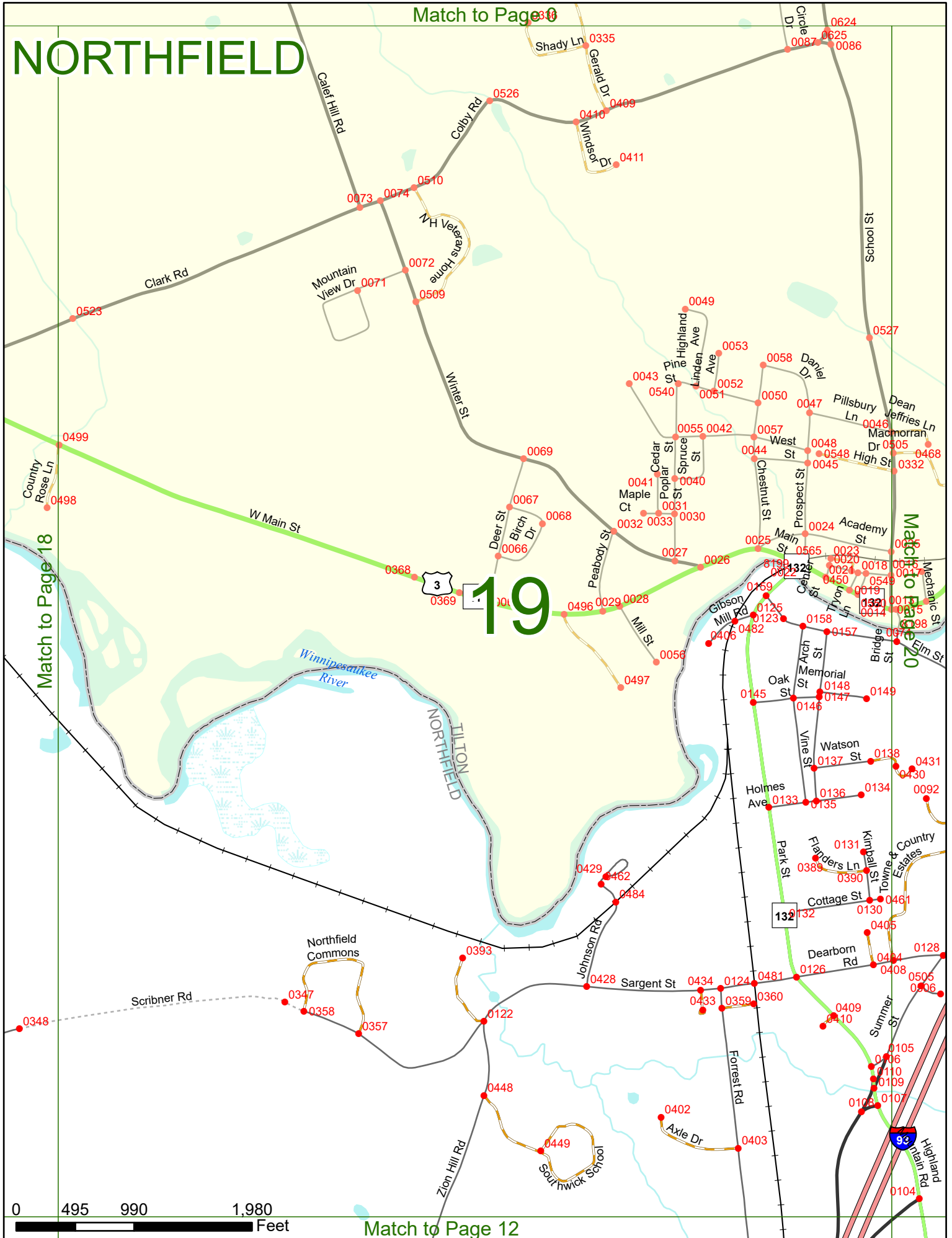

Match to Page 12



# NORTHFIELD

Match to Page 0

# 20

Match to Page 21

Match to Page 13

0 495 990 1,980 Feet

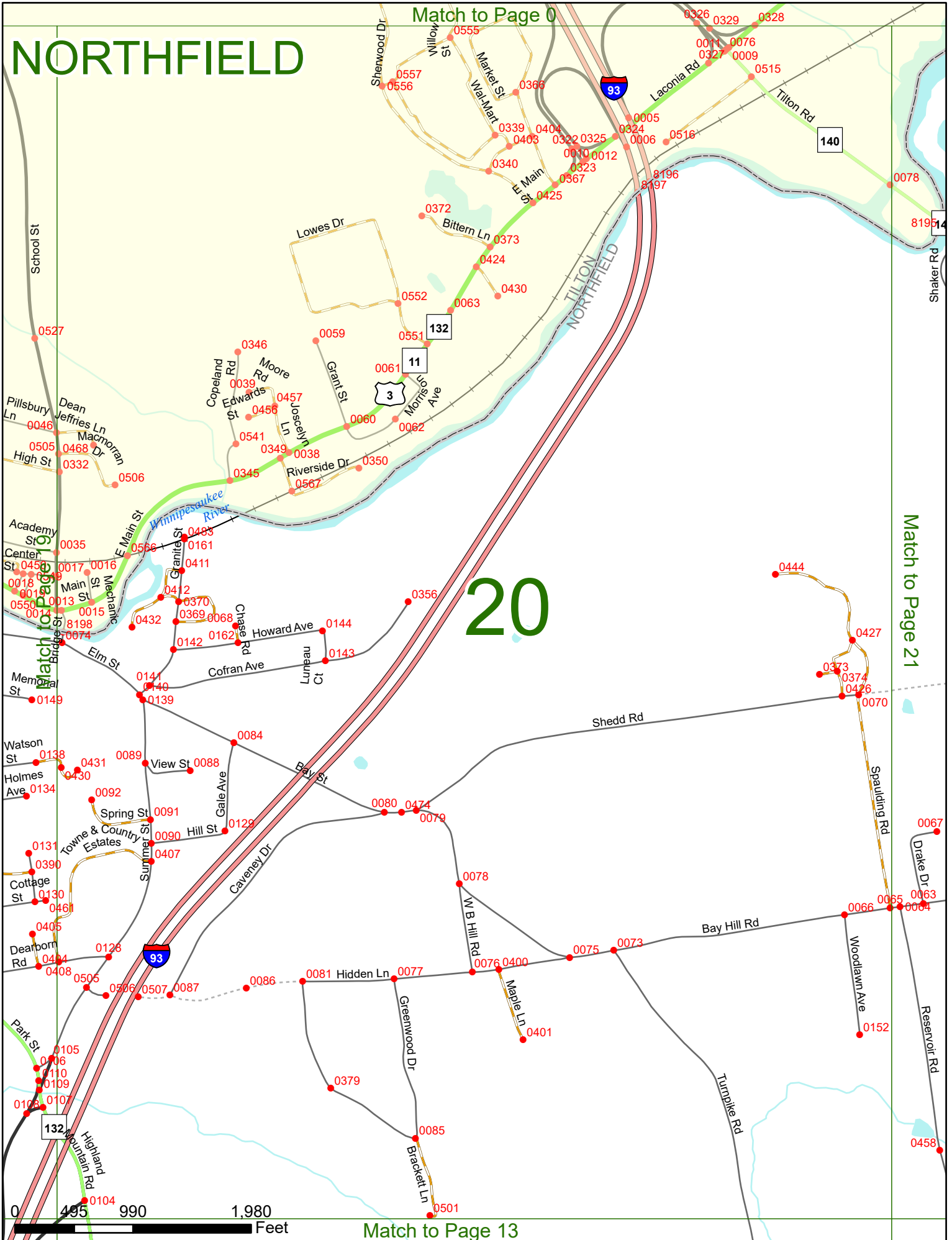



# NORTHFIELD

# 22

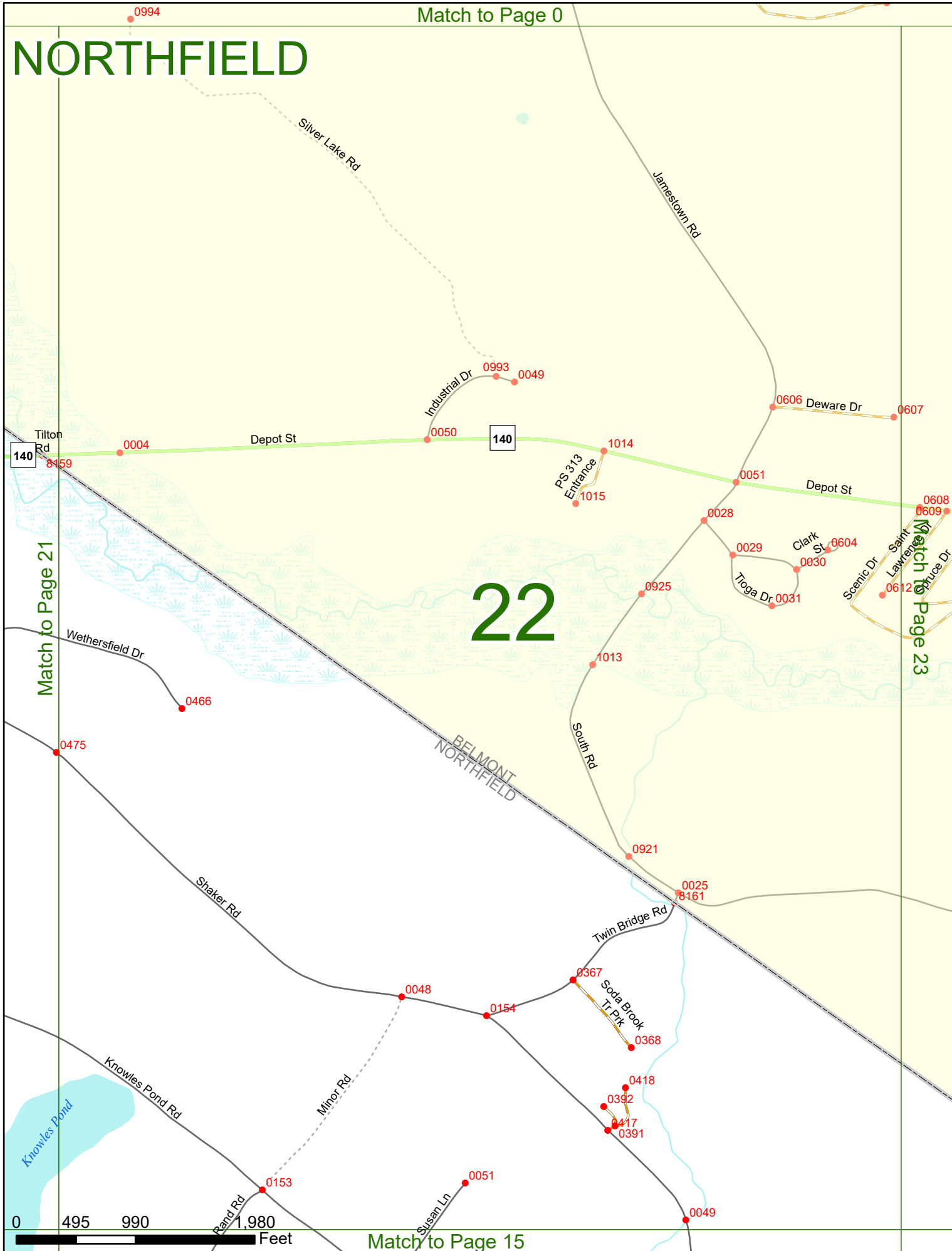

Match to Page 21

Match to Page 23



Match to Page 15

# NORTHFIELD

# 23

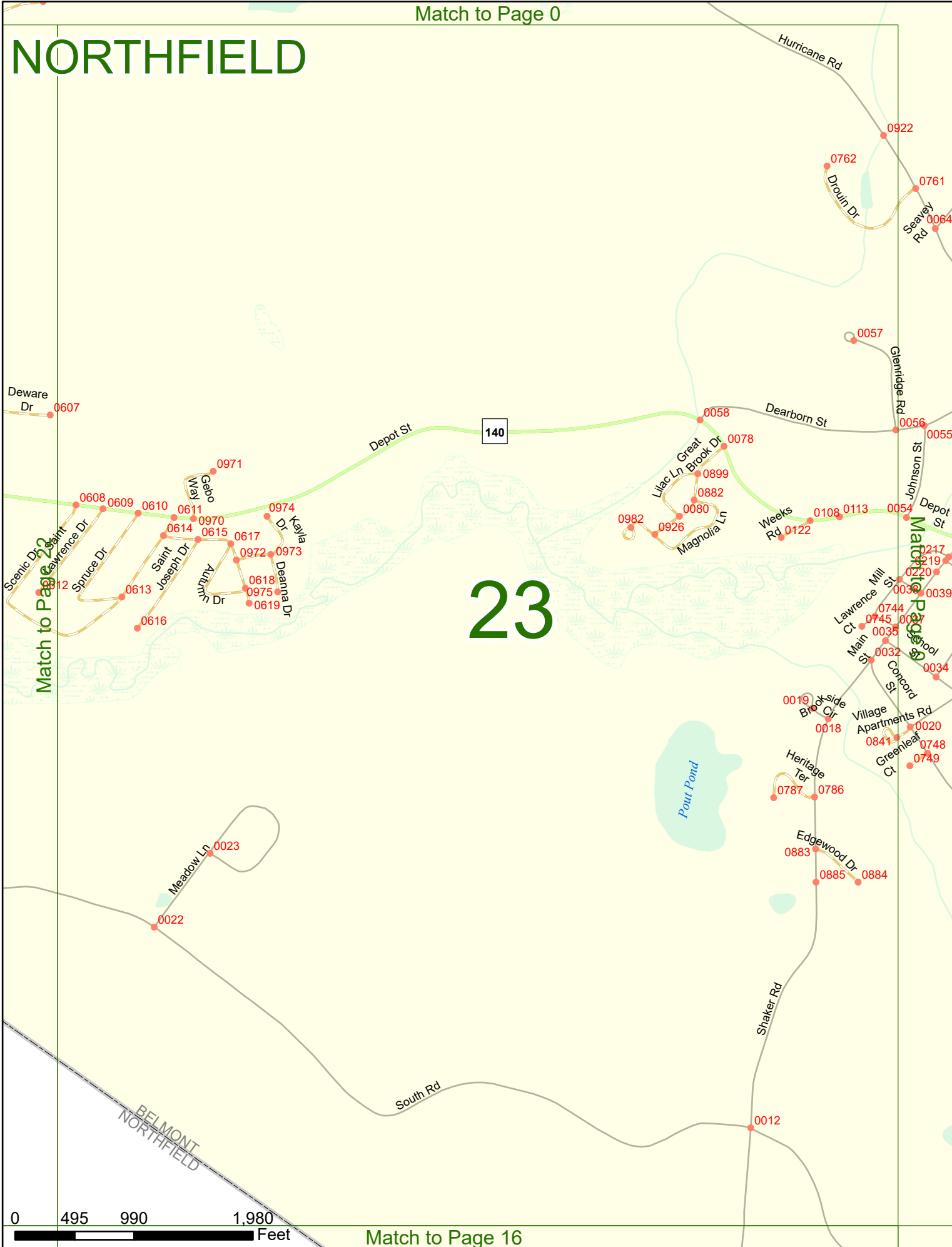

Match to Page 22

Match to Page 24

