



Maps and data sets are not guaranteed to be free from errors and omissions. Data is in a constant state of update and correction by various groups and agencies. Information displayed on this map is the best available at the time of publication.

# 2024 Nodal Reference Bookmap

## LEGEND

|  |                               |   |                                     |
|--|-------------------------------|---|-------------------------------------|
| <b>Divided Highway<br/>Limited Access</b>        | <b>Turnpike<br/>Toll Road</b> | <b>U.S. Route</b>                         | <b>N.H. Route</b>                   |
|  |                               |   |                                     |
| <b>State Roads<br/>(Carries NO Route Number)</b> | <b>Local Roads</b>            | <b>Class 6 Roads<br/>(Not Maintained)</b> | <b>Private Roads</b>                |
|  |                               |   |                                     |
|  | <b>State Line</b>             |   | <b>Lakes &amp; Ponds</b>            |
|  | <b>County Line</b>            |   | <b>State Parks</b>                  |
|  | <b>Town Line</b>              |   | <b>National &amp; State Forests</b> |
|  | <b>Rivers &amp; Streams</b>   |   | <b>Reference Nodes</b>              |

NHDOT will accept crash locations based on the State of NH Uniform Police Traffic Accident Report.

Crash occurred on:

**Option 1**     Street Address  
                   123 Main Street

**Option 2**     Route No and/or     Distance from             NESW             Intesecting Road, Bridge,  
                   Street name             Intersecting Street                                     Town/County line  
                   Main Street                     500                     E                     Oak Street

**Option 3**     First Node                     Distance from First Node                     Second Node  
                   515                                     212                                     632

**Option 4**     Route No and/or             Mile Marker on Interstate Only             NESW             Mile (Marker)  
                   Street name  
                   189S                                     700 feet                                     S                     36.8

**Option 3 – Example**

Street Name                     Loudon Road  
First Node                             803  
Distance from First Node             318 Ft  
Second Node                             813



# MONROE

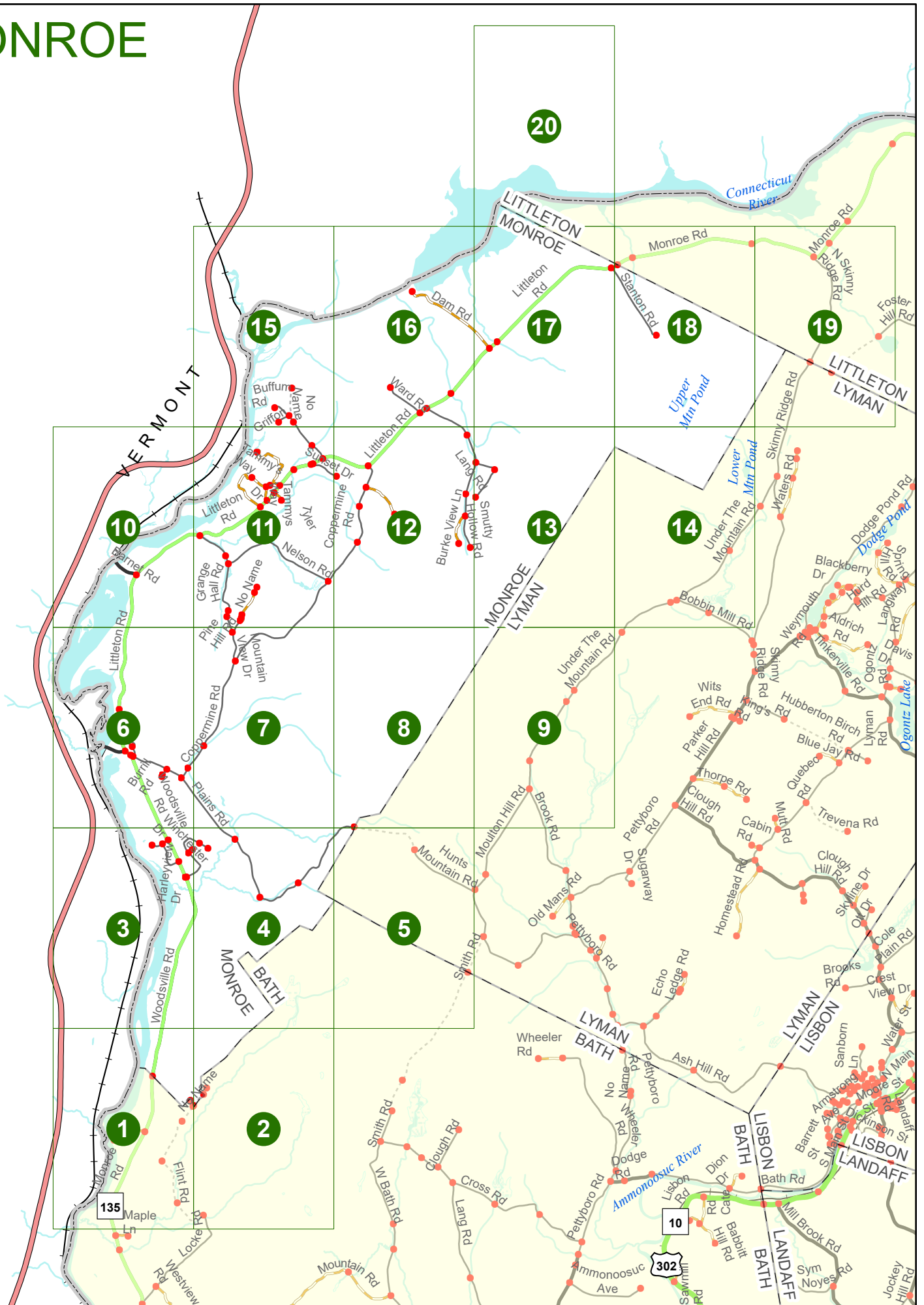

# MONROE

Match to Page 3

Match to Page 0

N 91

VERMONT

1

Dodge Falls Rd

0254

0248

135

Monroe Rd

Monroe Rd

6134

Woodsville Rd

MONROE BATH

0260

6135

0259

Match to Page 2

0262

0249

Flint Rd

0061

0 495 990 1,980 Feet

Match to Page 0

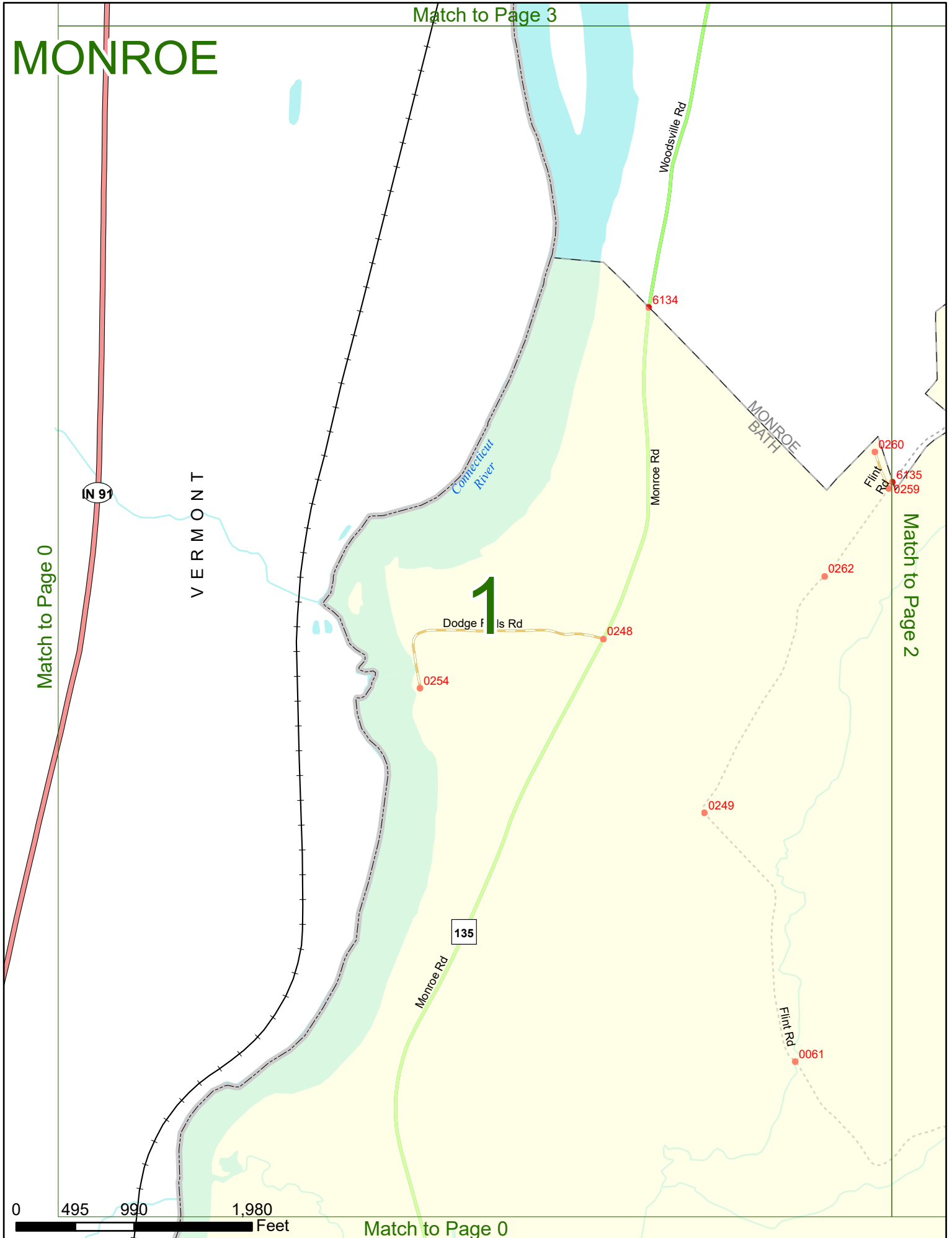

Match to Page 4

# MONROE

MONROE  
BATH

# 2

Match to Page 0

Match to Page 1

0260  
6135  
0259  
Flint Rd

0250  
6136

0060  
Flint Rd  
Locker Rd

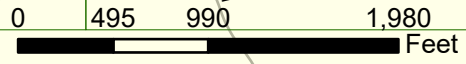

Match to Page 0

# MONROE

Match to Page 6

Match to Page 0

N 91

VERMONT

# 3

Match to Page 4

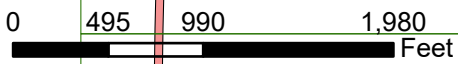
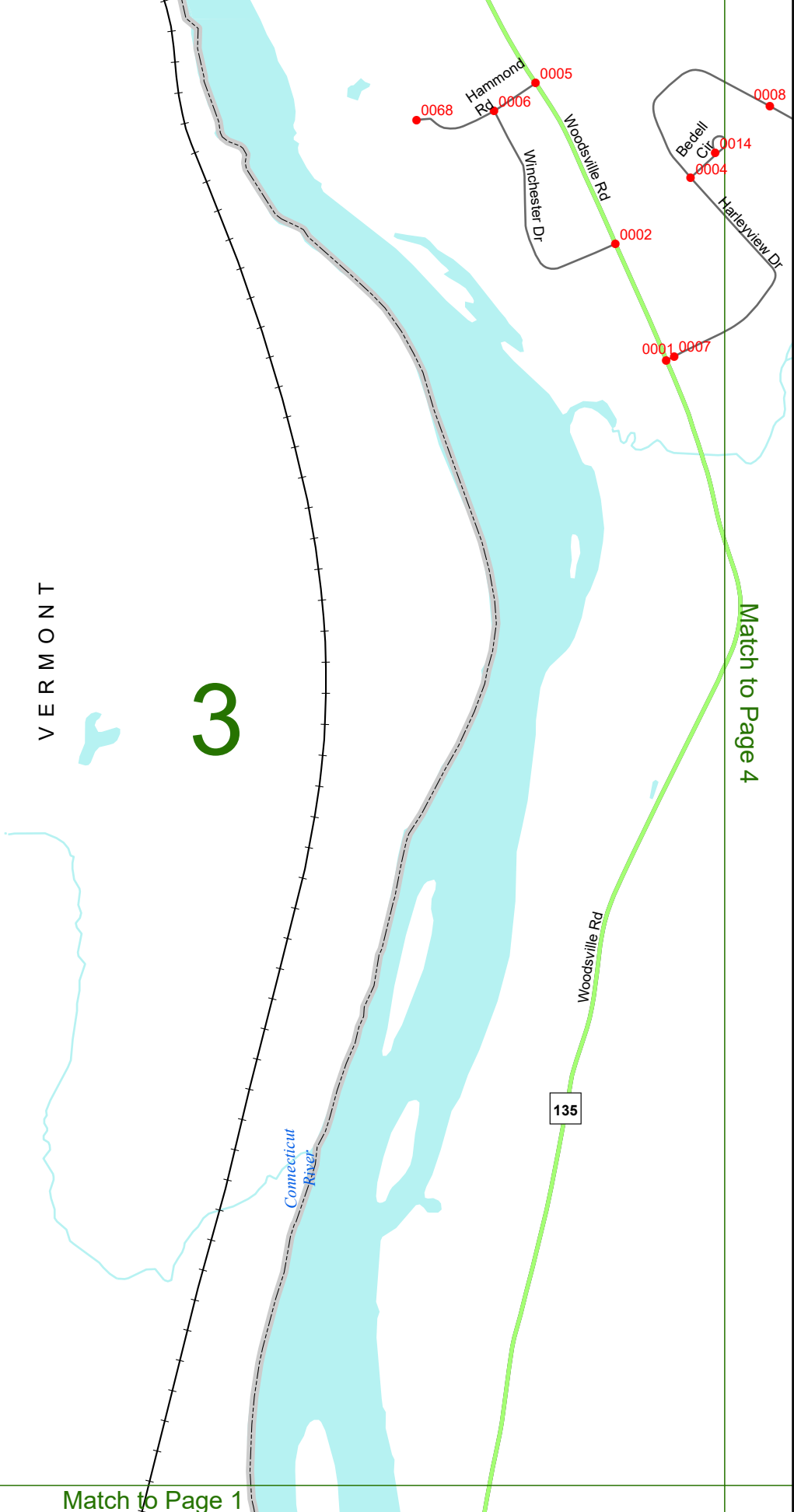

Match to Page 1

Match to Page 7

# MONROE

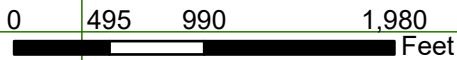
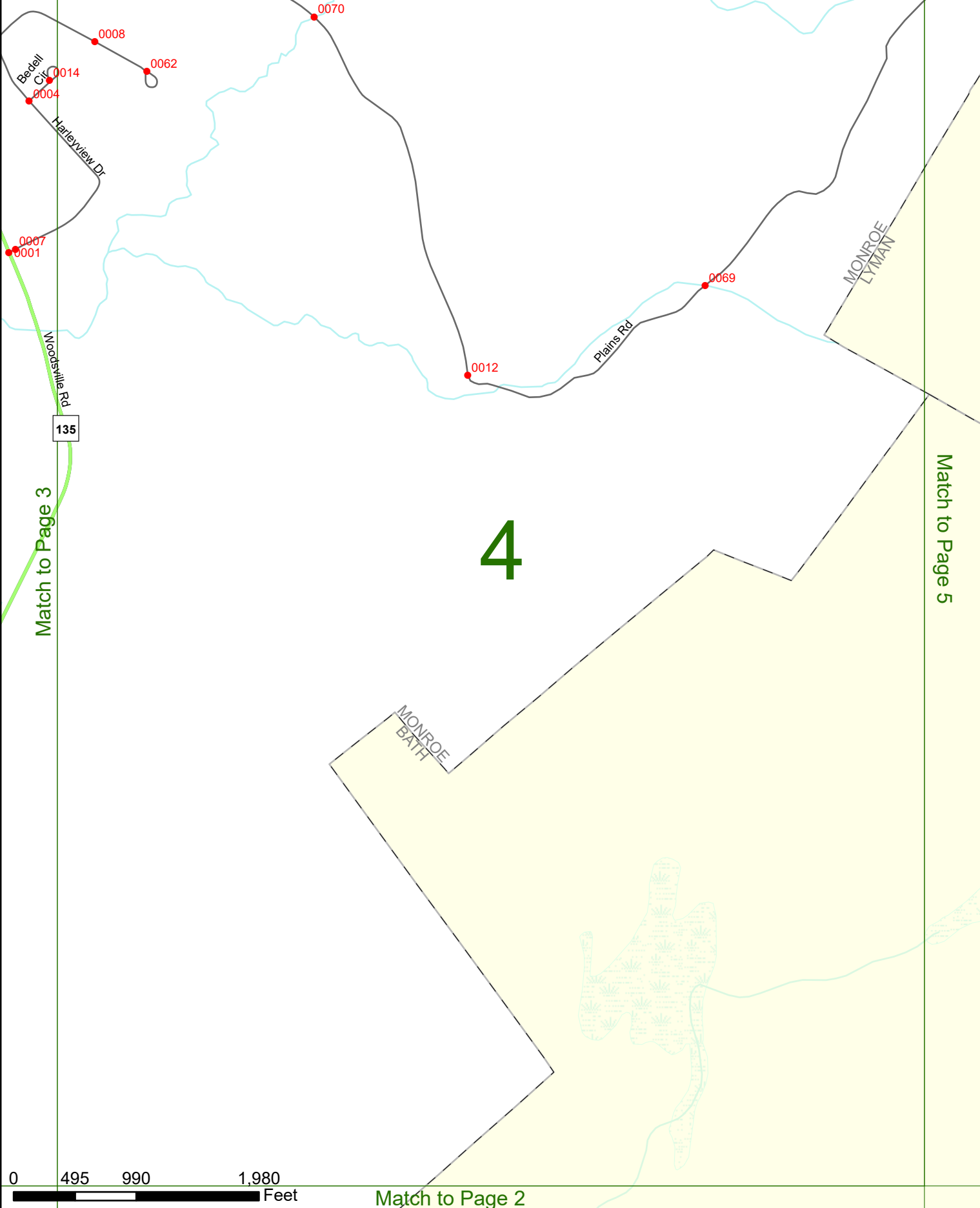

Match to Page 2

Match to Page 5

# MONROE

Match to Page 8

Match to Page 4

Match to Page 0

# 5

MONROE  
LYMAN

Hunts Mountain Rd

Moulton Hill Rd

LYMAN  
BATH

Smith Rd

6015

0297

0012

6014

0 495 990 1,980 Feet

Match to Page 0



Match to Page 10

# MONROE

Match to Page 0

Match to Page 7

## 6

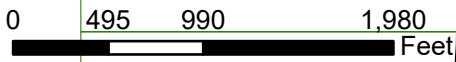
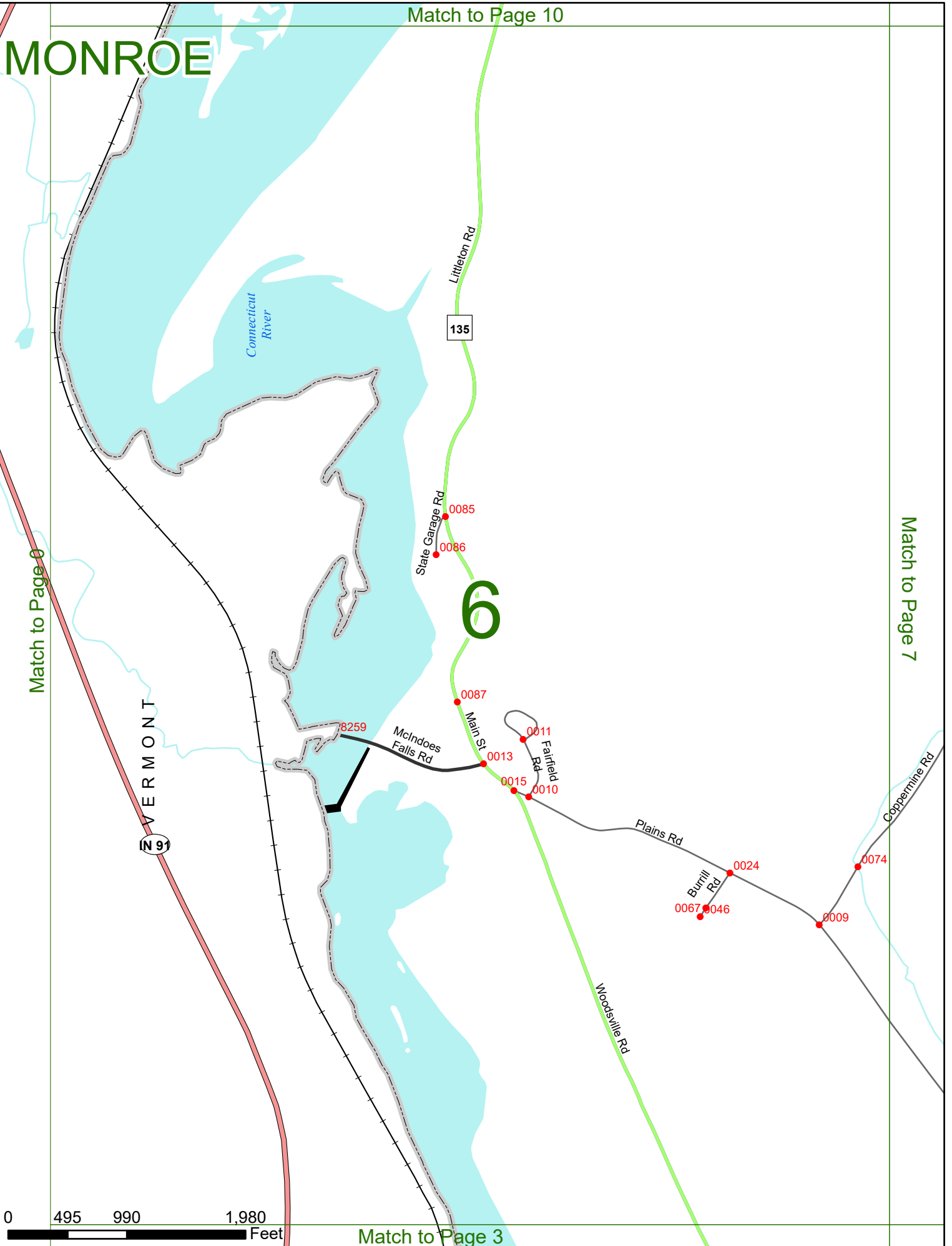

Match to Page 3

# MONROE

Match to Page 11

0018

Pine Hill Rd  
Mountain View Dr

0017

Coppermine Rd

# 7

0075

0074

Plains Rd

0 495 990 1,980 Feet

Match to Page 4

Match to Page 8

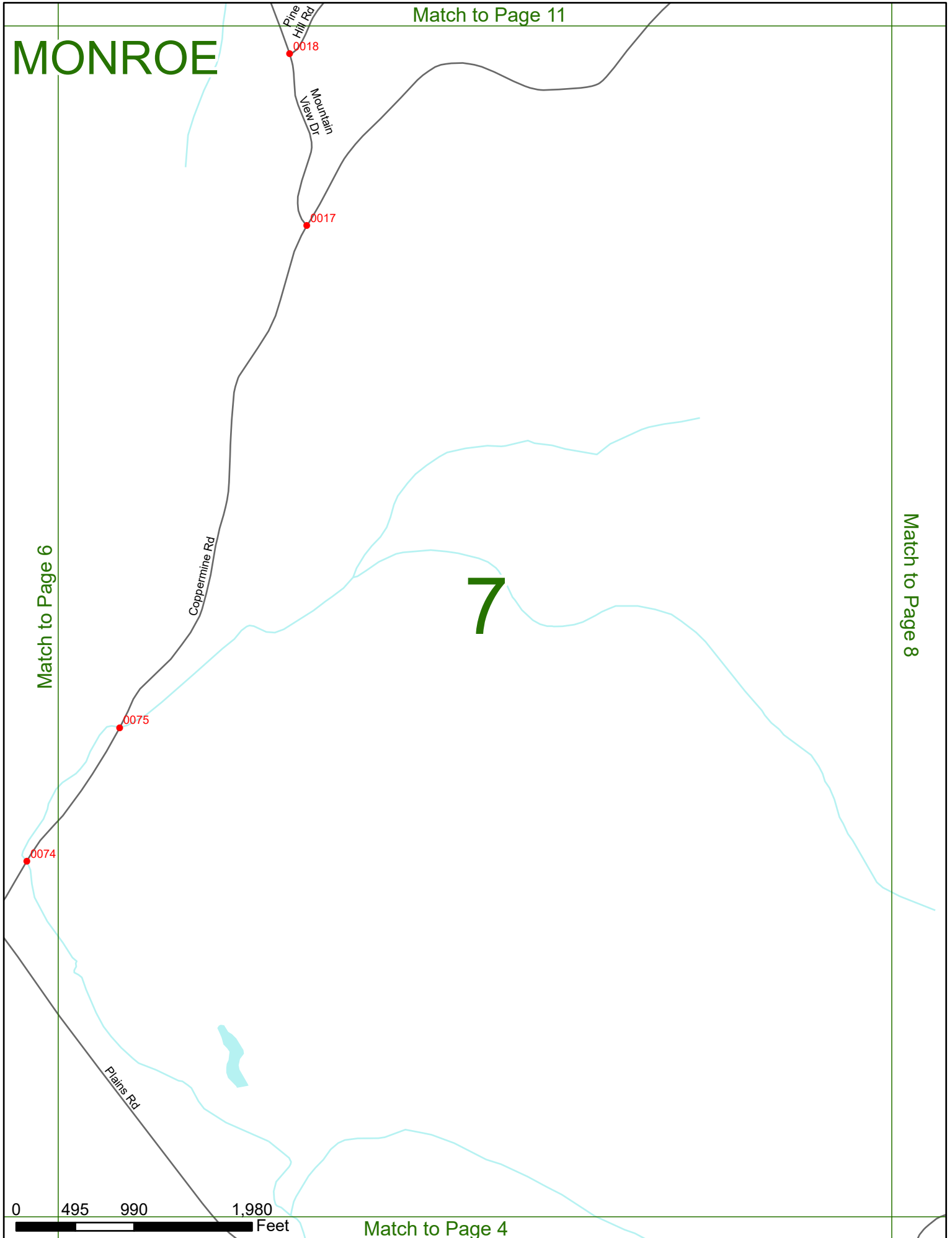

# MONROE

8

MONROE  
LYMAN

Match to Page 7

Match to Page 9



Match to Page 5

# MONROE

MONROE  
LYMAN

Match to Page 8

Match to Page 0

# 9

Under The Mountain Rd

Moulton Hill Rd

Brook Rd

0015

0014

0292

0122

0040

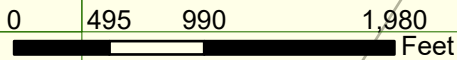

Match to Page 0

# MONROE

Match to Page 0

Match to Page 11

# 10

VERMONT

N 91

8258

Barnet Rd

0028

135

Littleton Rd

0027

Connecticut River



Match to Page 6

# MONROE

Match to Page 15

VERMONT  
9

Connecticut River

Buffum Rd 0032

Littleton Rd 0031

Sunset Dr 0083

Tyler Dr 0095

Tammy's Way 0064

Beth's Way 0065

Tammys Way 0025

Judy's Ln 0045

135

Littleton Rd

# 11

Nelson Rd

Grange Hall Rd 0073

0022

0029

0060

0021

0019

0020

0081

0066

Pine Hill Rd  
Mountain View Dr

Coppermine Rd

0023

Match to Page 10

Match to Page 12

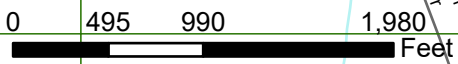

Match to Page 7

Match to Page 16

# MONROE

Littleton Rd

135

0041

Sunset Dr 0083

0091

Ridge Line Dr

0092

0076

Match to Page 11

# 12

0051

Smuffy Hollow Rd

0050

Lang Rd

Match to Page 13

0072

Burke View Ln

0093

0049

Coppermine Rd

0077

Nelson Rd 0023

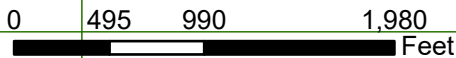

Match to Page 8

# MONROE

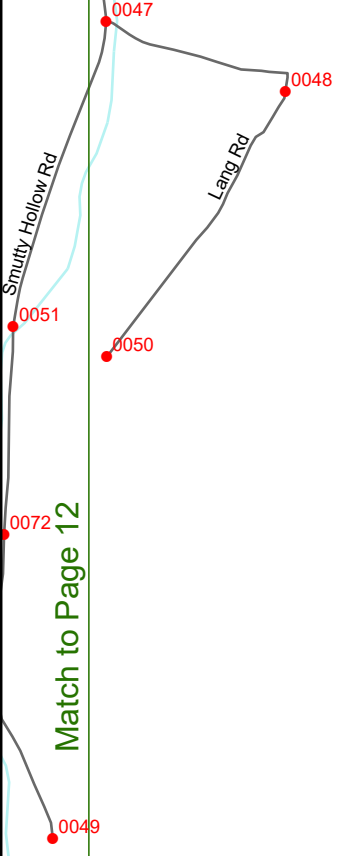

# 13

MONROE  
LYMAN

Match to Page 12

Match to Page 14



Match to Page 9



# MONROE

MONROE  
LYMAN

Lower  
Min Pond

# 14

Under The Mountain Rd

Bobbin Mill Rd

Skippy Ridge Rd

Match to Page 13

Match to Page 0

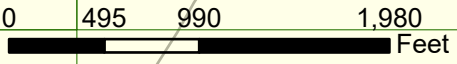

Match to Page 0

0071

0295

0041 0042

0043

Match to Page 0

# MONROE

VERMONT

N 91

# 15

Connecticut River

Match to Page 0

Match to Page 16

0 495 990 1,980 Feet

Match to Page 11

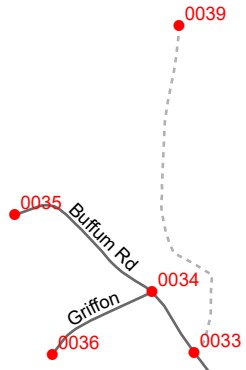

# MONROE

VERMONT

Connecticut River

# 16

Match to Page 15

Match to Page 17

0055

0044

0053

0043

0042

Ward Rd

Littleton Rd

135

Smuty Hollow Rd

Dam Rd



Match to Page 12

# MONROE

VERMONT

Connecticut River

Match to Page 20

LITTLETON  
MONROE

Monroe Rd

6137

0057

Stanton Rd

Littleton Rd

135

# 17

Match to Page 16

Dam Rd

0080

0054

Littleton Rd

Match to Page 18

0 495 990 1,980 Feet

Match to Page 13

# MONROE

135

Monroe Rd

0240

0241

6137

Littleton Rd

Match to Page 17

Match to Page 19

# 18

Stanton Rd

LITTLETON  
MONROE

0056

Upper  
Mtn Pond

MONROE  
LYMAN

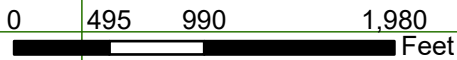

Match to Page 0

# MONROE

Connecticut River

0240

Monroe Rd

0454

135

0239

# 19

Match to Page 18

Match to Page 0

LITTLETON  
MONROE

N Skinny Ridge Rd

0302

Foster Hill Rd

6016

6736

LITTLETON  
LYMAN

MONROE  
LYMAN

Skinny Ridge Rd

0 495 990 1,980 Feet

Match to Page 0

# MONROE

Match to Page 0

VERMONT  
**20**

Match to Page 0

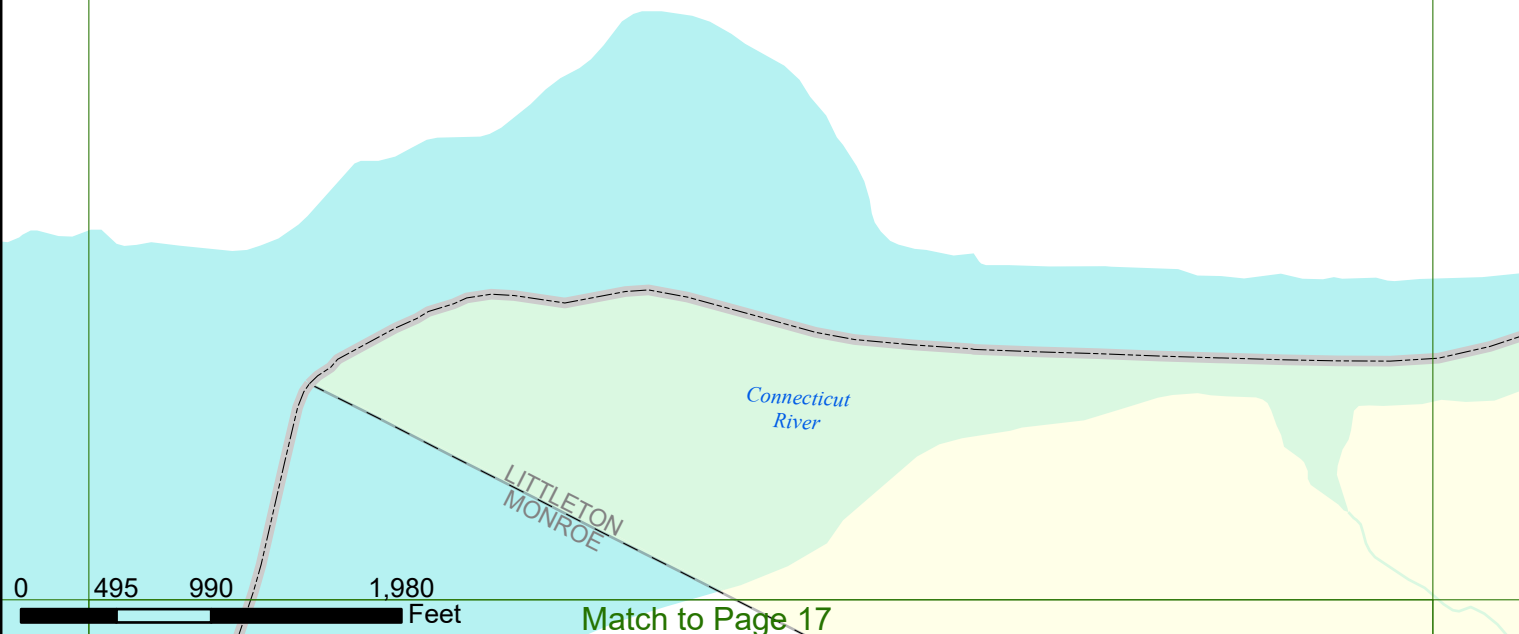

0 495 990 1,980 Feet

Match to Page 17