

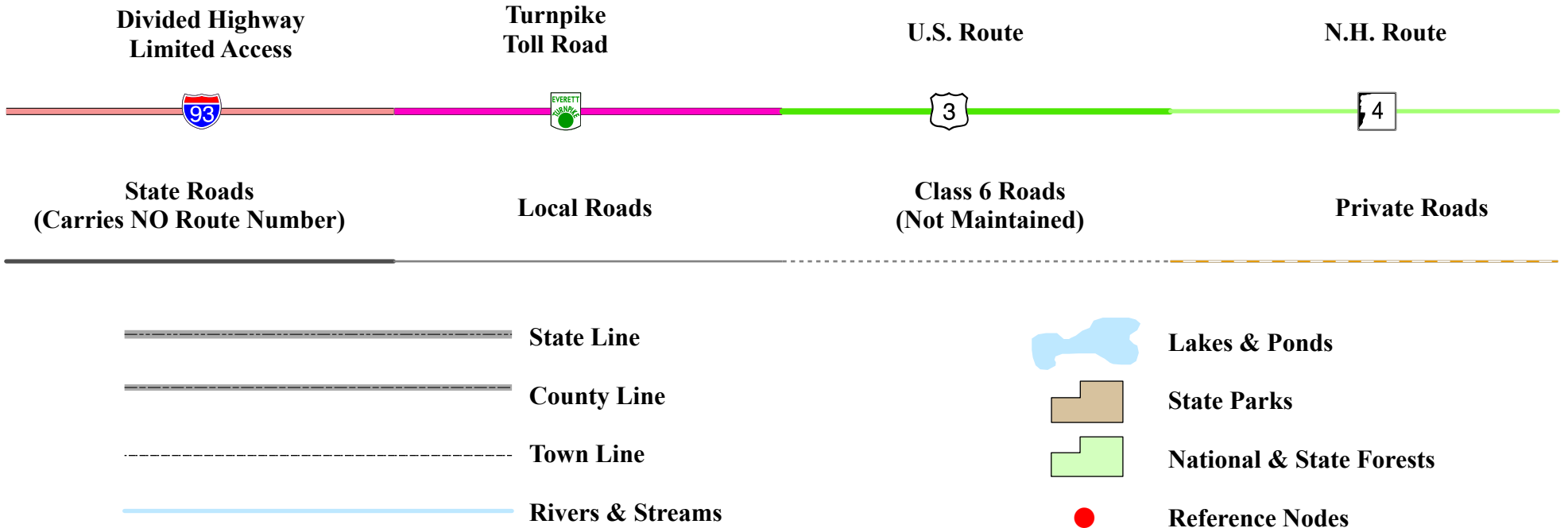

Maps and data sets are not guaranteed to be free from errors and omissions. Data is in a constant state of update and correction by various groups and agencies. Information displayed on this map is the best available at the time of publication.

# 2024 Nodal Reference Bookmap

## LEGEND



NHDOT will accept crash locations based on the State of NH Uniform Police Traffic Accident Report.

Crash occurred on:

**Option 1**     Street Address  
                   123 Main Street

**Option 2**     Route No and/or     Distance from             NESW             Intesecting Road, Bridge,  
                   Street name             Intersecting Street                                     Town/County line  
                   Main Street                     500                     E                     Oak Street

**Option 3**     First Node                     Distance from First Node                     Second Node  
                   515                                     212                                     632

**Option 4**     Route No and/or             Mile Marker on Interstate Only     NESW             Mile (Marker)  
                   Street name  
                   189S                                     700 feet                     S                     36.8

**Option 3 – Example**

Street Name                     Loudon Road  
First Node                             803  
Distance from First Node             318 Ft  
Second Node                             813



# CHANDLERS PURCHASE

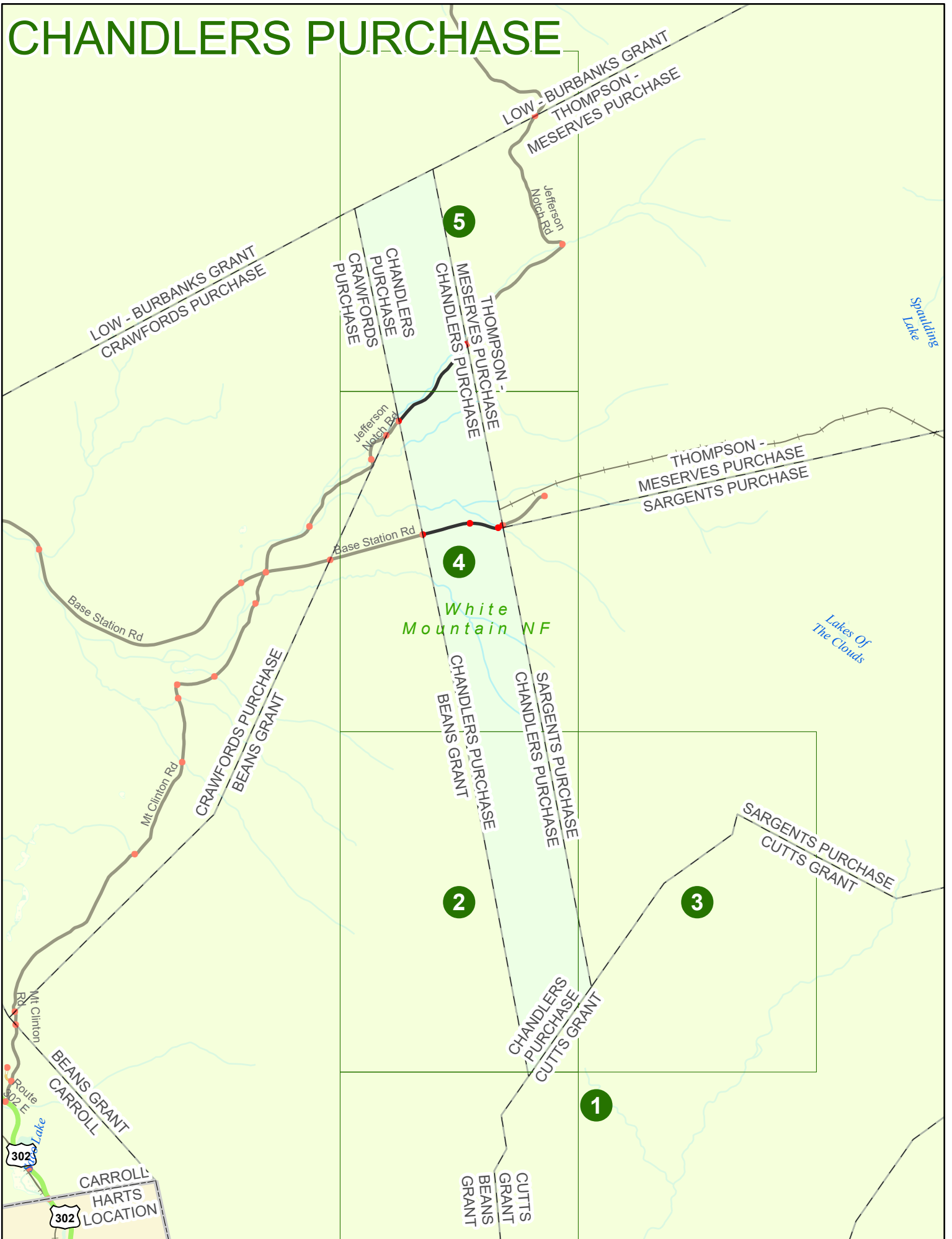

Match to Page 2

# CHANDLERS PURCHASE

Match to Page 0

Match to Page 0

**1**  
*White Mountain NF*

BEANS GRANT  
CUTTS GRANT

0 495 990 1,980 Feet

Match to Page 0

Match to Page 4

# CHANDLERS PURCHASE

Match to Page 0

Match to Page 3

Where  
Mountain 2 NF

CHANDLERS PURCHASE  
BEANS GRANT

SARGENTS PURCHASE  
CHANDLERS PURCHASE

CHANDLERS PURCHASE  
CUTTS GRANT

0 495 990 1,980 Feet

Match to Page 1

# CHANDLERS PURCHASE

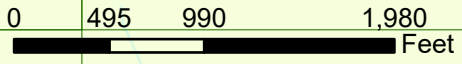
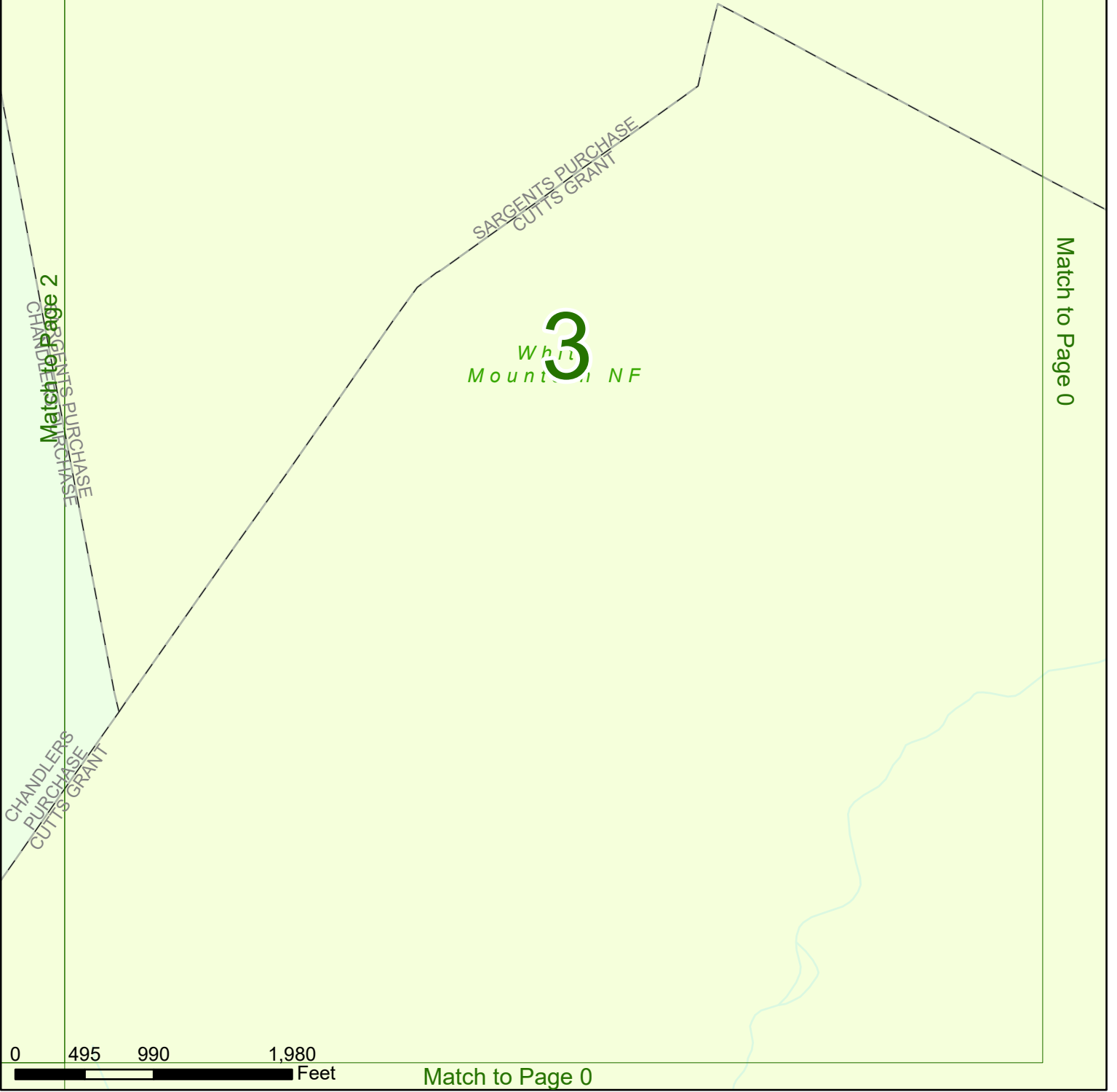

# CHANDLERS PURCHASE

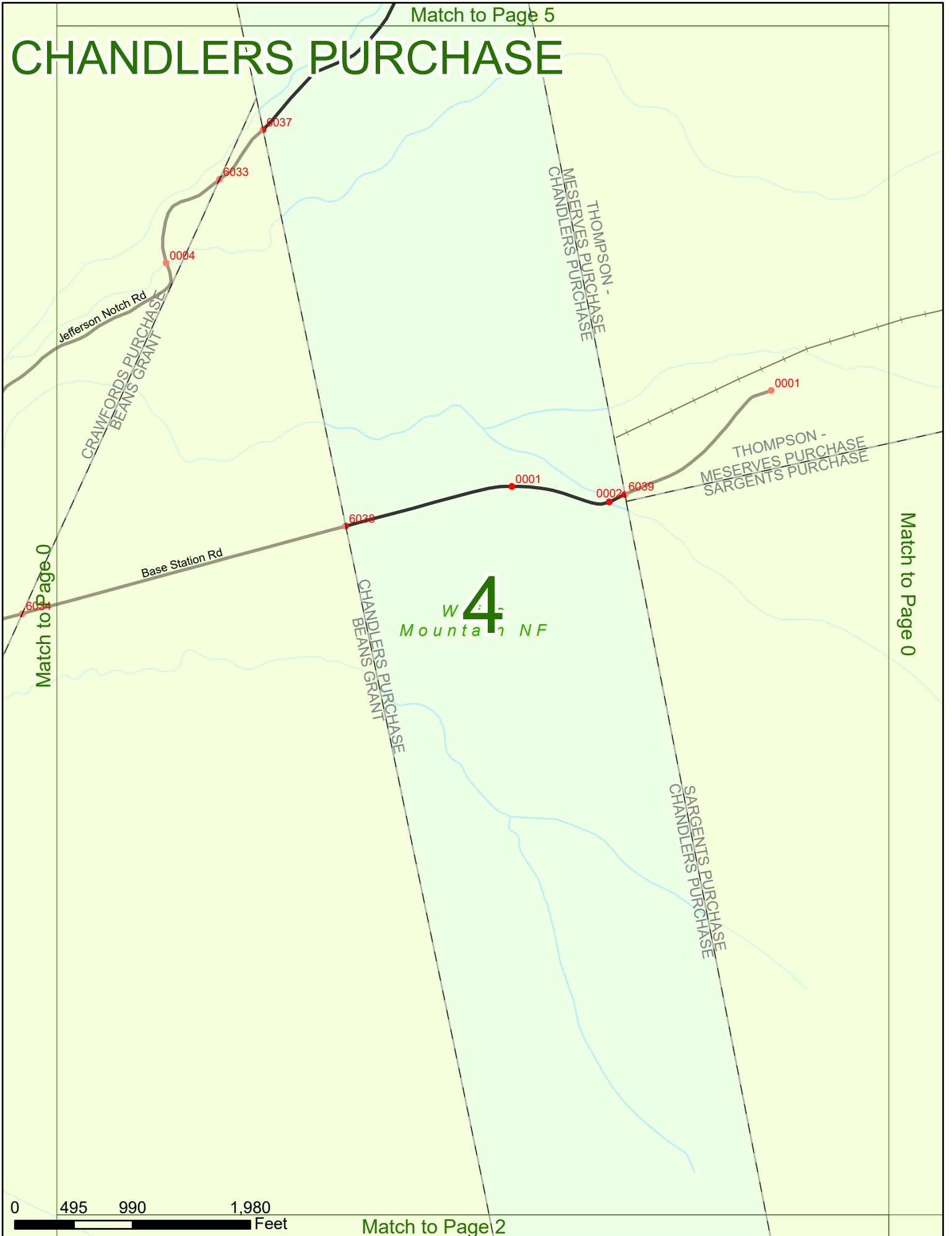

Match to Page 0

Match to Page 0

W4  
Mountain NF

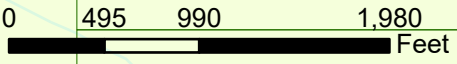

Match to Page 2

Match to Page 0

# CHANDLERS PURCHASE

Notch Rd

LOW - BURBANKS GRANT  
THOMPSON -  
MESERVES PURCHASE

6043

Match to Page 0

LOW - BURBANKS GRANT  
CHANDLERS PURCHASE

5  
Writ  
Mountains NF

Match to Page 0

0002

CHANDLERS PURCHASE  
CRAWFORDS PURCHASE

THOMPSON -  
MESERVES PURCHASE  
CHANDLERS PURCHASE

Jefferson Notch Rd

6040

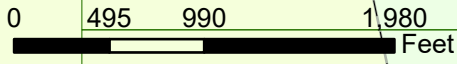

Match to Page 4