



Maps and data sets are not guaranteed to be free from errors and omissions. Data is in a constant state of update and correction by various groups and agencies. Information displayed on this map is the best available at the time of publication.

2023 Nodal Reference Bookmap

LEGEND



NHDOT will accept crash locations based on the State of NH Uniform Police Traffic Accident Report.

Crash occurred on:

Option 1 Street Address
 123 Main Street

Option 2 Route No and/or Distance from NESW Intesecting Road, Bridge,
 Street name Intersecting Street Town/County line
 Main Street 500 E Oak Street

Option 3 First Node Distance from First Node Second Node
 515 212 632

Option 4 Route No and/or Mile Marker on Interstate Only NESW Mile (Marker)
 Street name
 189S 700 feet S 36.8

Option 3 – Example

Street Name Loudon Road
First Node 803
Distance from First Node 318 Ft
Second Node 813



ORFORD

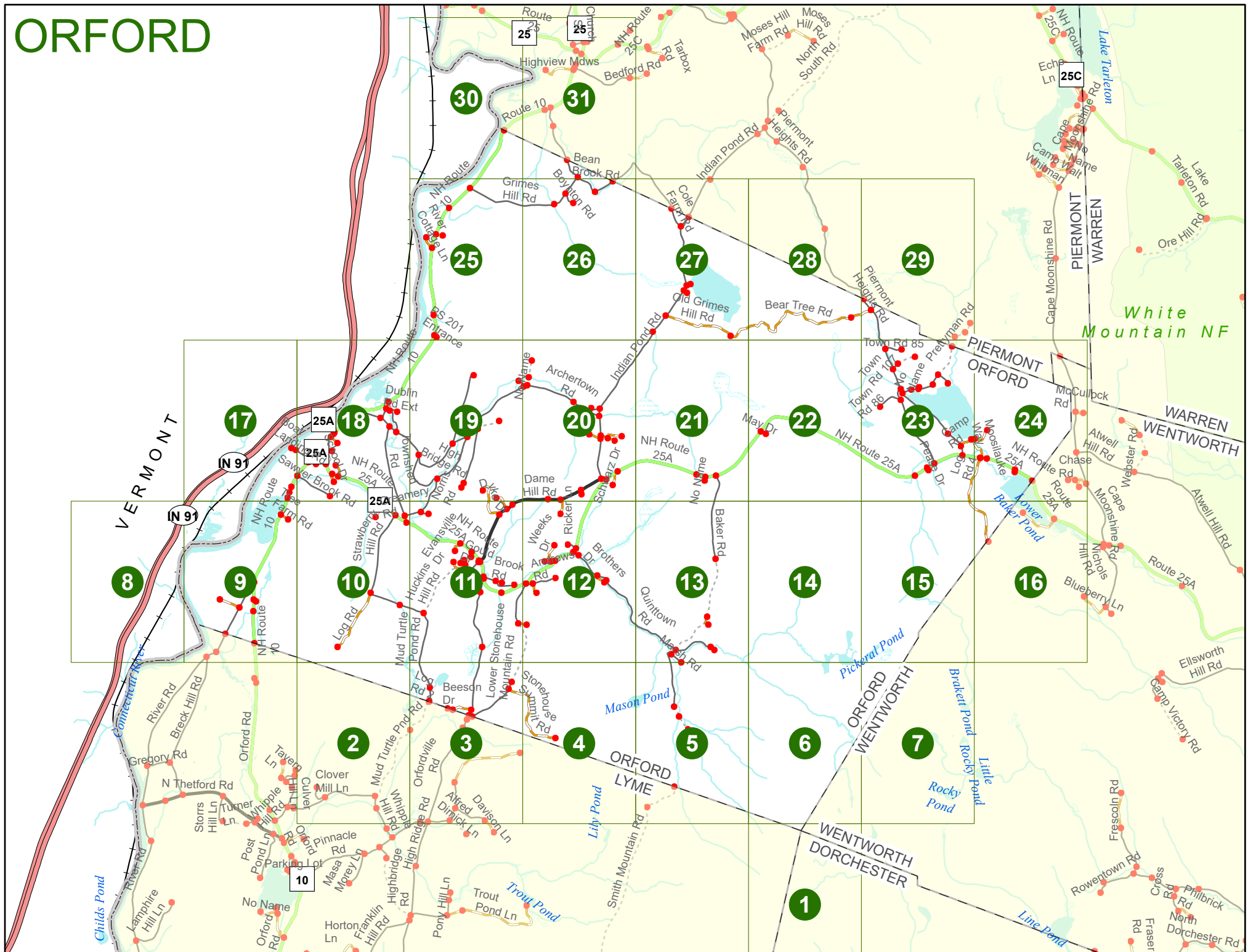

ORFORD

Match to Page 6

ORFORD
LYME

WENTWORTH
DORCHESTER

LYME
DORCHESTER

1

Match to Page 0

Match to Page 0

0 495 990 1,980 Feet

Match to Page 0

ORFORD

ORFORD
LYME

2

Match to Page 0

Match to Page 3

0130
0353
Culver Hill Ln

0352

0116
Clover Mill Ln

0115

Whipple Hill Rd

0126

Mud Turtle Pkwy Rd

0367

0369

0 495 990 1,980 Feet

Match to Page 0

Pinnacle Rd

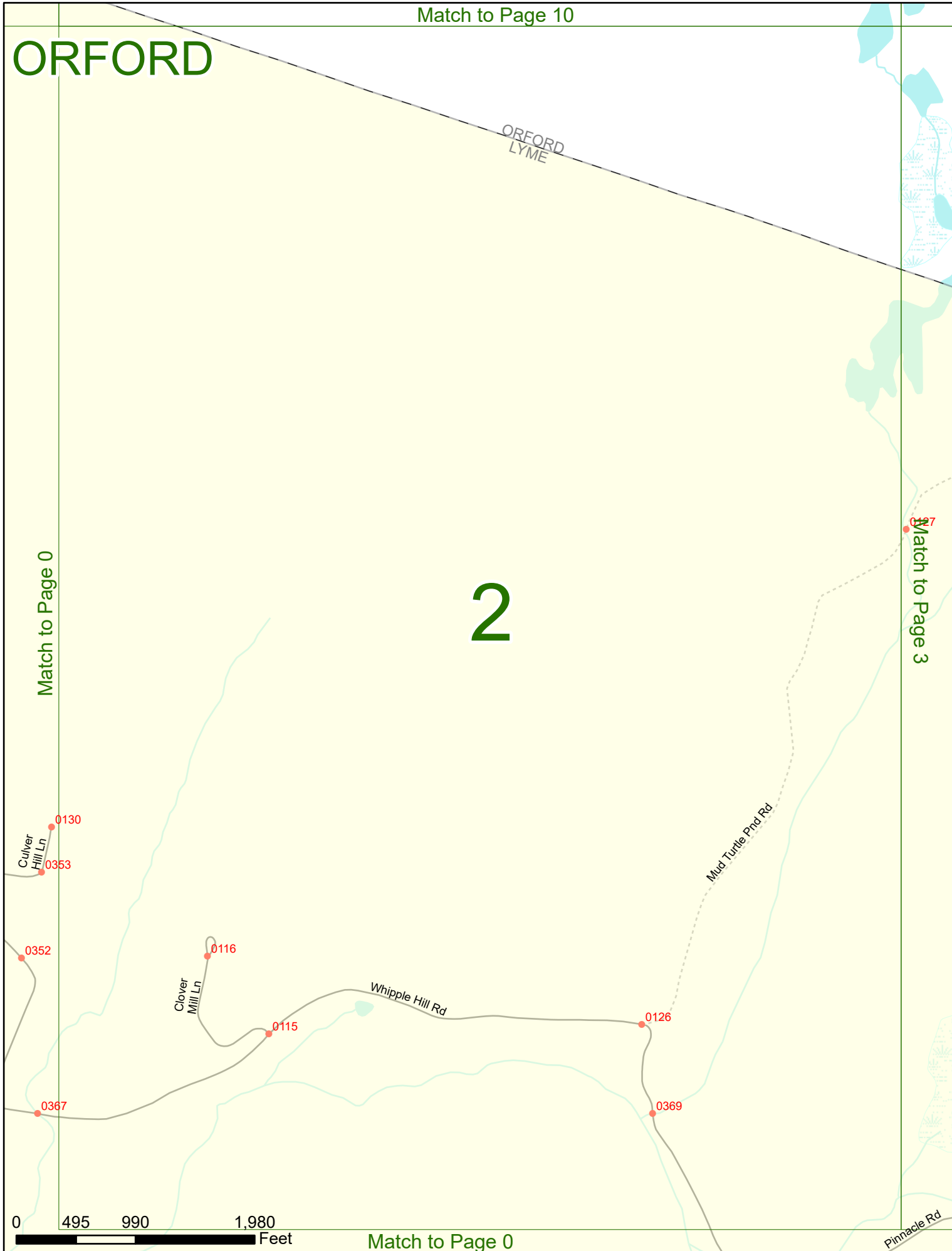

ORFORD

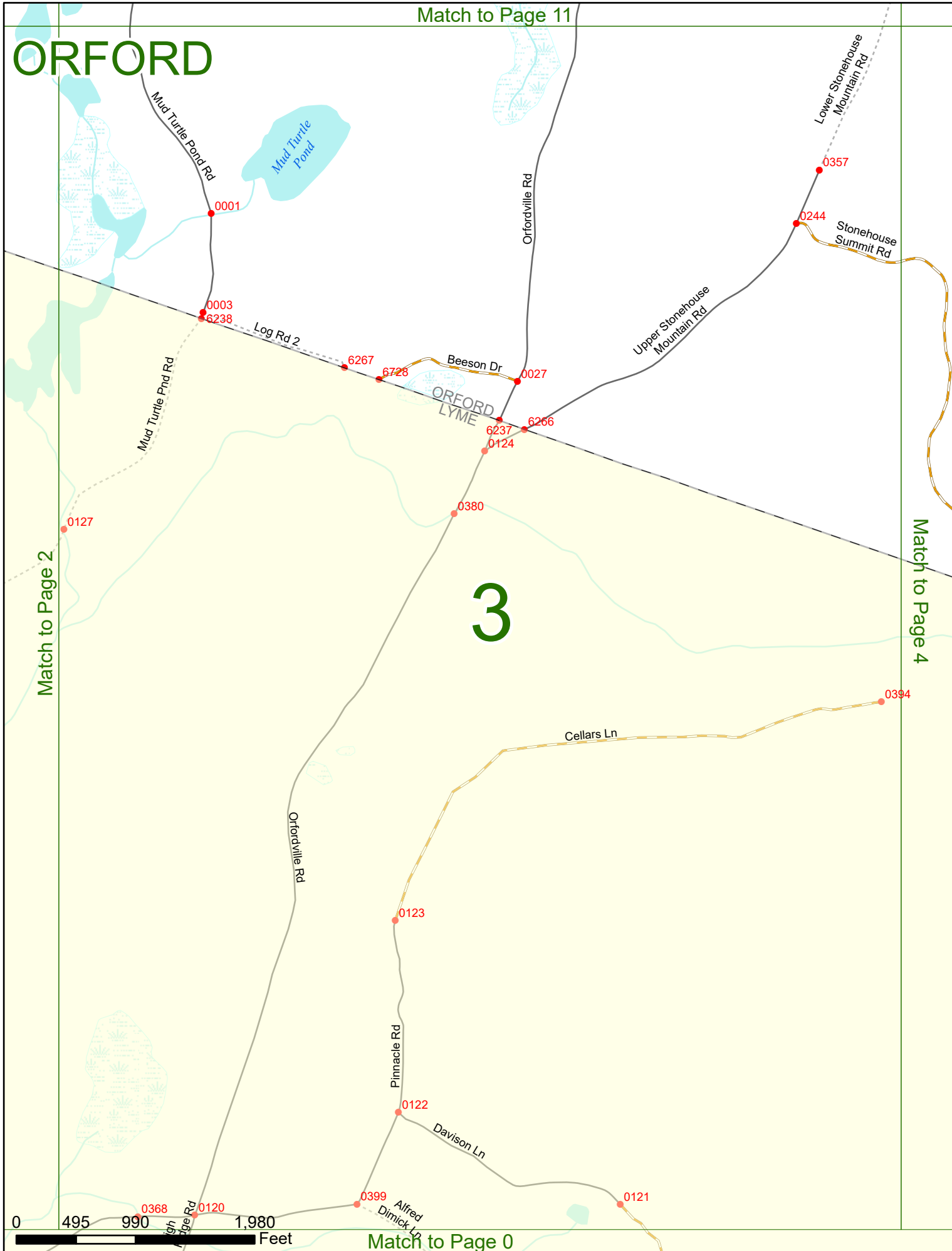

Match to Page 2

Match to Page 4

3

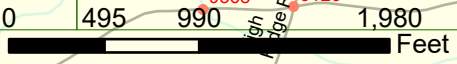

ORFORD

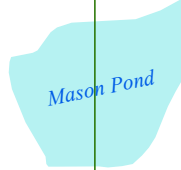
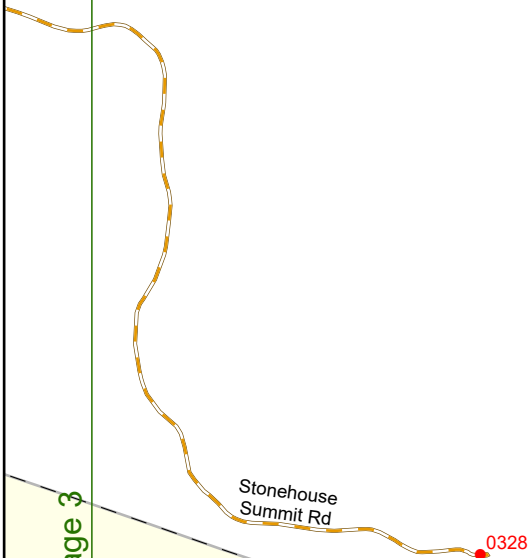

4

ORFORD
LYME

Match to Page 3

Match to Page 5

Cellar Ln
0394

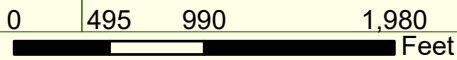

Match to Page 0

Lily Pond



ORFORD

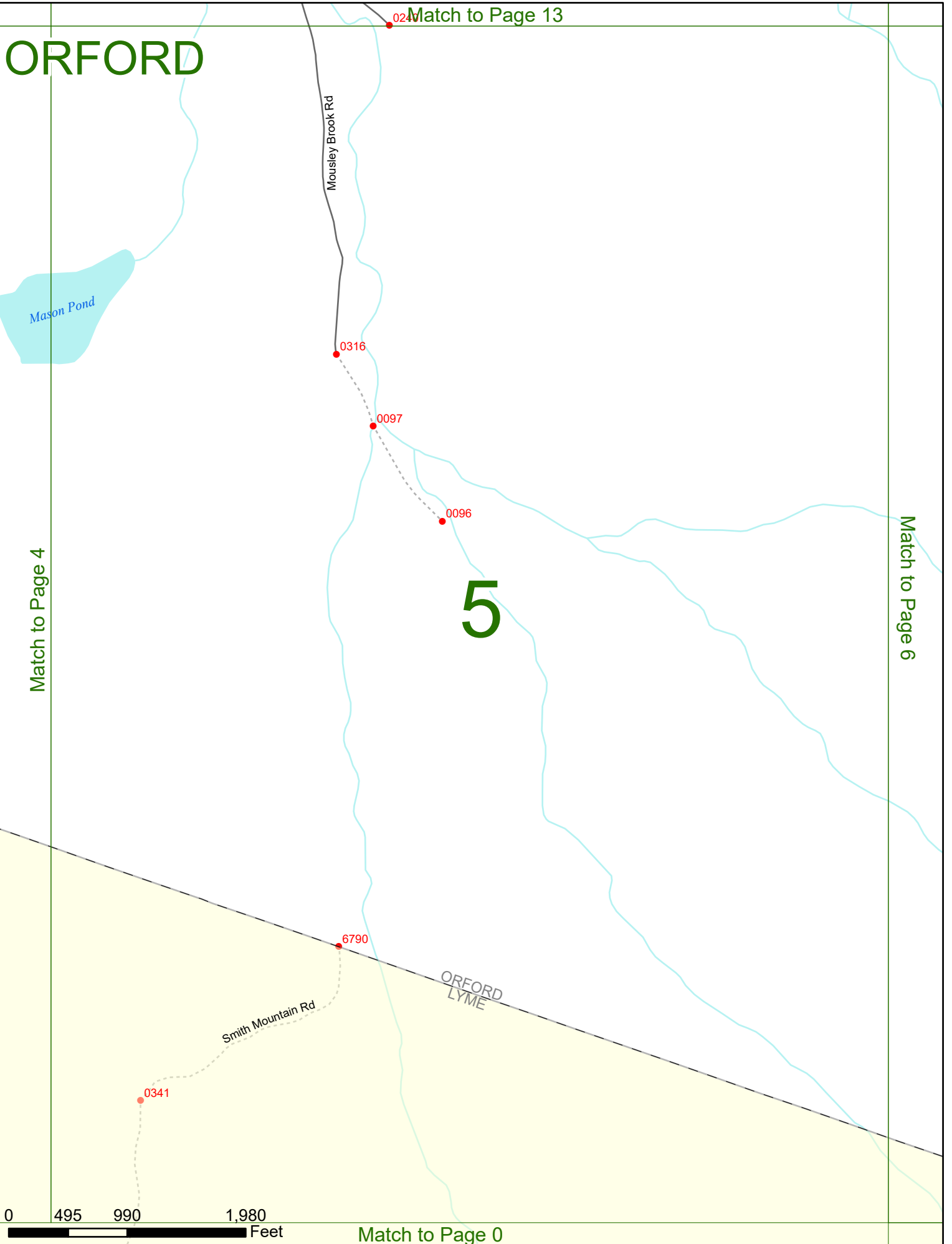

Match to Page 13

Match to Page 4

Match to Page 6

5

ORFORD
LYME

0 495 990 1,980 Feet

Match to Page 0

Match to Page 14

Pickeral Pond

ORFORD

6

Match to Page 5

Match to Page 7

ORFORD
WENTWORTH

ORFORD
LYME

0 495 990 1,980 Feet

Match to Page 1

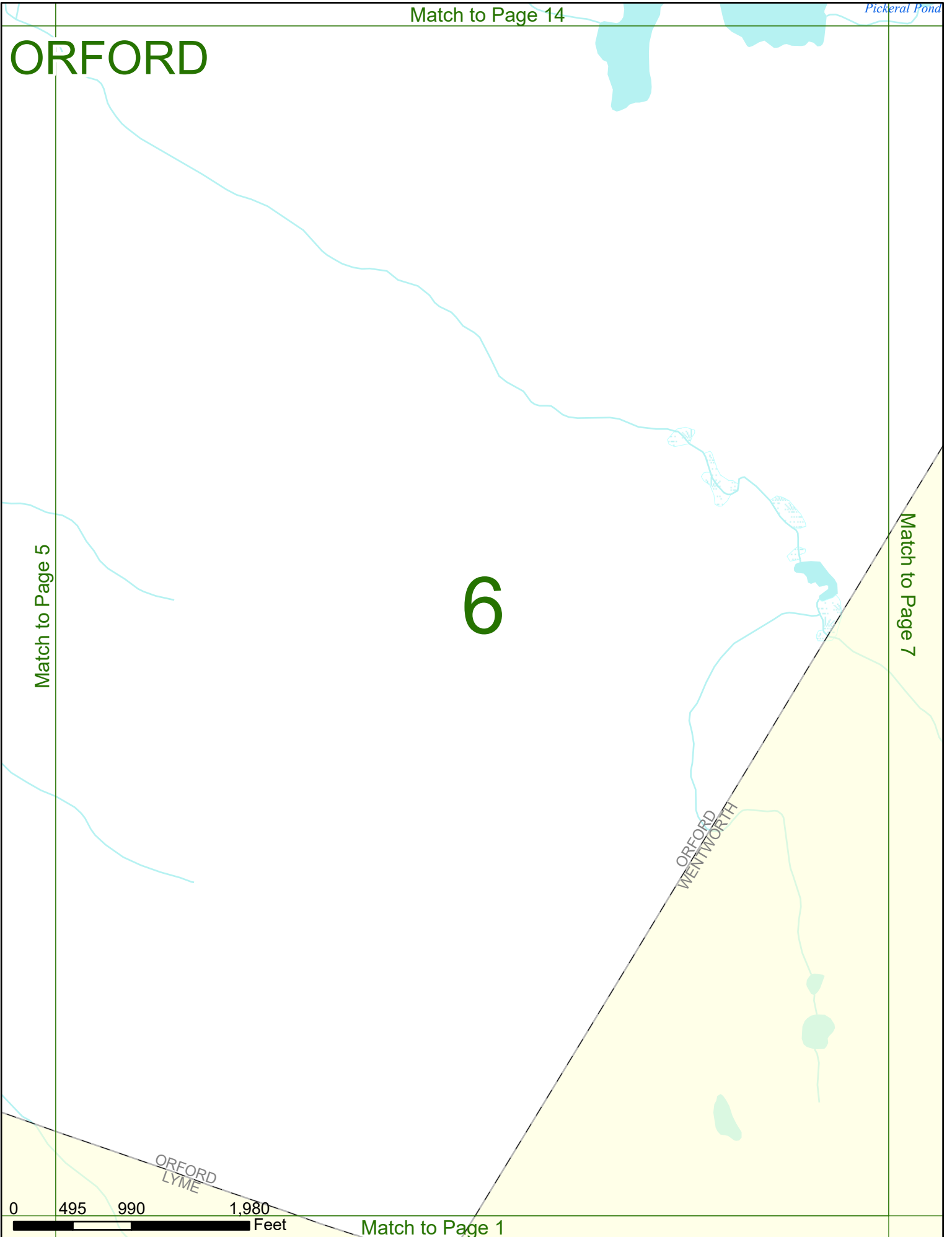

Pickeral Pond

Match to Page 15

ORFORD

ORFORD
WENTWORTH

Match to Page 6

Match to Page 0

7

Brackett Pond

Little
Rocky Pond

Rocky Pond

0 495 990 1,980 Feet

Match to Page 0

ORFORD

Match to Page 0

VERMONT
08

N 91

N 91

Connecticut River

Match to Page 9

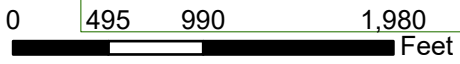

Match to Page 17

ORFORD

N 91
N 91

VERMONT

NH Route 10

0347 Tree Farm Rd 0348

9

Match to Page 8

Match to Page 10

0341 Sanborn Ln

0284 0285

0340

0006

10

6240

ORFORD LYME 6239

River Rd 0135

0136 Beech Hill Rd 4,980

Orford Rd

0 495 990 Feet

Match to Page 0

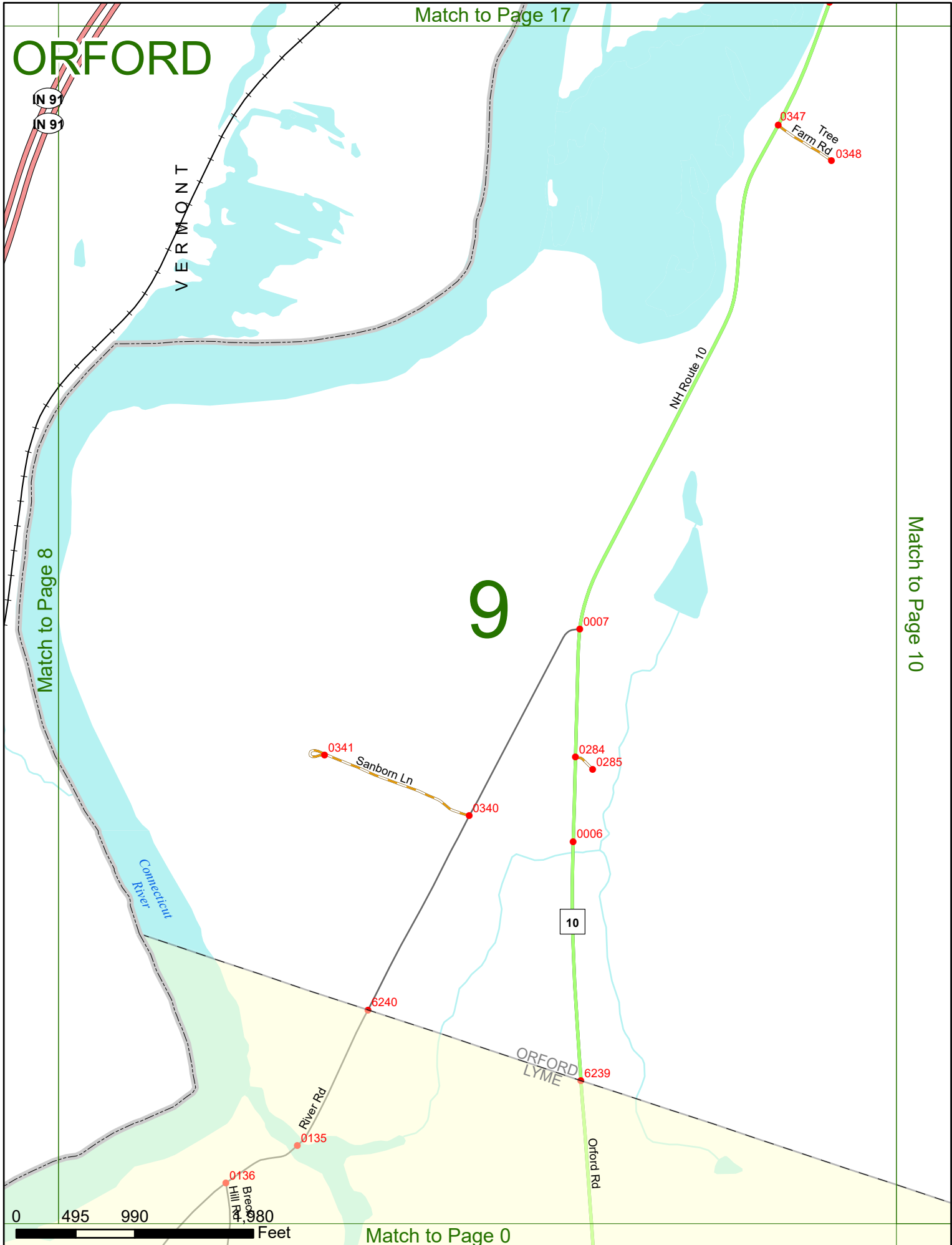

Match to Page 18

ORFORD

Match to Page 9

Match to Page 11

10



Match to Page 2

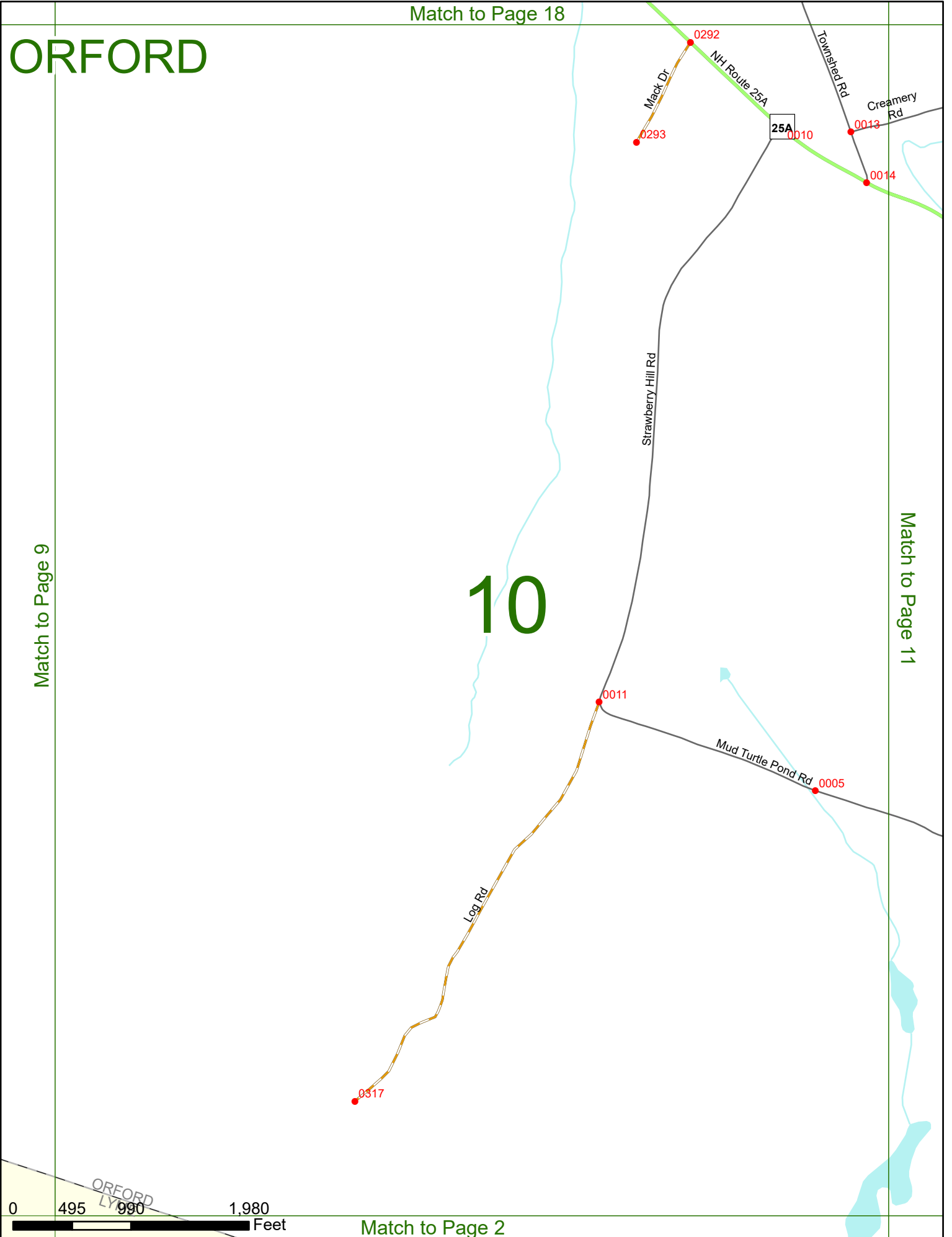

ORFORD

Match to Page 20

Match to Page 11

Match to Page 13

12

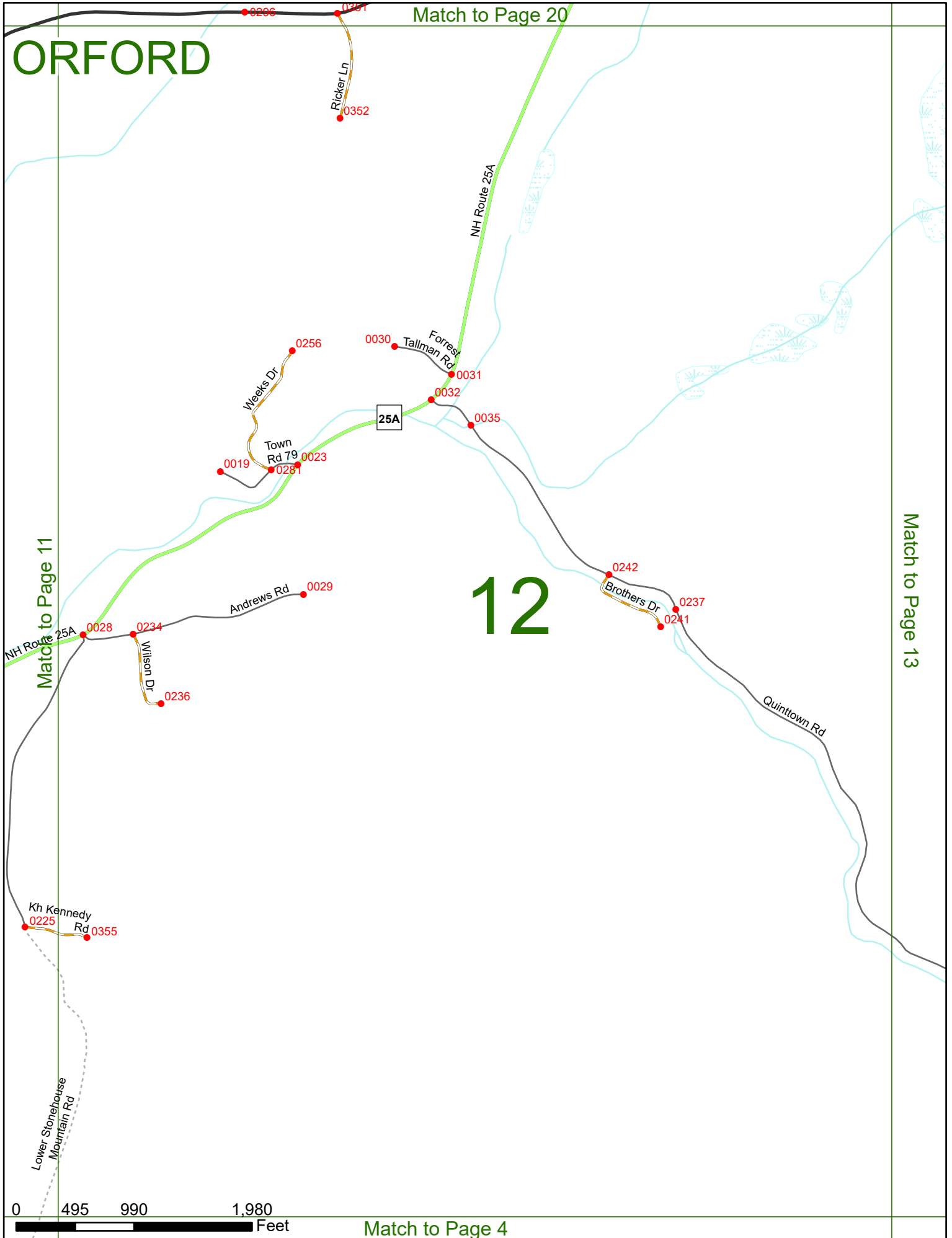

0 495 990 1,980 Feet

Match to Page 4

Match to Page 21

ORFORD

Match to Page 12

Match to Page 14

13

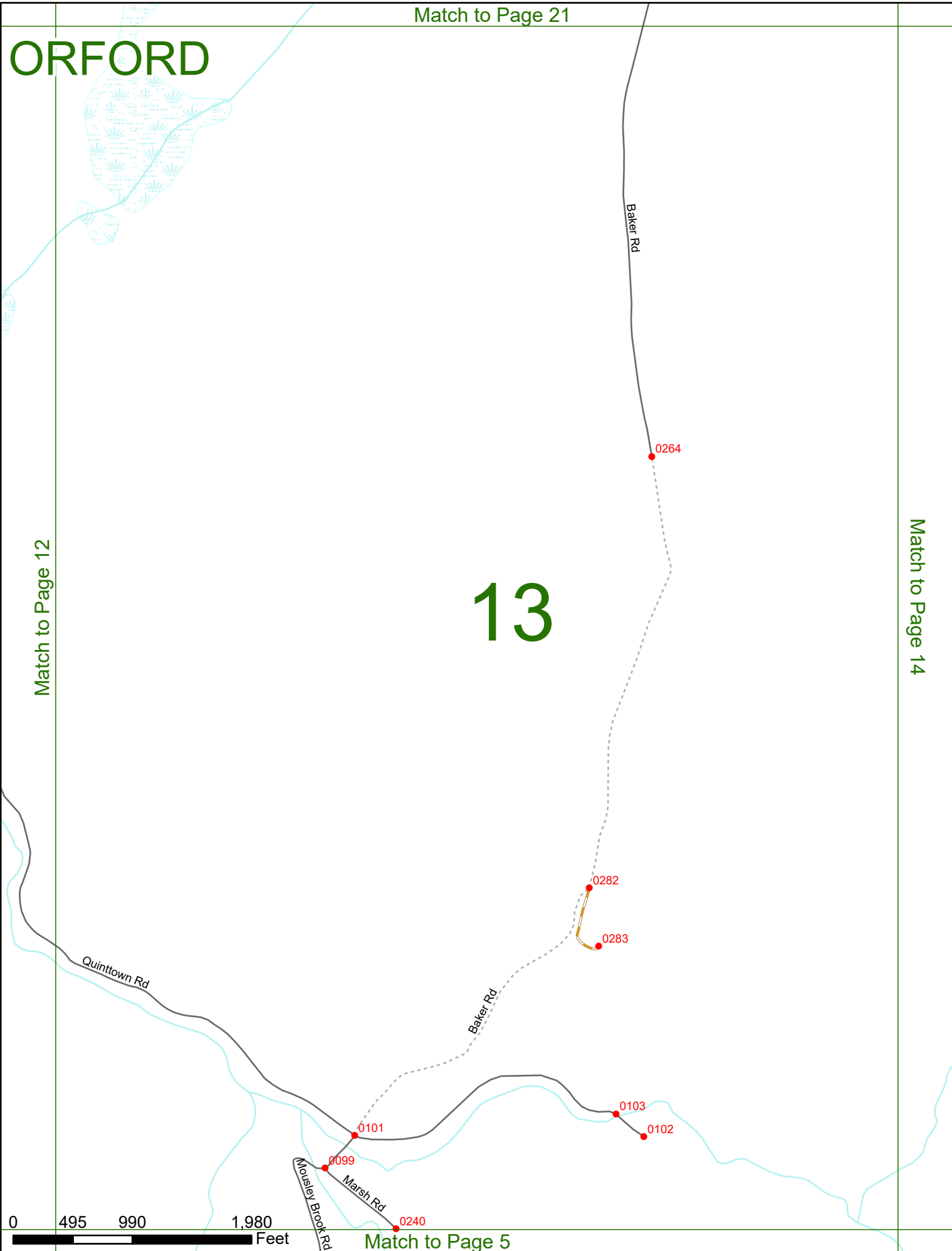

Match to Page 5

ORFORD

Match to Page 13

Match to Page 15

14

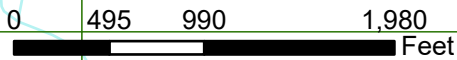

Match to Page 6

Pickeral Pond

Match to Page 23

ORFORD

Log Rd 4

Match to Page 14

15

Match to Page 16

ORFORD
WENTWORTH

Pickeral Pond



Match to Page 7

ORFORD

Match to Page 24

0230

Camp Pemigewasset Rd

Lower Baker Pond

0229

25A

Route 25A

Log Rd 4

ORFORD
WENTWORTH

0322

16

Match to Page 15

Match to Page 0

0228

Blueberry Ln

0 495 990 1,980 Feet

Match to Page 0

ORFORD

Match to Page 0

VERMONT

17

Match to Page 18

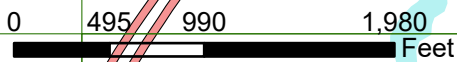

Match to Page 9

N 91

N 91

Connecticut River

0331

0086

Boat Landing Rd

0008

Sawyer Brook Rd

10

NH Route 10

0335

0287

0286

ORFORD

VERMONT

18

Match to Page 17

Match to Page 19

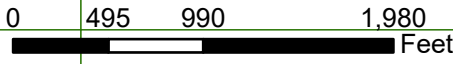
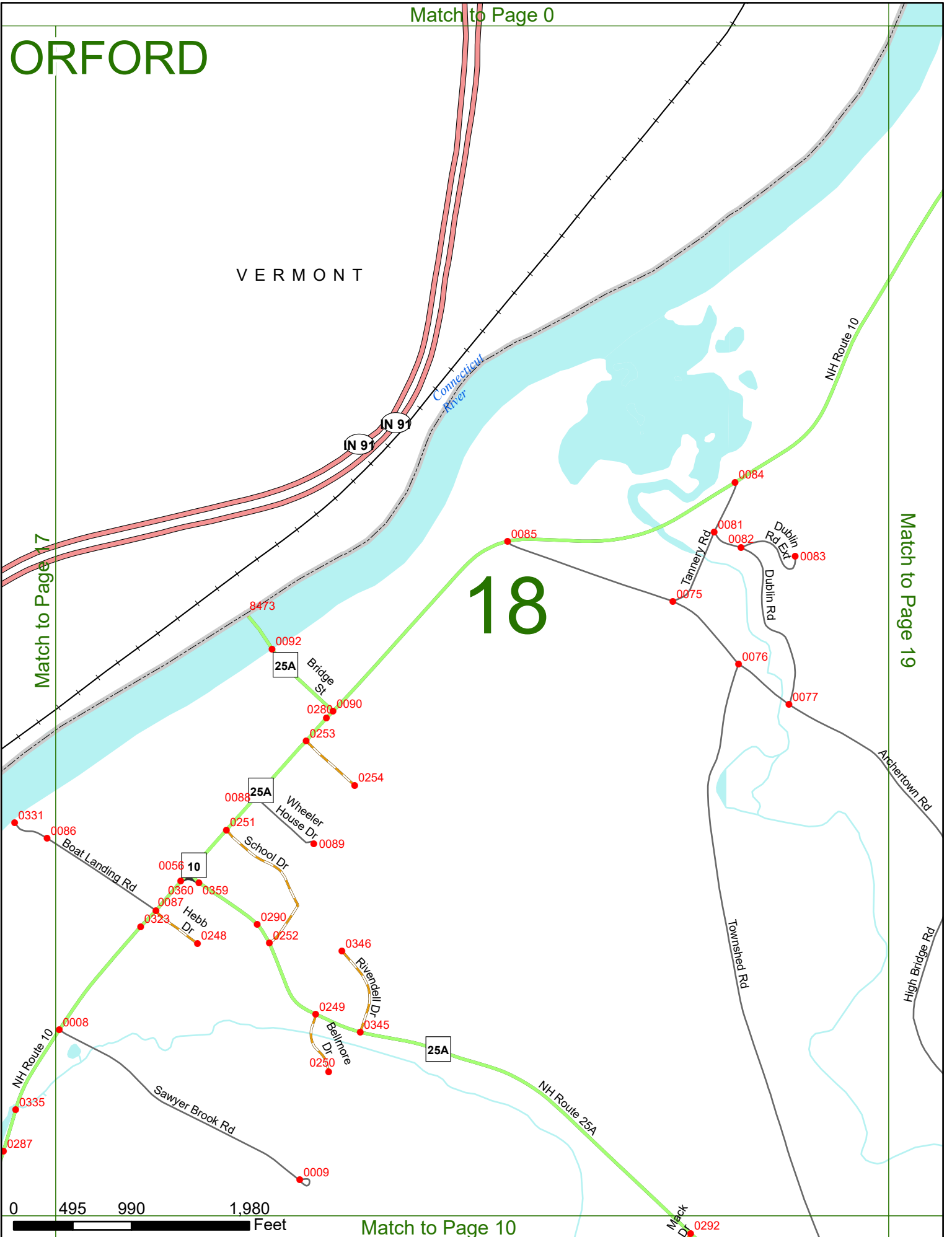

ORFORD

Match to Page 25

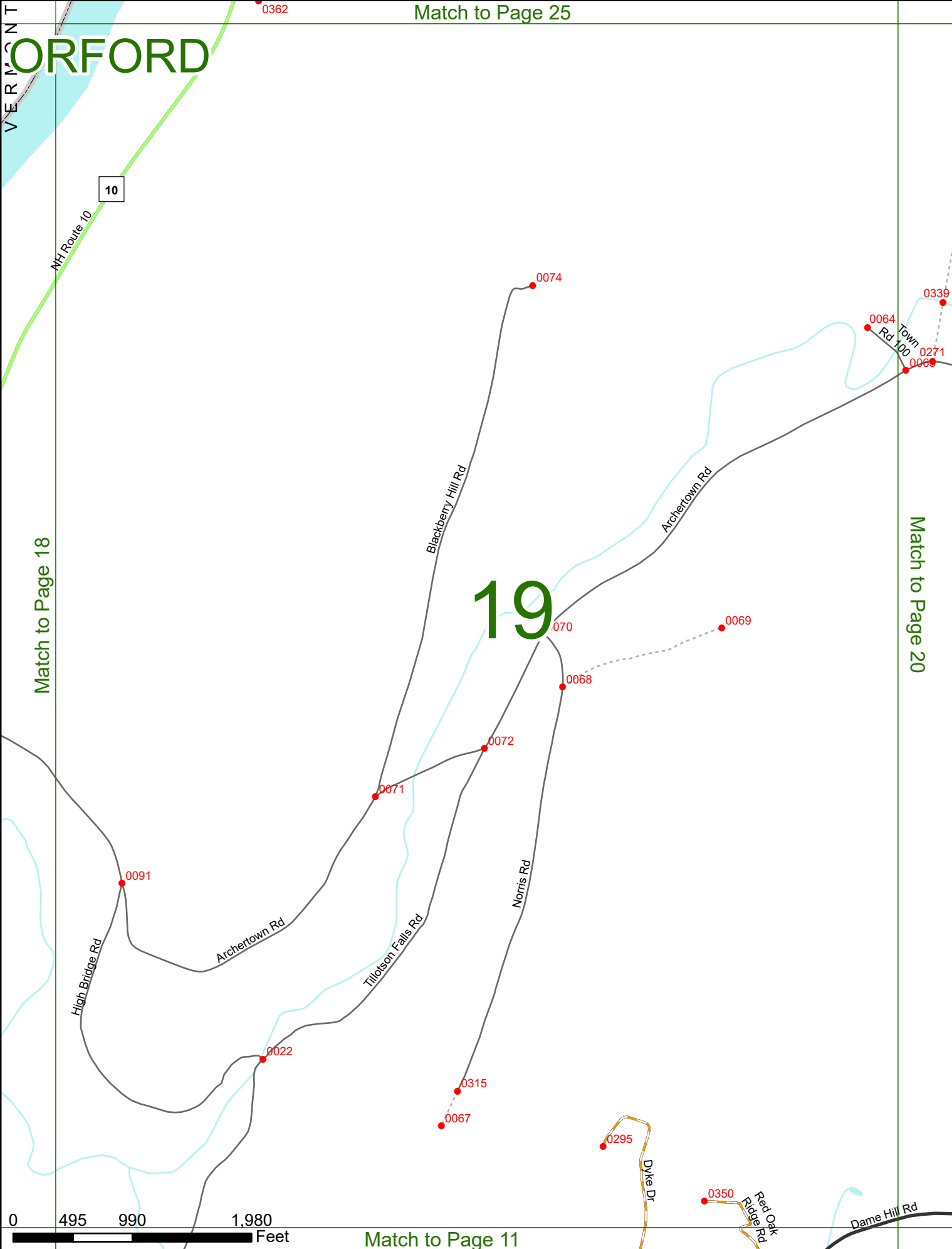

Match to Page 18

Match to Page 20

19

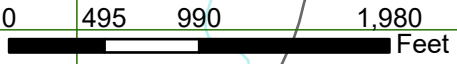

Match to Page 11

ORFORD

20

Match to Page 19

Match to Page 21

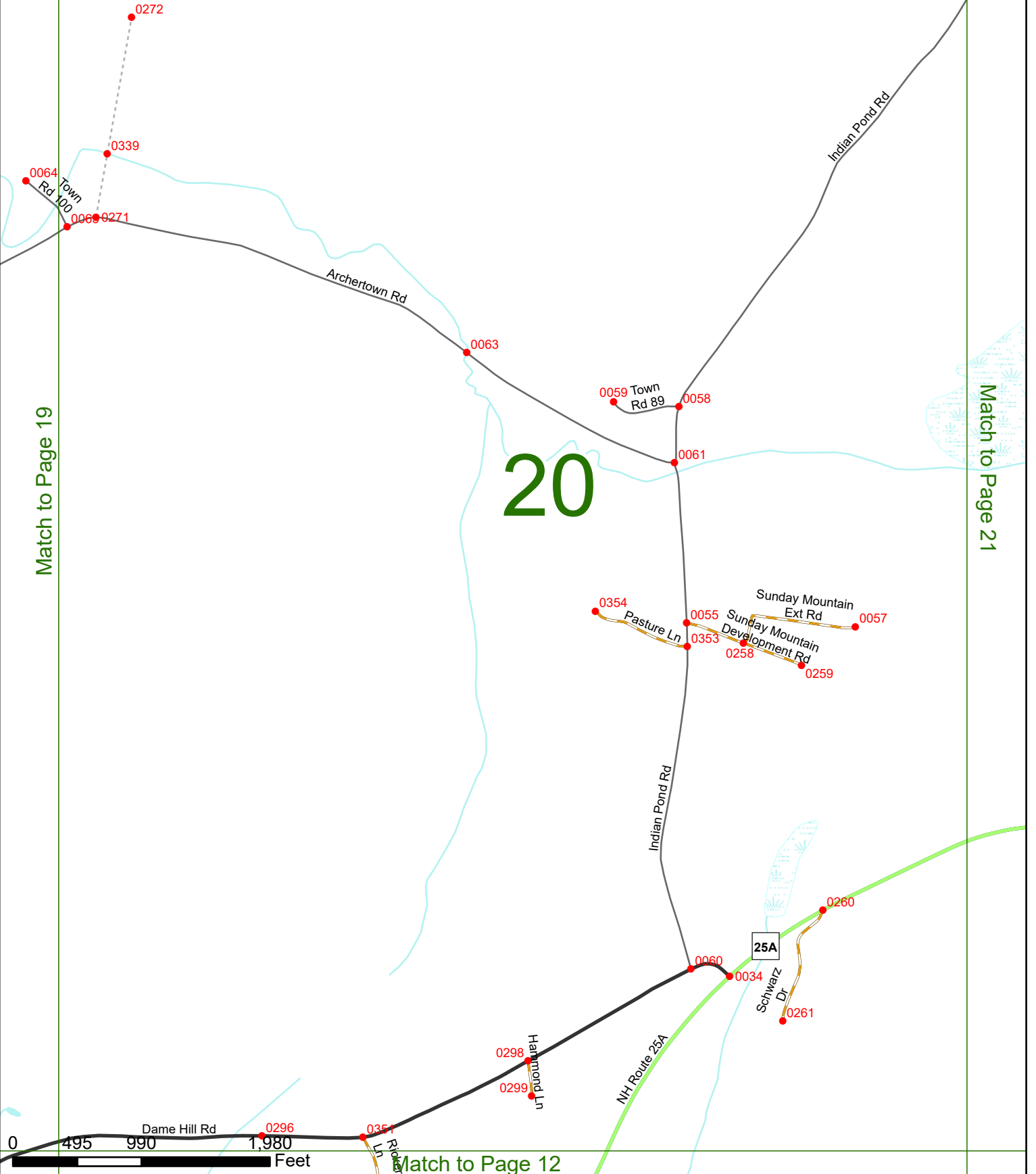

ORFORD

Indian Pond Rd

Match to Page 20

Match to Page 22

21

NH Route 25A

0054

25A

0262

0263

0053

Baker Rd

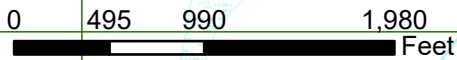

ORFORD

Match to Page 21

Match to Page 23

22

25A

NH Route 25A

0265 May Dr 0266

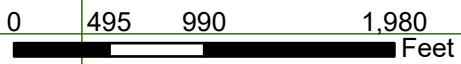

ORFORD

PIERMONT
ORFORD

Match to Page 22

Match to Page 24

23

Town Rd 85 0104 0105

Town Rd 107 0106 0048

Piermont Heights Rd 0047

Prettyman Rd 0039
Upper Baker Pond Beach Rd 0040

Town Rd 86 0046 0045

Upper Baker Pond Rd 0044 0043 0337 0309 0308

East Cemetery Rd 0305

Camp Rd 0304 0365 0330

NH Route 25A 0041 0329 0364

Pease Dr 0267 0268

25A

Log Rd 4

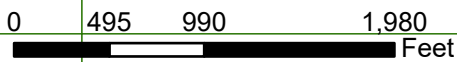

ORFORD

24

Match to Page 23

Match to Page 0

PIERMONT
ORFORD

PIERMONT
WENTWORTH

PIERMONT
WARREN

WENTWORTH
WARREN

Cape Monshire Rd

McCulloch Rd
0240 0241

0084 Atwell Hill Rd

Cape Monshire Rd

0262 0261
Bones Rd
Dancing
Chase Rd
0263 0087

ORFORD
WENTWORTH

Camp Rd
0365 0330

Moosilauke Way
0306

0329 0364
0038

NH Route 25A

25A
0036
0037

6248

Route 25A

Lower
Baker Pond

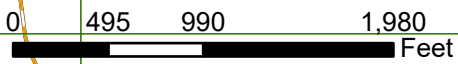

Match to Page 16

ORFORD

Match to Page 30

Match to Page 0

Match to Page 26

25

Connecticut River

NH Route 10

Grimes Hill Rd

0274
River Cottage Ln
0273
0275
Cottonstone Farm Ln
0276

NH Route 10
10

0334

PS 201 Entrance
0363
0362

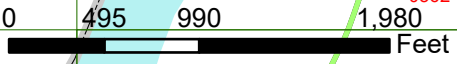

Match to Page 19

ORFORD

Match to Page 31

PIERMONT
ORFORD

Bean Brook Rd

0277
Boylston Rd

Grimes Hill Rd

0109

0278

0107

6263

26

Match to Page 25

Match to Page 27

0 495 990 1,980 Feet

Match to Page 20

Match to Page 0

ORFORD

Bean Brook Rd

0007

6268

Cole Farm Rd

6269

PIERMONT
ORFORD

0112

Indian Pond Rd

27

Match to Page 26

Match to Page 28

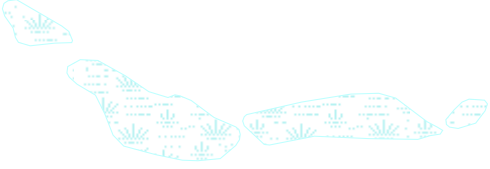

Indian Pond
Beach Rd 0094
Host Ln 0093
0312
0313

Indian Pond

0270

Old Grimes Hill Rd

0332

Bear Tree Rd

0327

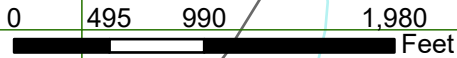

Match to Page 21

Match to Page 0

ORFORD

28

Match to Page 27

Match to Page 29

PIERMONT
ORFORD

Piermont Heights Rd

Bear Tree Rd

0205

6265

0324

0 495 990 1,980 Feet

Match to Page 22



ORFORD

29

Match to Page 28

Match to Page 0

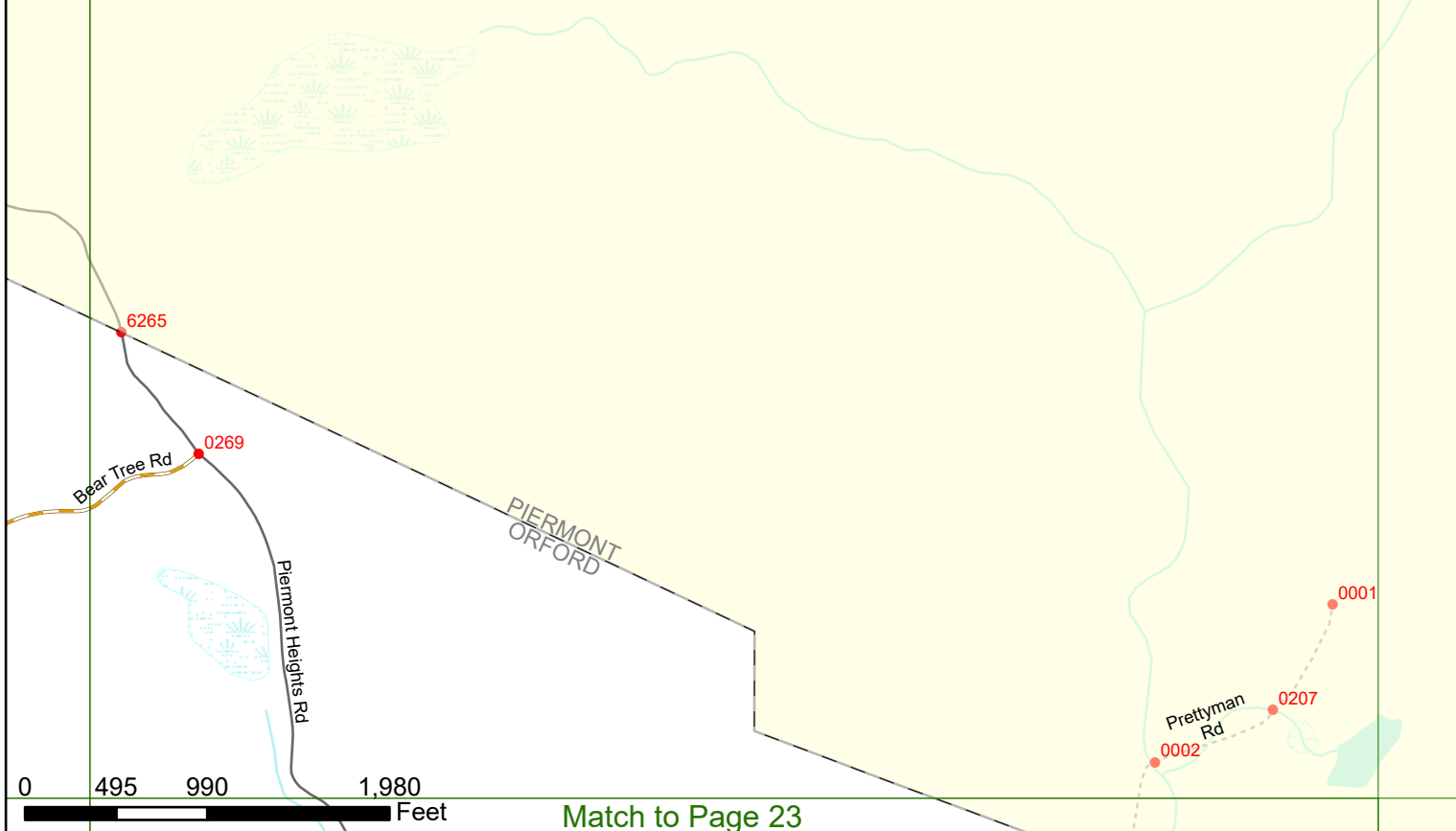

0 495 990 1,980 Feet

Match to Page 23

ORFORD

Match to Page 0

Route 25

25

Connecticut
River

Match to Page 0

30

Match to Page 31

VERMONT

Route 10

6261

10

NH Route 10

0 495 990 1,980 Feet

Match to Page 25

ORFORD

Match to Page 0

VERMONT

Match to Page 30

Match to Page 0

31

0 495 990 1,980 Feet

Match to Page 26

