



Maps and data sets are not guaranteed to be free from errors and omissions. Data is in a constant state of update and correction by various groups and agencies. Information displayed on this map is the best available at the time of publication.

2023 Nodal Reference Bookmap

LEGEND



NHDOT will accept crash locations based on the State of NH Uniform Police Traffic Accident Report.

Crash occurred on:

Option 1 Street Address
 123 Main Street

Option 2 Route No and/or Distance from NESW Intesecting Road, Bridge,
 Street name Intersecting Street Town/County line
 Main Street 500 E Oak Street

Option 3 First Node Distance from First Node Second Node
 515 212 632

Option 4 Route No and/or Mile Marker on Interstate Only NESW Mile (Marker)
 Street name
 189S 700 feet S 36.8

Option 3 – Example

Street Name Loudon Road
First Node 803
Distance from First Node 318 Ft
Second Node 813



NORTHUMBERLAND

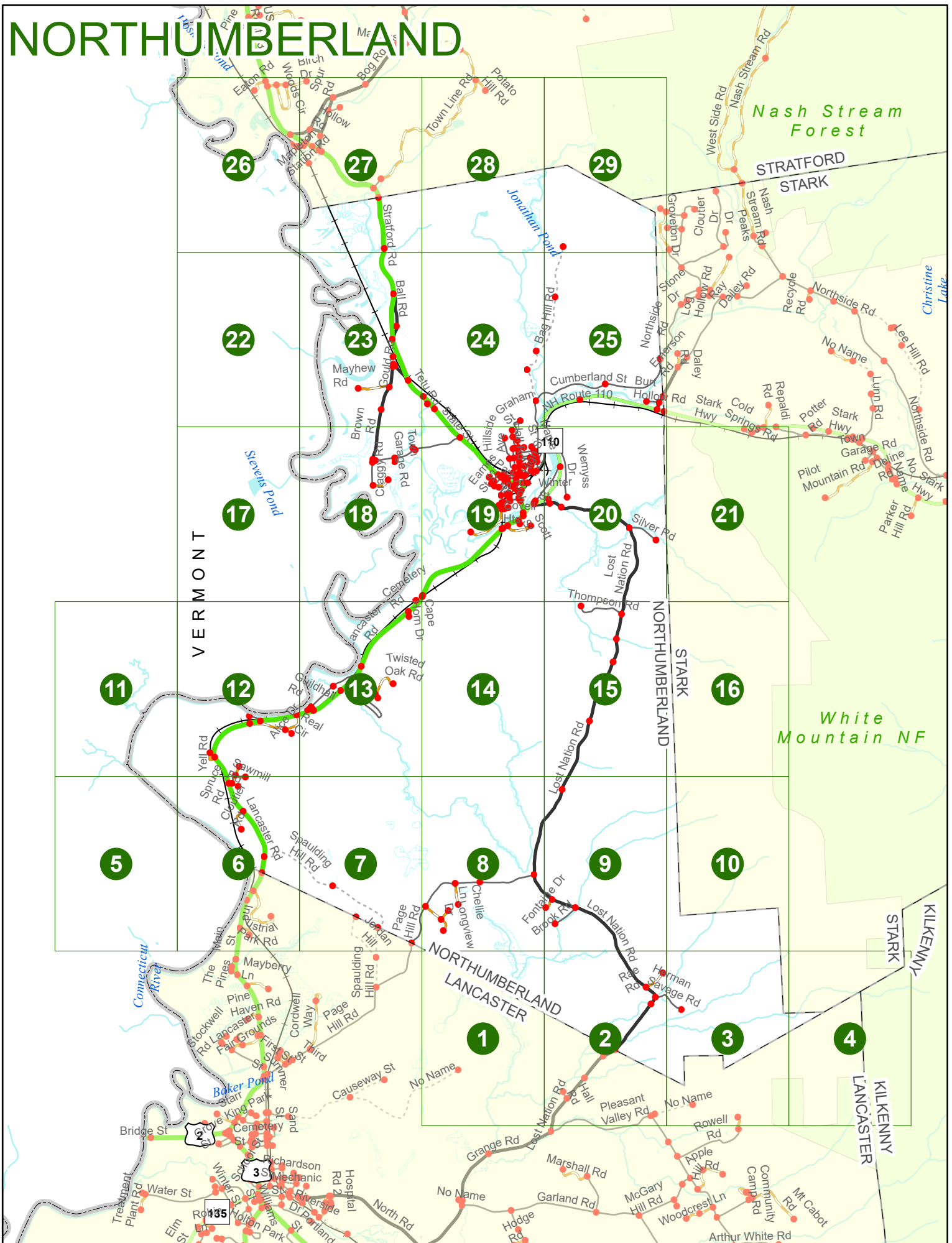

NORTHUMBERLAND

NORTHUMBERLAND
LANCASTER

1

Match to Page 0

Match to Page 2

0136

0 495 990 1,980 Feet

Match to Page 0

Lost
Nation Rd

Match to Page 9

NORTHUMBERLAND

Match to Page 1

Match to Page 3

2

NORTHUMBERLAND
LANCASTER

Lost Nation Rd

Herman
Savage Rd

Greene Rd

Lost Nation Rd

Abandoned
Town Rd

Pleasant Valley Rd

0 495 990 1,980 Feet

Match to Page 0

0223 0222

0002

0166

0209

0252

0208

0267

0139

0138

0140

0222

NORTHUMBERLAND

Ree Rd
0222

Herran Savage Rd
0001

STARK
NORTHUMBERLAND

Match to Page 2

3

Match to Page 4

NORTHUMBERLAND
LANCASTER

White
Mountain NF

0141

0207

Rowell Rd

0144

0 495 990 1,980 Feet

Match to Page 0

Match to Page 0

NORTHUMBERLAND

STARK
KILKENNY

STARK
LANCASTER

STARK
NORTHUMBERLAND

NORTHUMBERLAND
LANCASTER

4

*White
Mountain NF*

Match to Page 3

Match to Page 0

0 495 990 1,980 Feet

Match to Page 0

Match to Page 11

NORTHUMBERLAND

Connecticut River

Match to Page 0

VERMONT **5**

Match to Page 6

0 495 990 1,980 Feet

Match to Page 0

NORTHUMBERLAND

Match to Page 12

Match to Page 5

Match to Page 7

6

VERMONT

Connecticut River

0174
0141
0159
0142
0161
0150
Cloutier Rd

3

Lancaster Rd

0003

Spaulding Hill Rd

6248

NORTHUMBERLAND
LANCASTER

0296
0260
Main St
Industrial Park Rd

0297

0316
PS 102-L
Entrance

0315

0 495 990 1,980 Feet

Match to Page 0

NORTHUMBERLAND

7

Match to Page 6

Match to Page 8

0004

Spaulding Hill Rd

NORTHUMBERLAND
LANCASTER

6249

6250

Jordan Hill

6251

0175

Page Hill Rd

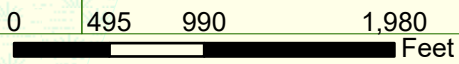

Match to Page 0

NORTHUMBERLAND

8

Match to Page 7

Match to Page 9

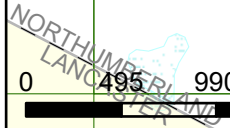
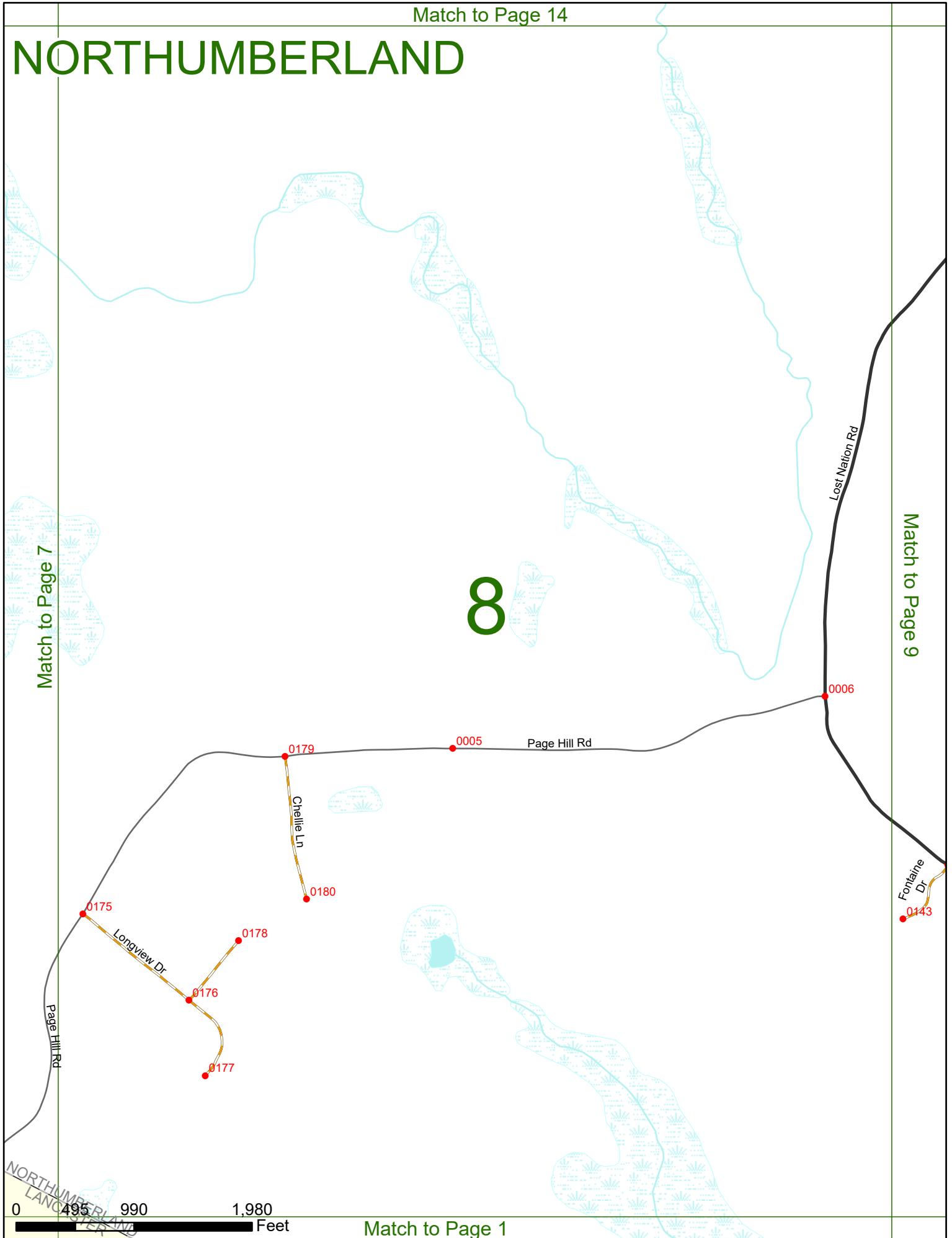

Match to Page 1

NORTHUMBERLAND

9

Match to Page 8

Match to Page 10

Lost Nation Rd
0127

Fontaine Dr
0143 0144

Brook Rd
0008

0007
Lost Nation Rd

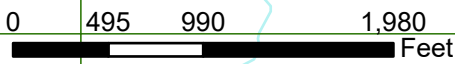

Match to Page 2

NORTHUMBERLAND

White Mountain NF

Match to Page 9

Match to Page 0

10

STARK
NORTHUMBERLAND

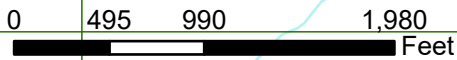

Match to Page 3

NORTHUMBERLAND

Match to Page 0

Match to Page 12

VERMONT

11

Comencicut
River

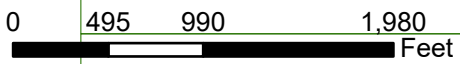

Match to Page 5

NORTHUMBERLAND

VERMONT

12

Match to Page 11

Match to Page 13

Connecticut River

0193 Perras Rd

0192

Lancaster Rd

Alice Dr

0220 Real Cir

0221

8753



0216 Yell Rd

0217

0172

0171

0142

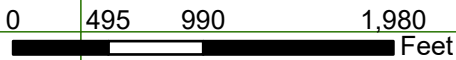

Match to Page 6

NORTHUMBERLAND

VERMONT

Match to Page 12

Match to Page 14

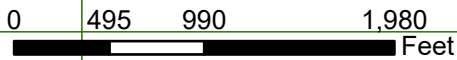
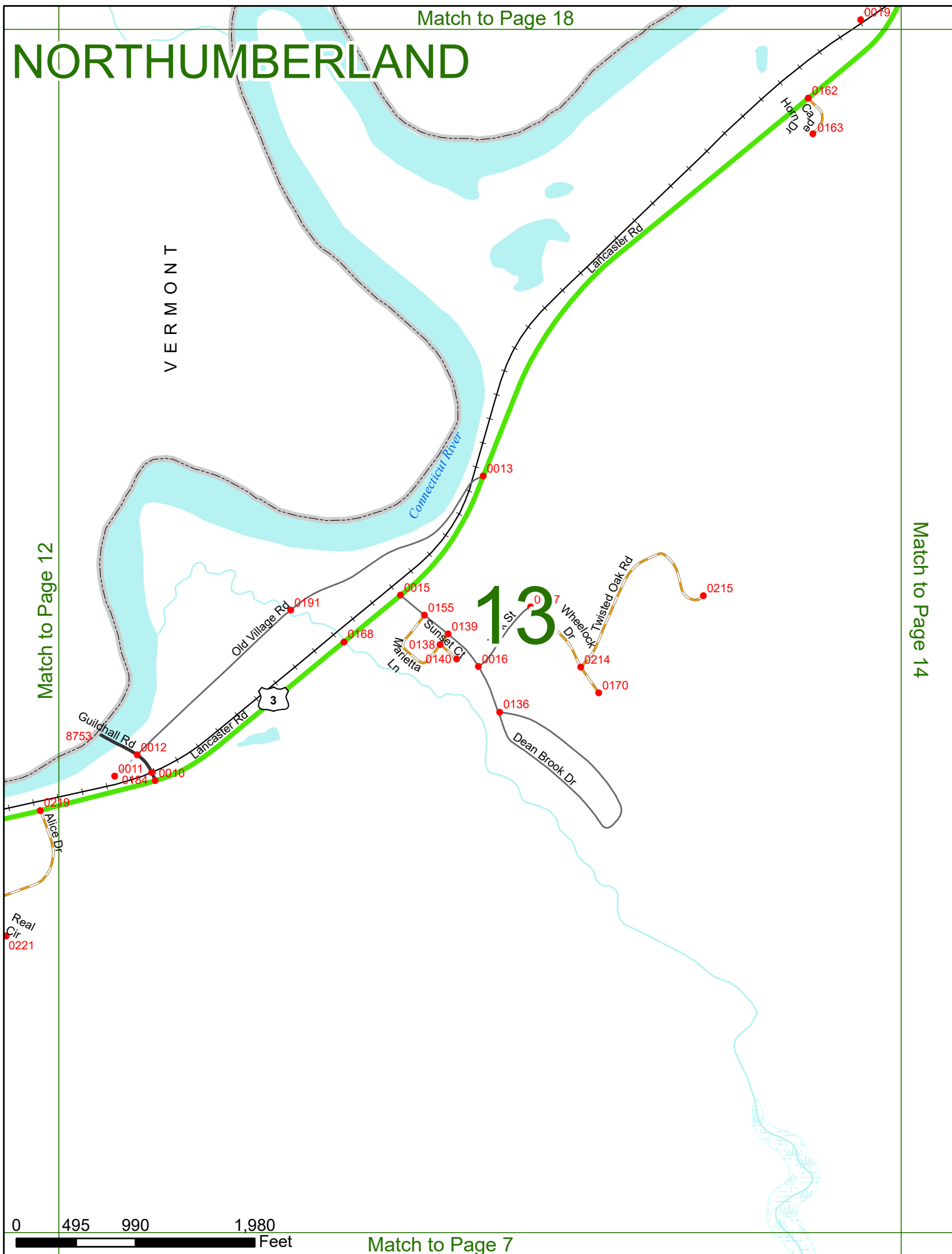



NORTHUMBERLAND

Match to Page 13

Match to Page 15

14

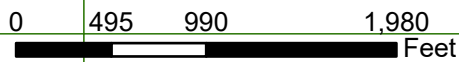

Match to Page 8



Match to Page 20

NORTHUMBERLAND

Lost Nation Rd

0020

0125

0126

15

Lost Nation Rd

0128

Match to Page 14

STARK
NORTHUMBERLAND
Match to Page 16

0 495 990 1,980 Feet

Match to Page 9

Match to Page 21

NORTHUMBERLAND

16

Match to Page 15

STARK
NORTHUMBERLAND

Match to Page 0

*White
Mountain NF*

0 495 990 1,980 Feet

Match to Page 10

NORTHUMBERLAND

Match to Page 0

Match to Page 18

VERMONT
17

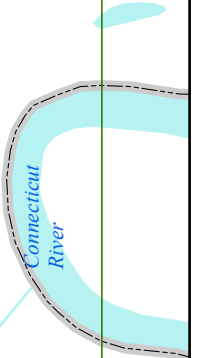

Match to Page 23

NORTHUMBERLAND

Match to Page 17

Match to Page 19

VERMONT

18

Connecticut River

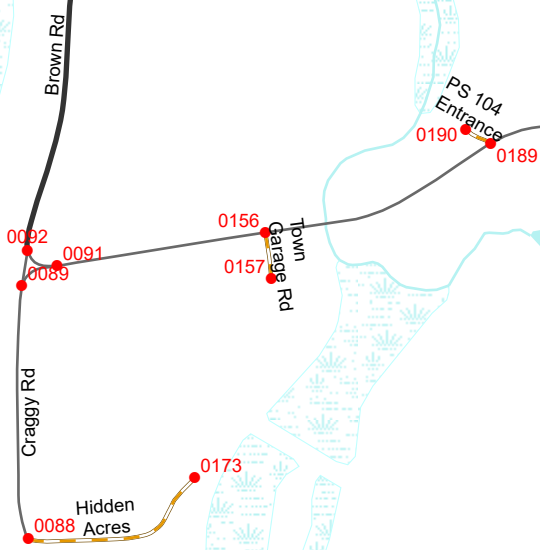

PS 104 Entrance
0190 0189

Town Garage Rd

0092 0089 0091

0156 0157

0173

0088 Hidden Acres

Craggy Rd

Brown Rd



Match to Page 13

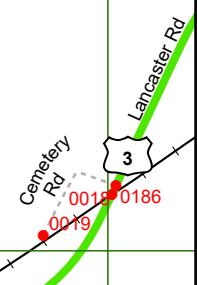

Cemetery Rd

Lancaster Rd

3

0019 0018 0186

NORTHUMBERLAND

19

Match to Page 18

Match to Page 20

VERMONT
Connecticut River

Cemetery Rd
0019
0018
00186

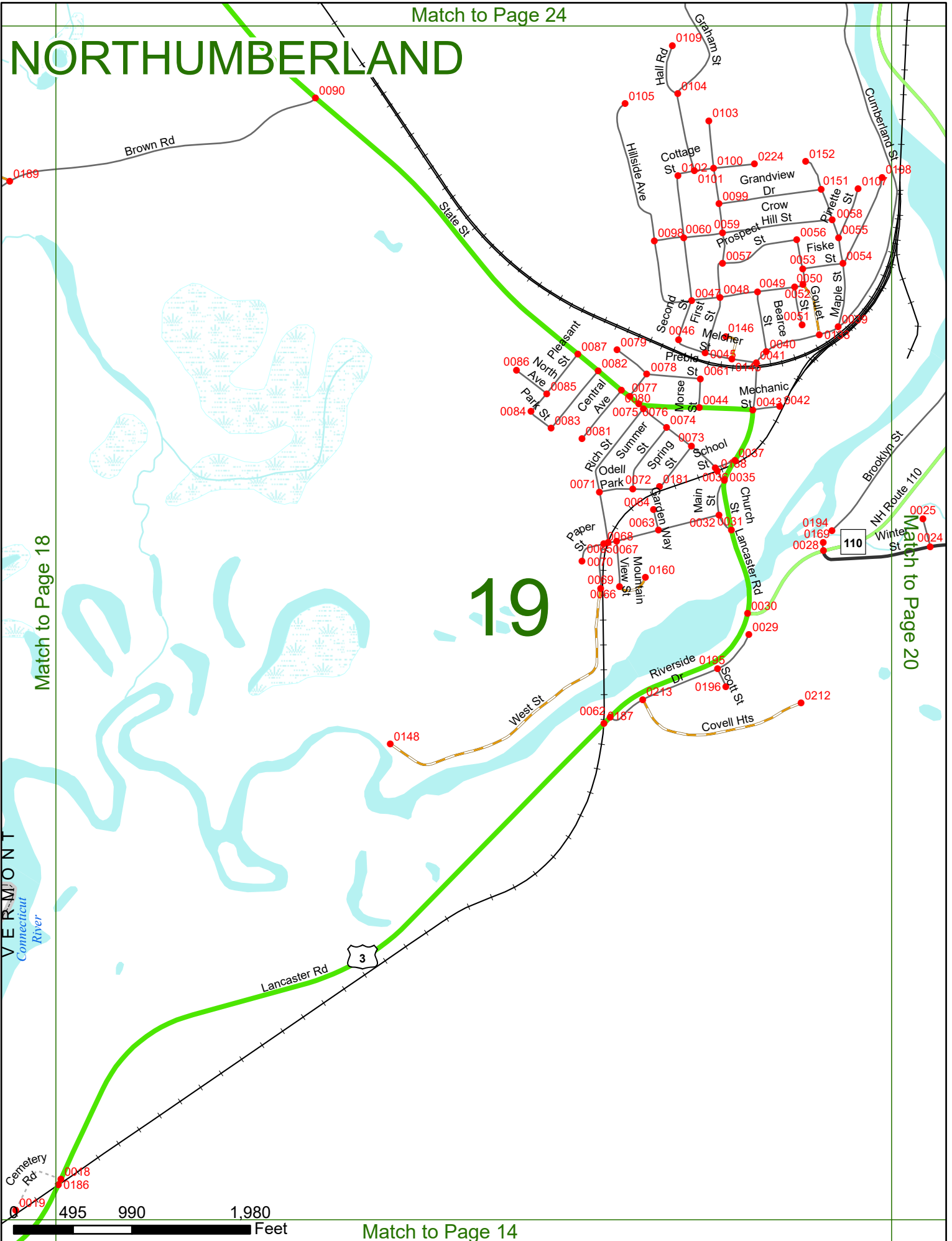
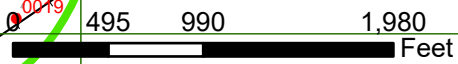

NORTHUMBERLAND

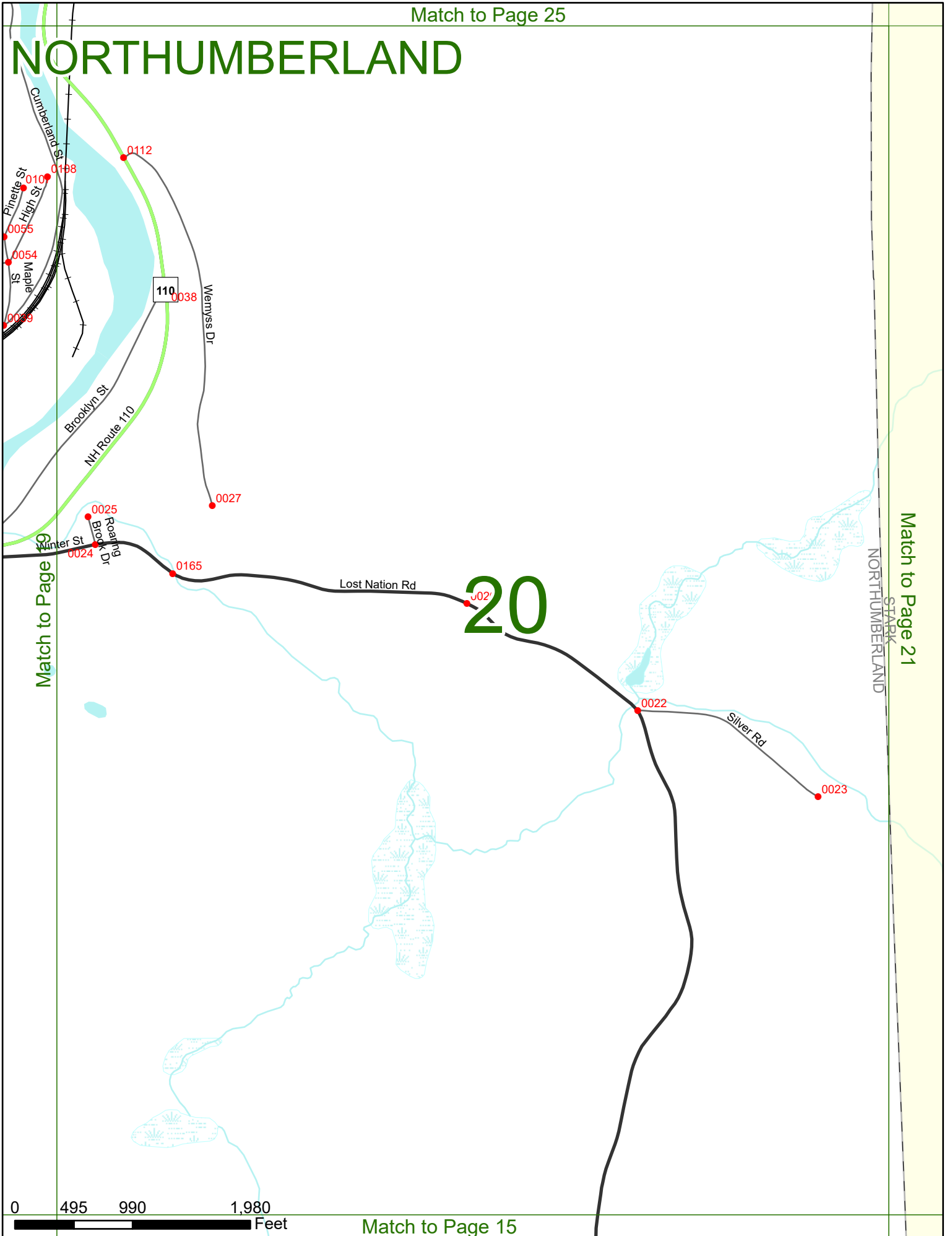

Match to Page 19

Match to Page 21

0 495 990 1,980 Feet

Match to Page 15

NORTHUMBERLAND

Match to Page 0

21

White Mountain NF

Match to Page 0

Match to Page 20

STARK

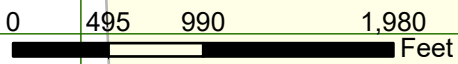

Match to Page 16

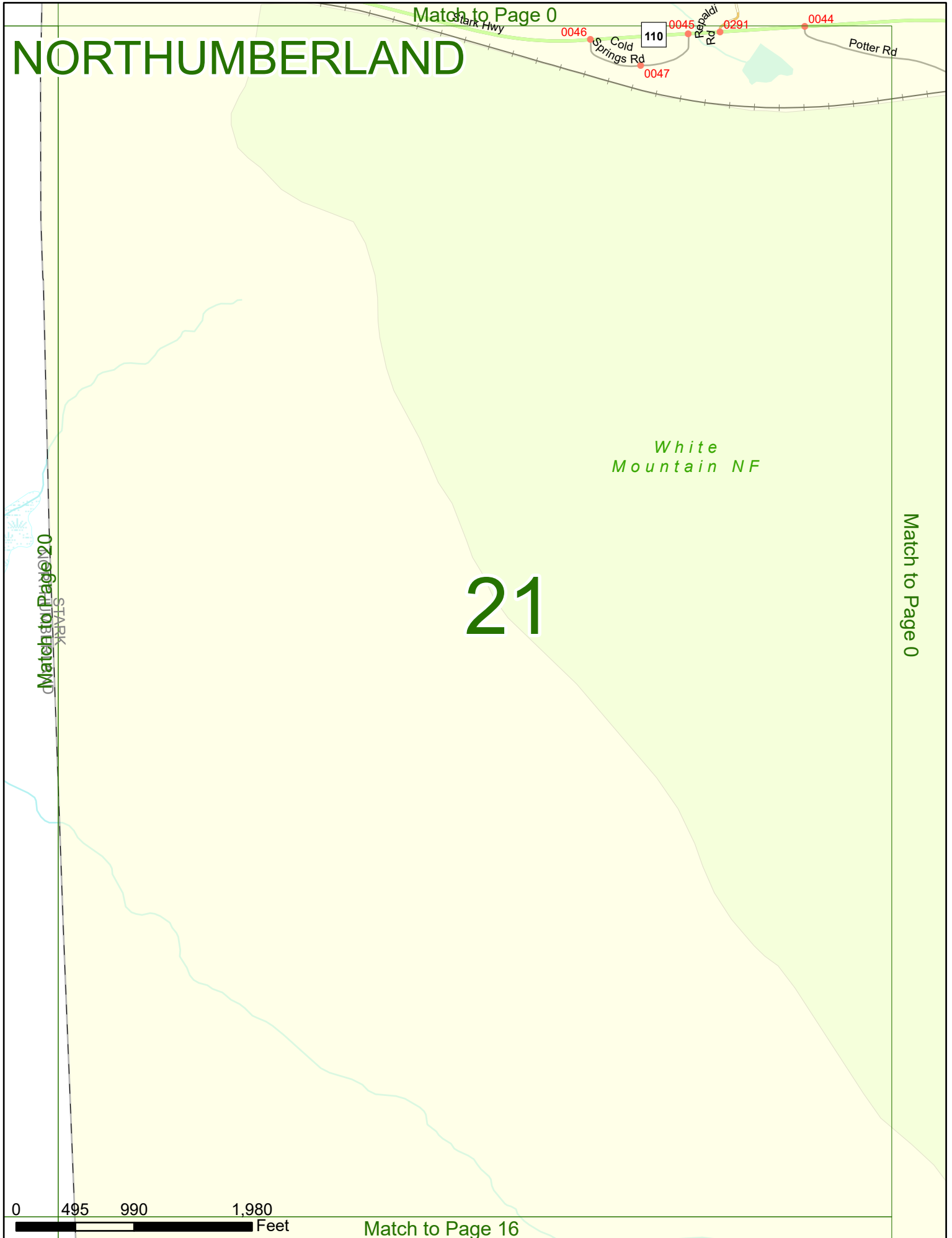

Connecticut River

NORTHUMBERLAND

Match to Page 0

VERMONT
22

Match to Page 23

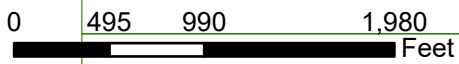

Match to Page 27

NORTHUMBERLAND

Match to Page 22

VERMONT

23

Match to Page 24

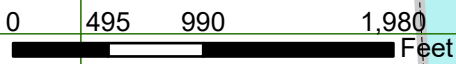

Match to Page 18



NORTHUMBERLAND

24

Match to Page 23

Match to Page 25

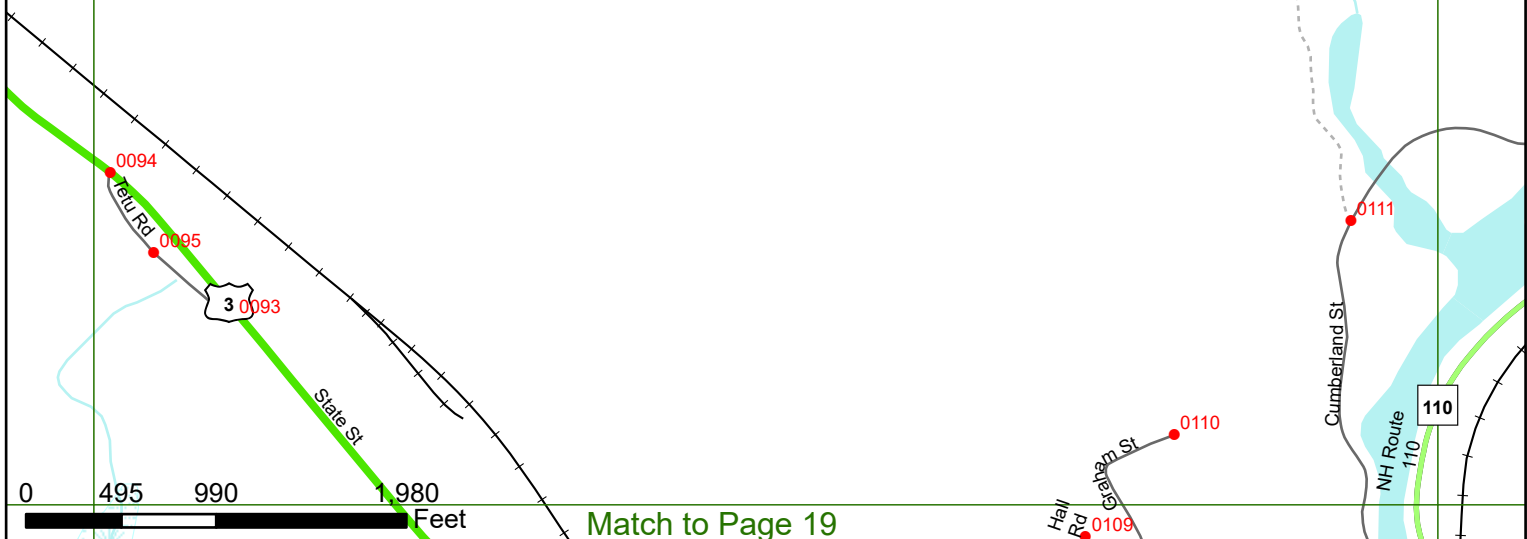

NORTHUMBERLAND

25

0063
Molly Brook Rd

0131
Bag Hill Rd

Match to Page 24

0119

NORTHUMBERLAND STARK
Northumberland Rd

Match to Page 26

6059

0117 Cumberland St

Emerson Rd

0111

0116 NH Route 110

110

6060

0115 Burt Hollow Rd

0114

0113

6061 Stark Hwy

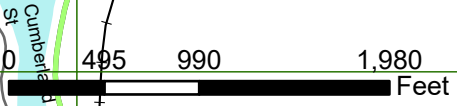

NORTHUMBERLAND

Match to Page 0

Match to Page 0

26

VERMONT

Match to Page 27

0 495 990 1,980 Feet

Match to Page 22



Match to Page 0

NORTHUMBERLAND

27

Match to Page 28

Match to Page 26

Match to Page 23

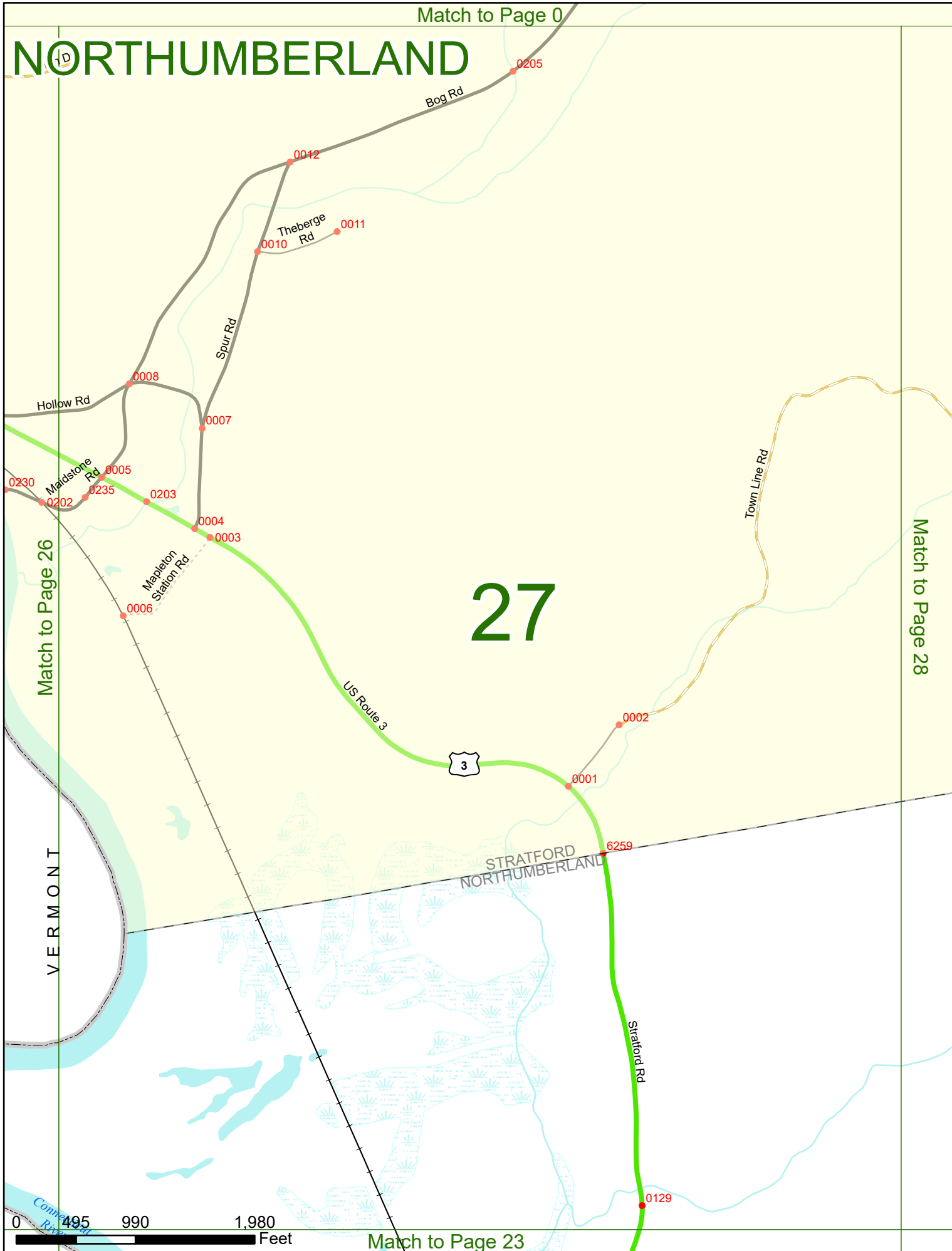

NORTHUMBERLAND

Match to Page 0

0086
to Hill Rd
0173

Town Line Rd

28

Match to Page 27

Match to Page 29

STRATFORD
NORTHUMBERLAND

Jonathan
Pond

0 495 990 1,980 Feet

Match to Page 24

Match to Page 0

NORTHUMBERLAND

Nash Stream Forest

29

Match to Page 28

Match to Page 0

STRATFORD
NORTHUMBERLAND

STRATFORD
STARK

NORTHUMBERLAND
STARK

High Acres Dr
0109
0068

Moose Pond Dr
0106

Grove-ton Dr

Molly Brook Rd
0063

Jonathan Pond



Big Hill Rd
0124

Match to Page 25