

*New Hampshire*  
**DOT**  
*Department of Transportation*

Maps and data sets are not guaranteed to be free from errors and omissions. Data is in a constant state of update and correction by various groups and agencies. Information displayed on this map is the best available at the time of publication.

# 2023 Nodal Reference Bookmap

## LEGEND



NHDOT will accept crash locations based on the State of NH Uniform Police Traffic Accident Report.

Crash occurred on:

**Option 1**     Street Address  
                   123 Main Street

**Option 2**     Route No and/or     Distance from             NESW             Intesecting Road, Bridge,  
                   Street name             Intersecting Street                                     Town/County line  
                   Main Street                     500                     E                     Oak Street

**Option 3**     First Node                     Distance from First Node                     Second Node  
                   515                                     212                                     632

**Option 4**     Route No and/or             Mile Marker on Interstate Only             NESW             Mile (Marker)  
                   Street name  
                   189S                                     700 feet                                     S                     36.8

**Option 3 – Example**

Street Name                     Loudon Road  
First Node                             803  
Distance from First Node             318 Ft  
Second Node                             813



# NORTHFIELD

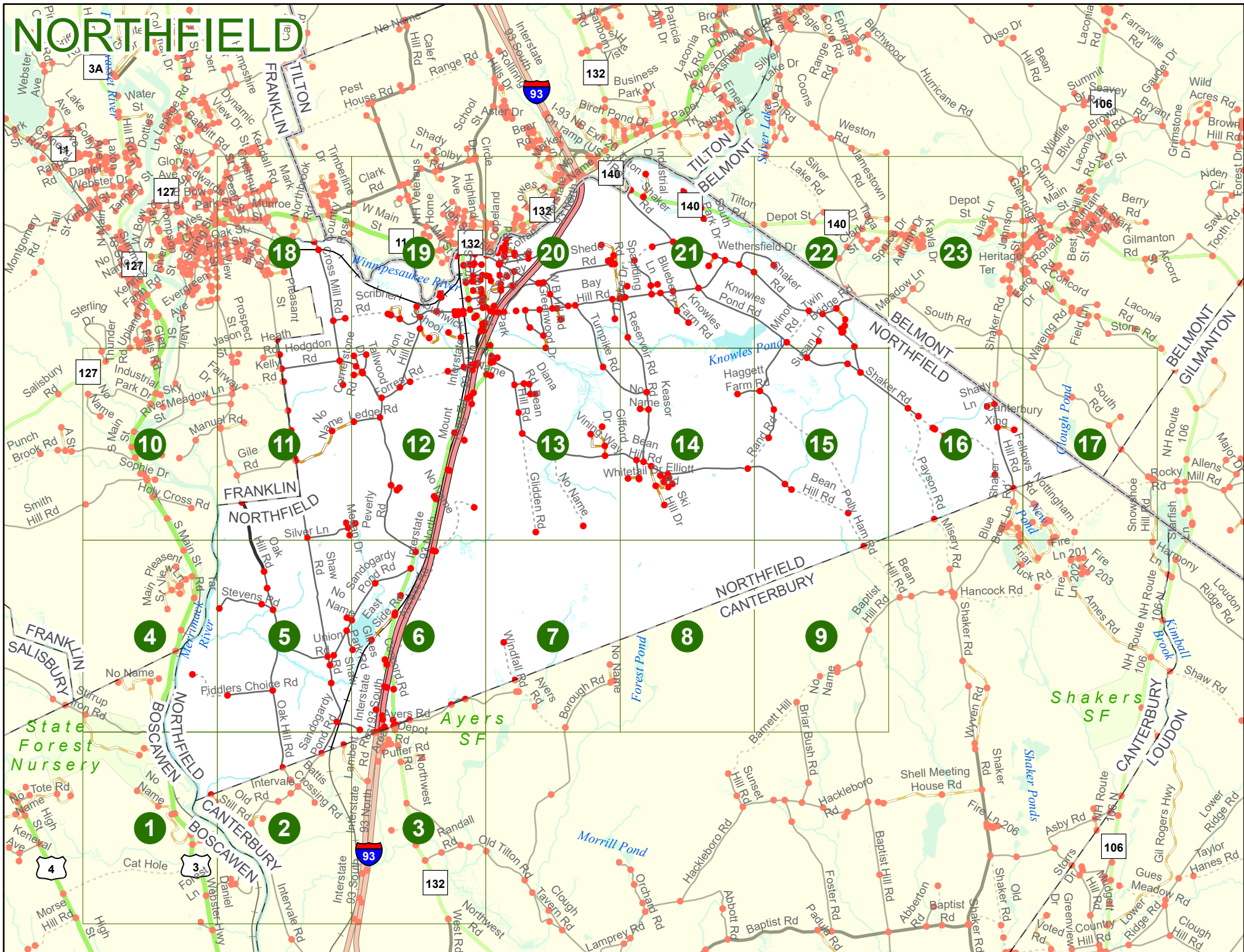

# NORTHFIELD

Match to Page 4

State Forest Nursery

# 1

Match to Page 0

Match to Page 2

Stirrup Iron Rd

NORTHFIELD BOSCAWEN

Merrimack River

NORTHFIELD CANTERBURY

CANTERBURY BOSCAWEN

Old Still Rd

3

Daniel Webster Hwy

Forest Ln

Daniel Webster Hwy

Eastmen Rd

Cat Hole

Wastewater Treatment Access

0102

4

495 990 1980 Feet

Match to Page 0

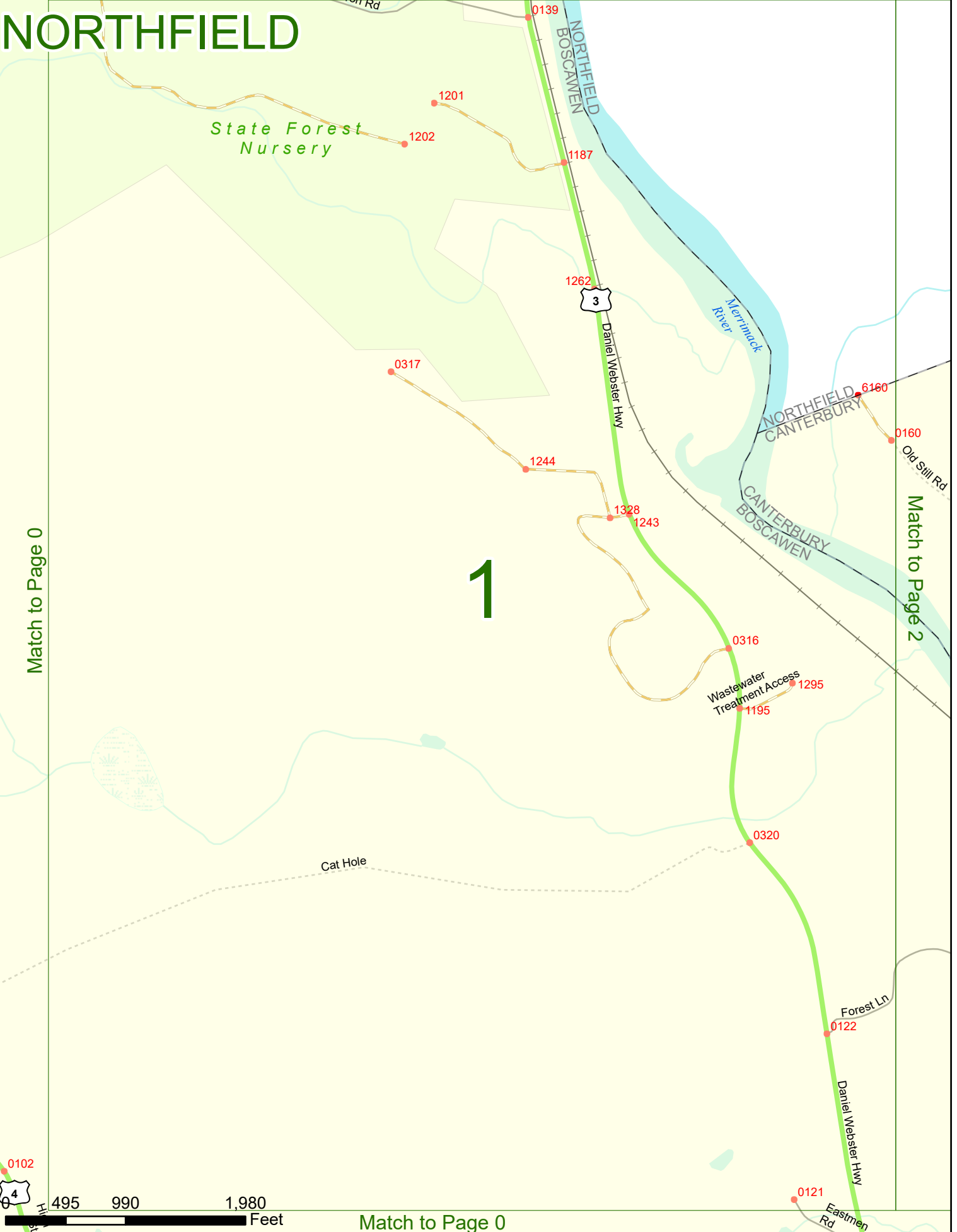

# NORTHFIELD

NORTHFIELD  
CANTERBURY

Oak Hill Rd

Sandogardy Pond Rd

Intervale Rd

Battis Crossing Rd

# 2

Old Still Rd

Merimuck  
River

CANTERBURY  
BOSCAWEN

Intervale Rd

Forest Ln

Deer Run Rd

Daniel Webster Hwy

Crossroads



Match to Page 1

Match to Page 3

495 990 1,980 Feet



6160  
0160

6093

6094

0904

0167

0168

0163

0162

0436

0159

0899

0158

0126

0123

0124

0150

0977

0978

# NORTHFIELD

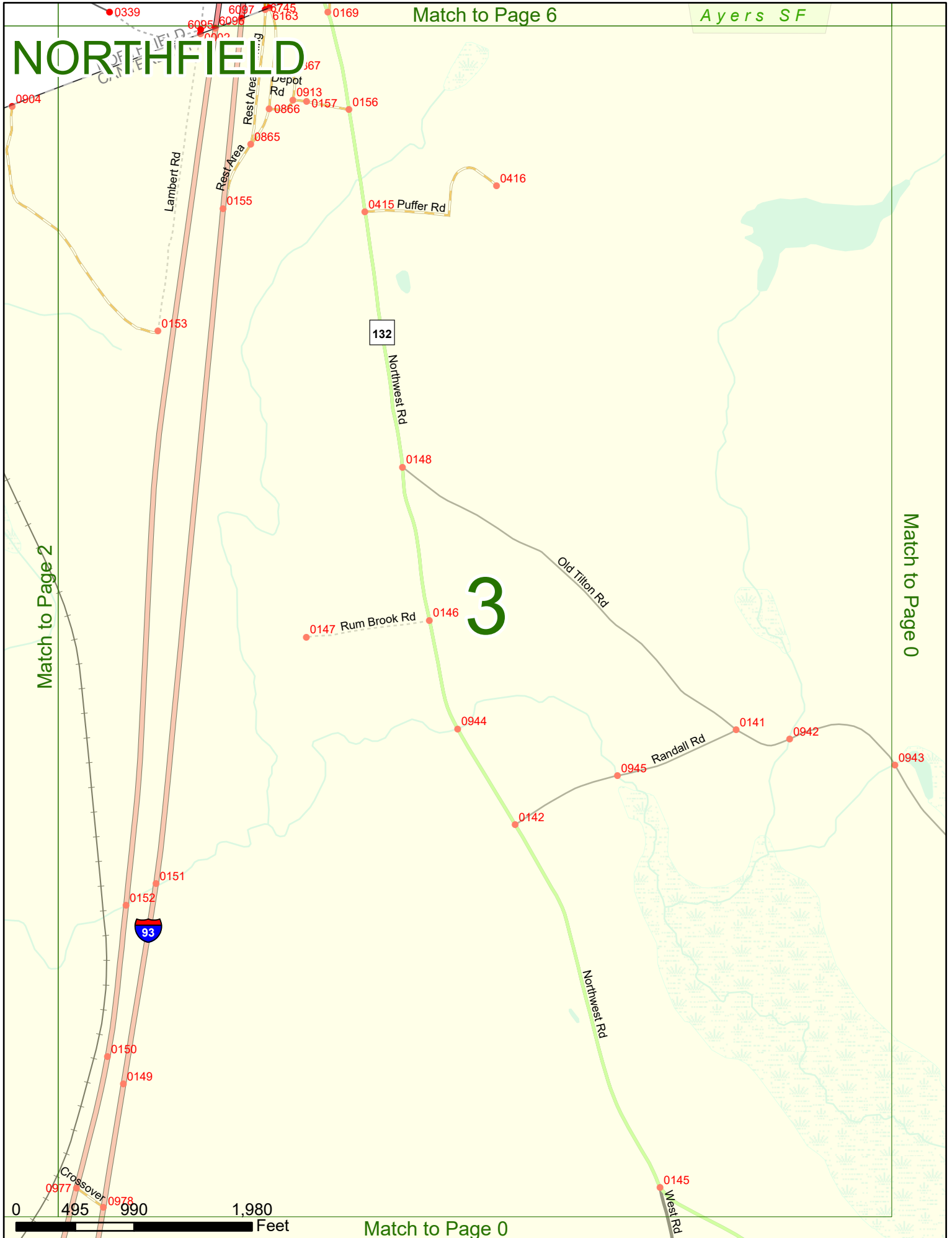

Match to Page 2

Match to Page 0

# 3



Match to Page 0

# NORTHFIELD

Match to Page 0

# 4

Match to Page 5

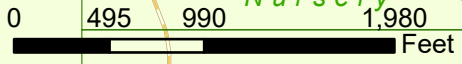
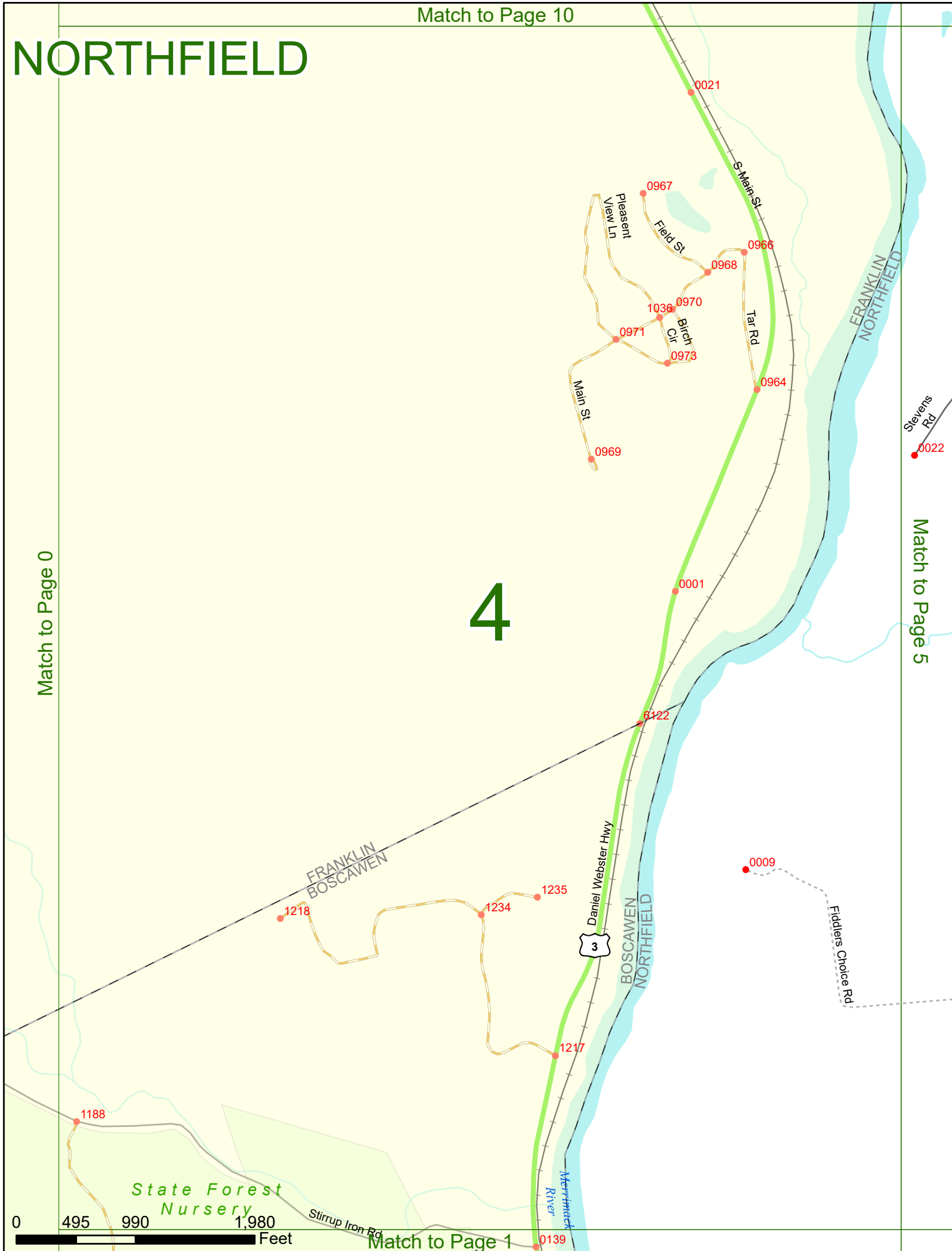

Match to Page 11

# NORTHFIELD

# 5

Match to Page 4

Match to Page 6

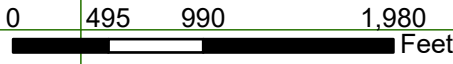
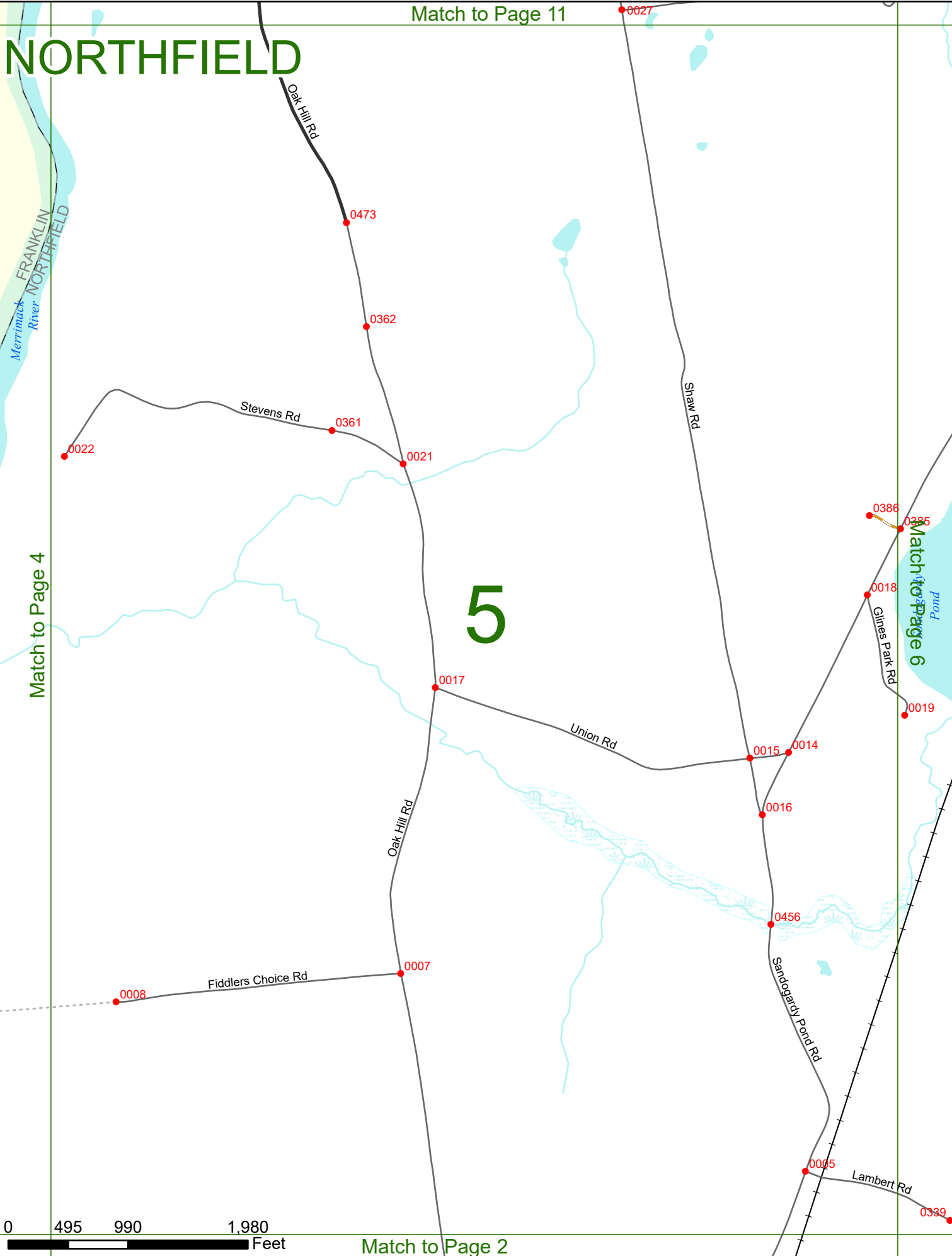

Match to Page 2



# NORTHFIELD

Match to Page 12

Match to Page 7

# 6

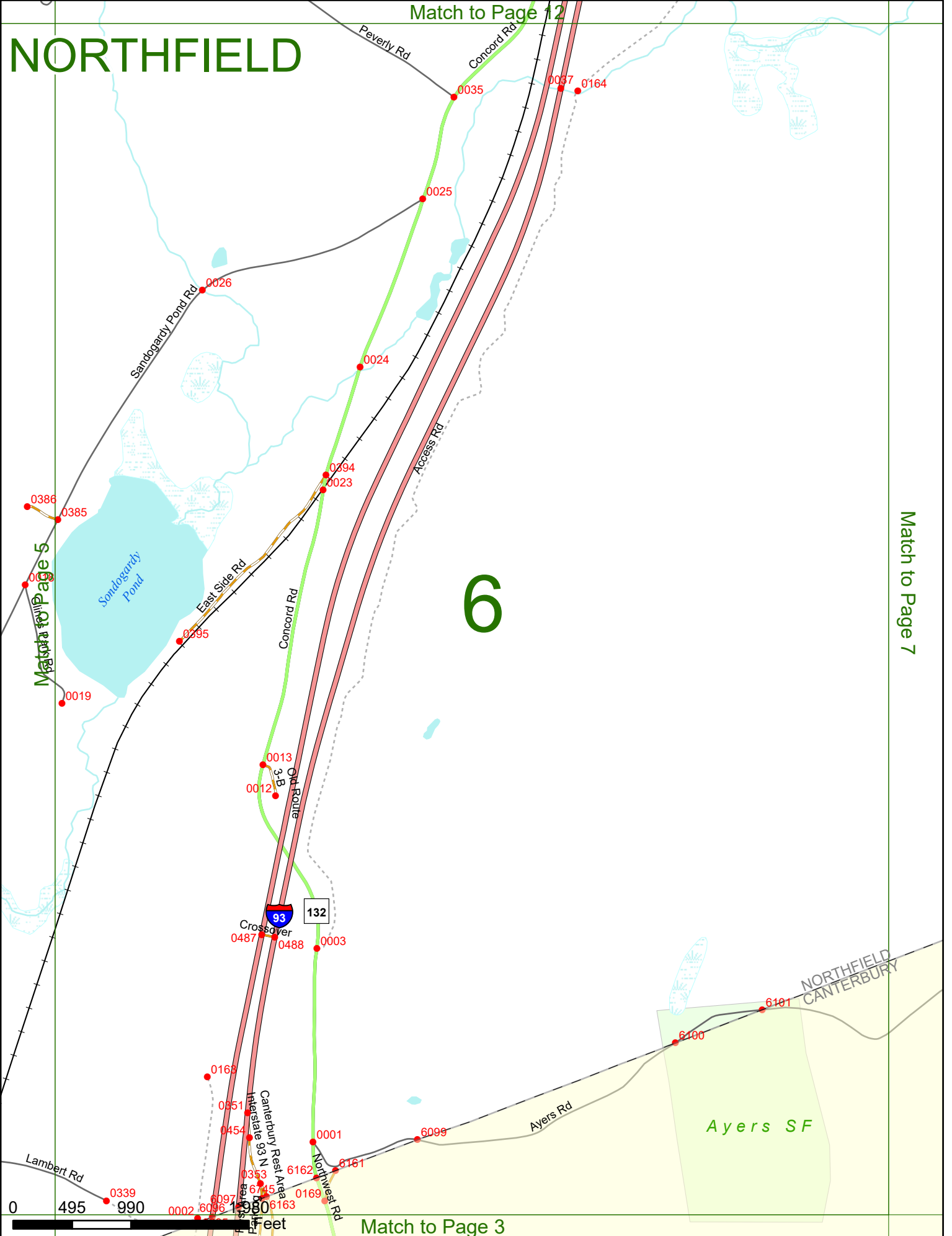

0 495 990 Feet

Match to Page 3

# NORTHFIELD

# 7

Match to Page 6

Match to Page 8

NORTHFIELD  
CANTERBURY

Windfall Rd

Borough Rd

Ayers Rd

0340

6182

0438

0170

0941

0172

0420

0173

0419

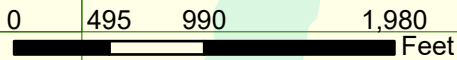

Match to Page 0

# NORTHFIELD

NORTHFIELD  
CANTERBURY

8

Match to Page 7

Match to Page 9

*Forest Pond*

0173

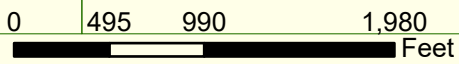

Match to Page 0

Match to Page 15

# NORTHFIELD

NORTHFIELD  
CANTERBURY

Polly  
Hart Rd  
6103

Bear Hill Rd

# 9

Baptist Hill Rd  
0934

Match to Page 0

Match to Page 8

0175

0871  
0870

0174

Briar Bush Rd

0959

Barnett Hill

0 495 990 1,980 Feet

Match to Page 0

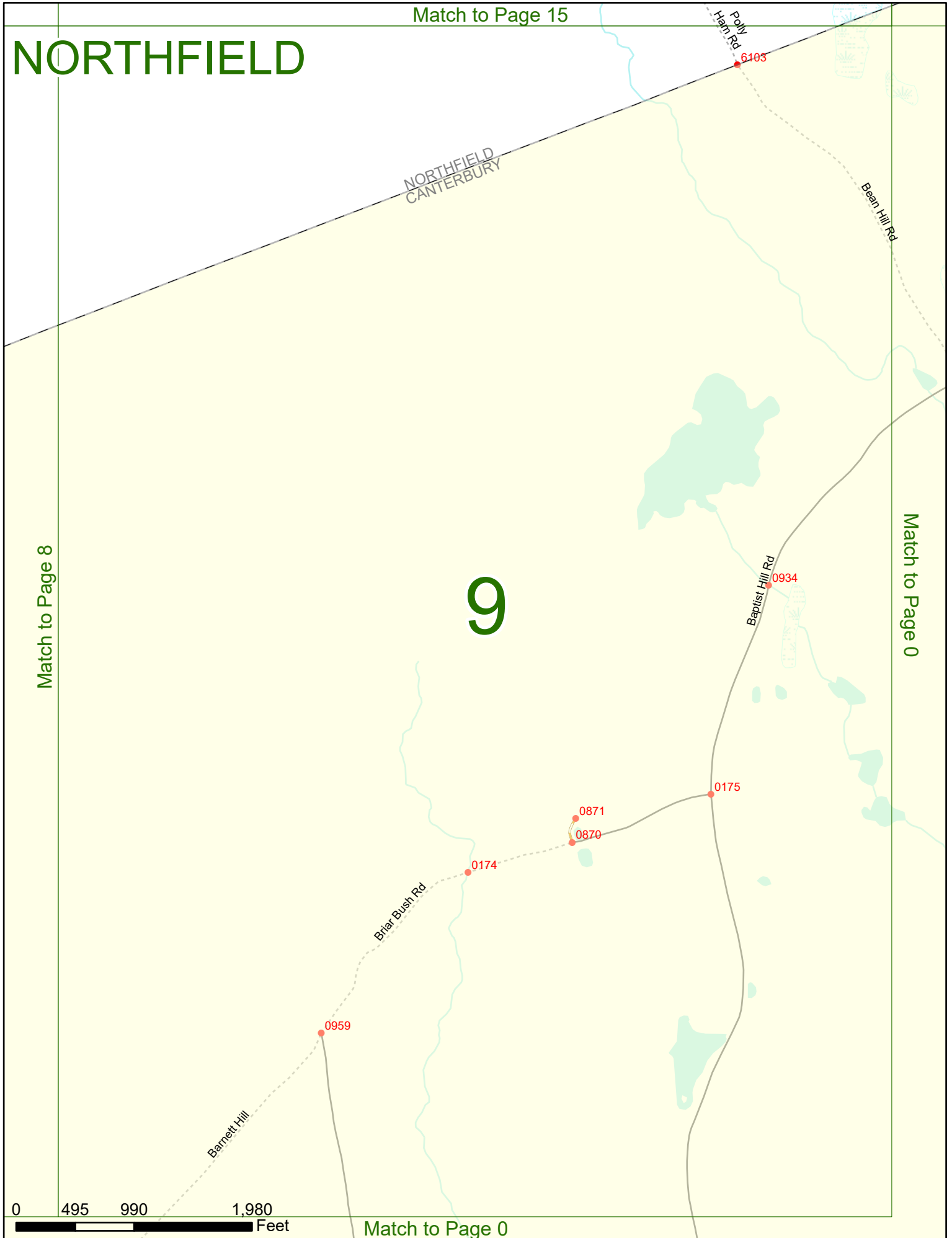

# NORTHFIELD

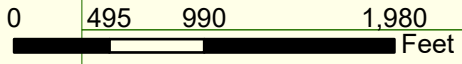
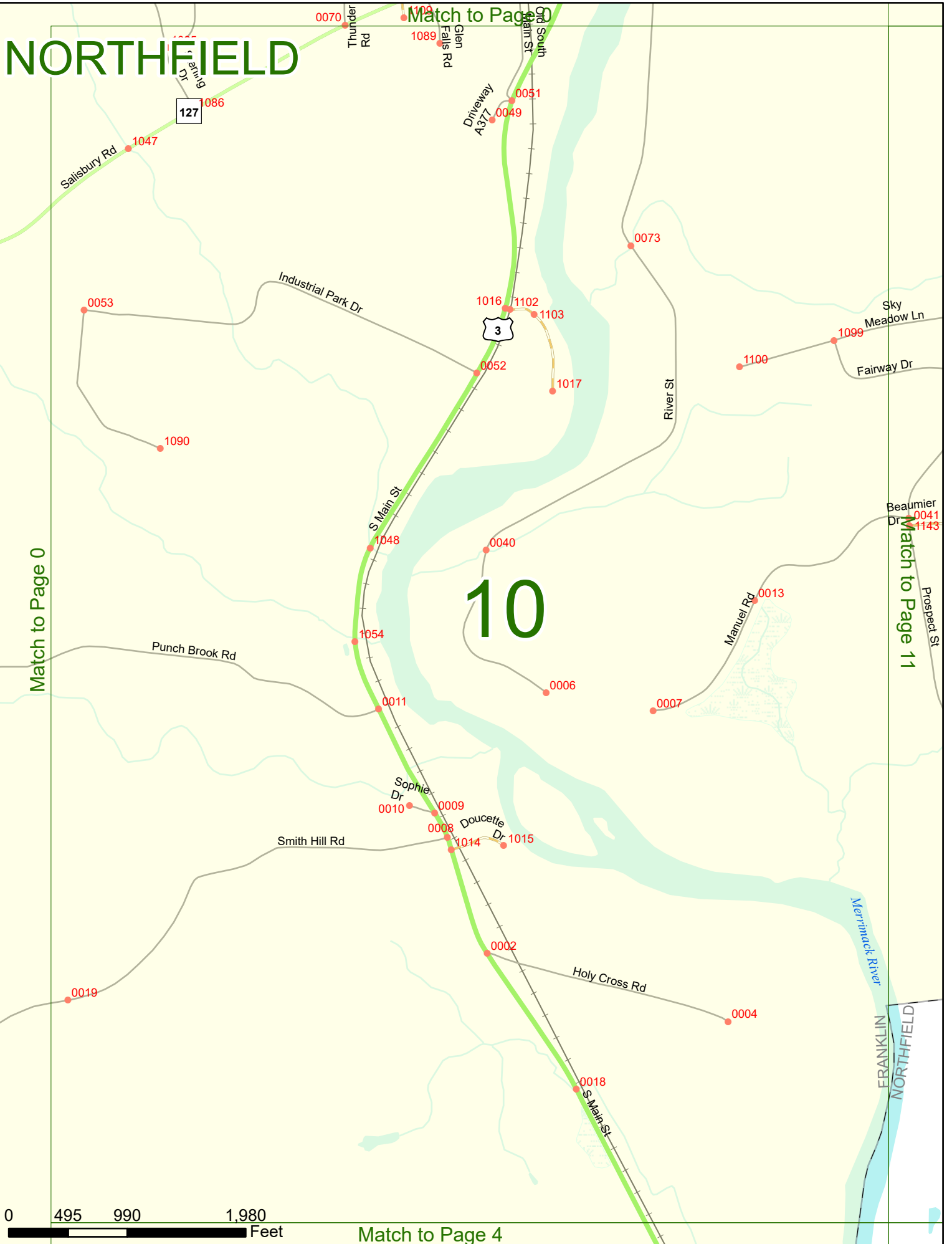

Match to Page 4

# NORTHFIELD

Match to Page 18

# 11

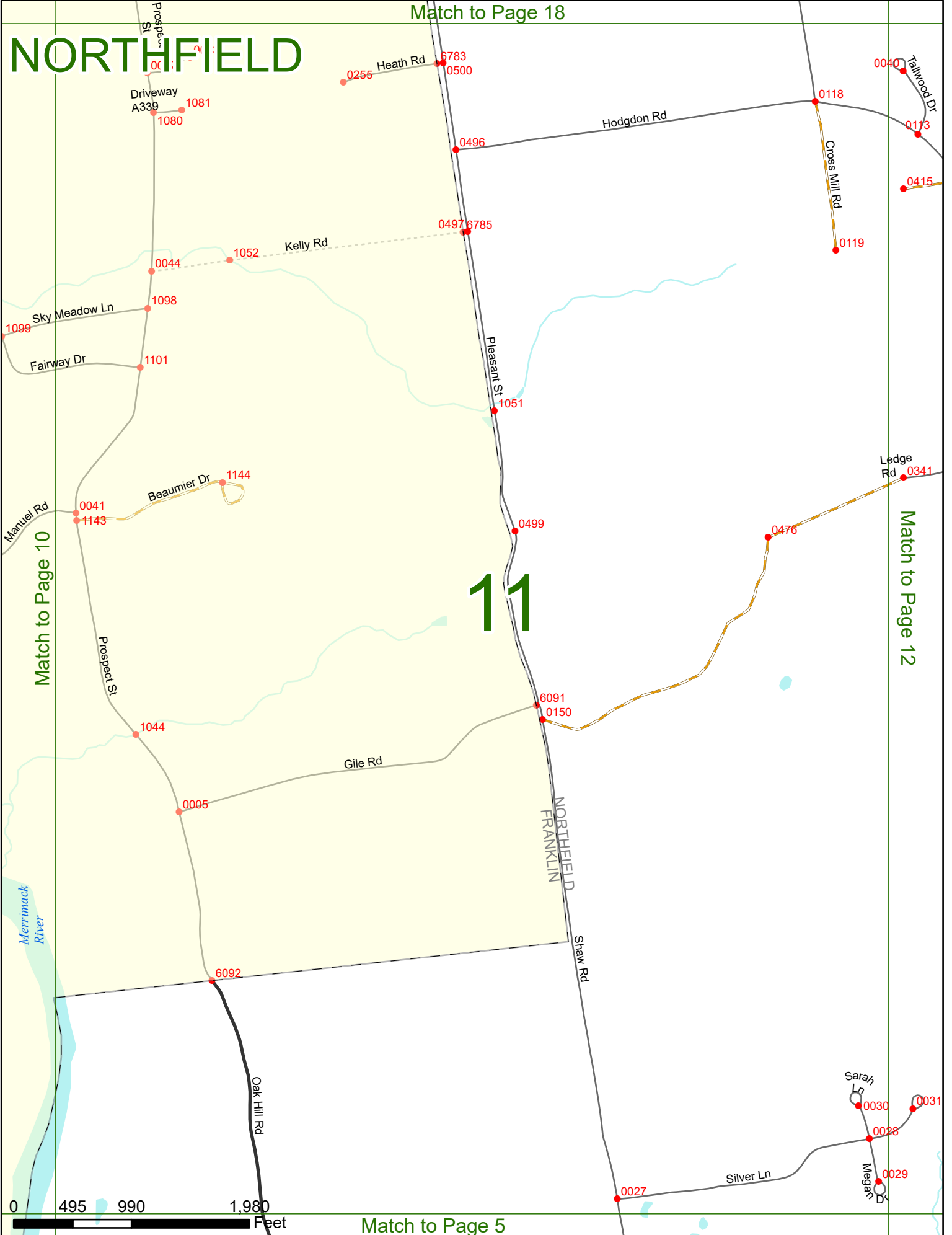

Match to Page 5

Match to Page 19

# NORTHFIELD

# 12

Match to Page 11

Match to Page 13

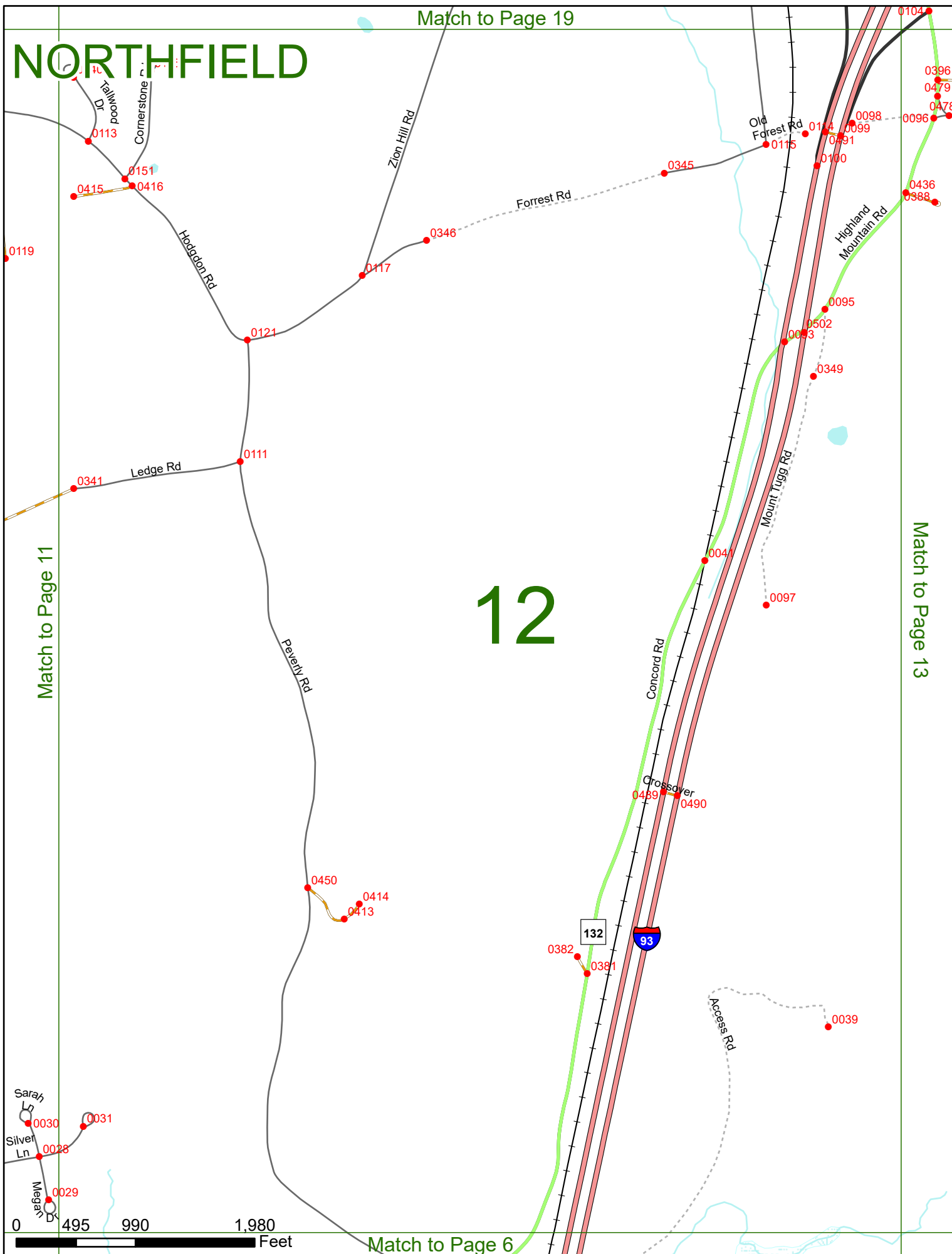

Match to Page 6

# NORTHFIELD

Match to Page 20

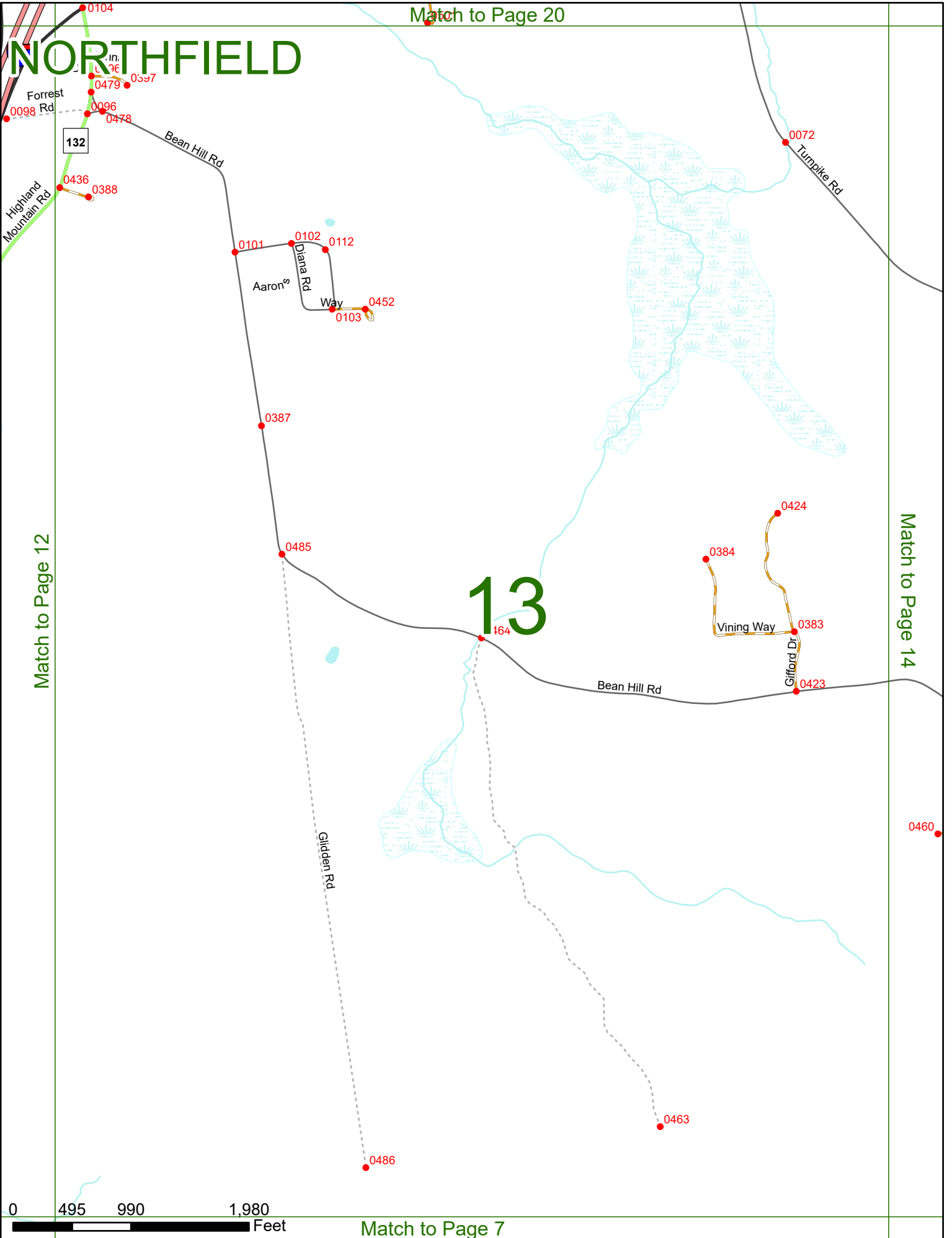

Match to Page 12

Match to Page 14

# 13

0 495 990 1,980 Feet

Match to Page 7



Knowles Pond

# NORTHFIELD

# 14

Match to Page 13

Match to Page 15

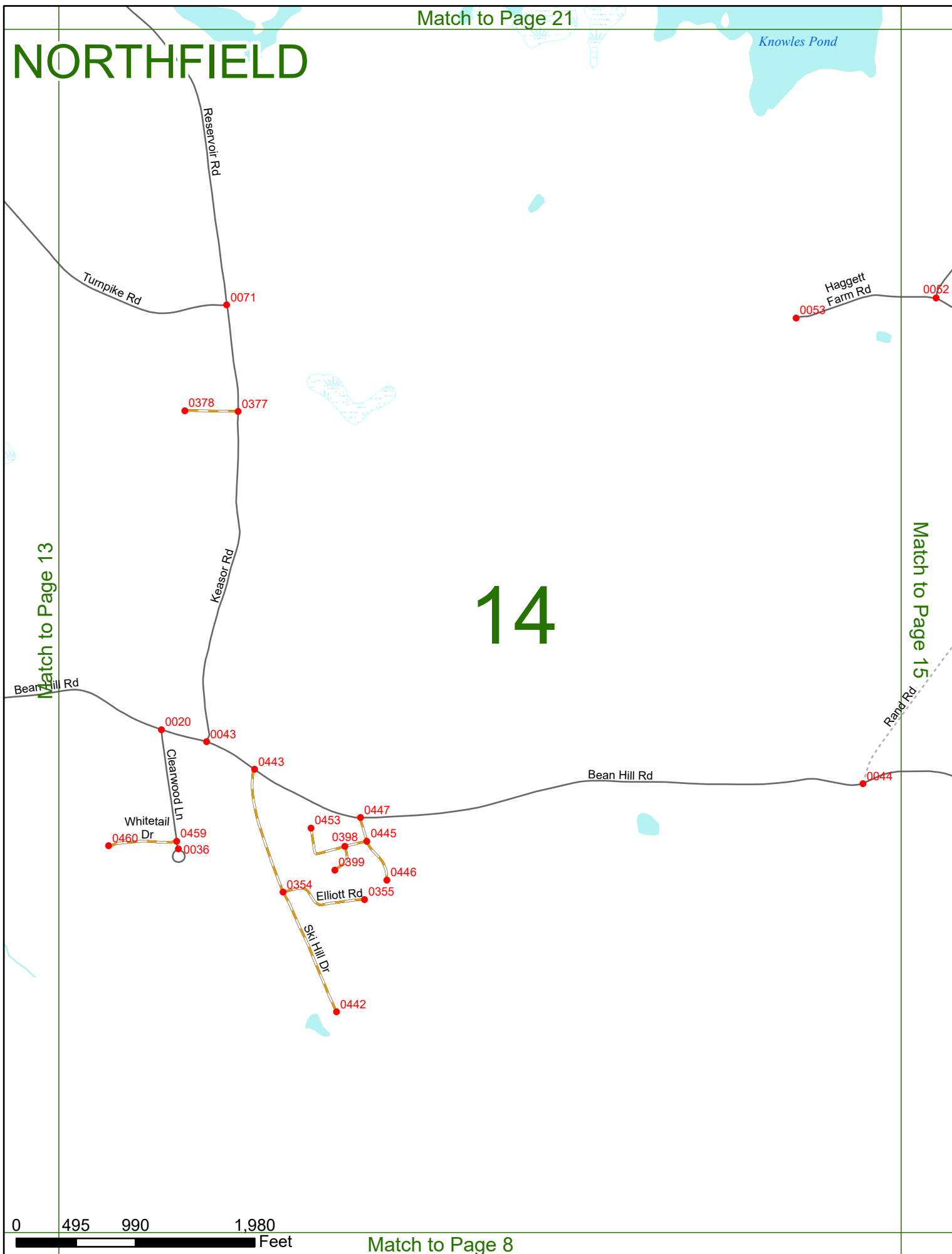

0 495 990 1,980 Feet

# NORTHFIELD

Match to Page 22

# 15

Match to Page 16

Match to Page 14

Match to Page 9

Haggett Farm Rd

Bean Hill Rd

Susan Ln

Knowles Pond Rd

Shaker Rd

Rand Rd

Rand Rd

Polly Horn Rd

Bean Hill Rd

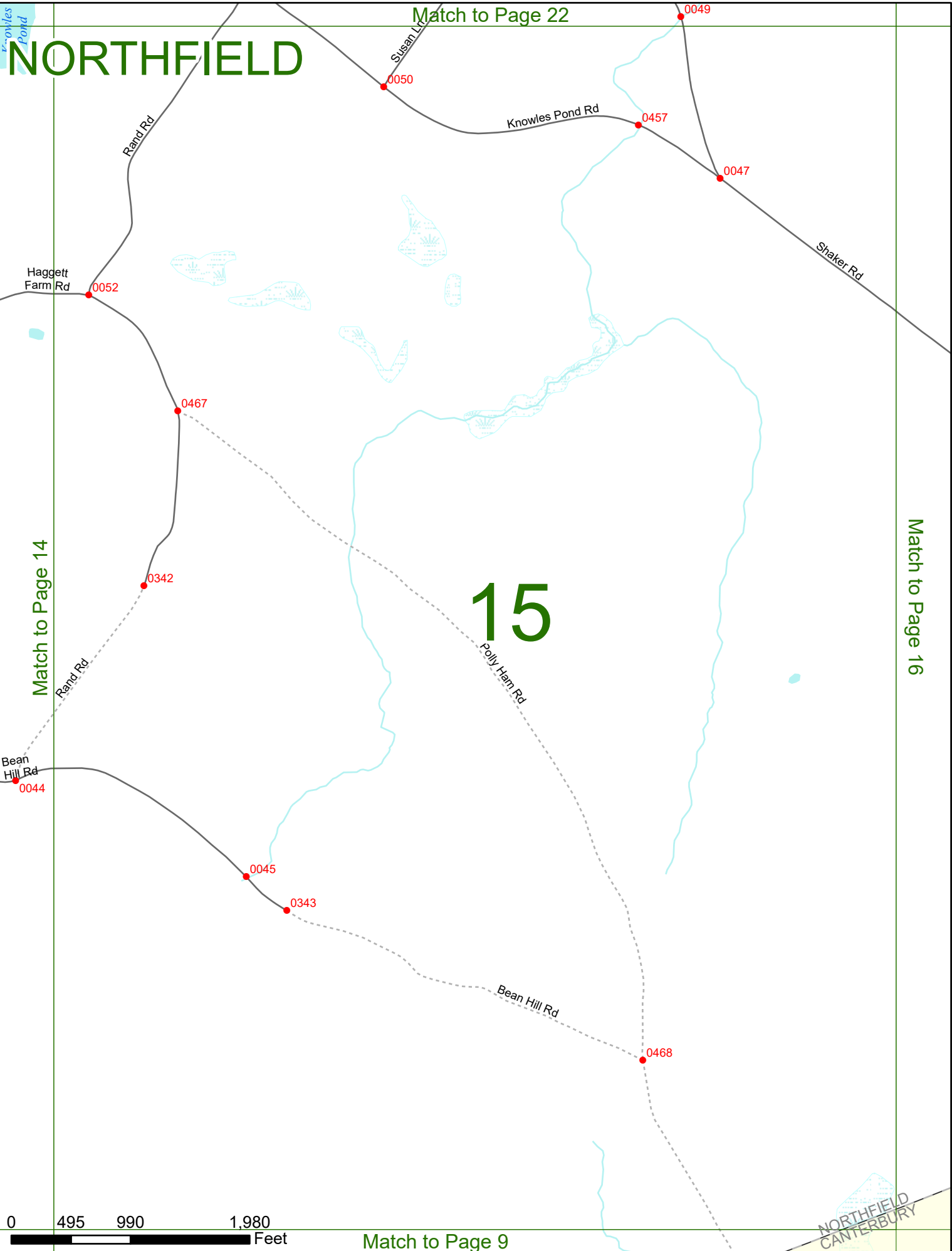
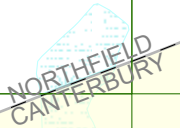
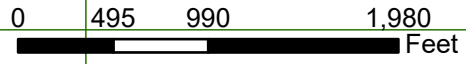

# NORTHFIELD

Match to Page 15

Match to Page 17

# 16

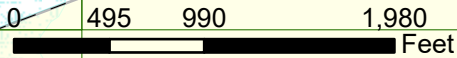
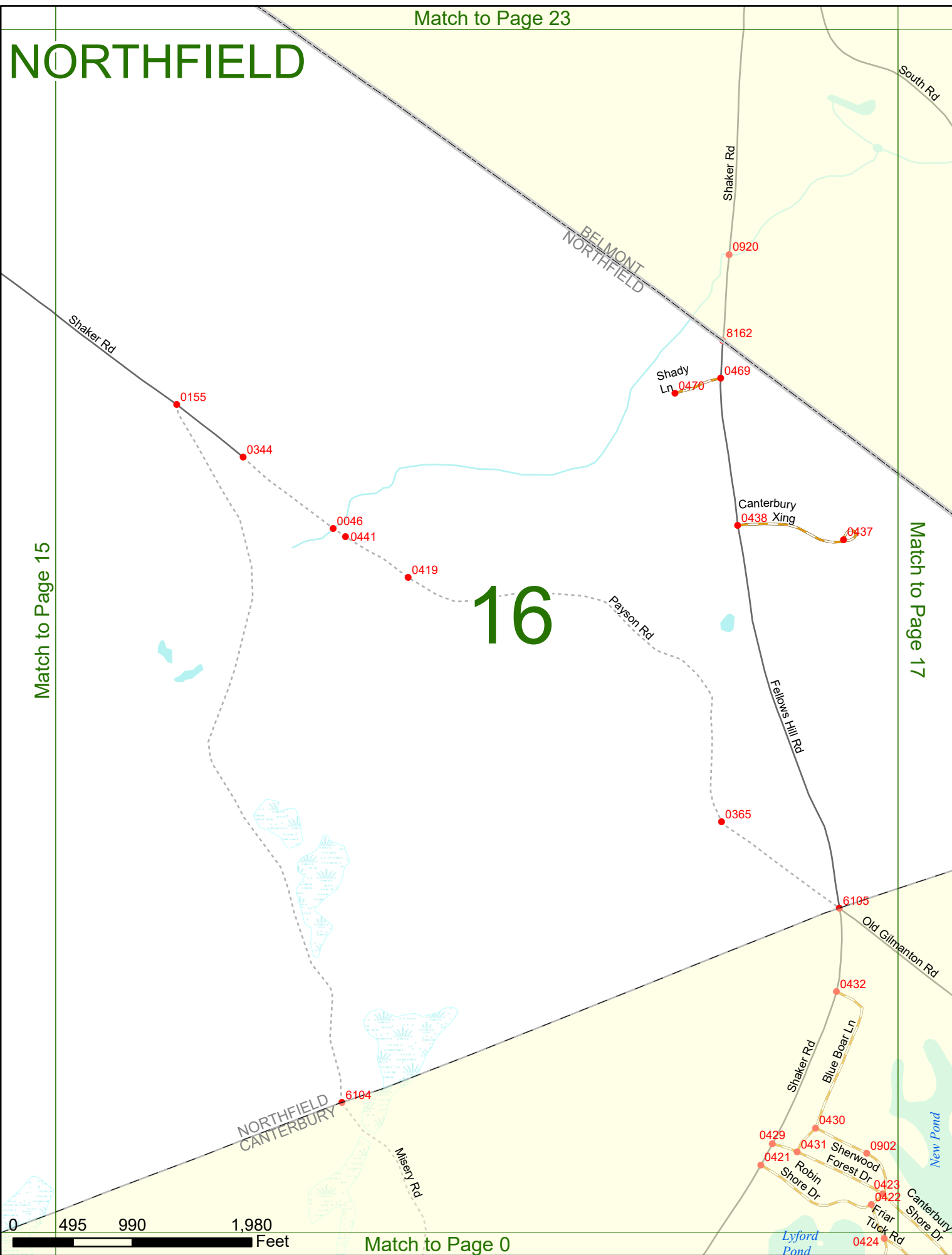

Match to Page 0

# NORTHFIELD

Stone Rd  
0008 106

Water

0005

South Rd

0003

Clough Pond

0002

0001

Watson Rd

BELMONT  
GILMANTON

Match to Page 0

# 17

Match to Page 16

BELMONT  
NORTHFIELD

6284

South Rd

NORTHFIELD  
CANTERBURY

BELMONT  
CANTERBURY

0016

0597

0258

8295

GILMANTON  
CANTERBURY

Blue Boat Ln

0440

0428

Old Gilmanton Rd

0869

0920

0984

Fire Lane 200

0868

Nottingham Rd

0902

0423

0422

990

1,980

0983

0427

0922

Snowshoe Hill Rd

0191

Harmony Ln

8801

0970

Rocky Pond

0424

Match to Page 0

Feet

0424

Match to Page 0

# NORTHFIELD

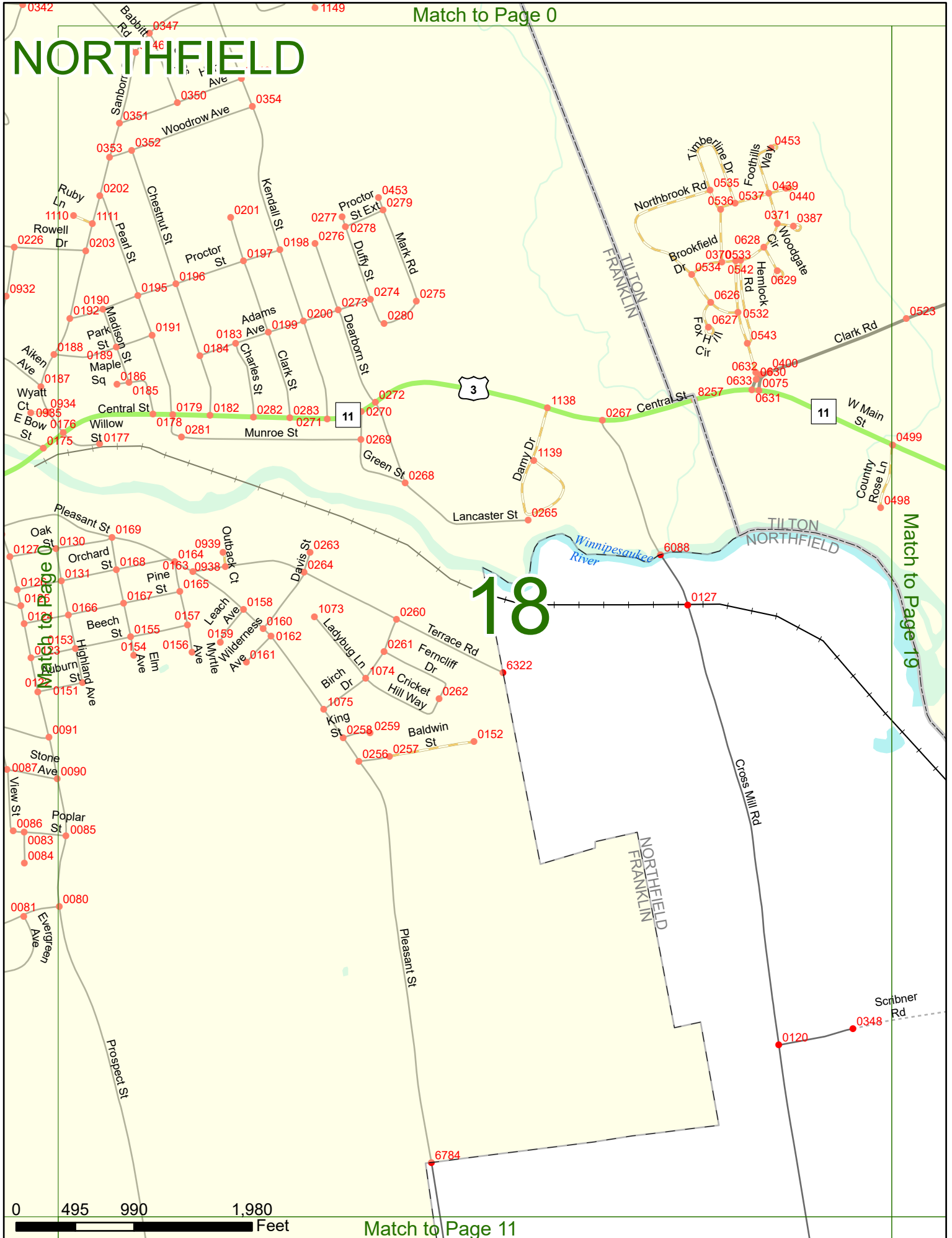

# 18

0 495 990 1,980 Feet

Match to Page 11

# NORTHFIELD

Match to Page 9

Match to Page 18

Match to Page 20

# 19

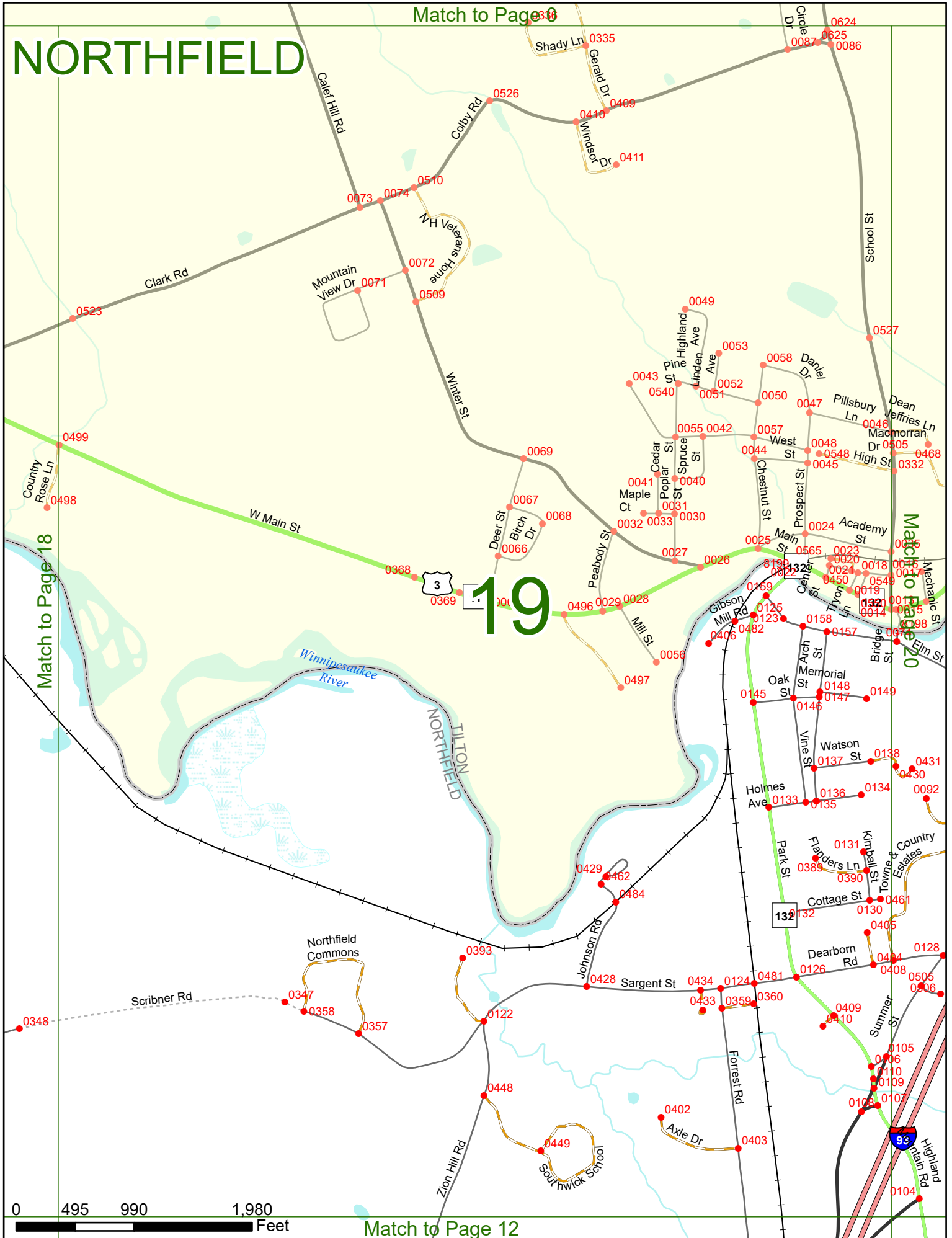

Match to Page 12

# NORTHFIELD

Match to Page 0

Match to Page 21

# 20

Match to Page 13

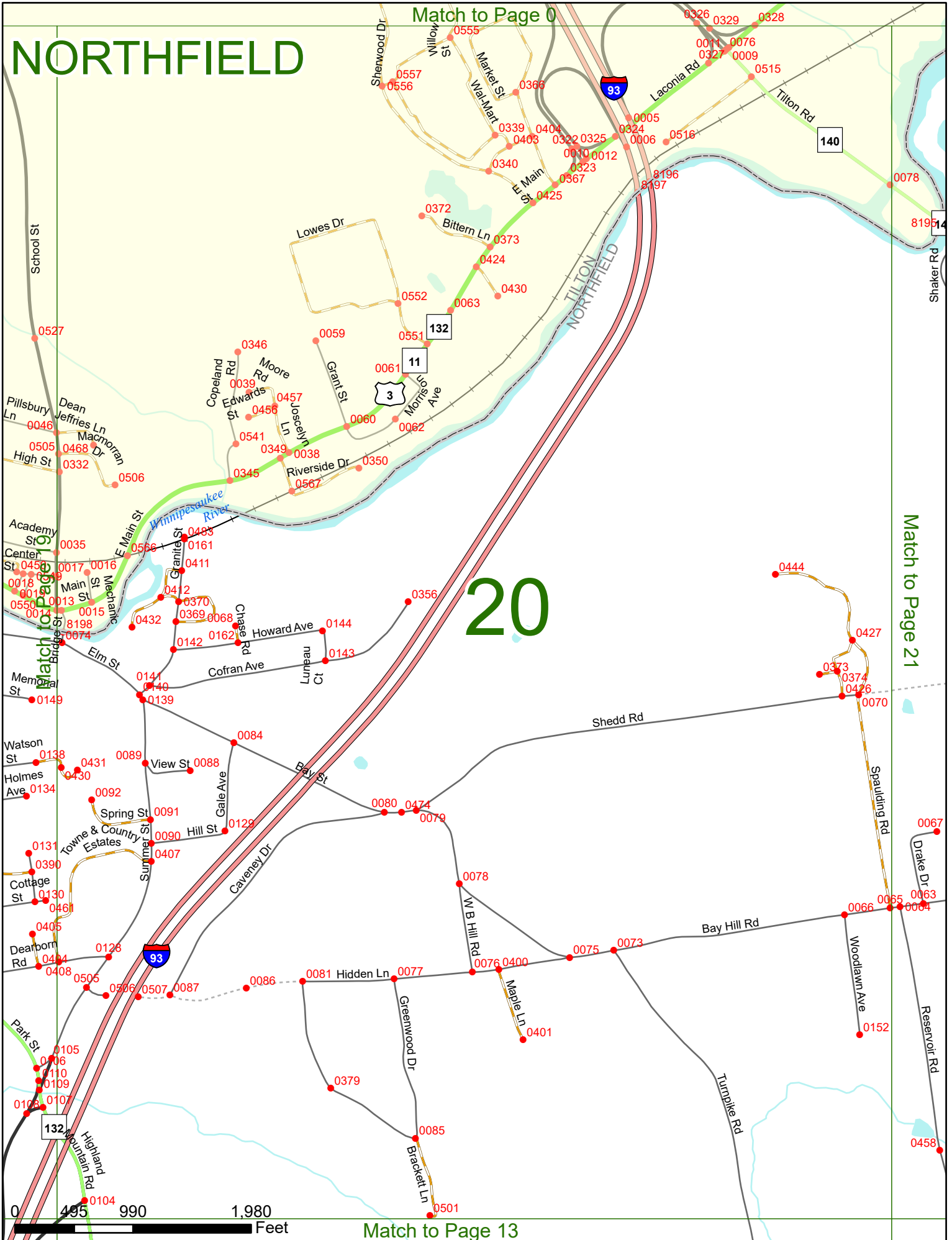

# NORTHFIELD

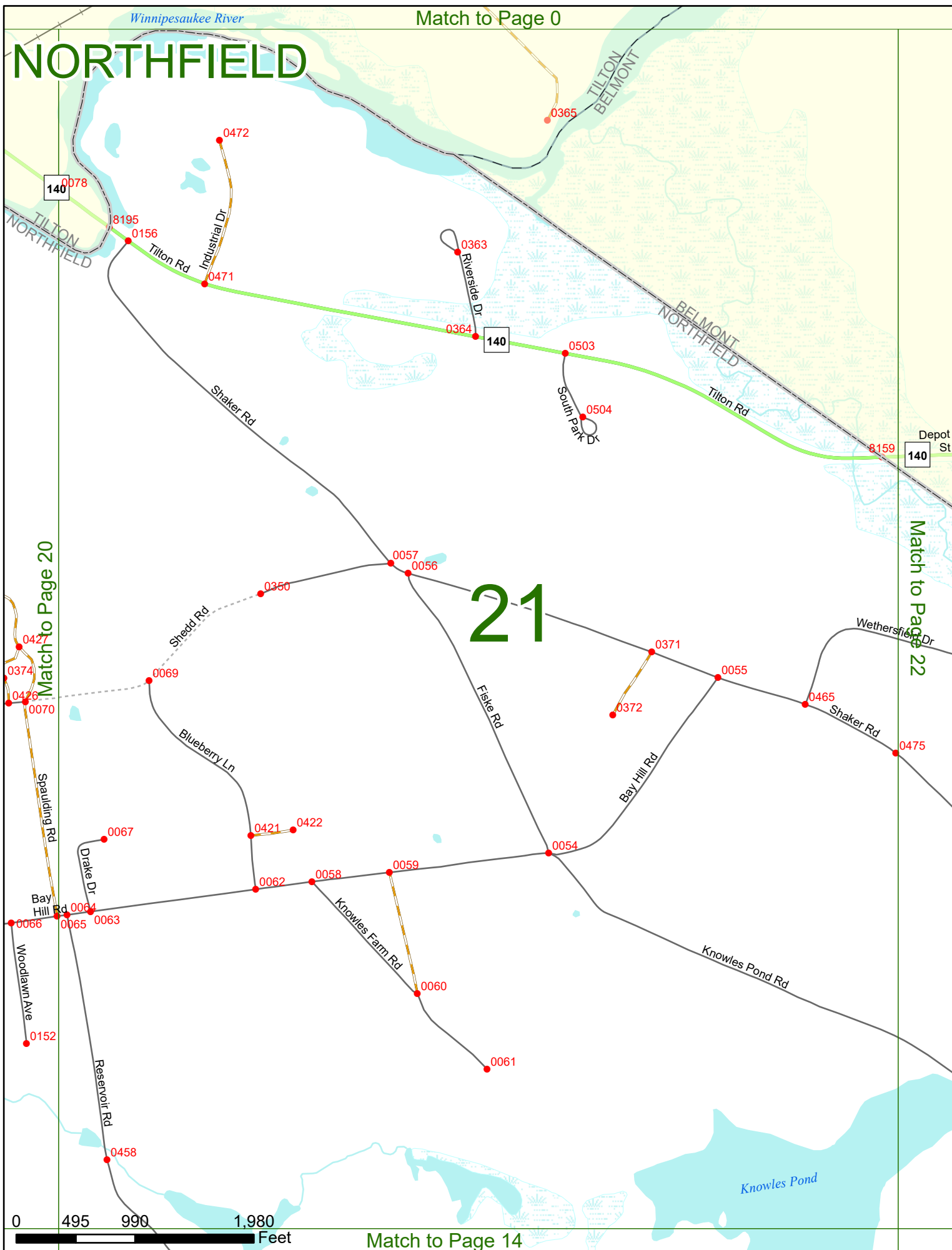

# 21





# NORTHFIELD

# 22

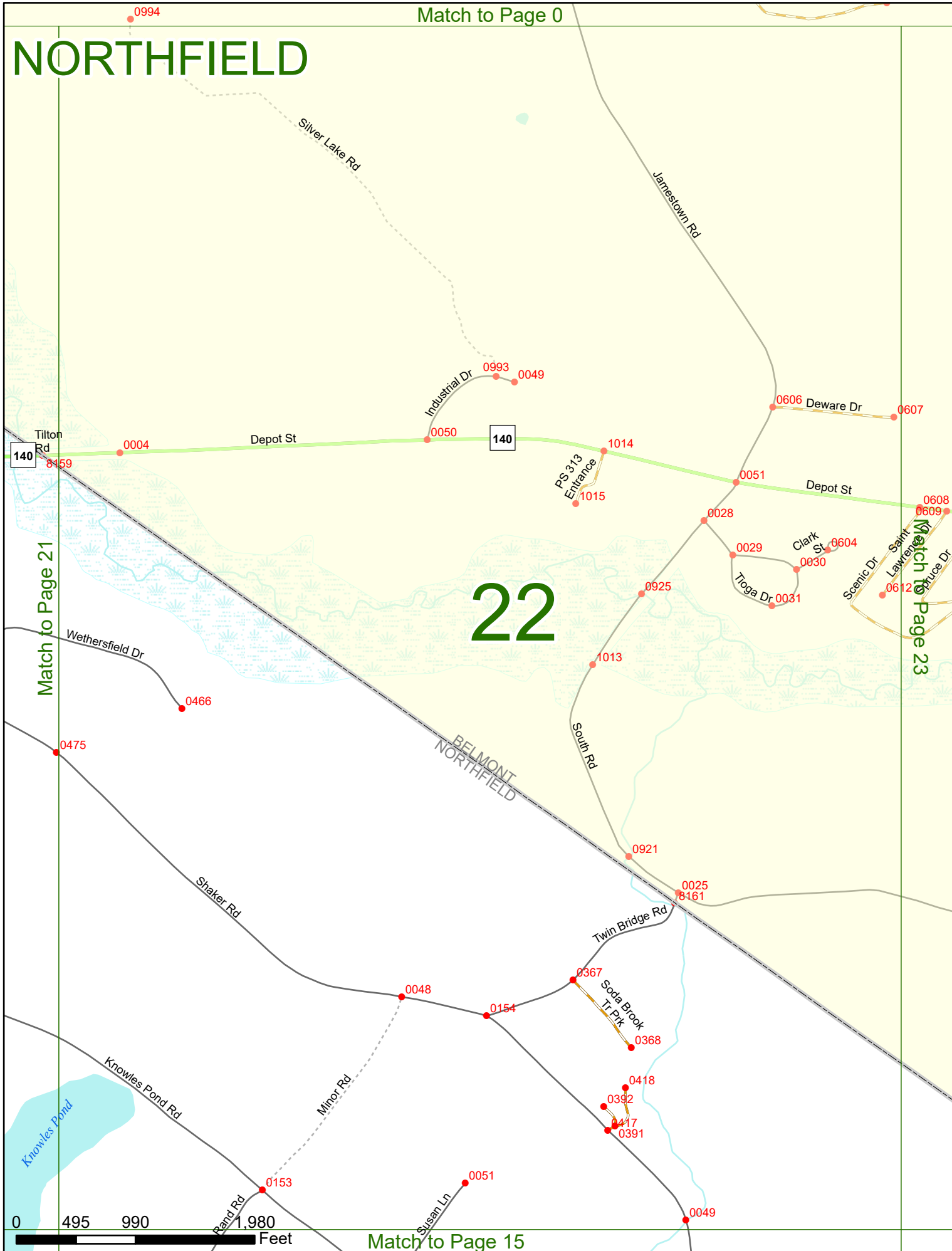

Match to Page 21

Match to Page 23



Match to Page 15

# NORTHFIELD

# 23

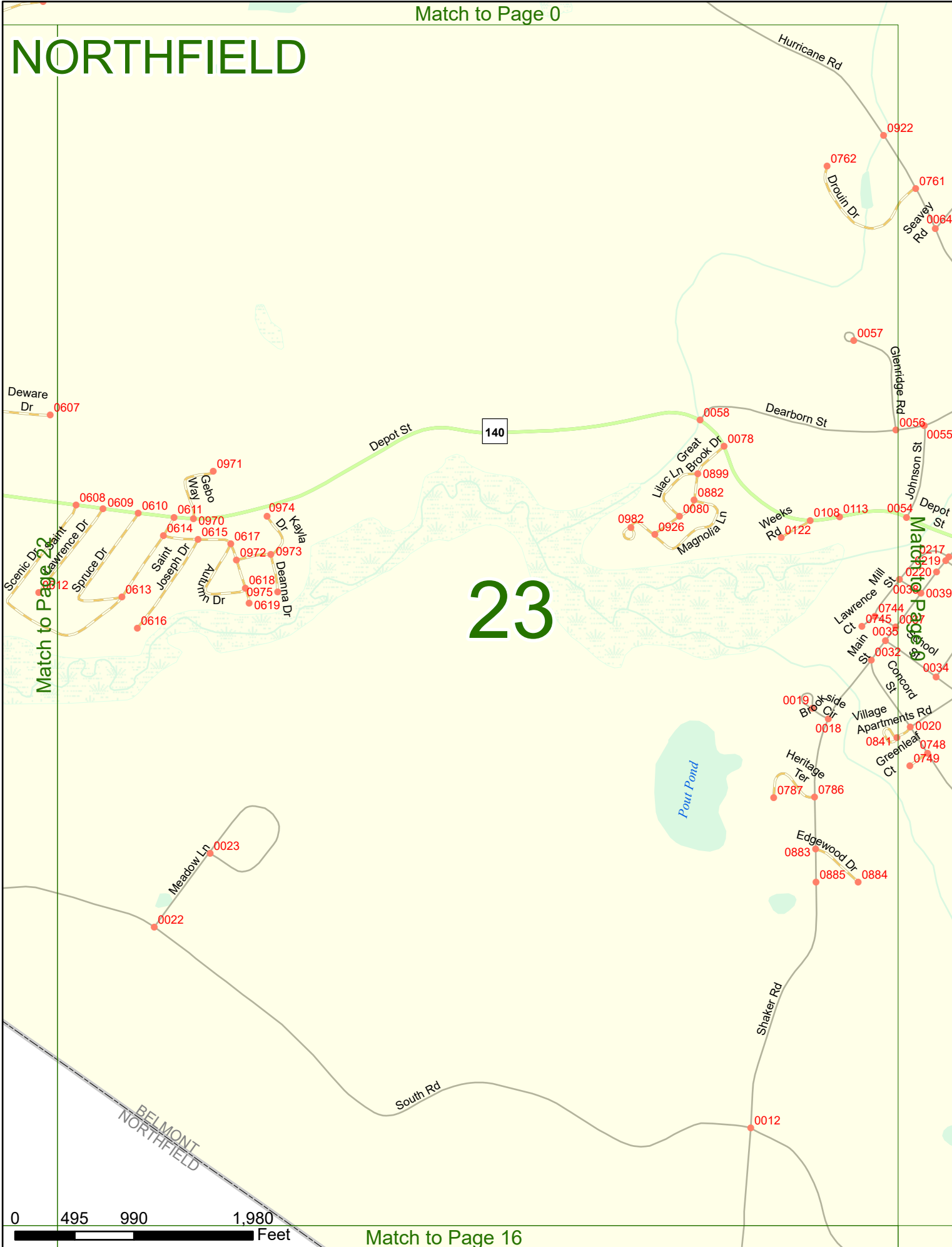

Match to Page 22

Match to Page 24

