

New Hampshire
DOT
Department of Transportation

Maps and data sets are not guaranteed to be free from errors and omissions. Data is in a constant state of update and correction by various groups and agencies. Information displayed on this map is the best available at the time of publication.

2023 Nodal Reference Bookmap

LEGEND



NHDOT will accept crash locations based on the State of NH Uniform Police Traffic Accident Report.

Crash occurred on:

Option 1 Street Address
 123 Main Street

Option 2 Route No and/or Distance from NESW Intesecting Road, Bridge,
 Street name Intersecting Street Town/County line
 Main Street 500 E Oak Street

Option 3 First Node Distance from First Node Second Node
 515 212 632

Option 4 Route No and/or Mile Marker on Interstate Only NESW Mile (Marker)
 Street name
 189S 700 feet S 36.8

Option 3 – Example

Street Name Loudon Road
First Node 803
Distance from First Node 318 Ft
Second Node 813



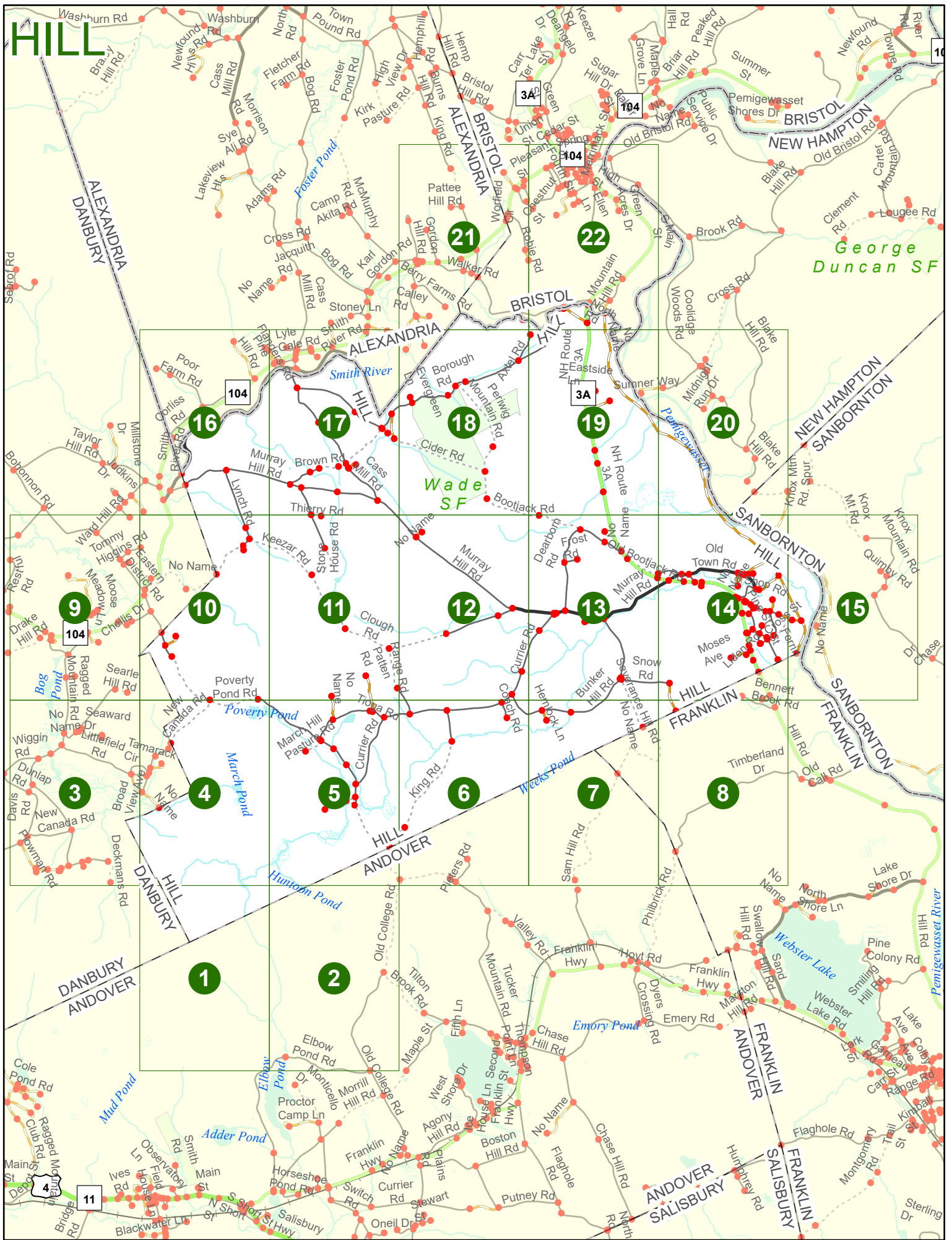

Match to Page 4

HILL

HILL
DANBURY

HILL
ANDOVER

DANBURY
ANDOVER

Match to Page 0

Match to Page 2

1

0 495 990 1,980 Feet

Match to Page 0

Elbow Pond Rd

Elbow Pond

HILL

Match to Page 5

HILL
ANDOVER
Huntoon Pond



2

Match to Page 1

Match to Page 0

Old College Rd

0206

Tilton Brook Rd

Old College Rd

Elbow Pond Rd

0124

0123

Maple
St
0656

0 495 990 1,980 Feet

Elbow Pond

Match to Page 0

Match to Page 9

HILL

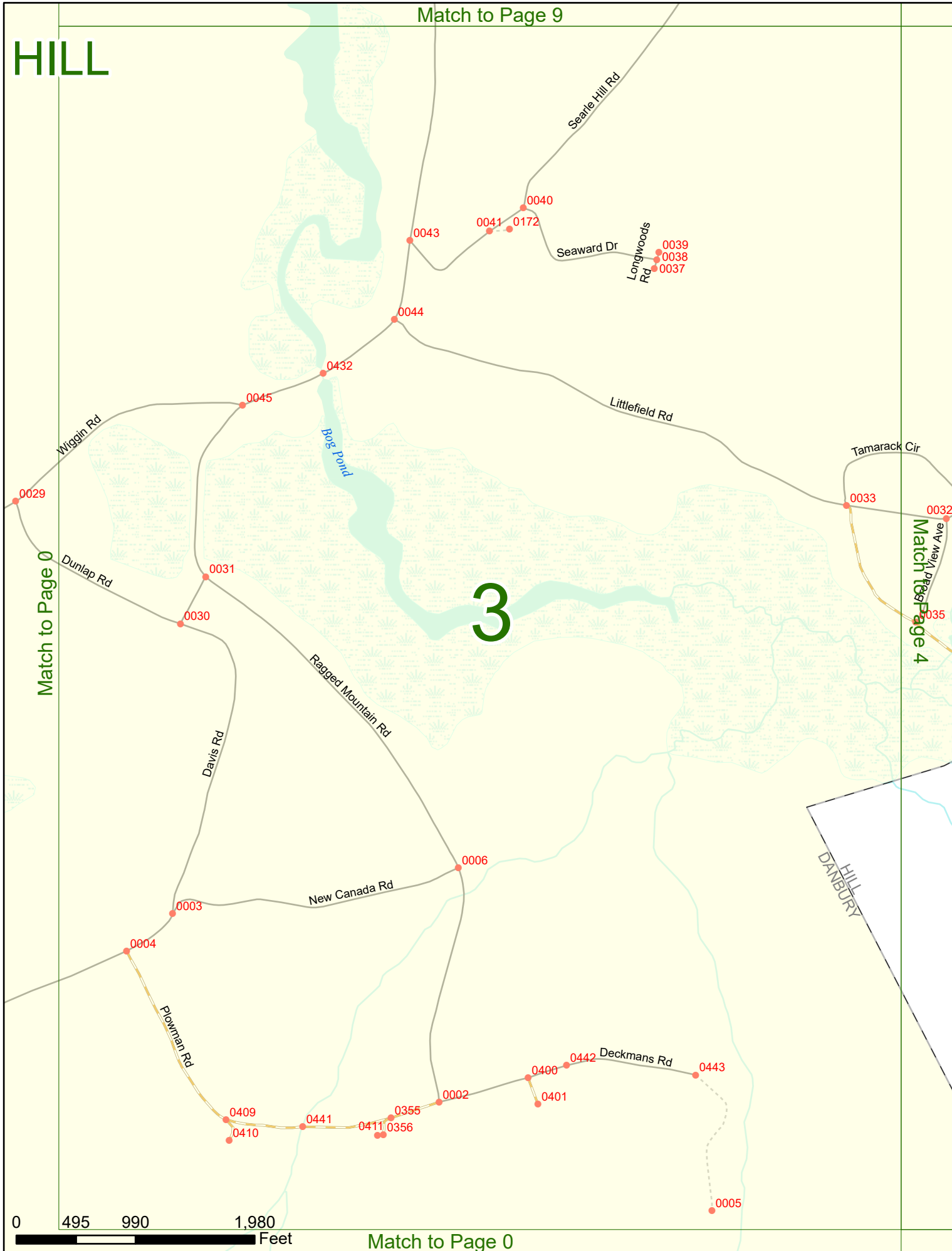

Match to Page 0

Match to Page 4

3

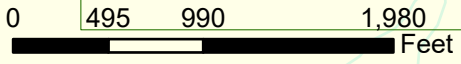

Match to Page 0

Match to Page 10

HILL

0321

Poverty Pond Rd

Poverty Pond

New Canada Rd

6044

0444

0440

0010
0008
Reed Hill Rd

Tamarack Cir

HILL
DANBURY

0034

0032

0033

Broad View Ave

0035

Match to Page 3

6751

4

March Pond

Match to Page 5

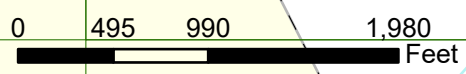

Match to Page 1

Match to Page 11

HILL

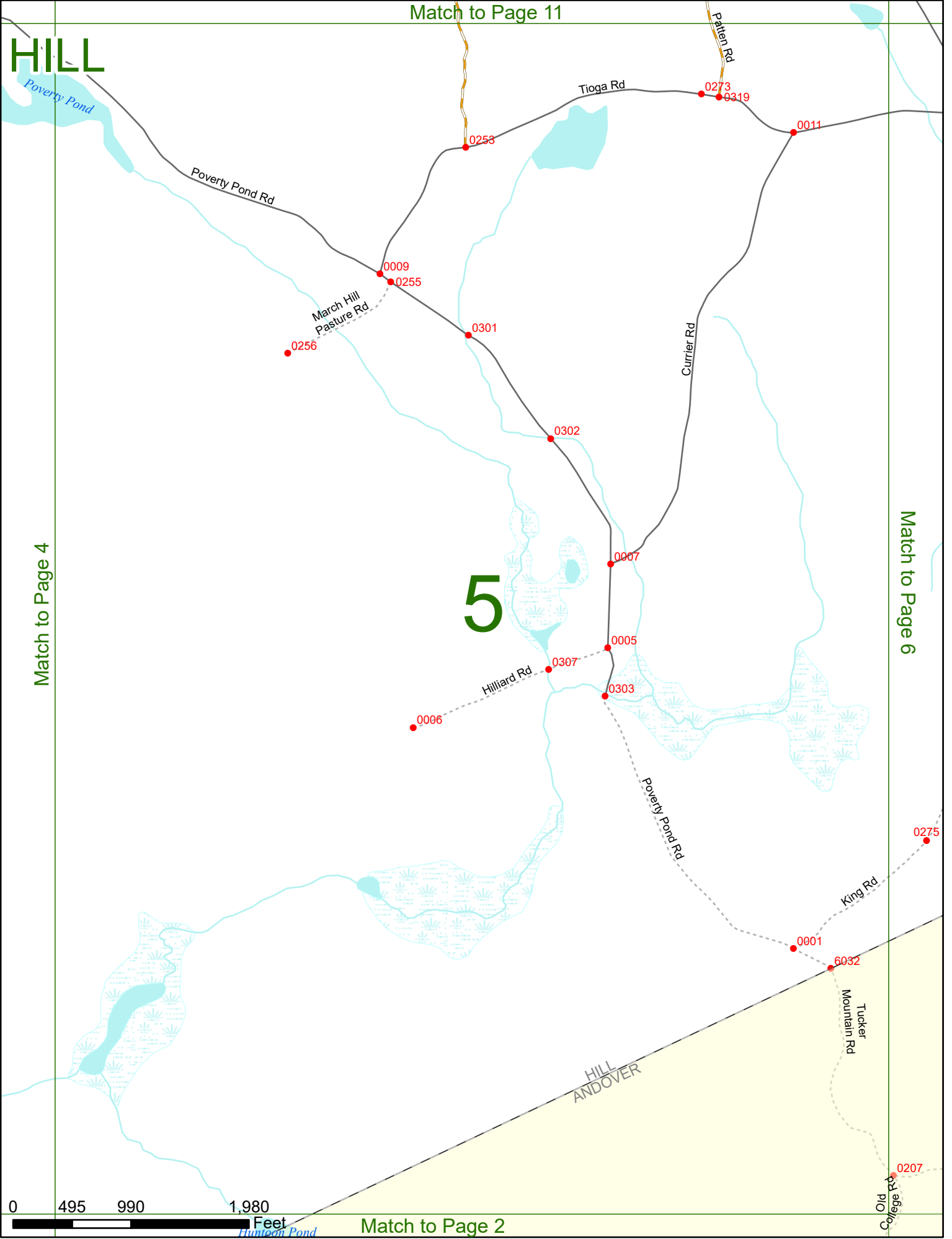

Match to Page 4

Match to Page 6

5

0 495 990 1,980

Feet

Match to Page 2

Hunter Pond

Old College Rd

Tucker Mountain Rd

HILL ANDOVER

King Rd

Poverty Pond Rd

Hilliard Rd

Currier Rd

Tioga Rd

Patten Rd

Poverty Pond

Poverty Pond Rd

March Hill Pasture Rd

Match to Page 12

HILL

Range Rd

Bunker Hill Rd

Currier Rd

Coach Rd

0014

0015

0257

0258

0016

King Rd

6

Match to Page 5

Match to Page 7

HILL ANDOVER

0275

0235

Pieters Rd

Tucker Mountain Rd

0207

0671

0234

0 995 1,980 Feet

Match to Page 0

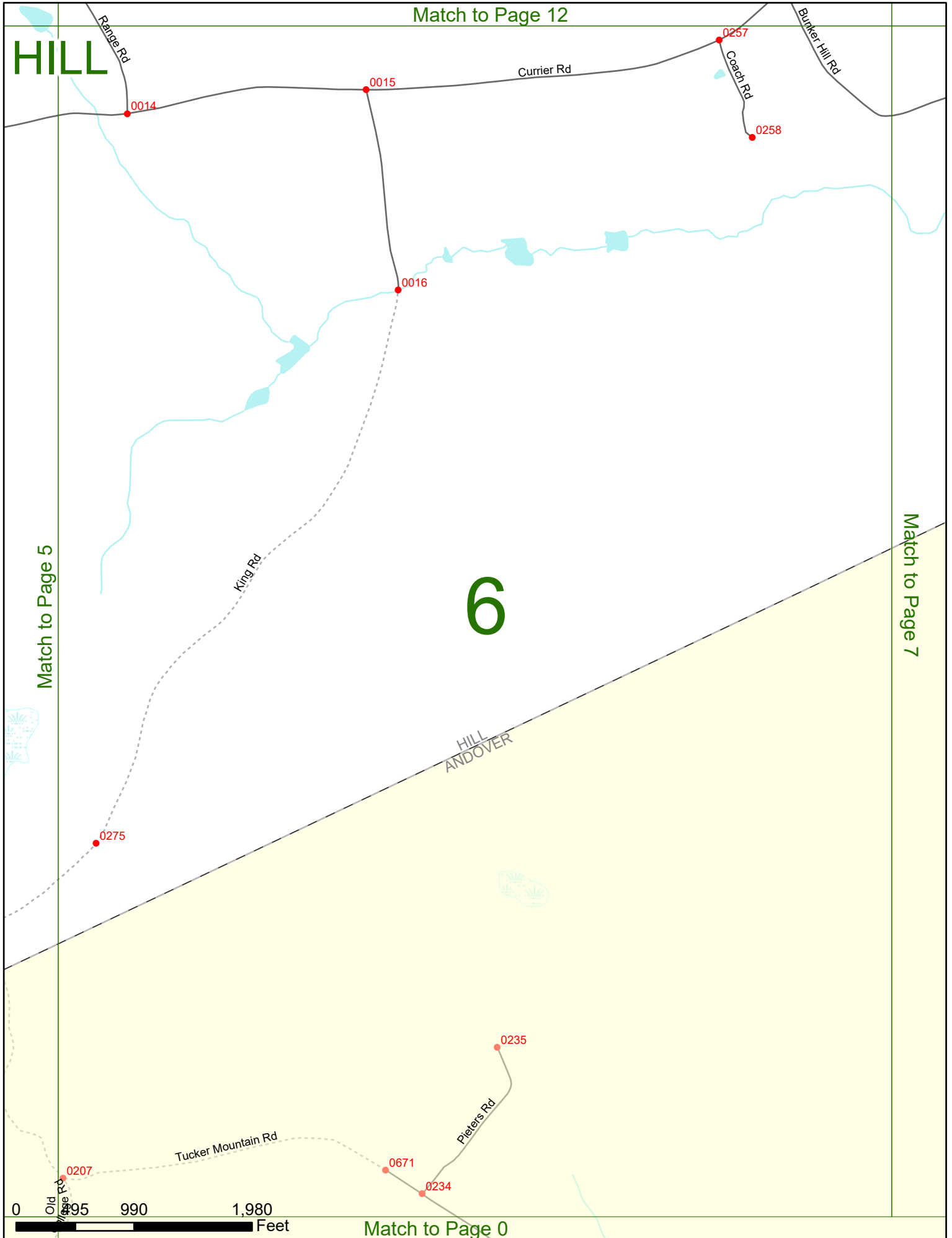

Match to Page 13

HILL

0259
Herlock Ln
0260

Bunker Hill Rd 0019

Severance Hill Rd

6045

HILL FRANKLIN

Weeks Pond

HILL ANDOVER

6039

FRANKLIN ANDOVER

7

Sam Hill Rd

0236

Match to Page 6

Match to Page 8

0 495 990 1,980 Feet

Match to Page 0

HILL

Match to Page 14

Bennett Brook Rd
HILL
FRANKLIN

0958
Bennett Brook Rd
0441

3A

Hill Rd

1060

0270

Match to Page 7

Match to Page 0

8

Timberland Dr

FRANKLIN
ANDOVER

6033

Philbrick Rd

0 495 990 1,980 Feet

Match to Page 0

Match to Page 0

HILL

Jackson Ridge Rd
0454

0480

Ward Hill Rd

Eastern District Rd

0153

0429

Tommy Higgins Rd

0395

0157

Lund Rd

0140

0056

0150

Resist Rd

0378

0380

Moose Meadow Ln

9

0152

0151

Smith River

Match to Page 10

Match to Page 0

0058

0057

NH Route 104

0361

0425

0360

Jones Hill Rd

0049

Chellis Dr

0455

0456

Buttrick Rd

0359

104

0050

0357

Russell Ln

0358

0407

0055

0406

0053

0052

Drive New MA
A-149

Drake Hill Rd

Spear Hill Rd

0396

Gould Hill Rd

0051

Elmwood Trailer
Park Rd

0363

0362

Ragged Mountain Rd

Searle Hill Rd

0447

0042

DANBURY HILL

0 495 990 1,980 Feet

Match to Page 3

HILL

Match to Page 16

Tommy Higgins Rd

NH Route 104
Smith River

Lynch Rd

Keezar Rd

104

Eastern District Rd

Match to Page 9

Jones Hill Rd

Poverty Pond Rd

DANBURY HILL

10

Match to Page 11

0455

0152

0151

0047

6043

0285

0286

0322

Poverty Pond Rd

0017

0321

0 495 990 1,980 Feet

Match to Page 4

0480

0157

0159

0173

6042

0304

0092

0093

0261

HILL

Match to Page 17

Murray Hill Rd

0088 Thierry Rd 0089

0278

Keezar Rd

Stone House Rd

0087

11

0086

Clough Rd

0274

Match to Page 12

Match to Page 10

0081

Ramp Rd

0320

Patten Rd

0276

0254

Match to Page 5

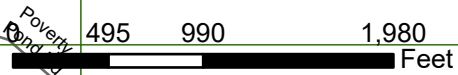

Poverty Rd

Match to Page 18

Bootjack Rd

HILL

0292 0293

Murray Hill Rd

12

Match to Page 11

Match to Page 13

0079

0080

Clough Rd

0277

Currier Rd

0309

Range Rd

0276

0 495 990 1,980 Feet

Match to Page 6

0257

Copch Rd

0018

Bunker Hill Rd

HILL

Match to Page 19

13

Match to Page 12

Match to Page 14

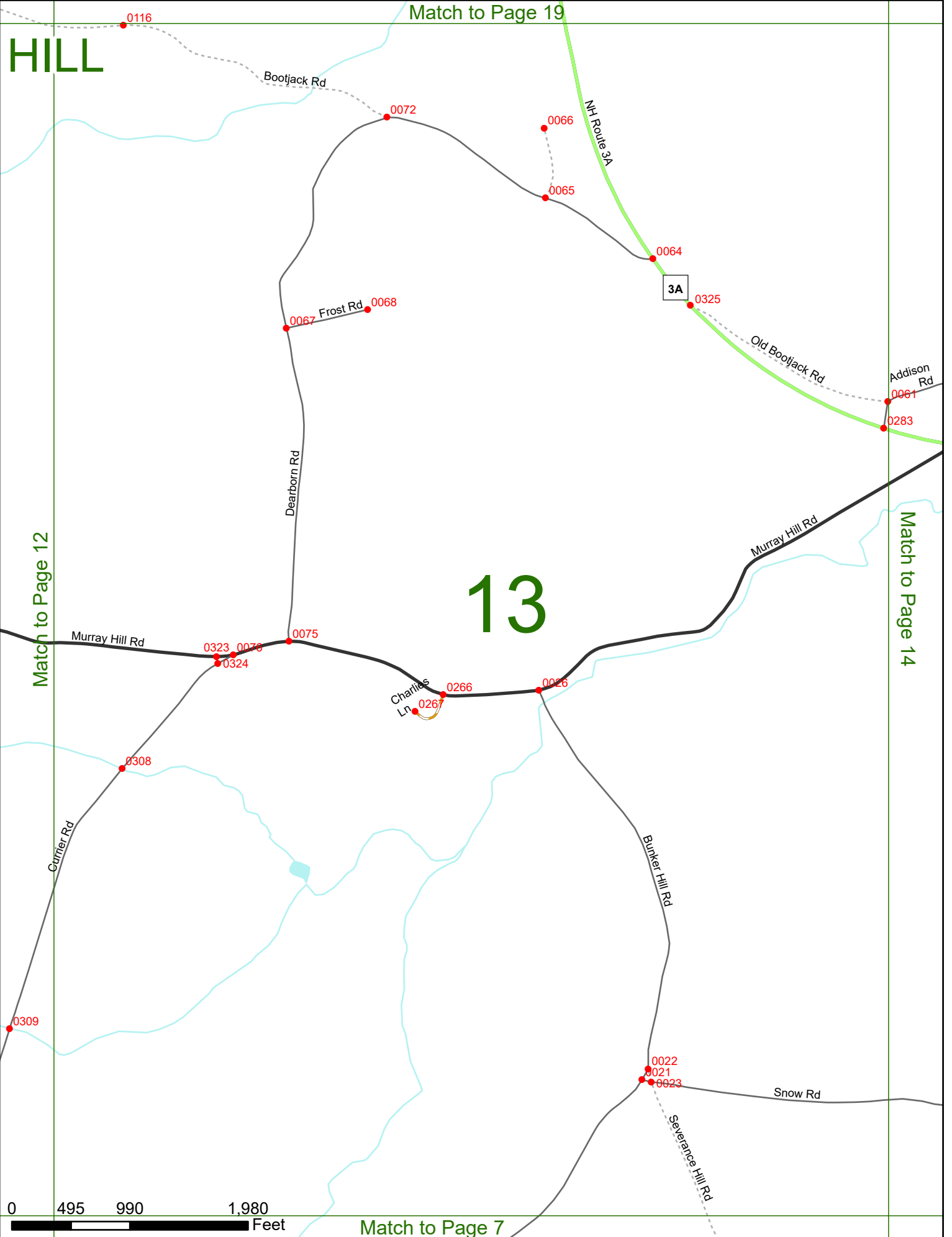

Match to Page 7

Match to Page 20

HILL

Pemigewasset
SANBORNTON HILL

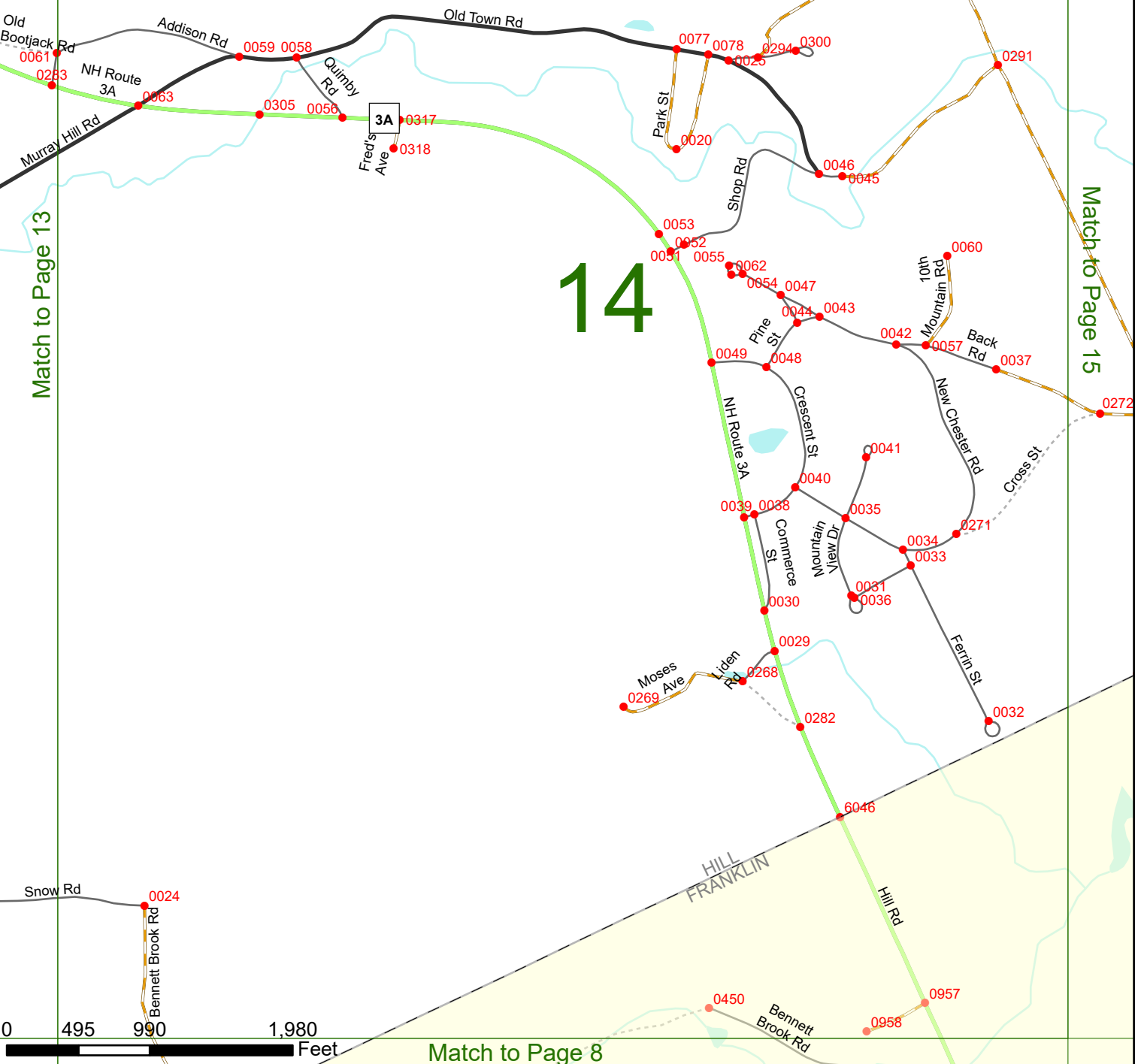

Match to Page 13

Match to Page 15

14

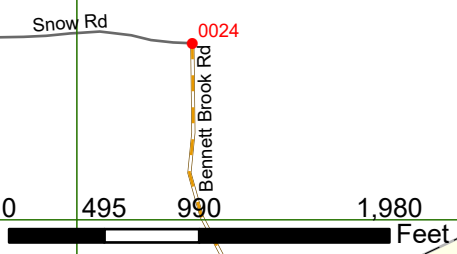

Match to Page 0

HILL

Knox Mt Rd

0431

SANBORNTON HILL

0093

0094

Quimby Rd

0529

0079

Knox Mountain Rd

Match to Page 0

15

Match to Page 14

0272

0281

Cross St

0557

0047

HILL FRANKLIN

Penigewasser

SANBORNTON FRANKLIN

0 495 990 1,980 Feet

Match to Page 0

HILL

Match to Page 0

Match to Page 17

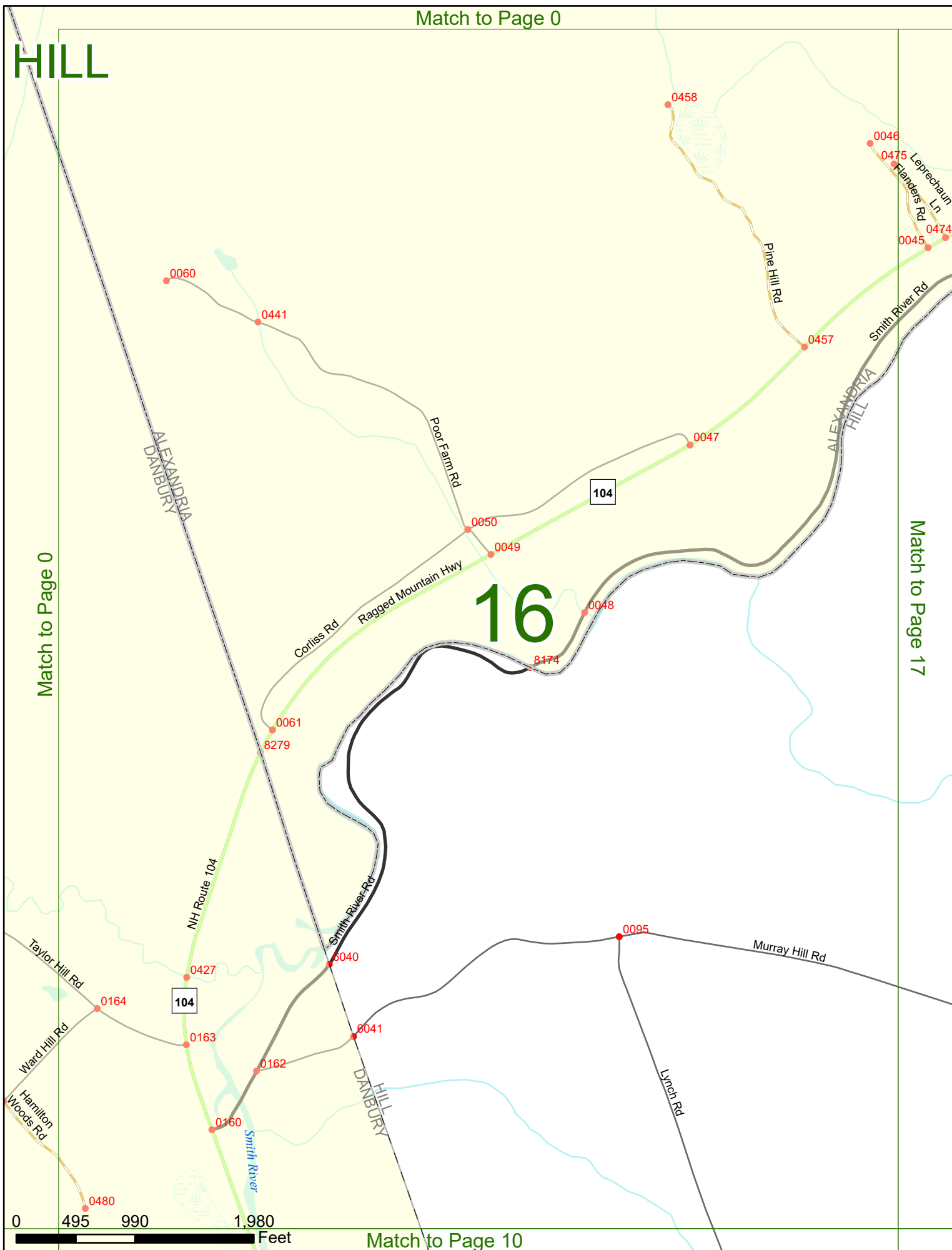

16

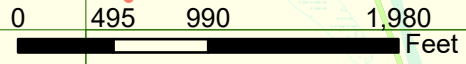

HILL

Match to Page 0

Match to Page 16

Match to Page 18

17

0 495 990 1,980 Feet

Match to Page 11

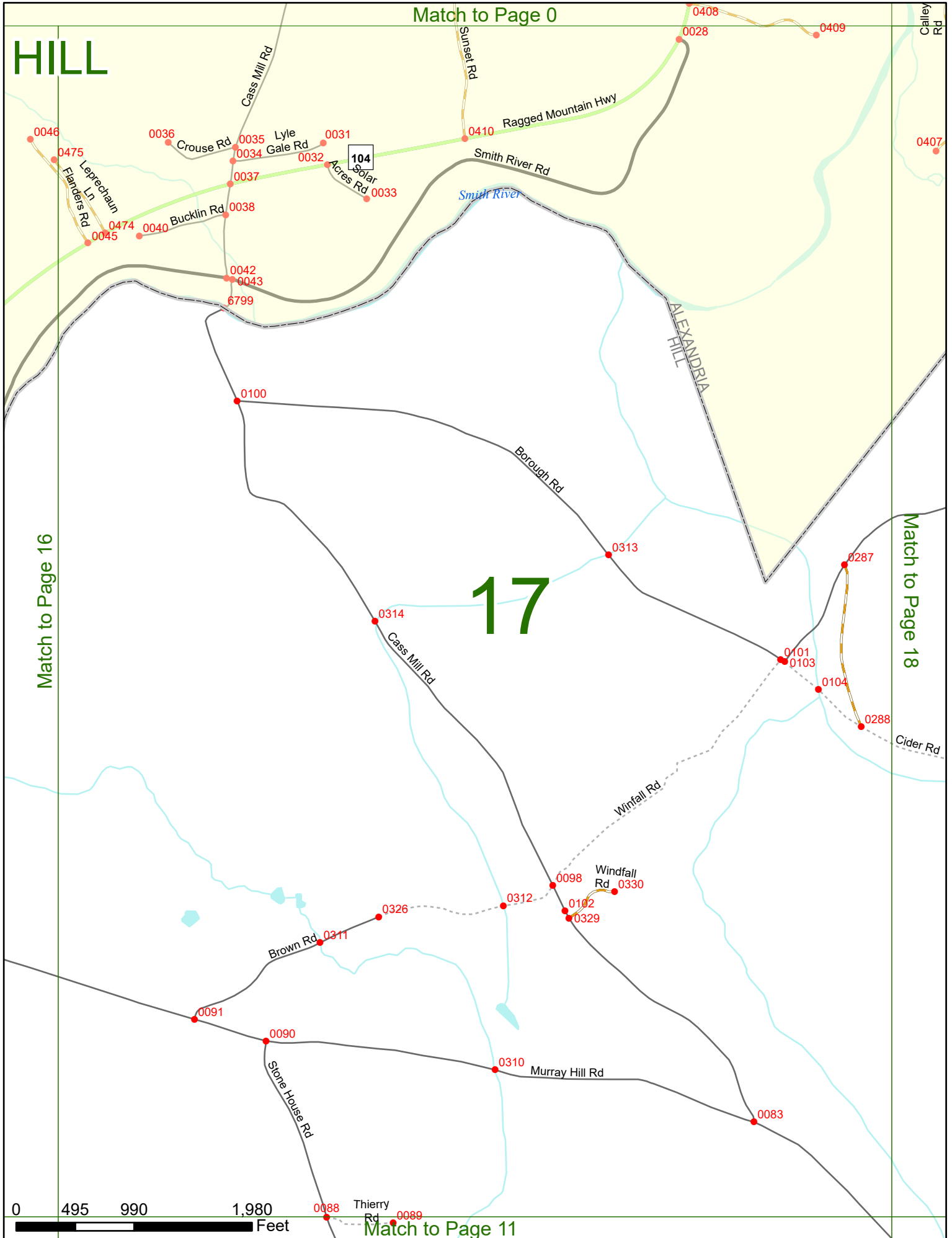

Match to Page 21

HILL

Calley Rd

Berry Rd

0422

0407

0018

0017

0019

Smith Riv

ALEXANDRIA HILL

Axteel Rd

0280

0411

Borough Rd

0108

0106

0306

0263

Evergreen Ln

0262

Borough Rd

0287

Match to Page 17

0288

18

Periwig Mountain Rd

Match to Page 19

Wade SF

0279

Cider Rd

0328

0074

Bootjack Rd

Murray Hill

0 495 990 1,980 Feet

Match to Page 12

Match to Page 22

HILL

Axel Rd
Borough Rd

NH Route 3A

3A

0264 0297 0265
Eastside Ln

Highridge Rd 0290

0289

19

0071

0315

NH Route 3A

0316

BRISTOL HILL
BRISTOL NEW HAMPTON

Penigewasset

NEW HAMPTON HILL

Sumner Way

0242

0335

Match to Page 20

Match to Page 18

W a s h S F

0 495 990.6 1,980 Feet

Match to Page 13

Match to Page 0

HILL

20

Match to Page 0

Match to Page 19

Match to Page 14

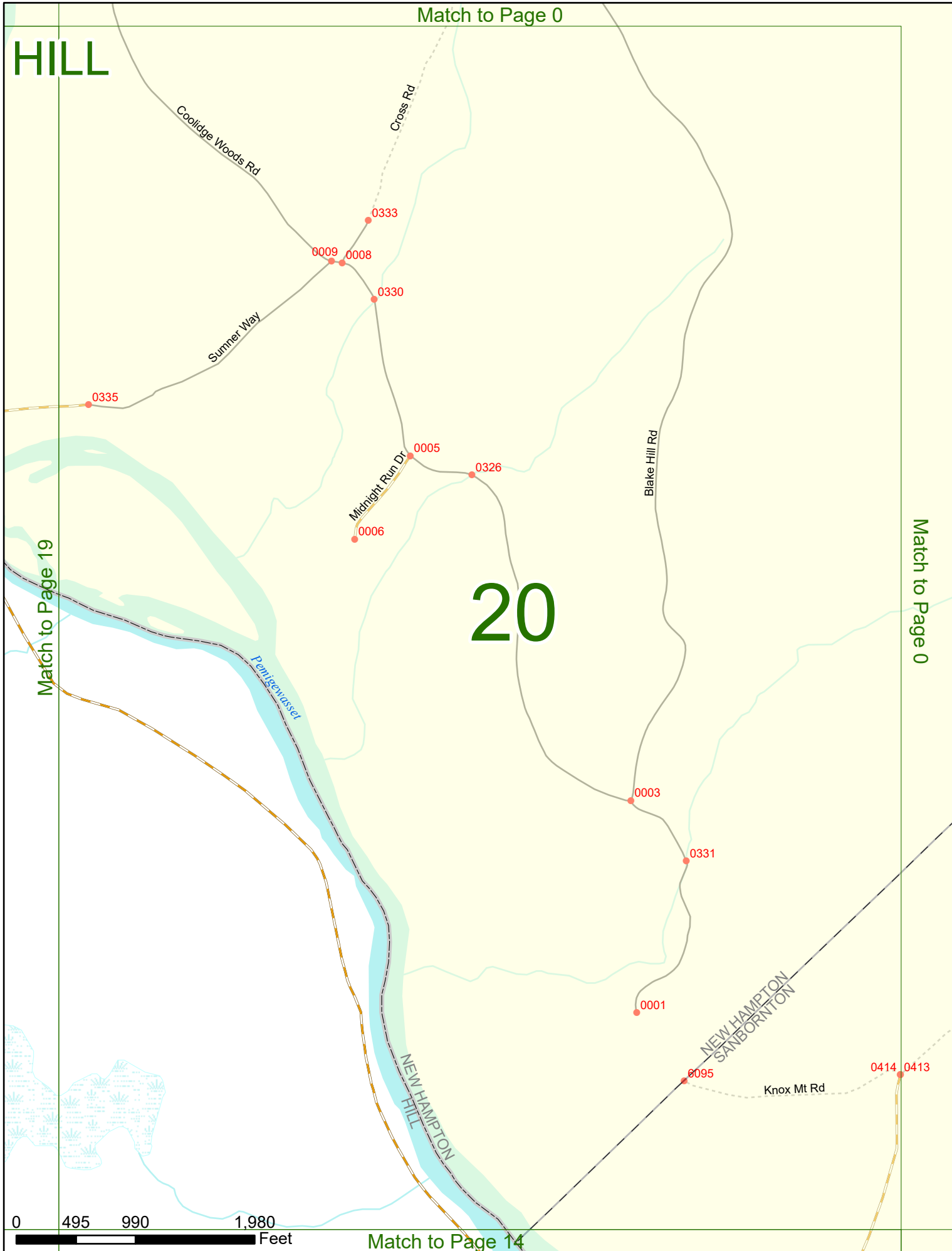

Match to Page 0

HILL

21

Match to Page 0

Match to Page 22

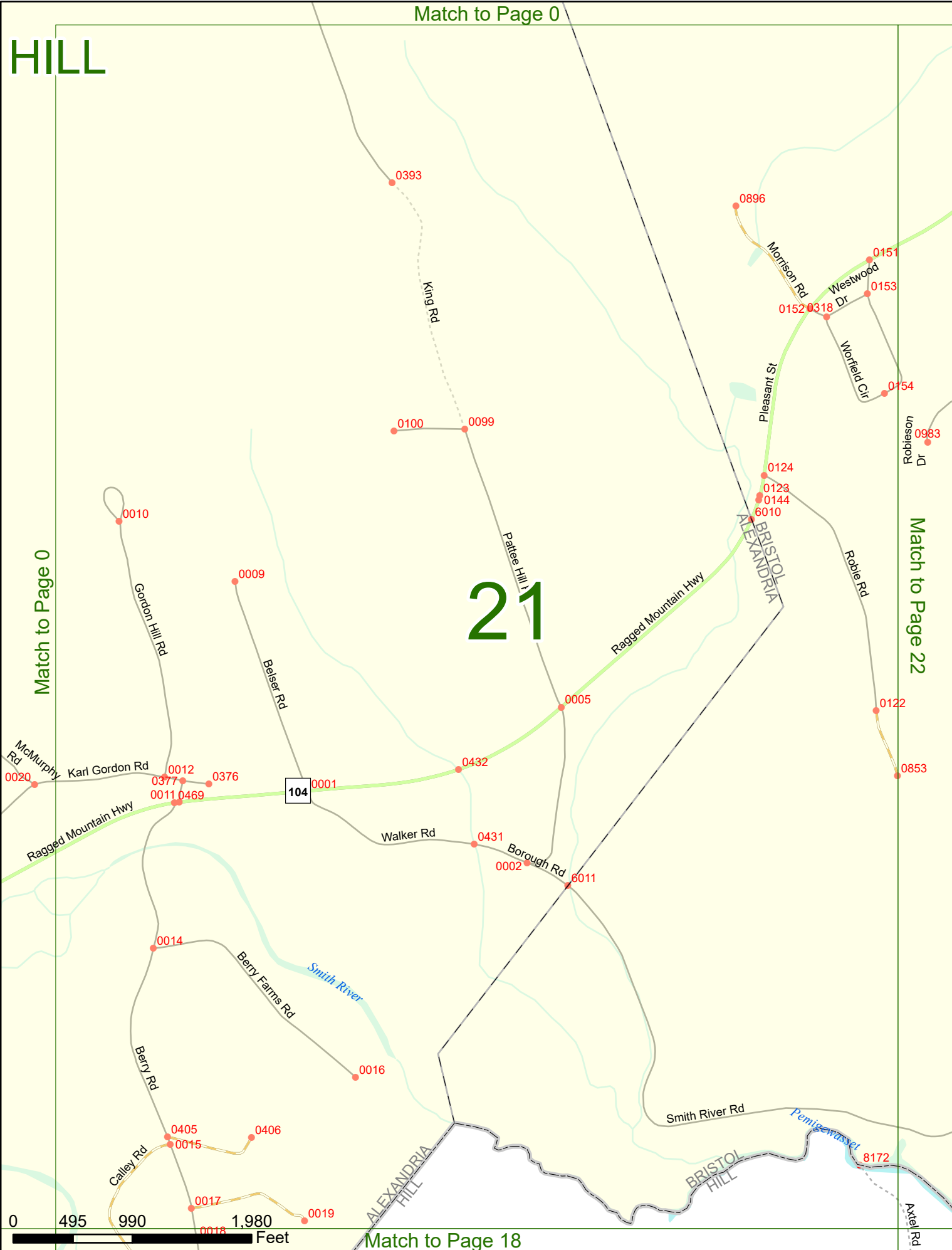

Match to Page 18

HILL

Match to Page 0

Match to Page 21

Match to Page 0

22

Match to Page 19

0 495 990 1,980 Feet

