

New Hampshire
DOT
 Department of Transportation

Maps and data sets are not guaranteed to be free from errors and omissions. Data is in a constant state of update and correction by various groups and agencies. Information displayed on this map is the best available at the time of publication.

2023 Nodal Reference Bookmap

LEGEND



NHDOT will accept crash locations based on the State of NH Uniform Police Traffic Accident Report.

Crash occurred on:

Option 1 Street Address
 123 Main Street

Option 2 Route No and/or Distance from NESW Intesecting Road, Bridge,
 Street name Intersecting Street Town/County line
 Main Street 500 E Oak Street

Option 3 First Node Distance from First Node Second Node
 515 212 632

Option 4 Route No and/or Mile Marker on Interstate Only NESW Mile (Marker)
 Street name
 189S 700 feet S 36.8

Option 3 – Example

Street Name Loudon Road
First Node 803
Distance from First Node 318 Ft
Second Node 813



DUMMER

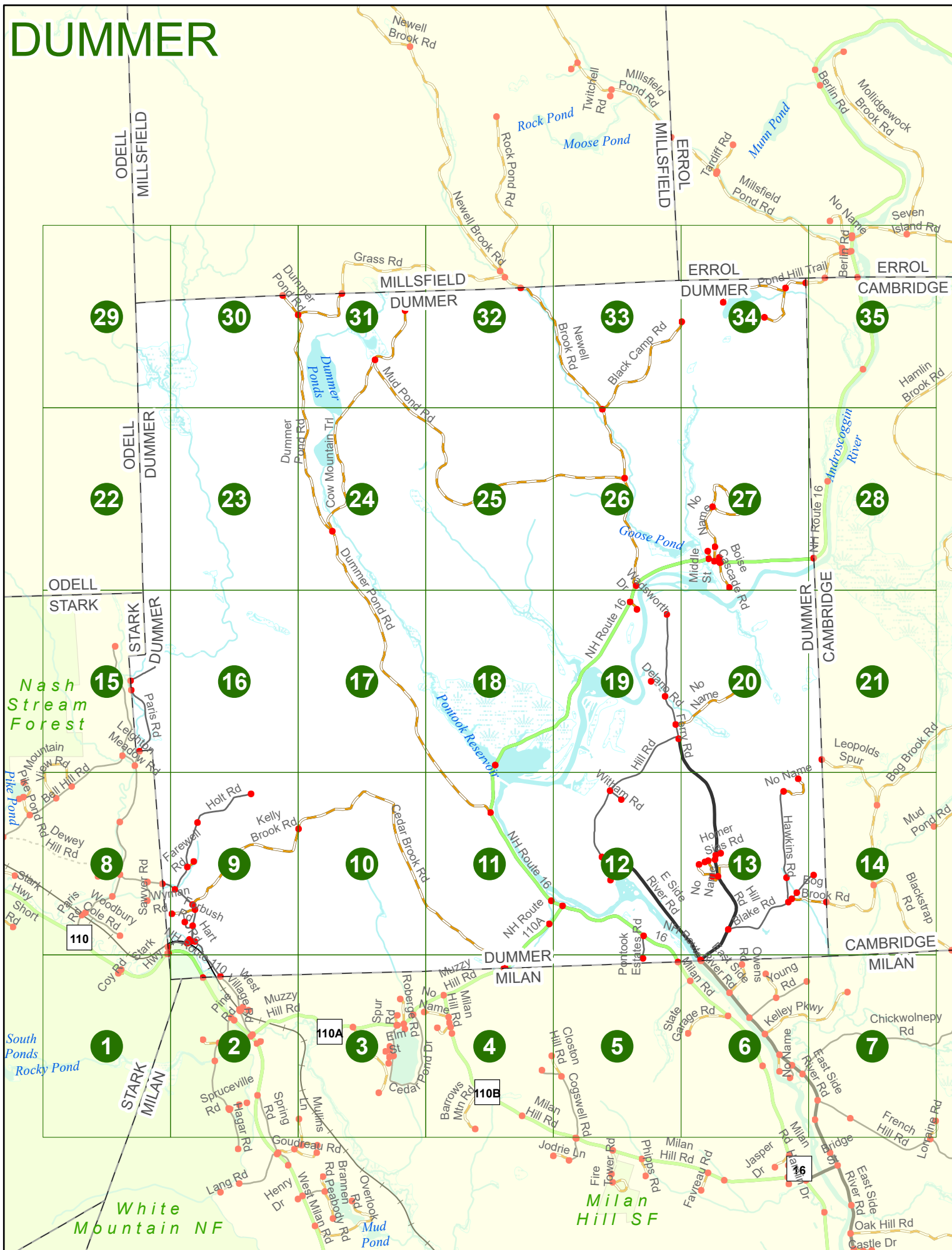

DUMMER

Match to Page 8

6031 6032

Coy Rd
0027
0023

110

Stark Hwy

DUMMER
STARK

Match to Page 0

White
Mountain NF

1

Match to Page 2

Rocky Pond

STARK
MILAN

0 495 990 1,980 Feet

Match to Page 0

Match to Page 9

DUMMER

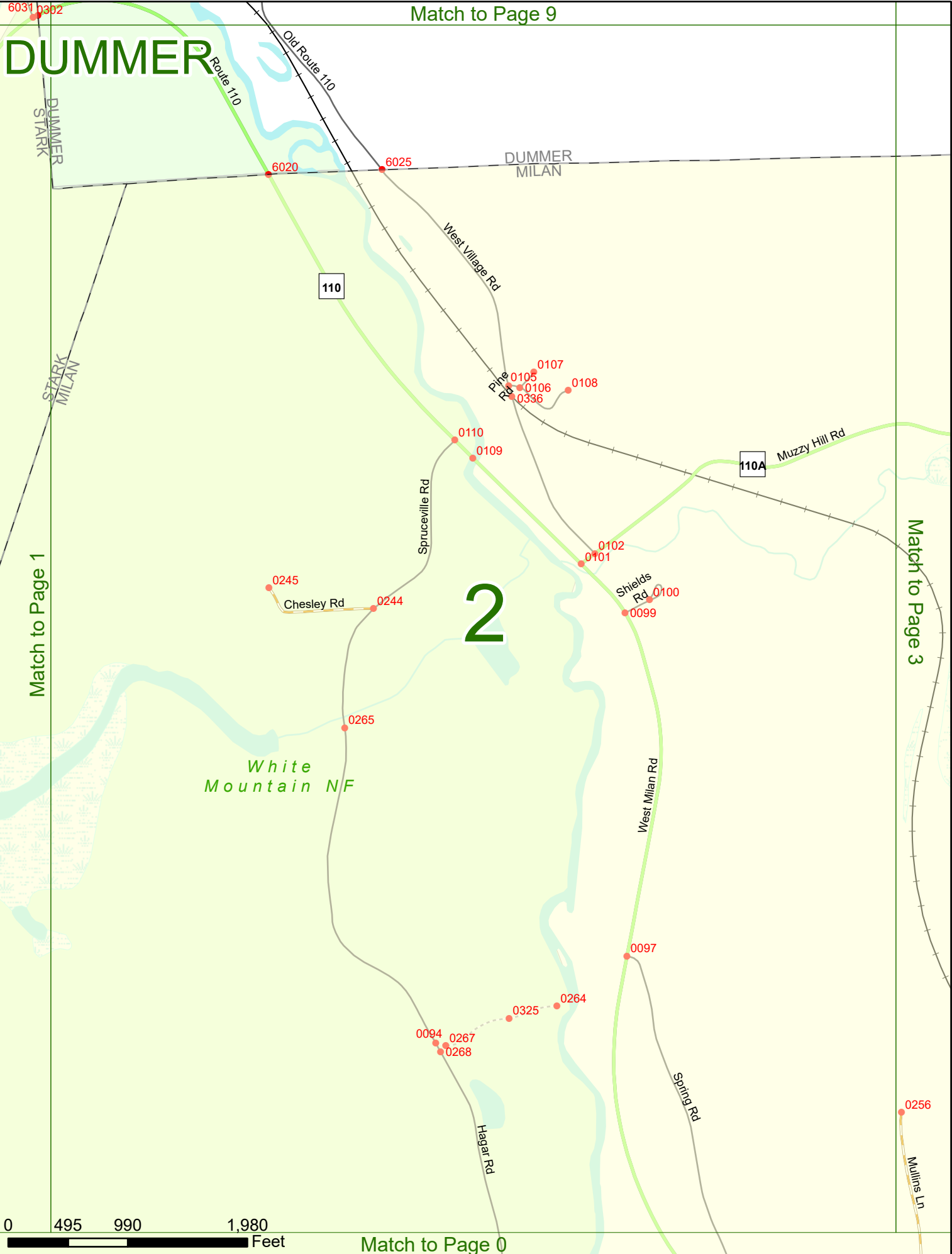

Match to Page 1

Match to Page 3

Match to Page 0

0 495 990 1,980 Feet

DUMMER

DUMMER
MILAN

Match to Page 2

Match to Page 4

3

110A

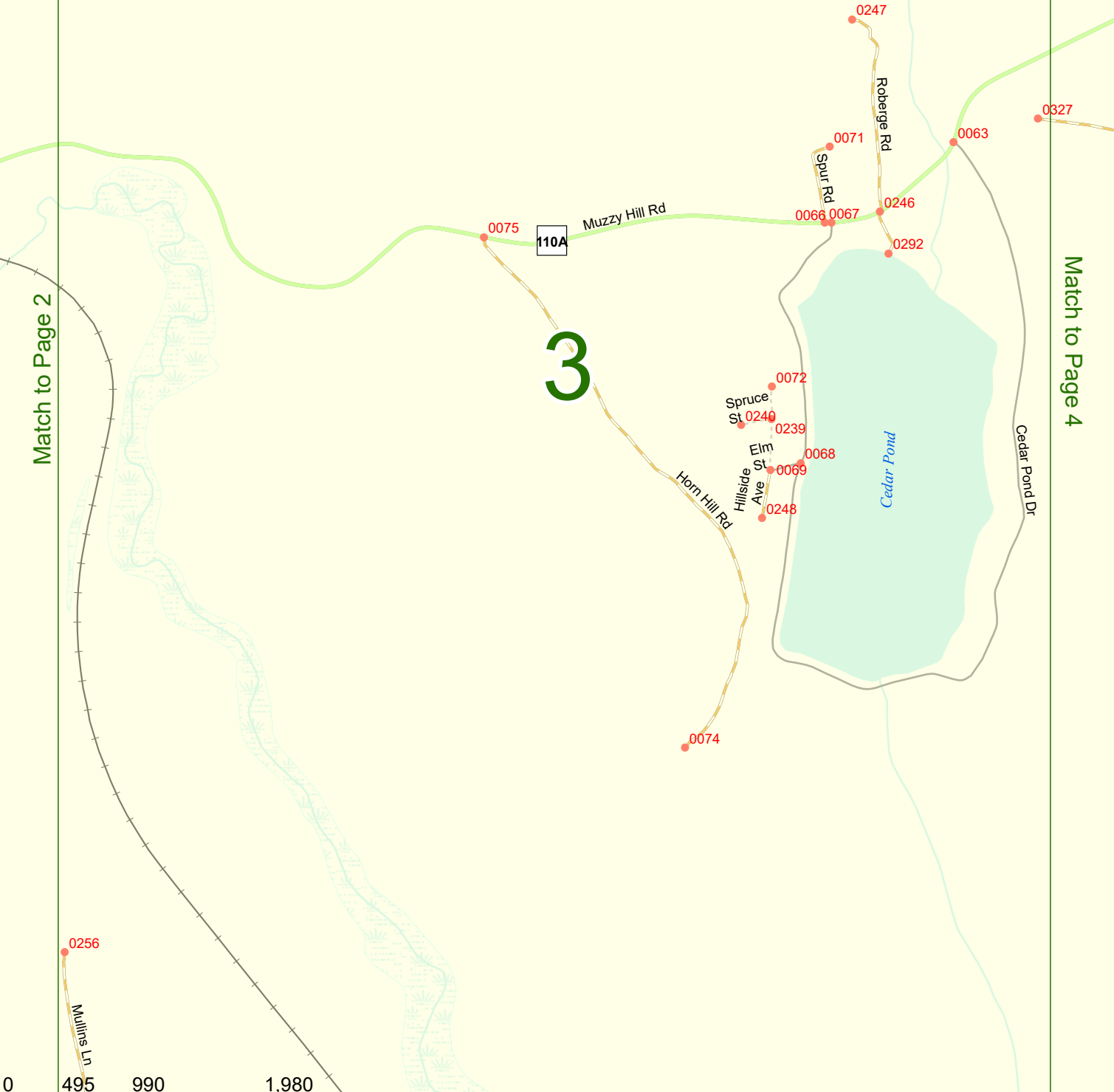

0 495 990 1,980 Feet

DUMMER

Match to Page 11

DUMMER
MILAN

Cedar Brook Rd

NH Route 110A

Muzzy Hill Rd

110A

0061

0327

0326

0299

0335
Wood
Thrush Way

0334

0315

110B

Milan Hill Rd

4

Match to Page 5

0056

Closton Hill Rd

0064

Cogswell Rd

0057

0312

0319

Barrows Mtn Rd

0311

0309

Milan Hill Rd

Cedar Pond
Cedar Pond Dr

Match to Page 3

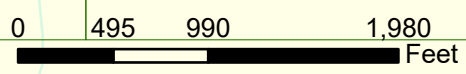

Match to Page 0

Match to Page 12

DUMMER

DUMMER
MILAN

0031

Pontook
Estate Rd

NH Route
16

6023

Androscooggin
River

16

Milan Rd

Match to Page 6

0035

5

Match to Page 4

0056

Closton Hill Rd

0057

Cogswell Rd

Milan Hill Rd

110B
990

Jorie

0054

1,980

0

495

990

Jorie

1,980

Feet

Match to Page 0

Match to Page 13

DUMMER

DUMMER MILAN

0032

0045

0047

0322

0228

0048

16

State Garage Rd

0050

0049

Kelley Pkwy

Match to Page 5

6

Match to Page 7

East Side River Rd
Androscooggin River

0343

0035

0249

0273

0041

0250

0043

0039

Milan Rd

East Side River Rd

0290

0 495 990 1,980 Feet

Match to Page 0

DUMMER

Match to Page 14

Young Rd 0047

0344

Kelley Pkwy

Chickwolnepy Rd

7

Match to Page 6

Match to Page 0

0039

East Side River Rd

0038

0290

0316

French Hill Rd

0230

Lorraine Rd

0229

0 495 990 1,980 Feet

Match to Page 0

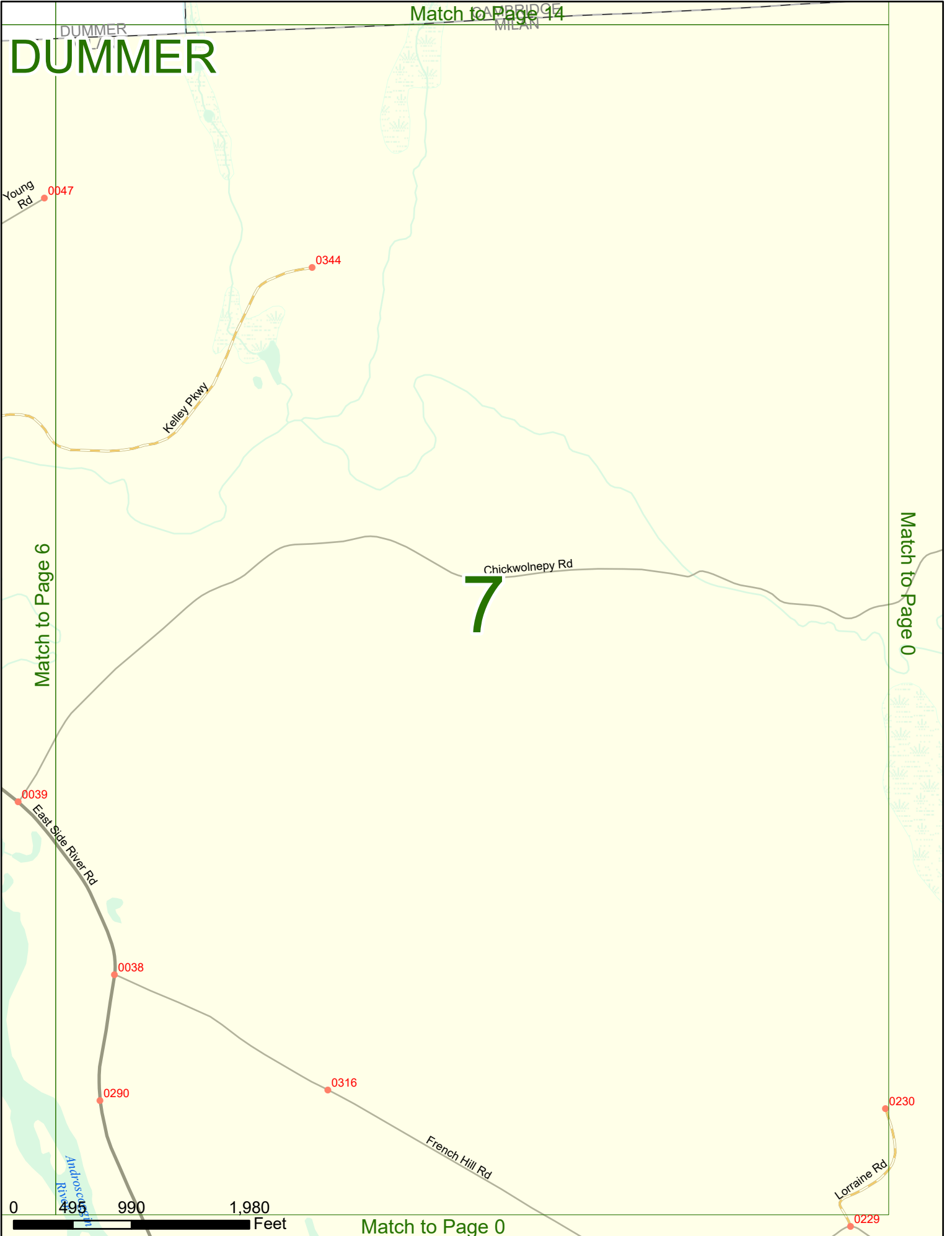

Match to Page 15

DUMMER

8

Match to Page 0

Match to Page 9

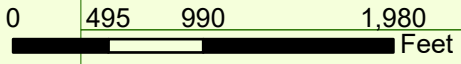
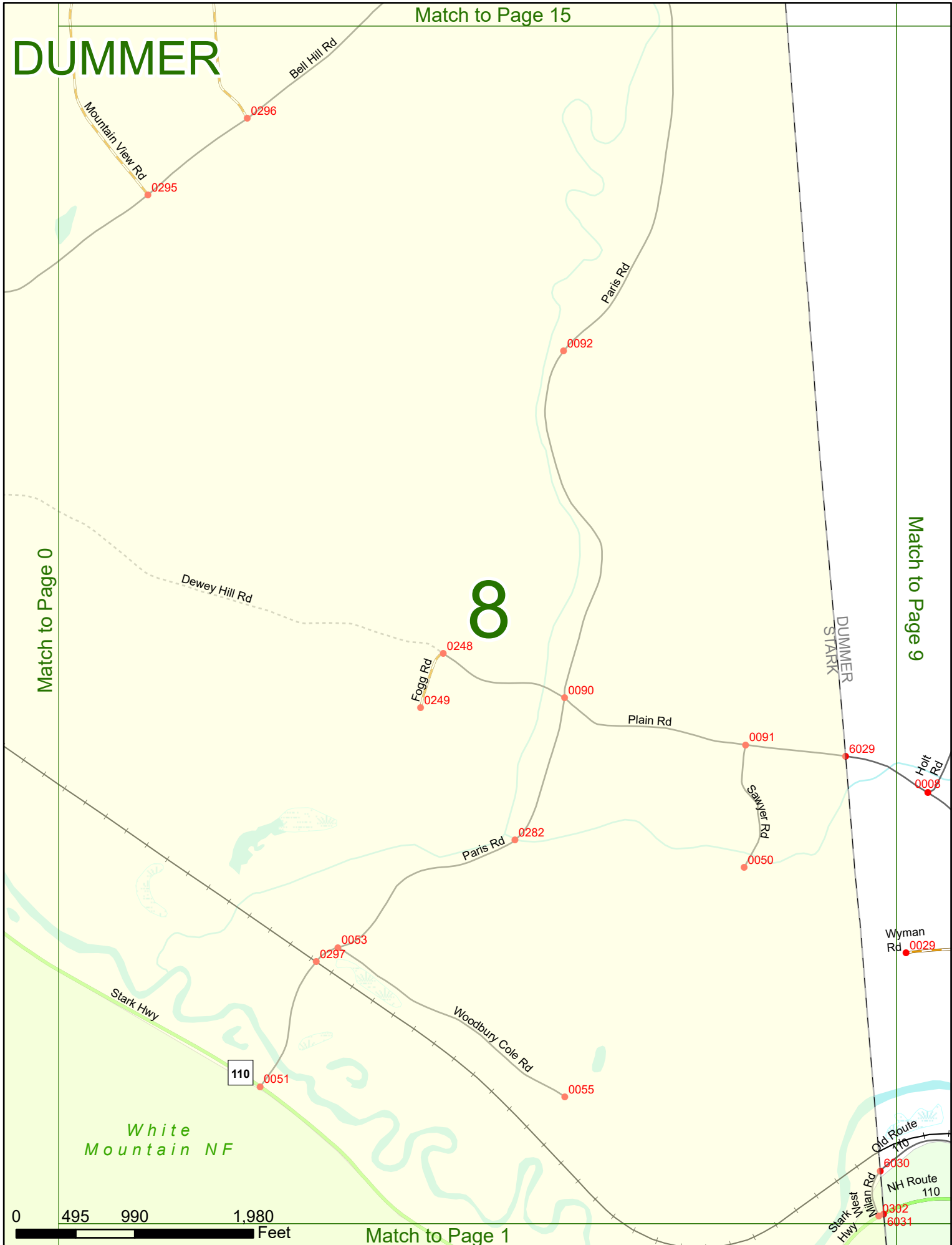

Match to Page 1

DUMMER

9

Match to Page 8

Match to Page 10

Holt Rd

Kelly Brook Rd

Cedar Brook Rd

Farewell Rd

Plain Rd

Wyman Rd

Fordush Rd

Hart Rd

Old Route 110

110

NH Route 110

White Mountain

1,980 Feet

6029

0008

0010

0024

0120

0040

0009

0005

0004

0029

0007

0006

0003

0002

0001

0110

6030

6049

6032

DUMMER STARK

DUMMER

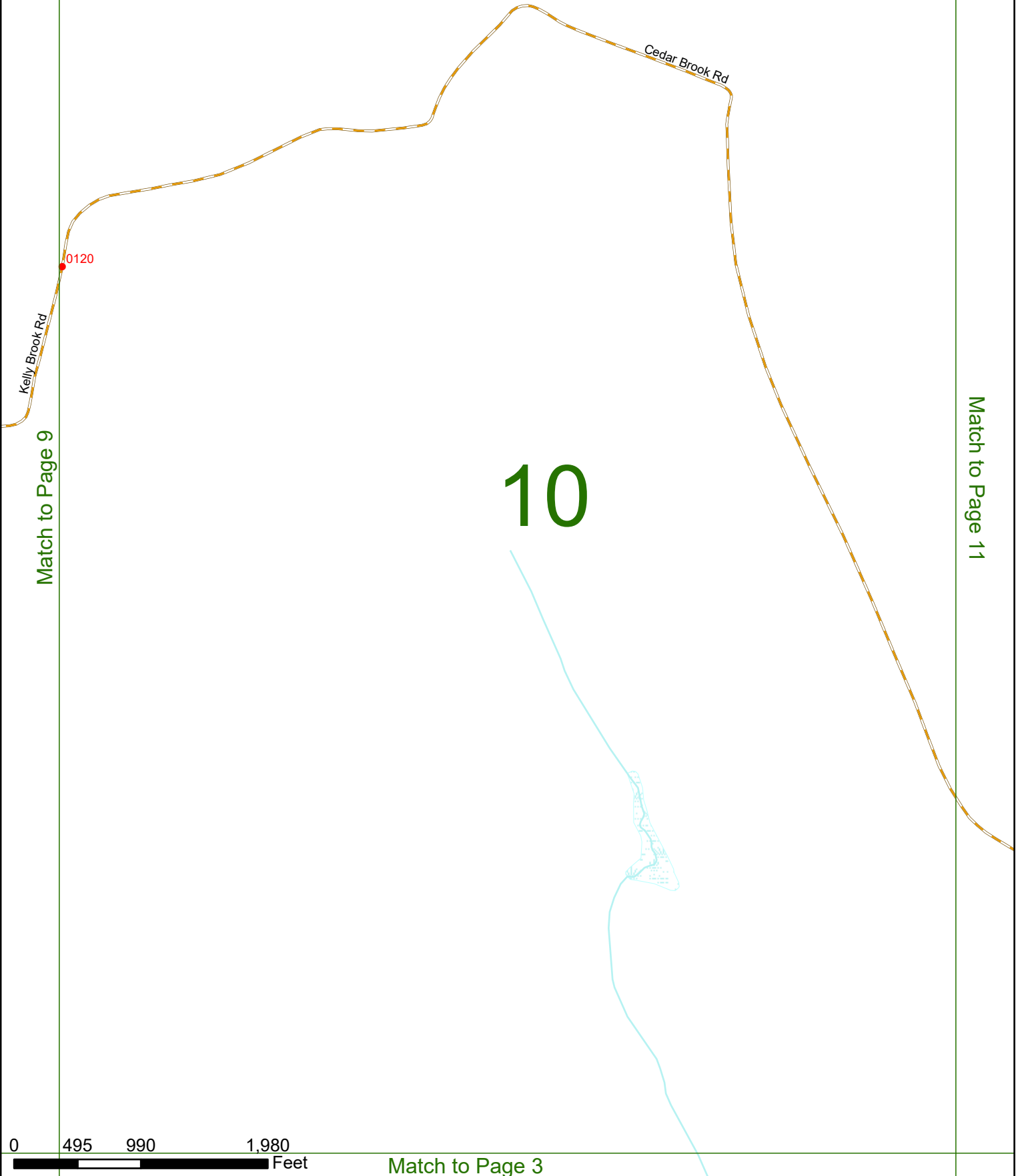

Match to Page 9

Match to Page 11

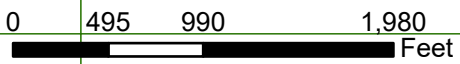

Match to Page 3

DUMMER

Match to Page 18

Pontock
Reservoir

Androskoggin
River

Dummer Pond Rd

0117

16

NH Route 16

11

Match to Page 12

Match to Page 10

0026

Cedar Brook Rd

002B

110A

NH Route 110A

0 495 990 1,980 Feet

Match to Page 4

Match to Page 19

DUMMER

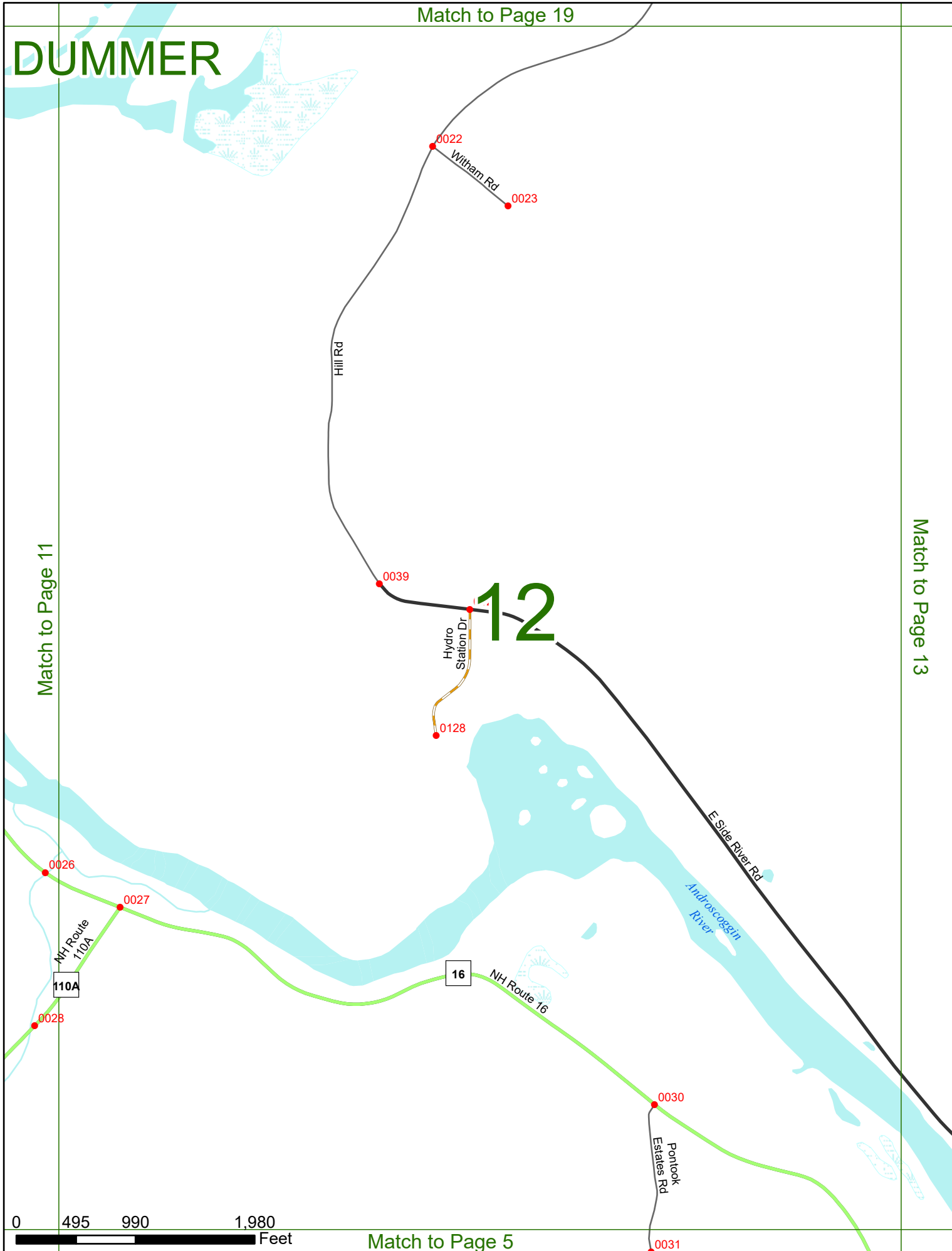

Match to Page 11

Match to Page 13

12

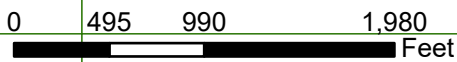

Match to Page 5

DUMMER

Match to Page 12

Match to Page 14

13

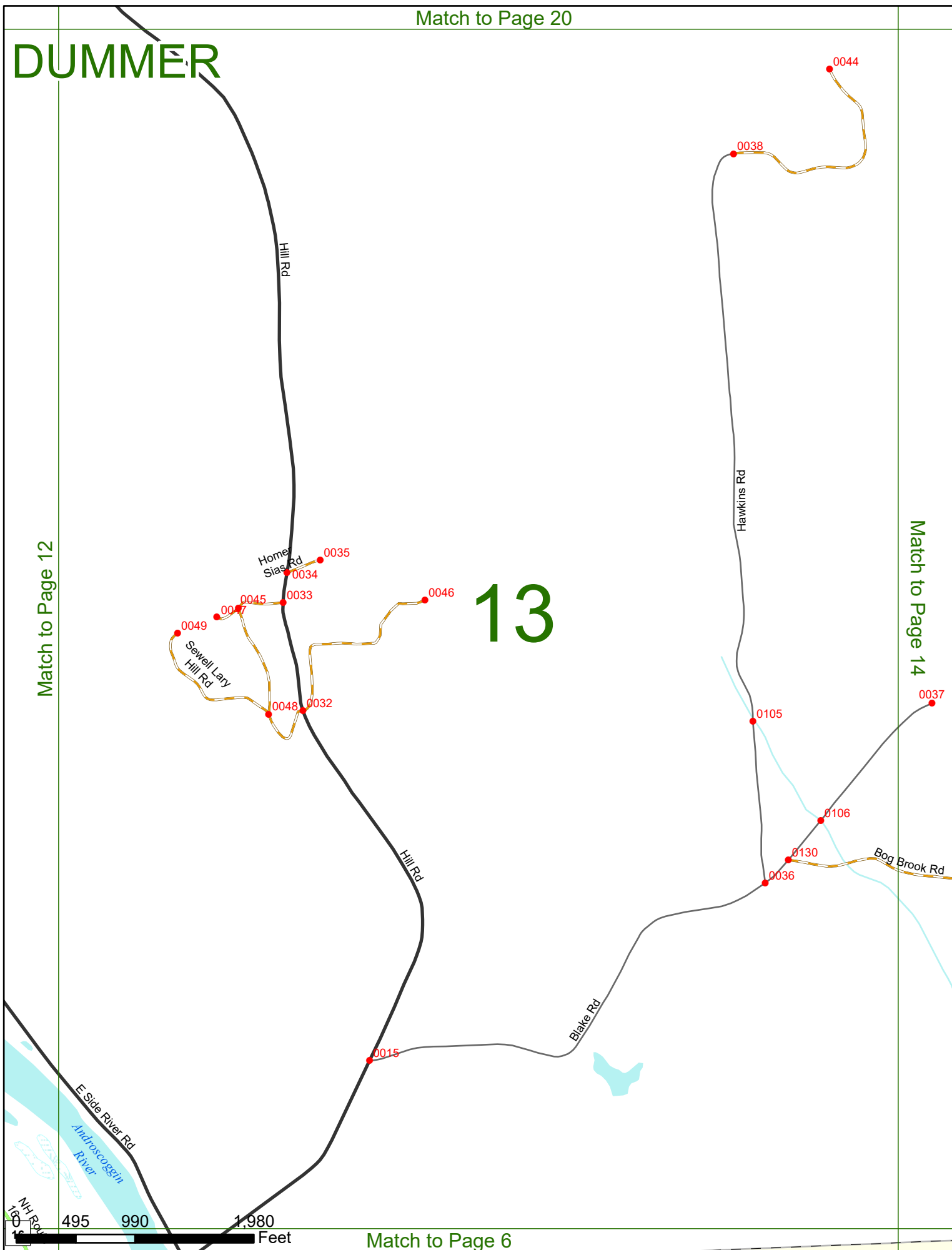

DUMMER

Match to Page 21

Match to Page 13

DUMMER
CAMBRIDGE

Match to Page 0

14

Leopolds Spur

0021

Mud
Pond Rd

0024

Bog Brook Rd

0026

Blackstrap Rd

6302

Blake Rd

0037



CAMBRIDGE
MILAN

Match to Page 7

Match to Page 22

DUMMER

ODELL
STARK

Match to Page 0

*Nash Stream
Forest*

15

Match to Page 16

0112

0021

6027

6028

Sullivan Rd

DUMMER
STARK

Paris Rd

6032

0095

Leighton
Meadow Rd

0093

Bell Hill Rd

Mountain View Rd

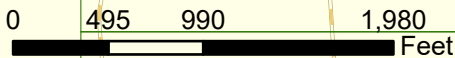

Match to Page 8

Match to Page 23

DUMMER

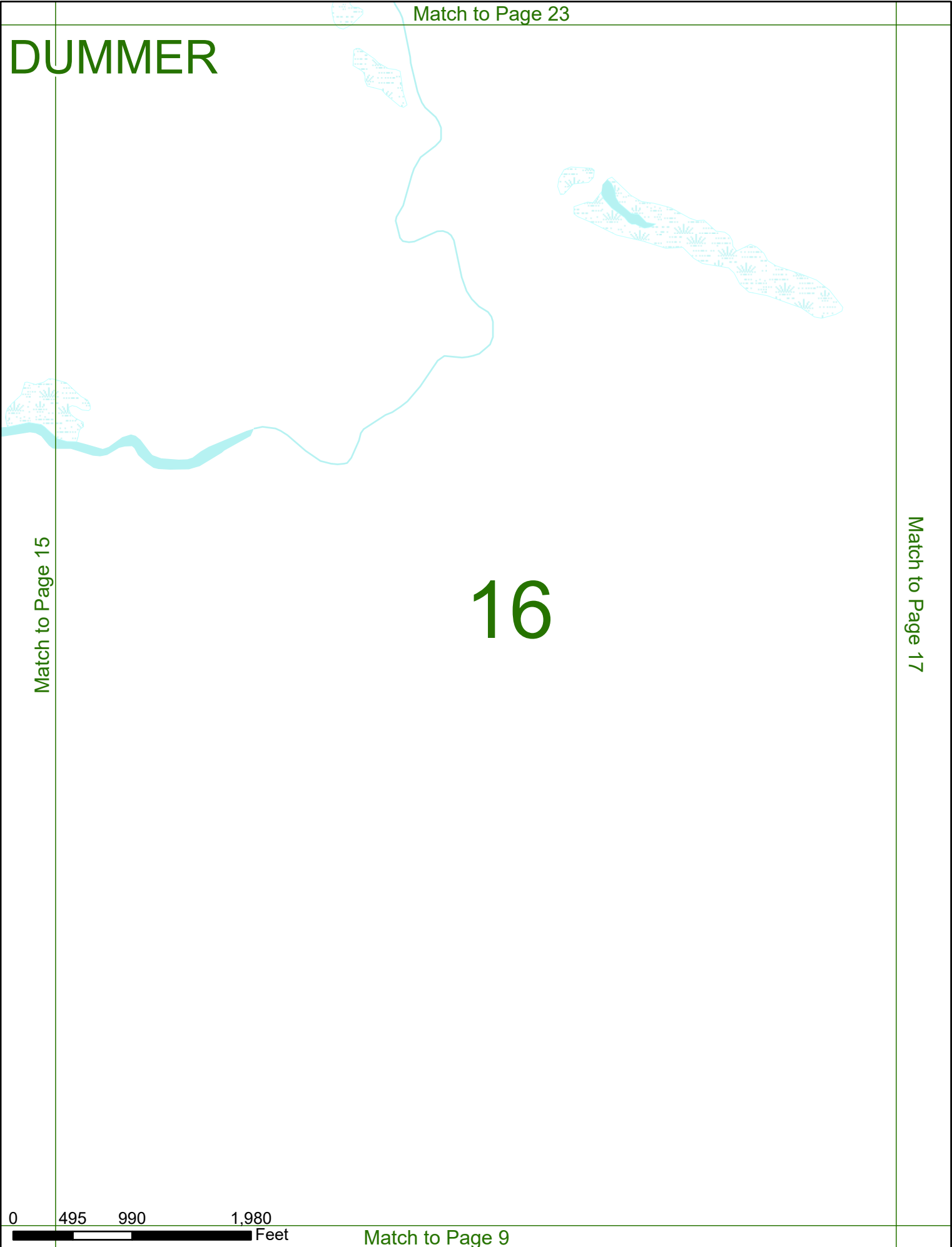

Match to Page 15

Match to Page 17

16

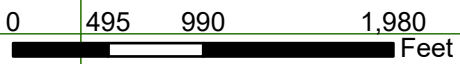

Match to Page 9

Match to Page 24

DUMMER

Match to Page 16

17

Dummer Pond Rd

Match to Page 18

Pulaski Reservoir

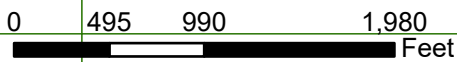

Match to Page 10

DUMMER

18

Match to Page 17

Match to Page 19

Pontook Reservoir

NH Route 16 16

0025

Dummer Pond Rd



Match to Page 11

Match to Page 26

DUMMER

Match to Page 18

Match to Page 20

16

19

NH Route 16

NH Route 16

Wadsworth Dr

0102

0101

0018

Ferry Rd

0020

Deiano Rd

0019

0017

0016

Hill Rd

Androscoggin River



Match to Page 12

DUMMER

●0014 Match to Page 27

Androscoggin
River

20

Match to Page 21

Match to Page 19

Ferry Rd

●0017

●0043

●0016

Hill Rd

0 495 990 1,980 Feet

Match to Page 13

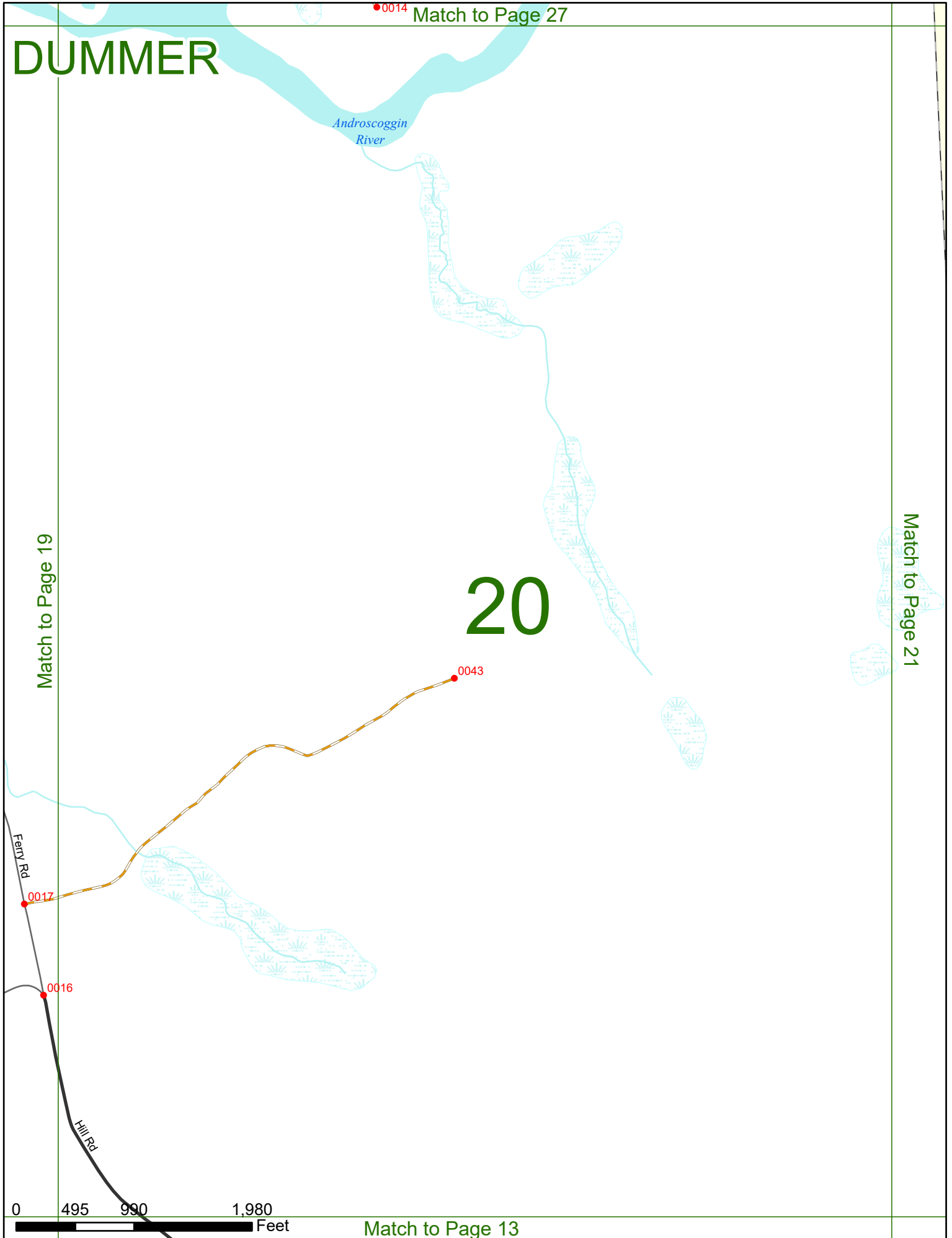

Match to Page 28

DUMMER

21

Match to Page 20

Match to Page 0

CAMBRIDGE
DUMMER

6303

Leopolds Spur

Bog Brook Rd

Mud Pond

0 495 990 1,980 Feet

Match to Page 14

DUMMER

Match to Page 0

22

ODELL
DUMMER

Match to Page 23



DUMMER

23

Match to Page 22

Match to Page 24

Dummer Pond Rd

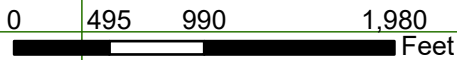

Match to Page 16

DUMMER

Match to Page 31

Mud Pond Rd

Dummer Pond Rd

Cow Mountain Trl

Dummer Ponds

24

Match to Page 23

Match to Page 25

0118

Dummer Pond Rd

0 495 990 1,980 Feet

Match to Page 17

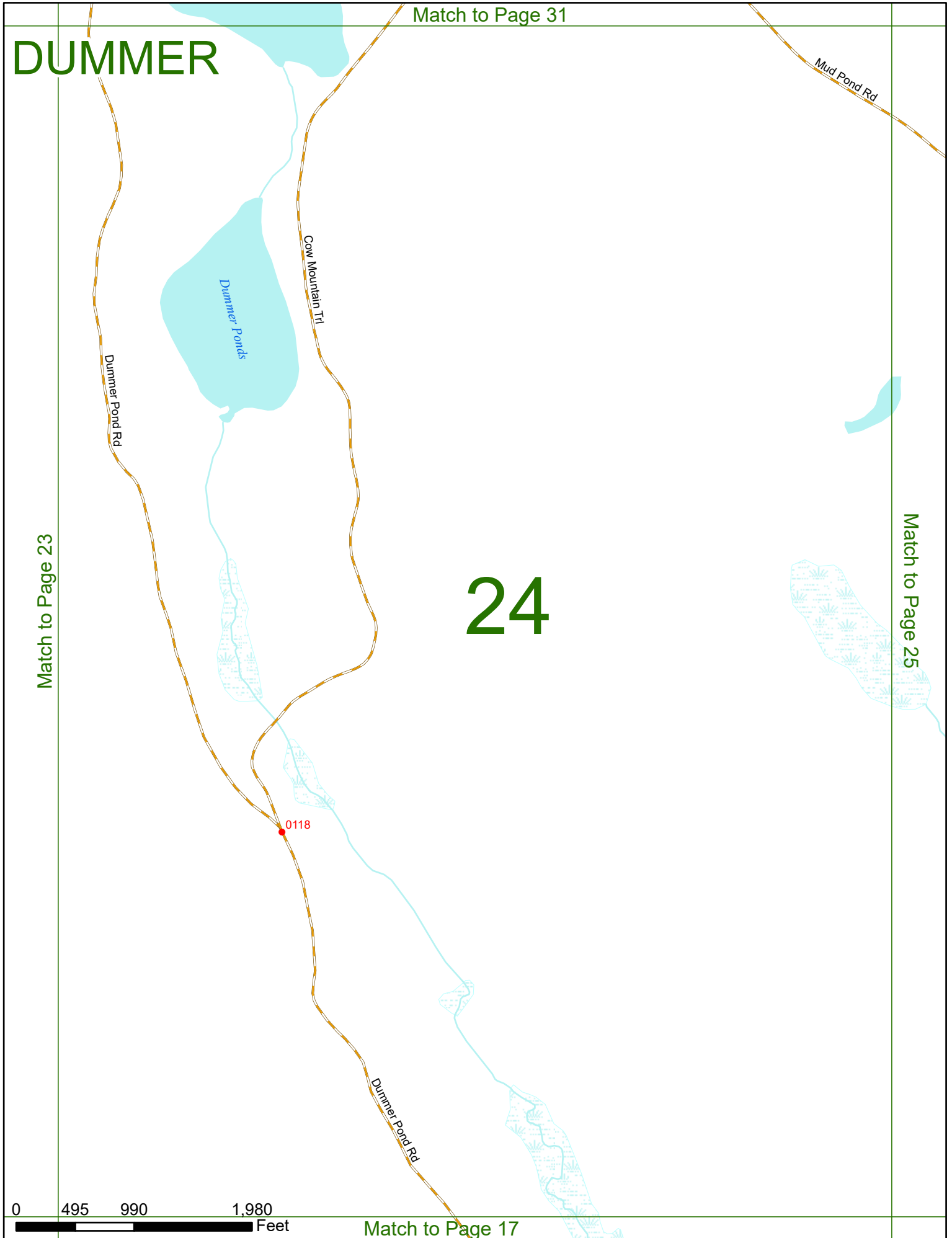

DUMMER

25

Mud Pond Rd

Match to Page 24

Match to Page 26

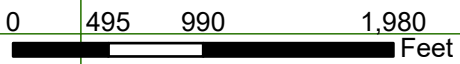

Match to Page 18

DUMMER

Match to Page 33

Black
Camp Rd
0113

Mud Pond Rd

0112

26

Newell Brook Rd

Goose Pond

NH Route 16

16

0111

Androscoggin River

Match to Page 25

Match to Page 27

0 495 990 1,980 Feet

Match to Page 19

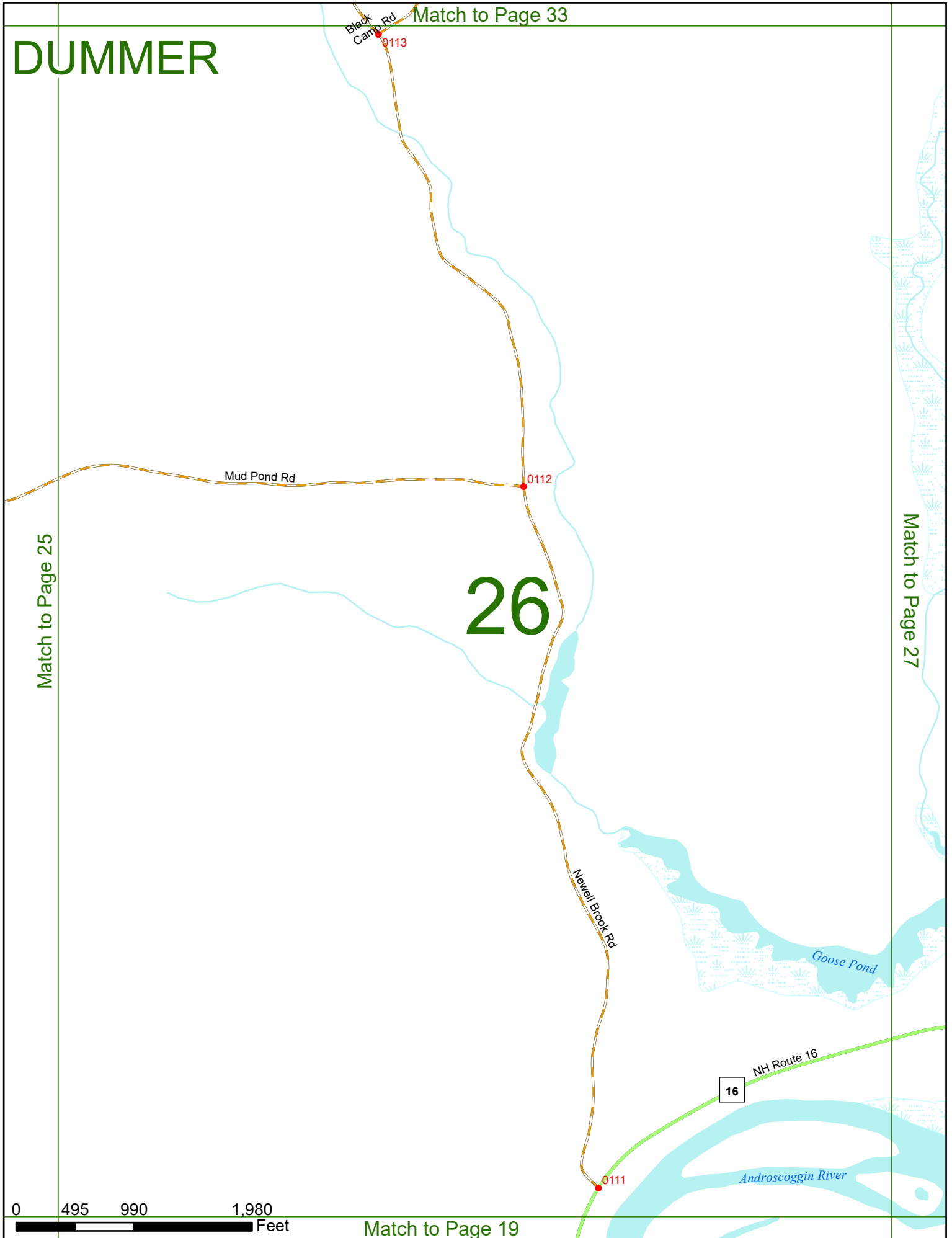

DUMMER

Match to Page 26

Match to Page 28

27

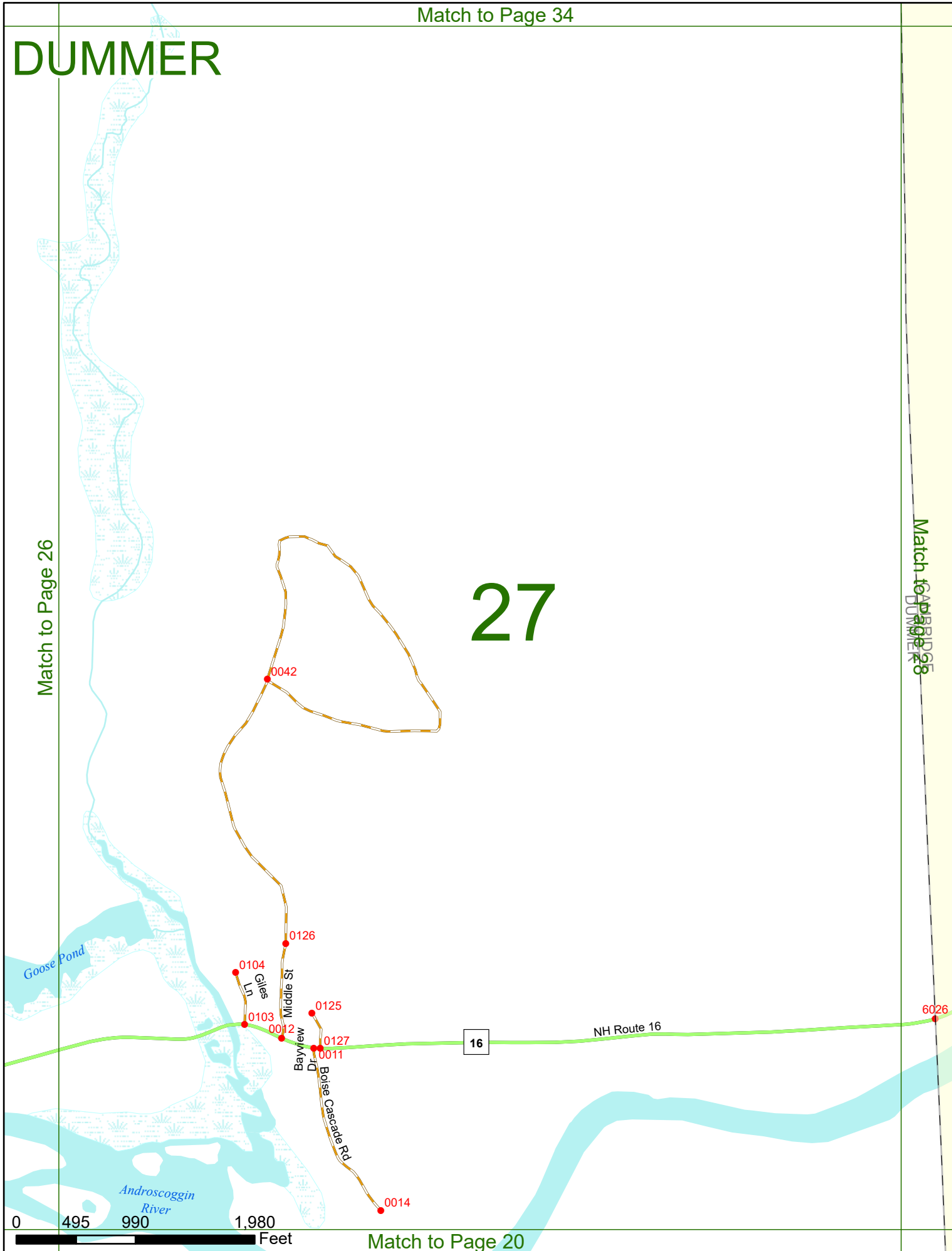

0 495 990 1,980 Feet

Match to Page 20

DUMMER

Match to Page 27

CAMBRIDGE
DUMMER

NH Route 16

16

0006

28

Hamlin Brook Rd

Match to Page 0

6026

Androscoggin
River

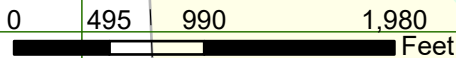

DUMMER

Match to Page 0

29

ODELL
MILLSFIELD

MILLSFIELD
DUMMER

Match to Page 30

ODELL
DUMMER

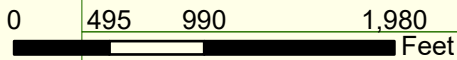

Match to Page 0

DUMMER

MILLSFIELD
DUMMER

30

6308

Match to Page 29

Match to Page 31

Dummer Pond Rd

Dummer Ponds

0 495 990 1,980 Feet

Match to Page 23

DUMMER

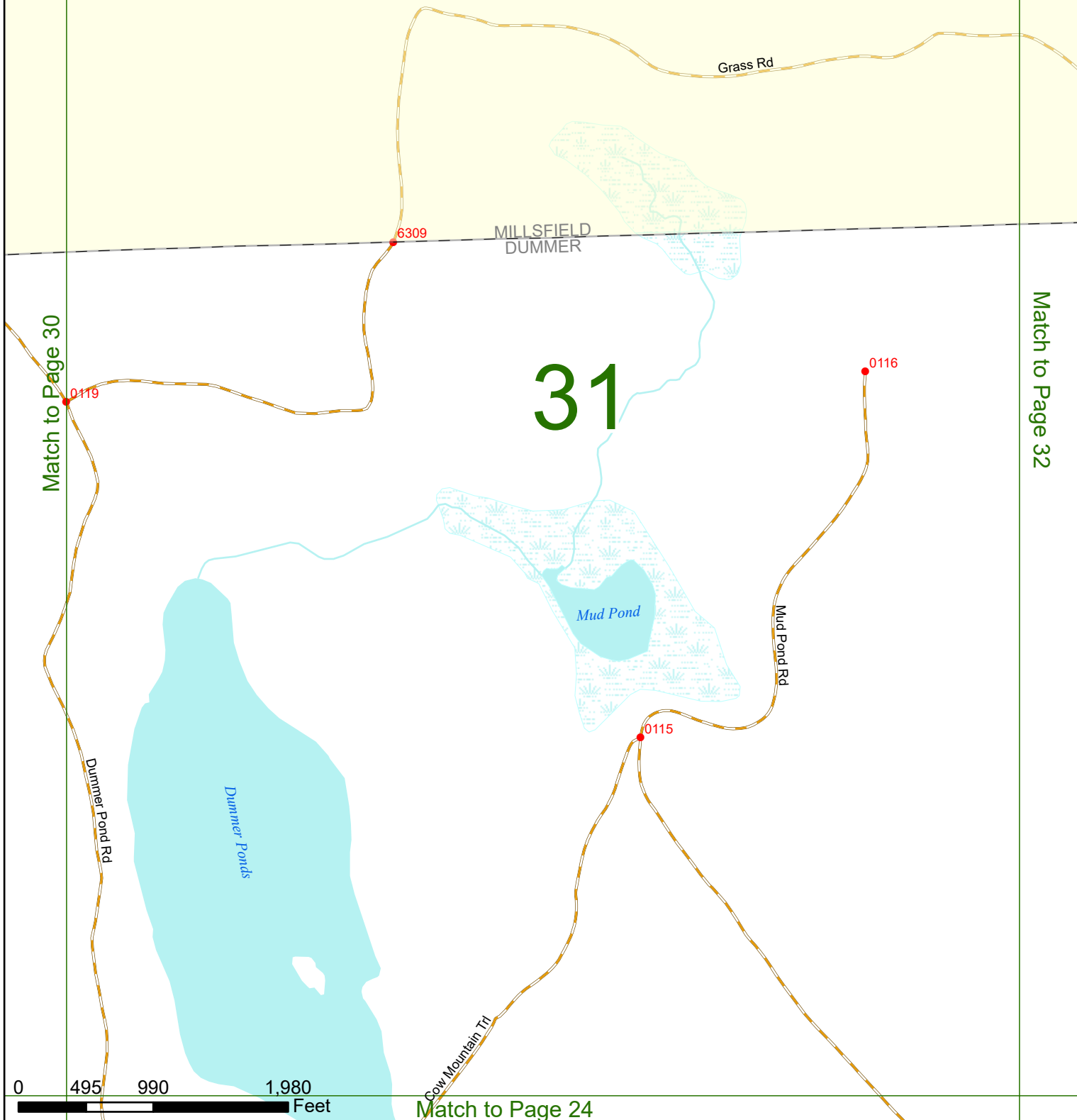

Match to Page 32

Match to Page 0

DUMMER

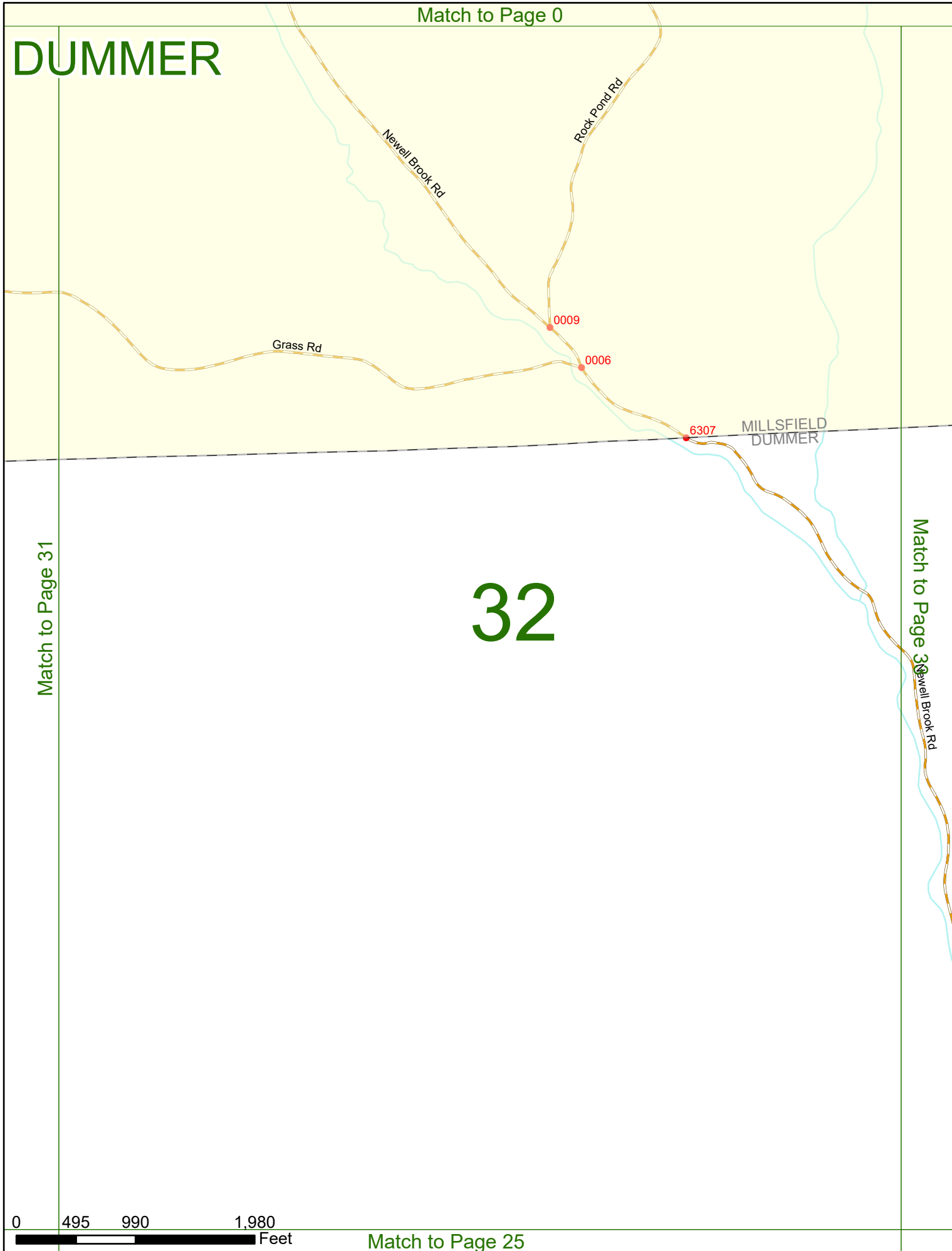

Match to Page 31

32

Match to Page 33
Sewell Brook Rd

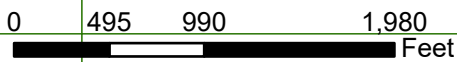

Match to Page 25

DUMMER

ERROL
MILLSFIELD

ERROL
DUMMER

MILLSFIELD
DUMMER

33

Match to Page 32

Match to Page 34

Black Camp Rd

Newell Brook Rd

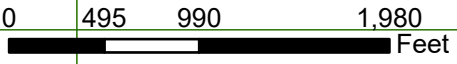

Match to Page 26

0113

DUMMER

Millsfield Pond Rd

ERROL
MILLSFIELD

ERROL
DUMMER
New Sessions
Pond Rd

6310

0122

0124

Sessions Pond

Pond Hill Trail

Match to Page 35

34

0123

Match to Page 33

0114

Black Camp Rd

DUMMER
CAMBRIDGE



DUMMER

Match to Page 0

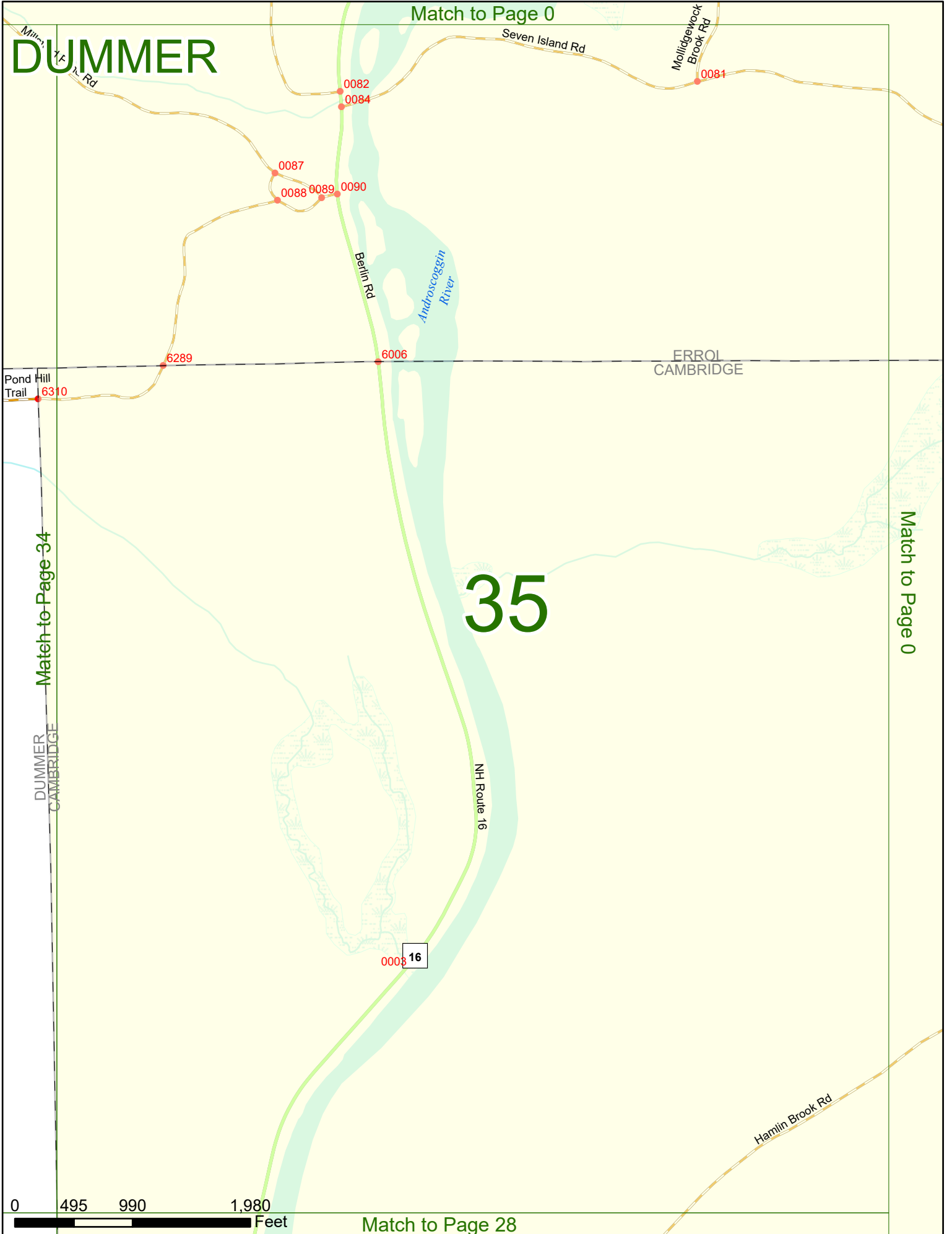

0 495 990 1,980 Feet

Match to Page 28

Match to Page 34

Match to Page 0

35